

F.D. 9097

FIELD NOTES
SUBDIVISIONS AND RANCHO BOUNDARIES

T. 1 S. R. 15 W. S.B.M.

By A. G. Ruxton 1888

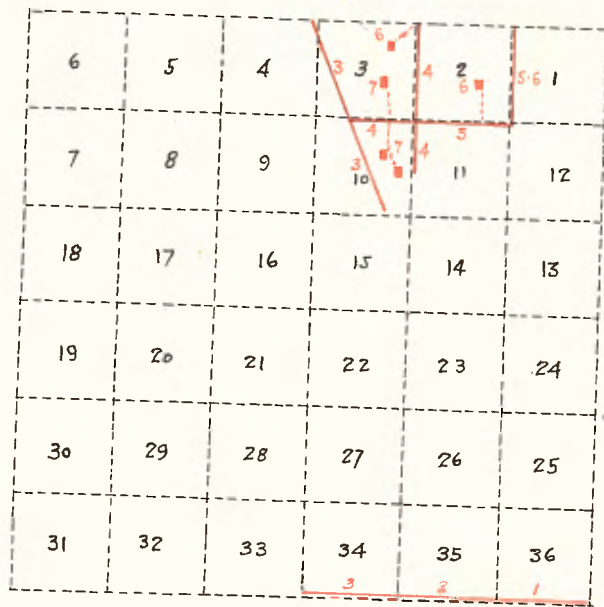

T 1 S

R 15 W

Ruxton

1888

Note: Three notes seem to have a number of typographical errors in them } lines with blue checks
Alfred Jones - 7-1-25 } have been checked against
certified copy. a.g.

From the Township corner to sections 31 and 36, T.1 N., R. 14 and 15 W., S.B.B. & M. the Elder post in mount of rocks still standing and being 37 links West of an Alder post at the East corner of section 1, T. 1 S., R. 15 W.,
 * West on the S. boundary of section 36

Magnetic Var. 14° 45' E.

- 4.00 * Cross deep ravine 50 lks. wide course ^N W. 20° E. - 70 ft.
- 7.34 Brow of ridge course N. and S. + 110 ft. and descend broken West slope thru Chaparral (dense)
- 25.00 Leave west slope and descend across North slope
- 32.00 North points of grassy spur
- 40.00 Point for $\frac{1}{4}$ section corner on South bdy. of section 36
- 42.08 To the Palo Colorado Tree now burned but still standing and plainly marked for $\frac{1}{4}$ section corner, this $\frac{1}{4}$ section corner on the North boundary of Section 1 by approved survey of T. 1 S., R. 15 W.
- 55.00 Cross gully 20 lks. wide course N. 45° W.,
- 57.50 Point of low brushy hill
- 62.00 House of C. Tullis at mouth of ravine coming from the East brs. N. 1.94 chs. dist.
- 62.08 Failed to find any trace of sand rock in mound of rock at point for corner to fractional section 1, set an oak post 30 x 4 x 4 ins., 12 ins. in the ground in a mound of earth ~~36~~ ³⁶ ins. base and 24 ins. high marked $\frac{1}{4}$ S.
- * 64.00 Enter bottom of Franklin canon, comes from the N. 10° E., 10 ft. to NE corner of small corral brs. S. 27 lks. dist.
- 64.50 the SE corner of a stable brs. N. 45 lks. dist.
- 65.60 Cross road course N. and S. 20° W.
- 65.60 Leave bottom of Franklin canon course SW and ascend steep brushy East slope.
- 69.00 Brok of brushy hill + 90 feet
- 72.00 Cross wash 20 lks. wide course S. 80° E.
- 79.80 Cross wash 10 lks. wide runs N. 20° E. about 2.00 chs. into wash last named.
- 80.00 Set a conglomerated sand rock 16 x 12 x 8 ins., 12 ins. in the ground marked with 1 notch on the East and 5 notches on the west side for standard corner to sections 35 and 36 and raised mound of granite boulders and conglomerated rock 36 ins. base and 18 ins. high around said conglomerated sand rock.

From which a

(Burned dead) Live Oak tree 10 ins. dia. marked S. 35 T. 1 N., R. 15 W., B. T. brs. N. 84 $\frac{3}{4}$ ° W., 1.42 lks.
 Land mountainous, very rough and broken covered with chamisal and sagebrush with some scattering Live Oak trees.
 NOTE: I commenced with an assumed variation which I find agreed with the line from the section to the $\frac{1}{4}$ section corner, but the distance I found to be 42.08 chs., I therefore re-measure the line and found the distance as above, I failed to find any trace of a sand rock in mound of sand rock as per official survey at the corner to fractional section 1.
 * West on South boundary of section 35

Magnetic variation 14° 45' East

Ascend steep brushy East slope of mountain.

F.D. 9097

- 4.28 Brow dividing ridge course N. 10° E. and S. 10° W.- 160 ft.
Descend brushy West slope
- 8.40 Enter barley patch of Higgins canon (the was formerly known
as Spanish Canon)
- 10.66 The SW corner of house of P. Higgins brs. S. 31° E., 2.57 chs.
dist.
The SE corner of stable brs. N. 17° E., 2.38 chs. distant
The SE corner of first house built by P. Higgins brs. N. 7½° E.
6.31 chs. distant
- 11.55 Cross road N. 18° E. and S. 18° W.
W. edge of barley patch which extends up and down the canon
10.00 chains each way.
- 12.20 Cross wash 10 lks. wide course S. 18° W. - 70 ft.
Leave Higgin's canon which comes from the N. 10° E. and runs
S. 18° W. and ascend across point of brushy hill.
- 14.75 To NE corner of about 3 acres cleared and plowed land, steep
hilly side
Cross wash 10 lks. wide course S. 70° E., and ascend steep
brushy ravine
- 32.50 Head of ravine and in Barley Patch on summit of ridge, course
N. and S. 20° W., 130 feet.
- 34.30 Leave barley patch N. 10 chs. and S. 50 lks. and enter cleared
and ploughed land.
- 40.00 Set a lime rock 16 x 12 x 7 ins., 12 ins. in the ground for
Standard ¼ section corner, marked ¼ S. on N. side and raised
mound of Lime rock 24 ins. base and 18 ins. high around said
lime rock

From which a

Live Oak tree 6 ins. dia. brs. N. 17½° E. 93 lks. dist.
marked ¼ S.B.T.

Brow of hill at South point of cleared land brs. S. about 5.00
chs. distant at head of deep brushy ravine course West brs. N.
45° E. about 3.00 chs. distant.

- 59.50 Leave brow of ridge and descend West slope thru grass and brush
Cross wire fence enter ravine which comes from the S. 80° E. 170
and along same. The ravine forms the head of East fork of
Benedict Canon.
- 62.50 Cross wash 10 lks. wide course N. 80° W. and run over low point
of hill thru Live Oak trees.
- 71.50 Enter last named ravine
- 73.90 Cross wire fence and wash 10 lks. wide course S. 70° W. and
in barley patch ascend.
- 76.70 Leave barley patch and run over brushy point.
- 78.50 South point of brushy ridge and descend West slope/
- 80.00 Set a sand rock 24 x 12 x 8 ins, 16 ins. in the ground for
Standard corner to sections 34 and 35, marked with 2 notches
on the E. and 4 notches on the West side and X on top and
raised small mound of stone alongside and from which the SW
corner house of John Levell in canon brs. N. 21° 35' W., 10.05
chs. distant
Land mountainous.
Last half mile very grassy hills with young Live Oak trees.

---o---

West on South boundary of section 34.

Magnetic variation 14° 45' East.

- Thru Barley patch
- 1.00- Cross gully 5 lks. wide course S. 10° E. and leave barley
patch which extends about 7.00 chains up canon.
- 1.50 Cross road N 10° W. and S. 10° E.
- 2.00 West edge of bottom or Lovell Canon which comes from the N.
x 13° Wand runs S. 26° W. - 50 ft.
Ascend brushy hill
- 10.00 Brow of ridge course N. 20° W. and S. 10° W. + 90 ft. descend
- 20.26 To a clump of young Elder trees in grassy ravine course S.

FD 9097

23° E.

- This is West fork of Benedict canon
- 20.50 Cross wash 20 lks. wide course S. 23° E., - 100 ft.
 - Ascend grassy East slope of mountain
 - 33.00 Enter small grassy flat
 - 36.00 Ascend North slope
 - 40.00 Set a grey granite rock 20 x 8 x 6 ins., 12 ins. in the ground for standard $\frac{1}{4}$ section corner marked $\frac{1}{4}$ S. on N. face and raised mound of grey granite 18 ins. base and 12 ins. high around said rock.
- From which a
Walnut tree 4 ins. dia. marked $\frac{1}{4}$ S.B.T. in a clump
of 4 Walnuts brs. S. 56 $\frac{1}{2}$ ° W., 50 lks. distant
- 46.00 Ascend steep brushy East slope
 - 51.25 Summit of divide course N. and S. + 500 ft., descend steep brushy West slope
 - 53.50 Cross West slope
 - 65.25 Enter bottom of canon (arroyo Seco) course South
 - 66.90 The NE corner of a chicken house brs. S. 81 lks. dist.
 - 67.25 Cross gully 12 lks. wide with small stream course S.- 300 ft. The house of Griffith brs. N. 1.06 chs. distant
Honey's house S. 127 chs. distant
 - Ascend grassy East slope
 - 76.25 Ascend over brush
 - 80.00 Set a lime rock 16 x 12 x 8 ins., 12 ins. in the ground for Standard corner to sections 33 and 34, marked with 3 notches on the E. and 3 notches on the W. sides and raised small mound of lime rock alongside + 200 ft.
The summit of ridge course N. and S. brs. W. 150 lks. dist.
Land mountainous, good for grazing with scattering Live Oak trees some Chaparral and Sagebrush.

- - - - 0 - - - -

East boundary of Rancho San Vicente Y Santa Monica
From the post marked SW S.M. 25 and S.J.B 9, 14 ins. in mound of earth and slate rock with pits at the common corner to the Rancho San Vicente Y. Santa Monica and San Jose de Buenos Ayres N. 19° 15' W.

- Magnetic var. 14° 45' East.
- 19.50 Along the Easterly boundary of Rancho San Vicente y Santa Monica Brow of spur course S. 60° W. into Arroyo Seco + 50 ft. and run across broken brushy West slope of Mt.
 - 90.00 Brow of ridge course NE and SE + 250 ft. to Arroyo Seco course S. 20° E. brs. W. about 15 chs. distant
Descend across broken brushy West slope
 - 137.00 Cross road in Arroyo Seco course N. 10° E. and S. 10° W.
 - 137.50 Cross wash of Arroyo Seco 10 lks. wide course S. 10° W., 175 ft. ascend across steep brushy East slope of mountain.
 - 170.00 Intersect the S.B.B. line 1.37 chs. East of section corner to sections 33 and 34, set an Oak post 48 x 5 x 5 ins. for corner to Fractional section 3 with a Lime rock 20 x 14 x 8 ins., 14 ins. in the ground, post marked S.V.S.M. on W. side,
S. 34 T. 1 N., R. 15 on NE
S. 3 T. 1 S., R. 15 on SE
 - x Lime rock marked S.W.P.M. on W. side and raised mound of lime rock 32 ins. base and 20 ins. high ground post and rock + 220 ft.
Land mountainous, very rough and broken and covered with Chaparral almost worthless.

March 30th 1888.

- - - - 0 0 0 - - - -

FD 9097

From the $\frac{1}{4}$ section corner between sections 10 and 11, an Elder post in a mound of slate rock on E. slope of ridge North between sections 10 and 11

Magnetic Var. $14^{\circ} 45'$ East

3.00 Foot of ridge and enter Benedict Canon - 20 ft.
7.50 Cross bottom of Benedict canon comes from the N. 40° W. and S. 20° E.
12.00 Brow of spur course SW
17.60 Brow of ridge course S. 70° W. + 200 ft. descend
20.00 Fine no trace of corner to fractional sections 10 and 11, Set a sand rock 14 x 9 x 6 ins. in the ground and raised small mound of sand rock around rock.
27.90 Brow of spur course N. 60° E and S. 60° W., + 100 ft
36.90 Brow of spur course E. and W. + 40 ft. descend
40.00 Set a slate rock 24 x 18 x 2 ins., 18 ins. in the ground for corner to sections 2, 3, 10 and 11, marked with 5 notches on the S. and 2 notches on the E. edges and raised mound of slate rock 36 ins. dia. at base and 18 ins. high around said slate rock. Land rough and broken, covered with Chamisal and Sagebrush.

- - - -0 0 0 - - - -

x West
North between sections 3 and 10

Magnetic var. $14^{\circ} 45'$ East

5.00 Head of brushy ravine course SE and descend
25.00 Set an Elder stake at the E. side of bottom of Benedict canon - 275 feet.
28.00 Leave bottom of Benedict canon comes from the N. 10° E. and runs S. and ascend steep slope of mountain thru dense Chaparral
40.00 Set an Elder post 3 ft. long, 3 ins. sq., with marked stone 12 ins. in the ground for $\frac{1}{4}$ section corner marked $\frac{1}{4}$ S. on N. face and dug pits 18 x 18 x 12 ins. E. and W. of post $5\frac{1}{2}$ ft. dist. and raised mound of earth 24 ins. base and 12 ins. high around post.
47.25 Cross gully 10 lks. wide course S.
50.40 Summit of ridge course NW and SE + 300 ft.
51.10 Intersect the E. bdy. of Rancho San Vicente y Santa Monica
x Set a rock 14 x 11 x 8 ins., 12 ins. in the ground for corner to fractional sections 3 and 10 marked,
S.V.S.M. on W. side
S. 3 on N. and
S. 10 on S. sides
and raised mound of sand rock 36 ins. base and 18 ins. high around said rock,

From which the

post marked S.V.S.M. No. 25 and S.B.J.A. 14 at the southeasterly corner of Rancho San Vicente Y Santa Monica brs. S. $19^{\circ} 15'$ E. 84.83 chains distant.

- - - -0 0 0 - - - -

North between sections 2 and 3

Magnetic variation $14^{\circ} 45'$ East

9.00 Brow of spur N. 80° E. and S. 80° W. + 30 ft.
24.90 Brow of spur N. 75° E. and S. 75° W. + 40 ft.
35.00 Brow of spur N. 77° E. and S. 77° W. - 20 ft.
Descend steep brushy North slope
39.30 Enter ravine course N. 80° W. - 150 ft.
40.00 Set a sand rock boulder 15 x 15 x 12 ins. for $\frac{1}{4}$ section corner marked $\frac{1}{4}$ S. on W. face with marked stone 12 ins. in the ground and raised mound of conglomerated rock 24 ins. base and 18 ins. high around said boulder and

From which an

Elder tree 5 ins. dia. brs. S. $42\frac{3}{4}^{\circ}$ E., 51 lks. marked $\frac{1}{4}$ S.B.T.

Live Oak 5 ins. dia. brs. N. 75° W., 47 lks. marked $\frac{1}{4}$ S.B.T.

40.30 Cross road brs. N. 70° E. and S. 70° W. and ascend rocky South slope.

FD9097

46.60 Brow of ridge N. 70° E. and S. 70° W. + 120 ft. and descend grassy
 North slope thru young Live Oak trees
 64.00 Cross ravine course W. - 50 ft.
 75.68 Enter East fork of Benedict canon course S. 30° W., 60 ft.
 75.80 Cross wash 10 lks. wide course S. 30° W.
 77.80 Cross wire fence N. 85° E. and S. 85° W.
 80.68 Set a sand rock 19 x 8 x 8 ins. 15 ins. in the ground for Closing
 Corner to sections 2 and 3, marked C.C. with 2 notches on the E.
 face and 4 notches on the W. face and raised mound of earth and
 lime rock 48 ins. base and 36 ins. high around said sand rock on
 brushy hillside and

From which the
 Standard corner to sections 34 and 35 brs. West 31 lks. dist.
 Land mountainous.
 First half very rough and covered with Chaparral
 Last half mile good grazing

-- - - - 0 0 0 - - - -

East on a random line between sections 2 and 11
 Magnetic var. 14° 45' East

40.00 Set temporary $\frac{1}{4}$ section corner,
 80.10 Intersect N. and S. line 98 lks. N. of the established corner
 to sections 1, 2, 11 and 12, a conglomerate quartz rock
 22 x 16 x 14 inches, 10 ins. deep.

From which corner I run
 N. 89° 18' W. on a true line between sections 2 and 11
 Magnetic var. 14° 45' East

.75 Enter vineyard at foot of low point of spur on East side of
 Franklin Canon

Vineyard and orchard extend about 10.00 chains up the canon.

2.30 Cross road N. 10° W. and SE

3.50 Cross wash course SE

4.90 Leave bottom of Franklin canon which comes from N. 10° W.,
 runs S. 45° E. about 15.00 chains, thence S. 20° E.
 Elevation 550 ft. above sea level

Ascend steep brushy East slope

11.00 x Brow of divide course N. 60° E. and S. 6° W. + 200 ft.

Descend steep brushy West slope

16.00 Enter bottom of Higgin's canon course S. 5° E. 175

16.77 Cross road N. 5° W. and S. 5° E., set stake

19.40 Leave canon and ascend steep brushy East slope

33.00 Brow of divide course N. 10° W. and S. 10° E. - 400 ft.

Descend steep brushy West slope

40.05 Set an Elder post 4 ft. long, 4 ins. sq., for $\frac{1}{4}$ section corner
 marked $\frac{1}{4}$ S. on the N. side with marked slate rock 12 ins. in
 the ground and raised mound of earth and slate rock 36 ins. and
 24 ins. high around post.

44.50 Enter Pea Vine canon course S. - 200 ft.

49.00 Leave canon and ascend steep brushy East slope

69.00 Summit of divide course N. 20° E. and S. 20° W., -300 ft. descend

80.10 The corner to sections 2, 3, 10 and 11 - 90

Land mountainous, very rough and covered with dense Chaparral.

- - - 0 0 0 - - -

✓ North between sections 1 and 2

Enter

✓ Magnetic Var. 14° 45' East

✓ 6.00 Thence in small ravine. The house of ^{Neph} Levening brs. W. 1.00 ch. dist.

✓ 7.00 Cross ravine with small stream; course S. 80° W., and ascend

✓ 14.90 Brow of brushy spur; course W. - 100 ft.

✓ Summit of ridge brs. E. about 3.00 chs. dist.

✓ 35.80 Brow of brushy spur course West - 100 ft.

Descend steep brushy north slope

9097

- ✓ 40.00 Set a grey granite rock 18 x 7 x 5 ins., 12 ins. in the ground for $\frac{1}{4}$ section corner, marked " $\frac{1}{4}$ " on W. face and raised mound of grey granite rock 54 ins. base and 16 ins. high around rock.
- ✓ 40.75 Cross wash 50 lks. wide course W. with large granite boulder 50 ft. Ascend steep brushy slope.
- ✓ 44.50 Brow of brushy spur course S. 70° W., + 50 ft. Descend.
- ✓ 55.50 Brush fence at southwesterly end of small garden patch on hillside.
- ✓ 56.47 to a sycamore tree 22 ins. dia. in bottom of Franklin canon
- ✓ 57.70 Cross stream in rocky wash 10 lks. wide; course S. 20° W., 90 feet.
- ✓ 58.10 Cross road N. 20° E. and S. 20° W.
- ✓ A Spring brs. S. 76 $\frac{1}{2}$ ° E. 4.65 chs. distant.
- ✓ Leave bottom of canon and ascend low brushy point
- ✓ 67.50 Brow of spur N. 68° W. and S. 68° E. + 110 ft. Descend N. slope.
- ✓ 75.60 Brow of grassy spur, E. and W. + 40 ft.
- ✓ 79.57 Set a Redwood post, 5 ft. long, 4 ins. sq., with charred stake and 12 small granite rocks 15 ins. in the ground for Closing Corner to sections 1 and 2 on the base line. Post marked.
- ✓ C. C. T. 1 S., R. 15 W. on S;
- ✓ S. 1 on E. side;
- ✓ S. 2 on W. side;
- ✓ and raised mound of earth and granite boulders 60 ins. base and 36 ins. high around post,
- ✓ From which
- ✓ The standard corner to sections 35 and 36 brs. West 64 lks. dist.
- ✓ Land mountainous, very rough and broken, Covered with Chamisal
- ✓ Poison Oak and Sagebrush.

- - - - 0 0 0 0 - - - -

Travers to locate house in section 2,
 From the stake in Higgin's canon N. 89° 18' W., 16.77 chs. from
 the corner to sections 1, 2, 11 and 12,
 N. 30° 15' W.

Magnetic Var. 14° 45' East

- 5.50 Up Higgin's canon
 To station, Thence
 N. 9° W.
- 13.20 To station Thence
 N. 23 $\frac{1}{2}$ ° W.
- 10.75 To center of E. side of house of L. Sarnow
 Travers locate house on Benedict canon
 Traverse No. 1.
 From the closing corner to sections 2 and 3
 S. 32° 15' W.
- Magnetic var. 14° 45' East
- 3.50 Cross wire fence N. 85° E. and S. 85° W.
- 10.00 To station in center of canon 4 chs. wide thence
 S. 11° 45' W.
- 2.50 To station in canon 2 chs. wide Thence
 S. 23° W.
- 8.70 To station Thence
 S. 65° 45' W.
- 5.00 To station Thence
 N. 23° W.
- 2.15 To the SW cor. of house of E. Parrish at foot of point of divide
 between E. and W. forks of Benedict Canon
 Traverse No. 2
 From the Elder stake 25.00 chs. W. of corner to sections 2, 3, 10
 and 11,
 N. 4° E.
- Magnetic Var. 14° 45' E.

9097

Up canon
 1.00 Cross wire fence course E. and W. across Benedict canon
 3.50 To station Thence
 N. 14° E.
 3.20 To station Thence
 N. 8° E.
 4.50 To station Thence
 N. 19° E.
 4.50 To station Thence
 North
 4.00 To station Thence
 North 43° 45' E.
 3.80 To station Thence
 N. 13° W.
 7.60 To SW corner of house of Dietrich on the west side of Benedict
 canon 4 chs. wide
 Traverse No. 3
 From the Elder stake 25 chains West of the corner to sections 2,
 3, 10 and 11
 S. 12° W.

Magnetic var. 14° 45' East

Down Benedict Canon
 5.20 To station in center of canon 3 chs. wide Thence
 S. 11° 15' W.
 4.50 To station Thence
 S. 15° E.
 7.90 To the NE corner of house of J. Schaefer
 Thence
 S. 49½° E.
 7.20 To station Thence
 S. 8° 15' E.
 4.90 To the SE corner of the house of C. Hanson on the SW side
 of canon 4 chs. wide.

--- -0 0 0 ---

Albert Geo. ^R ~~X~~uxton
 1880.

FD 9097