

Field Notes of Sections 20 and 28 of Township 7 North,
 Range 9 West, San Bernardino Meridian,
 California.

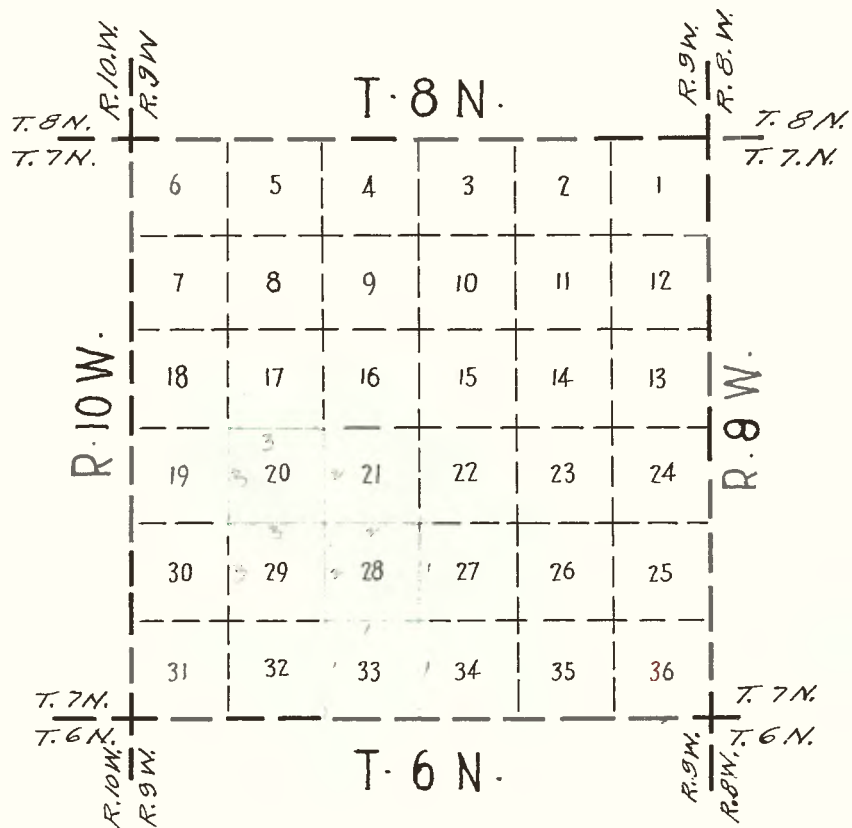

R. W. Norris
 Oct. 19th 1855.

North between sections 33 and 34.

Variation 14° 08' E.

x x x x x x x x x x x

- 80.00 Set a charred post for the corner to sections 27, 28, 33 and 34 and made a mound with trench and pits as per instructions.
Land level and second rate.

North between sections 27 and 28.

Variation 14° 08' E.

- 40.00 Set a charred post for the $\frac{1}{4}$ section corner and made a mound with trench and pits as per instructions.
80.00 Set a charred post for the corner to sections 21, 22, 27 and 28 and made a mound with trench and pits as per instructions.
Land generally level and sandy with grass and bushes.

February 13, 1856.

North between sections 32 and 33.

Variation 14° 08' E.

- 31.00 To foot of hill or mountain and along east side.
40.00 Set a charred post for $\frac{1}{4}$ section corner and made a mound with trench and pits as per instructions.
80.00 Set a charred post for the corner to sections 28, 29, 32 and 33 and made a mound with trench and pits as per instructions.
Land hilly and rolling with some grass and bushes.

East on a random line between sections 28 and 33.

Variation 14° 08' E.

- 15.00 Leave mountain.
40.00 Set a post for temporary $\frac{1}{4}$ section corner.

80.46 Intersect North and South line 45 links north of corner to sections 27, 28, 33 and 34, from which corner, I run West on the true line between sections 28 and 33.

Variation 13° 49' E.

40.23 Set a charred post for the $\frac{1}{4}$ section corner and made a mound with trench as per instructions.

80.46 The corner to sections 28, 29, 32 and 33.
Land second rate and generally level.

North between sections 28 and 29.

Variation 14° 08' E.

15.00 Leave mountain.

40.00 Set a charred post for the $\frac{1}{4}$ section corner and made a mound with trench and pits as per instructions.

80.00 Set a charred post for the corner to sections 20, 21, 28, and 29 and made a mound with trench and pits as per instructions.
Land second rate and level with find grass.

East on a random line between sections 21 and 28.

Variation 14° 08' E.

40.00 Set a post for temporary $\frac{1}{4}$ section corner.

80.39 Intersect North and South line 41 links North of the corner to sections 21, 22, 27 and 28, from which corner, I run West on the true line between sections 21 and 28.

Variation 13° 51' E.

40.19 Set a charred post for the $\frac{1}{4}$ section corner and made a mound with trench and pits as per instructions.

80.39 The corner to sections 20, 21, 28 and 29.
Land level and second rate.

North between sections 20 and 21.

Variation 14° 08' E.

40.00 Set a charred post for the $\frac{1}{4}$ section corner and made a mound with trench and pits as per instructions.

80.00 Set a charred post for the corner to sections 16, 17, 20 and 21, and made a mound with trench and pits as per instructions.
Land second rate, sandy and level.

North between sections 29 and 30.

Variation 14°08' E.

x x x x x x x x x x x x x

80.00 Set a charred post for corner to sections 19, 20, 29 and 30, and made a mound with trench as per instructions.
Land level, sandy and generally second rate.

East on a random line between sections 20 and 29

Variation 14° 08' E.

40.00 Set a post for the temporary $\frac{1}{4}$ section corner.

80.56 Intersect the North and south line 44 links north of the corner to sections 20, 21, 28 and 29, from which corner, I run West on the true line between sections 20 and 29.

Variation 13°39' E.

40.28 Set a charred post for the $\frac{1}{4}$ section corner and made a mound with trench and pits as per instructions.

80.56 The corner to sections 29, 30, 19 and 20.
Land slightly rolling with good grass.

North between sections 19 and 20.

Variation 14° 08' E.

40.01 Set a charred post for $\frac{1}{4}$ section corner and made a mound with trench as per instructions.

80.00 Set a charred post for the corner to sections 19, 20, 17 and 18 and made a mound with trench as per instructions.
Land level and sandy with grass and bushes.

East on a random line between sections 17 and 20.

Variation 14° 08' E.

- 40.00 Set a post for temporary $\frac{1}{4}$ section corner.
- 80.61 Intersect the North and South line 43 links North of the corner to sections 16, 17, 20 and 21, from which corner, I run West on the true line between sections 17 and 20.

Variation 15° 50' E.

- 40.50 Set a charred post for the $\frac{1}{4}$ section corner and made a mound with trench and pits as per instructions.
- 80.60 The corner to sections 17, 18, 19 and 20.
Land level and sandy with grass and bushes.

Surveyed by R. W. Norris, Deputy Surveyor,

Contract dated October 19, 1855.