

FIELD NOTES OF SURVEY OF
 CERTAIN LINES Bet. Tps. 6 & 7 N., Rs. 9 & 10 W.,
 S.B.M.,
 California.

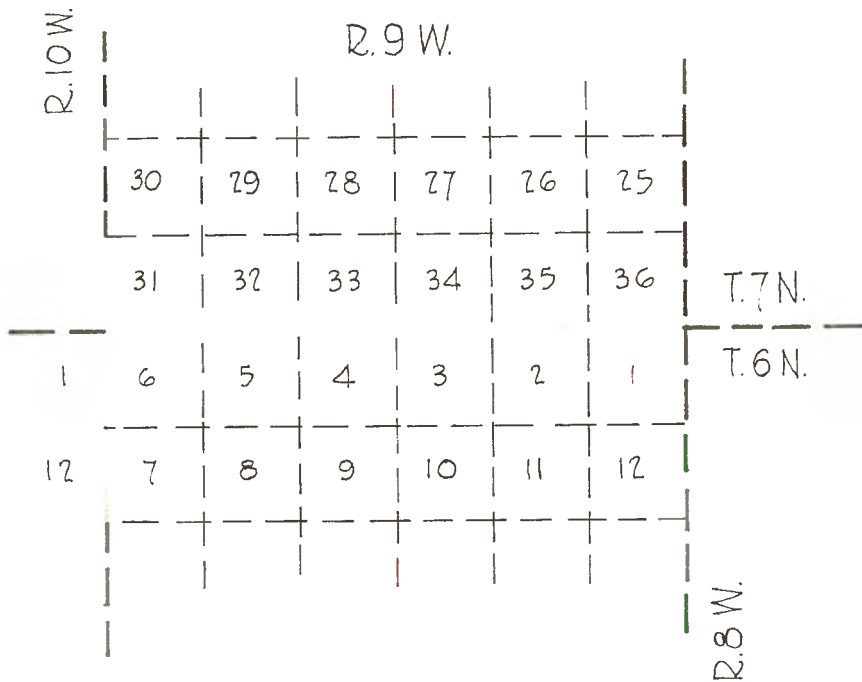

R. W. NORRIS
 1854.

Surveyed by R. W. Norris,
Contract of 1854.
Book 161, Part 19.

T. 6 N., R. 10 W., S.B.M. E. B.

North on the E. bdy. of sec. 12.

XXXXXXXXXXXX

80.00 Set charred chalked & notched post cor. to secs. 1, 12, 6 & 7,
made mound, trench, pits, etc. as per instructions.

Land generally 3rd rate.

North on the East bdy. of sec. 1.

Descending.

40.00 Set $\frac{1}{4}$ sec. charred and chalked post, made mound, trench, pits, etc.
as per instructions.

62.00 Ascend and run among immense pile of sand rocks.

79.00 To summit and descend.

80.00 To cor. Tps. 6 & 7 N., Rs. 9 & 10 W.

Set charred & chalked & notched post, made mound, trench, pits, etc.
as per instructions.

This corner is on the E. slope of high sand stone ridge.

North bdy. T. 6 N., R. 9 W., S.B.M.

Var.--

East on a random line on the north bdy. of secs. 6,5,4, 3, 2, 1

Set temp. mile and half mile posts ' int. east bdy. 30 lks. S.

of true cor. of Tps. 6 & 7 N., Rs. 9 & 8 W. 5 miles 79 chs.

88 lks. Therefore the correction will be 12 lks. W. 5.5 N
per mile.

True North Bdy.

Var. 14° 08' E.

West on the N. bdy. of sec. 5.

xxx

80.00 Set charred, chalked & notched post cor. to secs, 5, 6, 31, 32,
made mound, trench, pits, etc. as per instructions.
Soil 3d rate, scattering Spanish bayonet & scrub.

West on the N. bdy. of sec. 6.

7.00 Foot of ascent.
34.25 Foot of stony ridge.
40.00 Set $\frac{1}{4}$ sec. charred & chalked post, made mound, trench, pits, etc.
as per instructions, on East side of stony ridge.
47.00 Summit of stony ridge.
48.00 Foot of stony ridge.
79.88 To established cor. of Tps. 6 & 7 N., Rs. 9 & 10 W.
Land generally 2d rate.

East bdy. of T. 7 N., R. 10 W., S.B.M.

Var. 14° 12' E.

North on the East bdy. of sec. 36.

30.00 On desert plain.
40.00 Set $\frac{1}{4}$ sec. charred, chalked post made mound, trench, pits, etc. as
per instructions.
Last half mile good grazing.
80.00 Set charred, chalked & notched post, cor. to secs. 25, 36, 30, 31
made mound, trench, pits, etc. as per instructions.
Land 3rd rate.
