

RETURN TO  
COUNTY SURVEYOR,  
LOS ANGELES.

Field Notes  
of the  
North Boundary of Sections 4, 5, 6,  
T 1 N, R 7 W, S.B.M.

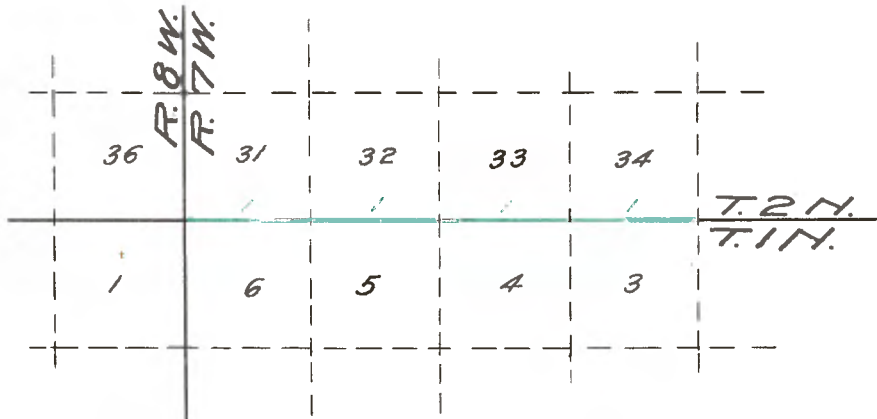

North Boundary of T 1 N, R 7 W. S.B.M.

S. 89° 47' W, on a TRUE LINE between Secs 3 and 34.

Var 14° 26' E.

80 00 Set a granite stone 17x11x8 ins. 11 ins in the ground for cor to Secs 3, 4, 33 and 34, marked with 3 notches on E & W edges, and raised a mound of stone alongside. Pits impracticable.

S. 89° 47' W, on a TRUE LINE between Secs 4 and 33.

Var 14° 26' E.

Ascend through dense brush.

28 00 Enter timber bears N & S.

40 00 Set a granite stone 28x20x6 ins 21 ins in the ground for  $\frac{1}{4}$  sec cor, marked  $\frac{1}{4}$  on N face and raised a mound of stone alongside. Pits impracticable.

41 00 Descend along N slope.

80 00 Set a granite stone 40x20x8 ins 30 ins in the ground for cor to secs 4, 5, 32 and 33, marked with 4 notches on E and 2 notches on W edges, from which bears

A pine 16" dia. S 41° E, 69 lks dist marked T 1 N, R 7 W S 4 BT.

A pine 12" dia S 14° W, 81 lks dist mkd T 1 N R 7 W S 5 BT.

No other tree within limits, raised a md of stone alongside.

Pits impracticable. Land mountainous. Soil 2nd & 3rd rate.

Timber of pine and cedar and dense undergrowth of chamisal.

S. 89° 47' W, on a TRUE LINE between Secs 5 and 32.

Var 14° 26' E.

Ascend through dense brush.

26 00 Top of ridge bears E & W and along same.

40 00 Set a granite stone 12x12x8x8 ins, 8 ins in the ground for  $\frac{1}{4}$  sec cor mkd  $\frac{1}{4}$  on N face and raised a md of stone alongside. Pits impracticable.

58 00 Descend abruptly.

72 50 Cross low sag and ascend

80 00 Set a granite stone 15x7x7 ins, 10 ins in the ground for cor to Secs 5, 6, 31 and 32, mkd with 5 notches on E and 1 notch on W edges, and raised a md of stone alongside. Pits impracticable.

Land mountainous. Soil 2nd & 3rd rate. Dense undergrowth chemisal.

S. 89° 47' W, on a TRUE LINE between Secs 6 and 31.

Var 14° 26' E.

Descend.

19 30 Cross gulch 10 lks wide, course S. 30° E, and ascend.

40 00 Set a granite stone 14x8x8 ins. 9 ins in the ground for  $\frac{1}{4}$  sec cor, mkd  $\frac{1}{4}$  on N face, and raised a md of stone alongside. Pits impracticable.

51.00 Top of Divide between Cucamonga and San Antonio Creeks, bears N & S, and descend.

82 08 The corner to Tps 1 and 2 N, Rs 7 and 8 W.

Land mountainous. Soil 2nd and 3rd rate. Dense undergrowth chaparral.

February 1st, 1854.

Surveyed by J. R. Glover, Deputy Surveyor,  
Contract dated January 14, 1884.

-----