

FIELD NOTES
of
Interior Section Lines
in
Township 8 North, Range 18 West
S. B. M.

Copied from official notes loaned
by Forest Supervisor at Santa Bar-
bara, California, July 1922

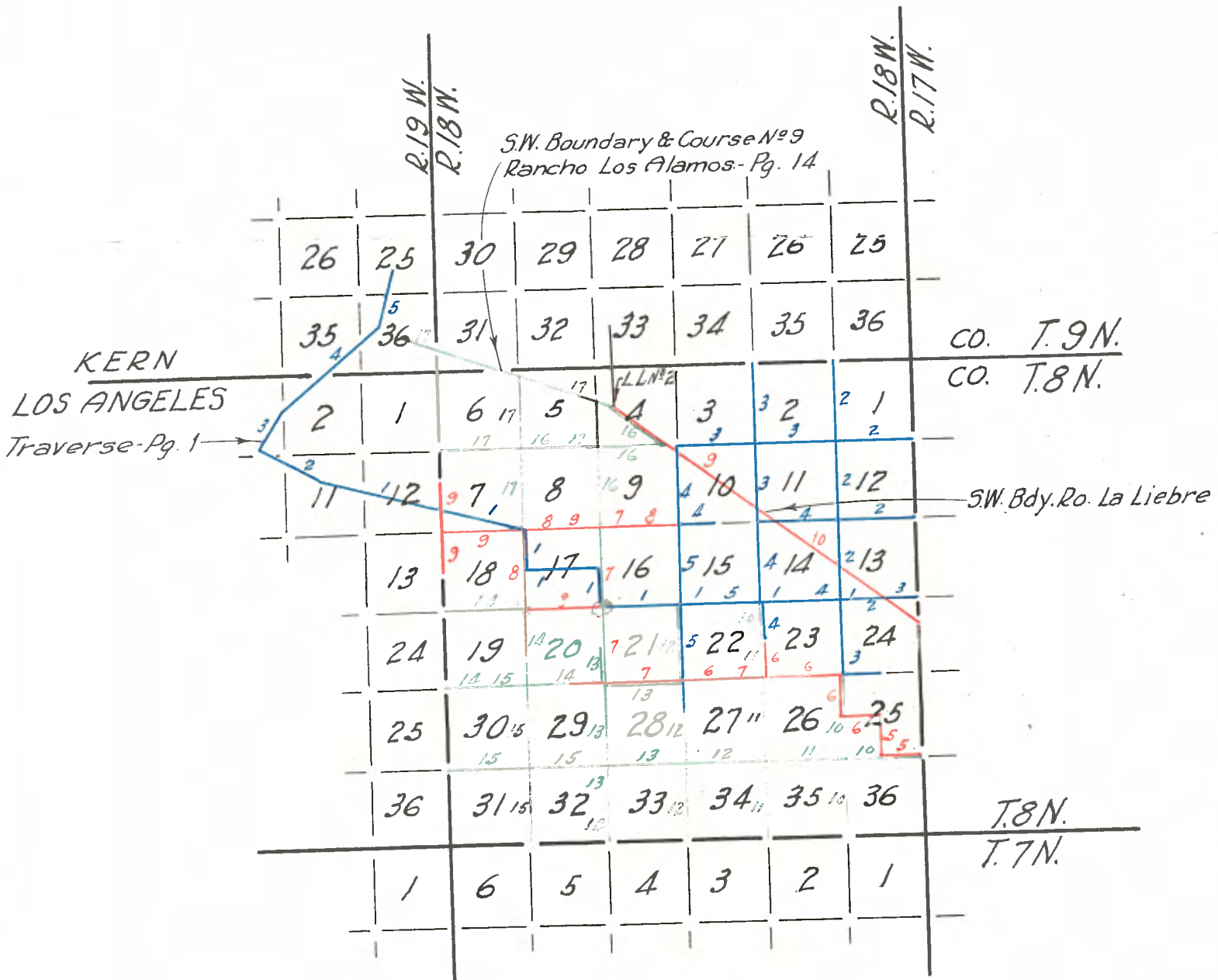

- R. S. Norris - 1854-1855
- John Goldsworthy - 1873
- T. H. Norway - 1880

T. 5 N., R. 15 W., S. B. M.

40.00 West on S. line of Sec. 13. Va. 14th 8' E.
Set $\frac{1}{4}$ mile post with mound cor. to secs. 13, 14, 23
and 24.

50.00 Set post with mound, cor. to secs. 13, 14, 23, 24.
Land 2nd rate, open and hilly.
On S. line of sec. 14.

40.00 Set $\frac{1}{4}$ sec. post with mound.
65.00 To valley.
50.00 Set post with mound, corner to secs. 14, 15, 22 and 23
2nd rate land and hilly.
South line of sec. 15.

2.00 Cross road to Cajon de Las Rivas, course N. of W.
40.00 Set $\frac{1}{4}$ sec. post with mound.
50.00 Set post with mound, cor. to secs. 15, 16, 21, 22 at foot
of hill.
2nd rate land and rolling.
South line of sec. 16.
Over hills.

40.00 Set $\frac{1}{4}$ sec. post with mound.
65.00 To valley extending more than 1 mile S.
80.00 Set post with mound, cor. to secs. 16, 17, 20 and 21.
Land good 2nd rate.
North on W. line of sec. 16.

40.00 Set $\frac{1}{4}$ sec. post on road to Cajon Des Rivas, course E.
& W. on S. bank of small lake. Made mound and run W.
through sec. 17.
West inside of sec. 17.

4.00 Pass W. end of lake.
31.50 Cross trail to San Francisco Rancho, course S.
50.00 Set $\frac{1}{4}$ sec. post on W. line of sec. 17 and make mound.
Land 2nd rate.
North on W. line of sec. 17.

30.00 Cross road to Cajon des Rivas.
40.00 Set post with mound, cor. to secs. 7, 8, 17 and 18, with
1 ch. S. as the cor. comes in gulch.
From this point true cor. I commence a traverse as the pass
is too narrow to run but short dist. at right angles.

Course	Dist.	North	South	East	West
1					
N 74 W	226.00	62.29			217.25
2					
N 60 W	49.00	24.50			42.44
3					
N 29 E	60.00	52.48		29.09	
4					
N 51 E	120.00	75.52		93.25	
5					
N 14 E	65.00	<u>63.07</u>		<u>15.72</u>	
		277.86		138.06	<u>259.69</u>
					<u>138.06</u>
					121.63

180.00 Ascend ridge.
226.00 To summit and descend.
About 40 chs. E. a lake and near here at E. entrance to
the valley called Canada des las Rivas. At this post, I
am inside of sec. 25, R. 19 W., T. 9 N. I run N.

July 15, 1854
R. W. MORRIS

Vol. 273-12
G.B.J.

T. 5 N., R. 15 W., S. E. M.

From the cor. to secs. 1 and 2 on N. E. of the Tp. I
run South bet. secs. 1 and 2. Va. 14° 13' E.
20.00 Enter broken hills.
40.00 Set a post, charred and chalked for the $\frac{1}{4}$ sec. cor. and
raised a mound with trench and pits as per inst.
60.00 To scattering timber.
80.00 Set a post, charred and chalked and notched for the cor.
to secs. 1, 2, 11 and 12; raised a mound with trench and
pits as per inst. from which a
White oak 14 in. dia. brs. N. 34° E. 244 lks. dist.
Land 2nd rate and rough hills.
East on a random line bet. secs. 1 and 12. Va. 14° 13' E.
20.00 Leave scattering timber.
40.00 Set a post for temp. $\frac{1}{4}$ sec. cor.
75.00 To a valley.
80.18 Int. E. E. of the Tp. 36 lks. N. of the cor. to secs. 1 and
12, from which cor. I run West on a true line bet. secs. 1
and 12. Va. 13° 58' E.
40.09 Set a post charred and chalked for the $\frac{1}{4}$ sec. cor. and
raised a mound with trench and pits as per inst.
80.18 The cor. to secs. 1, 2, 11 and 12.
Land 2nd rate and very hilly with scattering oak, cedar
and scrub.
South bet. secs. 11 and 12. Va. 14° 13' E.
5.00 Leave timber.
40.00 Set a post charred and chalked for $\frac{1}{4}$ sec. cor. and raised
a mound with trench and pits as per inst.
80.00 Set a post charred and chalked and notches for the cor. to
sec. 11, 12, 13 and 14, and raised a mound with trench and
pits as per inst.
Land 2nd rate and hilly.
East on a random line bet. secs. 12 and 13. Va. 14° 13' E.
18.00 Enter a valley bearing E. & W.
40.00 Set a post for tem. $\frac{1}{4}$ sec. cor.
69.00 To hills.
79.91 Int. the E. E. of the Tp. 50 lks. N. of the cor. to secs. 12
and 13 from which cor. I run
West on true line bet. secs. 12 and 13. Va. 13° 52' E.
39.95 Set a post charred and chalked for the $\frac{1}{4}$ sec. cor. and
raised a mound with trench and pits as per inst.
79.91 The cor. to secs. 11, 12, 13 and 14.
Land hilly and 2nd rate.
South bet. secs. 13 and 14. Va. 14° 13' E.
7.00 To a small valley bearing E. & W.
18.00 To hills.
40.00 Set a post, charred and chalked for the $\frac{1}{4}$ sec. cor. and
raised a mound with trench and pits as per inst.
75.00 To a valley course E. & W.
80.00 Set a post charred and chalked and notches for the cor. to
secs. 13, 14, 23 and 24, and raised a mound with trench
and pits as per inst.
Land hilly and 2nd rate.
East on a random line bet. secs. 13 and 24. Va. 14° 13' E.
20.00 To broken hills.
40.00 Set a post for tem. $\frac{1}{4}$ sec. cor.
80.26 Int. the E. E. of the Tp. 67 lks. N. of the cor. to secs. 13
and 24, from which cor. I run West on true line bet. secs.
13 and 24.
Va. 13° 44' E.

40.13 Set a post charred and chalked for the $\frac{1}{4}$ sec. cor. and raised a mound with trench and pits as per inst.

50.26 The cor. to secs. 13, 14, 23 and 24. Land hilly and 2nd rate. South bet. secs. 23 and 24. Va. $14^{\circ} 13'$ E.

7.00 Enter dry bed of Lake extending 40 chs. E. and 20 chs. W.

15.00 Leave bed of lake.

27.50 Cross road to Fort Tejon course E. & W.

31.00 Enter very abrupt hills.

40.00 The hill is so steep that I cannot make a mound for the $\frac{1}{4}$ sec. cor. and I therefore construct a witness mound 3 chs. S. and set a post charred and chalked

50.00 Set a post charred, chalked and notches for the cor. to secs. 23, 24, 25 and 26, and raised a mound with trench and pits as per inst. Land on N. portion of this line is valleys 1st rate; the remainder is mountainous and 2nd rate. East on a random line bet. secs. 24 and 25. Va. $14^{\circ} 13'$ E.

38.00 To scattering pine timber.

40.00 Establish the $\frac{1}{4}$ sec. cor. by setting a post charred and chalked and raising a mound with trench, from which a Pine 20 in. dia. brs. W. 90 lks. dist. Land 2nd rate. It is impossible to proceed further with this line on account of the steep mountains. Nor is it possible to run further S. for the same reason. South bet. secs. 2 and 3. Va. $14^{\circ} 13'$ E.

10.00 Enter broken hills.

40.00 Set a post charred and chalked for the $\frac{1}{4}$ sec. cor. and raised a mound with trench and pits as per inst. from which a White Oak 12 in. dia. brs. N. 34 E. 296 lks. dist.

50.00 Set a post charred, chalked and notches for the cor. to secs. 2, 3, 10 and 11 and raised a mound with trench and pits as per inst., from which a White oak 18 in. dia. brs. N. $10\frac{1}{2}^{\circ}$ E. 348 lks. dist. Land very hilly and broken, generally 2nd rate. East on random line bet. secs. 2 and 11. Va. $14^{\circ} 13'$ E.

40.00 Set a post for temp. $\frac{1}{4}$ sec. cor.

79.55 Int. N. & S. line 42 lks. N. of cor. to secs. 1, 2, 11, 12 from which cor. I run West on a true line bet. secs. 2 and 11. Va. $13^{\circ} 55'$ E.

39.77 Set a post charred and chalked for the $\frac{1}{4}$ sec. cor. and raised a mound with trench and pits as per inst.

79.55 The cor. to secs. 2, 3, 10 and 11. Land 2nd rate. Broken hills and scattering oak. South bet. secs. 10 and 11. Va. $14^{\circ} 13'$ E.

40.00 Set a post charred and chalked for the $\frac{1}{4}$ sec. cor. from which a white oak 36 in. dia. brs. S. $58\frac{1}{2}^{\circ}$ W. 62 lks. dist. A white oak 30 in. dia. brs. N. 53° $\frac{1}{2}$ W. dist. 87 lks.

50.00 Set a post charred and chalked and notches for the cor. to secs. 10, 11, 14 and 15, in mound with trench, from which a White oak 14 in. dia. brs. N. 29° E. 348 lks. dist. White oak 8 in. dia. brs. S. 45 W. 3.50 lks. dist. Land 2nd rate. Hills abrupt and broken. East on a random line bet. secs. 11 and 14. Va. $14^{\circ} 13'$ E.

20.00 Leave scattering timber.

40.00 Set post for temp. $\frac{1}{4}$ sec. cor.

79.62 Int. N. & S. line 14 lks. N. of the cor. to secs. 11, 12, 13 and 14, from which cor. I run
 39.81 West on a true line bet. secs. 11 and 14. Va. 14° 06' E.
 Set a post charred and chalked for $\frac{1}{4}$ sec. cor. and raised a mound with trench and pits as per inst.
 79.62 The cor. to secs. 10, 11, 14 and 15.
 Land good 2nd rate and very hilly.
 South bet. secs. 14 and 15. Va. 14° 13' E.
 40.00 Set a post charred and chalked for the $\frac{1}{4}$ sec. cor. and raised a mound with trench and pits as per inst.
 63.00 Leave scattering timber.
 65.00 Enter a Valley bearing E. & W.
 80.00 Set a post charred, chalked and notches for the cor. to secs. 14, 15, 22 and 23, and raised a mound with trench and pits as per inst.
 Land 2nd rate and very hilly.
 East on a random line bet. secs. 14 and 23. Va. 14° 13' E.
 40.00 Set a post for temp. $\frac{1}{4}$ sec. cor.
 79.56 Int. N. & S. line 50 lks. N. of the cor. to secs. 13, 14, 23, 24, from which cor. I run
 West on a true line bet. secs. 14 and 23. Va. 13° 52' E.
 39.78 Set a post charred and chalked for $\frac{1}{4}$ sec. cor. and raised a mound with trench and pits as per inst.
 79.56 The cor. to secs. 14, 15, 22 and 23.
 Land hilly and good 2nd rate.
 South bet. secs. 22 and 23. Va. 14° 13' E.
 3.50 Cross road to Fort Tejon, course N. 80° W.
 40.00 Set a post charred and chalked for the $\frac{1}{4}$ sec. cor. and raised a mound with trench and pits as per inst.
 This post is on the base of mountain and it is impossible to survey further South as the mountains are very steep and rough.
 As it is not practicable to run the line bet. secs. 3 and 4 on account of the mountains, I run
 West from the cor. to secs. 2, 3, 10, 11.
 West bet. secs. 3 and 10. Va. 14° 13' E.
 40.00 Set a post charred and chalked for the $\frac{1}{4}$ sec. cor. and raised a mound with trench and pits as per inst.
 80.00 Set a post charred, chalked and notches for the cor. to secs. 3, 4, 9, 10 and raised a mound with trench and pits as per inst.
 Land good 2nd rate. Hills very steep, scattering oak and pine.
 South bet. secs. 9 and 10. Va. 14° 13' E.
 40.00 To a live oak 6 in. dia. which I mark as inst. for the $\frac{1}{4}$ sec. cor.
 80.00 Set a post charred, chalked and notches for the cor. to secs. 9, 10, 15 and 16, in a mound with trench and pits per inst., from which a
 White oak 6 in. dia. brs. N. 2° E. 86 lks.
 White oak 6 in. dia. brs. S. 15° W. 37 lks.
 Pine 8 in. dia. brs. S. 72° E. 36 lks.
 Land 2nd rate, but broken and mountainous.
 East on a random line bet. secs. 10 and 15. Va. 14° 13' E.
 40.00 Set a post charred and chalked for the $\frac{1}{4}$ sec. cor. from which
 White oak 10 in. dia. brs. N. 17 $\frac{1}{2}$ ° E. 58 lks.
 White oak 24 in. dia. brs. S. 74° E. 73 lks.
 Land 2nd rate.
 Owing to the steepness of the mountains and their rugged

$$\begin{array}{r} 36 \\ 66 \\ \hline 216 \\ 216 \\ \hline 2376 \end{array}$$

$$\begin{array}{r} 56 \\ 56 \\ \hline 516 \\ 516 \\ \hline 5600 \end{array}$$

character I cannot run this line further.
 South bet. secs. 15 and 16. Va. 14° 13' E.
 40.00 As the hill is so steep that I cannot make a mound
 I make a witness mound as inst. 3 chs. S. from which a
 Pine 18 in. dia. brs. N. 42 W. 12 lks.
 48.00 Leave timber.
 73.00 To a valley bearing E. & W.
 74.50 Cross road to Fort Tejon course N. 45° W.
 80.00 Set a post, charred, chalked and notches for the cor.
 to secs. 15, 16, 21 and 22, and raised mound with
 trench and pits per inst.
 Land 2nd rate and very mountainous. Pine, white and
 Live oak.
 East on a random line bet. secs. 15 and 22. Va. 14° 13' E.
 40.00 Set a post for temp. $\frac{1}{4}$ sec. cor.
 68.50 Cross road to Fort Tejon, course N. 80° W.
 79.50 Int. N. & S. line 47 lks. N. of the cor. to secs. 14, 15,
 22, 23, from which cor. I run
 West on a true line bet. secs. 15 and 22. Va. 13° 53' E.
 39.75 Set a post charred, chalked for the $\frac{1}{4}$ sec. cor. and
 raised a mound with trench and pits as per inst.
 79.50 The cor. to secs. 15, 16, 21 and 22.
 Land level and good 2nd rate.
 South bet. secs. 21 and 22. Va. 14° 13' E.
 40.00 Set a post charred and chalked for the $\frac{1}{4}$ sec. cor.
 and raised a mound with trench and pits as per inst.
 65.00 To hills.
 80.00 Set a post, charred, chalked and notched for the cor.
 to secs. 21, 22, 27 and 28, and raised a mound with
 trench, pits and c. as per inst.
 This cor. is at the base of mountains and I cannot
 survey any more in this Tp.

Aug. 1, 1855
 R. W. MORRIS

Vol. 164.33
 G. B. J.

T. 6 N., R. 18 W., S. B. M.

West on true line bet. secs. 25 and 26. Va. 14° 30' E.
 19.00 To ravine 150 lks. wide, course S.W.
 21.00 To summit of spur, course S.
 25.00 To ravine 1 ch. wide course SE.
 32.00 To summit spur course S.
 40.00 To $\frac{1}{4}$ sec. cor. bet. secs. 25 and 36, set post and
 charred stake in mound with pits as per inst., from
 which a
 White oak tree 8 in. dia. brs. N. dist. 4 $\frac{33}{100}$ chs.
 I can proceed no farther either W. or S. on account
 of the steep and broken nature of the ground.
 1st 19 chs. land rolling, 2nd rate; growth of clover and
 wild oats good grazing. Last 21 chs. land quite broken,
 soil 3rd rate.
 Very little grass and a very scattering growth of
 scrub pine and live oak.
 North through sec. 25. Va. 14° 30' E.
 4.33 To a white oak 8 in. dia. on line.
 5.00 To brow of bluff, sloping S. course N. 60° W. & S. 30° E.
 15.50 To summit of ridge, course N. 33° W.
 40.00 To the center of sec. 25. Set post and charred stake in

mound with pits as per inst., from which a
 White oak tree 5 ft. in dia. brs. S. 52° E. dist. 100 lks.
 Land for the last 5 chs. broken almost barren of grass, 3rd
 rate, a few scattering scrub Pine and live oak trees.
 Land for the last 35 chs. quite rolling, 2nd rate. Growth
 of wild oats and clover.

20.00 West on a true line through sec. 25. Va. 14° 30' E.
 To summit of spur course N.W.
 34.00 To summit of spur course N. W.
 40.00 To $\frac{1}{4}$ sec. cor. bet. secs. 25 and 26, set post and charred
 stake in mound with pits as per inst.
 Land rolling 2nd rate.
 I could not proceed S. from this point on account of the
 steep and broken nature of the mountain range.
 11.50 North on random line bet. secs. 25 and 26. Va. 14° 30' E.
 25.10 To ravine 1 ch. wide course N.E.
 40.07 To ravine 2 chs. wide course N.E.
 To point 14 lks. W. of old mound, cor. to secs. 23, 24, 25
 and 26.
 Post had decayed hence I reestablished the same by setting
 a post and charred stake in old mound with pits as per inst.
 40.07 South on true line bet. secs. 25 and 26. Bearing S. 0° 12' W.
 To $\frac{1}{4}$ sec. cor. bet. secs. 25 and 26.
 Land very rolling, soil 2nd rate.
 10.00 West on true line bet. secs. 23 and 26. Va. 14° 30' E.
 20.00 To summit of spur course E.
 35.00 To ravine course N.E.
 40.00 To top of ridge course N.W.
 To $\frac{1}{4}$ sec. cor. bet. secs. 23 and 26. Set post and charred
 stake in mound with pits as per inst.
 60.00 To small ravine course N.E.
 73.00 To summit of ridge course NE. & SW.
 80.00 To cor. to secs. 22, 23, 26 and 27. Set stake --- charred ---
 in mound with pits as per inst.
 Land very rolling, soil 2nd rate.
 Growth clover and alfileria.

22.00 North on random bet. secs. 22 and 23. Va. 14° 30' E.
 23.00 To small ravine course N.E.
 32.00 To summit of ridge course N.E.
 40.06 To ravine course N.E.
 To point 7 lks. E. of old mound the $\frac{1}{4}$ sec. cor. bet. secs.
 22 and 23. The old stake had decayed so I reestablished the
 cor. by setting a post and charred stake in old mound with
 pits as per inst.

40.06 South on true line, bearing S. 0° 06' E.
 To cor. to secs. 22, 23, 26 and 27.
 Land rolling, soil 2nd rate.
 I can proceed no farther S. on account of steep hills.
 16.00 West on random bet. secs. 22 and 27. Va. 14° 30' E.
 30.00 To ravine course NW.
 40.00 To summit of spur course N.W.
 65.00 Set temp. $\frac{1}{4}$ sec. cor.
 75.00 To ravine course N.W.
 78.00 To base of high hill course N. & S. Enter small flat.
 80.16 To base of round knoll.
 To point 21 lks. N. of old mound, cor. to secs. 21, 22, 27
 and 28. The old post being decayed, I set a post and charred
 stake in old mound with pits as per inst.
 East on true line bearing N. 89° 51' E.

40.08 To $\frac{1}{4}$ sec. cor. Set post and charred stake in mound with pits as per inst.

80.16 To cor. to secs. 21, 22, 27 and 28.
Land very rolling, soil 2nd rate; growth of clover and wild oats. I am unable to run farther S. from cor. to secs. 21, 22, 27, 28 on account of the rough and broken nature of the mountain range.

March 25, 1873.

10.00 West on true line bet. secs. 21 and 28. Va. $14^{\circ} 30'$ E.

26.00 To foot of high hills, enter flat course SW. & NE.

40.00 To the S. point of a spur course N.

54.00 To $\frac{1}{4}$ sec. cor. set post and charred stake in mound with pits as per inst.

56.50 To W. edge of flat course SE. & NW. Commenced ascent of hills.

58.00 To summit of spur course SE.

80.00 To base of spur course SE.

To cor. to secs. 20, 21, 28 and 29. Set post in mound with charred stake and pits as per inst.
Land for 1st 10 chs. rolling, 2nd rate. Last 26 chs. hilly, 2nd rate.

I could proceed no farther S. or W. on account of steep hills.

32.00 North on random bet. secs. 20 and 21. Va. $14^{\circ} 30'$ E.

38.50 To summit of spur course SE.

40.00 To base of spur, enter flat course NE. and SW.

62.50 To $\frac{1}{4}$ sec. cor. Set post and charred stake in mound with pits as per inst.

67.50 To road to Los Alamos course SE. and NW.

80.04 To dry wash 2 chs. wide course SE.

To cor. to secs. 16, 17, 20 and 21, at old mound of Traverse line set post and charred stake in old mound with pits as per inst.
Land for 1st 25 $\frac{1}{2}$ chs. very hilly, soil 3rd rate.
Land for 1st 51 $\frac{1}{2}$ chs. level soil 2nd rate.

40.02 South on true line bearing S.

80.04 To $\frac{1}{4}$ sec. cor.

To cor. to secs. 20, 21, 28 and 29.

2.00 North bet. secs. 16 and 17. Va. $14^{\circ} 30'$ E.

12.00 To base of spur course E. & W. Commence ascent.

22.00 To summit of spur course E. & W. This spur extends about 10 chs. W. and terminates in flat.

36.20 To base of spur course E. & W. Enter dry lake valley.

36.80 To Fort Tejon road course E. & W.

40.00 To S. edge of small lake 1 ch. wide, extending 50 lks. E. of line and 2 chs. W. of line.

To $\frac{1}{4}$ sec. cor. bet. secs. 16 and 17. Set post and charred stake in old mound of meander line with pits as per inst.
From which the E. end of a small lake bears N. 80° W. dist. 6 chs. Lake is 8 chs. long E. & W. and 2 chs. N. & S.

42.00 To base of hills at N. edge of dry lake valley course E. & W. Commence ascent.

80.00 To cor. to secs. 8, 9, 16 and 17, set post and charred stake in mound with pits as per inst.
Land for 1st 22 chs. rolling, soil 3rd rate.
Next 20 chs. across dry lake valley level, soil 1st rate.
Land for last 38 chs. very rolling, soil 2nd rate.
Growth clover and wild oats.

25.50 East on random bet. secs. 9 and 16. Va. $14^{\circ} 30'$ E.

40.00 To ravine 1 ch. wide course S.E.
Set temp. $\frac{1}{4}$ sec. cor.

48.00	To summit of ridge course S. 70° E.
55.20	To pine tree on line 36 in. dia.
80.16	To point 16 lks. S. of old mound.
	West on true line bearing S. 89° 53' W.
40.08	To $\frac{1}{4}$ sec. cor. set post and charred stake in mound with pits as per inst. from which a scrub live oak brs. N. 70° W. dist. 40 lks. and a small spring brs. E. dist. 40 lks.
80.16	To cor. to secs. 8, 9, 16 and 17.
	Land very broken, soil 3rd rate.
	I can proceed no farther N. from this point on account of the steep and broken nature of the mountain range.
	West on true line bet. secs. 17 and 20. Va. 14° 30' E.
7.75	To dry wash 50 lks. wide course SE.
11.80	To Los Alamos road course SE.
24.00	To base of ridge course NW.
26.00	To summit of ridge course NW. and SE.
28.00	To base of spur enter flat.
40.00	To $\frac{1}{4}$ sec. cor. bet. secs. 17 and 20. Set post and charred stake in mound with pits as per inst.
49.50	To base of spur course N. & S.
61.00	To summit of spur course NE.
78.00	To base of spur course N. & S.
80.00	To cor. to secs. 17, 18, 19 and 20. Set post and charred stake in mound with pits as per inst.
	Land for 1st 24 chs. level, soil 2nd rate.
	Land 56 chs. quite rolling, soil 2nd rate.
	Growth of clover and alfileria.
	I can proceed no farther S. or W. from this point on account of a steep broken mountain range.
	March 29, 1873.
	North on random line bet. secs. 17 and 18. Va. 14° 30' E.
2.00	To base of hill, enter small flat, course NW. and SW.
10.00	To base of spur course NE. and SW. Leave flat.
20.00	To summit of spur course NE.
34.00	To base of spur course E. & W. Enter S. edge of dry lake valley
39.50	To S. edge of dry wash course SE.
40.00	To temp. $\frac{1}{4}$ sec. cor. in wash.
44.00	To N. edge of dry wash.
50.50	To Los Alamos road course SE.
57.00	To creek 8 lks. wide course E.
67.20	To S. edge of small lake course E. & W. 2 chs. wide and extending 250 lks. E. 72.00 lks. W. of line.
69.00	To Fort Tejon road at base of high hills on the N. side of dry lake valley, course E. & W.
79.04	To point 21 lks. E. of old mound of meander line, witness cor. 1 ch. S. of true cor.
80.04	To cor. to secs. 7, 8, 17 and 18. Set post and charred stake in old witness mound with pits as per inst.
	South on true line bearing S. 09' E.
40.02	To $\frac{1}{4}$ sec. cor. set post and charred stake in mound with pits as per inst.
80.04	To cor. to secs. 17, 18, 19 and 20.
	Land for 1st 34 chs. hilly, soil 3rd rate; the next 35 chs. level soil 2nd rate. Last 11 chs. hilly, soil 3rd rate, small growth of clover and alfileria.
	East on random bet. 8 and 17. Va. 14° 30' E.
19.00	To base of hill course SW. enter flat which extends N. into hills about 7 chs.
24.00	To base of hills, course SE. on E. edge of flat.
27.30	To point from which 2 adobe houses brs. S. 43° W., the 1st house is dist. about 12 chs., the other is dist. about 15 chs.