

C O P Y

FIELD NOTES OF SURVEY OF
Section 32, Township 8 North, Range 17 West, S.B.M.
California.

Copied from notes of
C. V. Hopkins.

N. B.: The notes, in red, on the following pages are taken from pencil notes, probably entered while in the field, by C.V. Hopkins. These are spaced in the same relative positions as they appear on the original.

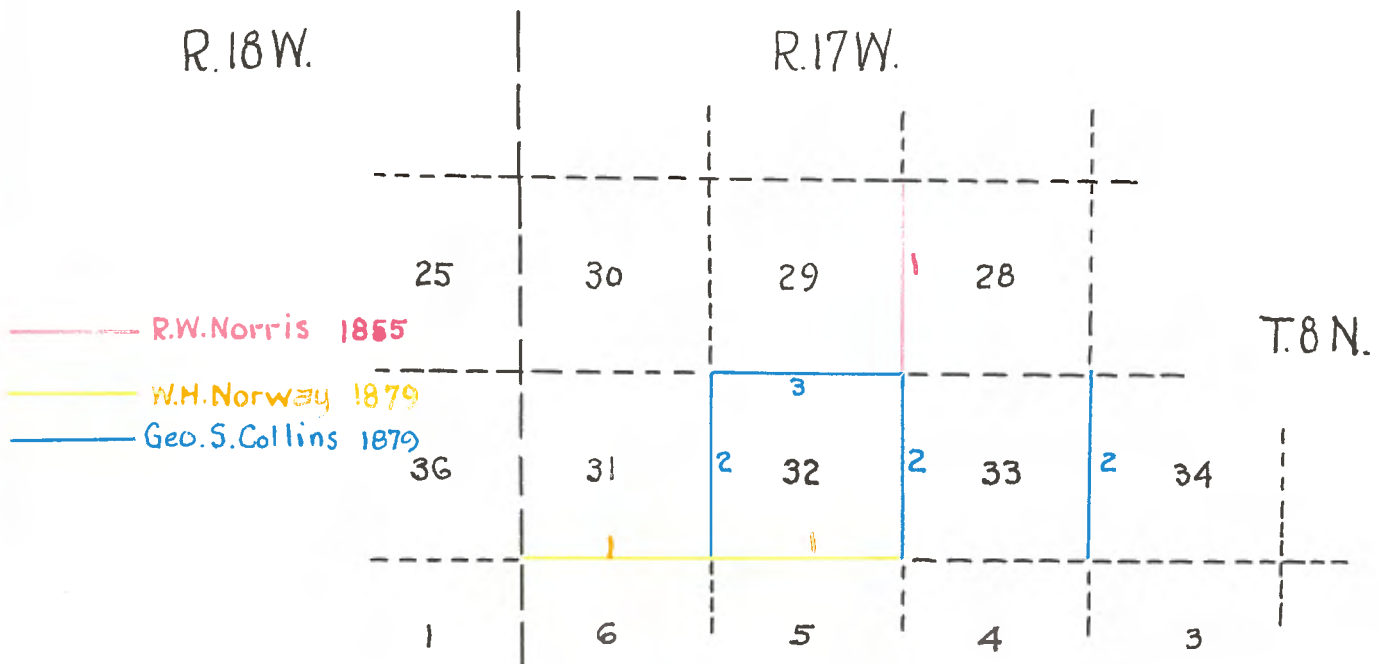

Book 164-19. By R.W.Norris, Deputy Surveyor, Contract of Aug.1,1855.
T. 8 N. R. 17 W. S. B. M.

South between sections 28 & 29 Var. 14°13' E.

80.00

Set a post, charred, chalked and notched for the corner to sections 28, 29, 32 & 33, and raised a mound with trench and pits as per instructions. This mound is on the side of a steep mountain.

Book 164-18 By W. H. Norway, Deputy Surveyor, Contract of Oct.10, 1879.

N. B. T 7 N. R. 17 W. S. B. M.

From the cor. to Tps. 7 & 8 N, Rs. 17 & 18 W. I run E. on a true line on N.B.of sec. 6. Var. 14°25' E.

80.00

Set post 4 in.sq., 1 ft. in earth, 1 ft. above stone mound, 4½ ft. in dia. at base by 2 ft. in height, for cor. to secs. 5, 6, 31, 32, from which bears a

Found This Corner

Live oak 16 ins. dia. N. 21°W 85 lks. dist. = 56.10 ft.

I marked Tree on S.E. side above old blaze 5-6-31-32 T.8N.R.17W. B+T.

Set 12"x14"x24" granite Stone 1ft. in ground with 6 notches on S side and 2 notches on E. Side Mound of rocks on north side

E. on N.B. of sec. 5

Var. 14°25' E.

N.B. This string of corners was run east for 23½ miles from original Tp. R9 Corner (Not Found) Co's monument 10.20 ft. to North of projected position. Tp. Line lays 5696.8 South of north boundary Lines of Sections 31-32-33-34 et. seq. T.8N.-17W.

Ascend.

7.00

Summit of spur bears S.W. & N.E. & descend

37.00

Cross head of gulch, 10 lks. wide, course S.W.

40.00

Set post 4 in. dia. 1 ft. in earth, 1 ft. above stone mound, 4 ft. in dia. at base, by 2 ft. in height, for ¼ sec. cor. and ascend gradually.

*Found This Corner
Didn't set one*

80.00

Set post 4 in. sq. 1 ft. in earth, 1 ft. above stone mound 4½ ft. in dia at base, by 2 ft. in height for cor. to secs. 4, 5, 32, 33.

Land, mountainous.

*blazed
12" Black oak bears S 75° 27' W 133.65 I marked it 18" above old blaze 4-5-32-33 B+T. This corner is a mound of rock 8' dia. x 1½' high at old fence corner, I placed granite stone 5"x12"x20" in center of mound with 2 notches on west side, 4 notches on east side and 6 notches on South side.*

Soil, 1st., 2nd. rate

Timber & undergrowth of oak and chaparral.

April 17th, 1880.

Found rock monument at ¼ and Sec. cor. ½ and mile east with 25 trees for each. Also next ¼ cor. with forked B.T.

Book 164-18.

By Geo. S. Collins, Deputy Surveyor, Contract of Oct. 21, 1879.

T. 8 N. R. 17 W, S. B. M.

North between sections 33, 34

Var. 14°25'25" East

Descend

20.00

Cross gulch 10 links wide, course N. W.

40.00

Set post 4 in. diameter, 1 foot in earth, 1 foot above stone mound, 4 feet in diameter at base by 2 feet in height for $\frac{1}{4}$ section corner. Can't find this corner, so set stone marked 4 on south side at foot of buckeye tree with mound of stones and 2 B+T's one east and one west of cor. 28-28.40 to Sec. cor. N 4 5 course S 2° 13' 41" W.

68.50

Enter valley, bears east and west

80.00

Set post 4 in. square, 1 foot in earth, 1 foot above stone mound, $4\frac{1}{2}$ feet in diameter at base by 2 feet in height for corner to sections 27, 28, 33, 34. 30" Black Oak blazed bears N 17° 43' E 68.71 feet. Found original 4x4" Oak stake. I marked tree above old blaze. 27-28-33-34 T&N.R.17W B+T

Land mountainous. Soil, 1st. and 2nd rate.

Timber and undergrowth of oak, chaparral and bunchgrass

North between sections 32, 33

Var. 14°25' E.

2.50

Descend

40.00

Set post 4 ins. diameter, 1 foot in earth, 1 foot above stone mound 4 feet in diameter at base, by 2 feet in height for $\frac{1}{4}$ section corner, from which bears an Can't find this corner

Oak 10 ins. diameter North $18\frac{3}{4}$ ° West, 29 lks. distant

74.00

Enter canada, bears N. E. and S. W.

80.00

Being unable, after deligent search, to find old corner I set

4 in. square, 1 foot in earth

1 foot above stone mound $4\frac{1}{2}$ feet in diameter at base by 2 feet in height, for corner to sections 28, 29, 32, 33

Land mountainous I found old oak post 4x4" marked for 28, 29, 32, 33 T&N R17W and 2" pipe driven at Sec. Cor. (I built mound of rock 3'dia. 2' high around same. 30" Black Oak with old blaze bears N 17° 43' E 68.71 Ft. I marked it above old blaze B+T. 28-29-32-33.

Soil, 1st. and 2nd. rate

Timber and undergrowth of oak, bunchgrass and chaparral.

North between sections 31, 32

Var. 14°25' East

Ascend

12.00

Top of spur bears East & West, & descend

24.00

Cross gulch, 10 links wide, course W. & ascend

N 2° 13' 41" E 5696.80

T. 8 N., R. 17 W., S. B. M.

- 36.50 Top of spur bears east and west and descend
- 40.00 Set post 4 in diameter, 1 foot in earth, 1 foot above stone mound, 1 feet in diameter at base by 2 feet in height for $\frac{1}{4}$ section corner.
- 49.20 Cross ravine, 5 links wide, course S. W. Ascend Can't find this $\frac{1}{4}$ cor. So set 2" Pipe and back monument with B+T.
- 69.00 Summit of ridge, bears N. W. and S. E. and descend

A house and corral bear east about 4.00 chais distant

- 80.00 Set post, 4 in. square, 1 foot in earth, 1 foot above earth mound. $4\frac{1}{2}$ ft. in diameter at base by 2 feet in height and dug pits 24x18x12 8 links distant at 4 angles for corner to sections 29,30,31,32 from which bears an Found this cor O.K. & B+T's

Oak 14 in. diameter N. 39° E 193 links distant.

Oak 22 in. diameter N $68\frac{1}{2}$ W. 195 links distant.

Land, mountainous,

Soil, 1st. and 2nd. rate.

Timber and undergrowth of oak, bunchgrass and chaparral.

East on a random line between sections 29 and 32

Var. $14^{\circ}25'$ East

Descend

- 11.75 Cross gulch, 6 links wide, course north.
- 34.80 Cross gulch, 5 links, course north west and ascend.
- 40.00 Set temporary $\frac{1}{4}$ section corner
- 50.50 Top of spur, bears north east and south west and descend
- 72.00 Enter canada bears N.E. & S.W.
- 78.80 Cross wash, 10 links wide, course N.E.
- 80.24 Intersect north and south line 18 lks. south of corner to sections 28,39,32,33, from which corner I run South $89^{\circ}52'$ West, on a true line between sections 29,32

Var. $14^{\circ}25'$ East

588'17"E
5239.0 to Sec. Cor.

40.12

Set post 4 in.diameter, 1 foot in earth, 1 foot above earth,
4 feet in diameter at base by 2 feet in height, and dug pit
24x18x12. 8 links north, for $\frac{1}{4}$ sec.corner. Cant. find this $\frac{1}{4}$ cor. Set

80.24

The corner to sections 29,30,31,32.

2" pipe with brass cap marked
 $\frac{1}{4}$ with B.T.

Land, mountainous.

Soil, 1st. and 2nd.rate

Timber and undergrowth of oak, bunchgrass and chaparral

September 15, 1880.