

Copied from Photographic Copies
 Furnished by
 U. S. General Land Office
 Washington, D. C.

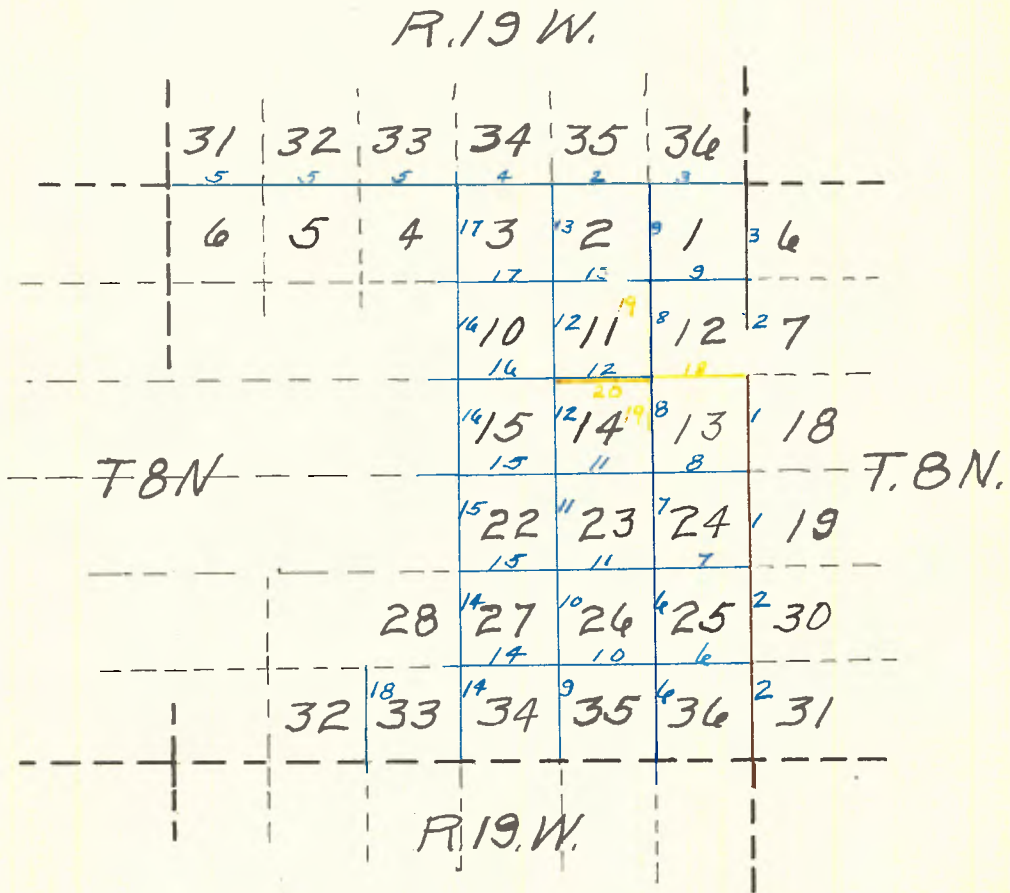

Blue = Survey made 1880
 Yellow = Survey made 1873

54:17

East Boundary T. 8 N., R. 19 W., S.B.M.

As a portion of the E. B. of T. 8 N., R. 19 W. has been previously surveyed I begin at Cor. to Tps. 7 & 8 N., Rs. 18 & 19 W. and run north on a random line along E. B. of Sections 36, 25, 24, 13.

Var. 14°25' E.

I set temporary corners at every 40 and 80 chs. and at 320.00 chs. I arrive at a point 176 lks. east of corner to secs. 12-13-7-18.

From which corner I run

S. 19' E. on a true line on E. B. of Sec. 13.

Var. 14°25' E.

Descend.

3.50 Cross ravine 125 lks. wide, course E. and ascend.

7.25 Top of spur bears E. and W. and descend.

33.00 Ascend.

Being unable after diligent ^{search} to find old corner.

40.00 Set post, 4 in. dia., 1 ft. in earth, 1 ft. above earth mound 4 ft. in dia. at base by 2 ft. in height and dug pit 24x18x12, 8 lks. east from $\frac{1}{4}$ sec. cor.

60.00 Top of spur, bears N. W. and S. \bar{E} . and descend.

80.00 Set post, 4 in. sq. 1 ft. in earth 1 ft. above earth mound, $4\frac{1}{2}$ ft. in dia. at base by 2 ft. in height and dug pits 24x18x12, 8 lks. dist. at 4 angles for corner to Secs. 18, 19, 13, 24.

Land mountainous, soil 2nd rate.
Pine, oak and bunch grass.

S. 19' E. on east boundary of sec. 24.

Var. 14°25' E.

Descend.

40.00 Set post 4 in. dia. 1 ft. in earth, 1 ft. above stone mound, 4 ft. in dia. at base by 2 ft. in height for $\frac{1}{4}$ sec. corner.

80.00 Set post 4 in. sq. 1 ft. in earth 1 ft. above earth mound $4\frac{1}{2}$ ft. in dia. at base by 2 ft. in height and dug pits 24x18x12, 8 lks. dist at 4 angles for cor. to secs. 24, 25, 19 and 30.
Land mountainous. Soil 3rd rate.
Timber & undergrowth of pine, oak and bunchgrass.

East Boundary T 8 N.R. 19 W., S.B.M.

S 19'E on East Bndy. of Section 25.
Descend

Va. 14°25'E

40.00 Set post 4 in.dia. 1 ft. in earth, 1 ft. above earth mound, 4 ft. in dia. at base by 2 ft. in height & dug pits 24x18x12, 8 lks. East for $\frac{1}{4}$ Sec. Cor.

55.50 Enter Canada bears N.W. & S.E.

72.20 Cross Gulch, 10 lks. wide, course S.E.

80.00 Set post 4 ins.sq. 1 ft. in earth 1 ft. above earth mound, 4 $\frac{1}{2}$ ft. in dia. at base by 2 ft. in height & dug pits 24x18x12, 8 lks. dist. at 4 angles for corner to Secs. 25-36-31-30.

Land level in Canada & mountainous elsewhere.

Soil 2nd. & 3rd. rate.

Timber & undergrowth of Pine, Oak and Bunchgrass.

S 19'E. on East Boundary of Section 36.

Va. 14°25'E.

9.50 Leave Canada bears N.W. & S.E. & ascend.

40.00 Set post, 4 in.dia. 1 ft. in earth 1 ft. above stone mound, 4 ft. in dia. at base by 2 ft. in height for $\frac{1}{4}$ Sec. Cor.

from which bears a

Cedar, 10 in.dia. N 10° E. 47 lks. dist.

80.00 The corner to Tps. 7 & 8 N. Rs. 18 & 19 W., S.B.M.

Land mountainous. Soil 2nd & 3rd rate.

Timber and undergrowth of Pine, Oak, Cedar & Chaparral.

From $\frac{1}{4}$ Sec. Cor. on East Boundary of Section 12 which I find standing and agreeing with field notes I run North on true line on E. Bdy. of Sec. 12.

Va. 14°25'E.

Ascend:

34.50 Summit of main divide bears N. 80°W. and S. 80°E. and descend.

East Boundary T 8 N, R.19 W, S.B.M.

40.00 Set post 4 ins.sq. 1 ft. in earth, 1 ft. above earth mound, 4½ ft. in dia. at base by 2 ft. in height and dug pits 24x18x12, 8 lks. dist. at 4 angles for cor. to Secs. 1-6-7-12.

Land mountainous, Soil 2nd & 3rd rate.
Timber & undergrowth of Oak
Pine and Bunchgrass.

North on East Boundary of Section 1. Va. 14°25'E.
Descend

30.00 Cross ravine 10 lks. wide, course N.E. and ascend

40.00 Set post 4 in. dia. 1 ft. in earth mound 1 ft. above earth mound, 4 ft. in dia., at base by 2 ft. in height and dug pit 24x18x12, 8 lks. east for ¼ sec. cor.

80.00 Set post 4 in.sq. 1 ft. in earth, 1 ft. above earth mound, 4½ ft. in dia. at base by 2 ft. in height & dug pits 24x18x12, 8 lks. dist. at 4 angles for corner to Tps. 8 & 9 N, Rs. 18 & 19 W.S.B.M. from which bears

White Oak, 14 in.dia. S 77½° E 273 lks. dist.

Land mountainous.

Soil 2nd & 3rd rate.

Timber and undergrowth of Pine, Oak and Bunchgrass.

September 2, 1880.

North Boundary T 8 N., R.20 W., S.B.M.

As the North Boundary of T 8 N., R. 20 W. is short the line west on N.B. of T. 8 N. R. 19 W. will not intersect it, I therefore make it a true line West.

West on a true line on N. B. of Section 1. Va. 14°25'E.

32.50 Descend

32.50 Top of spur, bears NE & SW & ascend.

36.75 Cross head of Gulch, 10 lks.wide, course North and ascend

40.00 Set post 4 in.dia. 1 ft. in earth 1 ft. above earth mound, 4 ft. in dia. at base by 2 ft. in height and dug pit 24x18x12, 8 lks. N. for ¼ sec. cor.

54.00 Top of Ridge, bears N. & S. & ascend

80.00 Set post 4 in.sq. 1 ft. in earth 1 ft. above earth mound 4½ ft. in dia. at base by 2 ft. in height and dug pits 24x18x12, 8 lks. dist. at 4 angles for cor. to Secs. 1-2-35 and 36.

Land mountainous.

Soil, 2nd & 3rd rate.

Timber and undergrowth of Oak, Pine and Bunchgrass.

West on North Boundary of Sec. 2

Va. 14°25'E.

Descend

8.00 Enter Canada bears N. & S.

9.25 Cross Gulch, 10 lks. wide, course North

14.50 Leave Canada and ascend.

North Boundary T 8 N., R. 19 W., S.B.M.

34.00 Top of spur, bears N.E. & S.W. & ascend
40.00 Set post 4 in.dia. 1 ft.in earth 1 ft. above earth mound, 4 ft.
in dia. at base by 2 ft. in height and dug pits 24x18x12, 8 lks.
North for $\frac{1}{4}$ sec. cor.
70.00 Enter Canada, bears N. & S.
71.00 Cross Ravine 20 lks. wide, course N
73.50 Leave Canada bears N. & S. and ascend
80.00 Set post 4 in.sq. 1 ft. in earth 1 ft. above earth mound, 4 $\frac{1}{2}$ ft.
in dia. at base by 2 ft. in height and dug pits 24x18x12, 8 lks.
dist. at 4 angles for corner to Sections 2-3-34-35.
from which bears a
White Oak 24 in. dia. S. 76° W. 64 lks. dist.
" " 10 " " S. 61° E. 41 " "
Land mountainous except in Canada.
Soil 2nd & 3rd rate.
Timber & undergrowth of Pine, Oak and Bunchgrass.

West on North Boundary of Sec. 3.

Va. 14°25'E.

Descend

36.50 Enter Valley, bears N.E. & S.W.
39.50 Cross Road, bears N.E. & S.W.
40.00 Set post, 4 in. dia. 1 ft. in earth, 1 ft. above earth mound 4 ft.
in dia. at base by 2 ft. in height, and dug pits 24x18x12, 8 lks.
North for $\frac{1}{4}$ sec.cor.

From which one of the cluster of Bickeys Bushes 7 in.dia. bears S.W.
22 lks. dist.

49.50 Cross Wash, 50 lks. wide, course N.E.
53.50 " Road to Tejon bears N.E. & S.W.
61.75 " " " " " " "
65.50 " Wash, 50 lks. wide, course N.E.
80.00 Set post 4 in.sq. 1 ft.in earth 1 ft. above stone mound, 4 $\frac{1}{2}$ ft. in
dia. at base by 2 ft. in height for cor. to Secs. 3-4-33-34.
from which bears an

Oak 7 in.dia. N. 89°E. 77 lks. dist.

Land in Valley

Soil, 1st & 2nd rate.

Timber and undergrowth of Pine, Oak and Bunchgrass.

North Boundary T 8 N., R.19 W. S.B.M.

West on North Boundary of Sec. 4. Va. 14°25'E.

8.50 Cross wash, 50 lks. wide, course S.E.
27.00 " Road bears N.W. & S.E.
37.70 A white oak 60 in.dia.
40.00 Set post 4 in.dia. 1 ft. in earth 1 ft. above stone mound,
4 ft. in dia. at base by 2 ft.in height for $\frac{1}{4}$ sec. cor.
from which bears a

80.00 White Oak 36 in. dia N 43 $\frac{1}{2}$ ° W. 20 lks. dist.
Set post 4 in.sq. 1 ft.in earth 1 ft.above stone mound 4 $\frac{1}{2}$ ft.
in dia. at base by 2 ft. in height for cor. to Sections 4-5-32-33.

Land level. Soil 2nd & 3rd rate.
Timber & undergrowth of Oak and Bunchgrass.

West on North Bndy. of Section 5. Va. 14°25'E.
Through valley.

30.50 Leave same, bears N.W. & S.E. & Ascend
40.00 Set post 4 in.dia. 1 ft. in earth 1 ft. above earth mound 4 ft.
in dia. at base by 2 ft. in height and dug pit 24x18x12, 8 lks.
North for $\frac{1}{4}$ Sec.Cor. and descend.
59.00 Cross Gulch, 10 lks. wide, course N.E.
and ascend
80.00 Set post, 4 in.sq. 1 ft. in earth 1 ft.above earth mound 4 $\frac{1}{2}$ ft.
in dia. at base by 2 ft. in height and dug pits 24x18x12, 8 lks.
dist. at 4 angles for Cor. to Sections 5-6-31-32

Land mountainous except in valley
Soil 1st & 2nd rate.
Timber & undergrowth of Oak and Bunchgrass.

West on North Boundary of Sec. 6. Va. 14°25'E.

Ascend
5.00 Top of knoll and descend
35.90 Cross S. Young's fence bears E. & W.
And enter field and valley
38.65 To N.E.corner of S.Young's house
40.00 Set post, 4 in.dia. 1 ft. in earth, 1 ft.above stone mound, 4 ft.
in dia. at base by 2 ft. in height for $\frac{1}{4}$ sec.cor.
from which bears a
White Oak, 18 in.dia. S.37°E 57 lks.dist.
And enter Cienega or swamp

55.00 Leave Cienega bears N. and S.

North Boundary T. 8 N. R.19 W., S.B.M.

59.27 Cross Young's fence bears N. & S.
75.75 To the $\frac{1}{4}$ Sec. Cor. on E.B. Sec. 36.
40 Chs. North of corner to Tps. 8 & 9 N. R.20 W. and set
post 4 in. sq. 1 ft. in earth 1 ft. above stone mound $4\frac{1}{2}$ ft.
in dia. at base by 2 ft. in height for corner to Tps. 8 & 9
N. R. 19 W.
from which bears a
Live Oak, 14 in. dia. N. 29° E 135 lks. dist.
Pine 10 in. dia. N $52\frac{1}{2}^{\circ}$ W. 139 lks. dist.
Land mostly in valley
Soil 1st and 2nd rate
Timber and undergrowth of
Pine, Oak and Bunchgrass

September 3, 1880

T. 8 N., R. 19 W., S.B.M.

From the corner to Secs. 35 and 36, 1 and 2 on the South Boundary
I run
North between Sections 35 and 36 Va $14^{\circ}25'$ E.
40.00 Set post, 4 in dia. 1 ft. in earth 1 foot above stone mound, 4 ft.
in dia. at base by 2 ft. in height for $\frac{1}{4}$ Sec. Cor.
80.00 Set post 4 in. sq. 1 ft. in earth 1 ft. above stone mound, $4\frac{1}{2}$ ft.
in dia. at base by 2 ft. in height for cor. to Secs. 25-26-35 & 36.
Land rolling. Soil 2nd rate.
Timber and undergrowth of Oak and Chaparral.
East on random bet. Secs. 25 & 36. Va $14^{\circ}25'$ E.
Descend
40.00 Set temporary $\frac{1}{4}$ Sec. Cor.
66.70 A Canada bears N.W. & S.E.
79.70 Intersect E.B. of Tp. 20 lks. North of Cor. to Sections 25 and 36
from which corner I run
N $89^{\circ}51'$ W. on a true line bet. Secs. 25-36. Va. East
39.85 Set post, 4 in. dia 1 ft. in earth 1 ft. above earth mound, 4 ft. in
dia. at base by 2 ft. in height and dug pits 24x18x12, 8 lks. North
for $\frac{1}{4}$ Sec. Cor.
79.70 The Cor. to Secs. 25-26-35 & 36.
Land rolling. Soil 2nd rate.
Timber and undergrowth of Oak, Cedar and Chaparral.

North between Sections 25 and 26.
Ascend.

Va $14^{\circ}25'$ E.

T. 8 N. R. 19 W., S.B.M.

- 40.00 Set stone 20x12x6 in stone mound 4 ft. in dia at base by 2 ft. in height for $\frac{1}{4}$ Sec. Cor.
- 80.00 Set post 4 in. sq. 1 ft. in earth 1 ft. above stone mound, $4\frac{1}{2}$ ft. in dia at base by 2 ft. in height for corner to Sections 23-24-25 & 26. Land rolling. Soil 1st & 2nd rate. Timber & undergrowth of Oak and Chaparral.

East on random line bet. Secs. 24 & 25. Va 14°25'E.
Descend

- 6.00 Enter Canada, bears N.W. & S.E.
10.40 Cross Gulch 20 lks. wide, Course S.E.
23.50 Leave Canada and ascend
40.00 Set temporary $\frac{1}{4}$ Sec. Cor.
79.44 Intersect East Boundary of Tp. 10 lks. South of Cor. to Secs. 24 and 25, from which corner I run S 89°56' W. on a true line bet. Secs. 24 and 25. Va East

- 39.72 Set post 4 in. dia 1 ft. in earth 1 ft. above stone mound, 4 ft. in dia. at base by 2 ft. in height for $\frac{1}{4}$ Sec. Cor. from which bears an Oak 10 in. dia. S 3°W 36 lks. dist.

- 79.44 The corner to Secs. 23-24-25 & 26. Land rolling, soil 2nd & 3rd rate. Timber and undergrowth of Oak and Chaparral.

North between Sections 23 and 24. Va 14°25'E.
Descend.

- 7.50 Enter Canada bears N.W. & S.E.
13.00 Cross Gulch, 10 lks. wide, course S.E.
21.00 Leave Canada and ascend
40.00 Set post, 4 in. dia. 1 ft. in earth 1 ft. above stone mound 4 ft. in dia. at base by 2 ft. in height for $\frac{1}{4}$ Sec. Cor.
- 75.00 Descend abruptly.
- 80.00 The point for cor. to Sections 13, 14, 23 & 24 falling on steep side hill a place not suitable to build mound I continue North 1.57 chs. and mark a White Oak, 10 in. dia. for witness to said corner.

Land mountainous.
Soil 2nd rate.
Timber and undergrowth of Oak and Chaparral.

Sept. 17, 1880.

T 8 N., R.19 W., S.B.M.

East on a random line bet. Secs. 13 and 24. Va. 14°25'E.
Ascend abruptly.

- 12.50 Summit of spur bears N.E. & S.W. descend.
31.30 Cross Gulch, 10 lks. wide, course South and Ascend
40.00 Set temporary $\frac{1}{4}$ Sec. Cor.
79.10 Intersect East Bndy. of Tp. 18 lks. North of Cor. to Secs. 13 and 24.
from which corner I run
N 89°52' W. on a true line bet. Secs. 13 & 24. Va. East
- 39.55 Set post, 4 in. dia. 1 ft. in earth, 1 ft. above stone mound, 4 ft.
in dia. at base by 2 ft. in height for $\frac{1}{4}$ Sec. Cor.
from which bears an
Oak, 10 in. dia. N. 12 $\frac{1}{2}$ ° W. 38 lks. dist.
- 79.10 The corner to Secs. 13-14-23 & 24.
Land mountainous. Soil 2nd rate.
Timber and undergrowth of Oak and Chaparral.
-

North on random bet. Secs. 13 and 14. Va. 14°25'E.
Descend.

- 1.57 Witness Tree
7.50 Cross near head of Gulch 5 lks. wide, course S.W. and ascend
35.00 Summit of ridge bears N.W. & S.E. and descend
40.00 Being unable after diligent search to find old corner I set
temporary $\frac{1}{4}$ Section Corner.
- 80.00 To a point 70 lks. East of old Cor. to Sections 11-12-13 & 14.
from which corner I run
S. 30°E. on a true line bet. Secs. 13 & 14. Va. 14°25'E.
- 40.00 Set post 4 in. dia. 1 ft. in earth, 1 ft. above earth mound, 4 ft.
in dia. at base by 2 ft. in height and dug pits 24x18x12, 8 lks.
East for $\frac{1}{4}$ Sec. Cor.
- 80.00 The corner to Sections 13-14-23-24.
Land mountainous.
Soil 1st & 2nd rate.
Timber and undergrowth of Oak and Chaparral.
-

North between Sections 11 and 12. Va. 14°25'E.
Descend

- 24.30 Cross fence & enter field bears E. & W.
40.00 Being unable after diligent search to find old corner. I set post
4 in. dia. 1 ft. in earth 1 ft. above earth mound 4 ft. in dia. at
base by 2 ft. in height and dug pit 24x18x12, 8 lks. East for $\frac{1}{4}$
Sec. Cor.
- 43.34 Cross Fence, bears E. and W. & leave field
44.00 Cross Road to Tejon bears E. and W.

T. 8 N., R.19 W., S.B.M.

46.50 Ascend
71.50 Top of hill bears N.W. & S.E. and descend

80.00 After diligent search being unable to find old corner I set post
4 in. sq. 1 ft. in earth, 1 ft. above earth mound $4\frac{1}{2}$ ft. in dia.
at base by 2 ft. in height and dug pits $24 \times 18 \times 12$, 8 lks. dist. at
4 angles for Cor. to Secs. 1-2-11-12

Land mostly level. Soil 1st rate.
Timber and undergrowth of Oak and Chaparral.

East on random bet. Secs. 1 and 12. Va. $14^{\circ}25'E$.
Ascend
35.00 Summit of ridge, bears N.W. and E. and along same.
40.00 Set temporary $\frac{1}{4}$ Sec. Cor.
73.00 Descend.
79.70 Intersect East Boundary of Tp. 31 lks. North of Cor. to Sections
1 and 12.
from which corner I run
N $89^{\circ}47'$ W. on a true line bet. Secs. 1 & 12. Va. E.

39.85 Set post 4 in. dia. 1 ft. in earth 1 ft. above earth mound, 4 ft. in
dia. at base by 2 ft. in height and dug pits $24 \times 18 \times 12$, 8 lks. North
for $\frac{1}{4}$ Sec. Corner.
79.70 The Cor. to Secs. 1-2-11-12.

Land mountainous. Soil 1st & 2nd rate.
Timber and undergrowth of Oak and Chaparral.

North on random line bet. Secs. 1 and 2. Va. $14^{\circ}25'E$.
Ascend.
12.00 Summit of Ridge bears S.E. and W. and along same
13.50 Descend
40.00 Set temporary $\frac{1}{4}$ Sec. Cor.
57.00 Enter Canada and cross Wash 10 lks. wide, course N.E.
66.50 Cross Wash course N.W. & leave Canada.
79.75 Intersect N. Bndy. of Tp. 21 lks. East of corner to Sections 1 and 2.
I run on true line S $9'$ E. bet. 1 & 2. Va. E.

39.75 Set post 4 in. dia. 1 ft. in earth 1 ft. above earth mound, 4 ft. in
dia. at base by 2 ft. in height and dug pits $24 \times 18 \times 12$, 8 lks. East
for $\frac{1}{4}$ Sec. Cor.

79.75 The corner to Sections 1-2-11-12.
Land mountainous, except in Canada. Soil 1st and 2nd rate.
Timber and undergrowth of Oak and Chaparral. Sept. 18, 1880.

North between Sections 34 and 35. Va. $14^{\circ}25'E$.
Through Valley.

T. 8 N., R.19 W., S.B.M.

- 3.50 Cross Road, bears N.W. & S.E.
15.65 Cross Creek, 10 lks. wide, course S.E.
39.15 Cross Road, bears N.W. & S.E.
40.00 Set Post, 4 in. dia. 1 ft. in earth 1 ft. above earth mound 4 ft. in dia. at base by 2 ft. in height and dug pit 24x18x12, 8 lks. East for $\frac{1}{4}$ Sec. Cor.
62.00 Cross wash, 30 lks. wide, course S.E.
80.00 Set post, 4 in.sq. 1 ft. in earth, 1 ft. above stone mound, 4 $\frac{1}{2}$ ft. in dia. at base by 2 ft. in height for corner to Sections 26-27-34 & 35.
Land level. Soil 1st rate.
Timber and undergrowth of Oak, Cedar and Chaparral.
-

East on random between Secs. 26 & 35. Va. 14°25' East.

- 1.80 Cross Road, bears N.W. & S.E.
6.50 Cross Wash 100 lks. wide, course S.E.
14.50 Leave valley bears N.E. & S.E. & ascend.
40.00 Set temporary $\frac{1}{4}$ Sec. Cor.
59.00 Top of spur, bears N. & S. & descend
79.78 Intersect N. & S. line 26 lks. South of Corner to Sections 25-26-35 & 36 from which corner I run S. 89°49' W. on a true line bet. Secs. 26-35. Va. 14°25' East
39.89 Set post 4 in.dia. 1 ft. in earth 1 ft. above stone mound, 4 ft. in dia. at base by 2 ft. in height for $\frac{1}{4}$ Sec. Cor.
79.78 The corner to Sections 26, 27-34 & 35.
Land mountainous. Soil 1st & 2nd rate.
Timber and undergrowth of Oak and Chaparral.
-

North between Sections 26 & 27. Va. 14°25' E.
Through Valley.

- 1.50 Cross Road, bears N.W. & S.E.
4.50 A corral bears west about 5.00 chs.
5.00 Cross Wash, 25 lks. wide, course S.E.
11.00 Enter Wash, course S.E.
15.50 Leave same course N.W.
40.00 Set post 4 in. dia. 1 ft. in earth 1 ft. above stone mound, 4 ft. in dia. at base by 2 ft. in height for $\frac{1}{4}$ Sec. Cor.
66.50 Leave Valley bears E. & W. & ascend.
80.00 Set post, 4 in.sq. 1 ft. in earth 1 ft. above stone mound, 4 $\frac{1}{2}$ ft. in dia. at base by 2 ft. in height for corner to Sections 22-23-26-27.
Land mostly level. Soil 1st rate.
Timber and undergrowth of Oak and Chaparral.

Tp. 8 N., R.19 W., S.B.M.

East on random line bet. Secs. 23 & 26. Va.14°25'E.
Ascend.

35.00 Top of spur, bears N. & S. & descend
40.00 Set temporary $\frac{1}{4}$ Sec. Cor.

79.82 Intersect N. & S. line 21 lks. South of Cor. to Secs. 23-24-25-26
from which Cor. I run
S 89°51'W. on true line bet. Secs. 23 & 26.

39.91 Set post 4 in. dia. 1 ft. in earth, 1 ft. above stone mound, 4 ft.
in dia. at base by 2 ft. in height for $\frac{1}{4}$ Sec. Cor. Va.14°25'E.

79.82 The corner to Sections 22-23-26-27.
Land mountainous
Soil 2nd & 3rd rate.
Timber and undergrowth of Oak and Chaparral.

North between Sections 22 & 23. Va.14°25'E.
Descend.

9.00 Enter Valley, bears E. and W.
40.00 Set post 4 in. dia. 1 ft. in earth 1 ft. above earth mound, 4 ft. in
dia. at base by 2 ft. in height and dug pit 24x18x12, 8 lks. East
for $\frac{1}{4}$ Sec. Cor.

55.00 Leave Valley, bears N.E. and W. & ascend
71.25 Top of spur, bears N.E. and S.W. and Ascend.

80.00 Set post 4 in. sq. 1 ft. in earth, 1 ft. above stone mound, 4 $\frac{1}{2}$ ft.
in dia. at base by 2 ft. in height for corner to Sections 14-15-22 & 23.
Land level in Valley and mountainous elsewhere.
Soil 1st & 2nd rate.
Timber and undergrowth of Oak and Chaparral.

East on random bet. Secs. 14 & 23. Va.14°25'E.
Ascend

32.50 Top of spur, bears NW. & SE. & descend.
40.00 Set temporary $\frac{1}{4}$ Sec. Cor.

52.10 Cross gulch, near its head 5 lks. wide, course S.E.
71.00 Cross gulch, near its head 5 lks. wide, course South
74.80 Cross gulch, 10 lks. wide, course S.W. and ascend

80.10 Intersect N. & S. line 14 lks. South of Cor. to Secs. 13-14-23-24.
from which corner I run

S 89°54'W on a true line bet. Secs. 14-23.

Va. 14°25'E.

Tp. 8 N., R. 19 W., S.B.M.

- 40.05 Set post, 4 in. dia. 1 ft. in earth 1 ft. above stone mound, 4 ft. in dia. at base by 2 ft. in height for $\frac{1}{4}$ Sec. Cor. from which bears a White Oak 12 in. dia. N. $13\frac{1}{2}^{\circ}$ E 40 lks. dist.
- 80.10 The course to Secs. 14-15-22-23

Land mountainous. Soil 1st & 2nd rate.
Timber and undergrowth of Oak and Chaparral.

Sept. 20, 1880.

North between Sections 14 and 15.

Va. $14^{\circ}25'E$.

Descend

- 3.50 Enter Valley bears N.E. & S.W.
- 21.50 Leave same and ascend

- 40.00 Set post, 4 in. dia. 1 ft. in earth 1 ft. above stone mound, 4 ft. in dia. at base by 2 ft. in height for $\frac{1}{4}$ Sec. Cor. on summit of spur bears N. E. & West and descend.

- 80.00 Set post 4 in. sq. 1 ft. in earth 1 ft. above earth mound, $4\frac{1}{2}$ ft. in dia. at base by 2 ft. in height and dug pits $24 \times 18 \times 12$, 8 lks. distant at 4 angles for corners to Sections 10-11-14-15.

Land mountainous.
Soil 1st & 2nd rate.
Timber and undergrowth of Oak and Chaparral.

East on a random bet. Secs. 11 & 14.
Descend

Va. $14^{\circ}25'E$.

- 2.75 Cross Gulch, 10 lks. wide, course N.W. and ascend
- 40.00 To $\frac{1}{4}$ Sec. Cor. which I find standing and agreeing with field notes, from which the Cor. to Secs. 11-12-13-14 bears N. $89^{\circ}30'E$. 39.43 chs. dist. which would make the line between Sections 11 and 14, 79.43 chs. long
Land mostly level.
Soil 1st and 2nd rate.
Timber and undergrowth of Oak and Chaparral.

North between Sections 10 and 11.

Va. $14^{\circ}25'E$.

Descend

- 11.50 Cross Gulch, 10 lks. wide, course N.W.
- 18.75 Cross Road bears N.E. and S.W.
- 24.50 Cross Gulch, 10 lks. wide, course N.E. and ascend.

- 40.00 Set post, 4 in. dia. 1 ft. in earth, 1 ft. above earth mound, 4 ft. in dia. at base by 2 ft. in height and dug pit $24 \times 18 \times 12$, 8 lks. East for $\frac{1}{4}$ Sec. Cor.

- 42.00 Enter Leonis Bailey Field bears E. and W.
- 46.50 Leave same and descend
- 46.75 Cross Gulch, 30 lks. wide, course East

T. 8 N. R.19 W., S.B.M.

- 48.10 Cross Road course N.E. & S.W.
Jesus Leon's House bears W. about 30 chs.
- 66.00 Cross Road from Los Angeles to Tejon
bears E. and W. and ascend.
- 80.00 Set post, 4 in. sq. 1 ft. in earth, 1 ft. above stone mound, $4\frac{1}{2}$ ft.
in dia. at base by 2 ft. in height for corner to Sections 2-3-10-11
on summit of Sierra Nevada Mountains, bears N.E. and S.W.
from which bears a

White Oak, 30 ins. dia. N 10°E 24 lks. dist.
" " 36 " " N 41°W 108 " "

Land rolling.
Soil 1st & 2nd rate.
Timber and undergrowth of Oak & Chaparral.

East on a random between Secs. 2 and 11. Va. 14°25'E.
Descend

- 40.00 Set temporary $\frac{1}{4}$ Sec. Cor.
79.54 Intersect N. & S. line 48 links south of corner to Sections 1-2-11-12.
from which corner I run
S 89°39' W. on a true bet. Secs. 2 & 11. Va. 14°25'E.
- 39.77 Set post 4 in. dia. 1 ft. in earth 1 ft. above stone mound, 4 ft. in
dia. at base by 2 ft. in height for $\frac{1}{4}$ Sec. Cor.
- 79.54 The Corner to Secs. 2-3-10-11
Land mountainous
Soil 1st & 2nd rates.
Timber and undergrowth of Oak and Chaparral.

North on a random bet. Secs. 2 & 3. Va. 14°25'E.

- 1.50 Descend west slope of mountain,
cross sag and descend.
- 31.00 Top of spur, bears N.W. & S.E. descend
- 40.00 Set temp. $\frac{1}{4}$ Sec. Cor.
- 80.24 Intersect N. Bndy. of Tp. 38 lks. E. of Cor. to Secs. 2 and 3.
from which Cor. I run.
S. 16' E. on true line bet. Secs. 2 and 3. Va. East
- 40.24 Set Post, 4 in. dia. 1 ft. in earth, 1 ft. above earth mound, 4 ft.
in dia. at base by 2 ft. in height and dug pit 24x18x12, 8 lks. E.
for $\frac{1}{4}$ Sec. Cor.
- 80.24 The corner to sections 2-3-10-11
Land mountainous.
Soil 1st & 2nd rate.
Timber and undergrowth of Oak and Chaparral.

Tp. 8 N., R. 19 W., S.B.M.

North between Sections 33 & 34. Va. 14°25'E.
Through valley.
5.00 Cross Gulch, 10 lks. wide, course N.E.
40.00 Set post 4 in. dia. 1 ft. in earth 1 ft. above earth mound 4 ft.
in dia. at base by 2 ft. in height and dug pit 24x18x12, 8 lks.
E. for $\frac{1}{4}$ Sec. Cor.
45.70 Cross Wash, 75 lks. wide, course East.
50.50 Leave valley bears E. & W. and ascend.
68.50 Summit of ridge, bears N.W. & S.E. and ascend (descend ?)
80.00 Set post, 4 in. sq. 1 ft. in earth 1 ft. above stone mound 4 $\frac{1}{2}$ ft.
in dia. at base by 2 ft. in height for corner to Sections 27-28-33 & 34.
Land mostly level.
Soil 1st & 2nd rate.
Timber and undergrowth of Oak and Chaparral. September 21, 1880

East on a random bet. Secs. 27 & 34. Va. 14°25'E.
Descend.
18.50 Enter valley bears N.W. & S.E.
21.50 Cross Wash 10 lks. wide, course S.E.
40.00 Set temporary $\frac{1}{4}$ Sec. Cor.
47.35 Cross Wash, bears N. W. and S. E.
54.00 Cross Wash, 50 lks. wide, course S.E.
65.00 Leave valley and ascend
73.00 Top of hill, and descend into valley, bears N. and S.W.
75.00 Cross Road, bears N. & S.W.
80.10 Intersect N. & S. line at corner to Secs. 26-27-34 & 35.
from which corner I run
West, on a true line bet. Secs. 27 & 34. Va. 14°25'E.
40.05 Set post 4 in. dia. 1 ft. in earth, 1 ft. above earth mound, 4 ft. in
dia. at base by 2 ft. in height and dug pits 24x18x12, 8 lks. North for
 $\frac{1}{4}$ Sec. Cor.
80.10 The corner to Secs. 27-28-33 & 34.
Land mostly valley
Soil 1st and 2nd rate
Timber and undergrowth of Oak and Chaparral.

North between Sections 27 & 28. Va. 14°25'E.
Descend
22.50 Enter valley, bears N.W. & S.E.
27.20 Cross Wash, 10 lks. wide, course S.E.
40.00 Set post, 4 in. dia. 1 ft. in earth 1 ft. above stone mound, 4 ft.
in dia. at base by 2 ft. in height for $\frac{1}{4}$ Sec. Corner
42.75 Cross Road bears N.W. & S.E.
57.50 Leave valley bears N.W. and S.E. and ascend

Tp. 8 N., R.19 W., S.B.M.

80.00 Set post, 4 in. sq. 1 ft. in earth, 1 ft. above earth mound, 4½ ft. in dia. at base by 2 ft. in height and dug pits 24x18x12, 8 lks. dist. at 4 angles for Cor. to Sections 21-22-27-28.

Land partly mountainous, partly level.
Soil, 1st and 2nd rate.
Timber and undergrowth of Oak and Chaparral.

East on a random bet. Secs. 22 & 27. Va. 14°25'E.
Ascend.

17.75 Cross Wash, 10 lks. wide, course S.E.
38.50 Summit of ridge, bears N.W. & S.E. and descend
40.00 Set temporary ¼ Sec. Cor.
60.00 Enter valley bears N.W. & S.W.
66.80 Cross Road bears N. and S.
72.50 Cross Wash, 50 lks. wide, course South

80.24 Intersect N. & S. line 23 lks. North of Cor. to Sections 22-23-26 & 27. from which corner I run
N. 89°50' W. on a true line bet. Secs. 22-27. Variations 14°25'E.

40.12 Set post 4 in. dia. 1 ft. in earth 1 ft. above stone mound, 4 ft. in dia. at base by 2 ft. in height for ¼ Sec. Cor.
80.24 The corner to Sections 21-22-27-28.

Land mountainous, except in valley.
Soil, 1st & 2nd rate.
Timber and undergrowth of oak and chaparral.

North between Sections 21 & 22. Va. 14°25'E.
Descend

21.80 Cross Gulch, 10 lks. wide, course S.E. and ascend
40.00 Set post, 4 in. dia. 1 ft. in earth, 1 ft. above stone mound 4 ft. in dia. at base, by 2 ft. in height for ¼ Sec. Cor.

54.00 Summit of Spur, bears N.W. & S.E. and descend

80.00 Set post 4 in. sq. 1 ft. in earth 1 ft. above earth mound, 4½ ft. in dia. at base by 2 ft. in height and dug pits 24x18x12, 8 lks. distant at 4 angles for corner to Sections 15-16-21-22.

Land mountainous.
Soil 1st & 2nd rate.
Oak and Chaparral.

East on a random bet. Secs. 15 and 22. Va. 14°25'E.
Descend.

40.00 Enter valley bears N. and S. 10°E. and
Set temporary ¼ Sec. Cor.
52.00 Cross Road bears N. & S.
78.50 Leave valley and ascend

Tp. 8 N., R.19 W. S.B.M.

80.30 Intersect N. & S. line 14 lks. North of corner to Secs. 14-15-22-23.
from which corner I run

40.15 N. 89°54' W. on true line bet. Secs. 15-22. Va. 14°25'E.
Set post 4 in. dia. 1 ft. in earth 1 ft. above earth mound, 4 ft.
in dia. at base by 2 ft. in height and dug pit 24x18x12, 8 lks. N.
for $\frac{1}{4}$ Sec. Cor.

80.30 The corner to Sections 15-16-21-22.
Land mountainous except in valley.
Soil 1st & 2nd rate.
Timber and undergrowth of Oak and Chaparral.

North between Sections 15 and 16. Va. 14°25'E.
Descend.

31.50 Cross Wash, 10 lks. wide, course S.E. and ascend
40.00 Set post, 4 in. dia. 1 ft. in earth 1 ft. above earth mound, 4 ft.
in dia. at base by 2 ft. in height and dug pit 24x18x12, 8 lks. East
for $\frac{1}{4}$ Sec. Corner.

57.50 A spring bears East about 7.00 chs.
67.00 Summit of Spur bears N.W. & S.E. and descend.
80.00 Set post 4 in. sq. 1 ft. in earth 1 ft. above earth mound 4 $\frac{1}{2}$ ft.
in dia. at base by 2 ft. in height and dug pits 24x18x12, 8 lks.
dist. at 4 angles for Corner to Secs. 9-10-15-16.
Land mountainous. Soil 2nd rate.
Timber and undergrowth of Oak and Chaparral. Sept. 22, 1880.

East on random bet. Secs. 10 & 15. Va. 14°25'E.
Descend.

40.00 Set temporary $\frac{1}{4}$ Sec. Cor.
67.50 Cross Road, bears N.E. & S.W.
79.90 Intersect N. & S. line, 14 lks. North of corner to Sections 10-11-14-15
from which corner I run
N 89°54' W. on a true line bet. Secs. 10 & 15. Va. 14°25' East

39.95 Set post 4 in. dia. 1 ft. in earth 1 ft. above earth mound, 4 ft. in
dia. at base by 2 ft. in height and dug pits 24x18x12, 8 lks. North
for $\frac{1}{4}$ Sec. Cor.

79.90 The Corner to Sections 9-10-15-16.
Land mountainous. Soil 2nd rate.
Timber and undergrowth of Oak and Chaparral.

North between Sections 9 and 10. Va. 14°25'E.
Descend.

30.00 Ascend.
40.00 Set post, 4 in. dia. 1 ft. in earth, 1 ft. above earth mound, 4 ft.
in dia. at base by 2 ft. in height and dug pit 24x18x12, 8 lks.
East for $\frac{1}{4}$ Sec. Cor.

Tp. 8 N., R. 19 W., S.B.M.

47.50 Summit of Ridge the main divide between waters of Peru Creek and Castaic Lake and descend

54.00 A valley bears N.E. & S.W.

77.50 Barley Field bears E. and W.

80.00 Set post 4 in. sq. 1 ft. in earth 1 ft. above earth mound $4\frac{1}{2}$ ft. in dia. at base by 2 ft. in height and dug pits 24x18x12, 8 lks. dist. at 4 angles for corners to Secs. 3-4-9-10.

Land mountainous. Soil 2nd rate.
Timber and undergrowth of Oak and Chaparral.

East on a random bet. Secs. 3 & 10.
Through Barley Field

Va. 14°25'E

26.50 Leave same, bears N.E. & S.W. and ascend.

40.00 Set temporary $\frac{1}{4}$ Sec. Cor.

51.25 To dry Lake about 3.00 chs. wide, bears N. & S.

52.50 Cross same bears N. & S.

53.35 Cross Road to Tejon bears N.W. & S.E.

80.00 Intersect N. & S. line at the corner to Sections 3-4-9-10.

from which corner I run

West on a true line bet. Secs. 3 & 10.

Va. 14°25'E.

40.00 Set post, 4 in. dia. 1 ft. in earth 1 ft. above earth mound, 4 ft. in dia. at base by 2 ft. in height and dug pits 24x18x12, 8 lks. North for $\frac{1}{4}$ Sec. Cor.

80.00 The Corner to Sections 3-4-9-10.

Land rolling. Soil 2nd rate.
Timber and undergrowth of Oak and Chaparral.

North on random bet. Secs. 3 and 4.

Va. 14°25'E.

2.00 Leave Barley Field, bears E. and S.W.

6.00 Cross gulch 18 lks. wide, course N.E.

18.00 " " 100 " " " N.E. & ascend.

24.00 " Road, bears West and N.E.

40.00 Set temporary $\frac{1}{4}$ Sec. Cor. on top of high table land and descend

59.00 Enter valley.

63.75 Cross Road

72.30 " " bears West & N.E.

77.75 " Wash, 20 lks. wide, course East

80.13 Intersect North Boundary of Tp. 27 lks. East of Cor. to Secs. 3 and 4.
from which I run S 12°E. bet. 3 & 4.

Va. East

40.13 Set post, 4 in. dia. 1 ft. in earth, 1 ft. above earth mound, 4 ft. in dia. at base by 2 ft. in height and dug pits 24x18x12, 8 lks. East for $\frac{1}{4}$ Sec. Cor.

80.13 The corner to Secs. 3-4-9-10.

Tp. 8 N., R.19 W., S.B.M.

Land rolling. Soil 2nd rate.
Timber and undergrowth of Oak and Chaparral.

North, between Sections 32 & 33. Va. 14°25'E.
Ascend.

- 21.00 Summit of Ridge, bears N.W. & S.E. and descend
- 40.00 Set post, 4 in. dia. 1 ft. in earth, 1 ft. above stone mound, 4 ft. in dia. at base by 2 ft. in height for $\frac{1}{4}$ Sec. Cor. at head of Canada, bearing S.E. and N.W. & ascend.
- 50.00 Top of spur, bears N.W. & S.E. & descend.
- 61.20 Cross gulch, 5 lks. wide, course N.E. and ascend
- 80.00 Set post, 4 in. square 1 ft. in earth 1 ft. above stone mound $4\frac{1}{2}$ ft. in dia. at base by 2 ft. in height for corner to Sections 28-29-32-33.

Land mountainous. Soil 2nd rate.
Timber and undergrowth of Oak and Chaparral.

Sept. 23, 1880.

East on random bet. Secs. 28 & 33. Va. 14°25'E.

In order to properly adjust my compass for Subdividing this Tp. I set my instrument on the cor. to Secs. 7-12-13 & 18 on the Range line bet. Tps. 8 N. Ranges 18 & 19 W. and I take a sight to the $\frac{1}{4}$ Sec. cor. bet. Secs. 7 & 12 which is in view from this point, and find the bearing N. 14°30' W.

Hence to retrace this line or run parallel thereto. I must use a Va. of 14°30' East. Sept. 25th. 1873.

West bet. Secs. 12 & 13. Va. 14°30' East

- 28.00 To S.E. cor. of James Gorman's field 10 chs. N. of line. The E. end of field is about 15 chs. wide, extending N. & S. across dry lake valley.
- 40.00 To $\frac{1}{4}$ Sec. Cor. Set post 4 ft. long 2x3 in. dia. with charred stake on W. side, 1 ft. in ground. Raised mound of earth $4\frac{1}{2}$ ft. diam. 2 ft. high with pits 18 in. square and 12 in. deep as per ins. from which
A scrub oak 7 in. dia. bears S. $32\frac{1}{2}^{\circ}$ W 80 lks. & another
" " " 7 " " " S. $80\frac{1}{2}^{\circ}$ W 98 "
- 41.00 To E. edge of grove of Scrub Oak. course N. & S.
- 46.00 To James Gorman's house 37 chs. N. of line
- 55.30 To center of ravine 4 chs. wide course N.
- 58.00 " summit " spur, & leave Scrub Oak course N. & S.
- 76.00 To E. edge of small flat, course N. & SW.
- 80.00 To cor. to Secs. 11-12-13 & 14.

T. 8 N., R. 19 W., S.B.M.

Set post 4 ft. long, 4 in. dia. with charred stake on N. side
1 ft. in ground.

Raised mound of earth $4\frac{1}{2}$ ft. diam. 2 ft. high with pits 18 in.
square & 12 in. deep, as per ins.

This line runs along the base of the hills on the S. side of Dry
Lake Valley.

Land rolling.
Soil 2nd rate.

South bet. Secs. 13 & 14,

Va. $14^{\circ}30'$ East

20.50 To base of hills course N.E. & W.

Commence ascent

40.00 To $\frac{1}{4}$ Sec. Cor. Set post 4 ft. long 2x3 in. dia. with charred stake
on N. side 1 ft. in ground. Raised mound of earth $4\frac{1}{2}$ ft. dia. 2 ft.
high, with pits 18 in. square & 12 in. deep as per ins.

Land 1st. 20 chs. level.

Soil 2nd rate

Last 20 chs. very hilly

Soil 3rd rate.

I could proceed no further S. or W. from this point on account of
the rough & broken nature of the mountains.

North bet. Secs. 11 & 12.

Va. $14^{\circ}30'$ E

24.30 To S. line of Gorman's field, 8 chs. from S.W. cor.
Course of fence E. & W.

40.00 To $\frac{1}{4}$ Sec. Cor. Set post 4 ft. long, 2x3 in. dia. with charred stake
on N. side, 1 ft. in ground.
Raised mound of earth $4\frac{1}{2}$ ft. dia. 2 ft. high with pits 18 in. square
& 12 in. deep as per ins.

42.69 To N. line of Gorman's field 15 chs. from the N.W. cor. course
E. & W.

42.90 To Fort Tejon road course E. & W.

48.00 To base of hills on N. side of Dry Lake Valley.

80.00 To Cor. to Secs. 1, 2, 11 & 12.

Set post 4 ft. long 4 in. dia. with charred stake on N. side 1 ft.
in ground. Raise mound of earth $4\frac{1}{2}$ ft. dia. 2 ft. high with pits
18 in. square & 12 in. deep, as per ins.

Land for 1st. 48 chs. level.

Soil 1st rate. Last 32 chs. very hilly. Soil 3rd. rate.

I could proceed no further E.N. or W. from this point on account
of broken steep mountain range.

T. 8 N., R.19 W. S.B.M.

West bet. Sect. 11 & 14.

Va. 14°30'E.

29.00

To base of hills course N. & S.E.
Commence ascent

40.00

To $\frac{1}{4}$ Sec. Cor. Set post 4 ft. long, 2x3 in. dia. with charred stake on W. side 1 ft. in ground. Raised mound of earth $4\frac{1}{2}$ ft. dia. 2 ft. high with pits 18 in. square & 12 in. deep as per ins.

Land for 1st. 29 chs. level.
Soil 2nd rate.
Last 21 chs. very hilly.
Soil 3rd rate.

I could proceed no further W. in this direction on account of the steep hills.

General Description.

There is a small strip of farming land about from 15 to 20 chs. wide running through the centre of Sec. 12 and the E. $\frac{1}{2}$ of Sec. 11.

There is also a little farming land in the N.E. $\frac{1}{4}$ Sec. 14.

There is also a small creek running through Sec. 12, 2 chs. S. of Gorman's house, course E. having its source near the W. line of Sec. 12.

John Goldsworthy

U.S. Dept. Surveyor.