

FIELD NOTES OF
 T. 1 S., R. 17 W.
 SECTIONS 25, 26, 27, 28, 29, 30, 35 AND 36;
 AND
 T. 1 S., R. 16 W.
 SECTIONS 18, 19, 30, 31, 32

Surveyed by
 J. R. Glover in Sept. 1895 and
 M. P. Reilly in Oct. 1895

Copied from Certified Copy in Main
 Office Files of County Surveyor,
 Received from Surveyor General of California
 March 20, 1925

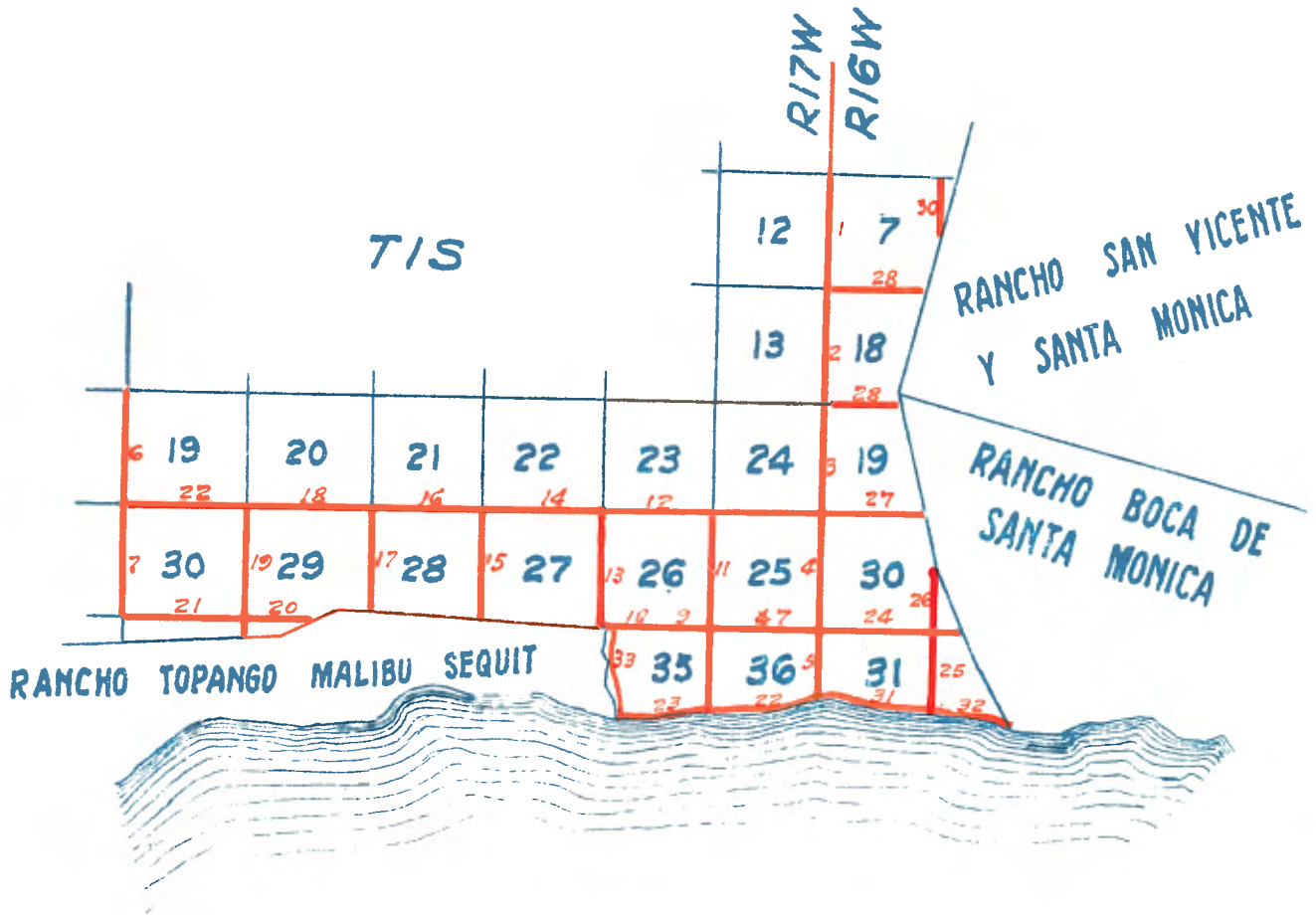

DEPARTMENT OF THE INTERIOR,
Office of U. S. Surveyor-General.

San Francisco, California,
March 20th, 1925.

I, JOHN PLOVER, U. S. Surveyor-General for California, do hereby certify that the annexed transcript of field notes of sections 25, 26, 27, 28, 29, 30, 35 and 36, Township 1 South, Range 17 West, and sections 18, 19, 30, 31 and 32, Township 1 South, Range 16 West, of the San Bernardino Meridian, California, is a true and literal exemplification of said field notes as they remain on file and of record in this office.

John Plover
United States Surveyor-General
for California.

SEAL

Book 128-15
Survey made by J. R. Glover,
U.S. Deputy Surveyor
Contract of November 20, 1884.
Survey commenced September 13, 1895.
Survey completed October 28, 1895.

E. Boundary T.1 S., R.17 W., S.B.M.

Chains.

From the cor. to Tps. 1 N., and 1 S., Rs. 16 and 17 W., on San Bernardino Base Line, previously set by me, I run
South, x x x x x
SOUTH, on true line, bet. secs. 7 and 12.

Var. $14^{\circ}30'$ East.

x x x x x x

80.00 Set a sandstone $30 \times 12 \times 10$ ins. 22 ins. in the ground, for cor. to secs. 7, 12, 13 and 18, marked with 2 notches on N. and 4 notches on S. edges; from which bears

A live oak 16 ins. dia. $S. 32\frac{1}{2}^{\circ}E.$, 48 lks. dist., marked T.1 S., R.16 W., S.18 B T.

A live oak 12 ins. dia. $S. 11\frac{1}{2}^{\circ}W.$ 45 lks. dist. marked T.1 S., R.17 W., S.13 B T.

No other trees within limits; raised a stone mound alongside.
Pits impracticable.

Land, mountainous.

Soil, 3rd rate.

Scattering oak and sycamore timber and dense undergrowth of chaparral.

Oct. 8th, 1895.

SOUTH on a true line bet. secs. 13 and 18.

Var. $14^{\circ}42'$ East.

Ascend.

1.10 Top of low spur, bears N.E. and S.W. and descend.

2.45 Cross canon, 12 lks. wide, course $N. 50^{\circ}E.$ and ascend.

- 17.50 Enter dense brush, bears E. and W.
 33.00 Top of ridge, bears E. and W. and descend.
 40.00 Set a sandstone 22x20x6 ins., 16 ins in the ground, for $\frac{1}{4}$ sec.
 cor., marked $\frac{1}{4}$ on W. face and raised a stone mound alongside.

Chains.

Pits impracticable.

- 54.41 Cross canon, 12 lks. wide, course N.40°E. and ascend.
 62.50 Top of ridge, bears E. and W. and descend.
 71.18 Cross gulch, 9 lks. wide, course E. and ascend.
 75.00 Cross road, bears N.E. and S.W.
 80.00 Set a sandstone 20 x 12 x 5 ins., 15 ins. in the ground for
 cor. to secs. 13, 18, 19 and 24, marked with 3 notches on N.
 and S. edges; from which bears

A live oak 12 ins. dia. N.7 $\frac{1}{2}$ °E. 91 lks. dist., marked
 T. 1 S., R. 16 W., S. 18 B T.

A live oak 30 ins. dia. S.40 $\frac{1}{2}$ °E. 122 lks. dist. marked
 T. 1 S., R. 16 W., S. 19 B T.

No other tree within limits; dug pits 18x18x12 ins., in
 secs. 13 and 24, 5 $\frac{1}{2}$ ft. dist., and raised an earth mound 2 ft.
 high, 4 $\frac{1}{2}$ ft. base, alongside corner stone.

Land, mountainous.

Soil, 3rd rate.

Scattering oak and sycamore timber and dense undergrowth of
 chaparral.

Oct. 9th, 1895.

 SOUTH, on a true line, bet. secs. 19 and 24

Va. 14°42' East.

Ascend.

- 2.00 Top of low spur, bears E. and W. and descend.
 3.71 Cross canon, 10 lks. wide. course E. and ascend.

- 29.00 Top of ridge, bears E. and W. and descend.
 34.72 Cross Gulch, 8 lks. wide, course S.E. and ascend.
 39.00 Top of spur bears E. and W. and descend.
 40.00 Set a sandstone, 34x 20 x 12 ins. in a stone mound, for $\frac{1}{4}$ sec. marked $\frac{1}{4}$ on W. face. Too rocky to set in the ground. Pits impracticable.
 41.27 Cross gulch, 7 lks. wide, course S.80°E. and ascend.

Chains.

- 51.00 Top of spur, bears E. and W. and descend.
 77.00 Cross canon, 14 lks. wide, course E. and ascend.
 77.90 Cross road, bears E. and W.
 80.00 Set a sandstone 18 x 12 x 6 ins., 12 ins. in the ground, for cor. to sees. 19, 24, 25 and 30, marked with 4 notches on N. and 2 notches on S. edges, and raised a stone mound alongside. Pits impracticable.

Land, mountainous.

Soil, 3rd rate.

Scattering oak timber and dense undergrowth of chaparral.

Oct. 10th, 1895.

SOUTH, on a true line bet. sees. 25 and 30.

W. 14° 33' East.

Ascend.

- 7.75 Top of spur, bears E. and W. and descend.
 10.06 Cross gulch, 2 lks. wide, course E. and ascend.
 17.50 Top of spur, bears E. and W. and descend.
 21.00 Cross gulch, 4 lks. wide, course E. and ascend.
 28.00 Top of spur, bears E. and W. and descend.
 37.40 Cross gulch, 4 lks. wide, course S.W. and ascend.
 39.50 Top of spur, bears N.E. and S.W. and descend.
 40.00 Set a sandstone, 22 x 12 x 6 ins., 16 ins. in the ground, for $\frac{1}{4}$ sec. cor., marked $\frac{1}{4}$ on W. face, and raised a stone mound, alongside. Pits impracticable.

Chains.

58.75 Cross ravine, 10 lks. wide, course E. and ascend.
62.00 Top of spur bears E. and W. and descend.
64.00 Cross gulch, 5 lks. wide. course N.E. and ascend.
65.10 Top of low spur, bears N.E. and S.W. and descend.
67.20 Cross gulch, 4 lks. wide, course N.E. and ascend.
70.40 Top of low spur, bears N.E. and S.W. and descend.
77.80 Cross gulch, 3 lks. wide, course N.E. and ascend.
80.00 Set a sandstone 28 x 14 x 10 ins. 21 ins. in the ground, for
cor. to secs. 25, 30, 31 and 36, marked with 1 notch on S.
and 5 notches on N. edges, and raised a stone mound alongside.
Pits impracticable.
Land, mountainous.
Soil, 3rd rate.
No timber.
Dense undergrowth of chaparral.

Oct. 11th, 1895.

SOUTH on a true line bet. secs. 31 and 36.

Va. 14*36' East.

Ascend.

1.90 Cross road on top of spur, bears N.W. and S.E. and descend.
13.40 Cross gulch. 2 lks. wide, course S.E. and ascend.
24.50 Top of spur, bears N.W. and S.E. and descend abruptly.
38.95 To a point near high water mark on the shore of the Pacific
Ocean and set a sandstone 36 x 18 x 9 ins., 27 ins. in the
ground, for meander cor. to fractional secs. 31 and 36, marked
M. C. on S. face, and raised a stone mound alongside; 2 ft.
high, 4½ ft. base. Pits impracticable.
Land, mountainous.
Soil, 3rd rate,
Dense undergrowth of chaparral.
No timber.

I carefully examined the adjustments of my solar compass, today, particularly the latitude and reversing apparatus and found them correct.

Oct. 12th, 1895.

W. Boundary of T.1 S., R.17 W., S.B.M.

Chains.

SOUTH on a true line bet. secs. 19 and 24.

Va. 14°30' East.

xxxxxxx

80.00 Set a sandstone 26 x 14 x 10 ins. 19 ins. in the ground, for cor. to secs. 19, 24, 25 and 30, marked with 4 notches on N. and 2 notches on S. edges, and raised a stone mound alongside. Pits impracticable.

Land, broken and mountainous. Soil, 3rd rate.

Scattering oak timber and dense undergrowth of chaparral.

Oct. 25th, 1895.

SOUTH on a true line bet. secs. 25 and 30.

Va. 14°30' East.

Ascend.

.50 Top of spur, bears E. and W. and descend.
3.00 Cross gulch, 6 lks. wide, course N.E. and ascend.
19.50 Top of ridge, bears N. 60° W. and S. 60° E. and descend.
23.25 Cross gulch, 4 lks. wide, course E. and ascend.
25.50 Top of ridge, bears E. and W. and descend.
40.00 Set a sandstone 28 x 12 x 10 ins., 21 ins. in the ground for $\frac{1}{4}$ sec. cor., marked $\frac{1}{4}$ on W. face and raised a stone mound alongside. Pits impracticable.
42.50 Cross canon, 10 lks. wide, course E. and ascend.
51.10 Top of low spur, bears N.E. and S.W. and descend.

Chains.

- 65.00 Cross canon, 10 lks. wide, course E. and ascend.
77.50 Top of spur, bears E. and W. and descend.
79.00 Cross gulch, 6 lks. wide, course E. and ascend.
80.00 Set a sandstone 24 x 12 x 6 ins., 18 ins. in the ground for
cor. to secs. 25, 30, 31 and 36, marked with 1 notch on S.
and 5 notches on N. edges, and raised a stone mound alongside.
Pits impracticable.
Land, mountainous.
Soil, 3rd rate.
Scattering oak timber and dense undergrowth of chaparral.

Oct. 26th, 1895.

Book 361-8
Survey made by M.F. Reilly,
Deputy Surveyor.
Contract of November 20, 1884.
Surveyed Oct. 26, - Nov. 27, 1895.

Subdivisions T.1 S., R.17 W., S. 34 N.

From the corner to sections 25, 30, 31 and 36, on east boundary
of township previously described, I run WEST on true line
between sections 25 and 36.

Var. 14° 36' East.

Ascend.

- 6.50 Cross trail bears NW. and SE.
7.00 Top of spur bears N. 50° W. and S. 50° E. and descend.
9.75 Cross gulch, 4 links wide, course S. and ascend.
12.00 Top of spur bears N. and S. and descend.
27.50 Cross gulch, 5 links wide, course S. and ascend.
29.00 To foot of perpendicular bluff impossible to chain.
To avoid same I offset N. 25 links, thence W. 100 links.
Thence S. 25 links to true line and continue west, counting
distances from corner to sections 25, 30, 31 and 36.

38.24 Top of spur bears N. and S. and descend.

40.00 Set a sandstone 26 x 15 x 9 inches, 19 inches in the ground for quarter section corner, marked $\frac{1}{4}$ on N. face, and raised a stone mound alongside.

Pits impracticable.

44.85 Cross gulch 3 links wide, course S. 10°W. and ascend.

47.00 Top of spur bears NE. and SW. and descend.

50.22 Cross canon 12 links wide, course S. and ascend.

55.50 Top of spur bears N. and S. and descend.

63.00 Enter rolling land bears N. and S.

69.42 A cabin, bears N. 5 links distant.

70.96 Cross gulch, 4 links wide, course S. and ascend.

75.50 Top of high hill, bears NW. and SE. and descend.

78.04 Cross gulch, 3 links wide, course S. 45°E. and ascend.

80.00 Set a cement stone 26 x 14 x 10 inches, 19 inches in the ground for corner to sections 25, 26, 35 and 36, marked with 1 notch on S. and E. edges, and raised a stone mound alongside.

Pits impracticable.

Land, for E. 60.00 chains broken and mountainous.

Remainder, rolling hills.

Soil, third rate.

Scattering oak timber and dense undergrowth of chaparral.

SOUTH, on a true line between sections 35 and 36.

Var. 14°30' East.

Ascend.

4.00 Top of ridge, bears N. 55° W. and S. 55° E. and descend.

5.60 Cross road bears N. 25° W. and S. 25° E.

40.00 Set a sandstone 22 x 18 x 12 inches, 16 inches in the ground for quarter section corner, marked $\frac{1}{4}$ on W. face, and raised

a stone mound alongside.

Pits impracticable.

41.10 To a point near high water mark on the shore of the Pacific Ocean and set a sandstone 28 x 12 x 12 inches, 21 inches in the ground for meander corner to fractional sections 35 and 36, marked M.C. with 1 notch on E. and 5 notches on W. edges and raised a stone mount alongside.

Pits impracticable.

Land, broken and mountainous.

Soil, third rate.

Scattering oak timber and dense undergrowth of chaparral.

October 26, 1895.

Subdivisions T.1 S., R.17 W., S.E.M.

From the corner to sections 25, 26, 35 and 36, I run WEST on a true line between sections 26 and 35.

Var. 14°30' East.

Ascend.

5.00 Cross wood road bears N.25°W. and S.25°E.
7.00 Cross wood road on top of ridge bears NW. and SE. and descend.
17.68 Cross canon, 8 links wide, course S. and ascend.
20.50 Top of spur bears N. and S. and descend.
22.57 Cross gulch, 4 links wide, course S.10°E. and ascend.
26.80 Top of spur bears N. and S. and descend.
37.04 Cross canon, 6 links wide, course S. and ascend.
40.00 Set a sandstone 16 x 12 x 6 inches, 11 inches in the ground for quarter section corner, marked $\frac{1}{4}$ on N. face.
Dug pits 18 x 18 x 12 inches E. and W. of stone, 5 $\frac{1}{2}$ feet distant and raised an earth mound 1 $\frac{1}{2}$ feet high 3 $\frac{1}{2}$ feet base alongside.
45.00 Top of spur bears N. and S. and descend.
63.50 Cross gulch, 10 links wide, course S.30°W. and ascend.
65.50 Top of spur bears N.20°E. and S.20°W. and descend.

Subdivisions T.1 S., R.17 W. S.B.M.

68.16 Intersect east boundary of Rancho Topango Malibu Sequit, at a point 4.10 chains S.31°E. from corner No. 2 on boundary which is a sycamore 14 in. dia. marked T.M.No.2, from which bears a

Live oak 14 in. dia. S.60 3/4°W. 65 links distant, marked T.M.B.T.

As this point falls in Mateo Creek, impossible to mark, I retrace line 58 links E. and at a distance from corner to section 25, 26, 35 and 36 of

67.68 Set a sandstone 26 x 18 x 10 inches, 19 inches in the ground for witness corner to closing corner to sections 26 and 35, marked W.C.C.C. with 1 notch on S. and 5 notches on N. edges; dug pits 18 x 18 x 12 inches N., S. and E. of stone, 5 1/2 feet distant and raised an earth mound 2 feet high and 4 1/2 feet base alongside.

Land, mountainous.

Soil, third rate.

Scattering oak timber.

Dense undergrowth of chaparral.

From the corner to sections 25, 26, 35 and 36, I run NORTH between sections 25 and 26.

Var.14°30'East.

Descend.

.25 Cross gulch, 2 links wide, course SE. and ascend.

1.00 Top of ridge bears E. and W. and descend.

1.75 Cross low sag bears E. and W. and ascend.

40.00 Set a sandstone 28 x 14 x 14 inches, 21 inches in the ground for quarter section corner, marked 1/4 on W. face, and raised a stone mound alongside.

Pits impracticable

41.00 Cross gulch, 4 links wide, course S.E. and ascend.

Subdivisions T.1 S., R.17W., S.B.M.

- 49.50 Cross road on top of ridge bears N.55°E. and S.55°W. and descend.
50.60 Cross head of gulch, course W. and ascend.
55.50 Top of spur bears E. and W. and descend.
65.60 Cross gulch 4 links wide, course N.45°W. and ascend.
68.00 Top of spur bears NW. and SE. and descend.
79.80 Cross ravin 6 links wide, course NW. and ascend.
80.00 Set a sandstone 28 x 20 x 8 inches, 21 inches in the ground
for corner to sections 23, 24, 25 and 26, marked with 2 notches
on S. and 1 notch on E. edges, from which bears a
Sycamore 16 in. dia. N.33½°E 21 links distant,
marked T.1 S., R.17W., S.24 B T.
Sycamore 14 in. dia. S.79½°W. 11 links distant,
marked T. 1 S., R.17 W., S.26 B T.
Live oak 18 in. dia. S.64½°E. 12 links distant,
marked T.1 S., R.17 W., S.25 B T.
No other tree within limits.
Raised a mound alongside corner stone. Pits impracticable.
Land, mountainous.
Soil, third rate.
Scattering timber of sycamore and oak and dense undergrowth
of chaparral.

October 28, 1895.

EAST on a random line between sections 24 and 25.

Var.14°15' East.

- 40.00 Set temporary quarter section corner.
80.18 Intersect east boundary of township 21 links north of corner
to sections 19, 24, 25 and 30, previously described.
Thence I run
North 89°51'W. on true line between sections 24 and 25.
Var.14°33' East.
Descend.
18.80 Cross gulch 6 links wide, course N.10°E. and ascend.

Subdivisions T.1 S., R.17 W., S.B.M.

- 21.15 Cross road bears NE. and SW.
28.15 Cross road bears NE. and SW.
38.50 Cross fence bears NE. and SW. and enter field.
40.09 Set a sandstone 26 x 12 x 9 inches, 19 inches in the ground for quarter section corner, marked $\frac{1}{4}$ on N. face, from which bears a

Live oak 8 in. dia. N.36°49'E. 62 links distant, marked $\frac{1}{4}$ S.B.T.

No other tree within limits.

Raised a mound of stone alongside corner stone.

Pits impracticable.

- 49.00 Top of ridge, bears NE. and SW. and descend.
55.00 Leave field and cross fence bears NE. and SW.
79.85 Cross ravine, 6 links wide, course SW. and ascend.
80.18 The corner to sections 23, 24, 25 and 26.

Land, mountainous.

Soil, third rate.

Scattering timber and dense undergrowth of chaparral.

- - - - -

From the corner to sections 23, 24, 25 and 26, I run WEST on a true line between sections 23 and 26.

Var.14°15'East.

Ascend.

- .20 Top of low spur bears N. and S. and descend.
.48 Cross ravine, 6 links wide, course N.50°W. and ascend.
10.00 Top of spur, bears N. and S. and descend.
17.20 Cross same ravine, 8 links wide, course S.60°W. and ascend.
39.00 Top of spur bears N.20°E. and S.20°W. and descend.
40.00 Set a sandstone 22 x 18 x 14 inches in a stone mound for quarter section corner, marked $\frac{1}{4}$ on N. Face.

Pits impracticable. Too rocky to set stone in earth.

Subdivisions T.1 S., R.17 W., S. B. M.

50.86 Cross gulch, 2 links wide, course S.15°W. and ascend.
58.50 Top of spur bears NE. and SW. and descend.
72.40 Enter Mateo Canon and cross creek 20 links wide, course
S.15°W.
75.00 Leave Mateo Canon bears N. and S. and ascend.
80.00 Set a sandstone 28 x 12 x 9 inches, 21 inches on the ground
for corner to sections 22, 23 and 27, marked with 2 notches
on S. and E. edges, and raised a stone mound alongside.
Pits impracticable.
Land, mountainous.
Soil, third rate.
Dense undergrowth of chaparral.
No timber.
I carefully examined the adjustments of my solar compass today,
particularly the latitude and reversing apparatus and found
them correct.

SOUTH on a true line between sections 26 and 27.

Var.14°06' East.

Ascend.

2.50 Top of spur bears E. and W. and descend.
15.50 Cross low sag bears E. and W. and ascend.
20.00 Top of spur bears N.65°W. and S.65°E. and descend.
25.14 Cross gulch, 5 links wide, course E. and ascend,
30.00 Top of spur bears E. and W. and descend.
35.52 Cross gulch, 4 links wide, course N.85°E. and ascend.
40.00 Set a sandstone 22 x 15 x 7 inches, 16 inches in the ground
for quarter section corner, marked $\frac{1}{4}$ on W. face, and raised a
stone mound alongside.
Pits impracticable.
Corner stands on top of spur bears E. and W. and descend.

Subdivisions T.1 S., R.17 W., S.E.M.

- 60.25 Cross gulch 4 links wide, course E. and ascend.
63.00 Top of spur bears N.40°E. and S.40°W. and descend.
64.75 Cross gulch, 4 links wide, course N.45°E. and ascend.
68.50 Top of spur bears E. and W. and descend.
70.20 Cross gulch, 4 links wide, course E. and ascend.
75.62 Intersect north boundary of Rancho Topanga Malibu Sequit,
9.64 chains N.84°09'W. from No. 2, and set a sandstone
18 x 12 x 10 inches, 12 inches in the ground, for closing
corner to sections 26 and 27, marked C.C. with 2 notches on E.
and 4 notches on W. edges, dug pits 18 x 18 x 12 inches NE.
and W. of stone, 5½ feet dist., and raised an earth mount
2 feet high, 4½ feet base alongside.

Land, mountainous.

Soil, third rate.

Scattering oak timber and dense undergrowth of chaparral.

November 2, 1895.

From the corner to sections 22, 23, 26 and 27, I run
WEST on a true line between sections 22 and 27.

Var.14°06'East

Ascend.

- 6.56 Top of ridge bears NW. and SE. and descend.
10.00 Cross wash 10 links wide, course N.80°E. and ascend.
25.00 Top of ridge bears N. and S. and descend.
31.00 Cross low sag bears N. and S. and ascend.
34.00 Top of spur bears NE. and SW. and descend.
39.00 Cross trail bears N. and S.
40.00 Set a sandstone, 28 x 14 x 10 inches. 21 inches in the ground,
for quarter section corner, marked ¼ on N. face and raised a
stone mound alongside. Pits impracticable.
40.50 Cross gulch 8 links wide, course SW. and ascend.

Subdivisions T.1 S., R.17 W., S.B.M.

- 42.50 Top of spur bears N. and S. and descend.
55.25 Cross canon, 25 links wide, course S.10°W. and ascend.
56.50 Top of spur bears N. and S. and descend.
73.85 Cross canon 10 links wide, course S. and ascend.
75.00 Top of spur bears N. and S. and descend.
80.00 Set a sandstone 30 x 12 x 10 inches, 22 inches in the ground for corner to sections 21,22,27 and 28, marked with 2 notches on S. and 3 notches on E. edges and raised a stone mound alongside. Pits impracticable.
Land, mountainous.
Soil, third rate.
Scattering oak timber and dense undergrowth of chaparral.

SOUTH on a true line between sections 27 and 28.

Var.14°18'East.

Descend.

- 7.50 Cross low sag bears E. and W. and ascend.
10.00 Top of spur bears E. and W. and descend.
12.00 Cross gulch, 10 links wide, course W. and ascend.
17.50 Top of spur bears N.60°E. and S.60°W. and descend.
25.85 Cross gulch 8 links wide, course W. and ascend.
27.75 Top of spur bears N.35°E. and S.35°W., and descend.
38.00 Cross canon 25 links wide, course S.35°E. and ascend.
40.00 The true point for corner falling on a perpendicular slide, impossible to mark, I continue S.50 links and set a sandstone 22 x 15 x 9 inches. 16 inches on the ground for witness corner to quarter section corner, marked W. C. $\frac{1}{4}$ on W. face, and raised a stone mound alongside.
Pits impracticable.
50.00 Top of spur bears E. and W. and descend.
61.50 Cross canon 6 links wide, course E. and ascend.

Subdivisions T.1, S., R.17 W., S.B.M.

69.54 Intersect north boundary of Rancho Topanga Malibu Sequit, 20.92 chains N.89°45'W. from corner No. 3 on boundary which is a live oak 12 in. dia., marked T. M. No. 3, on S. face, and set a sandstone 26 x 18 x 4 inches, 19 inches on the ground for closing corner to sections 27 and 28, marked G.C. with 3 notches on E. and W. edges, and raised a stone mound alongside. Pits impracticable.
Land, mountainous.
Soil, third rate.
Scattering oak timber and dense undergrowth of chaparral.

November 8, 1895.

From the corner to sections 21, 22, 27 and 28, I run WEST on a true line between sections 21 and 28.

Var. 14°18' East.

Descend.

5.00 Cross canon 10 links wide, course S.10°E. and ascend.
35.00 Top of high ridge, bears N. and S. and descend.
38.00 Cross gulch, 4 links wide, course S.45°W. and ascend.
40.00 Top of low spur bears N. and S.
Set a sandstone 24 x 12 x 7 inches, 18 inches in the ground for quarter section corner, marked $\frac{1}{4}$ on N. face, and raised a stone mound alongside.
Pits impracticable.
Descend.
52.50 Cross gulch, 4 links wide, course S.30°W. and ascend.
53.50 Top of spur bears N. and S. and descend.
55.25 Cross gulch 4 links wide, course S. 15°W. and ascend.
64.50 Top of spur bears N. and S. and descend.
70.00 Cross trail bears NE. and SW.
71.50 Cross gulch, 5 links wide, course S. and ascend.

Subdivisions T.1. S., R.17 W., S.E.M.

- 77.50 Top of spur bears N. and S. and descend.
- 80.00 Set a sandstone 24 x 18 x 15 inches, 18 inches in the ground for corner to sections 20, 21, 28 and 29, marked with 2 notches on S. and 4 notches on E. edges, and raised a stone mound alongside.
- Pits impracticable.
- Land, mountainous.
- Soil, third rate.
- Scattering oak timber and dense undergrowth of same and chaparral.
-
- SOUTH on a true line between sections 28 and 29.
- Var. 14°21' East.
- Descend.
- 3.80 Cross gulch, 6 links wide, course S.30°E. and ascend.
- 9.00 Top of spur bears NE. and SW. and descend.
- 15.00 Cross same gulch, 6 links wide, course S.25°W. and ascend.
- 21.00 Top of spur bears NE. and SE. and descend.
- 27.48 Cross gulch 3 links wide, course W. and ascend.
- 32.00 Top of spur bears E. and W. and descend.
- 40.00 Set a sandstone 44 x 16 x 12 inches, 33 inches in the ground, for quarter section corner, marked $\frac{1}{4}$ on W. face, and raised a stone mound alongside.
- Pits impracticable.
- 50.00 Enter gulch, course S., comes from N.10°E.
- 57.28 Cross gulch, 3 links wide, course S.30°W. and ascend.
- 69.28 Intersect north boundary of Rancho Topanga Malibu Sequit, 21.03 chains N.89°45'W. from stone set firmly in the ground marked T.M. 32/80 on S. face, with a stone mound in good order alongside, and set a sandstone 24 x 12 x 8 inches, 18 inches in the ground, for closing corner to sections 28 and 29, marked C.C. with 4 notches on E. and 2 notches on W. edges, and raised a stone mound alongside.

Subdivisions T.1 S., R.17 W., S.B.M.

Pits impracticable.

Land, mountainous.

Soil, third rate.

Scattering oak timber, and dense undergrowth of same and chaparral.

November 14, 1895.

From the corner to sections 20, 21, 28 and 29, I run
WEST on a true line between sections 20 and 29.

Var. 14° 21' East.

Descend.

- 2.25 Cross gulch 10 links wide, course S. and ascend.
- 12.00 Top of ridge, bears NE. and SW. and descend.
- 15.75 Cross gulch, 4 links wide, course S. and ascend.
- 28.00 Top of spur bears N. and S. and descend.
- 30.00 Cross gulch, 5 links wide, course S. 10° W, and ascend.
- 35.00 Top of spur bears North and South and descend.
- 40.00 Set a sandstone 26 x 18 x 10 inches, 19 inches in the ground
for quarter section corner, marked $\frac{1}{4}$ on N. face and raised a
stone mound alongside.
- Pits impracticable.
- 43.00 Cross gulch 10 links wide, course S. 40° W. and ascend.
- 62.00 Top of spur bears N. 40° E. and S. 40° W. and descend.
- 70.50 Enter Malibu Canon, course S.
- 71.10 Cross Malibu Creek, 30 links wide, course S.
- 71.75 Leave Malibu Canon, course S. and ascend.
- 80.00 Set a sandstone 24 x 16 x 6 inches, 18 inches on the ground
for corner to sections 19, 20, 29 and 30, marked with 2 notches
on S. and 5 notches on E. edges, and raised a stone mound
alongside. Pits impracticable.
- Land, mountainous.
- Soil, third rate.
- Timber of oak and dense undergrowth of chaparral.

Subdivisions, T.1 S., R.17 W., S.B.M.

SOUTH on a true line between sections 29 and 30.

Var.14°06'East.

Ascend.

- 1.00 Top of low spur bears E. and W. and descend.
2.50 Cross gulch 4 links wide, course E. and ascend.
5.00 Top of spur bears E. and W. and descend.
8.00 Cross gulch, 3 links wide, course E. and ascend.
12.25 Top of spur bears E. and W. and descend.
15.00 Cross gulch, 4 links wide, course E. and ascend.
17.10 Top of spur bears E. and W. and descend.
20.25 Cross gulch 5 links wide, course E. and ascend.
21.25 Top of spur bears E. and W. and descend.
23.00 Cross low sag bears E. and W. and ascend.
25.50 Top of ridge, bears E. and W. and descend.
33.50 Cross gulch, 5 links wide, course E. and ascend.
34.50 A house bears W. 35 links distant.
35.50 Cross road bears N.15°W. and S.15°E.
36.90 Top of low spur, bears E. and W. and descend.
38.25 Cross gulch, 4 links wide, course E. and ascend.
40.00 Set a sandstone 24 x 12 x 10 inches, 18 inches in the ground for quarter section corner, marked $\frac{1}{4}$ on W. face and raised a stone mound alongside.
Pits impracticable.
48.00 Top of ridge bears NE. and SW. and descend.
57.70 Cross gulch, 5 links wide, course E. and ascend.
69.50 Top of spur bears N.70°W. and S.70°E. and descend.
77.75 Cross gulch 5 links wide, course S.10°E. and ascend.
78.10 Top of low spur bears N.15°W. and S.15°E. and descend.
79.50 Cross gulch, 4 links wide, course S.70°E. and ascend.
80.00 Set a sandstone 28 x 14 x 10 inches, 21 inches in the ground for corner to sections 29, 30, 31 and 32, with 1 notch on S. and 5 notches on E. edges, and raised a stone mound alongside.

Subdivisions, T.1 S., R.17 W., S.B.M.

Pits impracticable.

Land, mountainous.

Soil, third rate.

Scattering oak timber and dense undergrowth of chaparral.

From corner to sections 29, 30, 31 and 32, I run
EAST on a true line between sections 29 and 32.

Var.14°01'East.

Descend.

- .75 Cross gulch 4 links wide, course N.60°E. and ascend.
- 10.00 Top of spur bears NE. and SW. and descend.
- 14.08 To foot of perpendicular bluff, impossible to continue survey further on this line.

Set a sandstone 28 x 14 x 9 inches, 21 inches in the ground for witness corner to closing corner to sections 29 and 32, marked W.C.C.C. with 1 notch on S. and 5 notches on N. edges, and raised a stone mound alongside.

Pits impracticable.

Land, mountainous.

Soil, third rate.

Scattering oak timber and dense undergrowth of chaparral.

From the corner to sections 29, 30, 31 and 32, I run
WEST on a random line between sections 30 and 31.

Var.14°01'East.

- 40.00 Set temporary quarter section corner.
 - 80.14 Intersect west boundary of township 29 links S. of corner to sections 25, 30, 31 and 36, which is a sandstone set firmly in the ground, marked with 1 notch on S. and 5 notches on N. edges, with a stone mound in good order alongside.
- Thence I run

Subdivisions T.1 S., R.17 W., S.B.M.

South $89^{\circ}48'$ East on a true line between sections 30 and 31.

Var. $14^{\circ}30'$ East.

Descend.

- 3.28 Cross gulch 18 links wide, course S. and ascend.
- 20.60 Top of spur bears N. and S. and descend.
- 23.85 Cross gulch, 4 links wide, course $S.30^{\circ}E.$ and ascend.
- 29.33 To top of perpendicular bank of a canon impossible to continue further and to obtain distance across canon I proceed ahead on line after leaving a flag.
- At this point and from the point ahead on line I run a base N. of 2.00 chains, from which the flag bears $S.83^{\circ}02'W.$ giving by calculation a distance of 15.91 chains across canon and a total distance from corner to sections 25, 30, 31 and 36 of
- 45.24 It being impossible to set quarter section corner at true point, At this point, which is 5.10 chains $S.89^{\circ}48'E.$ of the true point I set a sandstone 32 x 12 x 8 inches, 24 inches in the ground for witness corner to quarter section corner, marked W.C. $\frac{1}{4}$ on N. face, and raised a stone mound alongside.
- Pits impracticable.
- 46.40 Top of spur bears N. and S. and descend.
- 47.80 Cross head of gulch, course $S.30^{\circ}E.$ and ascend.
- 51.50 Top of spur bears NW. and SE. and descend.
- 80.14 The corner to sections 29, 30, 31 and 32.

Land, mountainous.

Soil, third rate.

Dense undergrowth of chaparral.

No timber.

From the corner to sections 19, 20, 29, and 30, I run WEST on a random line between sections 19 and 30.

Var. $14^{\circ}06'$ East.

- 40.00 Set temporary quarter section corner.

Subdivisions T.1 S., R.17 W., S.B.M.

79.86 Intersect west boundary of township 22 links south of corner to sections 19, 24, 25 and 30, which is sandstone set firmly in the ground, marked with 2 notches on S. and 4 notches on N. edges, with a stone mound in good order alongside.
Thence I run
South 89°51' East on a true line between sections 19 and 30.
Var. 14°30' East.
Descend.

14.80 Cross gulch 4 links wide, course NE. and ascend.

20.00 Top of ridge bears N. 35° W. and S. 35° E. and descend.

25.75 Cross gulch, 3 links wide, course N. and ascend.

38.00 Top of ridge bears N. and S. and descend.

39.86 Set a sandstone 22 x 14 x 10 inches, 16 inches in the ground for quarter section corner, marked $\frac{1}{2}$ on N. face, dug pits 18 x 18 x 12 inches E. and W. of stone, 5 $\frac{1}{2}$ feet distant, and raised an earth mound 1 $\frac{1}{2}$ feet high, 3 $\frac{1}{2}$ feet base alongside.

55.00 Cross low sag bears N. and S. and ascend.

58.60 Top of spur bears N. and S. and descend.

68.75 Cross gulch, 3 links wide, course N. 50° E. and ascend.

70.50 Top of spur bears N. and S. and descend.

79.86 The corner to sections 19, 20, 29 and 30.

Land, mountainous.
Soil, third rate.
Scattering oak timber and dense undergrowth of chaparral.

November 20, 1895.

Meanders of Shore of Pacific Ocean.

I commence at the meander corner to fractional sections 31 and 36, on east boundary of township, previously described and run with meanders in section 36.

Var. 14°36' East.

Course	Chains
s. 58° W.	5.53
s. 41° W.	6.95

Subdivisions T.1 S., R.17 W., S.B.M.

Course Chains

S.56°W. 1.38 85 Mouth of gulch, course S.

S.76 3/4°W 7.46

N.74°W. 10.68

S.86 1/2°W. 3.49

N.86 1/2°W 9.18

N.82°W. 15.07

N.87 1/2°W. 3.81

N.80 1/2°W. 15.88

N.85 1/2°W. 5.18

To Meander corner to fractional sections 25 and
36. Land, broken rough.

Meanders of Shore of Pacific Ocean.

Soil, fourth rate. No timber.

Dense undergrowth of chaparral.

Thence in Section 35.

Var.14°30' East.

S.79°W. 4.81

S.61 1/2°W. 6.53

S.78 1/2°W. 2.36

S.87°W 8.94

N.89 1/2°W 19.30

S.84°10'W. 7.87

S.70°58'W 8.32

To corner No. 1 on east boundary of Rancho Topango
Malibu Sequit, which is a post set firmly in the
ground marked T.M.No.1 on S. face, with a stone
Mound in good order around post.

Land, broken and rough.

Soil, fourth rate.

No timber.

Dense undergrowth of chaparral.

Book 361-6
Survey made by M.F. Reilly,
Deputy Surveyor
Contract of November 20, 1894.
Surveyed December 2 - 6, 1895.

Subdivisions T.1 S., R.16 W., S.B.M.

From the corner to sections 25, 30, 31 and 36, on west boundary of town-
ship, which is a sandstone, set firmly in the ground, marked with 1 notch
on S. and 5 notches on N. edges, with a stone mound in good order alongside,
I run

EAST on a true line between sections 30 and 31.

Var. $14^{\circ}36'$ East.

Descend

- 11.00 Enter plowed ground, bears N. and S.
15.00 Leave plowed ground bears N. and S. and enter dense chaparral.
26.30 Cross canon 50 links wide, course $S.10^{\circ}E.$ and ascend.
29.00 Top of spur bears $N.25^{\circ}W.$ and $S.25^{\circ}E.$ and descend.
30.53 Cross gulch, 4 links wide, course $S.35^{\circ}W.$, and ascend.
40.00 Set a sandstone 22 x 12 x 8 inches, 16 inches in the ground
for quarter section corner, marked $\frac{1}{4}$ on N. face, and raised
a stone mound alongside.

Pits impracticable.

- 50.00 Top of ridge bears NW. and SE. and descend.
80.00 Set a post 4 feet long, 4 inches square, with marked stone 12
inches in the ground for corner to sections 29, 30, 31 and 32,
marked,

T.1 S., S.29 on NE. R.16 W., S.32 on SE.

S.31 on SW. and S.30 on NW. faces, with 1 notch on S.
and 5 notches on E. edges, and raised a stone mound around
post. Pits impracticable.

Land, mountainous.

Soil, second and third rate.

Dense undergrowth of chaparral.

No timber

Subdivisions T.1 S., R.16 W., S.B.M.

SOUTH on a true line between sections 31 and 32.

Var.14°36'East.

Descend.

4.00 Cross Luna Creek, 20 links wide, course S.10°W. and ascend.

4.50 Cross road bears N.10°E. and S.10°W.

13.00 Top of spur bears E. and W. and descend.

24.86 Cross gulch 3 links wide, course W. and ascend.

33.00 Top of spur bears N.10°E. and S.10°W. and descend,

34.46 To a point near high tide line of the Pacific Ocean, and set a post 4 feet long, 4 inches square, with marked stone 12 in. in the ground, for meander corner to fractional sections 31 and 32, marked

M. C. T.1 S., on S. R.16 W., S. 32 on E. and S. 31 on W.faces, and raised a stone mound around post.

Pits impracticable.

Land, mountainous.

Soil, third rate.

Dense undergrowth of chaparral.

No timber.

From the corner to sections 29,30,31 and 32, I run

EAST on a true line between sections 29 and 32.

Var.14°36'East.

Descend.

2.77 Cross Tuna Creek, 20 links wide, course S.25°W. and ascend.

2.90 Cross road bears N. and S.

4.87 Intersect west boundary of Rancho Boca de Santa Monica, 3.50 chains N.23 3/4°W. from sandstone, set firmly in the ground, marked B.S.M. ²/₈₀ on SE.face with a stone mound in good order alongside, and set a post 4 feet long, 4 inches square, with marked stone 12 inches in the ground for closing corner to sections 29 and 32, marked

Subdivisions T.1 S., R.16 W., S.B.M.

C.C. T.1 S., R.16 on W. S.29 on N. and S.32 on S. faces, with 1 notch on S. and 5 notches on N. faces, and raised a stone mound around post.

Pits impracticable.

Land, mountainous.

Soil, third rate.

Dense undergrowth of chaparral.

No timber.

December 2, 1895.

From the corner to sections 29, 30, 31 and 32, I run NORTH between sections 29 and 30.

Var. $14^{\circ}36'$ East.

Ascend.

- 2.10 Top of low spur, bears NW. and SE. and descend.
3.20 Cross road bears NW. and SE.
3.34 Cross Tuna Creek 15 links wide, course S. 30° E. and ascend.
11.18 Intersect west boundary at Rancho Boca de Santa Monica 12.19 chains N. $23 \frac{3}{4}^{\circ}$ W. from closing corner to sections 29 and 32, and set a sandstone 28 x 20 x 12 inches, 21 inches in the ground, for closing corner to sections 29 and 30, marked C. C. with 1 notch on W. and 5 notches on E. edges, and raised a stone mound alongside.
Pits impracticable.
Land, mountainous.
Soil, third rate.
Dense undergrowth of chaparral.
No timber.

From the corner to sections 19, 24, 25 and 30, on west boundary of township, which is a sandstone set firmly in the ground, marked with 2 notches on S. and 4 notches on N. edges

Subdivisions T.1 S., R.16 W., S.B.M.

with a stone mound in good order alongside. I run EAST on a true line between sections 19 and 30.

Var. 14°33' East.

Ascend.

- 3.75 Top of spur bears N. and S. and descend.
- 4.55 Cross trail bears NW. and SE.
- 5.50 Cross gulch, 2 links wide, course N.10°E. and ascend.
- 7.00 Cross same trail bears NE. and SW.
- 7.45 Top of spur bears N. and S. and descend.
- 8.10 Cross same trail bears N.75°W. and S.75°E.
- 10.45 Cross Tuna Creek, 10 links wide, course S. and ascend.
- 17.00 Top of spur bears N. and S. and descend.
- 24.48 Cross gulch 5 links wide, course S. and ascend.
- 30.00 Top of spur, bears N. and S. and descend.
- 39.00 Cross gulch 3 links wide, course S.60°W. and ascend.
- 40.00 Set a sandstone 22 x 10 x 9 inches, 16 inches in the ground, for quarter section corner, marked $\frac{1}{4}$ on N. face, and raised a stone mound alongside.
- Pits impracticable.
- 49.00 Top of high ridge, bears N. and S. and descend.
- 51.94 Intersect west boundary of Rancho Boca de Santa Monica, 10.09 chains N.12°50' West from a post set firmly in the ground, marked S. S. M. 21 on NW. and B.M. 12 on NE. faces, and set a sandstone 28 x 12 x 10 inches, 21 inches in the ground for closing corner to sections 19 and 30, marked G.C. with 2 notches on S. and 4 notches on N. edges, and raised a stone mound alongside. Pits impracticable.
- Land, mountainous.
- Soil, third rate.
- Dense undergrowth of chaparral.
- No timber.
-

Subdivisions, T.1 S., R.16 W., S.B.W.

From the corner to sections 13, 18, 19 and 24, on west boundary of township, which is a sandstone set firmly in the ground marked with 3 notches on N. and S. edges, pits in sections 13 and 24, and an earth mound in good order, alongside stone, from which bears a

Live oak 12 in. dia. N.7½°E. 91 links distant, marked T.1 S., R.16 W., S.18 B.T.

Live oak 30 in. dia. S.40½°E. 122 links distant, marked T.1 S., R.16 W., S.19 B.T.

I run

EAST on a true line between sections 18 and 19.

Var.14°42'East.

Descend.

- 3.00 Cross ravin 10 links wide, course N. and ascend.
- 9.00 Top of spur bears N. and S. and descend.
- 12.48 Cross gulch 2 links wide, course N.25°E. and ascend.
- 20.00 Top of spur bears N. and S. and descend.
- 28.20 Cross gulch, 3 links wide, course NE. and ascend.
- 30.68 Intersect west boundary of Rancho San Vicente y Santa Monica 16 links N.27°32'East, from corner on line, which is post set firmly in the ground, marked B.S.M. on S. and, S.V.S.M. on N. faces, with a stone mound in good order around post, and set a sandstone 27 x 12 x 10 inches, 19 inches in the ground for closing corner to sections 18 and 19, marked C.C. with 3 notches on N. and S. edges, from which bears a
- Live oak 10 in. dia. N.3¼°E. 44 links distant, marked T.1 S., R.16 W., S.17 B. T.
- No other tree within limits; raised a stone mound alongside corner stone.
- Pits impracticable.
- Land, mountainous.

Subdivisions T.1 S., R.16 W., S.B.M.

Soil, third rate.

Scattering oak timber and dense undergrowth of chaparral.

December 3, 1895.

From the corner to sections 7, 12, 13 and 18, on west boundary of township, which is a sandstone set firmly in the ground, marked with 4 notches on S. and 2 notches on N. edges, with a stone mound in good order alongside, from which bears a

Live oak 16 in. dia. S. $32\frac{1}{2}^{\circ}$ E. 48 links distant, marked T.1 S., R.16 W., S.18 S.T.

Live oak 12 in. dia. S. $11\frac{1}{2}^{\circ}$ W. 45 links distant, marked T.1 S., R.17 W., S.13 S.T.

I run

EAST on a true line between sections 7 and 18.

Var. $14^{\circ}42'$ East.

Descend.

- 3.50 Cross canon, 12 links wide, course N. 50° E. and ascend.
- 5.00 Top of spur bears N. and S. and descend.
- 8.00 Cross Topanga Creek, 20 links wide, course S. 20° E. and ascend.
- 8.25 Cross wire fence, bears N. and S. and enter cultivated ground.
- 12.25 Cross road bears N. 65° W. and 65° E.
- 13.00 Cross wire fence bears NW. and SE. and leave cultivated ground.
- 16.50 Top of low spur, bears N. and S. and descend.
- 22.50 Cross creek 4 links wide, course S. 20° W. and ascend.
- 39.10 Cross wire fence bears N. and S.
- 40.00 Set a sandstone $3\frac{1}{4} \times 10 \times 8$ inches, 22 inches in the ground for quarter section corner, marked $\frac{1}{4}$ on N. face, and raised a stone mound alongside.
- Pits impracticable.
- 55.00 Top of low spur, bears N. and S. and descend.
- 65.00 Cross low sag, 50 links wide, course S. and ascend.
- 70.00 Top of ridge, bears N. and S. and descend.

Subdivisions T.1 S., R.16 W., S.B.M.

72.44 Intersect west boundary of Rancho San Vicente y Santa Monica, 6 links N.27°32' East from temporary closing corner to sections 7 and 18, previously set, and set a sandstone 23 x 15 x 9 inches, 16 inches in the ground for closing corner to sections 7 and 18, marked with 4 notches on S. and 2 notches on N. edges, and raised a stone mound alongside.

Pits impracticable.

Land, mountainous.

Soil, second and third rate.

Scattering oak timber and dense undergrowth of chaparral.

SOUTH on a true line between sections 7 and 8.

Var. 14°30' East.

x x x x x x

64.93 Intersect west boundary Rancho San Vicente y Santa Monica, 16.88 chains N.27°32' East from closing corner to sections 7 and 18, and set a sandstone 22 x 14 x 10 inches, 16 inches in the ground, for closing corner to sections 7 and 8, marked C.C. with 1 notch on W. and 5 notches on E. edges, from which bears a

Live oak 18 in. dia. N.31°E. 86 links distant, marked T.1 S., R.16 W., S.8 B.T.

Live oak 8 in. dia. N.87°W. 63 links distant, marked T.1 S., R.16 W., S.7 B.T.

No other tree within limits, raised a stone mound alongside corner stone.

Pits impracticable.

Land, broken and mountainous.

Soil, second and third rate.

Scattering oak timber and dense undergrowth of chaparral.

Subdivisions T. 1 S., R. 16 W., S.B.M.

Meanders of Shore of Pacific Ocean

I commence at the meander corner to fractional section 31 and 36 on west boundary of township, which is a sandstone set firmly in the ground, marked M.C. on S. face, with a stone mound in good order alongside.

Thence I run, with meanders in section 31.

Var. 14°36' East.

N. 75 3/4° E.	3.29	
N. 66 3/4° E.	9.24	
S. 89 1/2° E.	11.70	
N. 87° E.	15.55	
S. 71 1/2° E.	3.16	
N. 87 1/2° E.	1.58	Mouth of canon, course S.E.
N. 62° E.	8.37	
N. 82° E.	7.72	At 1.25 chains, mouth of gulch, course S.
N. 87 1/2° E.	7.15	
S. 75 1/2° E.	11.48	At 9.50, a Mexican house, bears N. 2.00 chains distant.
		At 10.50 mouth of creek, course S.W.
N. 86 1/2° E.	3.27	To meander corner to fractional sections 31 and 32.
		Land, broken and rough.
		Soil, fourth rate.
		No timber.

Thence in Section 32.

Var. 14°36' East.

Subdivisions T.1 S., R.16 W., S.B.M.

S. 84½°E 3.50
S. 71 3/4°E. 10.70
S. 64½°E 5.50
N. 45½°E. .58

To corner No. 1 on boundary of Rancho Boca de Santa Monica, which is a post set firmly in the ground, marked B.S.M.1 on SE. and B.M. on SW. faces, with a stone mound in good order but covered with sand.
Land, broken and rough.
Soil, fourth rate.
No timber, no undergrowth.

December 6, 1895.

GENERAL DESCRIPTION.

The land in this fractional township is generally rough, broken and mountainous, with third rate soil, sloping generally toward the Pacific Ocean, on its south boundary. It is well watered by Tuna, Tarapa and Topanga Creeks and several other streams.
Road and trails cross the township in various directions. There are houses in sections 5, 7, 8 and 31 and cultivated land in sections 30, 31, 7, 8 and 12.

Subdivisions T.1 S., R.17 W., S.B.M.

Meanders of Mateo Creek

Course Chains

Thence up Mateo Creek in section 35.

Var. 14°30' East.

Subdivisions T.1 S., R.17 W., S.B.M.

Meanders of Mateo Creek.

Course	Chains	
N. 36 $\frac{1}{2}$ °W.	11.82	To stone set firmly in the ground, marked F.H.R.1.
N. 4 $\frac{1}{2}$ °W.	7.40	To stone set firmly in the ground, marked F.H.R.2.
N. 25°W.	4.95	To stone set firmly in the ground, marked, F.H.R.3.
N. 14°E.	2.94	To stone set firmly in the ground, marked F.H.R.4.
N. 46 $\frac{3}{4}$ °E.	5.93	To stone set firmly in the ground, marked F.H.R.5.
N. 55 $\frac{1}{2}$ °W.	3.48	To stone set firmly in the ground, marked F.H.R.6. Junction of the gulch from the NE.
N. 5 $\frac{3}{4}$ °W.	1.50	To stone set firmly in the ground, marked F.H.R.7.
N. 11°E.	4.43	To mound of stone, No mark.
N. 18°E.	3.50	To stone set firmly in the ground, marked F.H.R.9.
N. 68 $\frac{1}{2}$ °W.	7.42	To stone set firmly in the ground, marked F.H.R.10.
N. 6°E.	1.50	To <u>post</u> set firmly in the ground, marked F.H.R.11.
N. 29 $\frac{1}{2}$ °E	4.46	To stone set firmly in the ground, marked F.H.R.12.
N. 31°W.	5.95	At 1.85 to a point 56 links west of witness corner to closing corner to sections 26 and 35 and the end of the course is at No. 2 on Boundary of Topango Malibu Sequit previously described.

Land, mountainous; soil, third rate.

Subdivisions T.1 S., R.17 W., S.B.M.

Meanders of Mateo Creek.

Scattering oak and sycamore timber and dense undergrowth of chaparral.
I carefully examined the adjustment of my solar compass today
particularly the latitude and reversing apparatus and found them correct.

November 27, 1895.
