

Copied from Photographic
 Copies furnished by U. S. General
 Land Office, Washington, D. C.

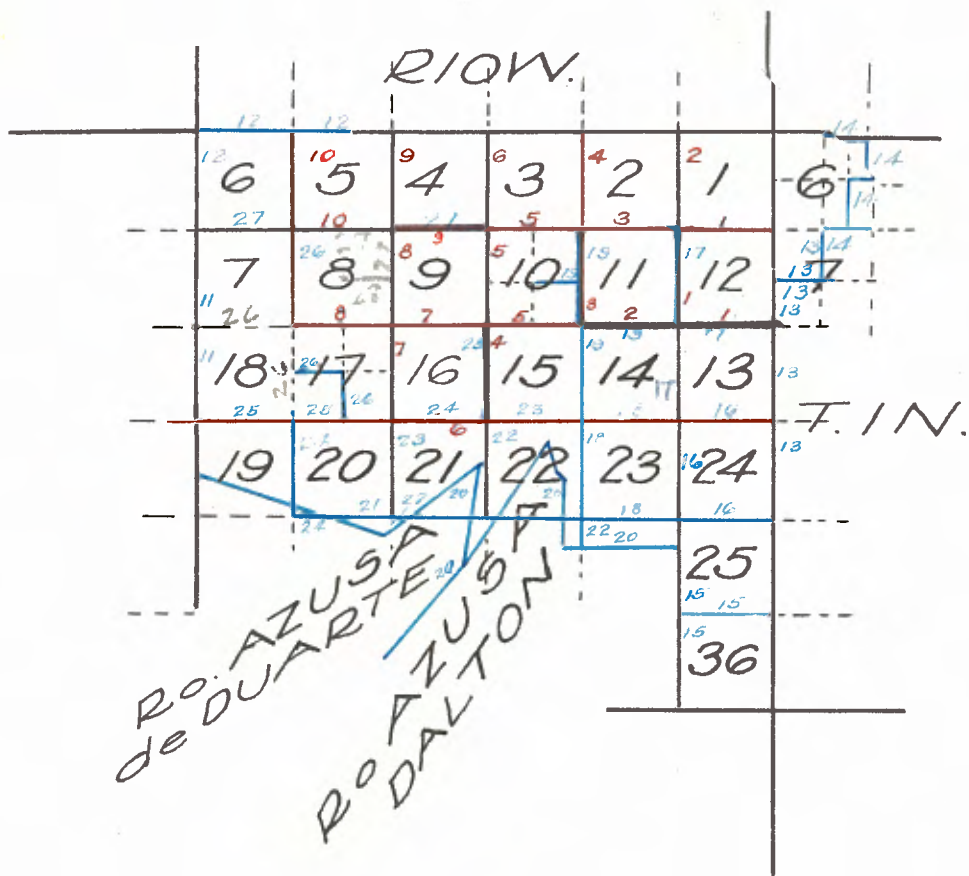

S. 9242 & 9253

Note,

Red, - G.W. Pearson 1884

Blue, - W.H. Norway -1875

T. 1 N., R.10 W., S. B. M.

From the established corner to Sections 11-12-13 & 14, which is an Oak post greatly decayed in remains of old earth mound with signs of pits.

I rebuild corner by setting Oak post 4x4 ins. $3\frac{1}{2}$ ft. long, 12 ins. in ground.

Corner to sections 11-12-13-14 marked T.1 N. S. 12 on N.E. R.10 N.S. 13 on S.E.

Section 14 on S.W. and Section 11 on the N.E. face and dug pits and rebuilt earth mound around post.

Thence I run North
between Sections 11-12-
retracing 60 chains.

Var. $14^{\circ} 29'$ East.

Ascending.

40.00 After diligent search being unable to find $\frac{1}{4}$ section corner I set post 4x4 ins. $3\frac{1}{2}$ ft. long 12 ins. in the ground and deposited marked stone for $\frac{1}{4}$ section corner marked $\frac{1}{4}$ on West face and raised mound of stone alongside. Pits impracticable.

60.00 Unable to find witness corner.

61.50 Summit of ridge bears N. 60° W. and S. 60° East

And Descend.

80.00 Set granite stone 16x11x10 ins. 11 ins. in the ground for corner to sections 11-12 marked with 5 notches on the S. and 1 notch on the E edges and raised mound of stone alongside.

Pits impracticable.

Land mountainous.

Soil 3rd rate.

Timber scat. Pine & Oak.

Dense undergrowth of Chaparral.

East on a random line between Sections 1-12

Var. $14^{\circ} 29'$ East

40.00 After diligent search being unable to find $\frac{1}{4}$ section corner I set a temporary $\frac{1}{4}$ Section corner.

79.90 Intersect East boundary of township at 26 links.

South of corner to Sections 1-6-7 and 12.

Thence I run

S. of $89^{\circ} 49'$ West on a true line between Sections 1-12 with same variation.

Ascending.

22.50 Summit of high ridge bears N.W. and S.E.

Descend.

39.95 Set granite stone 13x9x7 ins. 8 ins. in the ground for $\frac{1}{4}$ section corner.

Marked $\frac{1}{4}$ on N. face and raised mound of stone alongside.

Pits impracticable.

61.50 Gulch 20 links wide course S.E.

Ascend.

79.90 The corner to sections 1-2-11-12.

Land mountainous.

Soil 3rd rate.

Timber none.

Dense undergrowth of Chaparral.

T. 1 N., R. 10 W., S. B. M.

North on a random line between Sections 1-2
Var. 14°29' East

- 40.00 Set temporary $\frac{1}{4}$ Sec.cor
80.10 Intersect North boundary of township 15 links East of the
corner to sections 1-2-35-36.
Thence I run
S. 0°6' East on a true line between Sections 1-2 with same
variation.
Descending.
21.56 Head of Gulch course N. 60° East.
Ascend.
38.50 Summit of divide bears E. & W.
Descend.
40.10 Set granite stone 14x11x9 ins. 9 ins. in the ground for $\frac{1}{4}$ Sec-
tion corner marked $\frac{1}{4}$ on West face and raised mound of stone
alongside.
Pitts impracticable.
59.00 Head of Gulch course S.E.
Ascend.
80.10 The corner to Sections 1-2-11-12
Land mountainous.
Soil 3rd rate.
Timber scattering Pine and Oak.
Dense undergrowth of Chaparral.

From the established corner to Sections 11-12-13-14
I run West on a random line between 11-14 retracing
Var. 14° 29' East

- 40.00 After diligent search being unable to find old corner I set
temporary $\frac{1}{4}$ section corner.
80.11 Intersect N. & S. line 31 links N. of corner to sections 10-
11-14-15 which is part of decayed port.in mound of rocks.
I rebuilt corner by setting a granite stone 14x11x6 ins. 9
ins.in the ground for corner to sections 10-11-14-15 marked
with 4 notches on S. & 2 notches on E. edges and rebuilt
mound of rocks alongside.
Thence I run
N 89° 47' East on a true line between sections 11-14 with same
variation,
Ascending.
6.20 Summit of low ridge bears N. 40° East and S. 40° W.
Descend.
13.60 Gulch 60 lks.wide course S.
Ascend.
40.06 Set granite stone 16x11x9 ins. 11 ins. in the ground for $\frac{1}{4}$
section corner marked $\frac{1}{4}$ on N. face and raised mound of stone
alongside.
Pitts impracticable.
50.00 Low point of spur bears S.
Descend.
72.00 Gulch 40 lks.wide, course S.E.
Ascend.
80.11 The corner to Sections 11-12-13-14.
Land mountainous.
Soil 2nd Rate.

T. 1 N., R. 10 W., S. B. M.

Timber none.
Dense undergrowth of Chaparral.

From the corner to Sections 10-11-14-15
I run North between Sections 10-11 retracing 40 chains
Var. 14° 29' East.

- 40.00 Ascending.
After diligent search being unable to find old corner I set
granite stone 13x12x8 ins. 8 ins. in the ground for $\frac{1}{4}$
section corner marked $\frac{1}{4}$ on W. face, and raised mound of stone
alongside.
- 80.00 Pits impracticable.
Set granite stone 19-10-4 ins. 14 ins. in the ground for
corner to sections 2-3-10-11 marked with 5 notches on the S.
and 2 notches on the E. edges, and raised mound of stone along-
side.
Pits impracticable.
Land mountainous.
Soil 3rd Rate.
Timber none.
Dense undergrowth of Chaparral.
-

East on a random line between Sections 2 & 11.
Var. 14° 29' East.

- 40.00 Set temporary $\frac{1}{4}$ Sec.cor.
80.30 Intersect N. & S. line 47 links N of corner to Sections 1-2-
11-12;
Thence I run
N 89° 40' West on a true line between Sections 2-11-
With same variation
Ascend
- 19.50 Top of ridge bears N. & S.
Descend.
- 40.15 Set granite stone 12x9x8 ins. 7 ins. in the ground $\frac{1}{4}$ section
corner marked $\frac{1}{4}$ on N. face and raised mound of stone alongside.
Pits impracticable.
- 55.00 Gulch 30 links wide, course S.
Ascend.
- 71.50 Top of ridge bears N. 15° W. & S. 15-0 East.
Descend.
- 80.30 The corner to sections 2-3-10-11.
Land mountainous.
Soil 3rd rate.
Timber scattering.
Pine-Oak in Gulches.
Dense undergrowth of Chaparral.
-

T. 1 N., R. 10 W., S. B. M.

- North on a random line between Sections 2-3.
Var. 14° 29' East.
- 40.00 Set temporary $\frac{1}{4}$ Section corner
80.31 Intersect North boundary of Township 30 links West of corner
to Section 2-3-34-35.
Thence I run
S 0° 73' West in a true line between Sections 2 and 3 with
same variation.
Ascend.
- 39.00 Summit of ridge bears E. & W.
Descend.
- 40.31 Set sand stone 14x9x8 ins. 9 ins. the ground for $\frac{1}{4}$ section
corner marked $\frac{1}{4}$ on W. face, and raised mound of stone along-
side.
Pitts impracticable.
- 59.50 Gulch near head course E.
Ascend.
- 70.00 Summit of ridge bears N. 20° W. & S. 20 East.
Descend.
- 80.31 The corner to Sections 2-3-10-11-
Land mountainous.
Soil 3rd Rate.
Timber none.
Dense undergrowth of Chaparral.
April 14th, 1884.
-
- From the established corner to Sections 15-16-21-22, which is
a post 4x4 ins. marked T. 1 N. Section 15 on N.E. R. 10 W.,
Section 22 in S.E. Section 21 on the S.W. and Section 16 on
N. E. faces with large mound of rocks around post.
I run North between Sections 15 and 16, retracing 40 chains.
Var. 14° 29' East.
- Descending.
- 21.50 Gulch 50 links wide.
Course N. E.
Ascend.
- 40.00 After diligent search being unable to find old corner
I set sand stone 19x12x8 ins. 14 ins. in the ground for $\frac{1}{4}$ sec-
tion corner marked $\frac{1}{4}$ on W. face and raised mound of stone
alongside.
Pitts impracticable.
- 50.00 Summit of ridge bears North 50° W. and S. 50° E.
Descend.
- 65.50 Ravine 40 lks. wide course E.
Ascend.
- 80.00 Set granite stone 16x12x9 ins. 11 ins. in the ground for corner
to Sections 9-10-15-16 marked with 4 notches on the S. and 3
notches on the East edge and raised mound of stone alongside.
Pitts impracticable.
Land mountainous.
Soil 3rd Rate.
Timber scattering Pine & Oak in ravines.
Dense undergrowth of Chaparral.
-

T. 1 N., R. 10 W., S. B. M.

East on a random line between Sections 10 & 15.
Var. 14° 29' East.

- 40.00 Set temporary $\frac{1}{4}$ Sec. cor.
80.40 Intersect N. & S. line 46 lks. N of corner to Sections.10-11-14-15.
Thence I run N.89° 40' West on a true line between Sections 10-15 with same var.
Descend.
7.50 Gulch 20 links wide, course S.
Ascend.
17.50 Point of spur bears South.
Descend.
30.00 Ravine 45 links wide course S. E.
Ascend.
40.20 Set sand stone 16x11x5 ins. 11 ins. in the ground for $\frac{1}{4}$ section corner marked $\frac{1}{4}$ on N. face, and raised mound of stone alongside.
Pitts impracticable.
63.50 Top of ridge bears N. W. & S.E.
Descend.
80.40 The corner to sections 9-10-15-16
Land mountainous.
Soil 3rd rate.
Timber Pine & Oak in ravines.
Dense undergrowth of Chaparral.

North between Sections 9-10.
Var. 14°29' East.

- Descend.
35.00 Ravine 10 links wide near head.
Course south west.
Ascend.
40.00 Set post 4x4 ins. 3 $\frac{1}{2}$ ft. long 12 ins. in the ground and deep marked stone for $\frac{1}{4}$ Section corner marked $\frac{1}{4}$ S on W face and raised mound of rocks around post.
Pitts impracticable.
60.00 Summit of high ridge bears S.W.
Descend.
80.00 Set post 4x4 ins. 4 ft. long 8 ins. in the ground and deep marked stone for corner to Sections 3-4-9-10 marked T. 1 N. Section 3 on N.E. R. 10 W. Section 10 on S.E. Section 9 on the S.W. and Section 4 on N.W. with 3 notches on E. and 5 notches on S. edges - faces and raised mound of stone around post.
Pitts impracticable.
Land mountainous.
Soil 3rd rate.
Timber Pine & Oak in ravines.
Dense undergrowth of Chaparral.

East on a random line between Sections 3-10
Var. 14° 29' East.

- 80.00 After diligent search being unable to find corner-
Intersect N. & S. line 18 links S. of corner to Sections 2-3-10-11;

T. 1 N., R. 10 W., S. B. M.

Thence I run S. $89^{\circ} 52'$ West on a true line between Sections 3-10 with same var.

Ascend.

25.00 Ridge bears N. and S.

Descend.

40.00 Set granite stone $11 \times 11 \times 8$ ins. 6 ins. in the ground for $\frac{1}{4}$ Section corner marked $\frac{1}{4}$ on N. face and raised mound of stone alongside.

Pitts impracticable.

58.50 Gulch near head course S.E.

Ascend.

80.00 The corner to Sections 3-4-9-10

Land mountainous.

Soil 3rd rate.

Lumber none.

Dense undergrowth of Chaparral.

North on a random line between Sections 3-4
Var. $14^{\circ} 29'$ East.

40.00 Set temporary $\frac{1}{4}$ Sec. cor.

80.43 Intersect North boundary of township 19 links W. of corner to Sections 3-4-33-34

Thence I run

S. $0^{\circ} 8'$ West in a true line between Sections 3-4 with same variation.

Ascend.

8.60 Summit of ridge bears N. W. and S.E.

Descend.

31.50 Head of ravine course W.

Ascend.

40.43 Set granite stone $15 \times 11 \times 14$ ins. 20 ins. in the ground for $\frac{1}{4}$ Section corner marked $\frac{1}{4}$ on W. face and raised mound of stone alongside.

Pitts impracticable.

47.50 Summit of divide bears N. 80° E. & S. 80° W.

Descend.

80.43 The corner to Sections 3-4-9-10.

Land mountainous.

Soil 3rd Rate.

Timber none.

Dense undergrowth of Chaparral.

April 5th, 1884.

From corner to Sections 15-16-21-22

I run West on a random line between Sections 16-21, retracing.

Var. $14^{\circ} 29'$ East.

40.00 After diligent search being unable to find corner I set temporary $\frac{1}{4}$ Sec. cor.

80.06 Intersect N. & S. line 11 links S. of corner to Sections 16-17-20-21, which is a sand stone $22 \times 13 \times 10$ ins. firmly set in ground marked with 3 notches on the S. and 4 notches on the East edges 7 in large mound of rocks.

T.1 N., R. 10 W., S. B. M.

- Thence I run
S. 89° 55' East on a true line between Sections 16-21 with
same variation.
Descend.
- 11.50 Gulch 14 links wide, course S.
Ascend.
- 40.03 Set sand stone 17x12x4 ins. 12 ins. in the ground for $\frac{1}{4}$ sec-
tion, corner marked $\frac{1}{4}$ on N. Face and raised mound of stone
alongside.
Pitts impracticable.
Top of ridge bears N. & S.
Descend.
- 80.06 The corner to Sections, 15-16-21-22.
Land mountainous.
Soil 3rd Rate.
Timber none.
Dense undergrowth of chaparral.
-
- From the established corner to Secs. 16-17-20-21
I run North between Sections 16-17
Var. 14° 29' East.
- 40.00 Ascend along West slope of ridge.
I set sand stone 16x9x8 ins. 11 ins. in the ground for $\frac{1}{4}$
Section corner marked $\frac{1}{4}$ on West face, and raised mound of
stone alongside.
Pitts impracticable.
- 80.00 Set granite stone 12x10x5 ins. 7 ins. in the ground for corner
to Sections 8-9-16-17, marked with 4 notches on S. & E. edges,
and raised mound of stone alongside.
Pitts impracticable.
Land mountainous.
Soil 3rd rate.
Timber none.
Dense undergrowth of Chaparral.
-
- East, on a random line between Sections 9-16.
Var. 14° 29' East.
- 40.00 Set temporary $\frac{1}{4}$ Section cor.
79.84 Intersect N. & S. line 27 links S. of corner to Sections
9-10-15-16.
Thence I run
S. 89° 48' West on a true line between Sections 9-16 with same
variation.
Descend.
- 19.65 Ravine 20 lks. wide, course S. 5° West.
Ascend.
- 32.50 Summit of ridge bears N. & S.
Descend.
- 39.92 Set granite stone 18x13x5 ins. 13 ins. the ground for $\frac{1}{4}$ section
corner marked $\frac{1}{4}$ on N. face and raised mound of stone alongside.
Pitts improved.
- 65.00 Gulch 45 links wide, course S. 10° East.
Ascend.
- 74.30 Summit of ridge bears N. 10° W. & S. 10° E.
Descend.

T. 1 N., R. 10 W., S. B. M.

79.84 The corner to Section 8-9-16-17
Land Mountainous.
Soil 3rd Rate.
Timber scattering.
Pine and Oak in ravines.
Dense undergrowth of Chaparral.

West on a random line
Between Sections 8-17
Var. 14° 29' East.

40.00 Set temporary $\frac{1}{4}$ Sec. cor.
80.15 Intersect N. & S. line 34 links N. of corner to Sections 7-
8-17-18, which is part of decayed post in mound of rocks
partially destroyed. I rebuilt corner by setting sand stone
17x10x8 ins. 12 ins. in the ground for corner to sections 7-
8-17-18 and marked with 4 notches on the S. and 5 notches
on the East edges -- and raised stone mound around.
Thence I run
North 89° 45' East on a true line between Sections 8-17
with same variation.
Ascend.
17.50 Top of ridge bears N. & S.
Descend.
32.00 Ravine 60 links wide.
Course S. 30° East.
Ascend.
38.00 Top of ridge bears N. W. & S. E.
Descend.
40.08 Set sand stone 12x11x9 ins. 7 ins. in the ground for $\frac{1}{4}$ section
cor. marked $\frac{1}{4}$ on N. face and raised mound of stone alongside.
Pitts impracticable.
68.00 Gulch 20 links wide, course south.
Ascend.
80.15 The corner to Sections 8-9-16-17.
Land mountainous.
Soil 3rd rate.
Undergrowth scattering Chaparral.
Lumber scattering Pine and Oak in ravine.

North between Sections 8-9, retracing 40 chains.
Var. 14° 29' East.

Ascend.
40.00 After diligent search being unable to find old corner
I set a sand stone 17 x 11 x 8 ins. 12 ins. in the ground
for $\frac{1}{4}$ section corner marked $\frac{1}{4}$ on West face, and raised mound
of stone alongside.
Pitts impracticable.
80.00 After diligent search being unable to find corner I set granite
stone 19x12x10 ins. 14 ins. in the ground for corner to Sections
4-5-8-9, marked with 5 notches on the South and 4 notches on the
East edges, and raised mound of stone alongside.
Pitts impracticable.
Land mountainous.
Soil 3rd Rate.
Timber none.
Dense undergrowth of Chaparral.
April 7th, 1884.

T. 1 N., R. 10 W., S. B. M.

East, on a random line between
Sections 4-9

Var. 14° 29' East.

- 40.00 Set temporary $\frac{1}{2}$ Sec. Cor.
79.90 Intersect N. & S. line
25 links N. of corner to
Sections 3-4-9-10.
Thence I run,
N. 89° 49' West on a true line between Sections 4-9
with same variation.
Ascend.
38.50 Summit of ridge bears N. & S.
Descend.
39.95 Set granite stone 21 x 16 x 10 ins. 16 ins. in the ground for
 $\frac{1}{4}$ section corner marked $\frac{1}{4}$ on N. face, and raised mound of stone
alongside.
Pitts impracticable.
52.50 Head of ravine, course S.
Ascend.
69.00 Summit of ridge
Bears N. & S.
Descend.
79.90 The corner to Sections 4-5-8-9
Land mountainous.
Soil 3rd rate.
Timber none.
Dense undergrowth of Chaparral.

North on a random line between Sections 4-5.

Var. 14° 29' East.

- 40.00 Set temporary $\frac{1}{4}$ Sec. Cor.
80.54 Intersect North boundary of township 29 links West of corner
to Sections 4-5-32-33
Thence, I run
S. 0° 12' West on a true line between Sections 4-5 with same
variation.
Ascend.
40.00 Summit of divide bears N. 15° W. and S. 15° East
Thence along summit
40.54 Set gray granite stone 19x11x18 ins. 14 ins. in the ground for
 $\frac{1}{4}$ Section corner marked $\frac{1}{4}$ on West face and raised mound of
stone alongside.
Pitts impracticable
70.00 Leave summit, and
Descend.
80.54 The corner to Sections 4-5-8-9
Land mountainous.
Soil 3rd Rate.
Timber none.
Dense undergrowth of Chaparral.
-

T. 1 N., R. 10 W., S. B. M.

West on a random line
Between Sections 5-8
Retracing.

Var. 14° 29' East.

- 40.00 After diligent search being unable to find old corner.
Set temporary $\frac{1}{4}$ Sec. Cor.
- 80.47 Intersect N. & S. line at 53 links N. of corner to
Sections 5-6-7-8, which is end of burnt post in mound of rocks.
The bearing tree having been destroyed by fire.
I rebuilt corner by setting granite stone
16x11x9 ins. 11 ins. in the ground for corner to
Sections 5-6-7-8 marked with 5 notches on S. and E. edges,
and rebuilt stone mound around.
Thence, I run,
N. 89° 37' East, on a true line between
Sections 5-8, with same variation.
Ascend along N. slope of Mts.
- 40.23 Set granite stone 16x11x5 ins. 11 ins. in the ground for $\frac{1}{4}$
Section corner, marked 114 on N. face and raised mound of
stone alongside.
Pitts impracticable.
- 63.00 Summit of ridge, bears N.E. and S.W.
Thence along S. slope of divide.
- 80.47 The corner to Sections 4-3-8-9- *from Sec 5*
Land mountainous.
Soil 3rd rate.
Timber none.
Dense undergrowth of Chaparral.

From the corner to Sections 5-6-7-8- I run North on a random
line between Sections 5-6.
Retracing.

Var. 14° 29' East.

- 40.00 After diligent search being unable to find old corner
Set temporary $\frac{1}{4}$ Sec. Cor.
- 80.42 Intersect North boundary of township 50 links west of corner
to Sections 5-6-31-32.
Thence, I run,
S. 0° 21' West, on a true line between Sections 5-6, with same
variation.
Descend.
- 23.00 Gulch 50 links wide,
Course S.W.
Ascend.
- 40.42 Set Granite stone 17x11x9 ins.
12 ins. in the ground for $\frac{1}{4}$ Section Corner, marked
 $\frac{1}{4}$ on N. fence,
and raised mound of stone alongside.
- Pitts impracticable.
- 58.00 Summit of ridge bears E. & W.
Descend.

T. 1 N., R. 10 W., S. B. M.

74.00 Gulch 30 links wide,
Course S. 60° West.
80.42 The corner to Sections 5-6-31-32
Land mountainous.
Soil 3rd rate.
Timber none.
Dense undergrowth of Chaparral.
April 8th, 1884.

General Description

This Township contains mountain land and as this the Northern part, the soil ranges from 2nd to 3 rate. Some pine and oak is found in the ravines, and in the extreme northeastern part. The township is well watered by San Gabriel River, and its tributaries in the East and Sawpitt Creek in the West. It is generally valuable for its water and timber.

Field notes of the exterior boundaries of Tp. 1 N. R. 10 W. of San Bernardino Base & Mer. State of Cal. Surveyed by Wm.H.Norway, Dep.Surveyor, under contract with Jas. T. Stratton, U.S.Surveyor Genl. for Cal.
Dated July 31st, 1875.

From the established cor. to Secs. 18,19, 13 & 24 on the W. bound. of Tp. I run,
North, on W. bound. of Sec. 18.
Va. $14\frac{1}{4}^{\circ}$ East.

Ascending over high hills.
40.00 Set redwood post 3x3 in. $3\frac{1}{2}$ ft.long in rock Md.as instructed for $\frac{1}{4}$ Sec.Cor.
50.00 Summit of ridges, E. & W. and
Descend.
70.00 J.M.Butlers house about 3.00 chs. E.
71.50 Cross same pit, Creek 10 lks. wide,
Course W.
80.00 Set Oak post 4x4 in. $3\frac{1}{2}$ ft.long in Md.of rocks as instructed in side hill facing S. for cor.to Secs. 7,12,13, & 18, from which a gray granite rock 4 ft. cube bears N. 86° E., 22 lks. dist.
Land rough, 1st & 2nd rate, N. $\frac{1}{2}$; S $\frac{1}{2}$ 3rd rate.

North, on West boundary of Sec. 7.

Ascending high hills. Va. $14\frac{1}{4}^{\circ}$ E.
40.00 Set an Oak Post 3x3 in. $3\frac{1}{2}$ ft.long in Md.of earth & pits as instructed for $\frac{1}{4}$ Sec.Cor.

T. 1 N., R. 10 W., S. B. M.

80.00 Set redwood post 4x4 in. $3\frac{1}{2}$ ft. long in Md. of rocks on side hill facing N.E. as instructed for cor. to Secs. 1, 6, 7, & 12.
Land rough, soil mostly 2nd rate. Timber Live Oak & Redwood poles under bush chamisal.

North on W. boundary of Sec. 6th.
Va. $14\frac{1}{4}$ E.

26.50 Cross a gulch 50 lks. wide. Co. S.E.
40.00 Set an Oak post 4x4 in. 3 ft. long in Md. of earth & pits as instructed for $\frac{1}{4}$ Sec. cor. thence ascend abrupt. side hills.
80.00 Set Spruce post 6x6 in. 4 ft. long in Md. of rocks on S.E. slope of high mountains as instructed for cor. to Townships 1 & 2 N.
Ranges 10 & 11 W.
Land very rough along line, timber Oak & Fir in canadas, 2nd & 3rd rate soil.
The Northern boundary of this Tp. can only be run part way. I therefore run it a true line E.

East in true line on northern boundary of Sec. 6.
Va. $14\frac{1}{4}$ E.

Descending.
28.50 Cross dry gulch, near head 20 lks. wide. Co. S.E. thence ascend.
40.00 Set Redwood post 3x3 in. 3 ft. long in a Md. of rocks as instructed for $\frac{1}{4}$ Sec. cor. from which
A gray granite rock 10 ft. cube bears S. $70\frac{1}{2}$ E. 1.25 chs. dist.
80.00 Set Granite rock 10x16x24 in. in Md. of rocks as instructed for cor. to Secs. 5, 6, 31 & 32.
Land very rough with timber in Canadas Oak & scattering Fir and Pine.

East on true line on N. bound. of Sec. 5.
Va. $14\frac{1}{4}$ E.

40.00 Along on S. slope of high Mts.
Set granite rock 10x16x20 in. in Md. of rocks, a steep side hill facing S. as instructed for $\frac{1}{4}$ Sec. cor.
The land is too rough & worthless to run further E. or S. from this point.
I close the survey in this direction.
Land rough, 2nd rate.
Some timber.
Township 2 N. R. 10 W. is rough and broken. Mts. with some timber in Canada but too rough country to make the timber available.
Nov. 24th, 1875.
From the established cor. to Secs. 24, 25, 19, & 30 on the E. bound. of Tp.
I run,

T. 1 N., R. 10 W., S. B. M.

North on East bound. of Sec. 24.

Va. $14\frac{1}{4}^{\circ}$ E.

Ascending on high hills.

- 4.50 A spring 75 lks. E. of line.
8.50 Cross dry gulch 50 lks wide. Co. S.W. at the junction of
another gulch coming from the N.W.
40.00 Set an Oak post 3×3 in. 3 ft. long in Md. of earth & pits as
instructed for $\frac{1}{4}$ sec.cor. from which,
A Redwood tree 6 in.dia. bears N. 42° E. 18 lks.dist.
71.00 Summit of high Spur Co. S.W. & N.E. &
Descend.
80.00 Set Oak post 4×4 in. $3\frac{1}{2}$ ft.long in Md. of rocks as instructed
on steep side hill facing N. for cor. to Secs. 13,18, 19,24.
Land high broken Mts.
2nd & 3rd rate soil, Timber, Live Oak.
Some fir scattering.
-

North on E. bound. of Sec. 13.

Va. $14\frac{1}{4}^{\circ}$ E.

Descend.

- 40.00 The point for $\frac{1}{4}$ Sec.cor.falling in deep gulch Co.W. not suitable
place to build a monument.
I continue and at
42.50 Set an oak post 3×3 ins. 3 ft. long in Md. of rocks as instructed
for witness to $\frac{1}{4}$ Sec.cor.
from which
A oak tree 10 in. dia.bears S. 10 W. 1.07 lks.dist.
76.50 Summit of hill and descend.
78.50 Enter valley of San Gabriell River.
80.00 Set a Sycamore post 4×4 in. $3\frac{1}{2}$ ft.long in Md.of rocks as instructed
for cor.to Secs. 7, 12, 13 & 18, from which
A live oak 16 in.dia. bears S. 32° W. 1.95 chs.dist.
A Red Oak 18 in.dia.bears S. $48\frac{1}{2}^{\circ}$ E. 3.23 chs.dist.
Land, rough, 2nd rate; Timber, Live Oak and Sycamore.
Nov. 25th, 1875.
-

North, on East bound. of Sec. 12.

Va. $14\frac{1}{2}^{\circ}$ E.

- 7.00 Cross San Gabriel river 50 lks.wide. Co. W.
16.50 Leave valley or river bottom and ascend steep mountain side.
32.50 Summit of ridge Co.E. & W. and descend.
38.00 Cross short gulch, Co. S.E. and ascend.
40.00 Set an Oak post 3×3 in. 3 ft. long in Md.of rocks as instructed for
 $\frac{1}{4}$ sec.cor. on ridge facing E.
48.50 Cross ravine near head course S.E. and ascend.
60.00 Not being able to run further N. or E. in this direction, I set
A Oak post 3×3 in. $3\frac{1}{2}$ ft.long in Md.of rocks as instructed for
 $\frac{1}{8}$ Sec.cor. and return S. to $\frac{1}{4}$ Sec. bet. Secs. 12 & 7 bet.ranges
9 & 10, and run an offset line through T. 1 N., R. 9 W., East
through Sec. 7 on $\frac{1}{4}$ Sec.
Va. $14\frac{1}{4}^{\circ}$ E.
20.00 Enter canada of San Gabriel Co. S.W.
29.50 Leave valley in canada and ascend.
40.00 The point for $\frac{1}{4}$ Sec.cor.center of Sec.7 falling on steep hill
side not suitable place to build a monument, I set
A Sycamore post 4×4 in. 3 ft.long in Md.of rocks, as instructed
6.64 chs. N. for witness to $\frac{1}{4}$ Sec.center of Sec. 7 from which
A sycamore tree 12 ins.dia.bears S. $48\frac{1}{4}^{\circ}$ W.88 lks.dist;
thence North, through center of Sec. 7 on $\frac{1}{4}$ Sec.line.
Va. $14\frac{1}{4}^{\circ}$ E.
-

T. 1 N., R. 10 W., S. B. M.

6.64 Witness post leave mountain & enter canada San Gabriel.
21.50 To water in San Gabriel river co. S.W.
22.10 Over same.
34.00 Cross gulch & ascend.
40.00 Set Sycamore post 3x3 in. 3 ft. long in Md. of rocks on steep side hill facing S. as instructed for $\frac{1}{4}$ Sec. cor. bet. Secs. 6 & 7. Mountainous land, timber Live Oak, Sycamore & Cottenwood.

East, bet. Secs. 6 & 7 from $\frac{1}{4}$ Sec. cor.
Va. $14\frac{1}{4}^{\circ}$ E.

6.50 Enter Valley of San Gabriel River Co. S.W.
12.34 To right bank of San Gabriel river.
13.50 Over same co. S.W.
25.50 Leave valley of San Gabriel & ascend.
40.00 Set Sycamore post 4x4 in. 3 ft. long in Md. of rocks on steep hill side facing W. as instructed for cor. to Sec. 5, 6, 7 & 8. Land 2nd 3rd rate, Timber Live Oak, Sycamore & Cottenwood. The land is too rought to run N. or E. from this point I run,

West, 20.00 chs. & set a sycamore post 3x3 in. 3 ft. long in Md of rocks as instructed for $\frac{1}{8}$ Sec. cor. from which

A sycamore 12 in. dia. bears N. $3\frac{3}{4}^{\circ}$ E. 1.45 chs. dist.

North through $E\frac{1}{2}$ of Sec. Con $\frac{1}{8}$ line.
Va. $14\frac{1}{4}^{\circ}$ E.

5.50 Leave valley & ascend point of hill
21.50 Leave hill & enter Valley Co. E. & W.
31.00 Leave valley & ascend.
40.00 Set an Oak post 3x3 in. $3\frac{1}{2}$ ft. long in Md. of rocks on side hill facing N.E. as instructed for $\frac{1}{8}$ Sec. cor. thence, East on $\frac{1}{4}$ Sec. cor. in Sec. 6.
Va. $14\frac{1}{4}^{\circ}$ E.

14.00 Leave hill & enter river bottom. Co. N.W. & S.E.
20.00 Set Sycamore post 3x3 in. 3 ft. long in Md. of rocks on right bank of San Gabriel river as instructed for $\frac{1}{4}$ Sec. cor. bet. Secs. 5 & 6 from which
A sycamore tree 24 in. dia. bears S. 85° W. 2.13 chs. dist.
A live oak tree 24 in. dia. bears N. $15\frac{1}{2}^{\circ}$ W. 2.13 chs. distant.
Land rough, timber Oak, Sycamore & Cottenwood.

North, bet Secs. 5 & 6 from $\frac{1}{4}$ Sec. cor.
Va. $14\frac{1}{4}^{\circ}$ E.

13.00 Cross San Gabriel river 80 lks. wide Co. S.E.
15.00 Leave valley & Ascend.
40.00 Set an Oak post 4x4 in. $3\frac{1}{2}$ ft. long in Md. of rocks as instructed for cor. to Secs. 5, 6, 31 & 32 on the N. bound of Tp.
Land rough, timber scattering.
Sycamore & Cottenwood.
In order to establish the cor. to Tp. 1 & 2 N. R. 9 & 10 W, I run, West on N. bound. of Sec. 6th
Va.

28.00 Enter valley of San Gabriel river Co. N. & S.E.
35.50 San Gabriel river 50 lks wide. Co. S.E.

T. 1 N., R. 10 W., S. B. M.

37.00 To the foot of a large rocky bluff finding it impracticable to run further on this line or get back to the range line, I set A Sycamore post 4x4 in. 3 ft. long in Md. of rocks as instructed for witness to $\frac{1}{4}$ Sec.cor. from which
An Alder tree 6 in.dia. bears S. 84° E. 39 lks. dist.
An Alder tree 6 in.dia. bears N. 46° E. 27 lks.dist.
Land rough, 2nd rate.
Timber, Oak, Sycamore, Alder & Cottenwood scattering.
Nov. 26th, 1875.

Field notes of the subdivision of Tp. No. 1 N. of R. No.10 W. of San Bernardino base & Meridian by Wm. H. Norway, Dep.Surveyor under contract dated July 31st, 1875, with Jas. T. Stratton, U.S.Surveyor Gen'l for Cal.

From the cor.to Secs. 35, 36, 1 & 2, on the South bound. of Tp. on the base line the same being in the E.bound.of the Rancho Argusa, I run North, bet.Secs.35 & 36.

Va. $14\frac{1}{4}^{\circ}$ E.

40.00 Along the E.bound.of the rancho's Argusa
Set a walnut post 3x3 in. 3 ft. long in Md. of earth & pits as instructed for $\frac{1}{4}$ Sec.cor.
62.30 Cross a pole fence. Co. N. 70° E.
69.00 Casey's house about 30 lks. E. of line.
80.00 Set walnut post 4x4 in. 3 ft. long in an old Md. of rocks as instructed for cor.to Secs. 25,26,35 & 36.
Land level 1st. rate.

East on random line bet.Secs. 25 & 36.

Va. $14\frac{1}{4}^{\circ}$ E.

5.50 A house 1.75 links N. of line.
12.50 A house 80 lks. N. of line.
16.00 Cross a road. Co. NE & SW
20.50 A house 30 lks S.of line.
40.00 Set a post for temp. $\frac{1}{4}$ Sec.cor.
41.50 A house about 7.00 S. of line.
79.00 To W.bank of Canada. Co. S.
79.96 I int. the E. bound.of the Tp. at the point for cor.to Secs. 25 & 36 from this cor. I run, West, on true line bet. Secs. 25 & 36.
Va. $14\frac{1}{4}^{\circ}$ E.
39.98 Set a redwood post 3x3 in. 3 ft. long in a Md. of rock & pits as instructed for $\frac{1}{4}$ Sec.cor.
79.96 The cor. to Sec. 25,26, 35 & 36.
Land level, 1st rate soil.

North, bet Secs. 25 & 26.

East bound. Argusa Rancho.

Va. $14\frac{1}{4}^{\circ}$ E.

25.00 Foot of hill Co. E. & W. & ascend.
36.50 Summit of hill. Co. E. & W. & Descend.
40.00 Set an Oak post 3x3 in. & 3 ft. long in Md. of rocks, as instructed for $\frac{1}{4}$ Sec.cor. at the foot of hill, thence enter small valley.

T. 1 N., R. 10 W., S. B. M.

- 60.00 To corner N.E. cor. of the Rancho Argusa a stake in rock mound. I do not find any Cedar to correspond with the description furnished me.
- 63.20 Foot of high mountain & ascend.
- 78.00 Summit of ridge. Co. S.W. & N.E. & descend.
- 80.00 Set an Oak post 3x3 in. & 3 ft. long in rock Md. as instructed on steep side hill facing West. for cor. to Secs. 23, 24, 25, 26. Land mostly level 1st rate.

East, on random line bet. Secs. 24, 25.
Va. $14\frac{1}{4}$ E.

- Along foot of hills.
- 40.00 Set a post for temp. $\frac{1}{4}$ sec. cor.
- 51.50 Cross a dry gulch 50 lks. wide. Co. S.W. at junction with another gulch coming from N.W.
- 52.25 A house 50 lks N. of line.
- 80.10 Int. the E. bound. of Tp. 10 lks. S. of cor. to Secs. 24 & 25 from this cor. I run,
S. $89^{\circ}56'$ W. on true line bet. Secs. 24 & 25.
Va. $14\frac{1}{4}^{\circ}$ E.
- 40.05 Set an Oak post 3x3 in. 3 ft. long in Md. of rocks, on side hill facing E. as instructed for $\frac{1}{4}$ Sec. cor.
- 80.10 The cor. to Secs. 23, 24, 25, 26
Land mostly 1st rate. $W\frac{1}{2}$ broken.
2nd rate.

North, bet. Secs. ~~13~~ ^{23 & 24} & ~~14~~ ²⁴.
Va. $14\frac{1}{4}$ E.

- Ascending abrupt Mts.
- 40.00 Set a redwood post, 3x3 in. 3 ft. long in Md. of rocks as instructed for $\frac{1}{4}$ Sec. cor. on side hill facing S.
- 50.00 Summit of Spur cor. S.W. & E.
- 60.00 Enter valley of San Gabriel.
- 61.50 San Gabriel River 50 lks wide. Co. N.W.
- 72.50 San Gabriel River 50 lks. wide Co. S.E.
- 76.00 Enter field Co. N.W. & S.E.
- 80.00 Set Sycamore post 4x4 in. 3 ft. long in large Md. of rocks as instructed for cor. to Secs. 13, 14, 23 & 24, in center of small field
- A house bears
S 64° E. about 7 chs. dist.
Land rough with scattering timber.
2nd & 3rd rate soil.
Nov. 27th, 1875.

East on random line bet. Secs 13 & 24.
Va. $14\frac{1}{4}^{\circ}$ E.

- ? 8.00 Leave valley of San Gabriel & ascend along N. slope of Mts.
- 40.00 Set a post for temp. $\frac{1}{4}$ Sec. cor.
- 80.22 Int. E. bound. of Tp. 14 lks N. of cor. to Secs. 13 & 24 from this cor. I run,
N. $89^{\circ}54'$ W. on true line bet. Secs. 13 & 24.
Va. $14\frac{1}{4}^{\circ}$ E.
- 40.11 Set an Oak post 3x3 in. 3 ft. long in Md. of rocks as instructed for $\frac{1}{4}$ Sec. cor. on side hill sloping N.W.
- 80.22 The cor. to Secs 13, 14, 23 & 24
Land rough, mts. scattering timber.

T. 1 N., R. 10 W., S. B. M.

North, bet. Secs. 13 & 14.

Va. $14\frac{1}{4}$ E.

- 5.50 Leave river bottom & ascend.
15.50 Summit of Spur. Co. N.W. & S.E. & Descend.
24.00 Enter river bottom. Co. S.E. & S.W.
27.00 Cross river 40 lks. wide. Co. S.W. & ascend steep Mts.
40.00 Set redwood post 3x3 in. 3 ft. long in Md. of rocks as instructed for $\frac{1}{4}$ Sec. cor.
73.50 Cross dry gulch near head. 20 lks. wide. Co. S.E.
80.00 Set Oak post 4x4 in. $3\frac{1}{2}$ ft. long in Md. of earth & pits as inst. for cor. to Secs. 11, 12, 13, 14
Land very rough along line.
Scattering Oak, Sycamore & Cottenwood along river & in canadas.

East

on random line bet. Secs 12 & 13

Va. $14\frac{1}{4}$ E.

- Descend over gravel hills.
40.00 The point for $\frac{1}{4}$ Sec. cor. in steep gulch. Co. S.W.
51.00 Ft. of Mts. enter San Gabriel canon. Co. S.W. & N.E.
54.25 Cross San Gabriel river 50 lks. wide. Co. S.W. & ascend ft. of hills.
71.50 Summit of spur and descend.
76.00 Enter canada, San Gabriel Co. N.W. & S.E.
80.00 Int. the E. bound of Tp. 21 lks. N. of cor. to Secs. 12 & 13, from this cor. I run,
N. $89^{\circ} 51'$ W on true line bet. Secs 12 & 13.
Va. $14\frac{1}{4}$ E.
28.90 Set Alder post 3x3 in. 3 ft. long in Md. of Rocks on W. side of valley as inst. for witness to $\frac{1}{4}$ Sec. cor. as the true cor. will fall in deep gulch. ---- Not suitable place to build a monument from which
A Live Oak 16 in. dia. bears
N. 25° E. 36 lks. dist.
A Live Oak 8 in. dia. bears S. $42\frac{1}{2}^{\circ}$ W. 36 lks. dist.
The Winson Quartz Mill is about 10.00 chs. S.W. on W. side of river.
40.00 True point for $\frac{1}{4}$ Sec. cor. in gulch.
80.00 The cor. to Secs. 11, 12, 13 & 14.
Land mostly rough Mts.
Timber, Oak, Sycamore & Cottenwood scattering.
There are several mining claims in Secs. 13 of which the chief one is the Winson mine.

North bet. Secs. 11 & 12.

Va. $14\frac{1}{4}$ E.

- Ascend.
40.00 Set Oak post 3x3 in. 3 ft. long in Md. of earth & pits, as inst. for $\frac{1}{4}$ Sec. cor.
60.00 The ground being too rough to run further in this direction, I set a granite rock 10x16x24 in. in Md. of rocks as inst. for $\frac{1}{8}$ Sec. cor. on side hill facing S.
East on $\frac{1}{8}$ Sec. line through N. $\frac{1}{2}$ of Sec. 12.
Va. $14\frac{1}{4}$ E.
Along on South slope of high Mts.
31.50 Cross near head of gulch Co. S.
40.00 Set Oak post 3x3 in. 3 ft. long in Md. of rocks on S.W. slope of gravel hill as inst. for $\frac{1}{8}$ Sec. cor, and run,

T. 1 N., R. 10 W., S. B. M.

North, on $\frac{1}{4}$ Sec. line,

Va. $14\frac{1}{4}$ E.

20.00

Set Fir Post 3x3 in. 3 ft. long in Md of rocks, as inst. for $\frac{1}{4}$ Sec. cor. bet Secs. 1 & 12.
Land over high rolling hills, soil gravelly with good mineral indications--gold and silver.

This is as far as it is practicable to extend the survey in this direction. The Mts. to the N. are abrupt and broken with very scattering timber in canadas.

Nov. 29th, 1875.

From the cor. to Secs. 23, 24, 25, & 26, I run,
West on true line bet. Secs. 23 & 26.

Va. $14\frac{1}{4}$ E.

16.50

Cross gulch. Co. S.

40.00

Set Oak post 3x3 in, 3 ft. long in Md. of rocks on summit of ridge. Co. N.E. & S.W. as inst. for $\frac{1}{4}$ Sec. cor. thence descend

46.00

Cross ravine 50 lks. wide. Co. S.W.

50.00

Summit of Spur. Co. N. & S. & Descend.

52.00

Cross ravine Co. S. a spring about 5 chs. N.

67.00

To dry ravine.

68.00

Over same Co. S.W.

74.25

Descend steep bluff into valley of San Gabriel.

Co. N. & S.

Set Alder post 4x4 in. $3\frac{1}{2}$ ft. long in Md. of rocks as inst. for cor. to Secs. 22, 23, 26, 27.

Land along foot hills 1st and 2nd rate.

North bet Secs. 22 & 23.

Va. $14\frac{1}{4}$ E.

19.00

To edge of high rocky point too rough to measure.

West 5.00 chs. to valley, thence,

North, 15.00 Henry Roberts house west of line.

31.22 chs. to N. point of hill thence,

East 5.00 chs. to line bet. Secs. 22, 23, 10, 22. chs N. of $\frac{1}{4}$ Sec. cor. at an

Alder tree 2 ft. in dia. I mark for witness to $\frac{1}{4}$ Sec. cor. on N.E. edge of Sanja. Co. S.W., thence continue,

North, bet. Secs. 22 & 23.

50.50

Counting the dist. from cor. to Secs. 22, 23, 26, & 27, cross wagon road. Co. S.W. & N.E.

55.30

Cross San Gabriel River, 50 lks wide. Co. S.W.

62.50

Leave River W. and ascend steep side hill. Co. E. & W.

77.40

Edge of steep side hill, I set an

Alder post 4x4 in. & $3\frac{1}{2}$ ft. long in Md. of rocks as inst. for witness to cor. to Secs. 14, 15, 22 & 23 as the true cor. will fall on steep side hill not a suitable place to build a monument.

80.00

Point for cor. to Secs. 14, 15, 22, & 23.

Land along river 2nd & 3rd rate.

East, on random line bet Secs. 14 & 23.

Va. $14\frac{1}{4}$ E.

5.00

Cross dry gulch 100 lks. wide. Co. S. thence

Along N. edge of table land through field of Henry Roberts.

T. 1 N., R. 10 W., S.B.M.

- 40.00 Set post for temp. $\frac{1}{4}$ Sec.cor., thence along on S. slope of rocky hill.
- 65.00 Summit of Spur. Co. N.W. & S.E. & descend.
- 69.50 Enter valley of San Gabriel River.
- 76.00 Cross San Gabriel River. 50 lks.wide. Co. S.E.
- 77.50 Enter field. Co. N.W. & S.E.
- 80.14 Int. the N. & S. line 16 lks. N. of cor. to Secs. 13, 14, 23, 24 from this cor. I run, N. $89^{\circ} 53'$ W. on true line bet. Secs. 14 & 23.
Va. $14\frac{1}{4}$ E.
- 40.07 Set Cottenwood post 3x3 in. & 3 ft. long in Md. of rocks on side hill facing S. as inst. for $\frac{1}{4}$ Sec.cor.
- 80.14 The true cor. to Secs. 14, 15, 22, 23
Land rough, W $\frac{1}{2}$ mostly 1st rate soil.
E $\frac{1}{2}$ very rough scattering timber.

North, bet. Secs. 14 & 15.

- From true cor. on side hill, descend.
Va. $14\frac{1}{4}$ E.
- 7.00 Cross dry gulch 20 lks wide. Co. S.E. thence Descend.
- 15.31. Summit sharp peak thence along on W. slope of hill.
- 40.00 Set Sycamore post 3x3 in. & 3 ft long in Md. of rocks on W. slope of hill as inst. for $\frac{1}{4}$ sec.cor.
- 60.00 Cross gulch 50 lks.wide. Co. S.W. & ascend.
- 80.00 Set Oak post 4x4 in. 3 ft. long in Md. of rocks on side hill sloping W. as inst. for cor. to Secs. 11, 10, 14, 15.
Land rough with timber in Canadas, Oak, Sycamore, & Cottenwood.

East, on random line bet. Secs. 11 & 14.

- Summit of ridge. Co. N.E. & descend.
Va. $14\frac{3}{4}$ E.
- 6.00 Cross gulch 50 lks wide. Co. S.W. ascend.
- 13.50 Set post for temp. $\frac{1}{4}$ Sec.cor.
- 40.00 Cross near head of gulch, Co. S.E. & ascend.
- 72.50 Int. N. & S. line 26 lks. N. of cor. to Secs. 11, 12, 13, 14,
- 79.94 From this cor. I run,
N. $89^{\circ} 50'$ W. on true line bet. Secs. 11 & 14.
Va. $14\frac{1}{4}$ E.
- 39.97 Set redwood post 3x3 in. & 3 ft. long in Md. of rocks as inst. for $\frac{1}{4}$ sec.cor.
- 79.94 The cor. to Secs. 10, 11, 14, 15,
Land rough with timber in Canada: Oak, Sycamore, & Cotton.
Nov. 30th, 1875.

North, bet. Secs. 10 & 11.

- Ascend.
Va. $14\frac{1}{4}$ E.
- 40.00 Set Oak post 3x3 in. & 3 ft. long in Md. of rocks on S. slope of gravel hill as inst. for $\frac{1}{4}$ Sec.cor. This is as far N. as it is practicable to extend this line as there is no timber. Worthless mountains. I therefore run W. on $\frac{1}{4}$ Sec. line through Sec. 10.
Va. $14\frac{1}{4}$ E.
- 26.50 Descend into Canada, with timber.
Cross gulch 50 lks.wide. Co. S. thence Ascend.

T. 1 N., R. 10 W., S. B. M.

side hill covered with low brush.
 40.00 Set Oak post 3 x3 in. 3 ft. long in Md. of rocks as inst. for $\frac{1}{4}$ Sec. cor. in center of Sec. 10 on side hill facing E
 Thence,
 North, on $\frac{1}{4}$ Sec. line.

Va. $14\frac{1}{4}^{\circ}$ E.

21.00 Along on E. slope of hill.
 Cross gulch 25 lks. wide Co. S.E., thence Ascend side hill covered with low brush.

40.00 Set redwood post 3x3 in. 3 ft. long in Md. of rocks on S. slope of gravel hill as inst. for $\frac{1}{4}$ Sec. cor. bet. Secs. 3 & 10. Land rolling with Oak, Fir and Sycamore. Timber in Canadas. This is as far as it is practicable to extend the line in this direction on account of the worthlessness of the country.

As all the cor. on the N. bound of the Rancho Argusa have disappeared, or cannot be found, I find it necessary to resurvey the Rancho, I begin at the N.E. cor. of said Rancho, being 20.00 chs. S. of cor. to Secs. 23, 24, 25 & 26, and run along N. bound. of said Rancho according to the Co. & dist. of the final survey of said Rancho.

1st S. 89° W.

Va. $14\frac{1}{4}^{\circ}$ E.

83.50 chs.

At 13.00 chs. a house about 6.00 chs. N. at 23.75 chs. cross a dry wash 100 lks. wide. Co. S.

60.00 At 50.50 Cross road. Co. N.W. & S.E.
 64.30 ft. of hills enter Valley. Co. N. & S.

chains cross bush fence. Co. N. & S.

83.50. Finding no traces of the cor. called for in the final survey of the Rancho Argusa, I set an Alder post 3x3 ft. in Md. of earth & pits as inst. & marked same R.T.No. 15 for station No 15 of the final survey of the Rancho, thence,

2nd N. 4° W. 40.00 An Oak post in Md. of rocks for cor. No. 14 of this Rancho, thence,

3rd N. $18\frac{1}{4}^{\circ}$ W. 22.50 chs.

10.00 Cross water ditch C. S.W.

22.50 Find no trace of cor. called for in final survey. I set an Alder post 3x3 in. & 3 ft. long in Md. of rocks as instructed for Cor. No. 13 of this Rancho,

4th N. $7\frac{1}{4}^{\circ}$ E. 19.50 chs.

9.25 chs. Enter dry wash of San Gabriel River, S.W. & E.

19.50 chs. Find no trace of cor, as called for in the final survey of said Rancho, I set
 An Alder post 3x3 in. & 3 ft. long in large Md. of rocks as inst. for cor. No. 12 of this Rancho on S. edge of water, Co. of San Gabriel River. The Sycamore called for in the final survey have all been destroyed, thence,

5th S. $46\frac{1}{2}^{\circ}$ W.

8.00 to S. or left bank of dry bed or wash of San Gabriel River. Co. S.W. or N.E. 71.90 leave upland and enter dry wash of San Gabriel River. Co. Southerly, thence, down dry wash of river.

109.40. All traces of the monument having disappeared, I set an Alder post 3x3 in. 3 ft. long in large Md. of rock as inst. for cor. No. 11 of this Rancho, being cor.

T. 1 N., R. 10 W., S. B. M.

- No. 9 of this Rancho Argusa Duarte, thence, along the Rancho Argusa Duarte.
- 1 N. 6° E. 57.60 chs.
 30.50 chs. Cross Zanja, Co. W.
 31.75 chs. Leave river, Co. W. & Ascend.
 57.60 chs. I find no traces of blazed Sycamore as called for in the final survey of said Rancho. I set an Oak post 3x3 in. 3 ft. long in large Md. of rocks as inst. for cor. No. of the final survey of the Rancho Argusa Duarte on side hill facing S.E. at ft. of large Granite Rock.
- 2nd S. 58¼° W. 46.10 chs. Finding no trace of the monument Granite Rock as called for in the final survey, I set a Redwood scantling post 4x4 in. 3½ ft. long in large Md. of rocks as inst. marked same A.D. No. 7, from which, A Sycamore tree 2 ft. in dia. bears S. 55° W. 1.13 chs. dist. N. Van Tassel House bears N. 22° E. about 3.00 chs. dist., thence,
- 3rd S. 68½° W. 45.00 Chs.
 3.25. Chs. Cross gulch 100 lks. wide. Co. S.E.
 45.00 Chs. Finding no trace of the cor. called for in the former survey, I set Oak post 4x4 3½ ft. long in Md. of earth & rocks as inst. for cor. No. C. of said Rancho, thence,
- 4th S. 75° W. 11.00 chs. set a wooden scantling post 4x4 in. 3 ft. long in Md. of earth & pits as inst. for cor. No. 5 of the said Rancho about 2.00 chs. S. of ft. of Mt. in level plain, thence,
- 5th N. 79½° W. 119.00 Chs.
 At 14.70 chs. Cross brush fence Co. N & S.
 At 27.00 chs. Leave valley & ascend hill. Co. N. & S.
 31.50 Chs. summit spur Co. N.W. & S.E.
 Finding it too rough to measure on line as it passes the head of several ravines, I ran
 N. 31 3/4° W. 10.00 chs. thence,
 N. 79½° W. Along on mesa
 22.00 chs. thence, I offset back
 S. 31 3/4° E. 10.00 Chs. to W. edge of gulches in line to appoint
 53.50 chs.
 N. 79½° W. of Argusa Duarte No. 5, thence, continued on line
 N. 79½° W. Counting dist. from station No. 5
 64.60 chs. to head of gulch, thence,
 down
 75.00 chs. cross gulch in Canada 50 lks wide, Co. S.
 80.00 chs. cross gulch Co. S., thence, Ascend.
 88.50 summit of Spur, Co. N. & S., thence,
 over borken spur.
 10.00 chs. enter Valley, Co. N. & S.
 A house bears N. 2.00 chs.
 112.00 chs. leave valley & Ascend.
 119.00 chs. to an old Md. of rocks a summit of ridge facing S.E. I rebuild said monument, set an Oak stake in Md. of rocks, Mkd. same, A.D. No. 4, thence,
- N. 68½° W. 29.92 chs. Int. the W. bound. of Tp. 1 N. bet. Ranges 10 & 11 W.
 29.50 chs. N. of the cor. to Secs. 19 & 30, at the post cor. to fractional 19 & 24.

T. 1 N., R. 10 W., S. B. M.

From the cor. to Secs. 22, 23, 26 & 27, I run South, bet. Secs. 26 & 27.

Va. $14\frac{1}{4}^{\circ}$ E.

1.50
12.00
21.40

Leave Valley, Ascend point of hill
Leave hill & Descend.

Int. the N. bound. of the Azusa Rancho 3.49 chs. N. 89° E. of cor. No. 15 of said Rancho. Set Willow post 3×3 in. 3 ft. long in Md. of earth & pits as inst. for cor. to frac. Secs. 26 & 27. Land rolling, mostly 1st rate.

Dec. 1st, 1875.

From the cor. to Secs. 22, 23, 26, & 27, I ran West on true line bet. Secs. 22 & 27.

Va. $14\frac{1}{4}^{\circ}$ E.

4.99

Int. the E. bound of Rancho Azusa 21.49 chs. N. 4° W. of cor. No. 15 of said Rancho. Set Alder post 4×4 in. 3 ft. long in Md. of rock as inst. for cor. to frac. Secs 22 & 27, thence, continuing West bet. Secs. 22, 27, through Rancho Azusa.

8.50
40.00

Cross zanjon, Co. S.

Set Alder post 3×3 in, 3 ft. long in Md. of rocks in bushy bed of San Gabriel River, as inst. for $\frac{1}{4}$ Sec. Cor.

65.00
73.23

Enter wash of river, Co. N. & S.

Int. W. bound. of Rancho Axusa S.E. 09 chs. S. $46\frac{1}{2}^{\circ}$ W. of cor. No. 12 of said Rancho.

Set Cedar post 4×4 wide, 3 ft. long in large Md. of rock as inst. for cor. to fractional Secs. 22 & 27.

78.50
79.50
80.00

San Gabriel River --- No water as it runs in Zanjias.

Over River, Co. S.W.

Set Oak post in Md. of rocks as inst. for cor. to Secs 21, 22, 27, 28.

Land mostly through dry bushy bottom. Land of San Gabriel River 2nd & 3rd rate.

South, on true line bet. Secs 27, 28.

Va. $14\frac{1}{4}^{\circ}$ E.

3.00
6.43

Cross San Gabriel River, 100 lks. wide, Co. S.W.

Int. N.W. bound. of Rancho Azusa & set

An Alder post 3×3 in. 3 ft. long in Md. of rocks as inst. for cor to frac. Secs. 27, 28.

From this cor. I run along the N.W. bound of said Rancho S. $46\frac{1}{2}^{\circ}$ W. 13.98 chs. to cor. No. 11 of said Rancho, also cor. No. 9 of the Rancho Azusa Duarte, as established by myself.

From the cor. to Secs. 21, 22, 27 & 28, I run North bet. Secs. 21 & 22.

Va. $14\frac{1}{4}^{\circ}$ E.

15.40
31.00
37.00

Cross zanja, Co. S.W.

Leave river bottom & Ascend.

Foot of rocky ridge as the $\frac{1}{4}$ Sec. cor. will fall on rocky ledge not suitable place to build a mound,

I set at this point a post 3×3 in. 3 ft. long in Md. of rocks on steep side hill facing S. as instructed for witness to $\frac{1}{4}$ Sec. Cor.

L. M. Rossmussins house bears N.E. about 7.00 chs. dist.

T. 1 N., R. 10 W., S. B. M.

40.00 The true point for $\frac{1}{4}$ Sect.cor. on rocky ledge. Co. E. & W.
59.00 Summit of ridge & Descend. Co. E. & W.
80.00 Set redwood post 4x4 in. 3 ft.long in Md.of rocks as inst.
for cor.to Secs. 15,16,21,22.
Land S. $\frac{1}{2}$ level, mostly river bottom
N. $\frac{1}{2}$ Mts. Good Bee Rancho. Soil all 3rd rate.

East, on random line bet.Secs. 15 & 22.

Va. 14 $\frac{1}{4}$ ^o E.
7.50 Cross gulch with timber S. 10^o E. & Ascend.
10.00 Summit of Spur, Co. N. & S. & descend.
20.00 Cross a ravine 50 lks.wide. Co. S.E. & Descend.
40.00 Set post for $\frac{1}{4}$ Sec.Cor.
54.50 Summit of Spur cor. N.W. & S.E. & Descend.
79.90 Int. N. & S. line 21 lks.S. of cor.to Secs.14,15, 22, & 23
from this cor. I run,
S. 89^o 51' W. on true line bet. Secs. 15 & 22.
Va. 14 $\frac{1}{4}$ ^o E.
39.95 Set an Oak post 3x3 in. & 3 ft.long in large Md.of rocks
on S.W.slope of Mts.as inst. for $\frac{1}{4}$ Sec.Cor.
79.90 The cor.to Secs.15,16,21,22,
Land rough, Mts. 3rd rate. Timber in Canadas-good
Bee Rancho.

North, bet Secs. 15,16.

Va. 14 $\frac{1}{4}$ ^o E.
21.50 Cross gulch 50 lks.wide, Co. S.E., thence, Ascend.
40.00 Set post 3x3 in. 3 ft.long in Md.of rocks as inst.for $\frac{1}{4}$ Sec.
Cor. The mountains are too rough and worthless to run further
N. I, therefor, run E. on $\frac{1}{4}$ Sec.line through center of Sec.15.
Va. 14 $\frac{1}{4}$ ^o E.
40.00 Along on S.slope ridge
Set redwood post 3x3 in. 3 ft.long, Md.of rocks as inst.for $\frac{1}{4}$
Sec.Cor.in center of Sec.15
Land rough, Mts. Some timber in Canadas. This is all
the land in this direction worth subdivision.
Dec. 2nd, 1875.

From the cor.to Secs. 21,22,27,28, I run,
West on true line bet.Secs. 21 & 28

Va. 14 $\frac{1}{4}$ ^o E.
8.44 Int. E. bound.of Rancho Azusa Duarte 16.17 Chs. N. 6^o E.of
cor. No.9 of said Rancho, as established by me, I set
An Alder post 4x4 in. 3 $\frac{1}{2}$ ft.long in Md.of rocks as inst.for
cor.to fractional Secs. 21, 28, thence continued,
West, bet.Secs. 21,28 through the Rancho Azusa Duarte.
40.00 Set an Alder post 3x3 in. 3 ft.long in Md.of rocks as inst.for
 $\frac{1}{4}$ Sec.Cor.
80.00 Post for cor.to Section 20,21,28,29, inside the Rancho Azusa
Duarte.
I do not establish the cor.
Land level mostly bushy, W. of San Gabriel River.
Soil 2nd & 3rd Rate.

North, bet.Secs. 20, 21.

Va. 14 $\frac{1}{4}$ ^o E.
2.47 Int.the N.bound.of Rancho Azusa Duarte 5.65 chs.N.68 $\frac{1}{2}$ ^o E.from
cor.No.6 of said Rancho as re-established by me. Set Sycamore
post 3x3 in. 3 ft.long in large Md.of rock at foot of Mt. as
inst.for cor.to frac.Secs.20 & 21, thence, leave Valley & Ascend.

T. 1 N., R. 10 W., S. B. M.

- 40.00 Set Oak post 3x3 in. 3 ft. long in Md. of rocks as inst. for $\frac{1}{4}$ Sec. Cor.
75.00 Summit of ridge. Co. N.W. & S.E.
77.00 Descend. Leave ridge.
80.00 Set sand rock 10,16x24 in. in Md. of rock as inst. for cor. to Secs. 16,17,21,22.
Land high Mts. 3rd Rate soil.
Bee Rancho.
-

- East, on random line bet. Secs. 16 & 21.
Va. $14\frac{1}{4}^{\circ}$ E.
11.50 Cross gulch near head Co. S. & Ascend.
40.00 Summit high ridge set post for temp. $\frac{1}{4}$ Sec. cor.
41.50 Descend.
80.10 Int. N. & S. line at post cor. to Secs. 15,16,21,22, from which I run,
West, on true line bet. Secs. 16 & 21.
Va. $14\frac{1}{4}^{\circ}$ E.
40.05 Set an Oak post 3x3 in. 3 ft. long in Md. of rocks as inst. for $\frac{1}{4}$ Sec. Cor.
80.10 The cor. to Secs. 16,17,20,21
Land high and rough. Mts. 3rd rate. Soil.
Timber in Canada, Oak & Sycamore.
Van Tassels house in S.W. $\frac{1}{4}$ of Sec. 21. This is as far N. as it is practicable to survey on account of the worthlessness of the land.
-

- From the point for cor. to Secs. 20,21,28 & 29, inside the Rancho Azusa Duarte, I run,
West, on true line bet. Secs. 20 & 29.
Va. $14\frac{1}{4}^{\circ}$ E.
7.92 Int. the N. boundary of the Rancho Azusa Duarte 2.77 chs. S. 75° W of cor. No. 6 of said Rancho as re-established by me. Set A Sycamore post 4x4 in. $3\frac{1}{2}$ ft. long in Md. of rocks as inst. for cor. to frac. sects. 20 & 29.
27.38 Int. the N. bound. of the Rancho Azusa Duarte 11.70 chs. N. $79\frac{1}{2}^{\circ}$ W. of cor. No. 3 of said Rancho as re-established by me. Set An Oak post 4x4 in. 3 ft. long in Md. of rocks as inst. for cor. to frac. Secs. 20 & 29.
40.00 Set an Oak post 3x3 in. 3 ft. long in Md. of earth & pits as inst. for $\frac{1}{4}$ Sec. Cor.
53.50 Cross bush fence, Co. S.
80.00 Set Oak post 4x4 in. $3\frac{1}{2}$ ft. long in Md. of earth & pits as inst. for cor. to Secs. 19,20,29,30.
Land level, 1st & 2nd rate.
-

- North, bet. Secs. 19,20.
Va. $14\frac{1}{4}^{\circ}$ E.
9.00 Int. the N. bound. of Rancho Azusa Duarte the cor. falling on steep side hill facing W. not suitable place to build a monument. I set a Redwood Scantling post 4x4 in. $3\frac{1}{2}$ ft. long in a Md. of earth & pits which bears S. $79\frac{1}{2}^{\circ}$ E 4.00 chs. dist. at head of gulch Co. W. as inst. for cor. to frac. Secs. 19,20 from this cor. I run, N. $79\frac{1}{2}^{\circ}$ W. 54.15 chs. to cor. No. 4 of said Rancho, as established by me, thence from cor. to frac. Secs. 19,20, I ran North, bet. Secs. 19,20.
Va. $14\frac{1}{4}^{\circ}$ E.

T. 1 N., R. 10 W., S. B. M.

12.50 Counting the dist. from the cor. to Secs. 19, 20
 29.30 Cross near head of gulch. Co. W.
 14.30 Summit of Spur. Co. S.W. & N.E.
 17.00 Enter valley Co. N.E. & S.W.
 22.50 Cross gulch & leave valley. Co. N.E. & S.W.
 26.36 Summit of Spur. Co. S.W. & N.E.
 30.50 Enter gulch S. 15° W. thence up the same.
 32.00 Leave gulch, thence, along W. side.
 37.50 Summit of a low Spur, Co. N.E. & S.W.
 Ascend.
 40.00 Set an Oak post 3x3 in. 3 ft. long in Md. of rock as inst. on
 side hill facing W. for $\frac{1}{4}$ Sec. Cor.
 47.00 Cross gulch 20 lks wide, Co. S.W., thence ascending high hills.
 80.00 Set Oak post, 4x4 in. & 3 ft. long, in Md. of rocks as inst. for
 cor. to Sects. 17, 18, 19, 20. On side hill facing N.W. Land
 rough along line gravel land in rolling of Canada.
 Old Placer Mines in Sec. 19.
 Dec. 3, 1875.

East, on random line bet. Secs. 17, 20.
 Va. 14 $\frac{1}{4}$ ° E.

Along on S. slope of Mt.
 14.51 Descend.
 40.00 Set apart for temp. $\frac{1}{4}$ Sec. Cor.
 44.50 Cross gulch 50 lks wide. Co. S. thence, Ascend.
 53.00 Summit of Spur, Co. N. & S. & Descend.
 62.50 Cross gulch. 50 lks. wide, Co. S. thence, Ascend.
 79.86. Int. the N. & S. line 14 lks. S. of cor. to Secs.
 16, 17, 20, 21 from this cor. I run,
 S. 89° 54' W. on true line

Det. Secs. 17, 20.

Va. 14 $\frac{1}{4}$ ° E.
 39.93 chs. the point for $\frac{1}{4}$ Sec. Cor. falling on steep side hill
 not suitable place to build a monument, I continued at
 43.50 Set Oak post 3x3 in. & 3 ft. long in Md. of rock as inst. for
 witness to $\frac{1}{4}$ Sec. Cor.
 79.86 The cor. to Secs. 17, 18, 19, 20,
 Land over rough high Mt. 3rd rate soil with timber
 in Canada, Oak & Sycamore.

West, on random line bet. Sects. 18 & 19.
 Va. 14 $\frac{1}{4}$ ° E.

Along S. slope of Mt.
 17.00 Cross gulch 50 lks. wide, Co. S.W. & Ascend.
 35.00 Summit of Spur Co. N.E. & S.W. thence Descend.
 40.00 Set post for temp. $\frac{1}{4}$ Sec. Cor.
 57.00 Cross gulch 40 lks. wide, Co. S.
 80.70 Int. W. bound. of Tp. 16 lks. S. of cor. to Secs. 18 & 19 from
 this cor. I run,
 S. 89° 54' E on true line bet. Secs. 18 & 19.

Va. 14 $\frac{1}{4}$ ° E.
 40.70 Set an Oak post 3x3 in 3 ft. long in Md. of rocks as inst. on
 side hill facing W. for $\frac{1}{4}$ Sec. cor. from which
 A rock 10 ft. cube bears S. 41 $\frac{1}{2}$ ° E. 1800 chs. dist.
 80.70 The cor. to Secs. 17, 18, 19, 20
 Land high Mts. Soil 3rd rate with some timber in Canadas,
 Oak, Sycamore, Old Placer Mine in Sec. 19.

T. 1 N., R. 10 W., S. B. M.

North, bet. Secs. 17, 18.

Va. $14\frac{1}{4}^{\circ}$ E.

This line being too rough to measure, I begin at $\frac{1}{4}$ Sec. Cor. bet. Sects. 17 & 20, and run, North, through Sec. 17 on $\frac{1}{4}$ Sec. line on E. slope of hill ascending.

40.00

Set Oak post 3x3 in. 3 ft. long in Md. of rocks as inst. for $\frac{1}{4}$ Sec. Cor. Center of Sec. 17. from which,

A Live Oak tree 12 in. in dia. bears S. 60° E. 28 lks. dist. thence W. on $\frac{1}{4}$ Sec. line

33.50

Cross gulch near head, Co. S.W.

40.00

Set redwood post 3x3 in. 3 ft. long in Md. of rocks on side hill sloping S.E. as inst. for $\frac{1}{4}$ Sec. Cor. on line bet Secs. 17, 18, thence continued N. bet. Sects. 17, 18

Va. $14\frac{1}{4}^{\circ}$ E.

Ascending.

25.00

Summit of Spur Co. NE & SW & Descend.

40.00

Set redwood post 4x4 in. $3\frac{1}{2}$ ft. long in large Md. of rocks as inst. for cor. to Secs. 17, 18, 7, 8,

Land rough Mts. 3rd rate with mineral indicating Placers.

The line bet. secs. 8 & 17 is too rough & worthless to survey, I, therefore, run

West on random line bet. Secs. 7, 18.

Va. $14\frac{1}{4}^{\circ}$ E.

Along S. slope of ridge.

15.00

Cross gulch 25 lks wide. Co. W. thence along N. side.

25.50

Cross same gulch 25 lks. wide, Co. N.W.

Thence along on S. side of gulch

40.00

Set a post for temp. $\frac{1}{4}$ Sec. Cor.

45.50

Cross gulch 100 lks wide, Co. S.

58.50

Cross gulch 25 lks. wide, Co. S.

71.50

Enter field of Butler, Co. N. & S.

76.00

Leave field, Co. N. & S.

80.63

Int. W. bound. of Tp. 26 lks. S. of cor. to Secs. 7 & 18 from this cor. I run,

S 89° 49' E. on true line bet. 7 & 18,

Va. $14\frac{1}{4}^{\circ}$ E.

40.63

Set Oak post 3x3 in. 3 ft. long Md. of rocks as inst. for $\frac{1}{4}$ Sec. Cor.

80.63

The cor. to Secs. 7, 8, 17, 18.

Land very rough with Oak & Sycamore in Canadas. $W\frac{1}{2}$ mostly 1st rate.

North, bet Secs. 7 & 8.

Va. $14\frac{1}{4}^{\circ}$ E.

Descending.

7.50

Cross gulch, 25 lks. wide, Co. S.W. & Ascend.

40.00

Set sand rock 6x10x20 in, in Md. of rocks for $\frac{1}{4}$ Sec. cor.

43.00

Summit of ridge, Co. N.E. & S.W., thence, along on ridge

46.50

Descend.

80.00

Set an Oak post 4x4 wide, $3\frac{1}{2}$ ft. long in Md. of rocks as inst. for cor. to Secs. 5, 6, 7 & 8 from which

A Live Oak tree 10 in. in dia. bears N. 80° W. 70 lks. distant

A Fir tree 20 in. in dia. bears S. $72\frac{1}{2}^{\circ}$ W. 45 lks. dist.

Dec. 4th, 1875.

T. 1 N., R. 10 W., S. B. M.

West, on random line bet. Secs. 6 & 7.

Va. $14\frac{1}{4}^{\circ}$ E.

- 10.00 Cross gulch, 20 lks.wide, Co. S.W.
22.50 Summit of Spur Co. N. & S.
33.00 Cross gulch 75 lks.wide, Co.S.
40.00 Temp.post for $\frac{1}{4}$ Sec.cor.on steep side hill facing E.
45.00 Top of ridge, Co. N. & S.
62.75 Cross gulch, 25 lks. wide, Co. S.E. & Ascend.
80.30 Int.W.bound of Tp.14 lks. S. of cor.to Secs. 6 & 7 from this cor.
I run,
S. $89^{\circ} 54'$ E. on true line bet. Secs. 6 & 7.
Va. $14\frac{1}{4}^{\circ}$ E.
34.70 Summit of high ridge at the $\frac{1}{4}$ Sec.Cor.will fall on steep side hill,
not a suitable place to build a monument, I set
A Redwood post 3x3 in. 3 ft.long in Md.of rocks as inst.for witness
to $\frac{1}{4}$ Sec.cor.
40.30 The true point for $\frac{1}{4}$ Sec.Cor.
80.30 The cor.to Secs. 5,6,7,8,
Land rough with scattering timber in Canadas.

North, on random line bet. Secs. 5 & 6.

Va. $14\frac{1}{4}^{\circ}$ E.

Descending.

- 6.50 Cross gulch 25 lks.wide, Co. S.W. thence, Ascending.
22.50 Summit of Spur Co. N. & S.
40.00 Set post for temp $\frac{1}{4}$ Sec.Cor.
44.50 Enter gulch Co. S.W. thence, up same 50 lks. wide.
46.75 Leave gulch and Ascend.
80.23 Int. N. bound.of Tp. 19 lks. E. of cor.to Secs 5 & 6.
From this cor. I ran,
S. 08° E. on true line bet. Secs. 5 & 6.
Va. $14\frac{1}{4}^{\circ}$ E.
40.23 Set Oak post 3x3 in. 3 ft.long in Md.of rocks on steep side
hill facing N. as inst. for $\frac{1}{4}$ Sec.Cor.
from which,
A Fir tree 20 in. in dia. bears N. 16° W. 140 chs. dist.
80.23 The cor.to Secs. 5,6,7,8. Land rough, high Mts.with scattering
Fir & Oak Timber.

East, on true line bet. Secs. 5 & 8.

Va. $14\frac{1}{4}^{\circ}$ E.

- 40.00 Along on N. slope of high ridge
Set Oak post 3x3 in. 3 ft.long in Md.of rocks as inst.for $\frac{1}{4}$ Sec.
Cor. from which,
A Fir Tree 24 in. in dia. bears S. 41° E. 83 lks.dist.
62.50 Summit of ridge, Co. N. E & S.W. thence, descend.
80.00 Set sand rock 10x16x24 in. in Md.of rocks as inst.for cor.to
Secs. 4,5,8,9, on steep side hill facing S.E.
Land rough, with scattering Fir & Oak. The land N.& E. of the
point is too rough & worthless to extend the survey further in
this direction.

I, therefore, run,
South, bet. Secs. 8 & 9.

Va. $14\frac{1}{4}^{\circ}$ E.

T. 1 N., R. 10 W., S. B. M.

- 40.00 Descending side hill with scattering fir & oak.
Set sand rock 10x16x20 in. in Md.of rocks at the head of gulch
as inst.for $\frac{1}{4}$ Sec.Cor. this is as far as it is practicable to
extend this line as the country S. & E. is rough & worthless
Mts.
Land rough, scattering Oak, Fir, thence,
W. on $\frac{1}{4}$ Sec. line through center of Sec.8.
Va. $14\frac{1}{4}^{\circ}$ E.
- 40.00 Along on S.slope of Mt.
Set redwood post 3x3 in. 3 ft.long in Md.of rocks as inst.for
 $\frac{1}{4}$ Sec.Cor.
Center of Sec.8 about 18 chs. E. & 20 chs. N. of gulch, from
which,
A large rock bears N. $40\frac{1}{2}^{\circ}$ W. 70 lks dist.
A Live Oak Tree 2 ft.in dia.bears N. $24\frac{1}{2}^{\circ}$ E. 18 lks.dist.
Land along S.slope of Mt.scattering timber Oak and Fir, very
rough.
This comprises all the available land in the Tp.
Dec.6th, 1875.

General Description

There is a very small portion of agricultural land in the Township. Several small Bee Ranchos, situate along the foot hills. The Canadas or gulches have timber only valuable for fuel.

The mountains are very rough with some low brush along the San Gabriel River are several mining claims, none of them being worked, but the Winson Mine in Sec. 13.

Placer Mine has been extensively worked in Sec. 19, but now all are abandoned.

The W $\frac{1}{2}$ of Sec. 19, I would consider more valuable for mineral than agricultural purpose.

The N $\frac{1}{2}$ of Sec. 24 all of Sec 13;

The S $\frac{1}{2}$ of Sec. 12

The S $\frac{1}{2}$ of Sec. 14, also

should be reserved as mineral, also

N $\frac{1}{2}$ of N.E. $\frac{1}{4}$ of Sec. 23.