

✓
 Copied from Photographic Copies
 furnished by
 U.S. General Land Office
 Washington D. C.

Reynolds

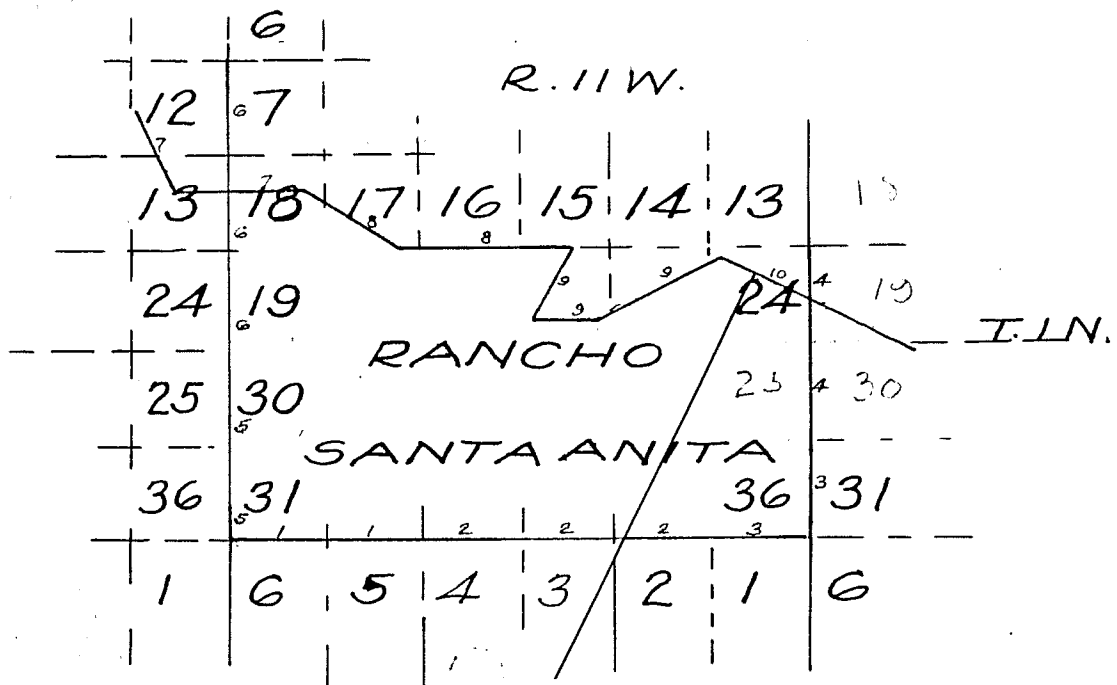

S. B. T 1 N. R. 11 West San Bernardino Meridian.

Chains

Make a correct survey of this fractional Tp.

I find it necessary to retrace the exterior boundaries of the same for the reason so long a time has elapsed since the lines were run there are no corners to be found readily on either the east or west boundaries of the said Tp.

I therefore begin at the post in a mound of earth and stones the cor. re-established by me in December 1868 while executing the survey of the subdivision lines of Tp. 1 S. R. 12 W. of the San Bernardino Meridian to Tps. 1 N. and 1 S. R's 11 and 12 west.

To determine the proper adjustment of my transit for retracing the S. B. of this Tp. I cause a flag to be placed at the established 1/4 Sec. cor. on the S. B. of Sec. 36 Tp. 1 N. R. 12 W. and find the variation to be

14° 56' East

I now run from the cor. to Tps. 1 N. and 1 S. R's. 11 and 12 W. East on true S. B. of Sec. 31

Va. 14° 56' East.

- 1.50 Cross road in dry wash runs S.
- 2.00 Leave wash runs S.
- 3.00 Cross road to Santa Anita runs N. 70° E.
- 4.00 Enter thick brush bears N. and S.
- 10.00 Cross dry arroyo 20 lks. wide runs S.
- 25.50 Cross road N. and S.
- 40.00 Point for 1/4 Sec. cor. at old mound, from which bears old witness trees as follows
 - A Sycamore 10 in. dia. N. 68-1/2° E. 117 lks.
 - A Scrub Oak 11 in. dia. S. 82-1/4° E. 213 lks.
- Set post and renewed old mound.
- 59.00 Cross a road bears N.&E. and S.&W.
- 69.03 A triple black Oak 40 in. dia.
- 80.00 Set an Elder post in old mound the established cor. to Secs. 5-6-31 and 32 from which bears an Elder 5 in. dia. N. 12-1/2° E. 87 lks.
- Renewed old mound from the pits as per ins.
- Land level.
- Soil sandy.
- Scattering Greasewood and Cacti.

East on true S. B. Sec. 32

Va. 14° 56' East

- 5.00 Leave brush bears N. E. and S.
- 24.00 Cross old water ditch 12 lks. wide runs S. 60° W.
- 30.50 Cross another water ditch 12 lks. wide runs S. W.
- 40.00 Set an Elder post for 1/4 Sec. cor. in old mound and renewed pits as per ins.
- 56.50 Cross an old water ditch 10 lks. wide runs S. E.
- 80.00 Set an Elder post in old mound for cor. to Secs. 4-5-32 and 33 and rebuilt with rocks.
- Land level.
- Soil sandy.
- No. timber or brush.

S. B. T. 1 N. R. 11 W. S. B. M.

Chains

East on S. B. Sec. 33
 Va. 14° 56' East

7.50 Cross a road bears N. and S.
 13.50 Cross a road bears N. and S.
 40.00 Set an Elder post for 1/4 Sec. cor.
 An Elder 12 in. dia. bears N. 19-3/4° E. 6.00 lks.
 49.50 Cross a dry arroyo 100 lks. wide, S.
 59.00 Cross an dry arroyo 20 lks. wide runs S.
 80.00 Set an Elder post for cor. to Secs. 3-4-33 and 34 and
 raised a mound with pits as per ins.
 Land level.
 Soil sandy.

S. B. T. 1 N. R. 11 West

San Bernardino Meridian.

East on S. B. Sec. 34

Va. 14° 56' East

30.00 Cross an arroyo 15 lks. wide runs S.
 40.00 Set an Elder post for 1/4 sec. cor.
 74.50 Cross a water ditch 10 lks. wide runs S.
 80.00 Set an Elder post in old mound the established cor. to
 Secs. 2-3-34 and 35. Renewed the pits and mound as per ins.
 Land level.
 Soil sandy.
 Scattering Elders.

East on S. B. Sec. 35

Va. 14° 56' East

4.50 Cross a road bears N. and S.
 26.50 Cross a road bears N. and S.
 40.00 Set an Elder post for 1/4 Sec. cor. in old mound.
 50.00 Enter belt of scattering Elder. bearing N. and S.
 52.00 Leave Elder bearing N. E. and S. W.
 79.30 Cross a brush fence bearing N. 18° E. and S. 18° W.
 80.00 Set Cedar post in fenced pasture for cor. to Secs. 1-2
 35 and 36 and raised mound with pits as per ins.
 Land level.
 Soil sandy loam.
 Scattering Elders.

S. B. T. 1 N. R. 11 W. San Bernardino M.

Chains

- East on S. B. Sec. 36
Va. 14° 56' East.
- 11.30 Cross a live Willow-fence and enter cultivated field bearing N. 72° W. and S. 72° E.
 - 19.25 Cross a live Willow-fence and leave cultivated field bearing N. 22° E. and S. 22° W.
 - 20.40 A small house bears N. 5 chs. dist.
 - 21.50 Cross an irrigating ditch 8 lks. wide runs S.
 - 22.00 Cross a road bears N. E. and S. W.
 - 25.00 Leave San Gabriel River bottom and ascend gentle slope with Chaparral.
 - 40.00 Set a post in old mound, the established 1/4 Sec. cor.
 - 49.00 Cross a Gully 20 lks. wide runs S. 20° W.
 - 80.00 Set a post in old mound the established cor. to Tps. 1 N. and 1 S.
R's 10 and 11 West.
Land 1st 25 chs. level, then broken and sandy with Chaparral and Cacti.

May 24th 1873.

From the cor. to Tps. 1 N. and 1 S. Rs. 10 and 11 W.
San Bernardino Mer.

I run

- North along the E. B. of Sec. 36.
Va. 14° 56' East.
- 7.30 Cross a branch of the San Gabriel River 20 lks. wide runs S. 80° W.
 - 19.00 Cross road bears E. and W.
 - 40.00 Set post for 1/4 Sec. cor. in mound of rock.
 - 52.00 Cross road and old irrigating ditch 20 lks. wide runs S. W.
Leave brush and run on level land.
 - 52.60 Cross a brush fence bearing S. 60° W. and N. 60° E.
 - 53.50 N. E. edge of Walnut Orchard, and along same.
 - 55.50 Leave Walnut Orchard.
 - 63.50 Cross irrigating ditch 30 lks. wide S. W.
 - 66.00 A Jacal or hut E. 100 lks.
 - 68.00 Cross road from Azusa to Mission San Gabriel bears N. 70° E. and S. 70° W.
 - 76.50 Cross road bearing N. 25° E. and S. 25° W.
 - 80.00 Set a post in old mound for the established cor. to Secs. 25-30-31 and 36 as per ins.
Land 1st 52 chs. broken and sandy. with patches of thick Chaparral. thence 2nd rate.

Between R's. 10 and 11 W. T. 1 N. S. B. Mer.

Chains

North on E. B. Sec. 25
 Va. $14^{\circ}56'$ East.

4.00 Cross on irrigating ditch 10 lks. wide S. 10° W.
 10.10 Cross on irrigating ditch 10 lks. wide S. 10° W.
 27.70 A Live Oak 30 in. dia. bears W. 76 lks.
 33.00 Cross Zanja 16 lks. wide runs S. 60° W. and enter
 cultivated field E. and W.
 40.00 Set a post for $1/4$ Sec. cor. and raised a mound with pits
 as per ins.
 49.00 Leave cultivated field and enter Chemisal brush bearing
 E. and W.
 57.00 Cross old San Gabriel road bearing N. 70° E. and S. 70° W.
 63.30 Beginning of foot hills S. 80° E. and N. 85° W.
 65.67 A white Oak 20 in. diam.
 67.00 Cross a dry ravine 40 lks. wide runs S. W.
 74.00 Top of hill N. E. and S. W.
 76.50 Center of Ravine 3 chs. wide runs S. W.
 80.00 Set a post in old mound the established cor. to Secs.
 19-24-25 and 30.
 Land level for 60 chs, the rest broken foot-hills sloping
 S. W. with Chemisal and Chaparral and scattering Oak
 timber.

North on E. B. Sec. 24

Va. $14^{\circ}56'$ East

4.00 Top of low hill E. and W.
 7.00 To base of hill and cross road E. and W.
 A house bears E. 280 lks. enter valley.
 27.00 Leave valley bears E. comes from S. 80° E. and ascend hill.
 27.50 Cross old mining ditch 10 lks. wide S. E.
 32.50 Top of point of hill 40 ft. high
 N. 60° E. and S. 60° W. and descend N. W. slope.
 35.75 Cross trail at foot of hill S. 60° W.
 38.00 Cross a mountain Gulch runs W.
 40.00 Set post for $1/4$ Sec. cor. in mound of rocks on S. slope of
 hill.
 A natural mound of trap rock 6 x 4 x 4 feet bears S. $36-1/2^{\circ}$
 W. 100 lks. dist.
 45.00 Cross a deep Gulch 70 lks. wide runs S. E.
 45.65 Cross old mining ditch 20 lks. wide runs S. E.
 60.00 Cross deep ravine runs S. W. 1 ch. wide.
 67.50 Top of ridge and descend left and S. E. side of mountain
 Canon runs S. W.
 80.00 Set a post in mound of rock for cor. to Secs. 13-18-19 and
 24 as per ins. on S. E. side of Canon.
 Land broken, 3rd rate.
 I find it impracticable to run this line further North,
 owing to roughness of mountains.

May 26th 1873.

Between R's 11 and 12 W. T. 1 N. San B. Mer.

Chains

From the cor. to Tps. 1 N. and 1 S. R's 11 and 12 West.

I run

North between Secs. 31 and 36

Va. 14° 56' East

- 0.75 Cross a picket fence and enter S. J. Rose's Vineyard bearing N. 84-1/2° W. and S. 84-1/2° E. 2.15 chs. to S. E. cor. of Vineyard.
- 10.80 Cross picket fence on E. side of Vineyard bearing N. 12-1/2° W. and S. 12-1/2° E.
- 12.50 Cross road bears N. 12° W. and S. 12° E. and enter dry wash of arroyo.
- 31.50 Cross the same road N. E. and S. W.
- 36.00 Top of table-land N. E. and S. W.
- 37.60 Cross a picket fence bearing N. 12-1/2° E. and S. 25° W. and enter new Vineyard of S. J. Rose.
- 40.00 Set post for 1/4 Sec. cor. in Vineyard with mound and pits as per ins.
- 46.00 Int. line of Rancho Santa Anita finally confirmed to Henry Dalton, from which station 3 of said Ranchos bear N. 68°50' W. 11.16 chs. dist.
- 47.20 Cross a picket fence bears N. 69-1/2° W. and S. 69-1/2° E. 3 chs. to the N. E. cor. of fence.
A jacal S. 80-° E. 60 lks. dist.
- 47.50 A jacal bears W. 15 lks. dist.
- 51.50 Cross an arroyo 15 lks. wide runs S. 12° E.
- 53.30 A Spanish Oak 38 in. dia. on the left and N. E. bank of same arroyo, marked as a line tree.
- 54.50 Enter swamp bearing E. and W.
- 58.00 Leave swamp bearing E. and W.
- 63.00 To right and S. W. bank of ravine S. E.
- 63.50 Centre of ravine in stream of water S. E.
- 64.20 Top of left bank of ravine, enter cultivated field.
- 71.50 Leave cultivated field and cross a brush fence bearing N. 10° W. and S. 10° E.
- 72.50 Enter dry arroyo runs S. E.
- 74.00 Leave same dry arroyo and enter dense undergrowth of Willow.
- 79.00 Cross road in a dry wash S. E.
- 80.00 Set a post in mound of rock for cor. to Secs. 25-30-31 and 36 from which a Cottonwood 18 in. in dia. marked for an old bearing tree bears S. 54-1/2° W. 161 lks.
Land level.
Soil 2nd rate.

North between Secs. 25 and 30.

Va. 14° 56' East

- 2.50 Left and S. W. bank of dry arroyo.
- 6.50 Right and N. E. bank of dry arroyo runs S. 70° E. comes from N. 28° E.
- 15.00 Enter same arroyo runs S. 10° W.
- 23.00 Leave same arroyo.
- 39.00 Cross old road bears N. 80° W. and S. 50° E.
- 40.00 Set post in old mound the established 1/4 sec. cor. on E. side of road runs N.
- 50.00 Enter road.
- 52.00 Cross road N. 10° E.
- 65.90 Cross a board fence 18 lks. E. of N. W. cor. from which cor. it runs S. 15° W. and E.
- 66.00 Cross a road N. 75° E. and S. W.

Bet. R's 11 and 12 W. T. 1 N. San B. Mer.

Chains
80.00

Set a post in old mound the established cor. to Secs. 19-24
25 and 30.
Land level.
Soil 2nd rate.
Scattering Sycamore and Live and Black Oak.

North bet. Secs. 19 and 24
Va. 14° 56' East.

20.50 Cross old road N. E. and S. W.
34.00 Cross old road E. and W.
35.50 Cross old road N. W. and S. E.
40.00 Set post in old mound the established 1/4 sec. cor.
72.80 Cross road S. 70° E. and N. 70° W.
80.00 Set an Elder post in old mound the established cor. to
Secs. 13-18-19 and 24 in thick Chemisal brush near foot of
S. slope of table-land.
Land sloping S.
Soil 2nd rate.
Chemisal and Scrub Oak brush.

North Bet. Secs. 13 and 18
Va. 14° 56' East.

2.50 Foot of table-land at W. side of mouth of a dry ravine
coming from N. E. table land bears N. 70° W. and S. 30° E.
18.50 Top of table-land.
23.00 Offset E. to avoid dense brush 13.00 chs. to station.
Thence north 12.00 chs. to station. Thence west 13.00 chs.
to line making the distance
35.00 To N. side of dense brush .
40.00 To post in a rock mound the established 1/4 Sec. cor.
49.46 Set a temp. stake for point for intersection with N.
boundary of Rancho Santa Anita.
50.00 Enter cultivated field of J. C. Davis bearing N. 84-1/2° E.
and S. 84-1/2° W.
65.00 Leave cultivated field of J. E. Davis bears E. and W.
The house of Davis bears E. 10.00 chs. dist.
69.50 Left and easterly bank of dry ravine.
72.00 Center of bottom of same ravine S. W.
74.00 Top of right and W. bank of ravine.
80.00 Set a post in old mound of rock the established cor. to
Secs. 7 -12-13 and 18.
A house N. W. 5 chs.
Broken table-land sloping south.
Soil 2nd rate.
Chemisal brush.

North bet. Secs. 7 and 12
Va. 14° 56' East

1.00 To gulch.
4.50 Cross wagon road N. 70° W. and S. 70° E.
6.00 Leave gulch S. 20° W.
20.33 Set a post for fractional Secs. 7 and 12 in mound of
rock on the brow of steep bank of canon running S. W.
Broken table land sloping S.
Soil 2nd rate.
Chaparral brush.

May 27th 1873.

84° 15' 11" SUG. TS M. J. I. M. 350 B. MEL.

N. B. of Rancho Santa Anita

Chains

From the originally established cor. at true Station 16
I run

N. 84-1/2° E. retracing the original line of the northerly boundary of said Rancho Santa Anita, and at

- 1.30 Cross old road course S. E.
- 7.00 Foot of table-land runs S. E.
- 10.50 Top of table-land runs S. E.
- 13.80 A ravine 80 lks. wide S. 30° W.
- 19.50 Another ravine 50 lks. wide S. 30° W.
- 21.00 Right and W. bank of deep canon S. 30° W. and descend.
- 23.50 Bottom of do. S. 30° W.
- 26.00 Top of left and E. bank of do.
- 32.00 Right and W. bank of another do.
- 38.00 Left and E. bank of same do. S. 32° W.
- 43.00 Enter cultivated field of J. C. Davis runs N, and on course.
- 47.55 To post at intersection of line bet. R's 11 and 12 W. T. 1 N. 30.54 chs. S. of cor. to Secs. 7-12-13 and 18 the true point corresponding to the Patent of this Rancho. I raise an irregular mound of earth with pits as per ins. for cor. to fractional Secs. 13 and 18 and at
- 54.00 Cross a ravine 4 lks. wide, south
- 57.00 Cross road to the house of J. C. Davis runs north
- 58.00 Leave cultivated field bears N. and enter Chaparral brush.
- 67.00 Cross a small Gulch 20 lks. wide runs south.
- 71.50 To the right and W. bank of ravine and descend steep bank.
- 72.50 Foot of bank runs S.
- 73.00 Cross a dry wash 40 lks. wide S.
- 75.00 Cross a road runs S.
- 82.00 Foot of bank of table-land runs S. 3 chs. to a bluff point 40 feet high.
Ascend.
- 85.00 Summit of same. Set a stake on line and descend.
- 88.00 Foot of E. slope and enter branch canon runs S. 35° W. 5 chs. and joins main canon.
- 90.00 Foot of bank on E. side of canon.
- 92.00 Top of canon bank S. 40° W.
- 98.00 Cross dry Arroyo 20 lks. wide runs S.
- 102.25 To old mound of rocks and earth the established cor. for Station 17. Set a post marked S. A. 17. Station about 5 chs. S. of the S. base of the mts. An earth dam bears N. 4 chs. dist. 100 feet long, 40 feet wide
Thence S. 62° E.
- 9.00 Cross a road N. E. and S. W.
- 20.00 Cross a ravine 80 lks. wide runs S. W.
- 30.00 A road N. E. and S. W.
- 32.00 Cross a ravine 30 lks. wide runs S. E.
- 42.00 Road N. and S.
- 50.00 Cross a dry sandy Gulch 40 lks. wide runs S. E.
- 90.00 Set a post marked S. A. 18 Station in old mound the previously established cor. for said station, differing 1 ch. in distance from the original survey.

May 28th 1873.

N. B. of Rancho Santa Anita

Chains

Thence East

8.40 To fence cor. running N. and S. 89° E.
 17.50 Cross a road bearing N. 20° E. and S. 20° W.
 40.30 Cross an irrigating ditch with water runs S. 70° E.
 45.00 Leave field and cross fence running N. 30° E.
 Set a post 70 lks. from the S. E. cor. of fence
 49.50 To the right and W. bank of the Little Santa Anita Canon
 runs S. 10° E.
 65.00 To the left and E. bank of same canon.
 91.00 Cross a small Gulch 30 lks. wide S.
 115.00 Cross a road N. and S.
 124.00 Cross a road N. 20° E. and S. 20° W.
 130.00 Leave sandy bottom of creek 3 chs. wide.
 143.50 Foot of bluff on E. side of Canon.
 148.35 Post in a mound of rock marked S. A. 19 being the original
 station established on the official survey, making a difference
 of 2.97 chs. more in distance as given by the official
 survey in Patent.

Thence

S. 21° W. retracing the boundary of Rancho.
 12.00 To right and W. side of wash and run along the stream.
 15.00 Leave W. side of wash and continue along foot of W. slope of
 hills.
 62.00 Ascend point of hills sloping N.
 68.50 Set post in old mound the established Station 20 of the
 original survey.

Thence

S. 32° E. still on line of Rancho.
 1.00 Cross point of hill descending S. 68° W.
 5.50 Set a post in mound the established Station 21 of original
 survey

Thence

East still on line of Rancho.
 7.00 Ascend across S. slope of point of foot hills or spur
 from the mts.
 26.00 Leave S. slope of spur.
 56.68 Set post in old mound, the established cor. to Station 22
 of the original survey

Thence

N. 65° E. on line of Rancho
 9.16 To S. W. cor. of a pole fence, running N. 66-3/4° E. and
 N. 42-1/2° W. and enter field and cross a road runs N.
 35° E.
 20.00 Cross a dry wash 20 lks. wide runs S.
 41.50 Cross a road runs N. and S.
 62.00 Cross a dry wash 40 lks. wide runs S. W.
 74.00 Cross pole fence running N. and S. 83 lks. from S. E. cor.
 bearing S.
 92.50 Cross a ravine with water runs S.
 100.00 Cross a road runs N. and S.
 102.00 Set a post in old mound of rock the originally established
 Station 23 of the survey of this Rancho on the W. bank of
 a Canada running S. 20° E.

May 29th 1873.

N. E. of Rancho Azusa de Duante

Chains

Thence

- 00.20 S. 66° E. still on line of Rancho
 - Descend steep bank of Canada.
 - 1.00 Foot of steep bank of Canada, and enter botton.
 - 2.50 Cross wash 40 lks. wide S. E.
 - 11.00 Cross a road runs S.
 - 26.00 Cross a wash 30 lks. wide S. E.
 - 28.00 Cross a wash 8 lks. wide S. E.
 - 28.50 To Station No. 1 of the official and final survey of this Rancho.
- Rancho Azusa de Duante* Set a post marked S. A. 1 in a mound of rock and also marked A. 1 for Station No. 1 of the final and official survey of Rancho Azusa which I have to retrace as follows S. 15° E. on the true northerly boundary of Rancho Azusa de Duante.
- 3.64 Set a post in old mound of rock at foot of a Sycamore 8 in. dia. A. 2. Station
- Thence
- S. 2° E.
 - 3.50 Set a post in old mound of rock A. 3. Station.
- Thence
- S. 63-1/2° E. on line of Rancho.
 - 0.70 Cross an old ditch 10 lks. wide S. 20° E.
 - 1.10 Cross an old ditch 12 lks. wide S. 20° E.
 - 2.60 Base of hill.
 - 4.60 Mouth of Canon.
 - 14.00 Cross a Gulch 20 lks. wide and ascend hill running S.
 - 23.60 Top of hill and descend.
 - 25.00 Opposite foot of hill and cross a road south.
 - 37.50 Cross a road runs S.
 - 41.50 Foot of hill and ascend.
 - 43.00 Top of hill and descend.
 - 46.00 Foot of hill.
 - 47.60 Cross a road runs S. 10° W. and N. 10° E.
 - 49.35 Int. line bet. R's 10 and 11 W.
 - 69.00 Tp. 1 N. of the San Bernardino Meridian 29.50 chs. N. of cor. to Secs. 19-24-25 and 30.
 - 84.22 A point bet. the mining Gulches near the heads they run S. W. A Granite Rock 18 in. dia. marked A. 4.

May 30th 1873.

The final oaths will be found in Book No. 2 of this survey.

Reynolds

8 x 1.2
 1 9 35
 3 7 8 7
 2 9 9 5
 1 9