

Copied from Photographic Copies
 furnished by
 U. S. General Land Office
 Washington D. C.

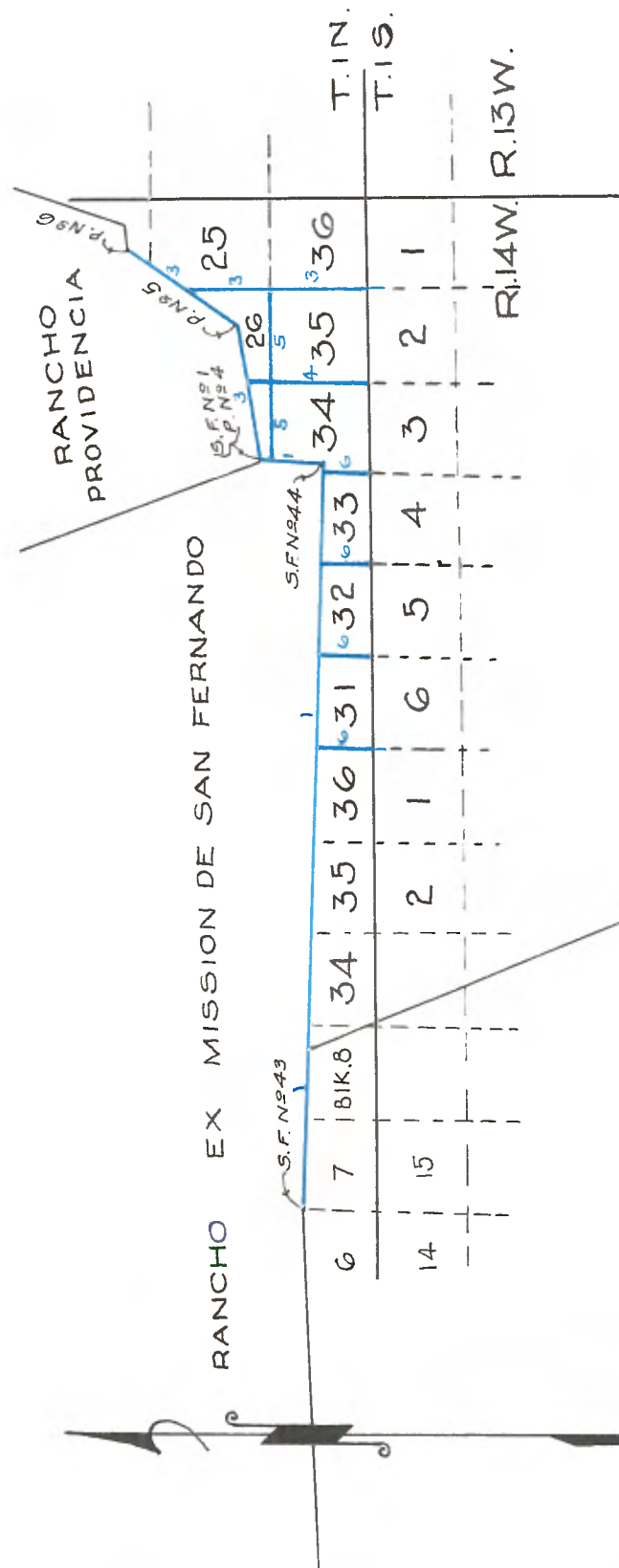

Township 1. North Range 14 W. San Bernardino M.

Survey Commenced July 23, 1879.

Chains

Survey and retracing of a portion of the rancho Ex Mission de San Fernando falling in this Township and adjoining the unsurveyed land therein.

I proceed to establish the line from Station No. 43 to Station No. 44 of the said Rancho Ex Mission de San Fernando by causing a large signal to be erected at Station No. 43 and at Station No. 44 in the summit of Cahuenga Pass at all flag staff, and from the summit of a high hill about 120 chs. westerly from Station 44. Intersect a point on Station x10 line between said stations 43 and 44 and I find the true bearing to be N. 87° W. to Station 43 and S. 87° E. to Station 44 and I find the distance between the two station as follows:

I take the angle at Station x10 from Sta. 43 of San Fernando to the Oak tree at Sta. 2 of said Rancho and find the same to be 100° 38'. I now run the line from x10 to Station 44 S. 87° E. on the southern boundary of Rancho Ex Mission de San Fernando.

Var. 15° 00' East

S. 87° E.	Along Ridge, bears S. 85° E. and N. W.
7.50	Leave ridge and descend along north slope of same.
26.00	Foot of descent and run down valley bears East.
32.00	Leave valley bearing south.
38.00	Ascend.
40.50	Top of ascent Ridge bears S. E. descend along north slope.
52.00	Foot of descent.
54.00	Cross ravine 2 lks. wide course N. W. and ascend.
63.00	Top of ascent.
67.00	Cross summit bears S. E. and N. W. descend.
78.00	Foot of descent.
78.50	Cross ravine 50 links wide co. N. 30° W. ascend.
92.00	Top of north slope of hill and descend.
97.50	Foot of descent.
98.00	Cross ravine 20 lks. wide co. N. W. ascend.
112.00	Top of north slope of hill, descend.
126.27	To the rock station No. 44 in the summit of Cahuenga Pass. From which a sand rock boulder running N. and S. 6 feet long 32 inches wide and 14 inches above the surface of the ground on side hill sloping east bears S. 54° 33' W. dist. 3 chs. 80 lks. stone being well buried in the ground.

Thence, Retracing
the line from Station No. 44 to Station No. 1 Ex Mission of San Fernando.

Va. 15° 00' East.

T. 1 N. R. 14 W. S. B. M.

Chains

1.50	N. 7° 18' E. on true line.
4.00	Cross Road bears N. 40° W. and S. 40° E. ascend.
10.00	Top of ascent low hills bears S. W. descend.
13.80	Foot of descent, cross gulch 50 lks. wide course S. W. ascend.
19.50	Top of ascent Ridge bears S. W. descend.
23.00	Foot of descent north slope of ridge bears S. W.
26.50	Cross round valley running S. 60° W. ascend.
27.50	Top of ascent Redge bears S. W.
36.00	Descend.
39.00	Foot of descent enter valley.
44.00	Cross valley bears W. ascend.
47.00	Top of ascent Ridge bears S. 55° W. descend.
56.00	Foot of descent enter small valley bearing west.
61.34	Cross dry Aroyo 30 lks. wide bears N. 18° E. To a point in a mound of rock and earth, being Station No. 1 of the Rancho Ex Mission de San Fernando and Station No. 4 of Rancho La Providencia.

Thence

The line from Station No. 1 of the Ex Mission de San Fernando to Station No. 2 of the same. I also retrace and find the bearing of the line to be N. 20-1/2° W. and distance 210 chs. 68 links as given by the papent of the Rancho Ex Mission de San Fernando, From which I observe angle from my flag at Stat: X10 and Station S.F. 43 56°28'. By traverse from Station X10 to, this point I find the bearing to be S. 13°38' W. and the distance 258 chs. 80 links.

	Ch.	Lks.	N.	S.	E	W.
X10 S. 87° E.	126.	27		6.60	126.09	
S.F. 44 N. 7.18 E.	61.	34				7.79
S.F. 1 N. 20-1/2	210.	68	197.36			73.78
			258.20	6.60	133.88	
			6.60		72.78	
			251.60		60.10	

	Tan =	9384.619 =	13°38' S. W.
Log	25160	2400711	
Rx Log	6010	11785330	
S.	1338	9372373	
X10 to oak S. F.		2412957 *	258.80 chains
	22.54	0409.912	
	<u>56.28</u>	<u>1920.939</u>	
	56.28	2743.808 =	554.40
	38	0079061	
S. F. 43 to S.F. 2		1992478	
		2815347 =	653.65

T. 1 N. R. 14 W. M. D. M.

Chains

I now commenced at the Station No. 1 Rancho Ex Mission de San Fernando and retrace the Southern Boundary of La Providencia N. 88° E.

N. 88° E.
126.00

Var. 15° 00' East

To the mound of rock Station No. 5 of said Rancho
Thence

N. 20° 1/4 E.
62.86
114.00

Still retracing the Boundary of La Providencia.
Set temporary for intersection with Rancho "Los Felis"
To the Oak P. 6 Oak 30 inches in diameter, and as called
for the Official Survey of the same having retraced the
Ranch lines I now commence to subdivide the several portions
of T. 1 N. R. 14 W. S. B. Meridian

Commenced at the Cor. to Secs. 35 and 36 on the South
Boundary of the Township

North

Between secs. 35 and 36.

Var. 15° 05' East

2.00

along the west boundary of the Rancho "Los Felis".
Cross ravine 10 lks. wide course S. 80° W. ascend chaparral
hills.

24.00
40.00

Top of ascent, ridge bears S. W. by W. descend.
Set a sand stone rock 6 x 9 x 16 in. 8 inches deep and
raised a mound of sand stone rock 3 feet square 24 inches
high for 1/4 Sec. Cor. on the north slope of hill.

40.00
48.50

Foot of descent, enter ravine bears S. 80° W.
Cross ravine and ascend south slope of the Cahuenga
mountains.

80.00

Set a sand stone rock 10 x 16 x 20 in. 10 in. deep in ground,
raised mound of rock 30 inches sq. 24 inches high for cor.
to secs. 25-26-35-36.
Land rough and broken.
Soil 3rd rate.

North

Between Secs. T. 1 N. R. 14 W. S.B.M.

25 and 26.

Var. 15° 05' East

10.50
21.80

Along the west boundary of the Rancho "Los Felis" ascending
steep slope of the Cahuenga Mountains.

30.00
40.00

Top of ascent, descend across N. W. slope of same.
Leave mountain slope and descend steep north slope of same,
set a mound of rock.
Foot of steep descent and thence along the summit of a spur.
Raised a mound of rock 3 ft. square 20 inches high for 1/4
Sec. Cor.

43.00
46.50
57.50
63.00

To foot of spur and to ravine 60 lks. wide course N. 76° W.
Cross point of spur bearing N. E. set a mound of rock ascend.
Top of ascent ridge bears N. 78° W. & S. 80° E. descend.
Foot of descent, cross a ravine 20 lks. wide co. N. 10° W.

T. 1 N. R. 14 W. S. B. M.

Chains
63.88

77.00

Point for intersection with the lines of the Rancho La Providencia as per patent.
Intersect Rancho La Providencia as I find it on the ground, from which my temporary stake set by me while retracing the lines from Station No. 5 to Station No (of La Providencia bears S. 20-1/4° W. 4 chs. 72 lks. distant) making the entire distance from station No. 5 of the last mentioned Rancho to this point of intersection 67 chs. 58 lks. This is on the right and east bank of a ravine running N. 22° W. and from this point

I run north 20 lks. and set a sand stone rock 8 x 10 x 16 and raise a mound of stone 3 feet in diameter, 24 inches high From which a Live Oak 22 in. dia. distant 25 lks dist. bears N. 83° East. Land broken and covered with chaparral. Soil 3rd rate.

Commenced at the corner to Secs. 34 and 35 on the south boundary of the Township.
Between Secs. 34 and 35

North

Var. 15° 05' East.

Ascend from corner.
2.50 Top of ascent ridge bears W. descend.
7.00 Foot of descent to ravine.
7.50 Cross ravine, course S. 68° W. ascend.
12.00 Top of brushey ridge bears E. & W. and descend.
16.00 Foot of descent, ascend.
19.00 Top of ascent ridge bears E. & W. descend.
24.00 Foot of descent.
25.00 Cross ravine 100 lks. wide course S. W. ascend.
38.00 Top of ascent ridge bears S. W.
38.80 Descend.
40.00 Set a sand stone rock 10 x 12 x 16 inches in a mound of rock 3 ft. square 20 inches high for 1/4 sec. cor.
45.00 Cross a ravine 20 lks. wide course S. W.
Ascend steep hill.
60.00 Top of ascent ridge bears E. & S. 67° W.
62.00 Descend from ridge.
67.00 Foot of descent cross ravine 20 lks. wide course N. 50° W.
Ascend.
70.00 Top of ascent of low spur bears N. E. & S. W. and descend.
74.50 Cross steep gully runs S. 70° W. ascend.
80.00 Top of west slope of ridge, set a sand stone rock 7 x 12 x 18 inches for cor. to secs. 26-27-34-35 raised a mound of stone 4 ft. square, 20 inches high.
Land rough and broken mountains covered with chaparral brush.
Soil 3rd rate.

T. 1. N. R. 14 W. S. B. M.

Chains

East

On random bet. secs. 26 and 35
 Var. 15° 15' East

40.00 Set temporary 1/4 Sec. stake.
 80.22 Intersect N. & S. line at the cor. to secs. 25-26-35-36.
 West on true line bet. secs. 26 & 35
 Var. 15° 15' E.

0.60 Cross a ravine 50 lks. wide co. S. 5 E. ascend.
 3.00 Top of ascent ridge bears S.
 5.00 Descend.
 12.00 Foot of descent and to ravine.
 12.50 Cross ravine course S. ascend.
 18.00 Top of ascent ridge bears S. descend.
 25.00 Foot of descent and cross ravine 20 lks. wide course S. 10° W.
 Ascend.
 35.00 Top of ascent, ridge bears S. descend.
 40.11 Set a sand stone rock 12 x 16 x 24 in for 1/4 sec. cor.
 and raised a mound of sand stone rock 3 feet square and 20
 inches high.
 43.00 Foot of descent and ascend.
 56.00 Top of ascent and along summit of ridge.
 67.50 Descend along south slope of ridge.
 70.00 To summit again.
 72.00 Leave summit and descend its west slope.
 80.22 To the cor. to secs. 26-27-34-35.
 Land broken mountains covered with chaparral.
 Soil 3rd rate.

North

Between Secs. 26 and 27. Va. 15° 15' East.

2.00 Foot of descent cross ravine 6 lks. wide course S. W. ascend.
 7.00 Top of ascent ridge bears S. W. and at foot of steep
 mountain.
 12.50 Intersect the south boundary of the Rancho La Providencia 69
 chains 90 links N. 88° E. of Station No. 4 of said Rancho.
 Set a large rock 8 x 10 x 16 in. at the point of intersection,
 raised a mound of stone 3 feet in diameter 20 in. high.
 Land rough and broken.
 Soil 3rd rate.

West

Commenced at the corner to Secs. 26-27-34-35.
 Between Secs. 27 & 34
 Var. 15° 15' East.

Descend from corner.
 2.00 Foot of descent enter ravine.
 5.00 Leave ravine course south ascend.
 25.00 Top of ascent, ridge bears N. & S. descend.
 30.00 Foot of descent, ascend.
 35.00 Top of ascent, descend.
 40.00 Set 1/4 Sec. post 3 in. diam. 4 feet long 18 inches in the
 ground raised a mound of stone 3 feet sq. and 20 inches high.
 45.00 Foot of descent and in Canon bearing West.

T. 1. N. R. 14 W. M. D. M.

66.00 Leave Canon now bearing N. W. and ascend on North slope of hill.
71.16 Intersect the east boundary of the Rancho Ex Mission San Fernando 9 chains 84 links S. 7°18' W. of Station No. 1. Set a stone 8 x 10 x 14 inches at point of intersection, raised a stone mound 3 feet square 20 inches high. Land rough and broken. Soil 3 rd rate.

Commenced at the established cor. on the south boundary of the Township. Set for secs. 33 & 34.

North

Between Secs.

Thence
33 & 34
Var. 15° 5' East

1.50 Ascend from true corner.
5.50 Top of ascent, descend.
10.60 Top of descent and ascend.
17.00 Top of ascent and descend.
29.05 Foot of descent over rolling ground head of Cahuenga Pass. Intersect the south boundary Rancho San Fernando 2 chs. 45 lks. N. 87° W. of corner. Station No. 44, set stone at point of intersection 8 x 10 x 18 inches, raised a mound of rock 3 feet square 22 inches high. Land broken. Soil 3rd rate.

Commenced at the established corner on the south boundary of the Township set for cor. to secs. 32 and 33.

North

Between Secs.

Thence
32 and 33
Var. 14°55' East.

33.25 Over broken ground. Intersect the south boundary of Rancho San Fernando 82 chs. 56 lks. N. 87° W. from the corner station S. F. No. 44. Set a post at point of intersection, 4 in. square 4 feet long, 18 inches in the ground raised a mound of rock 4 feet square 20 inches high. Land broken chaparral brush. Soil 3rd rate.

Commenced at the established cor. to secs. 31 & 32 on the south boundary of the Township, Thence

North

Between Secs.

31 and 32
Var. 15°00' East.

17.00 Descend from corner.
26.00 Foot of descent cross ravine 100 lks. wide course S. E. Ascend. Top of ascent, descend.

T. 1 N. R. 14 W. S. B. M.

Chains

37.45 Intersect the south boundary Rancho San Fernando 162 chs.
67 lks. N. 87° W. from Station No. 44. Set post at point
of intersection 4 inches sq. 4 ft. long 18 inches in the
ground. Raised a mound of rock 4 feet sq. 20 inches high.
Land broken chaparral brush.
Soil 3rd rate.

Commenced at the Tp. Cor. to Rs. 14° 15' West.
Secs. 31 and 36.

North

Between Secs.

31 & 36

Var. 15°00' East.

8.00 Descend from corner.
Foot of descent cross ravine 20 lks. wide course S. W.
Ascend.
17.00 Top of ascent ridge bears E. & W.
20.00 Descent.
23.00 Foot of descent, ascend.
34.00 Top of ascent main ridge bears E. & W.
36.00 Descend.
40.00 Set 1/4 sec. post 3 in. dia. 4 feet long 18 in. in the
ground raised mound of stone 4 ft. sq. 20 inches high.
41.65 Intersect south boundary of Rancho San Fernando 242 chs.
80 lks. N. 87° W. from Station No. 44.
Set post at point of intersection 4 in. sq. 4 ft. long
18 inches in the ground. Raised a mound of stone 4 ft.
sq. 20 inches high.
Land broken covered with chaparral.
Soil 3rd rate.

Survey completed on the 16th day of Aug. 1879.
