

Copied from Photographic Copies  
 furnished by  
 U. S. General Land Office  
 Washington D. C.

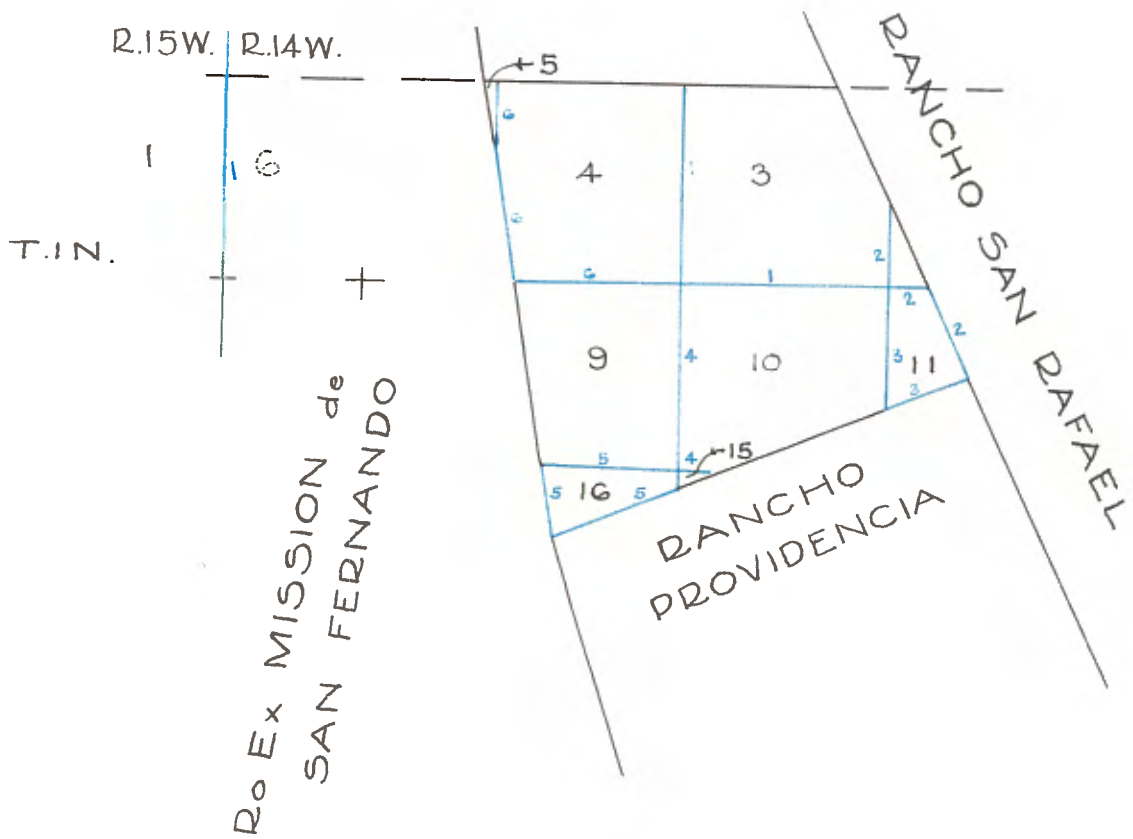

Blue lines, run by John Goldsworthy-1876

T. 1 N. R. 14 W. San Bernardino.

In order to find the proper Var. for subdividing the Township, I went to the N. W. corner (the E. line of the Township not being so well defined as the W.) and run Thence south on a blank line along the west boundary of Sec. 6. Var. 14° E.

40.03  
80.05

To point 30 lks. E. of 1/4 Sec. Cor.  
To point 58 lks. E. of cor. to secs. 6-7-1-12.  
To retrace this line or run parallel thereto I must adjust my compass to a Var. of 13°35' E.

---

Subdivision commenced Feb. 29th 1876.  
Subdivision completed March 4, 1876.

---

From the corner to secs. 3 and 4 33 and 34 on the north boundary of Township. I run, south between Secs. 3 and 4

3.00  
8.00  
21.60  
31.00  
32.00  
40.00

Var. 13°35' E.  
To road to Lansons house co. S. W.  
To Lansons house 9 chs. W. of line.  
To Southern Pacific Rail Road Co. S. E. and N. W.  
To road to Los Angeles co. S. 74° E.  
To wash 4 chs. wide co. S. 74° E.  
To 1/4 Sec. Cor. Set post 2 x 4 x 4 feet long with charred post on south side, 1 foot in ground and raised mound of earth 4-1/2 feet dia, 2 feet high with pits 18 in. square and 12 in. deep.  
To road course E. and W.  
To corner to sections 3-4-9-10  
Set post 4 in. dia. 4 feet long with charred post on south side 1 foot in ground and raised mound of earth 4-1/2 feet dia. and 2 feet high with pits 18 in. square and 12 in. deep from which and,  
Alder 12 in. dia. bears N. 81-1/2° W. 38 lks. and the house of Mrs. Grahams bears N. 26-3/4° West.  
Land level.  
Soil covered by granite wash and small boulders, 2nd Rate.

69.00  
80.00

---

East on a true line between sections 3 and 10  
Var. 13° 35' E.

10.50  
40.00

To house of H. C. Palmer 40 lks. south of line.  
To 1/4 sec. corner.  
Set post 2 x 4 and 4 feet long with charred post on east side 1 foot in ground and made a mound of earth 4-1/2 feet in dia. and 2 feet high with pits 18 in. square and 12 in. deep.  
To wash 10 chs. wide co. south.  
Leave same course south.  
To center line of Southern Pacific Rail Road Co. N. W. and S. E.  
To the corner to secs. 2-3-10-11. Set cedar post

60.00  
70.00  
73.46  
80.00

T.1 N. R. 14 W. San Bernardino

4 in. dia. 4 feet long with charred post on east side 1 foot in ground and raised mound of earth 4-1/2 feet in dia. 2 feet high with pits 18 in square and 12 in. deep.  
Land level.  
Soil 3rd rate.  
Land covered with Cactus and washed pebles and sand.

---

March 1st 1876.

North bet. Secs. 2 and 3.

10.00  
40.00  
42.00  
46.00  
50.55

Var. 13°35' E.  
To Cactus and brush co. S. S. E.  
To 1/4 Sec. corner.  
Set Elder post 2 x 3 x 4 feet long with charred post on north side 1 foot in ground and raised a mound of earth 4-1/2 feet dia. 2 feet high with pits 18 in. sq. and 12 in. deep from which an Alder 18 in. dia. bears east 125 lks.  
To north edge of brush and Cactus course east and west enter clear.  
To Los Angeles road course N. W. and S. S. E.  
To intersection of west line of "Rancho San Rafael" as previously flagged out in my survey of T. 2 N. R. 14 W. S. S. M.  
Set Elder post 2 x 4 4 feet long with charred stake on north 1 foot in ground and made mound of earth 4-1/2 feet dia. 2 feet high with pits 18 in. sq. and 12 in. deep.  
Land gently ascending.  
Soil 2nd rate.

---

East on a true line between Secs. 2 and 11

21.73  
25.00  
37.70  
38.70

Var. 13°35' E.  
To intersection of west line of "Rancho San Rafael" as previously flagged out by me.  
Set Elder post 2 x 3 4 feet long with charred stake on east side 1 foot in ground and raised mound of earth 4-1/2 feet diam. 2 feet high with pits 18 in. sq. and 12 in. deep.  
Land level.  
Soil 2nd rate.  
From which the N. E. corner of Rancho Providencia bears south 24° E. From this corner on the west boundary of "Rancho San Rafael" S. 24° E.  
Var. 13°35' E.  
Retracing west line of "Rancho San Rafael" as follows:  
To the house of Hines 3 chains west of line.  
To Los Angeles road N. W. and E.  
To the N. E. corner of the "Rancho Providencia" on west line of "Rancho San Rafael", which is a mound of stone on east bank of a run 100 lks. south of Los Angeles road

T. 1 N. R. 14 W. San Bernardino.

from which another pile of stone bears south 3° east dist. 140 lks.

I reset a 2 x 6 Redwood post 4 feet long in old mound of stones at N. E. corner of Rancho Providencia from this point my flag on the Oak tree "S. F. No. 2" and "P No. 3 at N. W. corner of Rancho Providencia" is visible and bears S. 67° W. I flagged this line through to the tree setting my flags so as to be able to intersect it in running south.

March 2nd 1876.

South between Secs. 10 and 11

	Var. 13°35' E.
5.00	To Los Angeles road course N. W. and S. E.
5.25	To center of Southern Pacific Rail Road course N. W. and S. E.
6.00	To north side of wash 6 feet deep course S. E.
17.00	Leave same wash course S. E.
28.00	To house of Frederick Ewengand 8 chains west of line.
40.00	To 1/4 sec. corner.
	Set 2 x 4 Elder post 4 feet long with charred stake on south side 1 foot in ground and raised mound of earth 4-1/2 feet diam. 2 feet high with pits 18 in. sq. and 12 in. deep from which an Elder 13 inches diam. bears S. 33-1/4° W. 48 lks. and the house of W. H. Graham bears S. 78° W.
43.50	To north edge of Messengers barley field course E. and W. in Sec. 10.
51.22	To intersection of the north line of "Rancho Providencia" as previously flagged out by me.
	Set Elder post 2 x 4 4 feet long with charred stake on north side in mound of earth 4-1/2 feet diam. 2 feet high with pits 18 in. sq. and 12 in. deep from which the house of George Messenger bears N. 78° W. dist. 12 chs. and the house of W. H. Graham bears N. 85-1/2° W. and the N. E. corner of the "Providencia" Rancho bears N. 67° E.
	Retracing said line as follows:
30.00	To wash course S. E.
37.25	Center of Southern Pacific Rail Road in wash course south.
39.50	To the east side of the above wash course S. E.
40.72	To the N. E. cor. of "Rancho Providencia".
	Land level.
	Soil 2nd rate.
	Land badly out by washes and runs.

1077  
37.25  
2.07  
63  
1082  
2082  
2390  
216  
13

82  
58  
75  
215.5

5.22  
60  
51.50  
31.20  
346.50

T. 1 N. R. 14 W. M. D. M.

South bet. Secs. 9 and 10.

Var. 13°35' E.

12.00

To wash 2 chains wide course S. E.

29.00

To north side of wash and Cactus course S. E. and N. W.

40.00

To 1/4 Sec. Corner.

Set post 2 x 3 4 feet long with charred stake on south side in mound of stone 4-1/2 feet diam. and 2 feet high from which an Elder 5 in. diam. bears N. 41° E. 70 lks dist.

52.00

To road course E. and W. and leave wash and Cactus course N. W. and S. E.

75.00

To road course E. and W.

80.00

To corner to Secs. 9-10-15-16.

Set Elder post 4 in. diam. 4 feet long with charred stake on south side 1 foot in ground and raised mound of earth 4-1/2 feet in diam. and 2 feet high with pits 18 in. sq. and 12 in. deep.

Land level.

Soil 3rd rate.

---

March 3rd. 1876

East on true line bet. Secs. 10 and 15.

Var. 13°35' E.

11.76

To intersection of north line of "Rancho Providencia" as previously flagged out by me.

Set Elder post 2 x 4 4 feet long with charred stake on east side 1 foot in ground and raised mound of earth 4-1/2 feet diam. 2 feet high with pits 18 in. square and 12 in. deep from which an Elder 10 in. diameter bears N. 89° west dist. 125 lks.

Land level.

Soil 2nd rate clear.

---

T. 1 N. R. 14 W. San Bernardino

South bet. Secs. 15 and 16

4.96  
Var. 13°35' E.  
To intersection of north boundary of "Rancho Providencia" as previously flagged out by me.  
Set Elder post 2 x 4 4 feet long with charred stake on south side 1 foot in ground and made mound of earth 4-1/2 feet in diam. 2 feet high with pits 18 in. sq. and 12 in deep.  
From which the live Oak tree "S. F. No. 2" and "P. No. 3" at the N. W. corner of "Rancho Providencia" bears S. 67° W.  
Retracing said line as follows:  
S. 67° W.

27.00  
51.50  
63.51  
Var. 13°35' E.  
To S. E. corner of Mr. Fromms barley field course north  
To the S. W. corner of Mr. Fromms barley field course N. 12° W.  
To a live Oak tree 40 in. dia. marked "S. F. No. 2" for San Fernando No. 2 and "P. No. 3" for Providencia No. 3.  
Land level.  
Soil 2nd. rate.

---

West on a true line between Secs. 9 and 16.

25.40  
40.00  
56.00  
62.23  
Var. 13°35' E.  
To N. E. corner of Mr. Fromms field course south.  
To 1/4 Sec. corner.  
Set post (Elder) 2 x 4 4 feet long with charred stake on west side 1 foot in ground and made mound of earth 4-1/2 feet diam. 2 feet high with pits 18 in. square and 12 in. deep from which Mr. Fromms house bears S. 47° W. dist. 7 chains.  
To the N. W. corner of Fromms field.  
To intersection of east line of Rancho San Fernando as previously flagged out by me in survey of T. 2 N. R. 14 W. S. B. M.  
Set 2 x 4 post 4 feet long with charred stake on west side 1 foot in ground and raised a mound of earth 4-1/2 feet in diam. 2 feet high with pits 18 in. square and 12 in. deep from which an Elder 7 in. diam. bears N. 29° E. dist. 199 lks. and Station No. 2 of San Fernando and Station No. 3 of Rancho Providencia bears S. 8° E.  
Retracing said line as follows:  
South 8° east

29.92  
Var. 13°35' E.  
To Station No. 2 of San Fernando and No. 3 of Providencia"  
Land level.  
Soil 2nd rate.

T. 1 N. R. 14 W. S. B. M.

March 4th 1876

West on a true line bet. secs. 4 and 9.

Var.  $13^{\circ}35'$  E.

5.00  
9.00  
27.00  
40.00

Mr. Grahams house bears N.

To wash 2 chains wide course S.

To wash 4 chains wide course S. S. E.

To 1/4 Sec. corner.

Set an Elder post 2 x 4 4 feet long with charred stake in the west side 1 foot in the ground and raised mound of earth 4-1/2 feet in diam. 2 feet high with pits 18 in. square and 12 in. deep from which a Dry Cedar 12 in. diam. bears N.  $86^{\circ}$  E. dist. 200 lks.

42.00  
68.80

Enter chemisal course N. and S.

To a large brushy top live oak 36 in. diam. 25 lks. N. of line.

73.33

To intersection of east line of "Rancho San Fernando as previously flagged out by me.

Set post 2 x 4 4 feet long with charred stake on west side in mound of earth 4-1/2 feet diam. 2 feet high with pits 18 in. sq. and 12 in. deep.

Land level.

Soil 3rd rate.

Covered with washes, brush and scattering cactus.

---

South between Secs. 4 and 5

Var.  $13^{\circ}35'$  E.

32.80

To intersection of east line of "Rancho San Fernando as previously flagged out by me.

Set Elder post 2 x 4 4 feet long with charred stake on south side 1 foot in ground and made mound of earth 4-1/2 feet diam. and 2 feet high with pits 18 in. square and 12 in. deep.

Thence

S.  $8^{\circ}$  E.

47.32

To post on east line of Rancho San Fernando bet. secs. 4 and 9

---

T. 1 N. R. 14 W. S. B. M.

Complete the survey of this Township the remainder being covered by Spanish Grants except a small portion in the southern part which is in the Cahuenga mountains and unsurveyable.

John Goldsworthy  
U. S. Dep. Surveyor

---

Report

This Township contains a very small amount of good farming land, has very little wood, and no water except what is obtained in wells by digging from 50 to 125 feet. It is mostly good for Bee men. There being quite a growth of cactus and sage.

John Goldsworthy  
U. S. Dep. Surveyor.

---