

COPIED FROM PHOTOGRAPHIC COPIES  
 FURNISHED BY  
 UNITED STATES GENERAL LAND OFFICE  
 WASHINGTON D.C.

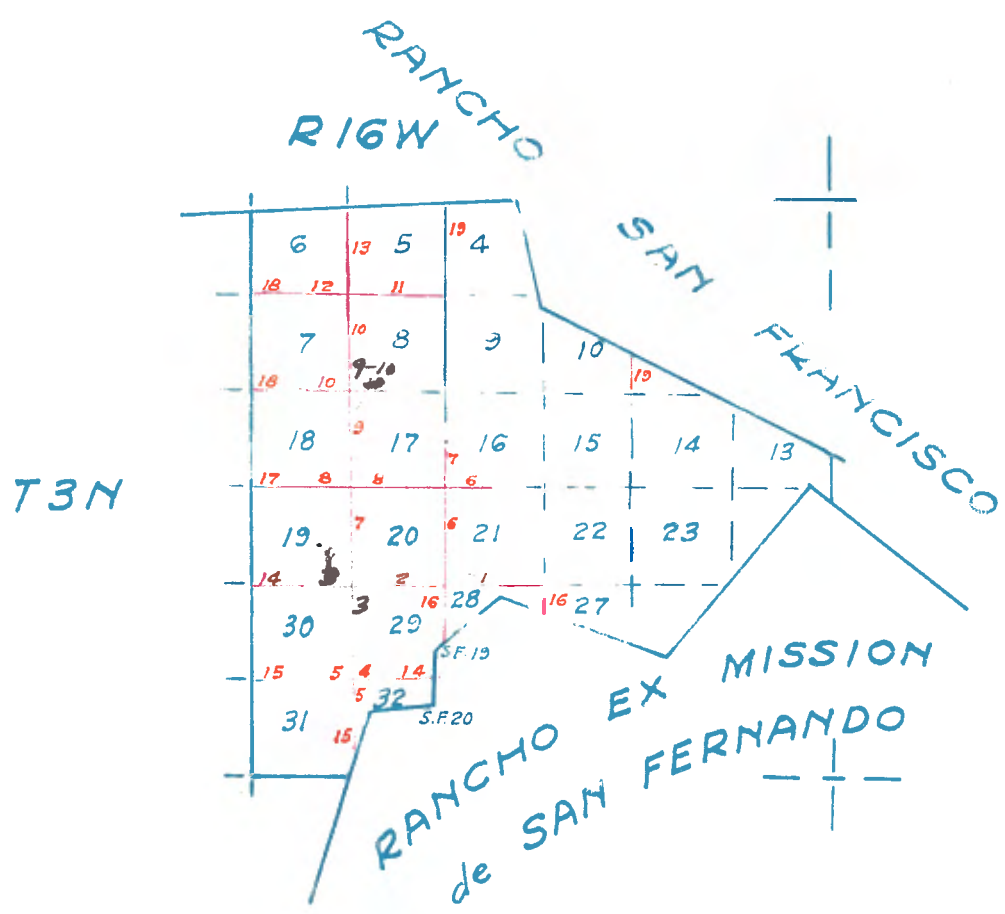

Lines Run By George H. Perrin 1896.

Copied from Photographic Copies  
Furnished by  
U. S. General Land Office  
Washington, D. C.

Survey commenced August 2nd, 1896, and executed with a Kennel and Kaser Transit No. 617, with solar attachment— the horizontal line having two double verniers reading to 1' of Arc.

The instrument was examined and listed on the true meridian at San Francisco and was approved by the Official Examiner of Instruments, Joseph Gale, as per Certificate No. 19, on file in office of U.S. Surveyor General of California.

At the cor. for Townships 2 and 3 North, Ranges 16 and 17 West, in Latitude 34°17' West; Longitude 118°39' West, at 10 hrs. 15 mi. P.M. by my watch (Pacific Coast Time). I observe Polaris and follow it until it reaches its Eastern elongation in accordance with instructions in the Manual and mark the line thus determined by a tack driven in a wooden plug set in the ground 5.00 chains North of my station.

At 6.30 A.M. I lay off the Azimuth of Polaris 1°29.9" to the west and mark the true meridian thus determined by cutting a mark on a rock in place west of the point determined before day-light.

The magnetic bearing of the true meridian is N 14°34' West which is reduced by table on page 100 of the Manual gives the mean magnetic declination of 14°31' E. August 4th, 1896, at 8 h. 6 mi. A.M. Corrected local mean time. Latitude 34°19' North. Longitude 118°36' West.

I set off Declination 17°01' North and determined my course by solar compass.

(407)

(Auxiliary Base)

Subdivisions of Twp. 3 N., R. 16 W., S. B. M.

Resurvey

Chains

From the cor. to Secs. 21, 22, 27 and 28, which is a Live Oak 28 ins. diam. marked and witnessed as described by Surveyor General

I run West on a true line bet. Secs. 21 and 28 along North slope of mountain. Cross Gulch 10 lks. wide, course North 50 ft. and ascend.

A house noted by Deputy Norway has been burned—foundation still visible.

to point for 1/2 Sec. cor. locus of which I established by the bearing tree, viz—

A white oak 36 ins. diam.

Bears N. 49 1/2° E 420 lks. dist.

Marked 1/2 S. 13 T and

Set an oak post 3 ft. long 3 ins. sq. with marked stone 24 ins. in the ground

for 1/2 Sec. cor.

Marked 1/2 S. on N. face, dug pits 18x18x12 ins. E and W of post 3 ft. dist. and raised a mound of earth 3 1/2 ft. base 1 1/2 ft. high N. of cor.

Corner stands on high spur towards N.E. Thence continue west on Auxiliary Base

Descend

Cross Canon corner North 3.50 below Sec. cor.

Cross wash, course North.

Mrs. Hanks house bears N 15° E 1.00 ch. dist.

Set a white oak post 3 ft. long 4 ins. sq. with marked stone 24 ins. in the ground for cor. to Secs. 20, 21, 28, and 29 marked

48.75  
55.00  
75.50  
80.00

40.00

9.50

Subdivisions of Twp. 3 N., R. 16 W., S. 8 N.

T 3 N. S. 21 on N.E.  
 R 16 W. S. 28 on S.E.  
 S 29 on S.W. and  
 S 20 on N.W. faces with 2 notches  
 on S. and 4 notches on E. edges dug pits 18x12 ins. in each  
 Sec. 5 1/2 ft. dist. and raised a mound of earth 4 ft. base 2 ft. high  
 From which  
 A live oak 16 ins. diam. bears  
 N 7 1/2 W 75 lbs. dist.  
 Marked  
 T 3 N. S. 16 W. S. 20 B.T.  
 A white oak 14 ins. diam. bears  
 S 22 1/2 W 34 lbs. dist.  
 Marked  
 T 3 N. S. 16 W. S. 29 B.T.  
 A live oak 24 ins. diam. bears  
 S 57 1/2 E 90 lbs. dist.  
 Marked  
 T 3 N. S. 16 W. S. 26 B.T.  
 No other tree within limits.  
 Land mountainous  
 Soil and rate  
 Timber Oak Walnut and Fir  
 Undergrowth same

Went on a true line bet. Secs. 20 and 29,  
 Ascend through dense timber and undergrowth.  
 Leave heavy timber and enter opening  
 bears N and S

Summit of Santa Susanna, Mountains bears N 30° W and S 30° E

600 ft. above Sec. cor. and descend abruptly.

Head of Canon, course South 200 ft. below ridges and ascend  
 Set an oak post 3 ft. long 3 ins. sq. with marked stone

24 ins. in the ground  
 for 1/2 Sec. Cor.

Marked 1/2 S. on N. face, dug pits 18x12 ins. E. and W. of  
 post 3 ft. dist. and

raised a mound of earth 3 1/2 ft. base  
 1 1/2 ft. high N of cor.

From which  
 A white oak 14 ins. diam. bears

N. 31 1/2 E 125 lbs. dist  
 marked 1/2 S.B.T.

No other tree within limits No. Mahon's house bears  
 N 40 E about 30 lbs. dist.

Summit of Santa Susanna Mountain bears  
 N. 60° E. and N. 60° W.

Descend  
 Gross Canon 20 lbs. wide, course S.W. 300 ft. below Ridge and

ascend along slope.  
 Top of spur trends S.W. + 300 ft. and

Descend.  
 Gross canon 10 lbs. wide corner South and ascend.

Set a slate stone 14x6 ins. 9 ins. in the ground for cor.  
 to Secs. 19, 20, 29 and 30.

Marked with 2 notches on S. and 5 notches on E. edges and  
 raised a mound of stone 2 ft. base 1 1/2 ft. high

N. of cor.  
 pits impracticable  
 Land mountainous

Soil and rate  
 Timber Oak  
 Undergrowth same.

50.00  
 76.00  
 71.00  
 64.00  
 57.50  
 45.00  
 40.00  
 26.00  
 20.50  
 9.00

August 5th, 1896. At 8 hr. 6 mi. A.M. Corrected local mean time Latitude 34°19' N. I set off destination 16°45' N and determine my course by Solar Compass  
 I now go to the cor. to Secs. 19, 20, 29 and 30, I run, S. 0°1' E. bet. Secs. 29 and 30. I find I cannot chain this line South from cor. on account of abrupt nature of the ground. I therefore run East on old set 20.50 chs. S 0°1' E 9.50 chs. West 2.00 chs. S 0°1' E 10.50 chs. West 3.50 chs. S 0°1' E 20.00 chs. West 15.00 chs. to line Also point for § sec. cor. Set a walnut post 3 ft. long 3 ins. sq. with marked stone 24 ins. in the ground for § sec. cor. Marked § S. on W. face dug pit 18x12 ins. N and S of post 3 ft. dist. and raised a mound of earth 3 ft. Base 1 1/2 ft. high W of cor. From which A walnut 10 ins. diam. bears N 30° E 127 lks. dist.

(40.00)

Subdivisions of Twp. 3 N., R. 16 W., S. B. M.  
 West on a true line bet. Secs. 19 and 30. Descend abruptly. I find it impracticable to chain across canon in advance. I cause a flag to be set on opposite side and measure a base at right angles North 15.00 chs. Flag bears S. 45°05' W. Angle 44°55' Nat. cot.  $1.003 \times 15.00 =$  To flag on west side of canon 15.05 Descend To East end of impassable gorge and set a flag on opposite side and measure base North 10.00 chs. Flag bears S 44° W angle 46° Nat. cot.  $9656 \times 10 = 9.66 \times 2450 =$  Ascend steep rocky bank 40.00 Set a slate stone 36x12x15 ins. 27 ins. in the ground for § sec. cor. Marked § S on W face and raised a mound of stone 2 ft. base 1 1/2 ft. high N of cor. pits impracticable.

NOTE: Having found that a portion of exterior and ranch lines upon which I must close my lines under this contract show great inaccuracies in the original work. I discontinue my notes here until I can apply to office for authority to resurvey the lines necessary to close on and prove my work. Land mountainous and broken Soil 5th rate Timber Oak Undergrowth same August 4th, 1896.

Subdivisions of Twp. 3 N., R. 16 W., S. 8 N.

Marked  $\frac{1}{2}$  S.B.T.  
 No other trees within limits.  
 Cross wire fence, bears E. and W. and  
 Descend  
 Descend off point of spur.  
 A live Oak 10 ins. diam. for cor. to Secs. 29, 30, 31 and 32  
 I marked  
 T 3 N S. 29 on N.E.  
 R. 16 W. S. 32 on S.E.  
 S. 31 on S.W. and  
 S. 30 on N.W. side with 1 notch  
 on S. and 5 notches on E. sides dug pits  
 18x12x12 ins. in each Sec. 5 ft. dist. and raised a mound of  
 earth around tree.  
 From which  
 a live Oak 10 ins. diam. bears S. 40° E 4 lks. dist.  
 Marked  
 T 3 N., R. 16 W. 32 S.T.  
 A live Oak 6 ins. diam. bears  
 N. 45° E 4 lks. dist.  
 Marked  
 T 3 N R 16 W. S. 29 S.T.  
 No other trees within limits  
 Land 40.00 chs. very broken and mountainous  
 Last 40.00 chs. open grassy mountains  
 Soil 2nd and 4th rate  
 Timber oak and walnut  
 Undergrowth of same.

---

East on a true line bet. Secs. 29 and 32  
 Ascend  
 Top of spur trends South and descend.  
 Cross ravine 15 lks. wide corner S 10° E and  
 Ascend.  
 Top of spur trends South 200 ft. above cor. and descend and  
 enter dense brush.  
 To edge of canon.  
 Being unable to chain across I cause a flag to be set on  
 line and measure a base South 7.50 chs. flag bears N 45° E  
 Cor. 45° 1.0x7.50 = 7.50  
 Being unable to reach true point for  $\frac{1}{2}$  Sec. cor.  
 A live Oak 16 ins. diam. I  
 marked  
 W. O.  $\frac{1}{2}$  S. on N side  
 from which  
 A live Oak 10 ins. diam.  
 bears S. 44° E 33 lks. dist.  
 marked  $\frac{1}{2}$  S.W. S.B.T.  
 No other trees within limits.  
 This witness Cor. is 2.50 chs. East of proper point for  
 $\frac{1}{2}$  Sec. Cor.  
 For this reason given in Note on Page 5 I discontinue my  
 notes for the present.  
 Land mountainous  
 Soil 2nd and 3rd rate  
 Timber Oak and Walnut  
 Dense undergrowth of same and Chinquapin.

42.50  
35.00  
23.00  
5.25  
3.50

45.39  
65.00  
80.00

August 6th, 1896. At 8 hr. 6 M. A.M. Corrected local mean time. Latitude 34°19' N. I set off destination 16°27' N. and determine my course by being compass.

August 5th, 1896.

Land mountainous. Soil red. Timber oak. Undergrowth same and Chinese.

From the cor. to base. 29, 30, 31 and 32, I ran, went on a line bet. base. 30 and 31, Descend. Gross having course S. 25° E. and ascend. 13.00 Gross trail base N.W. and S.E. Top of central hill and descend. 20.50 Gross canon 30 hrs. wide, course S. 30° W and ascend. 29.00 To edge of high dirt and as it is impracticable to reach this point for § sec. cor. I set a sand stone 16x10 ins. 11 ins. in the ground for witness to § sec. cor. Marked W. G. § S. on N. face and raised a mound of stone 2 ft. base 1 1/2 ft. high N. of cor. This W.G. is 6.15 hrs. East of true point for § sec. cor. Reques horse base S. 40° W For the reason given in note on page 5, I discontinue my notes for the present.

33.85  
29.00  
20.50  
13.00  
5.00

Land mountainous. Soil red. Timber oak and Walnut. Undergrowth of same.

From the cor. to base. 29, 30, 31 and 32, I ran, went on a line bet. base. 31 and 32, Descend. Gross canon 20 hrs. wide, course S 60° E. 200 ft. and ascend. 7.70 Gross trail on top of spur, trends S 60° E. + 100 ft. and descend. 11.20 Gross canon 20 hrs. wide, course S 60° E. + 300 ft. and ascend. 14.50 Gross canon 25 hrs. wide, course S 60° E. + 100 ft. and ascend. 21.00 Top of spur trends S. 70 E. + 100 ft. and descend. 29.75 Gross canon 5 hrs. wide, course S. 80° E. 150 ft. and ascend. 40.00 A Walnut 7 ins. diam. for § sec. cor. I marked § S. on W. side, dug pits 16x16x12 ins. N. and S. of cor. 4 ft. dist. and raised a mound of earth and stone around tree. For the reason given on page 5 I discontinue my notes for the present.

40.00  
29.75  
21.00  
14.50  
11.20  
9.50  
7.70

Subdivisions of Twp. 3 N., R. 16 W., S. 8 N.

Subdivisions of Twp. 3 N., R. 16 W., S. 8. N.

From the cor. to Secs. 20, 21, 28 and 29  
 I turn  
 N 0° 1' W. between Secs. 20 and 21.  
 Descend.  
 Mrs. Hand's water pipe bears E. and W.  
 Cross gulch course East and ascend.  
 Top of ridge bears N. E. and S. W. 300 ft. above cor. and descend.  
 Head of Ravine course N. E. and ascend.  
 Impossible to chain on line on account  
 of high rocks in advance  
 I therefore offset East 150 lks. thence N 0° 1' West.  
 Cross canon 20 lks. wide, course East 400 ft. below ridge  
 40.00 the point for § Sec. cor. falling on inaccessible rocks.  
 I continue North  
 Offset West 150 lks. to line on top of rocky spur trend East  
 and a post oak 10 ins. diam. I mark  
 W. G. § S. on W. side for  
 witness to § Sec. cor. dug pits 18x12 ins.  
 N. and S. of cor. 4 ft. dist. and raised a mound of earth  
 around tree.  
 This cor. is 4.00 chs. N. 0° 1' W. of true point for corner.  
 Top of spur trends N. E. and descend.  
 Enter Ravine and down same.  
 Leave ravine, course N. 20° E. and ascend.  
 Set a sand stone 20x20 ins. 15 ins. in the ground for cor.  
 to Secs. 16, 17, 20, and 21, marked with 3 notches on S. and  
 4 notches on E. edges and raised a mound of stone 2 ft.  
 base 1 1/2 ft. high W. of cor.  
 pits impracticable.  
 Land broken and mountainous.  
 Soil 4th Rate and rocky.  
 Timber none.  
 Dense undergrowth of chapparal and Chinquapin.

---

East on a random line bet. Secs. 16 and 21.  
 To a point 31 lks. South of old § Sec. cor., which is a badly  
 decayed chapparal post in old stone mound.  
 I destroy same and set a new oak post 3 ft. long 3 ins. sq.  
 with marked stone 24 ins. in the ground, marked § S. on N. face  
 and rebuilt a mound of stone 3/4 ft. base 1 1/2 ft. high N. of  
 cor.  
 Thence, I turn,  
 S. 89° 3/4' W. on a true line bet. Secs. 16 and 21.  
 Ascend through dense Chapparal  
 Top of high rocky ridge bears N. 20° E and S. 20° W + 500 ft.  
 above cor. and  
 Descend  
 Cross ravine 10 lks. wide, course N 10° E 300 ft. below ridge  
 and ascend.  
 The cor. to Secs. 16, 17, 20 and 21

Land mountainous  
 Soil 3rd Rate, rocky  
 Timber Oak  
 Dense undergrowth of chapparal

39.75  
 37.20  
 27.00  
 39.75  
 58.00  
 63.00  
 77.80  
 80.00  
 44.00  
 34.60  
 30.00  
 24.30  
 12.50  
 1.77  
 1.31



Subdivisions of Twp. 3 N. R. 16 W., S. 31 N.  
N 0-1' W on a random line bet. Secs. 16 and 17.  
To a point 17 lks. west of old witness to § Sec. cor. which  
is a live oak 30 ins. diam. marked and witnessed as described  
by survey general,  
Thence I run  
S 0-1 1/2' W on a true line bet. Secs. 16 and (21).  
17

Ascend through dense Chaparrals.  
Point for true corner.  
Top of high spur trends N. E. and descend abruptly.  
Spur + 400 ft. above § sec. cor.  
The cor. to Secs. 16, 17, 20 and 21  
Land broken and nonuniform.  
Soil 3rd and 4th rates, rocky.  
Timber none.  
Dense undergrowth of Chaparral.

42.05  
1.56  
33.56  
42.05

From the cor. to Secs. 19, 20, 29, and 30.  
I run,  
N 0-1' W. bet. Secs. 19 and 20.  
Ascend along west slope of spur.  
Summit of Santa Susanna Mts. bears  
E and W 150 ft. above cor. and descend.  
To dense jungle—impracticable to chain through.  
Offset west 3.00 chs.  
N 0-1' W 10.25 chs.  
East 3.00 chs. to line.  
To dry canon, course N 10° E 600 ft.  
Below ridge.  
Set a walnut post 3 ft. long 3 ins. sq. with marked stone  
24 ins. in the ground for § sec. cor.  
Marked § S. on W. face, dug pits 18x18 ins. N. and S.  
of post 3 ft. dist. and raised a mound of earth 1/2 ft. base  
1 1/2 ft. high W. of cor.  
From which,  
A white oak 12 in. diam. bears  
S. 65-90' E. 24 lks. dist.  
Marked § S. N. E.  
A live oak 30 ins. diam. bears  
S. 45-90' W 37 lks. dist.  
Marked § S. N. E.  
Ruins of old house bears S. 40° W 300 lks. dist.  
Enter dense thicket of Walnut  
Crows spring through 5 lks. wide, course N. E.  
Gross dry canon, course N. 20° W 300 ft. below § Sec. cor.  
and ascend.  
Top of spur trends N. W. and  
Descend.  
(Enter bed of creek 8 lks. wide, course North).  
Point falling in creek. I set a Gypsum post 3 ft. long  
4 ins. sq. with marked stone 24 ins. in the ground for  
witness to cor. to Secs. 17, 18, 19 and 20.  
Marked  
N. O. T. 3 N. S. 17 on N. E.  
N. 16 W. S. 20 on S. E.  
S. 19 on S. W. and  
S. 18 on N. W. faces with 3 notches on S. and 5 notches  
on E. edges, dug pits 18x18 ins. in each Sec. 1/2 ft. dist.  
and raised a mound of earth 4 ft. base 2 ft. high W. of cor.

46.50  
53.90  
54.75  
61.50  
78.00  
80.00

Counting from proper point, West on a true line bet. Secs. 18 and 19 To witness corner and ascend abruptly. Top of spur trends N.E. 400 ft. above cor. and descend and Enter dense Chaparral. Gross Canon 25 lks. wide, course N 20° E. 400 ft. below spur and ascend. Set a sand stone 24x10x6 ins. 18 ins. in the ground for § Sec. cor. Marked § on N. face and raised a mound of stone 2 ft. base 1 1/2 ft. high N. of cor. pits impracticable.

Land mountains. Soil 3rd and 4th rate. Dense undergrowth of Chaparral and Chinquiseal

Counting from proper point, East on a random line bet. Secs. 17 and 20. Set temporary § Sec. cor. Interest N. and S. line 31 lks. South of cor. to Secs. 16, 17, 20 and 21. Thence, I run, S. 89° 47' W on a true line bet. Secs. 17 and 20 Ascend abruptly in Chaparral Top of rough rocks spur trends North and descend + 150 ft. Gross canon 60 lks. wide, course N. 20° E. 250 ft. below spur and ascend. Set a sand stone 18x12x8 ins. 12 ins. in the ground for § Sec. cor. Marked § on N face and raised a mound of stone 2 ft. base 1 1/2 ft. high N. of cor. pits impracticable. This Co. is set on East slope of brushy spur. Gross Canon 20 lks. wide course North 150 ft. and ascend. Top of spur trends North 175 ft. above Canon and descend. The cor. to Secs. 17, 18, 19, and 20, 100 ft. below spur. 80.43

Soil 2nd and 3rd rate. First 20.00 aca. open wild oats. Timber Oak and Walnut. Undergrowth same.

From which A Live Oak 18 ins. diam. bears S. 7° E. 43 lks. dist. Marked T. J. N. R. 16 W. S. 20 W.C.B.T. A Live Oak 14 in. diam. bears N. 16° W. 45 lks. dist. Marked T. J. N. R. 16 W. S. 18 W.C.B.T. No other tree within limits. This witness cor. is set 15 lks. West of proper point for Land broken and mountainous.

Subdivisions of Twp. 3 N., R. 16 W., S. B. N.

Subdivisions of Twp. 3 N. R. 16 W., S. R. N.

For the reasons given in Note on Page 5, I discontinued my notes for the present. Land broken and mountains. Soil, thin rate. No timber. Dense undergrowth of Choptal. August 6th, 1896.

August 7th, 1896. At 8 1/2 A.M. Corrected local mean time. Latitude 34° 20' North, I set off destination 16-11' N and determine my course by Solar Compass. Counting from proper point. N 0-1' W. bet. Secs. 17 and 18. Descend in creek bottom. Leave creek, course N 5° W. and along bank of same. Enter dense Choptal. Cross creek 1/2 m. wide, course East and Ascend. Sheep Hill. Top of Spur trends S 80° E + 300 ft. above cor. and Descend. Cross Canon, course S. 89° E + 300 ft. below spur and Ascend.

40.00 Set a sand stone 18x18x12 ins. 8 ins. in the ground for 1/2 sec. Cor. Marked 1/2 on N. face, dug pits 18x18x12 ins. N. and S. of stone 3/4 ft. dist. and raised a mound of earth 3/4 ft. base 1 1/2 ft. high W. of cor. Top of Spur trends East + 300 ft. and descend over rough broken land through dense Choptal. Cross Ravine, 15 ins. wide, course S. 75° E 290 ft. and ascend. Intersect South line of Temple Oil Mine 15.55 chs. East of S. W. cor. Set a sand stone 18x18x12 ins. 12 ins. in the ground for cor. to Secs. 7, 8, 17 and 18. Marked with 4 notches on S. and 5 notches on E. edges and raised a mound of stone 2 ft. base 1 1/2 ft. high W. of cor. 600 ft. Land broken and mountains. Soil thin rate, rocky. Timber Oak. Dense undergrowth same and Choptal.

40.66 East on a random line bet. Secs. 8 and 17. To a point 25 ins. South of old 1/2 sec. cor. which is a partially decayed post in rock mound. I set a new post 3/4 ft. long 3/4 ins. sq. with marked stone 24 ins. in the ground. Marked 1/2 S. on N. face and rebuilt the mound of stone 3/4 ft. base 1 1/2 ft. high W. of cor. This is impracticable. Thence, I ran, S. 89° 40' W. on a true line Descend in Choptal. Cross Creek 5 ins. wide, in deep canon 4.35

A white oak 30 ins. diam.  
Bears N. 69° E 55 lks. dist.  
Marked  
W.O. 1/2 S.N.T.  
No other trees within limits.  
This witness corner is 1.00 chs. S. 0° 1' E of proper point  
for corner and on top of high hill.  
Descend.

15.76 Ascend through Temple Oil Mine  
Intersect North line of Temple Oil Mine and South line of  
Temple Oil Mine known location  
5.75 chs. West of S.E. cor.  
Top of Spur trends S.E. + 300 ft. above Sec. Cor. and continues  
Ascent.  
As the proper point for Sec. Cor. fall on steep side hill,  
not a suitable place for corner,  
I set a live oak post 3 ft. long 3 ins. sq. with  
marked stone 24 ins. in the ground for  
Witness to Sec. Cor.  
Marked W.O. 1/2 S. on W. face, dug pit  
18 inches ins. N. and S. of post 3 ft. dist. and raised a  
mound of earth 3/4 ft. base, 1 1/2 ft. high, W. of cor.  
from which,

17.00  
19.00  
21.00  
21.50  
22.00  
23.00  
24.00  
25.00  
26.00  
27.00  
28.00  
29.00  
30.00  
31.00  
32.00  
33.00  
34.00  
35.00  
36.00  
37.00  
38.00  
39.00  
40.00  
41.00  
42.00  
43.00  
44.00  
45.00  
46.00  
47.00  
48.00  
49.00  
50.00  
51.00  
52.00  
53.00  
54.00  
55.00  
56.00  
57.00  
58.00  
59.00  
60.00  
61.00  
62.00  
63.00  
64.00  
65.00  
66.00  
67.00  
68.00  
69.00  
70.00  
71.00  
72.00  
73.00  
74.00  
75.00  
76.00  
77.00  
78.00  
79.00  
80.00  
81.00  
82.00  
83.00  
84.00  
85.00  
86.00  
87.00  
88.00  
89.00  
90.00  
91.00  
92.00  
93.00  
94.00  
95.00  
96.00  
97.00  
98.00  
99.00  
100.00

West on a true line bet. Secs. 7 and 18.  
Ascend through dense Chaparral.  
Intersect West line of Temple Oil Mine  
14.75 chs. North of S.W. cor.  
Summit of Santa Susana Mountain bears  
N. 20° E and S. 20° W + 700 ft. above cor. and descend.  
Head of Sulphur Creek 200 ft. course S. 70° W. and ascend.  
Set an oak post 3 ft. long 3 ins. sq. with marked stone 24  
ins. in the ground for Sec. cor.  
Marked 1/2 S. on N. face and raised a mound of stone 3/4 ft.  
base, 1 1/2 ft. high. N. of cor.  
Pits impracticable.  
For the reasons given in Note on Page 5,  
I discontinue my notes for the present.  
Land broken and mountainous.  
Soil 3rd rate, rocky.  
Timber none.  
Dense undergrowth of Chaparral.

Top of Ridge bears N.E. and S.W. + 400 ft. above Creek and  
Descend.  
The cor. to Secs. 7, 8, 17 and 18.  
Dense undergrowth of Chaparral.

August 27th, 1896. At 5 A.M. Corrected local mean time. Lat. 34-22' N. I set off base, 15-54' N. and determine my course by Bojor compass. East on a random line bet. Secs. 5 and 8. Set temporary & sec. cor. Intersect N. and S. line 49 lks. South of cor. to Secs. 4, 5, 6, and 9, which I locate by the old bearing tree. A diameter 20 in. diam. bears S. 11° W 50 lks. dist. This tree has fallen down but marks still visible, and after diligent search am unable to find old post and set an Oak post. 3 ft. long & ins. sq. with marked stone 24 ins. in the ground. Marked I. 3 N. S. 4 on N.E. N. 16 W. S. 9 on S.E. S. 18 on S. W. and S. 15 on N.W. Trees with 5 notches on S. and 4 notches on E. edges, and raised a mound of stone 4 ft. base, 2 ft. high, N. of cor. Pits impracticable. Trees which

40.00  
50.46

August 17th, 1896. Dense undergrowth of Chagatal. Timber oak.

Land broken and mountainous. Soil 3rd rate.

No other trees within limits

Marked, I. 3 N., N. 16 W. S. 7 N.E.

A live oak 24 ins. diam. bears S. 22-30' W. 300 lks. dist.

From which,

This cor. is set on south side of steep spur.

raised a mound of earth 4 ft. base 2 ft. high, W. of cor. dug pits 12x12x12 ins. in each sec. 5 ft. dist. and S. 6 on N. W. Trees with 5 notches on S. and 4 edges S. 7 on S. W. and N. 16 W. S. 8 on S.E. I. 3 N. S. 5 on N.E.

Marked

Cor. to Secs. 5, 6, 7, and 8,

ins. in the ground for

Set a Walnut post 3 ft. long & ins. sq. with marked stone 24

200 ft. below ridge and ascend.

Cross ridge 10 lks. wide, course N.W.

ascend through dense chagatal over rough rocky ground.

Top of ridge bears N.E. 4 S.W. + 200 ft. and descend

cross canon 40 lks. wide, course N.E. and ascend + 600 ft.

Old mine 5.54 ins. west of S.E. cor.

Intersect South line of Alameda

Subdivisions of Twp. 3 N., R. 16 W., S. 8 N.

45.46  
53.00  
68.00  
78.00  
80.00