

Copied from Photographic Copies  
furnished by  
U. S. General Land Office  
Washington, D. C.

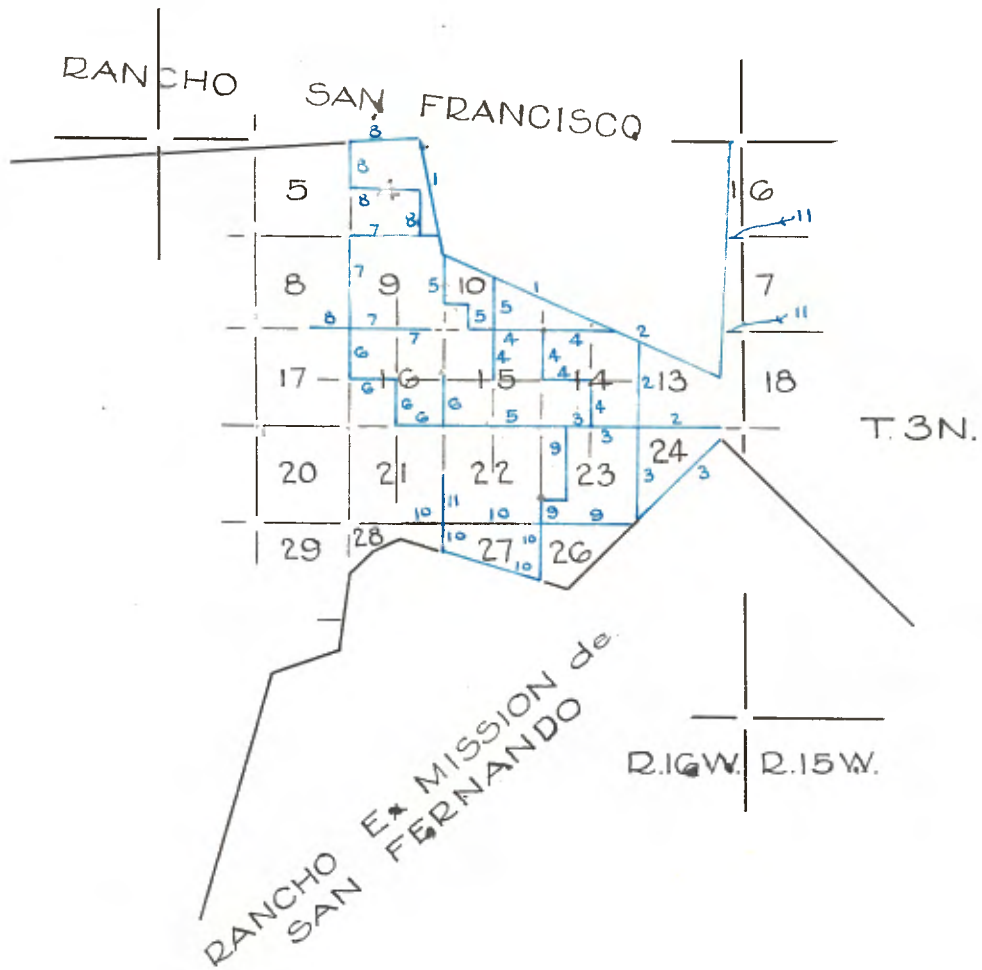

Blue lines, run by W. H. Norway - 1875

TP. 3 N. R 16 W., S. B. M.

As there is such a discrepancy bet. the location of Oak Street and S.F. No. 5, made by Deputy Surveyor Thompson, and by Deputy Surveyor Wheeler, I find it necessary to resurvey a portion of the Rancho San Francisco,

I begin at an Oak tree, 18 in. dia. standing on the point of a low hill, on the South Boundary of the Township 4 N, Range 16 West, of San Bernardino base and Meridian 16.50 chs. West of the cor. to Secs. 3, 4, 33, 34, marked S.F. No. 3, and run, thence according to the courses reported by Thompson

3rd

S 11° 35' E.

Var. 14° 10' E.

finding the topography to agree to that reported by Thompson and at

82.92

to an Alder tree marked S.F.No.4.

from this cor. to cor. No. 5, passes over a very rough and broken country too rough to measure. I, therefore, run it through and flag it without measurement.

S. 64° 50' E.

chs. to a point .08 lks.

North of the Live Oak tree and S.F.No. 5, standing on the east side of the old road at the foot of the Pass, at a place called La Cuesta or Purto. I assume the distance reported by Thompson 255.13 chs. to be correct.

I run,

N. 1° E.

Var. 14° 10' E.

14.00

Summit of a spur, bearing NE & SW

17.50

Cross ravine, course N.W.

20.00

Old road, bears NW and SE, thence along base of hills. East of stage road

34.00

Cross ravine, on wash and ascend

38.50

Summit of spur, bearing E & W, and descend

47.50

Cross gulch, course West

53.00

Summit of a spur, bearing E & W and descend

57.50

Cross a ravine, course West

77.00

Enter valley, bearing N & S

98.50

Cross creek .06 lks. wide, course West

101.00

Leave valley, bears E. & W.

113.00

Enter valley, bears E. & W.

120.00

Cross dry gulch .50 lks. wide, course West, leave valley and ascend.

123.00

Summit of spur and descend

142.50

Cross gulch in timbered Canada .50 lks. wide, course West

147.30

Cross gulch, course West .50 lks. wide

178.00

Cross gulch, near head .50 lks. wide, course N.E.

188.00

Leave hills, enter valley of the Canada "Los Placentas"

189.61

Intersect the Northern Bdy of the Tp. 3 N., Range 16 West, 7.40 chs. West of the cor. to Townships 3 and 4 N., Ranges 15 and 16 West, and set an Oak Post 3 x 3 in. 3 ft. long in a mound of rocks as instructed for cor. to frac Secs. 1 & 36, from which,

A live oak, 4 ft. in dia. bears S. 85½° W. 2.20 chs. dist.,

I, therefore, find the courses and distances given by Thompson to be correct

The connection reported by Dep. Surveyor Wheeler is erroneous. Dep. Wheeler has taken the wrong tree for S.F.No. 5, as there is a tree below on the East side of the road marked with a "t" which is regarded by some as being the Rancho cor., but its dimensions and positions does not agree with the Field notes as reported by Thompson and Hancock.

December 15th, 1875.

Tp.3 N., R.16 W., S.B.M.

From the cor. to Secs. 13, 14, 19, 24, on the Eastern Boundary of the Township,  
I run,

West, on a true line bet. Secs. 13 & 24.  
Var.  $14^{\circ}10'$  E.

- 4.00 Cross gulch, near head.  
6.75 To a point 4.50 chs. North of cor. No. 15, of the final Survey of the rancho Ex Mission of San Fernando.  
8.27 Cross gulch, course South then enter canada leading through San Fernando Pass at Railroad Camp.  
11.50 Cross ravine, bears  $S.20^{\circ}$  E.  
12.50 Cross road leading through San Fernando Pass, bears  $S.20^{\circ}$  E. and  $N.20^{\circ}$  W.  
18.82 South cor. of a house.  
20.50 Leave canada, and ascend, bearing NW and SE  
29.00 Summit of a ridge and trail, bearing NW and SE, thence along on South slope.  
31.50 Cross line of S.P.R.R. over tunnel about 12.00 chs. Northwesterly of the South terminus of tunnel.  
40.00 Set an Oak post 3 x 3 in. 3 ft. long in a mound of rocks on low hill, as instructed for  $\frac{1}{4}$  Sec. Cor., from which,  
A Live Oak, 10 in. in dia. bears  $N.82^{\circ}$  E. 50 lks.  
43.50 Summit of a spur bearing N & SE and descend  
54.00 Cross creek 06 lks. wide, course S.E.  
54.50 Cross wagon road, bearing NW and SE "wood road" and ascend  
64.00 Summit of a spur bearing N and S and descend.  
69.00 Cross deep gulch in canada, course NE and ascend  
80.00 Set an oak post 4 x 4 in  $3\frac{1}{2}$  ft. long in a mound and pits on East edge of a high grass adobe hill, as instructed for Cor. to Secs. 13, 14, 23, 24, from which,  
A Live Oak, 24 ins. in dia. bears  $N.32\frac{1}{2}^{\circ}$  E 1.10 chs  
A Live Oak, 10 ins. in dia. bears  $S.42\frac{1}{2}^{\circ}$  W 29 lks.  
Land very rough over broken hills, 1st and 2nd and 3rd rate, soil.  
Timber Live Oak.

---

North, bet. Secs. 13 and 14.

Var.  $14^{\circ}10'$  E.

Descending

- 12.00 Cross gulch, course SE  
32.60 Cross road on summit of ridge, dividing water of San Fernando and Santa Clara River or Valley, course SE and NW.  
32.70 Edge of steep bluff side hill. I set an Oak post, 3 x 3 in. 3 ft. long in a mound of rocks as instructed for witness to  $\frac{1}{4}$  Sec. Cor. as the true cor. will fall on steep side hill not a suitable place to build a monument, from which,  
A Live Oak, 20 in. in dia. bears  $N.5^{\circ}$  W. 45 lks.  
thence descending  
40.00 The point for  $\frac{1}{4}$  Sec. Cor.  
66.50 Cross gulch, near head, course E. and ascend  
70.76 Intersect the Southern Boundary of the Rancho San Francisco and set a redwood post 3 x 3 in. 3 ft. long in a mound of rocks as instructed for cor. to frac. Secs. 13 and 14 from this cor. I run along the Southern Boundary of the Rancho San Francisco  $S.64^{\circ}50'$  E.  
77.06 To cor. No. 5 of the final Survey of Rancho Land very rough 2nd and 3rd rate with good timber for fuel in places. Oak and fir.

Tp. 3 N., R. 16 W., S.B.M.

From the cor. to Secs. 13, 14, 23, 24, I run,  
 South bet. Secs. 23 and 24  
 Var. 14° 10' E.

8.75 To West edge of bluff, bank of Canada bearing S and E and descend  
 17.50 Over same, course SE  
 18.50 Summit of spur, adobe hill, covered with grass.  
 24.50 Cross gulch in Canada, course SE.  
 35.00 Over Canada S.E.  
 40.00 Set an Oak post 3 x 3 in. 3 ft. long in a mound and pits as instructed for  $\frac{1}{4}$  Sec. Cor.  
 46.00 Cross gulch, course East.  
 52.30 Cross Creek 06 lks. wide, course N.E.  
 67.25 Cross deep gulch, 50 lks. wide, course N.E., thence over Adobe grass hill.  
 70.76 Intersect the Northern Boundary of the Rancho, Ex Mission of San Fernando, and set an Oak post 3 x 3 in. 3 ft. long in a mound and pits as instructed for cor. to frac. Secs. 23 and 24 on adobe grass hill, from this Cor. I run,  
 N. 47  $\frac{3}{4}$ ° E along the Northern Boundary of said rancho.  
 98.90 To post S.F. No. 15 of the final Survey of said rancho.  
 Land very rough 1st rate grazing.  
 Timber mostly Live Oak in places only.

---

From the cor. to Secs. 13, 14, 23, 24, I run,  
 West on a true line bet. Secs. 14 and 23  
 Var. 14° 10' E.

7.00 Cross gulch near head course North.  
 29.00 Descend gulch  
 40.00 To point for  $\frac{1}{4}$  Sec. cor. on steep side hill facing East not a suitable place to build a monument, I continue, and at  
 42.00 Summit of high bluff set an Elder post 3 x 3 in. 3 ft. long in a mound and pits as instructed for witness to  $\frac{1}{4}$  Sec. Cor., from which,  
 A Live Oak 15 in. in dia. bears N. 68° E 57 lks.  
 50.50 Edge of deep Canada, course North  
 61.00 Over same.  
 67.44 Edge of abrupt bank, thence descend, bears N & S at this point  
 I leave an Oak post 3 x 3 in. 3 ft. long in a mound of rocks, from which,  
 An Oak tree 3 ft. in dia. bears S 78° W. 1.20 chs. thence descending rapidly  
 50.00 The point for Cor. to Secs. 14, 15, 22, 23, falling on steep hill, not a suitable place to build a monument,  
 I set an Oak post 3 x 3 in. 3 ft. long in a mound of rocks 1.00 ch. North as instructed for witness to cor. to Secs. 14, 15, 22, 23, from which  
 A Walnut tree 10 in. dia., bears S 45° E. 30 lks.  
 Land rough mostly good grazing with 1st rate Oak timber in places.  
 December 16th, 1875.

---

The line bet. Secs. 14 & 15 is too rough to measure, as it passes over two (2) deep gulches,  
 I begin at the true point for  $\frac{1}{4}$  Sec. Cor. bet. Secs. 14 & 23, and run,  
 North on  $\frac{1}{4}$  Sec. line, through center of Sec. 14, Var. 14° 10' E.  
 Descend abrupt side hill  
 11.50 Cross gulch near head, course West  
 32.00 Cross gulch, near head, course N.W. and ascend  
 40.00 Set an Oak post 3 x 3 in. 3 ft. long in a mound of rock on top of

Tp. 3 N., R. 16 W., S. B. N.

- grass hill, as instructed for  $\frac{1}{4}$  sec.cor.center of Sec.14, from which,  
A Live Oak, 2 ft.in dia.bears S.10° E.71 lks,  
thence,  
West,through center of Sec.14 on  $\frac{1}{4}$  Sec.line  
Var.14°10' E.
- 9.50 Cross gulch, 20 lks.wide,course N.W. and ascend  
18.00 Summit of spur bears N.W. and S.E.  
20.00 Descend  
32.50 Cross dry gulch, 10 lks.wide,course North and ascend  
40.00 Set an Oak post, 3 x 3 in. 3 ft long in a mound of rocks and pits  
as instructed for  $\frac{1}{4}$  Sec. Cor.bet Secs.14 and 15  
Land rolling mostly 1st rate grazing. Live Oak scattering mostly  
in canadas. Thence, North bet.Secs.14 and 15.  
Var.14° 10' E.  
from  $\frac{1}{4}$  Sec.Cor.
- 6.00 Ascend abrupt rocky bluff.  
20.00 Descend into canada  
24.25 Cross gulch,25 lks.wide,course N.W. and ascend.  
40.00 Set an Oak post 4 x 4 in 3 $\frac{1}{2}$  ft.long in a mound of rocks as instructed  
for cor.to Secs.10,11,14,15  
Land over high brushy hill good scattering timber live oak.
- 
- As the line bet.Secs.11 & 14 will strike the Rancho San Francisco in  
less than 80.00 chs. I therefore run it a true line East  
East on a true line bet.Secs.11 & 14  
Var.14° 10' E.
- 40.00 Over rough and broken hills.  
Set an oak post 3 x 3 in. 3 ft.long in a mound of rocks as instruc-  
ted for  $\frac{1}{4}$  Sec.Cor.
- 60.41 Intersect the Southern Boundary of the Rancho San Francisco and set  
an Oak post 3 x3 in. 3 ft.long in a mound and pits as instructed  
for Cor to frac. Secs.11 and 14, from this cor. I run,  
S.64° 50' E. along said Rancho 21.85 chs. to cor.to frac.Secs.  
13 and 14,  
Land very rough hills 3rd rate.
- 
- The line bet.Secs.10 and 11 is too rough to measure.  
From the cor.to Secs. 10,11,14,15,  
I run,  
West on a true line bet.Secs. 10 and 15.  
Var.14° 10' E.
- 33.00 Summit of bluff,bearing N and S and descend.  
39.00 Cross gulch,25 lks.wide,course South.  
40.00 Set an Elder post 3 x 3 in. 3 ft.long in a mound and pits on side  
hill facing East as instructed for  $\frac{1}{4}$  Sec.Cor.  
Summit of ridge and descend  
43.00 Leave hills,enter valley  
51.00 Cross creek .06 lks.wide,course N.W.  
55.30 Leave valley enter hills bears NW and SE  
58.00 This is as far as it is possible to continue the line in this  
60.00 direction.  
I set an Elder post 3 x 3 in. 3 ft.long in a mound of rocks on steep  
side hill facing N.E. as instructed for witness to cor.to Secs.  
9,10,15,16,  
Land East of  $\frac{1}{4}$  post, 3 rate. West 1st rate. Timber Oak, Sycamore  
and cottonwood.

Tp. 3 N., R. 16 W., S. E. M.

From this point, I run  
North on  $\frac{1}{8}$  Sec. line through  $\frac{1}{2}$  of Sec. 10  
Var.  $14^{\circ} 10'$  E.

2.00 Leave hills enter valley  
11.50 Cross creek  $\frac{1}{2}$  lks. wide, course N.W.  
15.00 Ascend steep bluff bank of creek bearing N.W. then over table  
land.  
20.00 Set an Oak post  $3 \times 3$  in. 3 ft. long in a mound and pits as in-  
structed for  $\frac{1}{8}$  Sec. Cor. and ran  
West on a true line,  
Var.  $14^{\circ} 10'$  E.

17.00 Cross creek .06 lks. wide, course North  
20.00 Intersect the line bet. Secs. 9 and 10 20.00 chs. North of the cor.  
to Secs. 9, 10, 15, 16, being unable to run South and establish  
the cor. I set a walnut post  $3 \times 3$  in 3 ft. long in a mound of earth  
and pits as instructed for witness to cor. to Secs. 9, 10, 15, 16,  
from which,  
A Walnut tree 2 ft. in dia. bears  $S. 43\frac{1}{2}^{\circ} E. 1.81$  chs.  
this cor. stands about 5.00 chs. N. of the base of mountains.  
Michel Brophy's House bears S.E. about 10.00 chs. dist.  
Land mostly valley, 1st rate soil.

---

North, bet. Secs. 9 and 10.  
Var.  $14^{\circ} 10'$  E.

16.75 Cross Creek .06 lks. wide, course N.W.  
18.00 Leave valley and ascend, bears N.W. and S.E.  
19.50 Summit of ridge and descend.  
20.00 Set an Oak post,  $3 \times 3$  in. 3 ft. long in a mound of rocks and pits  
as instructed for  $\frac{1}{4}$  Sec. cor. from which  
A Live Oak 24 in. dia. bears N.  $55^{\circ} E. 1.06$  lks.  
A Live Oak 10 in. dia. bears S.  $41^{\circ} E. 57$  lks.

23.00 Cross a board fence bearing E. & W.  
27.50 Leave hills enter valley  
46.20 Intersect the Southern Boundary of the Rancho San Francisco .50  
lks.  $S. 64^{\circ} 50' E.$  of Cor. No. 4 of said Rancho, the final Survey  
of same, and set a redwood post  $4 \times 4$  in. 3 ft. long in a mound of  
rocks as instructed for cor. to Frac. Secs. 9 and 10,  
from which,  
An Elder tree, 6 in. dia. marked for cor. No. 4 of said rancho  
bears N.  $64.50$  W.  $50$  lks. dist.  
Land mostly level valley, 1st rate soil.

---

From the  $\frac{1}{4}$  Sec. Cor. Bet. Secs. 10 and 15, I run,  
North on  $\frac{1}{4}$  Sec. line through Sec. 15  
Var.  $14^{\circ} 10'$  E.

20.00 This is as far as it is practicable to extend this line, as the  
country North is very worthless and broken  
I set an Oak post  $3 \times 3$  in. 3 ft. long in a mound of rocks as  
instructed for  $\frac{1}{8}$  Sec. Cor.  
Land rolling hills, 2nd rate.  
December 17th, 1875.

---

From the cor. to Secs. 14, 15, 22, 23, I run,  
West on a true line bet. Secs. 15 and 22.  
Var.  $14^{\circ} 10'$  E.

6.50 Cross gulch in canada bearing N.W. and ascend.

Tp. 3 N., R. 16 W., S. B. M.

- 34.00 Summit of a high grass ridge bearing N. & S. and descend.  
40.00 Set an Elder post 3 x 3 in. 3 ft. long in a mound of rocks and pits as instructed for  $\frac{1}{4}$  Sec. Cor.  
55.00 Cross gulch in canada, course N.E. and ascend.  
Gilchrist's House about 1.50 chs. North  
60.50 Cross gulch, near head, course N.E.  
80.00 Set an Oak post 4 x 4 in. 3 $\frac{1}{2}$  ft. long in a mound of rocks on South slope of high rocky spur as instructed for cor. to Secs. 15, 16, 21, 22. Land mostly high mountains 1st rate grazing and timber Live Oak, Petroleum in canadas claimed as mineral.
- 

North, bet. Secs. 15 and 16.

Var. 14° 10' E.

- 3.00 Summit of a spur, bearing N.E. and W. thence along West side of same.  
40.00 Set an Oak post 3 x 3 in. 3 ft. long in a mound of rocks as instructed for  $\frac{1}{4}$  Sec. Cor.  
60.00 Edge of high bluff bearing N.W. and S.E. finding it impossible to run farther on this course, I set a redwood post 3 x 3 in. 3 $\frac{1}{2}$  ft. long in a mound of rocks as instructed for witness cor. to Secs. 9, 10, 15, 16, Land very rough, with scattering Live Oak. Timber good grazing.
- 

From the cor. to Secs. 15, 16, 21, 22, I run,

West on a true line bet. Secs. 16 & 21

Var. 14° 10' E.

- 40.00 Along South slope of high rocky ridge  
Set a redwood post 3 x 3 in. 3 ft. long in a mound of rocks as instructed for  $\frac{1}{4}$  Sec. Cor.  
The land to the West is too rough and broken to extend this line farther West, I run,  
North on  $\frac{1}{4}$  Sec. line through center of Sec. 16  
Var. 14° 10' E.  
4.50 Summit of a sharp rock ridge and descend  
40.00 Set an Oak post 3 x 3 in. 3 ft. long in a mound of rocks as instructed for  $\frac{1}{4}$  Sec. Cor. center of Sec. 16, from which,  
A Live Oak 12 ins. dia. bears N. 60° E. 45 lks. dist. thence,  
West, on  $\frac{1}{4}$  Sec. line.  
Var. 14° 10' E.  
11.50 Cross gulch, 20 lks. wide, course North and ascend.  
39.00 Summit of high rocky spur, bearing N. and S.  
40.00 The point for  $\frac{1}{4}$  Sec. Cor. bet. Sec. 16 and 17. falling on steep side hill, not a suitable place to build a monument, I mark a Live Oak tree 2 ft. in dia. 1.56 chs. North for witness as instructed to  $\frac{1}{4}$  Sec. Cor.  
Land very rough, 2nd rate soil with scattering timber. Live Oak and walnut, from the point, I run,  
North, bet. Secs. 16 & 17  
Var. 14° 10' E.  
1.56 Live Oak 2 ft in dia. marked for witness cor.  
4.50 Summit of high rocky peak on ridge, thence descend along East side of same  
18.00 Cross head of gulch, course N.E.  
32.50 Cross near head of gulch, course N.E. and ascend.



Tp. 3 N., R. 16 W., S. B. M.

39.00 Summit of spur, bearing N.E. & S.W.  
40.00 Set a walnut post 4 x 4 in. 3½ ft. long in a mound of rocks on side hill, facing N.W. as instructed for cor. to Secs. 8, 9, 16, 17, Land high rolling mountainous, 1st rate, grazing. Scattering Live Oak and Walnut.

---

As the line bet. Secs. 9 and 16 can only be run part way, I run it a true line East on a true line bet. Secs. 9 and 16,  
Var. 14° 10' E.

.50 Summit of a spur bearing N.E. and S.W. and descend  
12.00 Cross gulch 50 lks. wide, course N.E. and ascend  
21.50 Summit of spur, bearing N.E. and S.W.  
40.00 Set a Walnut post 3 x 3 in. 3 ft. long in a mound of rocks as instructed for ¼ Sec. Cor.  
47.00 Cross gulch in deep canada, course North and ascend.  
70.00 Finding it impossible to measure farther on this line, I set an Oak post, 3 x 3 in 3 ft. long in a mound of rocks as instructed for witness to cor. to Secs. 9, 10, 15, 16.  
Land rough, 2nd rate grazing, Oak and Walnut scattering.

---

From the cor. to Secs. 8, 9, 16, 17, I run North, bet. Secs. 8 and 9.  
Var. 14° 10' E.

Descending  
12.00 Cross gulch, 50 lks. wide, course E. and ascend.  
40.00 Set an Oak post 3 x 3 in. 3 ft. long in a mound of rocks, as instructed for ¼ Sec. Cor. and descend.  
69.00 Cross gulch, 50 lks. wide, course N.E. then ascend over foot of hills.  
75.00 Descend  
79.25 Cross gulch 50 lks. wide, course S.E.  
80.00 Set an Elder post 4 x 4 in. 3½ ft. long in a mound of rocks at the West base of a high white rock bluff as instructed for cor to Secs. 4, 5, 8, 9, from which,  
A Sycamore 20 in. in dia. S. 11° W. 80 lks. dist  
Land over high mountains 2nd rate grazing.  
Timber scattering Oak, Walnut and Sycamore in canadas.

---

As the line bet. Secs. 4 & 9, will intersect the Rancho San Francisco in less than 80.00 chs. I run it a true line East, on a true line bet. Secs. 4 and 9.  
Var. 14° 10' E.

Ascending over high point of hills.  
20.00 Summit and descend.  
27.50 Leave hills enter valley.  
37.00 Cross dry gulch .56 lks. wide, course N.E.  
40.00 Set an Oak post 3 x 3 in. 3 ft. long in a mound of rocks on East side of Valley as instructed for ¼ Sec. Cor. from which,  
A Live Oak 18 in. dia. bears S. 74½° E. 1.78 chs.  
40.75 Leave valley, ascend brushy hill.  
50.35 Summit of hill, bearing N.E. and S.W. and Descend.



Tp. 3 N., R. 16 W., S. B. M.

- 55.00 Leave hills, enter valley, bearing N.E. and S.E.  
 60.00 Set an Oak post 3 x 3 in. 3 ft. long in a mound of rocks as instructed for  $\frac{1}{4}$  Sec. Cor.  
 76.83 Intersect the S.W. Boundary of the Rancho San Francisco and set a walnut post 4 x 4 in.  $3\frac{1}{2}$  ft. long in a mound of rocks as instructed for cor. to fractional Secs. 4 & 9 on East edge of gulch, from which, A Cottonwood tree, 3 ft. in dia. bears N.  $41\frac{1}{2}^{\circ}$  W. 1.57 chs. dist. from this cor. I run S.  $11^{\circ}35'$  E. along line of said rancho Land part in valley 1st rate part in mountain 2nd rate, rocky.  
 13.98 To Cor. No. 4 of the final survey of said rancho.

The line bet. Secs. 4, and 5, is very brushy to measure. I therefore begin at the  $\frac{1}{8}$  cor. 20.00 chs. East of the  $\frac{1}{4}$  Sec. Cor. bet. Secs. 4 & 9, and run

North on a true line on  $\frac{1}{8}$  Sec. line through E  $\frac{1}{2}$  of Sec. 4.  
 Var.  $14^{\circ}10'$  E.

- 16.00 Sanford Lyon's House about 2.50 chs. West  
 18.42 Enter Lyon's corral  
 20.00 Leave corral  
 21.00 Cross creek 50 lks. wide, course East  
 25.00 Enter plowed field of "Howe"  
 40.00 Set a Redwood post 3 x 3 in. 3 ft. long in a mound of earth and pits as instructed for  $\frac{1}{8}$  Sec. Cor. from which, Howe's house bears N  $25^{\circ}$  W about 12.00 chs. thence,  
 West on  $\frac{1}{4}$  Sec. line through Sec. 4.  
 Var.  $14^{\circ}10'$  E.  
 20.00 Set a White Oak post, 3 x 3 in. 3 ft. long in a mound of rocks as instructed for  $\frac{1}{4}$  Sec. Cor. in center of Sec. 4.  
 33.00 Leave valley and ascend brushy hill. Thence over brushy hills  
 60.00 Set an Oak post 3 x 3 in. 3 ft. long in a mound of rocks as instructed for  $\frac{1}{4}$  Sec. Cor. bet. Secs. 4 & 5.  
 Land part in valley, level, 1st rate, part in hills, 2nd rate, rolling and brushy, thence,  
 North bet. Secs. 4 & 5.  
 Var.  $14^{\circ}10'$  E.  
 25.60 Intersect the southern boundary of the Rancho San Francisco and set an Oak post 3 x 3 in. 3 ft. long in a mound of earth and pits as instructed for cor. to frac. Secs. 4 & 5, from this cor, I ran along the southern boundary of said rancho  
 N.  $85^{\circ}16'$   $\text{W}$   $\rightarrow$  ? E.  
 63.40 The cor. No. 3 of the final survey of said rancho  
 Land rough 1st and 2nd rate soil.  
 December 17th, 1875.

From the cor. to Secs. 8, 9, 16, 17, I run,  
 West, on a true line bet. Secs 8 and 17  
 Var.  $14^{\circ}10'$  E.

- Descending  
 19.65 Intersect the N.E. Boundary of the Towsley Petroleum Mine 9.10 chs. N.  $62^{\circ}20'$  W. of the East cor. of same.  
 Set an Oak post 3 x 3 in. 3 ft. long in a mound of rocks as instructed for cor. to frac. Secs. 8 & 17, thence through said claim

Tp. 3 N., R. 16 W., S. B. M.

- 25.00 Cross gulch 56 lks wide, course N.E.  
 39.20 Intersect the N.W. Boundary of the Towsley Petroleum Mine 9.07  
 chs. S. 27°40' W. of the North cor. of same. Set an Oak post 3 x 3  
 in 3 ft. long in a mound of rocks. At the point of intersection as  
 instructed for cor. to frac. Secs. 8 & 17  
 40.00 Set an Oak post 3 x 3 in. 3 ft. long in a mound of rocks on steep  
 side hill, facing East as instructed for  $\frac{1}{4}$  Sec. cor.  
 This is all the land in this direction practicable to Survey as the  
 mountains to the West are very rough and worthless.  
 Land over high mountains 1st rate grazing canadas with petroleum.  
 From the cor. to Secs. 14, 15, 22, 23, the line bet. Secs. 22 & 23 is too  
 rough to measure. I therefore, run,  
 East, bet. Secs. 14 & 23.  
 Var. 14°10' E.  
 20.00 Set an Oak post 3 x 3 in. 3 ft. long in a mound of rocks as instructed  
 for  $\frac{1}{8}$  Sec. Cor. thence,  
 South on  $\frac{1}{8}$  Sec. line through West  $\frac{1}{2}$  of Sec. 23.  
 Var. 14°10' E.  
 15.00 Ascend ridge, thence along on same.  
 53.27 To a point of ridge, thence,  
 West.  
 20.00 To line bet. Secs. 22 & 23, being 53.27 chs. South of the cor. to  
 Secs. 14, 15, 22, 23 on top of high bluff, being unable to return and  
 establish the  $\frac{1}{4}$  Sec. Cor.  
 I set a Walnut post 3 x 3 in. 3 ft. long in a mound of earth  
 and pits on North edge of Adobe grass hill as instructed for witness  
 to  $\frac{1}{4}$  Sec. Cor., from which,  
 A Live Oak, 20 in. in dia. bears N 17 $\frac{1}{2}$ ° W. 27 lks.  
 A Live Oak, 10 in. in dia. bears N. 67° E. 32 lks.  
 thence, continuing,  
 South bet. Secs. 22 & 23.  
 54.50 Counting the distance from cor. to Secs. 14, 15, 22, 23, Summit of ridge  
 bet. waters of San Fernando and Santa Clara River, course E & W, and  
 descend.  
 73.00 Cross gulch 50 lks. wide, course S.E.  
 80.00 Set a walnut post 4 x 4 in. 3 $\frac{1}{2}$  ft. long in a mound of rocks and pits  
 as instructed for cor. to Secs. 22, 23, 26, 27, from which,  
 A Walnut tree 10 in. dia. bears S. 7 $\frac{1}{2}$ ° E. 3.31 chs.  
 Land very rough  $\frac{1}{2}$  2nd rate, grazing.

---

As the line bet. Secs. 23 & 26 will intersect the N.W. line of the  
 Rancho Ex Mission of San Fernando in less than 80.00 chs. and run it  
 a true line

East, on a true line bet. Secs. 23 & 26  
 Var. 14° 10' E.

- 6.00 Cross gulch, .50 lks. wide, course S.E.  
 40.00 Set an Oak post 3 x 3 in. 3 ft. long in a mound of rocks as instructed  
 for  $\frac{1}{4}$  Sec. cor.  
 69.79 Intersect the N.W. Boundary of the Rancho Ex Mission San Fernando at a  
 point on steep side of a short gulch, facing South not a suitable  
 place to build a monument.  
 I set an Elder post 3 x 3 in. 3 ft. long in a mound of earth and  
 pits as instructed  
 0.64 N. 47  $\frac{3}{4}$ ° E. for witness to cor. to frac. Secs. 23 & 26, from this  
 cor. I run along said Rancho S. 47  $\frac{3}{4}$ ° W. 13.64 chs. to cor. to frac.  
 Secs. 23 & 24.  
 Land very rough, mostly 1st rate grazing.

Tp. 3 N., R. 16 W., S. B. M.

- From the cor. to Secs. 22, 23, 26, 27, I run  
South, bet. Secs. 26 & 27  
Var.  $14^{\circ} 10'$  E.
- 8.00 Cross gulch 25 lks. wide, course N.E. and ascend.  
40.00 Set a walnut post 3 x 3 in. 3 ft. long in a mound of rocks, as  
instructed on summit of ridge, bearing N.W. and S.E. for  $\frac{1}{4}$  Sec.  
Cor. and descend.  
41.64 Intersect the N. Bdy of the Rancho Ex Mission San Fernando 19.10  
chs. N.  $75\frac{1}{2}^{\circ}$  W. of Cor. No. 16 of the final Survey of said rancho.  
Set a Walnut post 3 x 3 in.  $3\frac{1}{2}$  ft. long in a mound of rocks as  
instructed for cor. to frac. Secs. 26 & 27.  
Land rolling 1st rate grazing. Timber Oak and Walnut.
- 
- From the cor. to Secs. 22, 23, 26, 27, I run  
West, on a true line bet. Secs. 22 & 27  
Var.  $14^{\circ} 10'$  E.
- 22.00 Cross gulch 56 lks. wide, course North  
35.00 Cross gulch 56 lks. wide, course N.E.  
39.50 Cross a brush fence bearing N.E. & S.W.  
40.00 Set a walnut post, 3 x 3 in. 3 ft. long in a mound of rocks, as  
instructed for  $\frac{1}{4}$  Sec. Cor., from which,  
A White Oak, 2 ft. in dia. bears S.  $29\frac{1}{4}^{\circ}$  E. 1.42 chs. dist.  
A White Oak 20 in. dia. bears N.  $41^{\circ}$  W. 2.00 chs.  
50.41 Summit of ridge, course N.E. & S.W. leave small mound of rock and  
descend.  
68.00 Cross gulch, 56 lks. wide, course North  
80.00 To a Live Oak Tree 18 in. dia. standing on side hill, facing N.W.  
mark, same as instructed for cor. to Secs. 21, 22, 27, 28,  
Land along ridge. 1st rate grazing.
- 
- South bet. Secs. 27 & 28.  
Var.  $14^{\circ} 10'$  E.  
Ascending
- 10.00 Summit of divide, bet. waters of San Fernando and Santa Clara  
River.  
20.40 Intersect the N. Boundary of the Rancho Ex Mission of San Fernando  
and  
Set a Walnut post 3 x 3 in. 3 ft. long in a mound of rocks as  
instructed for cor. to frac. Secs. 27 & 28, from this cor. I run,  
 $8.75\frac{1}{2}^{\circ}$  E. along line of said rancho  
82.63 To cor. to fractional Secs. 26 & 27  
Land over high mountain mostly good grass in places. Timber oak &  
Walnut.
- 
- From the cor. to Secs. 21, 22, 27, 28, I run,  
West, on a true line bet. Secs. 21 & 28.  
Var.  $14^{\circ} 10'$  E.
- 9.50 Cross gulch .50 lks. wide, course N.E.  
A house about 4.00 chs. North and ascend  
40.00 Set an Elder post 3 x 3 in. 3 ft. long in a mound of earth and  
pits as instructed for  $\frac{1}{4}$  Sec. Cor. on top of high ridge, bearing  
N.E. and S.W. from which,  
A White Oak, 3 ft. in dia., bears N.  $49\frac{1}{2}^{\circ}$  E. 4.20 chs. dist;

T. 3 N., R. 16 W., S. B. M.

this is as far as it is practicable to extend the survey in this direction, as the mountains are very rough and worthless. No timber. Timber along line. Live Oak and Walnut scattering. A few white oak in places.

---

From the cor. to Secs. 21, 22, 27, 28, I run, North on a true line as it can only be run part way  
North, bet. Secs. 21 & 22.  
Var.  $14^{\circ} 10'$  E.

1.00 Cross Ravine, 20 lks. wide, course N.E.  
4.00 A house about 5.00 chs. West  
An old field about 15.00 chs. E.  
7.50 Cross gulch 20 lks. wide, course East  
8.65 Cross gulch 20 lks. wide, course East  
30.30 Cross gulch 50 lks. wide, course East  
thence ascend rough hill, bearing E. & W.  
36.00 Summit of same.  
40.00 Set a walnut post 3 x 3 in. 3 ft. long in a mound of rocks on side hill facing East as instructed for  $\frac{1}{4}$  Sec. Cor.  
The land is too rough to run farther on this line. I therefore close the survey in this direction as the remainder is very rough and broken mountains too rough to survey.  
Land along line high mountains, mostly 2nd rate, with oak timber on East part.

December 20th, 1875.

---

From the corner to Secs. 7, 12, 13, 18, on the Eastern Boundary of the Tp. I run

West, on a true line bet. Secs. 12 & 13  
Var.  $14^{\circ} 10'$  E.  
9.90 Intersected the Eastern Boundary of the Rancho San Francisco, and set an Oak post 3" x 3" x 3 ft. long in a mound of rocks on side hill facing North as instructed for cor. to frac. Secs. 12 & 13, from this cor. I run along the Eastern Boundary of said Rancho S  $1^{\circ}$  W 42.11 chs. to cor. No. 5 of the final Survey of said rancho.  
Land rough. 3rd rate, with scattering Oak timber.

---

From the cor. to Secs. 1, 6, 7, 12, on the Eastern Boundary of the Township, I run

West, on a true line bet. Secs. 1 & 12,  
Var.  $14^{\circ} 10'$  E.  
8.54 Set a Redwood post 3 x 3 x 3 ft. long in a mound of rocks on top of ridge near Summit as instructed for cor. to frac. Secs. 1 & 12, from this Cor. I run, S.  $1^{\circ}$  W. along said rancho 80.00 chs. to cor. to frac. Secs. 1 & 12.  
Land rough, mostly 2nd rate. This comprises all the land in this township that can be surveyed.

December 21st, 1875.

---

GENERAL DESCRIPTION.

The greater portion of the lands surveyed in this township is fair grazing and some first rate farming. There are also bodies of valuable Live Oak, White Oak, and scattering walnut

Tp. 3 N., R.16 W., S. B. M.

and Sycamore timber. Scattered through the same. The portion adopted to farming is settled by Erophy, Lyons and Howe in Sections 4, 9, 10, 15.

Most of the canadas contains mineral water. Such as appears in Oil regions and 9 Mineral Districts have been formed out of this and adjoining Townships in which a greater portion of the land is claimed as mineral, but I found that only the Towsley Petroleum Mine situated in Sections 8 & 17, and another claim of the same mineral in the S.  $\frac{1}{4}$  of the S.W.  $\frac{1}{4}$  of Sec. 15 have been worked to some extent.

I did not make an examination of the interior of the Sections but from what I saw on the lines run, I consider the land surveyed by me more valuable for agricultural than mining purposes, with the exception of the above mentioned mineral claims. I was informed that the greater part of the claims were held under both the agricultural and mineral Acts.