

Copied from Photographic Copies
furnished by
U. S. General Land Office
Washington, D. C.

Note, Blue lines run by A. G. Ruxton - 1888
Vermilion, W. P. Reynolds - 1876

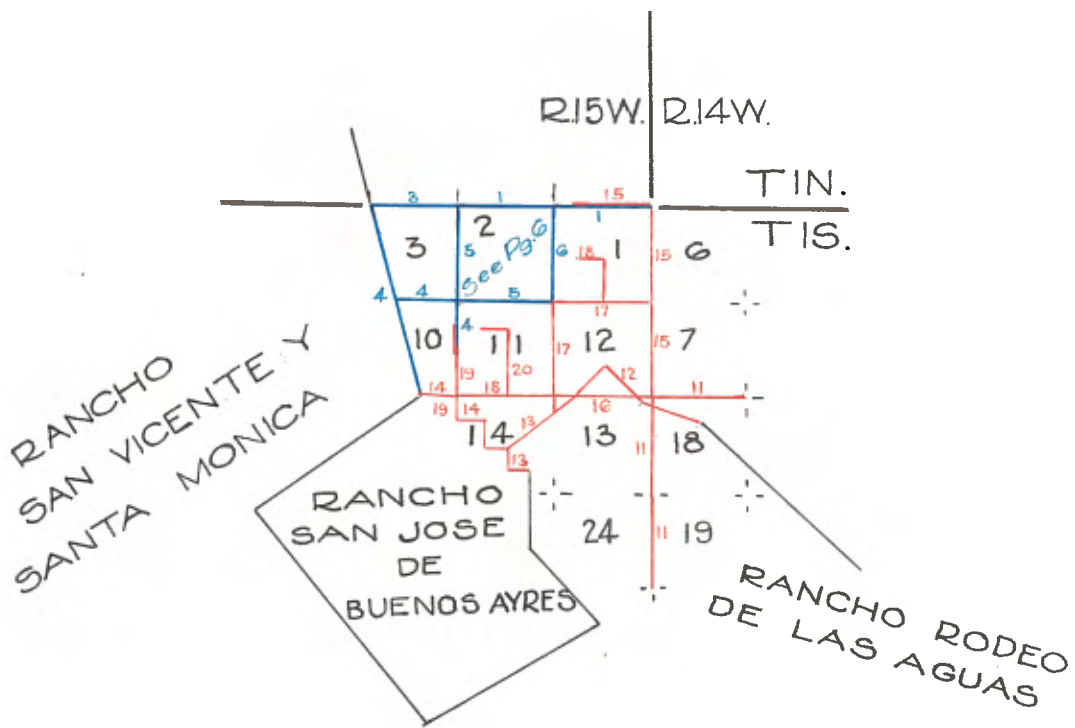

SAN BERNARDINO BASE LINE.

chs.

- From the established standard corner to Secs. 31 and 36, T. 1 N. R. 14 and 15 W. S. S. B. B. and M. the elder post in mound of rocks still standing and being 37 lks west of an elder post at the northeast corner of Secs. 1, T. 1 S., R. 15 W.
West on sth. bdy. of Sec. 36,
Mag. Var. $14\frac{3}{4}$ 45' East.
- 4.00 Cross deep ravine 50 lks. wide, course N. 20 E 70 feet
7.34 Brow of ridge, course N and S + 110 feet and descend broken west slope through chaparral (dense).
25.00 Leave west slope and descend across N. slope
32.00 N. point of grassy spur
40.00 Point for $\frac{1}{4}$ sec. cor. on S. bdy of Sec. 36,
42.08 To the Palo Colorado tree now burned but still standing and plainly marked for $\frac{1}{4}$ sec. cor.,
This is the $\frac{1}{4}$ sec. cor. on the north bdy of Sec. 1 by approved survey of T. 1 S., R. 15 W.,
55.00 Cross gully, 20 lks. wide, course N. 45 W. 180 feet.
57.50 Point of low brushy hill
62.00 The house of C. Tullis at mouth of ravine, coming from east, bears North 1.94 chs. distant.
62.08 Failed to find any trace of sand rock in mound of rock at point for cor. to frac. Sec. 1.,
Set an oak post $36 \times 4 \times 4$ in. 12 inches in the ground in a mound of earth 36 in. base and 24 in. high, marked $1/8$ S.
64.00 Enter Bottom of Franklin Canon comes from N. 10° E. 10 feet.
The N. E. corner of a small corral bears south 27 lks. distant,
64.50 The S. E. corner of a stable bears North 45 lks. dist., cross road, course North and S. 20 W.,
65.60 Leave bottom of Franklin Canon, course S. W. and ascend steep brushy east slope.
69.00 Brow of brushy hill + 90 ft.
72.00 Cross wash 20 links wide, course S. 80° E.
79.80 Cross rocky wash, 10 lks wide, runs N. 20° E about 2 chains into wash last named,
80.00 Set a conglomerate sand rock $16 \times 12 \times 8$ inches 12 in. in the ground marked with 1 notch on the east and 5 notches on the west side for standard corner to Secs. 35 and 36, and raised a mound of granite boulders and conglomerate rock 36 in. base and 18 in. high, around sand conglomerate sand rock from which a (burned and dead) live oak tree 10 in. diam., marked S. 35, T. 1 N., R. 15 W., B. T., bears, N. $84\frac{3}{4}$ W. 1.42 chs. distant,
Land mountainous, very rough, and broken, covered with chamisal, and sage brush, with some scattering live oak trees.
- NOTE:
I commenced with an assumed variation which I found agreed with the line from the section to the $\frac{1}{4}$ sec. cor., but the distance I found to be 42.08 chains, I, therefore, remeasured the line and found the distance as above,
I failed to find any trace of the sand rock in mound of sand rock, as per off survey at cor. to frac. Sec. 1,
West on south bdy of Sec. 35,
Mag. Var. $14\frac{3}{4}$ 45' E.
Ascending steep brushy east slope of mountain.
- 1.28 Brow of dividing ridge, course N. 10° E and S. 10° W + 160 feet, descend brushy west slope
40 Enter barley patch in Higgin's Canon (this was formerly known as Spanish Canon)
66 The S. W. corner of house of P. Higgins bears S. 31° E. 2.57 chs. dis.
The S. E. corner of stable, bears North 2.35 chs. dis.
The S. W. corner of barn bears,
N. 17 E. 2.38 chs. dis.

SAN BERNARDINO BASE LINE.

CHAINS:

- The S.E. corner of first house built by P. Higgins,
bears N. $7\frac{1}{2}$ E. 6.31 chs. dis.
- 11.50 Cross road, N. 18° E. and S. 18° W. at west edge of barley patch,
which extends up and down the Canon about 10 chs. each way.
- 12.20 Cross wash 10 lks.wide, course S. 18° W. 70 feet.
Leave Higgins Canon, which comes from N. 10° E. and runs S. 18°
W. and ascend across point of brushy hill.
- 14.75 To the N. E. corner of about 3 acres cleared and ploughed land
on steep hill side, cross wash 10 lks.wide, course S. 70° E. and
ascend steep brushy ravine.
- 32.50 Head of ravine and enter barley patch on summit of ridge, course
North and S. 20° W + 130 feet.
- 34.30 Leave barley patch which North about 10 chs. and South 50 lks.
and enter cleared and ploughed land.
- 40.00 Set a lime rock 16 x 12 x 7 in. 12 in. in the ground for standard
 $\frac{1}{4}$ sec.cor., marked $\frac{1}{4}$ on the north side and raised a mound of
lime rock, 24 in. base and 18 in. high around said lime rock and
from which a live oak tree, 6 in. dia., bears N. $17\frac{1}{2}$ E. 93 lks.
dis., marked $\frac{1}{4}$ S. B. T.
- Brow of hill at south point of cleared land bears,
South about 5 chs. dis.
- The head of a deep brushy ravine, course West, bears
N. 45° E. about 3

SAN BERNARDINO BASE LINE.

chains distant
 Leave brow of ridge and descend west slope through grass and brush
 Cross wire fence in ravine, which comes from S. 80° E - 170 feet and along
 same
 This ravine forms the head of east fork of Benedict Canyon,
 Cross wash 10 lks wide, course N. 80° W and run over low point of hill
 through live oak trees,
 Enter last named ravine,
 Cross wire fence and wash 10 lks wide, course S 70 W and enter barley
 patch ascending.
 Leave barley patch and run over brushy point
 South point of brushy ridge and descend, west slope.
 Set a sand rock 24 x 12 x 8 in. 16 in. in the ground for standard
 corner to Secs. 34 and 35, marked with 2 notches on the east and 4
 notches on the west side and 7 on top and raised a small mound of
 stone alongside and from which the S. E. corner of house of John Levell
 in Canon bears N. 21° 35' W 10.05 chs. distant,
 Land mountainous, last 7 mile over grassy hills with young live oak
 trees,
 March 28th, 1888.

West on south bay Sec. 34,
 Mag. Var. 14° E. 45 E.
 Through barley patch,
 Cross gully 5 lks. wide, course S. 10° E and leave barley patch,
 1.00
 which extends about 7 chains up canon
 Cross road N 10° W and S 10° E.
 West edge of bottom of Levell Canon, which comes from N 13° W and
 runs S 26 W - 50 feet, ascend brushy hill.
 2.00
 Brow of ridge, course N 20° W and S 10 W + 90 feet, descend.
 To a clump of young elder trees in grassy ravine, course S. 23° E.,
 this is the west fork of Benedict Canyon,
 Cross wash 20 lks. wide, course S. 23 E. - 100 feet ascend grassy east
 slope of mountain
 Enter small grassy flat.
 33.00
 Ascend north slope.
 36.00
 Set a grey granite rock 20 x 8 x 6 in. 12 in. in the ground for
 standard 1/2 sec. cor., marked 1/2 on north side and raised a mound of
 grey granite 18 in. base and 12 in high, around said rock and from
 which,
 A walnut tree 4 in. diam., marked 1/2 S. B. T. in a clump of 4 walnut
 trees bears S 56 1/2 W. 40 lks. dis.
 46.00
 Ascend steep brushy east slope
 Summit of divide, course N and S. + 500 feet
 51.25
 Descend steep brushy west slope.
 53.50
 Grass west slope
 Enter bottom of Canon, (Arroyo Seco), course south
 55.25
 The N. E. cor. of a chicken house bears South 81 lks. dis.
 66.90
 Cross gully 12 lks. wide, with small stream, course south - 300
 feet.
 The house of Griffith bears North 1.06 chs. dist.
 Honey house S. 127 ch. dist.,
 Ascend grassy east slope.
 76.25
 Ascend through brush.
 Set a lime rock 16 x 12 x 8 in. 12 in. in the ground for standard
 corner to Secs. 33 and 34, marked with 3 notches on the east and 3
 notches on the west side and raised a small mound of lime rock
 alongside + 200 feet.
 The summit of ridge, course N. and S. bears West 1.50 chs. distant,
 Land mountainous, good for grazing with scattering live oak trees,
 some chemical, and sage brush.
 March 29th, 1888.

From the established $\frac{1}{2}$ sec. cor., between Secs. 10 and 11, an elder post in a mound of slate rock on rocky east slope of ridge North between Secs. 10 and 11. Mag. Var. 14° 45' E.

Foot of ridge and enter Benedict Canon 20 feet
7.50
Cross bottom of Benedict Canon, comes from N. 40° W, runs S. 20 E.

Brom of spur, course S. W.
12.00
Brom of ridge, course S. 70° W + 200 feet and descend
17.60
Find no trace of cor. to frac. sec. 10 and 11,
20.00
Set a sand rock 14 x 9 x 6 in, 10 inches in the ground and raised a small mound of sand rock around rock,
27.90
Brom of spur, course E. and W. + 40 feet, descend.
35.90
Set a slate rock 24 x 18 x 2 in. 18 inches in the ground for cor. to Secs. 2, 3, 10 and 11, marked with 5 notches on the south and 2 notches on the east edge, and raised a mound of slate rock 36 in. base and 18 in. high, around said slate rock,
40.00
Land rough and broken,
Covered with chamisa and sage brush
West between Secs. 3 and 10,
Mag. Var. 14° 45' E.

Head of brushy ravine, course S. W. and descend.
5.00
Set an elder stake at the east side of bottom of Benedict Canon -
25.00
275 feet
Leave bottom of Benedict Canon, comes from N. 10 E and runs South and ascend steep east slope of mountain through dense chaparral.
40.00
Set an elder post $\frac{1}{2}$ ft. long, 3 in. square with marked stone 12 in. in the ground for $\frac{1}{2}$ sec. cor., marked post $\frac{1}{2}$ S. on north face, dug pits 18 x 12 in E and W of post $\frac{1}{2}$ feet distant and raised a mound of earth 24 in. base and 12 in. high around post.

SUB-DIVISION OF FRAC. T. 1 S., R. 15 W., S. B. B. and M.

CHAINS

East Boundary of Rancho San Vicente y Santa Monica,
from the post marked, S. V. S. M. 25 and S. J. B. A. 14 in mound of earth and slate rock with pits at the common corner to the Rancho San Vicente y Sta. Monica and San Jose de Buenos Ayres, N. 19° 15' W.,
Mag. Var. 14° 45' E.

Along the easterly boundary of the Rancho San Vicente y Santa Monica,
Brom of spur, course S. 60° W. into Arroyo Seco + 50 feet and run across broken brushy west slope of mtn.
19.50
Brom of ridge course N. E. and S. E. + 250 feet.
90.00
The Arroyo Seco, course S. 20° E. bears W. about 15 chs. dist.,
Descend across broken brushy west slope
137.00
Cross road in Arroyo Seco, course N. 10° E and S. 10° W.
137.50
Cross wash of Arroyo Seco 10 lks wide, course S. 10° W. 175 feet, ascend across steep brushy east slope of mountain.
170.00
Intersect the San Bernardino Base Line 1.37 ch. East of Standard corner to Secs. 33 and 34, Set an oak post 48 x 5 x 5 in for cor. to frac. sec. 3 with a lime rock 20 x 14 x 8 in. in the ground Post marked S. V. S. M. on west side S. 34, T. 1 N., R. 15 W. on N. E. side,
S. J. T. 1 S., R. 15 W. on S. E. side,
Lime rock marked S. V. S. M. on west side and raised a mound of lime rock 32 in base, and 20 in high around post and rock + 220 feet,
Land mountainous, very rough and broken and covered with chaparral
almost worthless,
March 30th, 1888.

EAST BOUNDARY OF RANCHO SAN VICENTE Y SANTA MONICA.

SAN BERNARDINO BASE LINE.

SUB DIVISION OF TRAC. T. 18., R. 15 W., S. B. B. AND M.

47.25	Cross gully 10 lks wide course S.
50.40	Summit of ridge course N.W. and S.E. + 300 feet
51.10	Intersect east boundary of Rancho San Vicente y Santa Monica
	Set a sand rock 14 x 11 x 8 in. 12 inches in the ground for cor. to
	Trac. secs. 3 and 10, marked S.V.S.M. on the west side, S. 3 on the
	north, and S 10 on the south and raised a mound of sand rock 36
	in base and 18 in high around said rock and from which
	The post marked S.V.S.M. 25 and S.B.J.V.A. 14 at the southeasterly
	corner of the Rancho San Vicente y Santa Monica bears S. 19° 15' E
	84.83 obs. dist.
	North between Secs. 2 and 3,
	Mag. Var. 14° 45' E.
9.00	Brow of spur N. 80° E and S 80° W + 30 feet
24.90	Brow of spur N 75° E and S 75° W + 40 feet
35.00	Brow of spur N 77° E and S 77° W - 20 feet.
	Descend steep brushy N slope
39.30	Enter ravine, course S 80° W - 150 feet
40.00	Set a sand rock boulder 15 x 12 in. for $\frac{1}{2}$ sec. cor., marked $\frac{1}{2}$
	on west face with marked stone 12 in. in the ground and raised a
	mound of conglomerate rock 24 in base and 18 in high around said
	boulder and from which,
	An elder tree 5 in. dia., bears S. 42 3/4° E 51 lks. distant, marked
	$\frac{1}{2}$ S.B.T.
40.30	A live oak tree 5 in. dia., bears N 75° W 47 lks. dia., marked $\frac{1}{2}$ S.B.T.
	Cross road N. 70° E and S. 70° W and ascend rocky south slope
46.60	Brow of ridge N 70° E and S 70° W + 120 feet, and descend grassy
	north slope through young live oak trees,
64.00	Cross ravine, course W. - 50 feet
75.68	Enter east fork of Benedict Canon, course S. 30 W. - 60 feet
75.80	Cross wash 10 lks. wide, S. 30 W.
77.80	Cross wire fence N. 85° E & S 85° W
80.68	Set a sand rock 19 x 8 x 8 in. 15 in. in the ground for closing corner
	to Secs. 2 and 3, marked 0.0. with 2 notches on the east face and 4
	notches on the west face and raised a mound of earth and lime rock
	48 in base and 36 in high around said sand rock, on brushy hill side
	and from which,
	The standard corner to Secs. 34 and 35, bears west 31 lks. dist.,
	land mountainous.
	First half mile very rough and covered with charparral.
	Last $\frac{1}{2}$ mile very good grazing.
	East on a random line between Secs. 2 and 11,
	Mag. Var. 14° 45' E.
40.00	Set temporary $\frac{1}{2}$ sec cor.
80.10	Intersect N and S line 98 links N of the established corner to Secs.
	1, 2, 11, and 12, a conglomerate quartz rock 22 x 16 x 14 in
	from which corner I run N 89° 18' W on a true line between Secs. 2
	and 11,
0.75	Enter Vineyard at foot of low point of spur on east side of Franklin
	Canon
2.30	Vineyard and orchard extend about 10 chains up the Canon
	Cross road N 10° W and S.E.
3.50	Cross wash, course S.E.
4.90	Leave bottom Franklin Canon, which comes from N 10° W, runs S. 45° E.
	about 5 obs., thence S. 20° E, Elevation 550 feet above sea level.
	Ascend steep brushy east slope
11.00	Brow of divide course N 6° E and S 6° W + 200 feet. Descend steep
	brushy W slope
16.00	Enter bottom of Higgins Canon, course S 5° E. - 175 feet
16.77	Cross road N. 5° W and S. 5° E set stake

SUBDIVISION OF RANGE T. 1 S., R. 15 W., S. B. B. and M.

19.40 Leave Canon and ascend steep brushy east slope
 33.00 Brow of divide course N. 10° W and S. 10° E + 400 feet
 40.05 Descend steep brushy west slope
 Set an elder post, 4 feet long, 4 in. square for 1/2 sec. cor., marked 8 on the north side, with marked slate rock 12 in. in the ground and raised a mound of earth and slate rock 36 in. base and 24 in high around post.
 44.50 Enter Pea Vine Canon, course south 200 feet
 49.00 Leave canon and ascend steep brushy east slope
 69.00 Summit of divide, course N 20° E and S 20° W x 300 feet and descend.
 To the corner to Secs. 2, 3, 10 and 11, 90 feet.
 Land mountainous, very rough and covered with chaparral.
 April 2nd, 1888.

North, between Secs. 1 and 2,
 Mag. Var. 14° 45' E.

6.00 Enter small ravine
 The house of Noah Leving bears west 1.00 ch. dist.
 7.00 Cross ravine with small stream, course S. 80° W and ascend.
 14.90 Brow of brushy spur course west + 100 feet. Summit of ridge bears East about 3 chains distant.
 35.80 Brow of brushy spur, course west + 100 feet, Descend steep brushy north slope.
 40.00 Set a grey granite rock 18 x 7 x 5 in. 12 in. in the ground for 1/2 sec. cor., marked 4 on west face and raised a mound of grey granite 54 in. base and 16 in high around rock,
 Cross wash, 50 links wide, course west with large granite boulders 50 feet
 40.75 Ascend steep brushy S. slope
 44.50 Brow of brushy spur, course S. 70° W + 50 feet Descend
 Brush fence at southwesterly end of small garden patch on hill side.
 55.50 To a sycamore tree 22 in dia in bottom of Franklin Canon
 56.47 Cross stream in rocky wash 10 lks. wide, course S. 20 W.-90 feet
 58.10 Cross road N. 20 E and S. 20 W.
 A spring bears S. 76° E 4.65 chains distant
 Leave bottom of Canon and ascend low brushy point
 67.50 Brow of spur N 68 W and S 68 E + 110 feet and Descend N slope
 Brow of grassy spur E & W + 40 feet
 Set a redwood post 5 feet long 4 in square with charred stake and 12 small granite rocks 15 in. in the ground for closing corner to Secs. 1 and 2, on the Base line.
 Post marked 0.0. T. 1 S., R. 15 W. on S. side S. 1 on E. side, S. 2 on W. side and raised a mound of earth and granite boulders 60 in. base and 36 in high around post, from which,
 The standard corner to Secs. 35 and 36, bears West 64 lks. distant. Land mountainous, very rough and broken and covered with chaparral. potash oak and sage brush.
 April 3rd, 1888.

Travel to locate house on Sec. 2,
 From the stake in Higgins Canon
 N. 89° 18' W 16.77 chs. from corner to Secs. 1, 2, 11, and 12,
 N. 3° 15' W.
 Mag. Var. 14° 45' E.

Up Higgins' Canon.

To Sta. N. 9° W. thence,

5.50

To Sta. N. 23° W. thence,

13.20

To the center of east side of house (front) of L. Sarnon.

10.75

SUBDIVISION OF FRAC. T. 1 S., R. 15 W., S. B. B. AND M.

Traverse locating house in Benedict Canon Traverse No. 1, from the closing corner to sections 2 and 3, S. 32° 15' W. Mag. Var. 14° 45' E.

3.50	Down Canon Cross wire fence N 55° E & S. 85° W. To sta. in center of Canon 4 chs. wide, thence, S. 11° 45' W.
10.00	To sta. in center of Canon 4 chs. wide, thence, S. 11° 45' W.
2.50	To sta. Canon 2 chs. wide, thence, S. 23° W.
8.70	To sta. thence, S. 65° 45' W.
5.00	To sta. thence, N. 23° W.
2.15	To the S. E. corner of the house of E. Parrish at foot of point of divide between the east and west forks of Benedict Canon Traverse No. 2 From the elder stake 25.00 chs. west of corner to Secs. 2, 3, 10, and 11, N. 4° E.
1.00	Up Canon Cross wire fence, course E. and W. across Benedict Canon To sta. thence, N. 27° E.
3.50	To sta. thence, N. 14° E.
2.50	To sta. thence, N. 14° E.
3.20	To sta. thence, N. 8° E.
4.50	To sta. thence, N. 19° E.
4.50	To sta. thence, North
4.00	To sta. thence, N. 43° 45' E.
3.80	To sta. thence, N. 13° W.
7.60	To S. W. cor. of house of Dietrich on W side Benedict Canon, 4 chs. wide, Traverse No. 3, From the elder stake 25.00 chs. west of corner to Secs. 2, 3, 10, and 11, S. 12° W.
Mag. Var. 14° 45' E.	
5.20	Down Benedict Canon. To sta. in center of Canon 3 chs. wide, thence, S. 11° 15' W.
4.50	To sta. thence, S. 15° E.
7.90	To the N. E. corner of the house of E. Sehaeter, thence, S. 43° 45' E.
7.20	To sta. thence, S. 8° 15' E.
4.90	To the S. E. corner of the house of O. Hanson on the S. west side of Canon, 4 chs. wide, S. 11° 15' W.
49.60	

GENERAL REPORT.

The land in this fractional township consists of rough broken and brushy hills which form part of the chain of mountains dividing the Los Angeles and San Fernando Valleys. In the canons which are deep and narrow there is a little land under cultivation. The hills are mostly used for grazing purposes. There is very little timber small live oak trees and some willows.

(SEAL)

H. H. CHAPMAN,
Notary Public.

A. D. 1890.

SUBSCRIBED AND SWORN to before me this 20th day of May,

STATE OF CALIFORNIA,
COUNTY OF LOS ANGELES. }
SS.

ALBERT GEORGE HUXTON,
United States Deputy Surveyor,

At closing corner to Secs. 2 and 3, I set a sand rock 18 x 8 x 8 in. 15 in. in the ground for closing corner to Secs. 2 and 3, marked O.G. with 2 notches on the east face and 4 notches on the west face and raised a mound of earth and lime rock 4 1/2 in base and 36 in high, around said sand rock, on brushy hillside, and from which the standard corner to Secs. 34 and 35, bears West 31 lks. distant.

A live oak tree 5 in. diam. bears N. 75° W. 47 lks. dist., marked # S.B.T. as per notes on page 22 and 23.

At 1/4 sec. cor. between Secs. 2 and 3, I set a sand rock boulder 15x 12 in for 1/4 sec. cor., marked # on west face with marked stone 24 in. base and 18 in high around said boulder, and from which an elder tree 5 in. diam., bears S. 42° E 51 lks. dist., marked # S.B.T.

A live oak tree 5 in. diam. bears N. 75° W. 47 lks. dist., marked # S.B.T. as per notes on page 22 and 23.

At 1/4 sec. cor. between Secs. 2 and 3, I set a sand rock boulder 15x 12 in for 1/4 sec. cor., marked # on west face with marked stone 24 in. base and 18 in high around said boulder, and from which an elder tree 5 in. diam., bears S. 42° E 51 lks. dist., marked # S.B.T.

At 1/4 sec. cor. between Secs. 3 and 10, I set an elder post 3 ft. long, 3 in. square, with marked stone 12 in. in the ground for 1/4 sec. cor. marked post # S. on north face, dug pits 18 x 18 x 12 in E. and W. of post, 5 ft. distant, and raised a mound of earth 24 in. base, and 12 in. high round post, as per notes on pages 20 and 21.

I, Albert George Huxton, United States Deputy Surveyor, do solemnly swear that in pursuance of special instructions received from R.P. Hammond, Jun., United States Surveyor General for California, dated June 8th, 1889, under contract No. 12, dated September 27th, 1887, I have well, faithfully and truly and in my own proper person made the following alterations on the ground in surveys executed by me in T. 1 S., R. 15 W., S.B.M. 412:

SWORN STATEMENT OF ALTERATION:

ALBERT GEORGE HUXTON,
U. S. Deputy Surveyor,
Los Angeles, June 11th, 1888.

Sycamores in the canons. In Section 2 there are deposits of granite. The improvements are permanent and the houses noted occupied by actual settlers. In order to correctly locate the houses I was obliged to run the traverse lines that precede this report.

SUBDIVISION OF FRAC. T. 1 S., R. 15 W., S.B.B. AND M.

I, ALBERT GEORGE HUXTON, United States Deputy Surveyor, do solemnly swear that in pursuance of instructions received from the United States Surveyor-General for California, bearing date of the 30th day of November, 1887, I have well, faithfully, and truly in my own proper person, and in strict conformity with the instructions furnished by the United States Surveyor-General for California, the surveying manual, and the laws of the United States, surveyed all those parts or portions of TOWNSHIP ONE SOUTH, RANGE FIFTEEN WEST, of the SAN BERNARDINO BASE AND MERIDIAN, of California, as represented in the foregoing field-notes as having been surveyed by me and under my directions; and I do further solemnly swear that all the corners of said survey have been established and perpetuated in strict accordance with the surveying manual, printed instructions, the special written

FINAL OATH OF UNITED STATES DEPUTY SURVEYOR.

(SEAL) R. H. CHAPMAN Notary Public.

SUBSCRIBED AND SWORN to before me this 26th day of May, 1888.

- James Henry Levering, Flagman.
-, Axman.
-, Axman.
-, Chainman.
-, Chainman.
- William Horace Ensign, Chainman.
- Ludolph George Sarnow, Chainman.
-, Chainman.

We hereby certify that we assisted Albert George Huxton, United States Deputy Surveyor, in surveying all those parts or portions of the TOWNSHIP ONE SOUTH, RANGE 15 WEST, of the SAN BERNARDINO base and Meridian, of California, as are represented in the foregoing field-notes as having been surveyed by him and under his direction; and that said survey has been in all respects to the best of our knowledge and belief, well and faithfully surveyed, and the corner monuments established according to the instructions furnished by the United States Surveyor-General for California.

FINAL OATHS OF ASSISTANTS.

-, Flagman.
- James Henry Levering, Flagman.
-, Axman.
-, Axman.
-, Chainman.
-, Chainman.
- William Horace Ensign, Chainman.
- Ludolph George Sarnow, Chainman.
-, Chainman.

A list of the names of the individuals employed by Albert George Huxton, United States Deputy Surveyor, to assist in running, measuring, and marking the lines and corners described in the foregoing field-notes of the survey of TOWNSHIP ONE SOUTH, RANGE 15 WEST, SAN BERNARDINO BASE AND MERIDIAN, showing the respective capacities in which they acted.

LIST OF NAMES.

FINAL OATHS FOR SURVEYS.