

Copied from Photographic Copies
furnished by
U.S. General Land Office,
Washington, D. C.

Note, -

Red lines run by M.F. Reilly - 1895

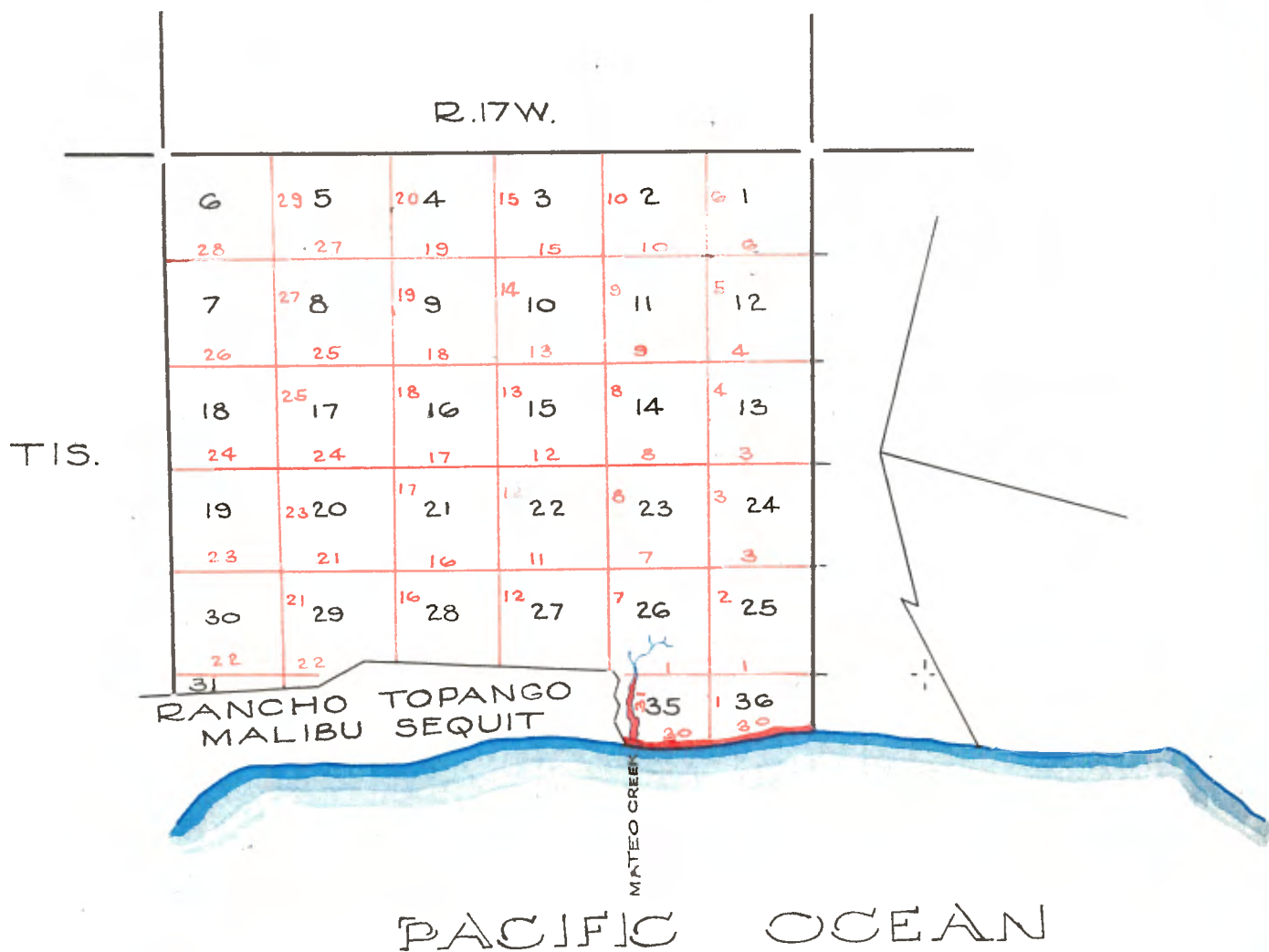

SUBDIVISIONS T.1 S., R.17 W., S.B.M.

From the cor. to Secs. 25, 30, 31, and 36, on E. Boundary of Tp. previously described, I run, West on a true line bet. Secs. 25 and 36, Var. 14° 36' East. Ascend.

6.50

Cross trail bears N.W. and S.E. Top of spur bears N. 50° W. and S. 50° E and descend.

7.00

Cross gulch, 4 lks. wide, course S. and ascend. Top of spur bears N. and S. and descend.

9.75

Cross gulch, 5 lks. wide, course S. and ascend. To foot of perpendicular bluff impossible to chain: to avoid same, I

12.00

offset N. 25 lks., thence W. 100 lks., Thence, S. 25 lks. to true line and continue W. counting distances from cor. to Secs. 25, 30, 31, and 36,

27.50

Top of spur, bears N. and S. and descend. Set a sandstone 26 x 15 x 9 ins. in the ground for 1/4 sec. cor., marked 1/4 on N. face and raised a stone mound alongside.

29.00

Pits impracticable. Cross gulch, 3 lks. wide, course S. 10° W. and ascend.

44.85

Top of spur bears N.E. and S.W. and descend. Cross canon 12 lks. wide, course S. and ascend

47.00

Top of spur bears N. and S. and descend. Enter rolling land, bears N and S

50.22

A cabin, bears N 5 lks. dist. Cross gulch, 4 lks. wide, course S. and ascend.

55.50

Top of high hill, bears N.W. and S.E. and descend. Cross gulch, 3 lks wide, course S. 45° E and ascend

63.00

Set a cement stone 26 x 14 x 10 ins. in the ground for cor. to Secs. 25, 26, 35, and 36, marked with 1 notch on S. and E. edges and raised

69.42

Pits impracticable. Land for E. 60.00 chs. broken and mountainous.

70.96

Remainder rolling hills. Soil 3rd rate. Scattering oak timber and dense undergrowth of chaparral.

75.50

South on a true line bet. Secs. 35 and 36, Var. 14° 30' East. Ascend

78.04

Top of ridge bears N 55° W and S 55° E and descend. Cross road bears N 25 W and S. 25° E.

80.00

Set a sandstone 22 x 18 x 12 ins. in the ground for 1/4 sec. cor., marked 1/4 on W. face and raised a stone mound alongside.

41.10

To a point near high water mark on the shore of the Pacific Ocean and set a sandstone 28 x 12 x 12 ins. in the ground for Meander cor. to fractional Secs. 35 and 36, marked M.C. with 1 notch on E. and

40.00

5 notches on W. edges and raised a stone mound alongside. Pits impracticable.

4.00

Top of ridge bears N 55° W and S 55° E and descend. Cross road bears N 25 W and S. 25° E.

5.60

Set a sandstone 22 x 18 x 12 ins. in the ground for 1/4 sec. cor., marked 1/4 on W. face and raised a stone mound alongside.

41.10

To a point near high water mark on the shore of the Pacific Ocean and set a sandstone 28 x 12 x 12 ins. in the ground for Meander cor. to fractional Secs. 35 and 36, marked M.C. with 1 notch on E. and

40.00

5 notches on W. edges and raised a stone mound alongside. Pits impracticable.

41.10

Scattering oak timber and dense undergrowth of Chaparral. Soil 3rd rate.

41.10

From the cor. to Secs. 25, 26, 35, and 36, I run, West on a true line bet. Secs. 26 and 35, Var. 14° 30' East. Ascend.

CHAINS

SUBDIVISIONS T.1 S., R.17 W., S.B.M.

5.00	Cross wood road bears N.25° W. and S.25° E.
7.00	Cross wood road on top of ridge, bears N.W. and S.E. and descend.
17.68	Cross canon, 8 lks. wide, course S. and ascend.
20.50	Top of spur bears N. and S. and descend.
22.57	Cross gulch, 4 lks. wide, course S.10° E. and ascend.
26.80	Top of spur, bears N. and S. and descend.
37.04	Cross canon 6 lks. wide, course S. and ascend.
40.00	Set a sandstone 16 x 12 x 6 ins. in the ground for $\frac{1}{4}$ sec. cor., marked $\frac{1}{4}$ on N. face
45.00	Top of spur, bears N. and S. and descend.
63.50	Cross gulch, 10 lks. wide, course S.30° W. and ascend.
65.50	Top of spur bears N.20° E. and S.20° W. and ascend.
68.16	Intersect E. boundary of Rancho Topanga Malibu Seguit at a point 4.10 chs. S.31° E. from cor. No. 2 on Bd. which is a Sycamore 14 ins. dia., marked T.M. No. 2, from which bears a live Oak 14 ins. dia. S. 60° 3/4. W.65 lks. dist., marked T.M.B.T. As this point falls in Mateo Creek impossible to mark, I retrace line 58 lks. E. and at a distance from cor. to Secs. 25, 26, 35 and 36 of
67.68	Set a sandstone 26 x 18 x 10 ins. in the ground for Witness cor. to closing cor. to Secs. 26, and 35, marked, W.C.C.C. with 1 notch on S. and 5 notches on N. edges dug pits 18 x 18 x 12 ins. N.S. and E. of stone 5 $\frac{1}{2}$ ft. dist and raised an earth mound 2 ft. high 4 $\frac{1}{2}$ ft. base alongside.
	Land mountainous.
	Soil 3rd rate.
	Scattering Oak timber.
	Dense undergrowth of chaparral.

	From the cor. to Secs. 25, 26, 35, and 36, I run, North, between sections 25 and 26, Var. 14° 30' East.
.25	Descend.
1.00	Top of ridge bears E. and W. and descend.
1.75	Cross low sag, bears E. and W. and ascend.
16.00	Top of ridge, bears E. and W. and descend.
40.00	Set a sandstone 28 x 14 x 14 ins. in the ground for $\frac{1}{4}$ sec. cor. marked $\frac{1}{4}$ on W. face and raised a stone mound alongside.
41.00	Cross gulch, 4 lks. wide, course S.E. and ascend
49.50	Cross road on top of ridge, bears N.55° E. and S.55° W. and descend
50.60	Cross head of gulch, course W. and ascend.
55.50	Top of spur, bears E. and W. and descend.
65.60	Cross gulch, 4 lks. wide, course N.45° W. and ascend.
68.00	Top of spur bears N.W. and S.E. and descend.
79.80	Cross ravine, 6 lks. wide, course N.W. and ascend.
80.00	Set a sandstone 28 x 20 x 8 ins. in the ground for cor. to Secs. 23, 24, 25, and 26, marked with 2 notches on S. and 1 notch on E. edges from which bears a
	Sycamore 16 ins. dia. N.33 $\frac{1}{2}$ ° E. 21 lks. dist. marked
	T.1 S. R.17 W., S.24, B.T.
	A Sycamore, 14 ins. dia. S. 79 $\frac{1}{2}$ ° W. 11 lks. dist., marked
	T.1 S., R.17 W., S.26 B.T.
	A live oak, 18 ins. dia. S.64 $\frac{1}{2}$ ° E. 12 lks. dist., marked,
	T.1 S., R.17 W., S.25 B.T.
	No other tree within limits.
	Raised a stone mound alongside corner stone
	Pits impracticable.

40.00 Set temporary $\frac{1}{4}$ sec. cor. Var. 14' 14' East. East on a random line bet. Secs. 13 and 24, and 24.

Scattering oak timber and dense undergrowth of chaparral, October 29th, 1895.

Land mountainous. Soil 3rd rate.

4 $\frac{1}{2}$ ft. base along side. Dug pits in each sec. 5 $\frac{1}{2}$ ft. dist., and raised an earth mound 2 ft. high, H. edges, Secs. 13, 14, 23, and 24, marked with 3 notches on S and 1 notch on Set a sandstone 26 x 12 x 10 ins. 19 ins. in the ground for cor. to Cross gulch, 3 lks. wide, course S. 60° E. and ascend 80.00 Top of spur bears N. W. and S. E. and descend. 45.50 an earth mound 1 $\frac{1}{2}$ ft. high, 3 $\frac{1}{2}$ ft. base, along side. Dug pits 18 x 18 x 12 ins. N. and S. of stone 5 $\frac{1}{2}$ ft. dist., and raised marked $\frac{1}{4}$ on W. face., 40.00 Set a sandstone 34 x 11 x 9 ins. 25 ins. in the ground for $\frac{1}{4}$ sec. cor. 38.60 Cross gulch 4 lks. wide, course E. and ascend. Top of spur bears E. and W. and descend. 28.00 Ascend. Var. 14' 15' East. North, between Secs. 23, and 24.

Scattering oak timber and dense undergrowth of chaparral.

Land mountainous. Soil 3rd rate.

The cor. to Secs. 23, 24, 25, and 26. 80.18 Cross ravine, 6 lks. wide, course S. W. and ascend. 79.85 Leave field and cross fence bears N. E. and S. W. 55.00 Top of ridge, bears N. E. and S. W. and descend 49.00 Pits impracticable. Raised a stone mound along side corner stone No other tree within limits. A live oak 8 ins. dia. N. 36° 49' E. 62 lks. dist., marked $\frac{1}{4}$ S. B. T. marked $\frac{1}{4}$ on N. face from which bears Set a sandstone 26 x 12 x 9 ins. 19 ins. in the ground for $\frac{1}{4}$ sec. cor., 40.09 Cross fence, bears N. E. and S. W. and enter field 38.50 Cross road, bears N. E. and S. W. 28.15 Top of spur, bears N. and S. and descend 21.15 Cross gulch, 6 lks. wide, course N. 10° E. and ascend. 18.80 Descend. Var. 14' 33' East. Thence I run N, 89° 51' W. on true line bet. Secs. 24 and 25, previously described. 80.18 Intersect E. Boundary of T. p. 21 lks. N. of cor. to Secs. 19, 24, 25, and 30, Set temporary $\frac{1}{4}$ sec. cor. 40.00 Var. 14' 15' East. East, on a random line bet. Secs. 24 and 25,

Scattering timber of Sycamore and Oak and dense undergrowth of Chaparral. October 28th, 1895.

Land mountainous. Soil 3rd rate.

SUBDIVISIONS, T. 1 S., R. 17 W., S. B. M.

SUBDIVISIONS T.1 S., R.17 W., S.B.M.

79.94 Intersect E. boundary of Tp. 19 lks. S. of cor. to Secs. 13, 18, 19, and 24, previously described
 Thence, I run,
 S. 89° 52' W on a true line bet. Secs. 13 and 24,
 Var. 14° 42' East.
 Ascend.
 6.50 Cross trail bears N. E. and S. W.
 28.00 Top of ridge, bears N. E. and S. W. and descend
 31.00 Cross low sag, bears N. E. and S. W. and ascend
 34.50 Top of ridge, bears N. and S. and descend
 39.40 Cross gulch, 4 lks. wide, course N. E. and ascend.
 39.97 Set a sandstone 14 x 12 x 8 ins. 9 ins. in the ground for $\frac{1}{4}$ sec. cor., marked $\frac{1}{4}$ on N. face and raised a stone mound alongside.
 62.00 Top of ridge, bears N. W. and S. E. and descend.
 79.94 The cor. to Secs. 13, 14, 23, and 24.
 Land mountains.
 Soil 3rd rate.
 Scattering oak timber and dense undergrowth of same and chaparral.

North, between Secs. 13 and 14,
 Var. 14° 14' East.
 Ascend.

1.00 Top of ridge bears E. and W and descend
 13.00 Cross gulch 3 lks wide course N. E. and ascend
 17.50 Top of spur bears N. 55° E. and S. 55° W. and descend
 25.40 Cross gulch 3 lks. wide, course N. E. and ascend
 33.00 Top of spur bears N. E. and S. W. and descend
 37.92 Cross gulch, 3 lks. wide, course N. E. and ascend
 40.00 Set a sandstone 20 x 16 x 10 ins. 15 ins. in the ground for $\frac{1}{4}$ sec. cor., marked $\frac{1}{4}$ on W. face.,
 Dug pits 18 x 18 x 12 ins. N. and S. of stone $5\frac{1}{2}$ ft. dist. and raised an earth mound $1\frac{1}{2}$ ft. high, $3\frac{1}{2}$ ft. base alongside
 40.20 Top of Sierra Madre de Santa Monica mountains bears N 60° E. and S. 60° W. and descend
 46.50 Cross ravine, 6 lks. wide course E and ascend
 54.50 Top of ridge bears E and W and descend
 62.80 Cross gulch 5 lks wide, course E and ascend
 69.70 Top of spur bears N. E. and S. W. and descend
 74.54 Cross gulch 3 lks wide, course E. and ascend
 76.50 Top of spur bears N. E. and S. W. and descend
 80.00 Set a sandstone 20 x 14 x 12 ins. 15 ins. in the ground for cor. to Secs. 11, 12, 13, and 14, marked with 1 notch on E. and 4 notches on S. edges.
 Dug pits 18 x 18 x 12 ins. in each sec. $5\frac{1}{2}$ ft. dist and raised an earth mound 2 ft. high $4\frac{1}{2}$ ft. base alongside.
 Land mountains
 Soil 3rd rate.
 Scattering oak timber and dense undergrowth of chaparral.
 October 30th, 1895.

East, on a random line bet. Secs. 12 and 13,
 Var. 14° 30' East.
 40.00 Set temporary $\frac{1}{4}$ sec. cor.
 80.28 Intersect E. boundary of Tp. 24 lks. S. of cor. to Secs. 7, 12, 13, and 18, previously described.
 Thence, I run,
 S. 89° 52' W on a true line bet. Secs. 12 and 13, Var. 14° 42' East.
 Ascend!

SUBDIVISIONS T.L.S. R.17. W. S.B.M.

1.40	Cross road bears N.E. and S.W.
1.45	Cross wire fence, bears N. and S.
3.00	Enter cultivated land bears N and S
12.50	Cross road and enter vineyard, bears N. and S.
17.00	Cross road and leave vineyard, bears N. and S.
17.10	Leave cultivated land, bears N. and S.
28.00	Top of spur, bears N. 15° E. and S. 15° W. and descend
30.00	Cross gulch, 6 lks. wide, course N. 10° E. and ascend.
35.00	Top of spur, bears N. and S. and descend.
38.75	Cross gulch, 4 lks. wide, course N. 15° E. and ascend
40.14	Set a sandstone 30 x 14 x 10 in. in the ground for $\frac{1}{4}$ sec. cor., marked $\frac{1}{4}$ on N. face from which bears
51.50	A live oak 15 ins. dia. S. 25° E. 57 lks. dist. marked $\frac{1}{4}$ S.B.T.
56.00	A live oak 8 ins. dia. S. 12 3/4° W. 32 lks. dist. marked $\frac{1}{4}$ S.B.T.
63.00	Top of spur bears N. and S. and descend.
67.00	Cross gulch 4 lks wide, course N 3° W. and ascend.
75.10	Top of spur, bears N.E. and S.W. and descend.
80.28	The cor. to Secs. 11, 12, 13, and 14, Land mountainous. Soil 2nd and 3rd rate. Scattering oak timber and dense undergrowth of chaparral
14.50	Descend North between Sections 11 and 12, Var. 14° 30' East.
14.50	To foot of perpendicular sandstone rocks impossible to chain. To avoid same I offset E 100 lks. thence N. 2.00 chs. thence W. 100 lks. to true line counting distance from cor. to Secs. 11, 12, 13, and 14,
16.70	Cross ravine, 20 lks. wide, course E. and ascend.
22.25	Top of spur bears E. and W. and descend.
27.30	Cross gulch, 5 lks. wide, course E. and ascend.
28.00	Top of slope bears E. and W. and descend
28.70	Cross ravine 6 lks. wide, course E. and ascend.
32.10	Top of low spur bears E. and W. and descend.
37.50	Cross gulch, 3 lks. wide, course E. and ascend.
40.00	Set a sandstone 22 x 12 x 6 ins. in the ground for $\frac{1}{4}$ sec. cor., marked $\frac{1}{4}$ on W. face and raised a stone mound alongside. Pits impracticable.
42.00	Top of spur, bears E. and W. and descend.
45.02	Cross gulch, 3 lks. wide, course S.E. and ascend.
50.00	Top of spur bears N.W. and S.E. and descend.
67.80	Cross gulch, 4 lks. wide, course S. 65° E. and ascend
73.00	Top of high spur, bears E. and W. and descend.
80.00	Set a sandstone 28 x 16 x 12 ins. in the ground for cor. to Secs. 1, 2, 11, and 12, marked with 1 notch on E and 5 notches on S. edges from which bears,
	A Manginita 5 ins. dia. S. 87° E. 50 lks. dist. marked T.1 S., R.17 W. S. 12 B.T.
	A live oak 8 ins. dia. N. 46 3/4° W. 43 lks. dist. marked T.1 S., R.17 W., S. 2 B.T.
	No other tree within limits.
	Raised a stone mound alongside, corner stone Pits impracticable.
	Land mountainous. Soil 3rd rate.

SUBDIVISIONS T.1 S., R.17 W., S.B.M.

Scattering oak timber and dense undergrowth of same and chaparral. Oct. 31st, 1895.

40.00	Set temporary $\frac{1}{4}$ sec. cor. Var. 14° 36' East.
80.21	Intersect E. boundary of Tp. 32 lks. S. of cor. to Secs. 1, 6, 7, and 12, previously described thence I run S. 89° 46' W on a true line bet. Secs. 1 and 12, Var. 14° 30' East.
2.38	Descend.
11.00	Cross gulch 4 lks wide, course S. 25° E and ascend.
18.75	Top of spur, bears N. 25° W and S. 25° E and descend.
29.00	Cross gulch, 5 lks. wide, course S. 25° E. and ascend.
37.25	Cross road on top of spur bears N 30° W. and S. 30° E. and descend.
40.10	Set a sandstone 34 x 18 x 8 ins. 25 ins. in the ground for $\frac{1}{4}$ sec. cor., marked $\frac{1}{4}$ on N. face and raised a stone mound alongside.
41.50	Pits impracticable.
49.84	Top of spur bears N. E. and S. W. and descend.
56.00	Cross gulch, 4 lks. wide, course S. and ascend.
68.00	Top of spur bears N. and S. and descend.
69.00	Cross gulch 4 lks wide, course S. W. and ascend.
70.00	Top of low spur bears N. and S. and descend.
71.00	Cross Topango creek 20 lks. wide, course S. and ascend.
77.00	Cross road, bears N. 25° W. and S. 25° E.
79.00	Top of spur bears N and S and descend.
80.21	Cross gulch 3 lks. wide, course N and ascend.
80.21	The cor. to Secs. 1, 2, 11, and 12, Land mountainous
	Soil 3rd rate.
	Scattering oak timber and dense undergrowth of chaparral.
40.00	Set temporary $\frac{1}{4}$ sec. cor. Var. 14° 36' East.
80.22	Intersect the San Bernardino Base Line 27 lks. W. of cor. to Secs. 1, 2, 35, and 36, on N. boundary of Tp. previously described, thence, I run, S. 12' W. on a true line bet. Secs. 1 and 2, Var. 14° 30' East
3.70	Descend.
14.00	Cross gulch 5 lks wide, course S. W. and ascend
17.00	Top of spur bears N 60° E and S. 60° W. and descend
21.00	Cross gulch 3 lks wide, course S. W. and ascend
25.76	Top of spur bears N. E. and S. W. and descend
30.00	Cross gulch, 3 lks. wide, course S. 60° W and ascend
30.75	Top of spur bears N. E. and S. W. and descend
33.70	Enter open glade bears N. E. and S. W.
39.50	Leave open glade bears N 20° W and S 20° E
40.22	Cross gulch, 2 lks wide, course S. 20° E and ascend
	Set a sandstone 32 x 20 x 14 ins. 24 ins. in the ground for $\frac{1}{4}$ sec. cor., marked $\frac{1}{4}$ on W. face and raised a stone mound alongside.
	Pits impracticable.
41.00	Cor. set on top of low spur bears E. and W. and descend.
43.00	Cross gulch, 4 lks. wide, course E. and ascend.
46.20	Top of low spur bears E and W and descend
	Cross ravine, 15 lks. wide, course W. and ascend.

CHAINS

SUBDIVISIONS T.1S. R.17 W., S.B.M.

59.00 Top of spur,bears E.and W.anddescend
 62.50 Crossgulch,4 lks.wide,course N.W.and ascend
 66.50 Top of spur,bears E.and W.anddescend
 75.00 Cross road bears N.60° W.and S.60° E.
 75.40 Cross Topango creek 20 lks.wide,
 Course E.and ascend
 80.22 The cor.to Secs.1,2,11,and 12,
 Landmountainous
 Soil 3rd rate.
 Scattered oak timber and dense undergrowth of chaparral.
 November 1st,1895.

From the cor.to Sec.23,24,25,and 26,I run,
 West on a true line bet.Secs.23 and 26,
 Var.14° 15' East.

20 Ascend
 Top of low spur bears N and S and descend
 .48 Cross ravine 6 lks.wide,course N.50° W.and ascend.

10.00 Top of spur bears N.and S.and descend
 17.20 Cross same ravine 8 lks.wide,course S.60° W.and ascend.
 39.00 Top of spur bears N 20° E and S.20° W and descend

40.00 Set a sandstone 22 x 18 x 14 ins. in a stone mound for $\frac{3}{4}$ sec.cor.,
 marked $\frac{3}{4}$ on N face.,
 Pits impracticable; too rocky to set stone in earth

50.86 Cross gulch,2 lks.wide,course S.15° W and ascend
 Top of spur bears N.E.and S.W. and descend
 72.40 Enter Mateo canon and cross creek 20 lks.wide,course S.15° W.

75.00 Leave Mateo canon bears N.and S.and ascend
 80.00 Set a sandstone 28 x 12 x 9 ins.21 ins.in the ground for cor.to
 Secs.22, 23,26 and 27, marked with 2 notches on S.and E.edges and
 raised a stone mound alongside.

Pits impracticable.
 Land mountainous.
 Soil 3rd rate.

Dense undergrowth of chaparral.
 No timber.

I carefully examined the adjustments of my solar compass today particularly the latitude and reversing apparatus and found them correct.

South on a true line bet.Secs.26 and 27,
 Var.14° 06' East

2.50 Top of spur bears E. and W. and descend
 15.50 Cross low sag,bears E.and W.and ascend
 20.00 Top of spur bears N.65° W.and S.65° E.and descend

25.14 Cross gulch,5 lks.wide,course E.and ascend
 Top of spur,bears E.and W.and descend
 (30.00)

(35.52) Cross gulch,4 lks wide,course N.85° E.and ascend
 40.00 Set a sandstone 22 x 15 x 7 ins. 16 ins.in the ground for $\frac{3}{4}$ sec.cor.,
 marked $\frac{3}{4}$ on W.face and raised a stone mound alongside.
 Pits impracticable.

60.25 Cor. set on top of spur,bears E.and W.anddescend
 Cross gulch 4 lks.wide course E and ascend
 63.00 Top of spur bears N 40° E and S 40° W and descend

64.75 Cross gulch,4 lks.wide,course N.45° E and ascend
 Top of spur bears E.and W.anddescend

70.20 Cross gulch,4 lks.wide,course E.and ascend
 Intersect N.boundary of Rancho Topango Malibu Seguit 9.64 chs.N.84°

09' W.from cor.No.2 and set a sandstone 18 x 12 x 10 ins.12 ins.in the
 ground for closing cor. to Secs.26 and 27, marked C.C. with 2 notches on

E. and

Var. 14° 15' East.

North, between Sections 14 and 15,

Scattering oak timber and dense undergrowth of chaparral. November 4th, 1895.

Soil 3rd rate.

Land mountainous

The cor. to Secs. 14, 15, 22, and 23.

Cross Mateo canon 8 lks. wide, course S. and ascend.

Top of spur, bears N.W. and S.E. and descend.

Cross gulch, 3 lks. wide, course S. 10° W. and ascend

Pits impracticable.

marked $\frac{3}{4}$ on N. face and raised a stone mound alongside.

Set a sandstone 17 x 15 x 10 ins. in the ground for $\frac{3}{4}$ sec. cor.,

Top of spur, bears N. and S. and descend

Cross head of gulch, course S. 12° W. and ascend

Top of spur bears N. and S. and ascend

Cross head of gulch, course S. and ascend

Descend.

Var. 14° 14' East.

S. 89° 47' W. on a true line bet. Secs. 14 and 23,

I run,

Intersect N. and S. line 31 lks. S. of cor. to Secs. 13, 14, 23, and 24, thence,

Set temporary $\frac{3}{4}$ sec cor.

Var. 14° 15' East.

East on a random line bet. Secs. 14 and 23,

Scattering oak timber and dense undergrowth of chaparral

Soil 3rd rate.

Land mountainous

Pits impracticable.

raised a stone mound alongside.

Set a sandstone 28 x 12 x 8 ins. in the ground for cor. to Secs.

Cross gulch, 5 lks. wide, course S.E. and ascend.

Top of spur, bears N.W. and S.E. and descend

Cross gulch, 5 lks. wide, course S. 70° E. and ascend

Pits impracticable.

on W. face, and raised a stone mound alongside.

Set a sandstone 18 x 16 x 12 ins. in the ground for $\frac{3}{4}$ sec. cor., marked $\frac{3}{4}$

Top of spur, bears N.W. and S.E. and descend.

Cross gulch, 3 lks. wide, course S. 65° E. and ascend

Top of spur, bears N. 60° W. and S. 60° E. and descend

Cross gulch, 3 lks. wide, course E. and ascend

Descend

Var. 14° 06' East

North, between Secs. 22, 23, 26 and 27, I run,

From the cor. to Secs. 22, 23, 26 and 27, I run,

Scattering oak timber and dense undergrowth of chaparral. November 2, 1895.

Soil 3rd rate.

Land mountainous.

4 notches on W edges dug pits 18 x 18 x 12 ins. N.E. and W. of stone $5\frac{1}{2}$ ft. dist., and raised an earth mound 2 ft. high, $4\frac{3}{4}$ ft. base alongside.

SUBDIVISIONS T. 1. S., R. 17 W., S. B. M.

Ascend
 14.00 Top of spur, bears N. W. and S. E. and descend.
 21.76 Cross gulch, 4 lks. wide, course S. 40° E. and ascend
 40.00 Set a sandstone 27 x 15 x 9 ins. in the ground for $\frac{3}{4}$ sec. cor., marked $\frac{3}{4}$ on W. face and raised a stone mound alongside, pits impracticable.
 45.00 Top of Sierra Madre de Santa Monica mountains, bears N. 70° E. and S. 70° W. and descend.
 76.60 Cross gulch, 4 lks. wide, course W. and ascend.
 80.00 Set a sandstone 22 x 14 x 10 ins. in the ground for cor. to Secs. 10, 11, 14, and 15, marked with 2 notches on E. and 4 notches on S. edges and raised a stone mound alongside. Pits impracticable.
 Land mountainous.
 Soil 3rd rate.
 Scattering sycamore and oak timber and dense undergrowth of chaparral.

East on a random line bet. Secs. 11 and 14, Var. 14° 15' East.
 40.00 Set temporary $\frac{3}{4}$ sec. cor.
 80.19 Intersect N. and S. line 18 lks. N. of cor. to Secs. 11, 12, 13, and 14, thence, I run,
 N. 89° 52' W. on a true line bet. Secs. 11 and 14, Var. 14° 30' East.
 Descend.
 5.90 Cross gulch, 5 lks. wide, course N. 10° E. and ascend
 9.00 Top of spur, bears N. and S. and descend.
 18.77 Cross gulch, 4 lks. wide, course N. 10° W. and ascend
 29.74 Top of spur, bears N. and S. and descend
 35.73 Cross ravine, 20 lks. wide, course N. 44° E. and ascend
 40.09 Set a sandstone 24 x 14 x 10 ins. in the ground for $\frac{3}{4}$ sec. cor., marked $\frac{3}{4}$ on N. face and raised a stone mound alongside. Pits impracticable.
 58.72 Top of divide, bears N. 10° E. and S. 10° W. and descend.
 80.19 The cor. to Secs. 10, 11, 14, and 15, Land mountainous
 Soil 3rd rate,
 Timber of oak and dense undergrowth of chaparral.
 November 5th, 1895.

North between Sections 10 and 11,
 Var. 14° 15' East,
 Ascend.
 75 Top of low spur, bears N. E. and S. W. and descend.
 1.50 Cross gulch, 3 lks. wide, course S. W. and ascend
 34.00 To foot of perpendicular bluff 40 ft. high impossible to chain
 To avoid same I offset 1.25 chs. E. thence N. 1.25 chs. thence W. 125 chs. to true line counting distance from cor. to Secs. 10, 11, 14 and 15, descend
 37.75 Cross gulch 4 lks wide course W and ascend
 40.00 Set a sandstone 24 x 12 x 9 ins. in the ground for $\frac{3}{4}$ sec. cor., marked $\frac{3}{4}$ on W. face and raised a stone mound alongside, pits impracticable.
 41.40 Top of ridge bears N. 70° E. and S. 70° W. and descend
 58.50 Cross gulch 10 lks. wide, course N. 65° E. and ascend
 65.00 Top of spur bears N. E. and S. W. and descend.

40.00 Set temporary $\frac{1}{4}$ sec cor Var. 14° 00' East
 80.10 North on a random line bet secs 2 and 3
 on N. boundary of "p previously described,
 Intersect San Bernardino Base Line 8 lks. E. of cor to secs. 2, 3, 34, and 35,

43.00 Top of spur bears N.W. and S.E. and descend
 45.15 Cross same gulch 5 lks. wide, course S.E. and ascend
 48.00 Top of low spur bears N and S and descend
 50.30 Cross same creek 5 lks wide, course N.E. and ascend
 56.00 Top of spur bears N and S and ascend
 63.60 Cross gulch 6 lks. wide, course N and ascend
 71.50 Top of spur bears N. 25° W. and descend
 78.00 Cross gulch 6 lks wide course N and ascend
 79.96 The cor. to Secs. 2, 3, 10, and 11,
 Landmountainous
 Soil 3rd rate,
 Scattering oak timber and dense undergrowth of chaparral.
 November 6th, 1895.

40.00 Set temporary $\frac{1}{4}$ sec. cor. Var. 14° 00' East.
 40.00 East on a random line bet. Secs. 2 and 11,
 Intersect N and S line 17 lks S of cor. to Secs. 1, 2, 11, and 12, thence,
 I run, S. 89° 53' W on a true line bet. Secs. 2 and 11,
 Var. 14° 36' East
 Ascend
 4.50 Top of spur bears N and S and descend
 13.50 Cross ravine 6 lks. wide, course N. 20° E and ascend
 13.90 Cross road, bears N. and S.
 17.50 Marcett's house bears N 33° E 2.00 chs. dist.
 20.00 To foot of perpendicular bluff on spur bears N and S impossible to
 chain
 To avoid same I offset 50 lks., thence, S. 89° 53' W. 2.00 chs. thence,
 N. 50 lks. dist. to true line counting distances from cor. to Secs. 1, 2,
 11, and 12,
 Descend.
 28.00 Cross creek, 15 lks. wide, course N.E. and ascend
 29.10 Top of spur, bears N. and S. and descend
 31.48 Cross same creek, 15 lks. wide, course S.E. and ascend
 36.00 Top of spur bears N and S and descend
 38.55 Cross same creek 10 lks. wide course N.E. and ascend
 39.98 Set a sandstone 30 x 10 x 8 ins. 22 ins. in the ground for $\frac{1}{4}$ sec. cor.,
 marked $\frac{1}{4}$ on N. face from which bears
 A Sycamore 8 ins. dia. N. 86° E. 180 lks. dist.,
 marked, $\frac{1}{4}$ S.B.T.
 A Sycamore 6 ins dia S 60° E 152 lks. dist.,
 marked $\frac{1}{4}$ S.B.T.

SUBDIVISIONS T. 1. S., R. 17 W., S. B. M.

70.90 Cross gulch 4 lks wide course N. 45° E and ascend
 73.75 Top of spur bears E and W and descend
 80.00 Set a sandstone 22 x 12 x 8 ins. 16 ins. in the ground for cor. to
 Secs. 2, 3, 10, and 11, marked with 2 notches on E. and 5 notches on S.
 edges and raised a stone mound alongside.
 Pits impracticable
 Land mountainous
 Soil 3rd rate
 Scattering oak timber and dense undergrowth of chaparral.

SUBDIVISIONS T.1 S., R.17 W., S.B.M.

Thence, I run, S.0° 4' E on a true line bet. Secs. 2 and 3, Var. 14° 30' East.

1.50 Top of ridge bears E and W and descend
 15.00 Cross canon 10 lks. wide, course N 60° E and ascend
 23.50 Top of ridge bears E and W and descend
 28.50 Cross canon 10 lks. wide, course E and ascend
 34.75 Top of ridge bears N 50° E and S. 50° W and descend
 38.00 Cross gulch 10 lks. wide, course N 85° E and ascend
 40.10 Set a sandstone 24 x 14 x 9 ins. 18 ins. in the ground for $\frac{3}{4}$ sec. cor., marked $\frac{1}{4}$ on W. face and raised a stone mound alongside, pits impracticable
 56.50 Top of spur bears E and W and descend
 60.50 Cross gulch, 4 lks. wide, course S. 60° W and ascend
 62.50 Top of ridge bears N. 70° E and S. 70° W and descend
 65.20 Cross gulch 3 lks. wide course S 60° W and ascend
 66.25 Top of ridge bears N 60° E and S 60° W and ascend
 68.20 Cross gulch 4 lks wide, course S 30° E and ascend
 69.00 Top of spur bears E and W and descend
 74.50 Cross ravine 6 lks. wide, course E. and ascend
 80.10 The cor. to secs. 2, 3, 10, and 11, Land mountainous
 Soil 3rd rate
 Scattering oak timber and dense undergrowth of chaparral
 November 7th, 1895.

From the cor. to Secs. 22, 23, 26, and 27, I run, West on a true line bet. Secs. 22 and 27, Var. 14° 06' East

6.56 Ascend.
 10.00 Top of ridge bears N. W. and S. E. and descend
 25.00 Cross wash 10 lks. wide, course N. 80° E. and ascend
 25.00 Top of ridge bears N. and S. and descend
 31.00 Cross low sag, bears N. and S. and ascend
 34.00 Top of spur bears N. E. and S. W. and descend
 39.00 Cross trail, bears N. and S.
 40.00 Set a sandstone 28 x 14 x 10 ins. 21 ins. in the ground for $\frac{3}{4}$ sec. cor., marked $\frac{1}{4}$ on N face and raised a stone mound alongside
 pits impracticable
 40.50 Cross gulch 8 lks wide, course NW and ascend
 42.50 Top of spur, bears N and S and descend
 55.25 Cross canon 25 lks. wide, course S. 10° W. and ascend
 56.50 Top of spur bears N and S and descend
 73.85 Cross canon 10 lks wide, course S and ascend
 75.00 Top of spur bears N and S and descend
 80.00 Set a sandstone 30 x 12 x 10 ins. 22 ins. in the ground for cor. to Secs. 21, 22, 27 and 28, marked with 2 notches on S. and 3 notches on E. edges and raised a stone mound alongside.
 pits impracticable.
 Land mountainous.
 Soil 3rd rate.
 Scattering oak timber and dense undergrowth of chaparral.

South on a true line bet. Secs. 27 and 28, Var. 14° 18' East.
 Descend
 7.50 Cross low sag, bears E. and W. and ascend.