

Copied from Photographic Copies
 furnished by
 U. S. General Land Office,
 Washington, D. C.

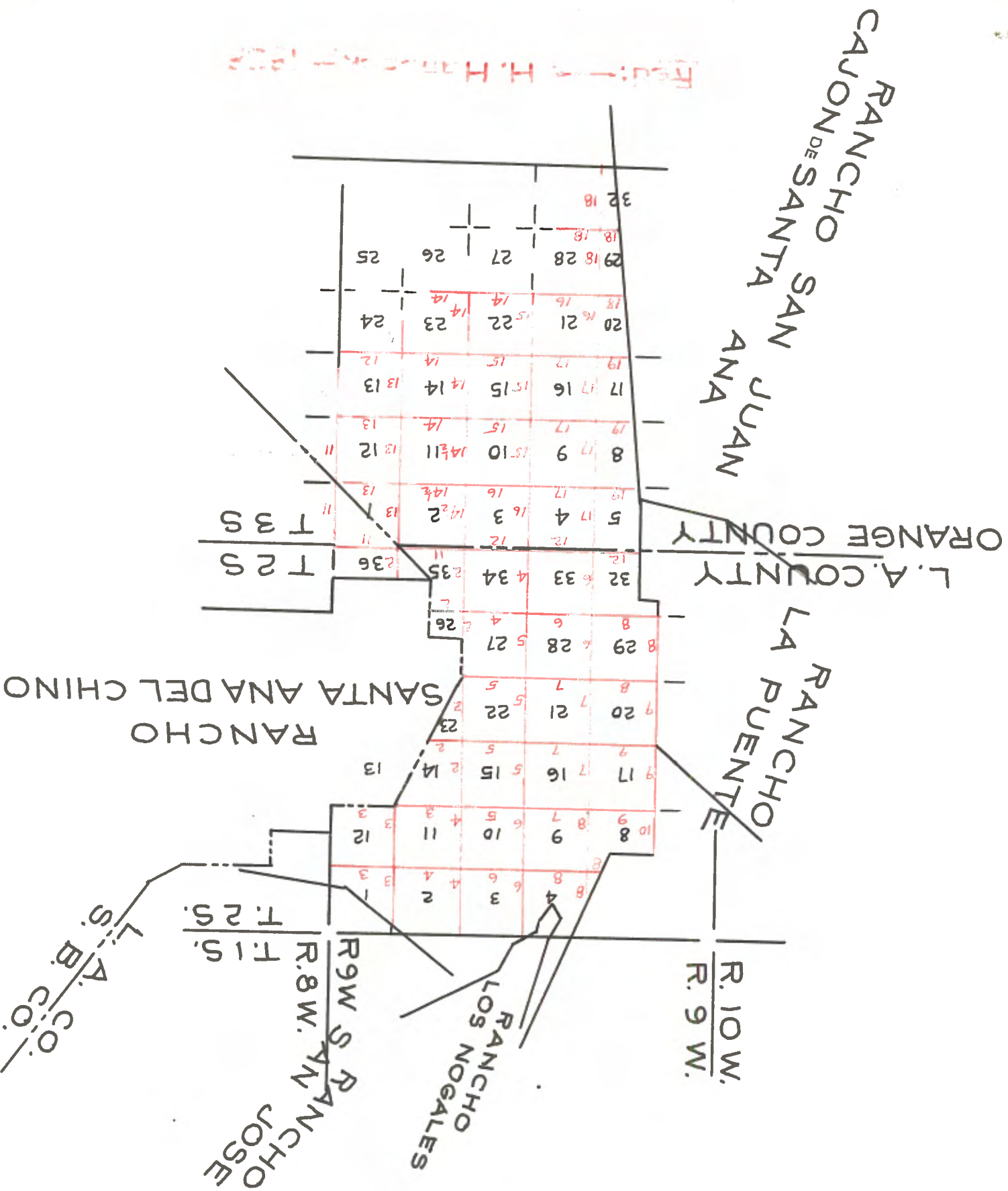

Filed: H. H. ...

HENRY HANCOCK,
Deputy sur.

this 1st day of June, 1858.

SUBSCRIBED AND SWORN to by the above named Ramon Mendibil on

RAMON MENDIBIL.

I SOLEMNLY SWEAR that I will truly perform the duties of
AYKMAN, according to instructions given me, and to the best
of my skill and ability.

HENRY HANCOCK,
Deputy sur.

SWORN and SUBSCRIBED to before me at Camp, June 1st, 1858.

JOHN WARREN,
HENRY VIRGIN.

we, JOHN WARREN and BENJAMIN VIRGIN do solemnly swear that we
will faithfully perform the duties of Chain Carriers; that
we will level the chain upon uneven ground and well and truly
plumb the tally pins whether by striking or dropping the same
and that we will report the true distance to all notable ob-
jects, and the true length of all lines that we may assist in
measuring to the best of our skill and ability.

HENRY HANCOCK,
Deputy sur.

1858.

SUBSCRIBED AND SWORN to before me at Camp on the 1st of June,

BENJAMIN HADLEY.

I, BENJAMIN HADLEY, do solemnly swear that I will well and
truly perform the duties of Compressor, according to instru-
tions given me, and to the best of my skill and ability.

PRELIMINARY OATHS OF ASSISTANTS.

TOWNSHIP 2 S., RANGE 9 W., S. B. MERIDIAN.

FIELD NOTES OF THE SURVEY OF THE SUBDIVISION LINES IN T. 2 S., R. 9 W., OF THE SAN BERNARDINO MERIDIAN IN THE STATE OF CALIFORNIA, executed by Henry Hancock, U. S. Deputy Surveyor, under his contract dated March 17, 1858, and adopted by this office under instructions dated February 23, 1865.

40.00

NORTH between sections 35 and 36, Variation 13° 25' East. Set $\frac{1}{2}$ sec. post in mound with trench and pits as per instructions on the S. bdy. line of Rancho "Santa Ana del Chino" 40 chs. E. of S. W. cor. of said Rancho. Land hilly, soil 2d rate.

40.00

NORTH between sections 34 and 35, Variation 13° 25' East. Set $\frac{1}{2}$ sec. post in mound with trench and pits as per instructions. Set post for cor. to secs. 26, 27, 34 & 35, in mound with trench and pits as per instructions, on S. bdy. of Canada Ia Brea. Land broken and hilly, soil 2nd rate.

40.00

EAST between sections 26 and 35, Variation 13° 25' E. Set $\frac{1}{2}$ sec. post in mound in the trench and pits as per instructions on W. boundary of Rancho Santa Ana del Chino" 40 chs. N. of S. W. cor. of same. Land hilly, soil 2nd rate.

28.00

NORTH between secs. 26 and 27, Var. 13° 25' East. Cross Canada Ia Brea, 2 chs. wide, course S. W. Set a sandstone rock 10 in. long, 6 in. wide and 5 in. thick for $\frac{1}{2}$ sec. cor. Set a rock 18 x 10 in. x 6 in. for cor. to secs. 22, 23, 26 & 27, on W. boundary of "Santa Ana del Chino" Rancho. Land hilly, soil 2nd rate.

40.00

NORTH between sections 22 and 23, Variation 13° 25' East. Set a sandstone rock 18 x 16 x 5 for $\frac{1}{2}$ sec. cor. marked same as per instructions. Set post for cor. to secs. 14, 15, 22 and 23, in mound with trench and pits as per instructions. Land rolling, soil 2nd rate.

40.00

EAST between sections 14 and 23, Var. 13° 25' East. Interest boundary of Rancho "Santa Ana del Chino", and set a rock 24 x 24 x 4 for $\frac{1}{2}$ sec. cor.

40.00

NORTH between secs. 14 and 15, Var. 13° 25' E. Set $\frac{1}{2}$ sec. post in mound with trench and pits as per instructions. Set post in mound, with trench and pits as per instructions for cor. to secs. 10, 11, 14 and 15. Land hilly, soil 2nd rate.

TOWNSHIP 2 S., RANGE 9 W., S. B. MERIDIAN.

40.00 EAST on random between Secs. 11 and 14,
 Var. 13° 25' East.
 Set a rock for temporary & sec. cor.
 Intersect N. & E. line 18 lrs. N. of cor. to Secs. 11, 12, 13 & 14,
 at a corner of Rancho "Santa Ana del Chino" from which I run,
 EAST on true line between Secs. 11 and 14,
 Var. 13° 17' E.
 Set a Gray sand stone rock 17 x 6 x 5 for & sec. cor.
 To cor. to Secs. 10, 11, 14 and 15,
 Land hilly, soil 2nd rate.

40.00 EAST on random between Secs. 12 & 13,
 Var. 13° 25' East.
 Set rock for temporary & sec. cor.
 Intersect E. boundary of Township at corner to Secs. 7, 12, 13
 and 16, from which I run east on true line between Secs. 12 and 13,
 and on N. boundary of Rancho "Santa Ana del Chino"
 Var. 13° 25' E.
 Set a Granite rock 16 x 8 x 6 for & sec. cor.
 To cor. to Secs. 11, 12, 13 & 14,
 Land broken and rocky, soil 2nd rate.

40.00 NORTH between Secs. 11 and 12,
 Var. 13° 25' East.
 Set a rock 14 x 7 x 6 for & sec. cor.
 Set post for cor. to Secs. 1, 2, 11 and 12, in mound with trench
 and pits as per instructions.
 Land hilly, soil 2nd rate.

40.00 EAST on random between sections 1 and 12,
 Var. 13° 25' East.
 Set a rock for temporary & section corner.
 Intersect E. boundary of Township at post corner to sections 1, 6,
 7 and 12,
 West on true line between sections 1 and 12,
 Var. 13° 25' East.
 Set a Granite rock, 16 x 6 x 5 for & sec. corner.
 To cor. to sections 1, 2, 11 and 12.
 Land hilly, soil 2nd rate.

40.00 NORTH on random between sections 1 & 2,
 Variation 13° 25' E.
 Set temporary & section post.
 To cor. to sections 1, 2, 35 & 36,
 from which I run
 South on true line between sections 1 and 2.
 Var. 13° 25' E.
 Set & sec. post in mound with trench and pits as per instructions.
 To cor. to Secs. 1, 2, 11 and 12.
 Land hilly, soil 2nd rate.

TOWNSHIP 2 SOUTH, RANGE 9 WEST, S.B.M.

NORTH between sections 10 and 11,
Variation 13° 25' East.
Set & section post in mound with trench and pits as per instructions.
Set post for cor. to secs. 2, 3, 10 and 11, in mound with trench and
pits as per instructions.
Land underlating, soil 2d rate.

EAST on random between sections 2 & 11.
Var. 13° 25' E.
Set temporary & sec. post.
Intersect N. and S. line at cor. to secs. 1, 2, 11 and 12, from
which I run west on true line between sections 2 & 11,
Set & sec. post in mound with trench and pits as per instructions.
To cor. to secs. 2, 3, 10 and 11,
Land underlating, soil 2d rate.

NORTH on random between sections 2 & 3,
Var. 13° 25' East.
Set temporary & section post.
Intersect N. boundary of Township at corner to sections 2, 3, 34
and 35, from which I run,
SOUTH on true line between secs. 2 & 3,
Var. 13° 25' E.
Set & sec. post in mound with trench and pits as per instructions
To cor. to secs. 2, 3, 10 and 11,
Land underlating,
Soil 2d rate.

NORTH between sections 33 and 34,
Var. 13° 25' E.
Set Gray sand stone rock 14 x 12 x 6 for & sec. cor.
Set a rock 14 x 12 x 6 for cor. to secs. 27, 28, 33 & 34,
Land hilly, soil 2d rate.

EAST on random between sections 27 and 34,
Var. 13° 25' East.
Set temporary & sec. post.
Gross errands in area, 3 hrs. wide, course S.W.
Intersect N. & S. line 30 lks. N. of cor. to secs. 26, 27, 34 & 35,
from which I run,
West on true line between sections 27 and 34,
Var. 13° 12' East.
Set & sec. post in mound with trench and pits as per instructions.
Land hilly, soil 2d rate.

TOWNSHIP 2 SOUTH, RANGE 9 WEST, S.B.M.

NORTH between sections 27 & 28,
 Var. 17th 25' E.
 Set sandstone rock 24 x 12 x 4, for $\frac{1}{2}$ sec. cor.
 Set sandstone rock 16 x 12 x 4 for cor. to sections 21, 22, 27 & 28,
 Land hilly, soil 2nd rate.

40.00

50.00

EAST on random between sections 22 and 27,
 Var. 17th 25' E.
 Set a rock for temporary $\frac{1}{2}$ sec. corner.
 Intersect N. & S. line at cor. to sections 22, 23, 26 and 27, from
 which I run west on true line between sections 22 & 27,
 Var. 17th 25' East.
 Set a brown sand stone rock, 16 x 12 x 7 for $\frac{1}{2}$ sec. cor.
 To cor. to sections 21, 22, 27 and 28,
 Land hilly with scattering live oaks, soil 2nd rate.

40.00

50.00

NORTH between sections 21 & 22,
 Var. 17th 25' East.
 Set sandstone rock 13 x 12 x 6 for $\frac{1}{2}$ sec. cor.
 Set post for cor. to sec. 15, 16, 21 and 22, in
 mound with trench and pits as per instructions on S. side of valley.
 Land hilly, soil 2nd rate.

40.00

50.00

EAST on random between sections 15 and 22,
 Variation 17th 25' East.
 Enter hills.
 Set a rock for temporary $\frac{1}{2}$ sec. cor.
 To post cor. to sec. 14, 15, 22 and 23, from which I run west on
 true line between sections 15 and 22,
 Variation 17th 25' East.
 Set a granite rock, 16 x 10 x 8, for $\frac{1}{2}$ sec. cor.
 To cor. to sections 15, 16, 21 and 22,
 Land hilly with scattering walnut and oak timber.
 Soil 2nd rate.

40.00

50.00

NORTH between sections 15 and 16,
 Variation 17th 25' East.
 Leave valley, course N. and enter hills.
 Set a granite rock 14 x 10 x 8 for $\frac{1}{2}$ sec. cor.
 Set a granite rock 20 x 12 x 8 for cor. to sec. 9, 10, 15 & 16,
 Land flat with level, last $\frac{1}{2}$ mile hills, soil 2nd rate.

40.00

50.00

EAST on random line between sections 10 and 15,
 Variation 17th 25' East.
 Set temporary $\frac{1}{2}$ sec. post.
 Intersect N. & S. line 25 lks. N. of cor. to sec. 10, 11, 14 & 15,
 from which I run,
 WEST on true line between sections 10 and 15,
 Var. 17th 15' East.
 Set $\frac{1}{2}$ sec. post in mound with trench and pits as per instructions.
 To cor. to sec. 9, 10, 15 & 16,
 Land level, soil 2nd rate.

40.50

51.00

TOWNSHIP 2 SOUTH, RANGE 9 WEST, S. B. M.

40.00 NORTH between sections 9 & 10, Variation 13° 25' East.
 40.00 Set & sec. post in mound with trench and pits as per instructions.
 40.00 Set post for cor. to sec. 3, 4, 9 & 10, in mound with trench and pits as per instructions.
 Land undulating. Soil 2nd rate.

40.00 EAST on random between sections 3 & 10, Variation 13° 25' East.
 40.00 Set temporary & sec. post.
 40.00 To cor. to sec. 2, 3, 10 and 11, from which I run
 WEST on true line between sections 3 & 10,
 Var. 13° 25' East.
 40.00 Set & sec. post in mound with trench and pits as per instructions.
 To cor. to sections 3, 4, 9 & 10,
 Land undulating. Soil 2nd rate.

40.00 NORTH between sections 3 & 4,
 Var. 13° 25' E.
 40.00 Set & sec. post in mound with trench and pits as per instructions.
 73.00 Interest S. boundary of Rancho Los Negules 3 chs. S. 53 1/2 + W. from
 Sta. No. 13 of same.
 Set post in mound with pits and trench.
 Land level, soil 1st rate.

40.00 NORTH between sections 32 and 33,
 Var. 13° 25' E.
 40.00 Set sandstone rock 1 1/2 x 12 x 6 for & sec. cor.
 40.00 Set granite rock, 1 1/2 x 6 for & sec. cor.
 50.00 Land broken, soil 2nd rate.

40.00 EAST on random between sections 28 and 33,
 Var. 13° 25' East.
 40.00 Set rock for temporary & sec. cor.
 42.00 Enter Canada.
 58.50 Cross same, course S. 60° W.
 50.00 To cor. to sections 27, 28, 33 & 34,
 from which I run,
 WEST on true line between sections 28 and 33,
 Variation 13° 25' East.
 40.00 Set granite rock, 20 x 10 x 4 for & sec. cor.
 To corner to sections 28, 29, 32 and 33,
 Land hilly, soil 2nd rate.

40.00 NORTH between sections 28 and 29,
 Variation 13° 25' East.
 40.00 Set granite rock, 1 1/2 x 6 for & sec. cor.
 70.00 Enter valley, course S. W. 20 chs. wide.
 50.00 Set rock, 12 x 11 x 10 for cor. to sec. 20, 21, 28 & 29,
 Land mostly hilly, soil 2nd rate.

TOWNSHIP 2 SOUTH, RANGE 9 WEST, S.B.M.

EAST on random between sections 21 & 28,
 Var. 13° 25' E.
 Enter hills.
 15.00
 Set rock for temporary & section corner.
 40.00
 Intersect N. & S. line 33 lks. S. of cor. to Secs. 21, 22, 27 & 28,
 from which I run
 WEST on true line between sections 21 & 28,
 Variation 13° 40' East.
 39.90
 Set Granite rock 20 x 10 x 4 for & sec. cor.
 To cor. to sections 20, 21, 28 & 29.
 79.80

NORTH between sections 20 and 21,
 Var. 13° 30' E.
 40.00
 Set a rock 12 x 10 x 4 for & section corner.
 60.00
 Set post for cor. to sections 16, 17, 20 and 21, in mound with
 trench and pits as per instructions.
 Land hilly, soil 2d rate.

EAST on random line between sections 16 and 21,
 Variation 13° 30' East.
 40.00
 Set temporary & section post.
 79.90
 Intersect N. and S. line at cor. to sections 15, 16, 21 and 22,
 from which I run,
 West on true line between sections 16 and 21,
 Var. 13° 30' East.
 39.95
 Set & section post in mound with trench and pits as per instru-
 tions.
 79.90
 To cor. to sections 16, 17, 20 and 21,
 Land hilly, soil 2d rate.

NORTH between sections 16 & 17,
 Var. 13° 30' East.
 40.00
 Set Granite rock, 20 x 7 x 4 for & sec. cor.
 62.00
 Cross road, course S. 60° W.
 80.00
 Set post in mound, with trench and pits as per instructions, for
 cor. to sections 8, 9, 16 and 17,
 Land undulating,
 Soil 2nd rate.

EAST on true line between sections 9 and 16,
 from which I run,
 To cor. to sections 9, 10, 15 & 16,
 80.00
 Set temporary & sec. post.
 40.00
 Enter valley, course S. 60° W.
 8.00
 Variation 13° 30' East.
 EASTERN RANDOM between sections 9 and 16,
 Variation 13° 30' East.
 40.00
 Set & sec. post in mound with trench and pits as per instructions
 To cor. to Secs. 8, 9, 16 and 17,
 Land level.
 Soil 1st rate.

TOWNSHIP 2 SOUTH, RANGE 9 WEST, S. B. MERIDIAN

NORTH between sections 7 & 9,
 Variation 13°30' East.
 Set post for cor. to sections 4, 5, 8 & 9, in mound with trench and pits as per instructions.
 40.00
 Set post for cor. to sections 4, 5, 8 & 9, in mound with trench and pits as per instructions.
 40.00
 EAST on random line between sections 4 & 9,
 Variation 13°30' East.
 Set temporarily § section post.
 Interest N. and S. line at cor. to sections 3, 4, 9 & 10, from
 which I run west on true line between sections 4 & 9,
 Variation 13°30' East.
 Set § sec. post in mound with trench and pits as per instructions.
 40.00
 To cor. to sections 4, 5, 8 & 9,
 Land level, soil 1st rate.
 40.00

NORTH between sections 4 & 5,
 Var. 13°30' East.
 Interest boundary of "La Puente" Rancho at a point N. 24°50' E.
 14.00
 From station No. 14 of said Rancho.
 Set post in mound with trench and pits.
 WEST between sections 5 and 8,
 Variation 13°30' East.
 Interest boundary of Rancho "La Puente" N. 24° E. 17 chs. from
 Sta. No. 14 of said Rancho.
 5.50

FROM cor. to sections 28, 29, 32 and 33,
 I run
 WEST between sections 29 and 32,
 Variation 13°30' East.
 Set a rock 20 x 10 x 4 for § sec. cor.
 40.00
 Set a sandstone rock 12 x 10 x 11 for cor. to sections 29, 30, 31
 and 32, on N. side of Valley, 62 chains wide, course S. W. 22 chs.
 N. of post No. 5 of Rancho "Rincon de la Green".
 Land undulating, soil 2d rate.
 40.00

NORTH between sections 29 and 30, and on E. boundary of Rancho
 "Rincon de la Green",
 Variation 13°30' East.
 Set a rock 14 x 8 x 6 for § sec. cor.
 40.00
 Set granite rock, 20 x 10 x 6 for cor. to secs. 19, 20, 29 and 30.
 Land hilly, soil 2d rate.
 40.00

EAST on random between sections 20 and 29,
 Variation 13°30' East.
 Set a rock for temporary § section corner.
 Interest N. & S. line at cor. to sections 20, 21, 28 & 29, from
 which I run west on true line between secs. 20 & 29,
 Variation 13°30' E.
 40.00
 40.11

TOWNSHIP 2 SOUTH, RANGE 9 WEST, S.B. MERIDIAN

40.06 Set granite rock 14 x 8 x 6 for $\frac{1}{4}$ sec. cor. To cor. to sees. 19, 20, 29 and 30, Land level, soil 2nd rate.

40.00 NORTH between sections 19 & 20, Variation 13.30' East. Set a sandstone 20 x 4 x 3 for $\frac{1}{4}$ sec. cor. To station No. 16 of "La Fuente Rancho" Set post for cor. to sees. 17, 18, 19 and 20, in mound with trench and pits as per instructions. Land undulating, soil 2nd rate.

40.00 EAST on RANCHO, between sections 17 and 20, Variation 13.30' East. Set temporary $\frac{1}{4}$ section post. Cross road, course S. Intersect N. and S. line at cor. to sees. 16, 17, 20 and 21, from which I run, WEST on true line between sections 17 and 20, Variation 13.30' East. Set a granite rock, 16 x 10 x 4 for $\frac{1}{4}$ sec. cor. To cor. to sections 17, 18, 19 and 20, Land hilly, soil 2nd rate.

20.00 Leave hills and enter valley of San Jose, course W. Set $\frac{1}{4}$ sec. post in mound with trench and pits as per instructions. To a point 1 ch. W. of a new adobe house of O. Barrin, with a shingle roof. Across road, course West, leading from China to Los Angeles. Cross fence and enter field. Set post for cor. to sections 7, 8, 17 and 18, in mound with trench and pits as per instructions, from which an adobe house bears S. 25° W. distant about 16 chs. Land level, soil 1st rate.

40.20 EAST on random between sections 8 and 17, Variation 13.30' East. Leave fenced field. Set temporary $\frac{1}{4}$ sec. post. Enter low hills, course N. & S. Intersect N. and S. line 10 hrs. N. of cor. to sees. 8, 9, 16 and 17, from which I run, WEST on true line between sections 8 and 17, Set $\frac{1}{4}$ sec. post in mound with trench and pits as per instructions. Land level, soil 1st rate.

40.20 Set $\frac{1}{4}$ sec. post in mound with trench and pits as per instructions. To cor. to sees. 7, 8, 17 and 18, Land level, soil 1st rate.

of sections 1, for which, see field notes of same.

The S. boundary of the Rancho "San Jose" entering the N.E. portion boundary.

thence by the "La Puente" and "Los Regales" to the Northern sections 17, 18, 19 and 20, by the Rancho "Ninon de la Brea"; 32 and 33 lies public lands and from said point to corner to On the south to a point 50.60 chs. W. of corner to sections 4, 5, to $\frac{1}{2}$ sec. cor. on E. boundary of section 18.

and del Chino" from $\frac{1}{2}$ mile N.W. from the southern boundary up This fractional Twp. is bounded on the East by the Rancho "Santa

REMARKS

This fractional Township consists principally of undulating hills well adapted to grazing, the principal part of which has resulted from excess from the Rancho "Ninon de la Brea", and the remainder from that of the "Los Regales".

GENERAL DESCRIPTION.

NORTH between sections 7 and 8,
 Var. 13.30' East.
 across San Jose Creek, 50 lks. wide, water 6 lks. wide, course N.
 Set $\frac{1}{2}$ sec. post in mound with trench and pits as per instructions.
 To cor. of Rancho "La Puente" at Sta. No. 15 and set a sandstone
 rock 16 x 7 x 7 at point of intersection.

37.00
 40.00
 62.00

TOWNSHIP 8 SOUTH, RANGE 9 WEST, S.B.M.

EAST BOUNDARY TOWNSHIP 3 SOUTH, RANGE 9 WEST,
SAN BERNARDINO MERIDIAN.

FIELD NOTES of the Survey of the North and East boundary of T. 3 S. R. 9 W. of the San Bernardino Meridian in the State of California, executed by Henry Hancock, Deputy Surveyor, under his Contract dated March 17, 1859, and adopted by this office under instructions dated February 23, 1865.

BEGINNING at the previously established corner to Township 2 & 3 South, Range 8 & 9 West, and run South between Secs. 1 & 6, Variation 13°25' N.
 Set a Gray sandstone rock 30 x 12 x 4 for $\frac{1}{4}$ Sec. cor.
 Set a Gray sandstone rock 24 x 8 x 7 for cor. to Secs. 1, 6, 7 and 12. Land, very broken and mountainous.
 Soil 2nd rate.

SOUTH between Sections 7 & 12, Variation 13°25' N.
 Set a sandstone rock 16 x 7 x 6 for $\frac{1}{4}$ Sec. cor.
 Set a sandstone rock 20 x 14 x 7 for cor. to Secs. 7, 12, 13 & 18. Land mountainous, Soil 2nd rate, timber Oak, Sycamore and Walnut.

SOUTH between Sections 13 & 18, Variation 13°25' East.
 Set a Gray Granite rock 18 x 11 x 8 for $\frac{1}{4}$ Sec. cor.
 To a previously established post in irregular earth mound on the South bank of a deep canon, 2 chs. wide, at S. base of mountain ridge, course S. W.
 Land mountainous.
 Soil 2nd rate.

From post previously established on line of S. boundary between Sections 1 & 36, 30 chs. W. of cor. to Tps. 2 & 3, S. R. 8 & 9 W., counting from said Tp. cor., I run West on true S. boundary of Tp. & between Sections 1 & 36, Var. 13°25' N.
 Set a rock 20 x 12 x 6 for $\frac{1}{4}$ Section corner.
 Across a stream of water 10 lks. wide, course S. W.
 Set a post for cor. to sections 1, 2, 35 & 36, in mound with trench and pits as per instructions.
 Land mountainous and broken, covered mostly with sage brush.
 Soil 2nd rate.

WEST between Sections 2 & 35, Variation 13°25' East.
 Set a sandstone rock 16 in. long and 10 x 7 for $\frac{1}{4}$ Sec. cor.
 Set a Gray sandstone rock 16 x 14 x 5 for cor. to Secs. 2, 3, 34 & 35. Land mountainous, Soil 2nd rate.
 Sage underbrush.