

Copied from Photographic Copies
furnished by
U. S. General Land Office,
WASHINGTON, D. C.

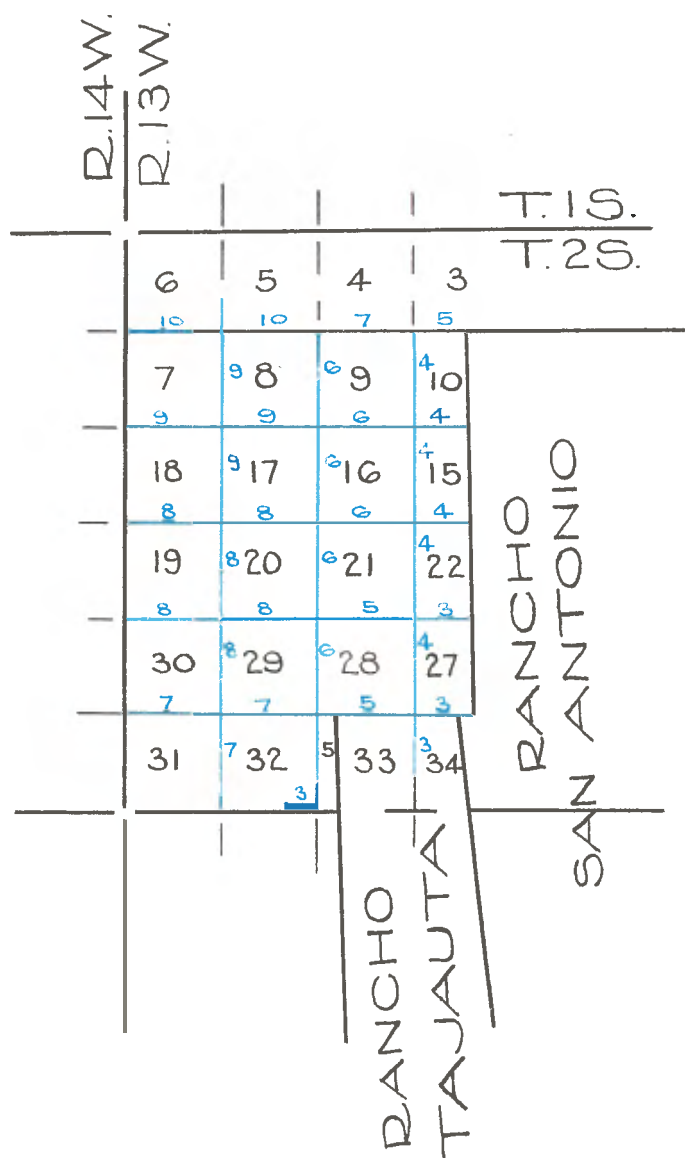

Blue lines run by George Hansen-1868

PRELIMINARY OATHS OF ASSISTANTS.

I, EBENEZAR HADLEY, do solemnly swear that I will well and truly perform the duties of Compassman, according to the instructions given me and to the best of my skill and ability.

EBENEZAR HADLEY.

SUBSCRIBED AND SWORN to before me this 14th day of February, A.D. 1868.

GEORGE HANSEN,
U.S. Deputy Surveyor.

I, CHARLES COLE, do solemnly swear that I will well and truly perform the duties of Axeman according to the instructions given me, and to the best of my skill and ability.

his
CHARLES X COLE,
mark.

WITNESS: M. KELLER.

SUBSCRIBED AND SWORN to before me this 14th day of February, A.D. 1868.

GEORGE HANSEN,
U.S. Deputy Surveyor.

PRELIMINARY OATHS OF ASSISTANTS.
(Continued)

We, AUGUST ASHRAM and GEORGE GUNNDEISEN, do solemnly swear that we will faithfully execute the duties of of Chain Carriers; that we will level the chain upon uneven ground and plumb the tally pins whether by sticking or dropping the same; that we will report the true distance to all notable objects and the true length of all lines that we may assist in measuring, to the best of our skill and ability.

AUGUST ASHRAM.
GEORGE GUNNDEISEN.

SUBSCRIBED AND SWORN to before me this 14th day of Febry,
1868.

GEORGE HANSEN,
U.S. Deputy Surveyor.

LIST OF NAMES.

A list of the names of the individuals employed to assist in running, measuring, and marking the lines and corners described in the foregoing Field-Notes of the Sub-division of Township

FIELD-NOTES
of the
SURVEY OF THE SUBDIVISION LINES IN
TOWNSHIP NO. 2 SOUTH, RANGE NO. 13 WEST, SAN BER-
NARDINO MERIDIAN,

as executed by GEORGE
HANSEN, U.S. Deputy S.
under his Contract of
February 7, 1868.

Survey commenced, February 19th, 1868.
Survey completed February 22nd, 1868.

The South East corner of this Township being located in the dry bed of Los Angeles River, could not be found, consequently the adjustment of the Compass was taken from the Variation of the Eastern boundary of Sec. 25, which was found to be, $14^{\circ} 15'$ East.

The eastern part of this Township being part of the Rancho San Antonio, I commence at _____ of Secs. 33 & 34 in the South boundary of this Township, and between the Rancho Tajanta and run,

NORTH between Secs. 33 & 34,
Var. $14^{\circ} 15'$ East.

80.00 Set post in mound run pits as per instructions for cor. to Secs. 27, 28, 33, 34 on North boundary of the Rancho Tajanta.

EAST On true line
Between Secs. 27 & 34,
Var. $14^{\circ} 15'$ E.

32.00 Set post, marked R.T. for N.E. cor. of Rancho Tajanta.

40.00 Set a $\frac{1}{4}$ Sec. post in mound with pits as per instructions on the West line of the Rancho San Antonio and go back W _____ of Secs. 27, 28, 33, 34.
Land level,
Soil 1st rate.

NORTH Between Secs. 27 & 28,
Var. $14^{\circ} 15'$ E.

40.00 Set $\frac{1}{4}$ Sec. post in mound with pits as per instructions.

80.00 Set post in mound with pits as per instructions for cor. to Secs. 21, 22, 27, 28, in the N.E. Cor. of a Cultivated field.

EAST On true line,
Between Secs. 22 & 27,
Var. $14^{\circ} 15'$ E.

0.20 Leave field.
13.50 Road to Los Angeles, bearing North.
22.50 Road to Los Angeles bearing North.

SUBDIVISION LINES
of
T. 2 S., R. 13 W., S. E. M.

40.00 Set $\frac{1}{4}$ Sec. post in mound with pits as per instructions on the West line of Ranch San Antonio.
Land level and sandy soil, 2nd rate.

NW Between Secs. 21 & 22,
Var. $14^{\circ} 15'$ E.
40.00 Set $\frac{1}{4}$ Sec. post in mound with pits as per instructions.
80.00 Set post in mound with pits as per instructions for cor. to Secs. 15, 16, 21, 22,
Land level and sandy, 2nd rate.

EAST on true line.
Between Secs. 15 & 22.
Var. $14^{\circ} 15'$ E.
17.00 Road to Los Angeles bearing NW and South.
40.00 Set $\frac{1}{4}$ Sec. post in mound with pits as per instructions,
I go back West of Secs. 15, 16, 21, 22,
Land level, soil 2nd rate.

NORTH Between Secs. 15 & 16,
Var. $14^{\circ} 15'$ East.
20.00 A small house bears S. 84° E. about 15 chs. distant.
40.00 Set $\frac{1}{4}$ Sec. post in mound with pits as per instructions from which
a small adobe house bears S. $88\frac{1}{2}^{\circ}$ E. 1.75 chs. distant.
This mound is situated in a young Vineyard about 2.50 chs. West
of main road to Los Angeles.
42.50 Leave Vineyard.
70.00 The house of Rubio bearing West 2.00 chs. distant.
80.00 Set post in mound with pits as per instructions for cor. to Secs. 9, 10, 15, 16,
Land level and mostly cultivated, soil 1st rate.

EAST on true line,
Between Secs. 10 & 15,
Var. $14^{\circ} 15'$ East.
0.30 Enter Mr. Howard's field, bearing N.W. and S.W.
24.50 Leave Howard's field, bearing N.W. and South.
40.00 Set $\frac{1}{4}$ Sec. post in mound and pits as per instructions, West
boundary of Rancho San Antonio. I go back to cor. of Secs. 9, 10,
15, 16.
Land and soil 1st rate.

NORTH Between Secs. 9 & 10,
Var. $14^{\circ} 15'$ East.
40.00 Set $\frac{1}{4}$ Sec. post in mound with pits as per instructions cor
of a cultivated field.
78.80 To the Scott Vineyard bearing East and West.
80.00 Set a post in mound with pits as per instructions for cor. to
Secs. 3, 4, 9, 10, from which run to the boundary line of the
City land, North 1.00 distant.
Land level, soil 1st rate.

SUBDIVISION LINES

of
T. 2 S., R. 13 W., S. B. M.

EAST On true line between 3 & 10,
Var. 14° 15' East.
32.00 Leave Scott's Vineyard bearing North and South.
40.00 Set a $\frac{1}{4}$ Sec. post in mound with pits as per instructions in W.
boundary of the Rancho San Antonio, from which bears an Adobe
house S. 85 E. I run North 1.00 ch. West of line and set post,
Land level, mostly under cultivation.
Soil 1st rate.

Feb. 20th, 1868.

20.00 WEST on Township line between Secs. 5 & 32,
Var. 14° 15' E.
20.00 Set a post marked R.I. in West Boundary line of Rancho Tajanta
NORTH between Secs. 32 & 33, in the Rancho Tajanta,
Var. 14° 15' E.
80.00 Set post in mound with pits as per instructions for cor. to
Secs. 28, 29, 32, 33, in North boundary line of Rancho Tajanta.

EAST on Random line between Secs. 28 & 33,
Var. 14° 15' E.
40.00 Set a temporary $\frac{1}{4}$ sec. post from which bears a small house
N. 10° E. about 10 chs. distant.,
80.00 To cor. to Secs. 27, 28, 33, 34, to North boundary line of Rancho
Tajanta, from which I run,
WEST On true line,
Var. 14° 15' E.
40.00 Set $\frac{1}{4}$ Sec. post in mound with pits as per instructions.
80.00 To cor. of Secs. 28, 29, 32, 33,
Land level, soil 1st rate.

NORTH Between Secs. 28 & 29,
Var. 14° 15' E.
5.00 Road running N. E.
40.00 Set $\frac{1}{4}$ Sec. post in mound with pits as per instructions.
50.50 Road bearing E. & W.
80.00 Set post in mound with pits as per instructions for cor. to Secs.
20, 21, 28, 29, from which bears a small lumber house S. 52 E.
about 10 chs. dist. Land level.
Soil 1st rate.

EAST On random line between Secs. 21 & 28,
Between Secs. 21 & 28,
Var. 14° 15' E.
40.00 Set a temporary $\frac{1}{4}$ sec. post.
56.00 Road bearing S. 15° W.
79.70 Intersect N.W. and South line 20 lks. N. of Cor.,
from which cor. I run,
N. 89° 51' W.
On true line
39.85 Set a $\frac{1}{4}$ Sec. post in mound with pits as per instructions.
79.70 Set post in mound with pits as per instructions, for cor. to

SUBDIVISION LINES
of
T. 2 S., R. 13 W., S. B. M.

Secs. 20, 21, 25, 29,
Land level, soil 1st rate.

NORTH Between Secs. 20 & 21,
Var. $14^{\circ} 15'$ East.
40.00 Set a $\frac{1}{4}$ Sec. post in mound with pits as per instructions.
80.00 Set a post in mound with pits as per instructions for cor. to
Secs. 16, 17, 20, 21.
Land level, soil 1st rate.

EAST On random line between Secs. 16 & 21,
Var. $14^{\circ} 15'$ E.
40.00 Set temporary $\frac{1}{4}$ Sec. post.
79.85 Intersect N. & S. line 40 lks. North to Cor. to Secs. 15, 16, 21, 22,
from which I run,
N. $89^{\circ} 43'$ W. on a true line bet. Secs. 16 & 21,
Var. $14^{\circ} 15'$ E.
29.93 Set $\frac{1}{4}$ sec. post in mound with pits as per instructions.
79.85 To cor. to Secs. 16, 17, 20, 21,
Land level, soil 1st rate.

NORTH Between Secs. 16 & 17,
Var. $14^{\circ} 15'$ E.
40.00 Set $\frac{1}{4}$ Sec. post in mound with pits as per instructions.
80.00 Set post in mound with pits as per instructions for cor. to Secs.
8, 9, 16, 17,
Land level, soil 1st rate.

EAST On a random line between Secs. 9 & 16,
Var. $14^{\circ} 15'$ E.
20.00 Pass a willow fence, enter Rubio's field bearing N. & S.
40.00 Set a temporary $\frac{1}{4}$ sec. post.
79.60 Intersect North and South line 60 lks. N. of Cor. to Secs. 9, 10, 15, 16,
from which I run,
N. $89^{\circ} 34'$ W. on a true line bet. Secs. 9 & 16,
Var. $14^{\circ} 15'$ E.
39.80 Set $\frac{1}{4}$ Sec. post in mound with pits as per instructions.
79.60 To cor. to Secs. 8, 9, 16, 17,
Land level, soil 1st rate.

NORTH Between Secs. 8 & 9,
Var. $14^{\circ} 15'$ E.
40.00 Set a $\frac{1}{4}$ sec. post in mound with pits as per instructions.
80.00 Set post in mound with pits as per instructions for cor. to Secs.
4, 5, 8, 9,
The house of Figarrea bears N.E. about 5.00 chs. dist.
Land level, all under cultivation, soil 1st rate.

SUBDIVISION LINES

of
T. 2 S., R. 13 W., S. B. M.

EAST On a random line between Secs. 4 & 9,
Var. 14° 15' E.
1.00 Figaroas Vineyard and orchard bearing N. & S.
40.00 Set a temporary $\frac{1}{4}$ sec. post.
78.00 Road to Los Angeles bearing N. & S.
79.40 Intersect N. & S. line 38 lks. N. of Cor. to Secs. 3, 4, 9, 10,
from which I run, N. 89° 44' W. on a true line bet. Secs. 4 & 9,
39.70 Set a $\frac{1}{4}$ Sec. cor. with mound and pits as per instructions.
79.40 To Cor. to Secs. 4, 5, 8, 9, from which to S. line of City land I
run N. 1.00 chs. separate.
Land level, soil 1st rate.

NORTH Between Secs. 31 & 32,
Var. 14° 15' E.
14.00 Enter Aguire's field bearing N. & S.
40.00 Set $\frac{1}{4}$ Sec. post in mound with pits as per instructions from which
bears the house of Aguire's, S. 80° E. about 20.00 chs. dist.,
60.50 Enter field of Nelson, bearing N. & S.
80.00 Set post in mound with pits as per instructions for cor. to Secs.
29, 30, 31, 32, from which bears barn of Nelson, S. 0.50 chs. dist. and
his house bears N. 45 E. about 5 chs. dist.
Land level, soil 1st rate.

EAST On random line, between 29 & 32,
Var. 14° 15' E.
0.12 Enter Nelson's field bearing N. & S.
30.50 Leave field bearing N. & S.
32.50 Road running N. & S.
40.00 Set temporary $\frac{1}{4}$ sec. post
44.00 Road running N. & S.
80.00 Intersect N. and S. line at cor. to Secs. 28, 29, 32, 33, from which
Cor. I run West on true line.
20.00 Set a post marked R.T. for N.W. Cor. of Rancho Tajanta.
40.00 Set $\frac{1}{4}$ Sec. post in mound with pits
and as per instructions.
80.00 To Cor. to Secs. 29, 30, 31, 32, land level, soil 1st rate.

WEST On random line between Secs. 30 & 31,
Var. 14° 15' E.
40.00 Set temporary $\frac{1}{4}$ sec. post
63.00 Road to Los Angeles running N. & S.
80.81 Intersect West boundary of this township at Cor. to Secs. 25, 30,
31, 36, from which cor. I run East on true line.
40.81 Set $\frac{1}{4}$ Sec. cor. in mound with pits as per instructions.
80.81 To cor. to Secs. 29, 30, 31, 32,
Land level, soil 1st rate.

NORTH Between Secs. 29 & 30,
Var. 14; 15' East.
25.00 Bears house of A. Fogel, West, about 6 chs. dist.
40.00 Set $\frac{1}{4}$ Sec. post in mound with pits as per instructions.
50.00 Bears a house S. 75° W. about 15 chs. dist.
70.00 To house of Franchis Coll.
80.00 Set post in mound with pits as per instructions.

SUBDIVISION LINES
of
T. 2 S., R. 13 W., S. B. M.

for cor. to Secs. 19, 20, 29, 30,
Land level, soil some alkali.
South half 1st rate.
North half 2nd rate.

EAST on Random line between Secs. 20, & 29,
Var. 14° 15' E.
40.00 Set a temporary $\frac{1}{4}$ Sec. post
80.00 Intersect N. and S. line at cor. of Secs. 20, 21, 28, 29,
from which cor. I run,

WEST on true line between Secs. 20 & 29,
Var. 14° 15' East.
40.00 Set $\frac{1}{4}$ Sec. post in mound with pits as per instructions.
80.00 To cor. to secs. 19, 20, 29, 30,
Land level, soil 1st rate.

WEST on Random line between Secs 19 & 30,
Var. 14° 15' E.
25.00 San Pedro Road running N. & S.
40.00 Set a temporary $\frac{1}{4}$ Sec. post
80.35 Intersect West boundary of Township 28 lks.
to Secs. 19, 24, 25, 30, from which cor. I run N. 89° 48' E.
on true line

40.35 Set $\frac{1}{4}$ Sec. post in mound with pits as per instructions.
80.35 To cor. of Secs. 19, 20, 29, 30,
Land level, soil 1st rate.

NORTH Bet. Secs. 19 & 20,
Var. 14° 15' East.
40.00 Set $\frac{1}{4}$ Sec. post in mound with pits as per instructions.
80.00 Set a post in mound with pits as per instructions for cor. to
Secs. 17, 18, 19, 20,
Land level, soil 1st rate.

EAST on random line between Secs. 17 & 20,
Var. 14° 15' E.
23.50 Road running N. & S.
35.00 Road running N. & S.
40.00 Set a temporary $\frac{1}{4}$ Sec. post.
80.00 Intersect N. & S. line at Cor. to Secs. 17, 16, 20 & 21, from which
cor. I run West on true line,
40.00 Set $\frac{1}{4}$ Sec. post in mound with pits as per instructions.
80.00 To cor. to Secs. 17, 18, 19, 20,
Land level, soil 1st rate.

WEST On random line between Secs. 18 & 19,
Var. 14° 15' E.
15.00 Road running N. & S.
35.00 Road running N. & S.
40.00 Set a temporary $\frac{1}{4}$ Sec. post.

SUBDIVISION LINES
of
T. 2 S., R. 13 W., S. B. M.

80.40 Intersect West boundary of Township 20 lks. North of cor. to
Secs. 13, 18, 19, 24, from which cor. I run N. 89° 51' E. on true
line bet. Secs. 18 & 19,
40.40 Set $\frac{1}{4}$ Sec. post in mound with pits as per instructions.
80.40 To cor. to Secs. 17, 18, 19, 20,
Land level, soil 1st rate.

NORTH Between Secs. 17 & 18,
Var. 14° 15' East.
29.00 Road running N. 5° E.
40.00 Set $\frac{1}{4}$ Sec. post in mound with pits as per instructions.
77.00 Enter field bearing E. & W.
80.00 Set post in mound with pits as per instructions for cor. to
Secs. 7, 8, 17, 18,
Land level, soil 1st rate.

EAST on Random line between Secs. 8 & 17,
Var. 14° 15' E.
40.00 Set a temporary $\frac{1}{4}$ Sec. post
47.50 Road running N. & S.
65.00 Road running N. & S.
80.20 Intersect N. & S. line 30 lks. N. of corner to Secs. 8, 9, 16, 17,
from which cor. I run N. 89° 47' W. on true line,
40.10 Set a $\frac{1}{4}$ Sec. post in mound with pits as per instructions.
80.20 To cor. to Secs. 7, 8, 17, 18,
Land level,
Soil 1st rate.

WEST On random line bet. Secs. 7 & 18,
Var. 14° 15' E.
12.00 Road running N. & S.
40.00 Set a temporary $\frac{1}{4}$ sec. post
80.50 Intersect West boundary of Township at cor. to Secs. 7, 12, 13, 14,
from which Cor. I run East, on true line.
40.50 Set $\frac{1}{4}$ Sec. post in mound with pits as per instructions.
80.50 To cor. to Secs. 7, 8, 17, 18, land level, soil 1st rate.

NORTH Between Secs. 7 & 8,
Var. 14° 15' E.
22.50 Pass a ditch, from which bears an adobe house S. 63° W. about 15.00
chs. dist.
40.00 Set $\frac{1}{4}$ Sec. post in mound with pits as per instructions.
70.50 Road running N. 28° E.
80.00 Set a post in mound with pits as per instructions for Cor. to Secs.
5, 6, 7, 8, from which bears the house of Henry, N. 46° W. about 15.00
chs. dist. and I run North 1.00 ch. and set stake in S. boundary of
Los Angeles Pueblo land.
Land level, soil 1st rate, all under cultivation.

SUBDIVISION LINES
of
T. 2 S., R. 13 W., S. B. M.

EAST On Random line bet. Secs. 5 & 8,
Var. $14^{\circ}15'$ E.

5.00 Road running N. & S.
27.00 Enter field of Wilson, bearing N. & S.
40.00 Set a temporary $\frac{1}{4}$ Sec. post
45.00 Middle road running N. & S.
46.00 Enter field of Andrew bearing N. & S.
80.00 Intersect N. & S. line at Cor. to Secs. 4, 5, 8, 9,
from which Cor. I run,
West on true line

40.00 Set $\frac{1}{4}$ Sec. post in mound with pits as per instructions.
80.00 To cor. to secs. 5, 6, 7, 8,
Land level, soil 1st rate.

WEST On Random line between Secs. 6 & 7,
Var. $14^{\circ}15'$ E.

40.00 Set a temporary $\frac{1}{4}$ Sec. post
80.30 Intersect West boundary of Township at Corner to Secs. 1, 6, 7, 12,
from which cor. I run East on true line
Bet. Secs. 6 & 7,
Var. $14^{\circ}15'$ E.

34.70 Offset North 1.00 ch. set a post in S.W. Cor. of the Pueblo land
of Los Angeles City.

40.30 Set $\frac{1}{4}$ Sec. post in mound with pits as per instructions.
80.30 To Cor. to Secs. 5, 6, 7, 8,
Land level, soil 1st rate.
Feb. 22nd, 1868.

GENERAL DESCRIPTION.

The quality of the land in this Township is nearly all 1st rate. It consists mostly of a rich sandy loam, a portion of which is moist enough to produce corn without irrigation, the balance is supposed to produce a summer crop with deep cultivation, and is superior land for small grain, potatoes, and other winter crops.

A large portion of it is under cultivation and the northern part adjoining the Pueblo land of Los Angeles is irrigated by the water from the Irrigation Water Works of said city. The public land in the Township in a body presents the appearance of a level plain, but it slopes gently towards the South at the rate of 14 ft. per mile, a proper inclination for a cheap and efficient system of irrigation.

FINAL OATH OF DEPUTY SURVEYOR.

I, GEORGE HANSEN, U.S. Deputy Surveyor, do solemnly swear that in pursuance with a Contract with L. Upm, U.S. Surveyor-General, for California, bearing date the day of I have well, faithfully, and truly, in my own proper person and in strict enforcement with the instructions furnished by the Surveyor-General, the surveying Manual, and the laws of the United States Surveyor authorized parts or portions of the Subdivision Lines of Townships Two South, Range Thirteen West of the San Bernardino Base and Meridian,

SUBDIVISION LINES
of
T. 2 S., R. 13 W., S. B. M.

as are represented in the foregoing Field Notes as having been surveyed under my directions, and I do further solemnly swear that all the Corners of said Surveys have been established and perpetuated in strict accordance with the Surveying Manual and printed instructions and that the foregoing are true and original Field Notes of Survey.

GEORGE HANSEN.
U.S. Deputy Surveyor.

SUBSCRIBED AND SWORN to before me this 28th day of February, 1868.

JAMES H. LANDES,
Notary Public
Los