

Copied from Photographic Copies
 furnished by
 U.S. General Land Office,
 WASHINGTON, D. C.

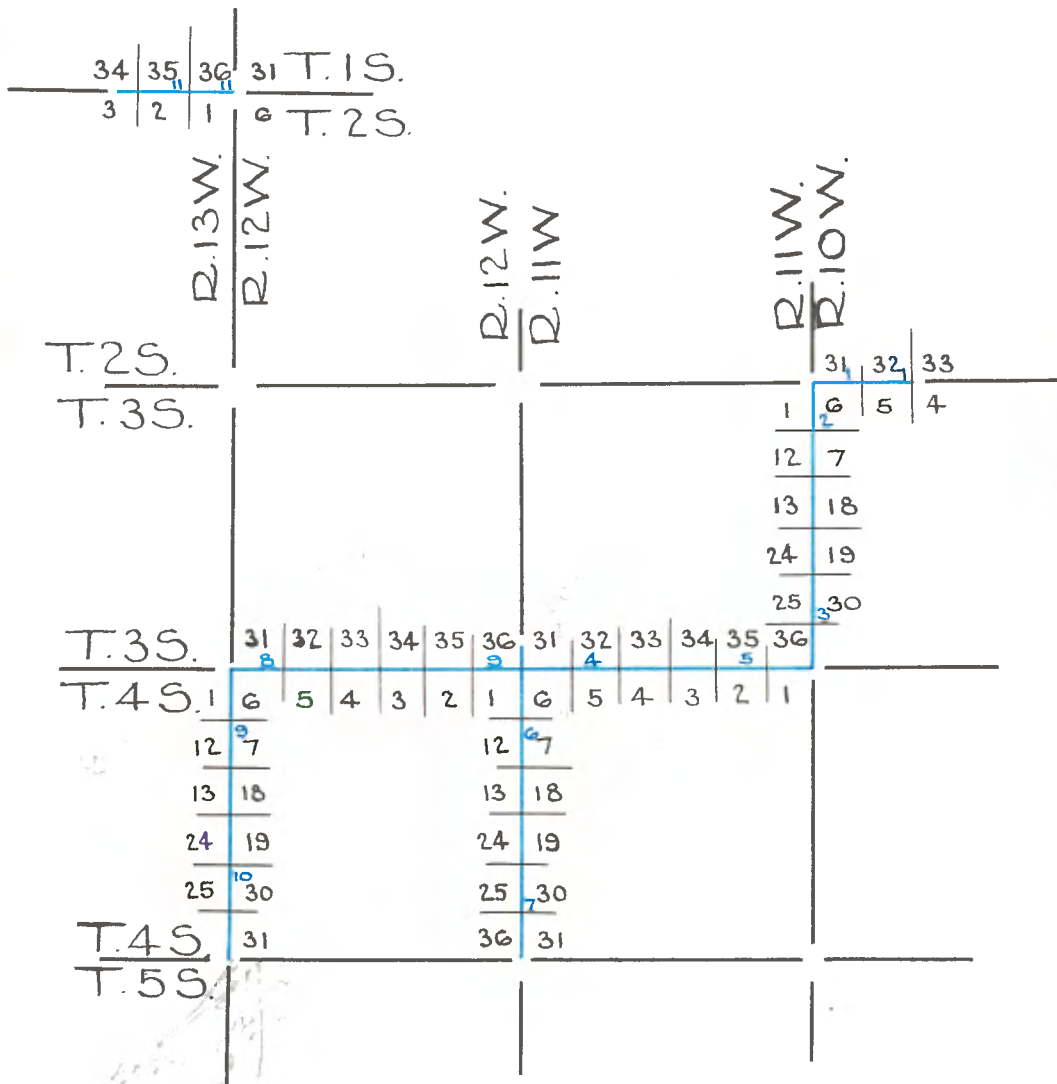

Blue, H. Hancock ~ 1853

TOWNSHIP 3 S., RANGE 10 W., S. B. M.

WEST BOUNDARY, VARIATION 13°30'E.

SOUTH ON WEST BOUNDARY OF SEC. 6.
 40.00 Set $\frac{1}{4}$ Sec. post and charred stake in mound d 10
 44.00 Across Road, S. 60° E.
 80.00 Set Sec. post and charred stake in mound, corner of Secs. 6 & 7,
 1st $\frac{1}{2}$ mile 2nd rate. Soil last $\frac{1}{2}$ first rate, ^{with} clover and mustard.

ON WEST BOUNDARY OF SEC. 7.
 10.00 Leave mustard.
 25.00 Head of Ravine, S. 18° W.
 40.00 Set $\frac{1}{4}$ Sec. post and charred stake in mound.
 46.00 Ravine, taking W.
 65.00 Across flat ravine.
 78.50 Top of hill a 100
 80.00 Set Sec. post and charred stake in mound d 12
 cor. of Secs. 7 & 18, Broken prairie.
 2nd rate, soil and good pasturage.

ON WEST BOUNDARY OF SEC. 18.
 9.00 Ravine d 40
 20.00 To castrice
 25.00 Over same and to bottom ranging N.E. and S.W.
 36.26 To gulch, 8 ft. deep and 50 lks. over with a few stagnant
 pools of water, course S. 47° W.
 40.00 Set $\frac{1}{4}$ Sec. post and charred stake in mound on S. side of road,
 course S. 50° W.
 44.00 Base of isolated hills.
 50.00 Top of hill a 100
 58.50 Ravine, course N.W. d 70
 74.50 Top of hill and enter sage a 200
 80.00 Set Sec. post and charred stake in mound on W. face of hill,
 corner of Secs. 18 & 19,
 Broken and hilly, 2nd rate soil.
 From this corner the houses on Rancho Los Coyotes bear as
 follows, S. 70° W. Do. S. 30° E. and S. 34° E.

ON WEST BOUNDARY OF SEC. 19.
 0353 Offset for insuperable gulch 100 ft. deep.
 EAST
 2.00 To 2nd offset Station, thence,
 SOUTH ON WEST BOUNDARY OF SEC. 19, ON OFFSET LINE.
 4.17 Ravine, d 30
 7.42 To 3rd offset Station,
 thence,

WEST
 2.00 To 4th offset Station and line
 thence, a 30

SOUTH
 6.75 Broad ravine d 60
 16.75 Ridge a 40
 30.75 To head of gulch and leave sage d 40
 31.75 Set $\frac{1}{4}$ Sec. post and charred stake in witness mound, 23 lks. W.
 of true corner, on account of gulch.

TOWNSHIP 3 S., RANGE 10 W., S. B. M.

SAN BERNARDINO MERIDIAN.

38.25 Across gully
51.75 Centre of long flat ravine, course S.50° W.
56.25 South bank of same.
59.25 Trail, course N.E.
68.75 Trail, course S.50° W.
71.75 Set Sec. post and charred stake in mound, corner of Secs. 19 & 30.
Broken and hilly. First $\frac{1}{2}$ mile 3rd rate soil, last $\frac{1}{2}$ do. 2nd rate.

d 15

ON WEST BOUNDARY OF SEC. 30.
15.00 Long and broad Ravine, S.40° W.
22.50 Ravine at right angles.
40.00 Set $\frac{1}{4}$ Sec. post and charred stake in mound, from which bears a Ranch house S.70° W. and a Ranchita S.8° E.
53.50 Over road and to swamp at base of hills
Course S.85° W.
56.00 Over swamp and enter mustard.
69.00 Narrow belt of salt weed.
70.50 Through mustard.
80.00 Set Sec. post and charred stake in mound, corner of Secs. 30 & 31, from which bears Ranchita S.23 $\frac{1}{2}$ ° E. House N.61 $\frac{1}{2}$ ° W. Do. N.73 $\frac{1}{2}$ ° E. Do. N. 84° E.

d 60

SOUTH ON WEST BOUNDARY OF SEC. 31.
5.50 To cultivated field.
17.00 To sanja on S. side of cultivated land
28.50 Across sanja 20 lks. wide, 8 in. deep (and natural) course S.87° W.
40.00 Set $\frac{1}{4}$ Sec. post and charred stake in mound on S. of mustard
80.00 Set township corner post and charred stake in mound, cor of Townships 3 and 4 S., Ranges 10 and 11 West.

TOWNSHIP 3 S., RANGE 11 W. SAN BERNARDINO MERIDIAN.

SOUTH
 45.00 To mustard.
 65.00 Leave mustard.
 80.00 Set township post and 2 charred stakes in mound, cor. of Townships 3 and 4 S., Ranges 11 and 12 West. Soil 1st $\frac{1}{2}$ mile 3rd rate and sandy; last $\frac{1}{2}$ mile 1st and 3rd rate.

SOUTH BOUNDARY

EAST ON RANDOM LINE ON THE SOUTH BOUNDARIES OF SECS. 31, 32, 33, 34, 35, & 36, Setting temporary mile and $\frac{1}{2}$ mile posts and intersect Eastern boundary 266 lks. North, 6 miles 4 chs. and 30 lks. Therefore the correction will be 430 lks. West and 44.3 lks South per mile.

NOTE: Here it seems that by some unaccountable means the divergency of both Ranges 10 & 11 are thrown together, it must however, be attributed to the courses either by attraction or by some trivial error in the variation.

TRUE SOUTH BOUNDARY

WEST ON SOUTH BOUNDARY OF SEC. 36.
 1.00 Cross road, course N.W.
 40.00 Set $\frac{1}{4}$ Sec. post and charred stake in mound
 80.00 Set Sec. post and charred stake in mound, corner of Secs. 35 36
 from which a tree on S. bears S. 44° W. and house of Senor 2 1
 Ocampo, one of the claimants of "Los Coyotes" Rancho
 N. 13° E. other houses of same Rancho, N. 3° E. and N. 17 $\frac{1}{2}$ °
 W.
 Soil 3rd rate, being on a sandy ridge some 40 chs. wide,
 ranging E. & W.

ON SOUTH BOUNDARY OF SEC. 35.

40.00 Set $\frac{1}{4}$ Sec. post and charred stake in mound,
 43.00 Leave sand and enter mustard.
 56.30 Dry slough, course S.E.
 59.30 Across same.
 80.00 Set Sec. post and charred stake in mound, corner of Secs. 34 35
 Soil 1st $\frac{1}{2}$ mile, 3rd rate; 2nd $\frac{1}{2}$ mile 2nd rate 3 2
 prairie. Oct. 9th.

ON SOUTH BOUNDARY OF SEC. 34.

8.30 Leave mustard.
 40.00 Set $\frac{1}{4}$ Sec. post and charred stake in mound from which bears the
 tree before taken, S. 71° E.
 House of Ocampo N. 53 $\frac{1}{2}$ ° E. Timber of "Los Coyotes"
 N. 30 $\frac{1}{2}$ ° E. a house N. 32 $\frac{1}{2}$ ° E. Bushes at head of the creek of Los
 Coyotes, N. 9° E. Trees N. 17 $\frac{1}{2}$ ° W.
 53.30 Enter sand.
 65.30 Road, N. 10° W. and leave naked sand.
 80.00 Set Sec. post and charred stake in mound, cor. of Secs. 33 34
 Soil 3rd rate level prairie. 4 3

ON SOUTH BOUNDARY OF SEC. 33.

40.00 Set $\frac{1}{4}$ Sec. post and charred stake in mound.
 62.30 East bank of Coyote Creek, course S. 41° W. bank 15 ft. high. Water
 60 lks. wide and 6 in. deep, current sluggish, say 1 mile per hour.
 80.00 Set Sec. post and charred stake in mound, corner of

TOWNSHIP 4 S., RANGE 11 W., S. B. M.

WEST BOUNDARY, VARIATION 13°22'

SOUTH FROM CORNER OF TOWNSHIPS 3 & 4, S., RANGES 11 & 12 W. run due South on trial line on W. boundaries of Secs. 6, 7, 18, 19, 30 & 36, and intersect the 1st Standard S. at 20.13 chs. West of the Standard corner of Ranges 11 and 12 W. and at the said point of intersection.

Set Township C.C. post and charred stake in mound according to General Instructions. Thence following on & retracing the West boundary by aid of temporary posts previously set.

NORTH ON WEST BOUNDARY OF SEC. 31.
40.00 Set $\frac{1}{4}$ Sec. post and charred stake in mound.
45.00 Across dry slough $\frac{1}{4}$ feet deep, S.E.
80.00 Set Sec. post and charred stake in mound, cor. of Secs. 30 & 31, Soil apparently 1st rate with salt grass.

ON WEST BOUNDARY OF SEC. 30.
40.00 Set $\frac{1}{4}$ Sec. post and charred stake in mound.
80.00 Set Sec. post and charred stake in mound, cor. of Secs. 19 & 30. Soil same as last mile.

ON WEST BOUNDARY OF SEC. 19.
13.90 To South bank of Cayota Creek.
14.50 To North bank of Cayota Creek 20 lks. over water, current 2 miles per hour and course S. 56° W. banks 5 ft. high.
32.50 To Cienega.
35.00 Across same.
40.00 Set Sec. post and charred stake in mound.
80.00 Set Sec. post and charred stake in mound, cor. of Secs. 18 & 19, Soil apparently same as last mile, grass poor.

ON WEST BOUNDARY OF SEC. 18.
40.00 Set Sec. post and charred stake in mound.
68.00 To bank of sand
80.00 Set Sec. post and charred stake in mound, base 6 ft. cor. of Secs. 7 and 18. Soil of last $\frac{1}{2}$ mile, 2nd rate.

NORTH ON WEST BOUNDARY OF SEC. 7.
20.00 Enter thin clover.
40.00 Set $\frac{1}{4}$ Sec. post and charred stake in mound.
70.00 Enter mustard and first rate soil.
80.00 Set Sec. post and charred stake in mound, cor. of Secs. 6 & 7, First $\frac{1}{2}$ mile sandy, last 1st and 2nd rate soil.

ON WEST BOUNDARY OF SEC. 6.
30.00 Leave mustard.
37.50 Leave thin clover for belt of yellow weed.
40.00 Set $\frac{1}{4}$ Sec. post and charred stake in mound.
62.50 Leave yellow blossomed weed.
68.33 To corner of Townships 3 & 4 S., Ranges 11 & 12 West.

TOWNSHIP 1 S., RANGE 12 W.

WEST BOUNDARY

Var.(of record) 13° 35"

SOUTH	ON WEST BOUNDARY OF SEC.6.	
4.75	Small sanja, course S.W.	d 10
6.00	Across road, course W.	
12.50	Across gulch, course W.	a 6
25.50	Top of hill	a 80
33.50	Base of hill	d 60
37.00	Road S.50° W.	
40.00	Drove $\frac{1}{4}$ Sec.post and charred stake from which bears a Black Oak	
	22 in.dia. S.25° W.1005 lks.dist.	Do Do
	S.17° E. 441 lks.dist.	
60.00	Bluff of arroyo.	
65.50	1st bottom.	
67.00	Across a small sanja, irrigating a small field below.	
70.00	Dry arroyo.	
80.00	Drove Sec.post and charred stake from which bears an Alder 7	
	in dia. N. 17° W. 134 lks.dist.	
		Do 6
	in.dia. bears N. 6° E. 195 lks.dist.	
	A Sycamore 13 in.dia. S.17 $\frac{1}{2}$ ° W. 61 lks.dist.	
	Do Do 5 in.dia. S.85° E.197 lks.dist.	
	Soil of first $\frac{1}{2}$ mile, 2nd rate, broken prairie; last	
	$\frac{1}{2}$ mile rocky bed of arroyo with willow and sycamore.	

:

:

:

:

:

:

TOWNSHIPS 3 & 4 S., RANGE 12 W. SAN BERNARDINO MERIDIAN.

SOUTH BOUNDARY
Variation 13° 22'

EAST ON RANDOM LINE ON SOUTH BOUNDARIES OF SECS. 31, 32, 33, 34, 35, & 36.
Setting temporary mile and half mile posts and intersect the 11th
Range line 235 lks. South of the true S.E. corner of Township, 6
miles, 231 lks,
Therefore, the correction will be 231 lks. West. and 39.1
lks. N. per mile.

TRUE SOUTH BOUNDARY

WEST ON SOUTH BOUNDARY OF SEC. 36.
40.00 Set $\frac{1}{4}$ Sec. post and charred stake in mound.
40.70 Across road, course N.
73.86 To natural sanja (now dry at this point).
80.00 Set Sec. post and charred stake in mound, corner of Secs. $\frac{35}{2} \frac{36}{1}$
from which bear certain Sycamores as follows:
N. 2° E. N. $1\frac{3}{4}$ ° W. - N. $13\frac{1}{2}$ ° W. - N. $32\frac{1}{4}$ ° W. - and N. $57\frac{3}{4}$ ° W.
Soil of 1st half mile 2nd rate,
of last 1st rate with mustard.

ON SOUTH BOUNDARY OF SEC. 35.
40.00 Set $\frac{1}{4}$ Sec. post and charred stake in mound.
80.00 Set Sec. post and charred stake in mound, cor of Secs. $\frac{34}{3} \frac{35}{2}$
from which bears trees noted at last corner,
N. $32\frac{1}{2}$ ° E.
N. $21\frac{1}{3}$ ° E.
N. 4° E.
S. $24\frac{1}{2}$ ° E. and trees at spring S. $12\frac{1}{2}$ ° E.
Oct. 17th.

ON SOUTH BOUNDARY OF SEC 34.
11.94 To East bank of natural sanja, at this time and at this point
dry, but water seen in Coyote holes within 9 inches of surface.
13.08 To West bank of same, 4 ft. high.
The East bank of this Sanja is said to be the boundary line
between the "Rancho Los Cerritos" and Los Alamitos at this point.
40.00 Set $\frac{1}{4}$ Sec. post and charred stake in mound.
80.00 Set Sec. post and charred stake in mound, corner of Secs. $\frac{33}{4} \frac{34}{3}$
Soil 1st rate with mustard and Lucerne.

ON SOUTH BOUNDARY OF SEC. 33.
40.00 Set $\frac{1}{4}$ Sec. post and charred stake in mound
80.00 Set Sec. post and charred stake in mound, corner of Secs.
 $\frac{32}{5} \frac{33}{4}$. Leave mustard and enter a yellow blossomed prickly weed.
Soil as last mile.

ON SOUTH BOUNDARY OF SEC. 32.
40.00 Set $\frac{1}{4}$ Sec. post and charred stake in mound in centre of a belt
of salt grass 5 chs. wide, course N. & S.
80.00 Set Sec. post and charred stake in mound, corner of Secs. $\frac{31}{6} \frac{32}{5}$
Soil apparently 1st rate.
Last half mile has an alkaline appearance.

TOWNSHIPS 3 & 4 S., RANGE 12 W., SAN BERNARDINO MERIDIAN.
ON SOUTH BOUNDARY OF SEC. 31.

40.00 Set $\frac{1}{4}$ Sec. post and charred stake in mound
82.31 To corner of Townships 3 & 4 South, Ranges 12 & 13 West.

SOUTH Township 4 S., Range 12 W. West Boundary.
Adopting Variation $13^{\circ} 22'$ E.
It being too foggy to ascertain it by observation from Township corner of Townships 3 & 4 South, Ranges 12 & 13 W. setting temporary mile and $\frac{1}{2}$ mile posts on line, on West boundaries of Secs. 6, 7, 18, 19, 30 and 31, and intersect the 1st Standard South 20.23 chs. West of Standard corner of Ranges 12 & 13 West at which intersection set C.C. Township post and charred stake in mound cor. of Secs. 36 and 31.

NORTH and at, (W. boundary of Sec. 31)
40.00 Set $\frac{1}{4}$ Sec. post and charred stake in mound from which a pass of El Serrito, through which a line of Rancho Los Cerritos is said to run, bears $N. 40^{\circ} E.$
43.00 Across road, course N.W.
74.00 Stock trails N.E.
80.00 Set Sec. post and charred stake in mound, corner of Secs. 30 & 31, from which bears the pass last noted $N. 53^{\circ} \frac{1}{2}' E.$ and lower point of timber of Rio San Gabriel $S. 89^{\circ} \frac{1}{2}' W.$ Upper
Do N. $28^{\circ} \frac{1}{4}' W.$

ON WEST BOUNDARY OF SEC. 30.
40.00 Set $\frac{1}{4}$ Sec. post and charred stake in mound
80.00 Set Sec. post and charred stake in mound, corner of Secs. 19 & 30, Soil 2nd rate prairie.
Oct. 18th,

ON WEST BOUNDARY OF SEC. 19.
18.00 To offset Station, from which the distance to the water of Tulare Lake is 3 chs. North, thence,
EAST To around Tulare Lake.
6.00 To 2nd offset station,
Thence,
NORTH To 3rd offset station,
7.00 Thence,
WEST To small stream 15 lks. wide, shallow and sluggish. d 20
1.12 To line, from which point we measure a 30
6.00 South over prickly pear patch, 160 lks. to lake,
Thence,
NORTH On West boundary again.
15.00 Set $\frac{1}{4}$ Sec. post and charred stake in mound
28.50 To base of Ridge.
35.00 Top of W. slope of Ridge. a 40
40.50 Ravine d 20
55.00 Set Sec. post and charred stake in mound, cor. of Secs. 18 & 19 from which bears the South point of timber on or near the Rio San Gabriel, $S. 17^{\circ} \frac{1}{2}' W.$ and N. base of Serrito observed from S.P. $S. 53^{\circ} E.$
Soil 2nd rate prairie or table land and like - last $\frac{1}{2}$ mile covered with clover burrs.

TOWNSHIP 4 S., RANGE 12 W., SAN BERNARDINO
MERIDIAN.

NORTH ON WEST BOUNDARY OF SEC. 18.
 40.00 Set ¼ Sec. post and charred stake in mound from which a Sycamore
 tree bears S. 70½° E.
 Do. Do. S. 72° 16' E. the last West base of Serrito, S. 42½° E.
 70.00 Across road, N.E.
 80.00 Set Sec. post and charred stake in mound, cor. of Secs. 7 & 18,
 Soil 1st rate prairie.
 Vegetation, clover and mustard.



40.00 ON WEST BOUNDARY OF SEC. 7.
 Set ¼ Sec. post and charred stake in mound from which bears the
 Ranch house of Senor Don Juan Temple of the Rancho Los Cerritos
 S. 88 ¾° W. N.E. corner of a field N. 41½° W. and another N. 38½° W.
 59.00 To water of Cienega
 60.50 Across water of same.
 80.00 Set Sec. post and charred stake in mound, cor. of Secs. 6 & 7,
 from which house last taken bears S. 44° W. and corner of field
 S. 45° W. and S. 70½° W. Soil same as last mile.

d 30



20.00 ON WEST BOUNDARY OF SEC. 6.
 Slough, course N.E.
 40.00 Set ¼ Sec. post and charred stake in mound
 65.39 To corner of Townships 3 & 4 S., Ranges 12 & 13 W.
 Oct. 19th.



:
:
:
:
:
:
:
:
:

TOWNSHIP 1 S., RANGE 13 W., S.B.M.

SOUTH BOUNDARY

Variation 13° 43' East.

RECORD V.

EAST

The West boundary having been run by Col. Washington and adopting his Variation, it being that of record and 13° 43' E. ON RANDOM LINE ON SOUTH BOUNDARIES OF SECS. 31, 32, 33, 34, 35, & 36, Setting mile and ½ mile posts and intersect E. boundary 73 lks. North of true corner 5 miles 79 chs and 23 lks.

Therefore, the correction will be 77 lks. West and 12.1 S. per mile.

TRUE SOUTH BOUNDARY

WEST
33.73
40.00
48.23
63.23
80.00

ON SOUTH BOUNDARY OF SEC. 36.
Road to Los Angeles, N.W.
Set ¼ Sec. post and charred stake in mound
Ravine, course S.W.
Ravine, course S.
Set Sec. post and charred stake in mound corner of Secs. 35 36
Broken prairie, 2nd rate soil.

d 60
d 30

29.33
34.23
37.73
40.00
42.00
56.23
62.23
71.00
80.00

ON SOUTH BOUNDARY OF SEC. 35.
Leave table land
Ravine, course N.
Bluff of ravine
Set ¼ Sec. post and charred stake in mound
Dry Arroyo and centre of Ravine, course S.W.
Point of Ridge.
Ravine, South
Trail, course N.W.
Set Sec. post and charred stake in mound, corner of Secs. 34 35
from which bears certain houses on bluff of the
bottom of Rio Los Angeles
N. 5° E.
N. 4½° W. cluster Do do
N. 10° W.
The S.W. corner of a vineyard on bottom and on E. side of river N.
19° W. The pass in the hills of the Rio Los Angeles N. 5° W.
and a high hill North of Pueblo, N. 20½° W. Foot hill
N 34° W. Same as last mile.

d 30
a 20
d 60
d 20
a 80
d 60
a 40

ON SOUTH BOUNDARY OF SEC. 34.

3.23
4.00
4.70
6.23
7.73

16.73
20.23
26.23

27.01

Gulch, course N.W.
House of Francisco Ruis
Over same.
To stream of water or sanja.
Across same, 5 in. deep, course S. 28° W. current, 3 miles per hour.
To sandy bed of Rio Los Angeles.
To water of same.
Across River Los Angeles average depth 4 inches current 4 miles per hour and water rapidly sinking in sand.
To fence of cultivated field, belonging to Ylarío Barrillo.

d 40