

COPIED FROM CERTIFIED COPY
FURNISHED BY
UNITED STATES DISTRICT CADASTRAL ENGINEER
FOR CALIFORNIA.

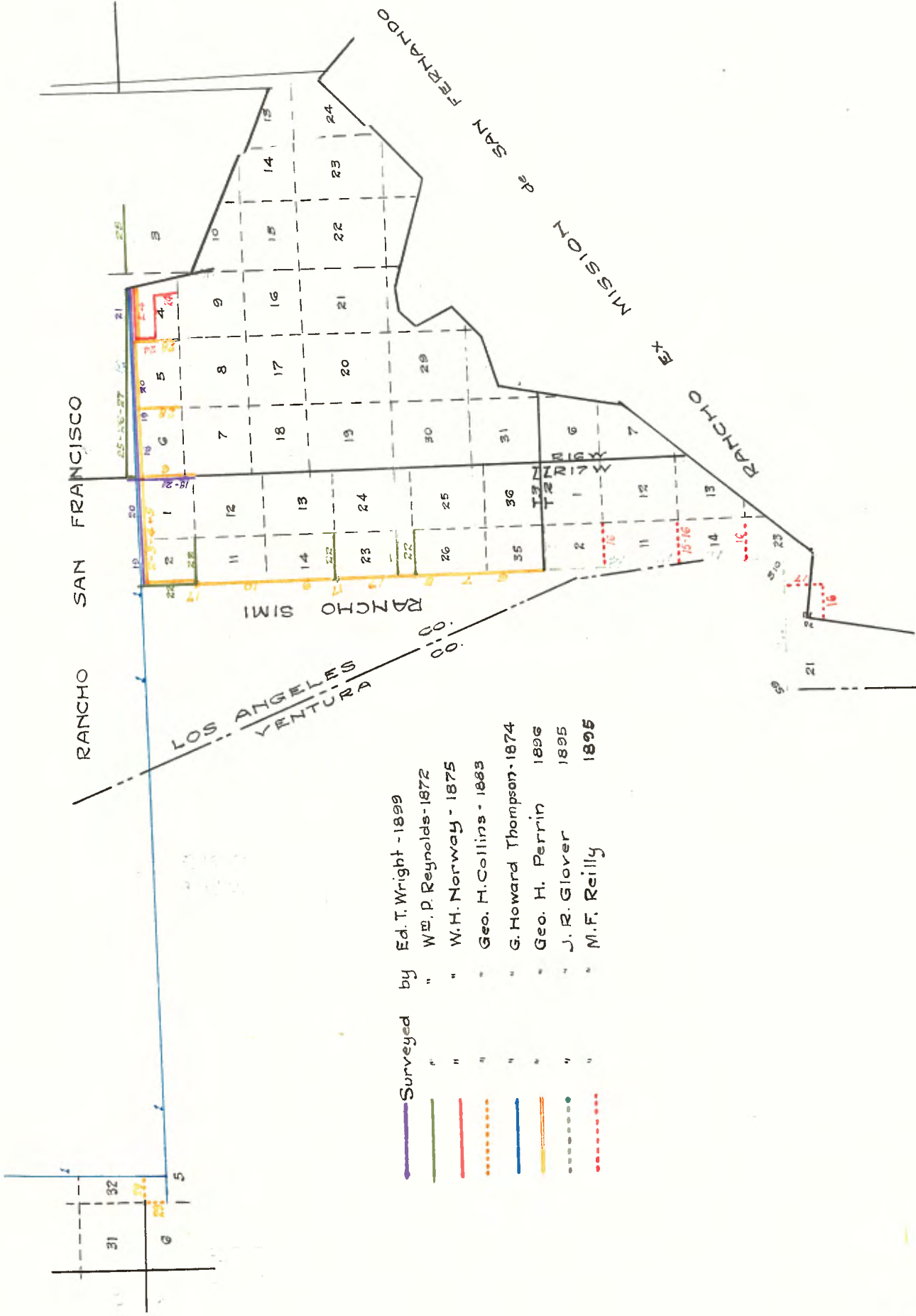

Surveyed	by	Ed. T. Wright - 1899
	"	W. P. Reynolds - 1872
	"	W. H. Norway - 1875
	"	Geo. H. Collins - 1883
	"	G. Howard Thompson - 1874
	"	Geo. H. Perrin - 1896
	"	J. R. Glover - 1895
	"	M. F. Reilly - 1895

4 -- 699

DEPARTMENT OF THE INTERIOR

Public Survey Office
145 Sansome St.,
San Francisco

November 11th, 1926.

I, Frank E. Barker, U. S. Office Cadastral Engineer, for California, do hereby certify that the annexed transcript of field notes of survey of Rancho San Francisco, along the line between corners Nos. 2 and 3, and of Rancho Simi along the line between corners No. 10 and 11, with notes of surveys connecting said lines with section and township lines, San Bernardino Meridian, is a true and literal exemplification of said field notes as they remain on file and of record in this office.

(Signed) Frank E. Barker
Frank E. Barker
Office Cadastral Engineer,
for California.

FIELD NOTES OF SURVEY OF

Part of Rancho San Francisco and part of Rancho Simi;
also resurvey of E. boundary of T. 3 N., R. 17 W., S. B. M.

RANCHO SAN FRANCISCO.

Jacoba Feliz.

Confirmed.

Survey made by G. Howard Thompson, Deputy Surveyor.

Under his Instructions dated May 28th, 1874.

Commencing at a post in a mound of rocks marked "S.F.

No. 1" standing in the mouth of the Pirn Creek, near its

Junction with the river, Santa Clara. I ran thence toward

a large lone oak, standing on the summit of the ridge, as

follows:

Variation $14^{\circ} 21'$ East.

1 S. 10°30' W.

7.00 Junction of the Pirn Creek and Santa Clara river.

thence, crossing the sandy bed of same, 15 chains

35.00 To foot of mountain and ascend over steep broken

153.67 To a post in a mound of stones on steep mountain

side, marked "S.F. 2", from which the lone oak.

on summit of ridge bears S. $10\frac{1}{2}^{\circ}$ W. 60.00 chains

N. 72 E. 8.00 chains distant.

Thence, along the steep side of the mountain fac-

ing north, over very broken bushy ground.

2 N. 88°16' E.

1072.77 To a burr oak, 18 inches diameter standing on the

point of a low hill, on the south boundary of Town-

ship 4 North, Range 16 West, of San Bernardino

Meridian 16.50 chains west of the corner to sec-

tions 3, 4, 33 and 34.

I remarked said tree "S.F.3", (this tree had been

previously marked for fractional sections 4 and 33)

Thence, descending. x x x x x x x x x x x x x x x x

Book 390-15 Survey by Geo. H. Perrin, Deputy Surveyor,
Contract of August 22, 1896.
Survey executed November 13th - 21st, 1896.

Resurvey of Rancho San Francisco,
T. 3 N. R. 16 W., Course No. 2

From corner S. No. 9 of Rancho Simi, on southerly boundary of Rancho San Francisco, which is a white oak 16 inches diameter marked "S. No. 9", I run North $88^{\circ} 16'$ East on a random line on southerly line of San Francisco Rancho.

I set temporary corners at every 40.00 and 80.00 chains and at

363.04 I arrive at a point north $1^{\circ} 44'$ west, 1.88 chains distant from Cor. S.F. No. 3, which is a white oak 20 inches diameter, marked "S. F. No. 3"

Thence I run

South $88^{\circ} 34'$ West on a true line.

Descending.

18.50 Cross road from Newhall to Oil Wells, bears east and west, and ascend.

38.00 Cross same road, bears north 70° east and south 70° west.

40.00 Set a redwood post, 4 feet long, 4 inches square, with marked stone 24 inches in the ground, marked "S. F." on side facing ranch, and "1/400" on said facing last described corner, and raised a mound of stone 2 feet base, $1\frac{1}{2}$ feet high north of corner.

Pits impracticable. From which

A live oak 14 inches diameter bears north 5° west 64 links distant, marked "S.F. 1/400. B.T."

43.60 Cross same road bears north and south.

80.00 Set a redwood post, 4 feet long, 4 inches square, with marked stone, 24 inches in the ground, marked "S.F." on side facing ranch and "1/800" on side facing last described corner and raised a mound of stone 2 feet base, $1\frac{1}{2}$ ft. high north of corner. Pits impracticable.

94.00 Descend.

110.00 Enter valley bears north and south.

Resurvey of Rancho San Francisco, T.3 N., R.16 W., S.B.M.
 * * Course No. 2 * *

- 112.00 Sampone's cabin, bears south 2.00 chains distant.
- 113.50 Enter chamisal, bears north and south.
- 118.00 Cross wire fence, bears northeast and southwest.
- 118.50 Cross same road, from Newhall to oil wells, bears north
 60° east and south 60° west.
- 120.00 Set an oak post 4 feet long, 4 inches square, with marked stone
 24 inches in the ground, marked "S.F." on side facing ranch
 and "2/400" on side facing last described corner, and raised
 a mound of stone 2 feet base, 1½ feet high, north of corner.
 Pits impracticable. From which
- A live oak 10 inches diameter, bears north, 8 links dis-
 tant, marked "S.F. 3/120 C.B.T."
- 120.25 Enter bed of dry arroyo; course north 70° east.
- 122.35 Leave same, course north 70° east.
- 124.00 To foot of high bluff, impracticable to chain on line, I there-
 fore run on offset south 1°26' East, 7.75 chains south 88°34'
 west, at
- 3.00 Cross road from Newhall to oil wells, bears north 70° east
 and south 70° west.
- 11.00 Cross dry arroyo; course north 70° east.
- 15.00 To foot of perpendicular bluff, thence South 1° 26' East 1.40
 chains. Thence South 88° 34' west, and at
- 3.50 Cross dry arroyo, course south 70° east.
- 5.76 Cross fence, bears north and south.
- 19.00 To east bank of arroyo. Thence North 1° 26' West, 7.00 chains.
 To foot of bluff. Thence South 88° 34' West, 4.00 chains, thence
 North 1°26' West, 2.15 chains to line of San Francisco Rancho.
- 124.00 + 15.00 + 19.00 + 4.00 =
- 162.00 To foot of bluff, 200 feet high, and set an alder post 4 feet
 long, 4 inches square, with marked stone 24 inches in the
 ground, marked "S.F." on side facing ranch, and "W.C.2/800"

Resurvey of Rancho San Francisco,
T. 3 N., R. 16 W., S.B.M. Course No.2

on side facing last described corner, and raised a mound of
stone 2 feet base, $1\frac{1}{2}$ feet high, north of corner.

Pits impracticable.

This witness corner is 2.00 chains south $88^{\circ} 34'$ west of
proper point for corner.

171.65 Cross dry bed of arroyo, 4 links wide, course southeast.

172.78 Cross Newhall and Oil Wells road, bears northwest and
southeast.

176.00 Enter bed of arroyo, course northeast.

179.50 Leave bed of arroyo, course northeast.

181.50 Enter brush and ascend.

200.00 Set an oak post, 4 feet long, 4 inches square, with marked
stone 24 inches in the ground, marked "S.F." on side facing
ranch, and " $\frac{3}{400}$ " on side facing last described corner,
Dug pits $24 \times 18 \times 12$ inches, on line 4 feet distant, and
raise a mound of earth 4 feet base, 2 feet high, north of
corner, on point of spur, trends north and descend.

206.75 Cross ravine, 10 links wide, course north - 250 feet and
ascend.

213.50 Top of spur, trends north + and descend north slope

240.00 Set a cottonwood post, 4 feet long, 4 inches square, with
marked stone 24 inches in the ground, marked "S.F." on
side facing ranch and " $\frac{3}{800}$ " on side facing last described
corner.

Dug pits $24 \times 18 \times 12$ inches on line 4 feet distant, and
raised a mound of earth 4 feet base, 2 feet high, north of
corner.

Pacific Coast Oil Co's power house bears North 35° west,
2.14 chains distant.

Resurvey of Rancho San Francisco.
T. 3 N., R. 16 W., S. B. M., Course No. 2

- 242.14 Pump house on line.
Oil tank bears south 20° west 1.20 chains distant.
- 244.00 Cross dry arroyo; course northeast.
- 244.25 Cross road to Oil wells, bears northeast and southwest.
- 246.50 House bears south 10 links.
- 247.00 Ascend steep hill.
- 255.00 Water tank, bears south 36° west.
- 266.50 Top of ridge, bears north 20° east and south 20° west
+ 500 feet, and descend.
Water tank bears south 20° 18' east.
- 280.00 Set an oak post, 4 feet long, 4 inches square, with
marked stone 24 inches on the ground, marked "S.F." on
side facing ranch and "4/400" on side facing last de-
scribed corner.
Dig pits 24 x 18 x 12 inches on line. 4 feet base, 2
feet high north of corner.
- 317.00 Cross canon, with small stream of water, course north
10° east - 600 feet and ascend.
- 320.00 Set a walnut post, 4 feet long, 4 inches square, with
marked stone 24 inches in the ground, marked "S.F." on
side facing ranch, and "4/800" on side facing last de-
scribed corner.
Dug pits 24 x 18 x 12 inches on line, 4 feet distant,
and raised a mound of earth, 4 feet base, 2 feet high,
north of corner.
- 363.04 To corner S. No. 9. Land, mountainous. Soil, 2nd and third
rate. Timber, oak and walnut. Undergrowth of same with
chaparral.

November 16, 1896.

Resurvey of E. B. T. 3 N., R. 17 W., S.B.M.

North $0^{\circ} 14'$ West, on east boundary of Section 1.

x x x x x x x x x x x x x x

- 78.92 Intersect southerly line of Rancho San Francisco, South $88^{\circ} 34'$ West, 23.20 chains from corner S.F. 3/40 C, and set a cottonwood post 3 feet long, 3 inches square, with marked stone 24 inches in the ground, for corner to fractional sections 1 and 6, marked "R 16 W S 6" on East. "T. 3 N." on South; and "R 17 W. S 1" on west faces, marked with 6 notches on south, east and west faces; dug pits 24 x 24 x 12 inches on south, east and west of post, 6 ft. distant, and raised a mound of earth 4 feet base, 2 feet high south of corner.
- 87.50 Cross dry arroyo, course south 65° east and ascend.
- 89.48 The corner to Townships 3 and 4 North, Ranges 16 and 17 West. Land, broken and mountainous.

November 19, 1896.

Resurvey of Rancho Simi, T. 3 N., R. 17 W., S.B.M.
Course 10

From the closing corner to Townships 2 and 3 North, Range 17 West, which is an oak post, 4 inches square, 1 ft. above ground, marked and witnessed as described by the Surveyor General, I run North $1^{\circ} 20'$ West on a random line (Course given by Deputy Glover, in tracing Simi Grant, in T. 2 N., R. 17 W.)

Setting temporary corners at every 40 chains and 80 chains, and at 472.02 chains I arrive at a point 151 links east of corner S. No. 9, previously described, in resurvey of Course No. 2 of Rancho San Francisco.

Thence I run South $1^{\circ} 31'$ East on a true line.

Ascend abruptly in dense chaparral.

Resurvey of Rancho Simi, T.3 N., R.17 W.
S.B.M. Course No. 10

- 3.00 Top of rocky spur, trends west and descend.
- 12.00 Cross canon, course west, -200 feet and ascend.
- 32.02 Set an oak post, 4 feet long, 4 inches square, with marked stone 24 inches in the ground, marked "S" on side facing ranch and $\frac{1}{32.02}$ C. on side facing last described corner, and raised a mound of stone 2 feet base, $1\frac{1}{2}$ feet high west of corner. Pits impracticable.
- 43.00 Top of ridge bears east and west + 400 feet above canon, and descend.
- 72.02 Set an oak post, 4 feet long, 4 inches square, with marked stone 24 inches in the ground, marked "S" on side facing ranch, and $\frac{1}{72.02}$ C. on side facing last described corner; dug pits 24 x 18 x 12 inches on line 4 feet distant, and raised a mound of earth, 4 feet base, 2 feet high west of corner.
- 77.12 Cross dry bed of Salt Creek, 20 links wide; course east, - 700 feet bellow ridge and ascend.
- 112.02 Set an oak post 4 feet long, 4 inches square, with marked stone 24 inches in the ground, marked "S" on side facing ranch and 2.400 on side facing last described corner. Dug pits 24 x 18 x 12 inches on line, 4 feet distant, and raised a mound of earth 2 feet high, 4 feet base, west of corner.
- 152.02 Set an oak post, 4 feet long, 4 inches square, with marked stone 24 inches in the ground, marked "S" on side facing ranch, and $\frac{2}{80}$ C. on side facing last described corner. Raised a mound of stone 2 feet base, $1\frac{1}{2}$ feet high west of corner. Pits impracticable.
- 170.02 Summit of divide between waters of Salt and Sulphur Creeks, bears east and west, + 800 feet above creek, and descend along west slope of brushy mountain.

Resurvey of Rancho Simi
T. 3 N., R. 17 W., S. B. M. Course No. 10

- 192.02 Set a sandstone 18 x 10 x 6 inches 12 inches in the ground marked "S" on side facing ranch and $\frac{3}{40}$ C on side facing last described corner, and raised a mound of stone 2 feet base, $1\frac{1}{2}$ feet high, west of corner. Pits impracticable.
- 218.02 Leave chaparral, bears east and west.
- 225.52 Cross Sulphur Creek, 20 links wide; course west, 600 feet below ridge, and leave timber, bears east and west and ascend open hill.
- 232.02 Set an oak post 4 feet long, 4 inches square, with marked stone 24 inches in the ground, marked "S" on side facing ranch, and $\frac{3}{80}$ C. on side facing last described corner. Raised a mound of stone 2 feet base, $1\frac{1}{2}$ feet high west of corner. Pits impracticable. From which
- A white oak 24 inches diameter, bears South 54° east, 173 links distant, marked "T. 3 N. R. 17 W. S. $\frac{3}{80}$ C B.T." Descending through oak timber.
- 272.02 Set an oak post, 4 feet long, 4 inches square, with marked stone 24 inches in the ground, marked "S" on side facing ranch and $\frac{4}{40}$ C. on side facing last described corner, and raised a mound of stone 2 feet base, $1\frac{1}{2}$ feet high, west of corner. Pits impracticable. From which
- A live oak 10 inches diameter bears north 3° east, 49 links distant, marked "T 3 N. R. 17 W.S. $\frac{4}{80}$ C. B.T."
- 312.02 This point falling on steep side hill, not suitable for corner, I continue line and at
- 314.52 Set an oak post, 4 feet long, 4 inches square, with marked stone 24 inches in the ground, marked "S" on side facing ranch, and W.C. $\frac{4}{80}$ C on side facing last described corner. From which
- A white oak 36 inches diameter bears north $66\frac{1}{2}^{\circ}$ east 98 links distant, marked "T 3 N.R. 17 W.S.23 W.O.S $\frac{4}{80}$ C B.T.

Resurvey of Rancho Simi,
T. 3 N., R. 17 W., S. B. M.
Course No. 10

A live oak 12 inches diameter bears South 61° east,
106 links distant, marked "T. 3 N.R. 17 W. S. 26 W. C.
S 4/80 C B.T."

This witness corner is 250 links south 1° 31' East from
the true point for corner. Ascend open mountain side.

- 334.52 Summit of high ridge, bears east and west, + 500 feet ^{above} ~~below~~
creek and enter chaparral and descend abruptly.
- 352.02 Set an oak post, 4 feet long, 4 inches square, with marked
stone 24 inches in the ground, marked "S" on side facing
ranch and 5/40 C. on side facing last described corner, and
raised a mound of stone 2 feet base, 1½ feet high west of
corner. Pits impracticable.
- 364.17 Cross spring branch 5 links wide, course southwest - 500
feet below ridge and ascend.
- 376.02 Top of spur trends south 20° west + 200 feet and descend
along west slope.
- 392.02 Set an oak post, 4 feet long, 4 inches square, with marked
stone 24 inches in the ground, marked "S" on side facing
ranch and 5/80 C. on side facing last described corner, and
raised a mound of stone 2 feet base, 1½ feet high west of corner.
Pits impracticable. Descending in chaparral.
- 402.52 Cross dry creek, 10 links wide, course south 80° east - 200
feet.
- 411.02 Ascend.
- 432.02 Set an oak post 4 feet long, 4 inches square, with marked
stone 24 inches in the ground, marked "S" on side facing
ranch and 6/40 C. on side facing last described corner, and
raised a mound of stone 2 feet base, 1½ feet high west of
corner. Pits impracticable.

Resurvey of Rancho Simi,
T. 3 N., R. 17 W., S. B. M.
Course No. 10

472.02 The closing corner to townships 2 and 3 north, range 17
west; Land mountainous and broken.
Soil, third and fourth rate.
Timber of oak.
Dense undergrowth of chaparral.

November 20 and 21, 1896.

FIELD NOTES OF SURVEY OF

Part of Rancho Simi, and part of Township 2 North, Range
17 West; part of Township 3 North, Range 16, 17, 18 West,
and part of Township 4 North, Range 16 West, S. B. M.

California.

- - - - -

Book 128-7 Survey by J. R. Glover, U. S. Deputy Surveyor.
Under contract dated November 20th, 1884.
Survey executed August 23rd - September 20, 1895.

Resurvey Boundary Line of Rancho Simi.

From Station No. 9, I run

East on a random line along boundary.

Var. $14^{\circ} 30'$ East.

162.94 To station No. 10, which I find in a bad condition. To
remark same I set a post, 4 ft. long, 6 ins. square, 12
ins. in the ground marked S. 10 on N. W. face; dug pits
 $18 \times 18 \times 12$ ins. on line N. and W. of post, $5\frac{1}{2}$ ft. dist.
and raised a mound of earth, 2 ft. high $4\frac{1}{2}$ ft. base around
post.

From which bears

A live oak 30 in dia. N. 17° E. 40 lks. dist. marked
S 10 B. T.

Sept. 6th, 1895.

From station No. 10, I run N. $1^{\circ} 20'$ W. on a random line
along boundary.

Var. $14^{\circ} 30'$ East.

It being impracticable to chain this line, on account of
precipitous cliffs, I offset N. $88^{\circ} 40'$ E. 4.00 chs.,
thence N. $1^{\circ} 20'$ W. 40.00 chs., thence S. $88^{\circ} 40'$ W. to
line, thence N. $1^{\circ} 20'$ W.

124.90 To a live oak tree, marked S. 8 on W. face.

Sept. 9th, 1895.

Thence I run S. $1^{\circ} 20'$ E. on a true line, along boundary.

Var. $14^{\circ} 30'$ East.

Descend.

4.90 A sandstone in place, $6 \times 6 \times 3$ ft. above ground, marked
S. $3/120$ for cor. on line.

17.93 Cross gulch, 10 lks. wide, course E. and ascend.

19.90 Top of Spur, bears E. and W. and descend.

31.55 Cross gulch 10 lks. wide, course E. and ascend.

44.90 Set a sandstone $24 \times 18 \times 12$ ins., 18 ins. in the ground
for cor. on line, marked $2/80$ on S. face and raised a mound
of stone alongside. Pits impracticable.

- 68.90 Top of spur bears E. and W. and descend.
- 84.90 Set a sandstone 14 x 12 x 10 ins. 9 ins. in the ground, for cor. on line, marked S. 1/80 on S. face, and raised a stone mound along side. Pits impracticable.
- 124.90 To station No. 10.
Land, mountainous.
Soil, 3rd rate.
Scattering oak timber and dense undergrowth of chaparral.
- Sept. 10th, 1895.
- Having verified the course of the last line, as being N. 1° 20' W., I continue on this angle, from the live oak tree marked S. 8, to what I consider a proper distance for the N. boundary of T. 2 N., R. 17 W., and at
- 162.31 Set temporary cor. for secs. 2 and 35, on N. boundary of Tp.
- Sept. 11th and 12th
- I now go to the cor. to Tps. 2 and 3 N., Rs. 16 and 17 W. and run W. (See page ____ Book of Extensors.)
- The length of boundary line of Ro. Simi from the live oak tree marked S. 8, to N. boundary of T. 2 N., R. 17 W. is therefore 162.41 chs. where I set cor. description of which is given on page ____ Book of Extensors. Thence I run S. 1° 20' E. on a true line along boundary.
- Var. 14° 30' East.
- Ascend.
- 5.31 Top of ridge, bears E. and W. and descend.
- 7.31 Set a sandstone 16 x 12 x 4 ins. 11 ins. in the ground, for cor. on line, marked S. 7/280 on S. face, and raised a stone mound alongside.
- 18.96 Cross gulch, 10 lks. wide, course E. and ascend.
- 47.31 A sandstone in place, 12 x 8 x 6 ft. above ground, which I marked S. 6/240 on S. face, for cor. on line.
- 57.46 Top of spur bears N.E. and S.W. and descend.

Resurvey Boundary Line of Rancho Simi

- 83.71 Cross gulch, 10 lks. wide, course E. and ascend.
- 86.96 Cross trail, bears E. and W.
- 87.31 Set a sandstone 24 x 18 x 12 ins. 18 ins. in the ground for cor. on line, marked S. 5/200 on S. face, and raised a stone mound alongside. Pits impracticable.
- 98.31 Top of ridge, bears E. and W. and descend.
- 107.35 Cross gulch, 8 lks. wide, course S. 30° E. and ascend.
- 111.81 Top of spur, bears N.W. and S.E. and descend.
- 118.46 Cross gulch, 6 lks. wide, course E. and ascend.
- 122.76 Top of spur, bears E. and W. and descend.
- 127.31 Set a sandstone 24 x 14 x 8 ins. 18 ins. in the ground, for cor. on line, marked 4/160 on S. face; and raised a stone mound alongside. Pits impracticable.
- 131.26 Cross gulch, 6 lks. wide, course E. and ascend.
- 131.35 Cross road from Los Angeles to Ventura, bears E. and W.
- 144.31 Top of spur, bears E. and W. and descend.
- 148.96 Cross low sag, bears E. and W. and ascend.
- 162.11 Cross old road from Los Angeles to Ventura, bears E. and W.
- 162.41 To live oak tree, marked S.S. Land, mountainous.
- Soil, 3rd rate.
- Scattering oak timber and dense undergrowth of chaparral.

September 18th, 19th and 20th.

Book 128-15 Survey by J. R. Glover, Deputy Surveyor,
Contract of November 20, 1884.
Survey executed September 13th, 1895.
October 28, 1895.

North Boundary T. 2 N., R. 17 W., S. B. M.

West on a true line bet. secs. 2 and 35.

Var. 14° 30' E.

x x x x x x x x x x x

- 46.70 Intersect E. boundary of Rancho Simi, at a point 10 lks.
N. 1° 20' W. of temporary cor. to secs. 2 and 35, on bd.
of Ro. Simi, and set a post 4 ft. long, 4 ins. square,
with marked stone 12 ins. in the ground, for closing cor.
to Tps. 2 and 3 N., R. 17 W., marked
C. C. R. 17 W. on E. face; T. 3 N., S. 35 on N. face,
and T. 2 N. S. 2 on S. face, with 6 notches on north,
south and east faces, and raised a stone mound around
post. Pits impracticable.

Book 380-6 Survey by M. F. Reilly, Deputy Surveyor,
Contract of November 20, 1884.
Survey executed September 19 - 27, 1895.

Subdivision T. 2 N., R. 17 W., S. B. M.

West on a true line between sections 11 and 14.

Variation 14° 30' East.

x x x x x x x x x x x

- 43.10 Intersect east boundary Rancho Simi at a point 2.38 chains
N. 1° 20' W. from oak tree, 40 inches diameter, marked
S. 8 and 7.28 chains N. 1° 20' W. of a stone corner in
good order, marked S. 3/120, and set a post 4 feet long,
4 inches square with marked stones 12 inches in the ground
for closing corner to sections 11 and 14, marked
C. C. T. 2 N. R. 17 W. on east face; S. 11 on North and
S. 14 on south faces, with 2 notches on north and 4 notches
on south faces, and raised a stone mound around post.
Pits impracticable.

West on a true line between sections 2 and 11.

Variation 14° 30' E.

Subdivision T. 2 N., R. 17 W., S. E. M.

x x x x x x x x x x x

- 44.84 Intersect east boundary of Rancho Simi, at a point 7.23 chains N. $1^{\circ} 20'$ W. from stone corner in good order, marked S. 5/200 and set a sandstone 22 x 16 x 5 inches, 16 inches in the ground for closing corner to sections 2 and 11, marked C. C. with 1 notch on north and 5 notches on south edges, and raised a stone mound alongside. Pits impracticable.
-

West on a true line between sections 14 and 23.

Variation $14^{\circ} 30'$ East.

x x x x x x x x x x x

- 41.18 Intersect east boundary of Rancho Simi, at a point 7.18 links N. $1^{\circ} 20''$ W. from stone corner in good order, marked S. 1/40 and set a post 4 feet long; 4 inches square, with marked stone, 12 inches in the ground, for closing corner to sections 14 and 23, marked C.C. T 2 N., R.17 W. on east; with 3 notches on N. and S. faces, S. 14 on north and S. 23 on south faces, and raised a stone mound around post; pits impracticable.

Corner on top of spur bears northeast and southwest.

From the closing corner to sections 22 and 27 on boundary of Rancho San Fernando, I run East on a blank line 32.08 chains, thence north 14.06 chains and intersect boundary line of San Fernando Rancho, 29.48 chains S. $85^{\circ} 19'$ E. from station No. 33 on boundary, which is a post set firmly in the ground marked S.F. No. 33, on south face with a stone mound in good order around post, and set a sandstone 30 x 14 x 10 ins. 22 ins. in the ground for closing corner to secs. 22 and 23, marked C. C. with 2 notches on east and 4 notches on west edges, dug pits 18 x 18 x 12 ins. N.E. and W. of stone $5\frac{1}{2}$ ft. dist. and raised an earthmound 2 ft. high, $4\frac{1}{2}$ feet base alongside.

Thence I run North on a true line between sections 22 and 23.

Variation 14° 30' East.

Over broken land.

18.90 Intersect boundary line of Rancho Sima, 3.46 chains east of a sandstone set firmly in the ground, marked 3/120 on west, and S. on north faces, with a stone mound in good order alongside, and set a sandstone 28 x 17 x 7 inches, 21 inches in the ground for closing corner to sections 22 and 23, marked C. C. with 2 notches on east and 4 notches on west edges, and raised a stone mound alongside.

Pits impracticable.

Book 363-2 Survey by Geo. H. Perrin, Deputy Surveyor,
Contract of May 25, 1896.
Subdivisions T. 3 N., R. 17 W., S. B. M.

It being evident from the courses of the lines on the East and W. boundaries of sections 11 and 14, that there is an error in departure in either the north boundary of section 11 or the south bdy. of section 14, in order to locate or determine that fact, I proceed as follows:

From corner S. 3/80 C. which is a post on easterly line or rancho, which I mark for corner to fractional sections 14 and 23, South 14 on northeast and south 23 on southeast faces, & run EAST. x x x x x x x x x x x x x x x x

From corner S. $\frac{1}{72.02}$ C., which is a post I mark for corner to fractional sections 2 and 11, S. 2 on northeast and S. 11 on southeast faces, and run EAST. x x x x x x x x x x

Book 392-10 Survey by Edward T. Wright, U.S. Dep. Sur.
Under instructions dated October 28, 1899.

East boundary Sec. 1, T. 3 N., R. 17 W.

I begin at the point for corner to secs. 1, 12, T. 3 N., R. 17 W.

As described by me in the survey of sec. 1, T. 3 N., R. 16 W.

From said point I run N. 0°11' W. on true line on E.bdy. sec. 1,
T. 3 N. R. 17 W.

x x x x x x x x x x x x

78.74 Redwood post 4 ins. square, mentioned in my field notes on
Range line in survey of sec. 7, T. 3 N., R. 16 W.

Descend along E. side of summit of ridge.

81.13 Old cottonwood post, mentioned in my field notes of Range
line in survey of sec. 7, T. 3 N., R. 16 W., 5 ins. diam.

in mound of earth, with pits E. W. and S. marked

T. 3 N., R. 16 W., S. 6 on E.

T. 3 N., R. 17 W., S. 1 on W.

S F on N. and O O on S faces, for closing corner to frac-
tional secs. 1 and 6 and San Francisco Rancho, at top of
steep ascent.

As there seems to be some doubt as to where the true inter-
section of this range line and S. line of Rancho San Francisco
is, I locate present stakes, as above described and find inter-
section point later.

86.61 Foot of steep slope, enter Pico canon, course E.

87.72 Center dry wash, course E.

88.78 Three iron pipe lines bearing E. and W.

89.10 Old cor. of Tps. 3 and 4 N., Rs. 16 and 17 W., mentioned in my
field notes on range line in survey of sec. 7, T. 3 N., R. 16 W.

August 22, 1899.

North Boundary Sec. 1, T. 3 N., R. 17 W.

The S. line of San Francisco Rancho, not being established to my satisfaction on the ground,

I go to the white oak tree S.F. 3, San Francisco Rancho and run

S. 88° 09' W. on what is supposed to be the true line toward Sta. 2 of said rancho.

- 222.24 Intersect range line between ranges 16 and 17 west, at old cottonwood post as described 7.97 chs. S. 0° 11' E. of township corner.
- 301.36 Corner set by Deputy W. P. Reynolds as the closing cor. at NW. corner of fractional sec. 1, bears S. 1.85 chs. dist.
- 364.29 Sta. No. 9 of the Rancho Simi, bears S. 3.40 chs. dist. At this station is a white oak tree, marked S 9 and as called for in patent and said to be on line of rancho San Francisco.

I correct my N. line of sec. 1 to agree with the ~~true~~ line between Sta. 9 of Rancho Simi.

August 26, 1899

I return to Range line and establish the corner to secs. 1 and 6, on true S. line of Rancho San Francisco at 10.05 chains S. 0° 11' E. from township corner and being S. 0° 11' E. 2.08 chs. (calculated) from old C.C. described in my notes of W. bdy. of T'p 3 N., R. 16 W.

Set sandstone 8 x 10 x 16 ins. on N. slope of hill. marked S F on N. 1 on W. C C on S and 6 on E. faces; dug pits and built mound 2 ft. at base, 1½ ft. high. Thence from said closing corner I run S. 87° 37' W. on S. line of Ro. San Francisco.

Var. 14° 35' E.

- 3.50 Summit small ridge, bearing N.
- 11.00 Cross steep spur.
- 21.00 Foot of bank on E. side of Pico Canon.

North Boundary Sec. 1, T. 3 N., R. 17 W.

- 26.00 Foot of bank on W. side of Pico canon.
43.76 Point on line on summit of dividing ridge 2.48 chs. S. of
granite monument set in ridge.
66.00 Cross low flat ridge bearing N.
76.50 Top of ridge bearing NW.
79.13 Intersect W. line sec. 1, T. 3 N., R. 17 W., at 96 lks. S.
of closing corner as described by Deputy W.P. Reynolds.
Set granite monument 30 ins. long, 4 ins. square at top,
24 ins. in ground, on W. slope of hill, for closing cor-
ner to fractional secs. 1 and 2, marked S.F. on N.
S 1 on E. CC on S. and S 2 on W. faces;
from which

Black walnut, 18 ins. dia. marked T 3 N R 17 W
S 1 C C B.T. bears N. $11^{\circ} 30'$ E. 1.95 chs. dist.

A willow tree, 14 ins. diam. marked T 3 N R 17 W.
S 2 C C B T bears N. 16° W. 2.24 chs. dist.

Book 392-9 Survey by Edward T. Wright, Deputy Surveyor
Instructions of October 28, 1899.

I begin at the established corner of Tp. 3 and 4 N., Rs.
16 and 17 W., San Bernardino Base and Meridian, which is
a cottonwood post 6 in. dia. marked T 4 N R 16 W S 31 on NE.
T 3 N R 16 W S 6 on SE. T 3 N R 17 W S 1 on SW.
T 4 N R 17 W S 36 on NW. faces, with an older marked post
alongside, in large mound of rocks in bottom of Pico
Canon, from which

A cottonwood tree, 26 in. dia. bears S. $61\frac{1}{2}^{\circ}$ E. 98
lks. dist.

A live oak tree, 24 in. dia. bears N. 58° W. 138 lks.
dist., on all which trees the old blazes and marks are

West Boundary T. 3 N., R. 16 W.

plainly discernible, as described by the Surveyor General.

From said post, I run S. 0°11' E., as turned from true north and south line as determined August 6, on a random line.

Var. 14° 35' E.

- 7.97 An old cottonwood post 5 ins. dia. in mound of earth, with pits, east, west and south and marked
T 3 N R 16 W S 6 on E.
T 3 N R 17 W S 1 on W.
S. F. on N. and C C on S. faces, for closing corner to fractional secs. 1 and 6, and the San Francisco Rancho.
- 10.36 A redwood post, 4 ins. square, marked S F on N. and N. S. 4 on S. W. faces.
- 16.99 A redwood post 4 ins. square, marked N. S. on W. face.
- 28.71 A redwood post 4 ins. square, marked N. S. on W. face.
- 60.13 Intersect N. line of Arcadia Oil claim, which point falls on N. face of precipitous rock bluff.
- 60.55 An old rock mound on summit of high rock peaks.
This corner is mentioned in field notes of Deputy W. P. Reynolds.

August 7, 1899.

- - - - -

Book 164-12 Survey by Wm. P. Reynolds, Deputy Surveyor,
Contract of March 29th, 1872.

Frac. Tp. 3 North, Range 17 West, S.B.M.

West on a true line bet. secs. 23 and 26.

Var. 15° 10' E.

59.44 ~~x x x x x x x x x~~
Intersected the E. bdy of the Rancho Simi.

From which

The high rock peak bears South.

Set a sandstone 22 x 18 x 12, for cor. to frac. Secs. 23-
26, in a mound of sand rock as per ins. Land, hilly &
broken. 3d rate.

From the cor. to secs. 13, 14, 23 and 24, I run
West on a true line bet. secs. 14 and 23.

Va. 15° 10' E.

~~x x x x x x x x x~~
59.16 Intersect E. bdy. of Rancho Simi, and set a post for cor.
to frac. secs. 14 & 23, in a mound of sand and slate rock,
as per ins. 3.80 chs. E. of the left bank of the Canada
de los Alisos, about 4 chs. wide, running S. 30° E. Land,
grassy ridge and hills, 2nd rate.

May 31, 1872.

From the cor. to secs. 1, 2, 11 & 12, I run West on a true
line bet. secs. 2 & 11

Var. 15° 10' E.

~~x x x x x x x x x x~~
58.40 Intersect the E. bdy of Rancho Simi.
Set a post for cor. to fract. secs. 2 & 11, in a mound of
shale rock as per ins.

Land, steep hills with grass, 2nd rate.

North, along the E. bdy of Rancho Simi in Sec. 2.

Var. 15° 10' E.

Along the NW. slope of hill.

Fract. Tp. 3 N., R. 17 W., S.B.M.

- 27.00 Leave NW. slope of hills.
40.00 Set a post for fract. $\frac{1}{4}$ sec. cor. in a mound of shale, as
per ins.
43.00 To s'm't of hill, E. & W.
51.50 Cross do. and set a post for cor. to fract. sec. 2, in a
mound of sand rock as per ins.

Land, hilly with good grass, 2nd rate with scattering
black walnut.

From this point it is impracticable to run the line any
further North, on account of a steep gorge intervening.
I therefore run a traverse line along the northerly slope
of hill.

Course Dist.

N. 60 E. 10.00 chs. in sec. 2. Thence

" 20 " 15.00 " " " 2. "

2.45 " and intersect the S. bdy of Rancho San
Francisco.

Set a post for cor. to frac. sec. 2, in a mound of sand
rock; from which

Station 9 of Rancho Simi bears S. $87^{\circ} 21'$ W. 13.79 chs.
dist. and said Sta. 9 is by calculation 72.41 chs. north
of cor. to frac. secs. 2 & 11.

June 4th, 1872.

- - - - -

Book 164-3 Survey by W. H. Norway, Deputy Surveyor,
Contract of November 19, 1875.

T. 3 N., R. 16 W., S. E. M.

The line bet. secs. 4 & 5, is very brushy to measure, I
therefore begin at the $\frac{1}{8}$ cor. 20.00 chs. east of the $\frac{1}{4}$
sec. cor. bet. secs. 4 & 9, and run
North on a true line on $\frac{1}{8}$ sec. line, through E. $\frac{1}{2}$ of
sec. 4.

x x x x x x x x x x x x x

40.00 x x x x x x x x x x x x x

Thence West on $\frac{1}{4}$ sec. line through sec. 4.

Var. $14^{\circ} 10'$ E.

x x x x x x x x x x x x x

60.00 Set an oak post 3' x 3 in 3 ft. long, in a mound of rocks
as instructed for $\frac{1}{4}$ sec. cor. bet. secs. 4 & 5.

Thence North bet. secs. 4 & 5.

Var. $14^{\circ} 10'$ E.

25.60 Intersect the Southern boundary of the Rancho San Francisco
and set an oak post, 3 x 3 in. 3 ft. long, in a mound of
earth and pits; as instructed for cor. to fract. secs. 4
& 5. From this cor. I run along the Southern boundary of
said Rancho.

(E)
N. $88^{\circ} 16'$ W.

63.40 The cor. No. 3 of the Final Survey of said Rancho.
Land, rough 1st & 2nd rate soil.

December 17th, 1875.

63.40
38.00
38.00
42.70
85.67

Book 164-11 Survey by W.P. Reynolds, Deputy Surveyor
Contract of March 19, 1872,

S. Bdy T. 4 N., R. 16 W., S.B.M.

3rd Mile

West on S. bdy of sec. 34,

x x x x x x x x x x x x x

80.00 Set a post in mound, the established cor. to secs. 3,4,33 & 34.

West on a true line along the S. bdy of sec. 33.

Var. 15° 10' E.

14.00 Foot of hills bearing N. 25° E and S. 25° W.

16.52 A burr oak 20 in. dia. with blaze and rock mound Sta. 4 of
the Rancho San Francisco, finally confirmed to Jacoba Feliz.

40.00 Point for $\frac{1}{4}$ sec. cor. I set no post.

46.00 To summit of a main ridge, bearing N. & S.

Set a post in an irregular mound of rock; from this point
the line continues over steep and brushy hills, rendering it
impracticable to measure over the same. I therefore run the
following traverse:

Course	Dist. chs.
N. $38\frac{1}{4}^{\circ}$ W.	17.00

Foot of ridge NE. & SW.

Enter valley.

30.00

To a point in valley 30 chs. wide,
N. 30° E. Thence up the valley.

S. 70° W.	62.00
-----------	-------

Thence

S. $83\frac{1}{4}^{\circ}$ W.	20.36
-------------------------------	-------

Set a sand rock 18x10x6 on line bet.
secs. 5 and 32, 16.95 chs. east of
cor. to said secs.

Thence

South	5.86
-------	------

Set a post at intersection of Rancho
San Francisco, from which
Sta. 4 bears N. $87^{\circ}21'$ E. 126.54 chs. dist.

6.77

Set a stake in canon.

Thence-

S. $78\frac{1}{4}^{\circ}$ W.	3.43
-------------------------------	------

Set a stake in canon, thence

" 50 "	8.66
--------	------

" " " " " "

T. 4 N., R. 16 W., S. B. M.

S. 68° W.	5.62	Set a stake in canon. Thence
S. 87 "	1.77	" a post for witness cor. to secs. 5, 6, 31 & 32, in an irregular mound of shale rock on the S. side of a high bluff, running N. 70° W. & S. 70° E. 15.19 chs. S. of point for the true cor. to said sections.
		Thence across mouth of Spring Canon.
S. 56½° W.	8.76	To westerly junction of Spring & DeWitt canons. The latter canon comes in from S. 20° W. Thence up Spring canon.
N. 58½° W.	5.00	Cross a dry wash, 40 lks. wide, N.E.
	11.00	Cross same dry wash, 35 lks. wide, S.E.
	18.00	" " " " 35 lks. wide N.E.
	24.80	To a telegraph pole on N. side of Spring canon 100 lks. S. of steep rocky ridge, extending the entire length of canon.
		Thence still up canon. Along the line of telegraph poles.
N. 72½° W.	4.00	Cross same dry creek, 40 lks. S.E.
	6.00	" " " " " " N.E.
	7.50	" " " " " " S.E.
	23.00	" " " " 50 " N.E.
	28.50	" " " " 30 " S.E.
	29.50	A gully, 20 lks. wide, runs N.E. to main creek,
	32.50	To a telegraph pole in center of canon, 5 chs. wide.
		A canon comes in from N.W. through which the telegraph line passes is 200 lks. wide at the mouth, and 4 chs. dist. from this point.
		Thence still up the main Spring canon.
S. 79½° W.	11.00	& set a stake. Thence
" 83 "	5.00	Cross a dry wash, 20 lks. wide, N.E.
	8.50	To a point of hill in turn of road, running NW. & N.E. thence

T. 4 N., R. 16 W., S.B.M.

N. $71\frac{1}{4}^{\circ}$ W. 1.28 Set an elder post in an irregular mound of sand rock for cor. to Tps. 3 & 4 N., Ranges 16 & 17 West on the left and north bank of the main dry arroyo in canon, from which post bears
A live oak 18 in diam. N. 58° W. 135 lks.
" cottonwood 26" " S. $61\frac{1}{2}^{\circ}$ E. 95 "
" " 13 across dry arroyo S. $63\frac{1}{2}^{\circ}$ W. 170 lks.

May 23, 1872.

Bet. Rs. 16 & 17 W., Tps. 3 N., S. B. M.

From the cor. to Tps. 3 & 4 North, Ranges 16 & 17 W., I run
S. $00^{\circ} 11'$ E. on a true line bet. secs. 1 and 6. Var. $15^{\circ} 10'$ E.
2.00 Cross a dry arroyo, runs S. 65° E. and ascend N. slope of high, grassy hill.
10.36 Set post for fractional cor. to secs. 1 & 6 at intersection of S. bdy of Rancho San Francisco, finally confirmed to Jacoba Feliz, in a sand rock mound as per ins., from which Sta. 3 of said Rancho bears N. $87^{\circ} 21'$ E. 223.74 chs.

X X X X X X X X X X X X X X X X

Book 363-1 Survey by George H. Perrin, Deputy Surveyor.
Contract of May 25, 1896.
Survey executed Aug. 4th - Nov. 25, 1896.

Subdivisions T.3 N., R.16 W., S. B. M.

From the corner to sections 5, 6, 7 and 8, I run
North $0^{\circ} 1'$ West on a true line between sections 5 & 6.

x x x x x x x x x x x

57.90 To foot of impassable bluff, 200 feet high and set a walnut
post, 3 feet long, 4 inches square, with marked stone 24
inches in the ground for witness to closing corner to sections
5 and 6, marked W C to C.C. T 3 N., R. 16 W. on south; S. 5
with 1 groove on west and 5 grooves on east faces,
on east, and S 6 on west faces, and raised a mound of stone
4 feet base 2 feet high south of corner. Pits impracticable.
From which

A willow 20 inches diameter bears south 32° east 88 links
distant, marked T 3 N R 16 W S 5 W C B.T.

A willow 14 inches diameter bears south 79° west, 192
links distant, marked T 3 N R 16 W S 6, W. C. B.T.

August 8, 1896

RESURVEY.

As I have hunted unsuccessfully for the quarter section
corner between sections 4 and 5, I now go to the corner to
sections 4, 5, 8 and 9 and run
North on a true line between sections 4 and 5.

x x x x x x x x x x x

90
66.63 Intersect line of Rancho San Francisco, at a point north 88°
34' east, 16.32 chains distant from corner No.1- 80 -c S.F.
described by me in resurvey of Rancho San Francisco, in my
contract No. 136, dated August 22, 1896, and

337
80
16.32
63.68
Set an oak post 4 feet long, 4 inches square, with marked
stone 24 inches in the ground, for closing corner to sections
4 and 5, marked C.C.T.3 N., R.16 W. on south; S 4 on east
and S 5 on west faces; with 4 grooves on east and 2 grooves
on west faces, and raised a mound of stone, 4 feet base, 2 feet
high south of corner. Pits impracticable.

Book 215-19 Survey by Geo. S. Collins, Deputy Surveyor.
Contract of April 1, 1882
Survey executed May, 1883

T. 3 N., R. 18 W., S. B. M.

From the cor. to sections 5, 6, 31 and 32, on north boundary of township, which is a post with earth mound and pits, I run South, on true line between sections 5 and 6.

Variation $14^{\circ} 30'$ East

Over broken brushy spurs.

- 29.30 Top of spur bears northwest and southeast and descend.
- 34.58 Intersect north boundary of Rancho Simi as resurveyed by me, South $63\frac{1}{2}$ west 20.20 chains from corner No. 12, of said rancho and set post 4 ft. long, 4 ins. square, with marked stone 12 ins. in the ground, for corner to fractional sections 5 and 6, marked T 3 N R 18 W. on north; S 5 on east and S 6 on west faces, with 1 notch on west and 5 notches on east faces; dug pits $18 \times 18 \times 12$ ins. north, east and west of post, $5\frac{1}{2}$ ft. distant and raised mound of earth 2 ft. high $4\frac{1}{2}$ ft. base around post. Land, mountainous; soil, third rate. Timber oak. Dense undergrowth of same and chemisal and sage.
- - - - -

From corner to sections 5, 6, 31 and 32, I run East on true line on north boundary of section 5. Variation $14^{\circ} 30'$ East. Descend. x x x x x x x x x x x

- 22.60 Intersect the west boundary of rancho San Francisco, north $10\frac{1}{2}$ east 25.77 chains from corner No. 12 of Simi rancho, and set post 4 ft. long, 4 ins. square, with marked stone 12 ins. in the ground, for corner to fractional sections 5 and 32, marked R 18 W on west; T 4 N S 32 on north; T 3 N S 5 on south face; with 2 notches on west and 4 notches on east edges dug pits $18 \times 18 \times 12$ ins north, south and west of post. $5\frac{1}{2}$ ft. distant, and raised mound of earth 2 ft. high $4\frac{1}{2}$ ft. base around post.

May 5, 1883.