

C 7361

COPIED FROM GOVERNMENT FIELD NOTES

LOANED BY

U. S. GENERAL LAND OFFICE

SAN FRANCISCO.

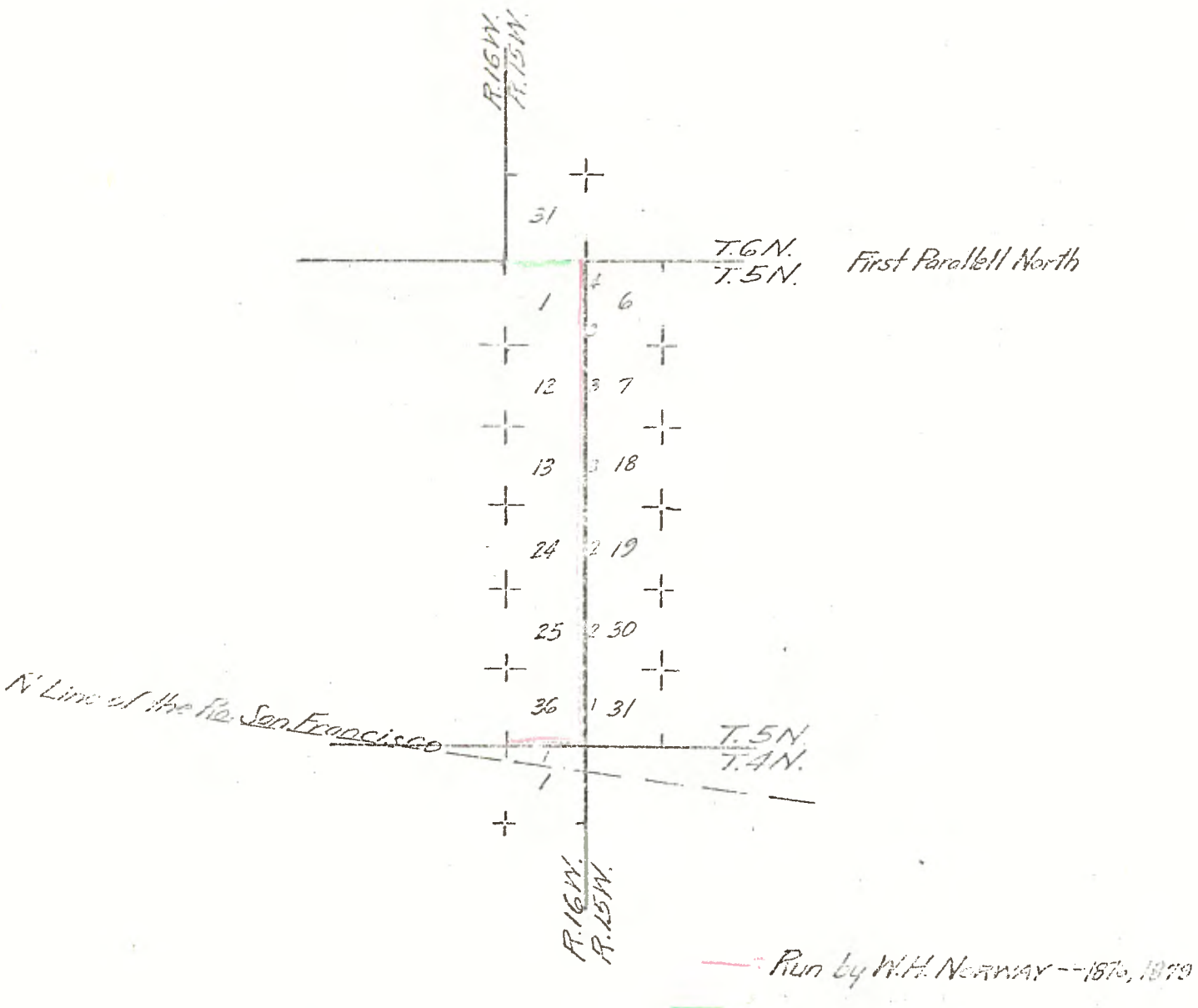

DEPARTMENT OF THE INTERIOR.

U. S. LAND OFFICE.

-----  
Office of Public Surveys.

San Francisco, California.

January 27th, 1928.

I, FRANK E. BARKER, Office Cadastral Engineer, do hereby certify that the annexed transcript of field notes of survey of the boundary line between Ranges 15 and 16 West, Township 5 North, San Bernardino Meridian, is a true and literal exemplification of said field notes, as the same remain in this office on file and of record.

*Frank E. Barker*

FRANK E. BARKER,

Office Cadastral Engineer

for California.

-----

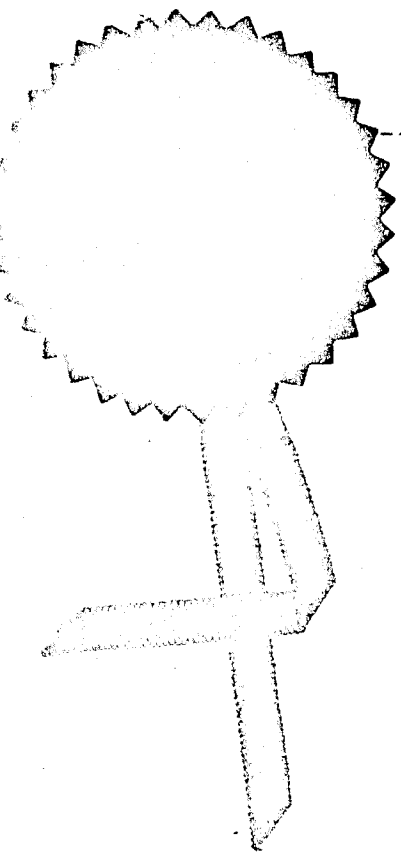

Book 163-30 Survey by W.H.Norway, Deputy Surveyor,  
Contract of Sept.19th,1876.  
Survey commenced Oct.9th,1876.  
Survey completed Nov.28th,1876.

-----  
Township 4 North, Range 16 West, S.B. M.

From the true corner I run East on north boundary of sec.1.

Var.14°40'East.

x x x x x x x x x

80.00 Set a cottonwood post 4 x 4 in. 3½ ft.long, in a large mound of earth, and pits on side hill facing S.E. as instructed for cor. to Townships 4 and 5 North, Ranges 15 and 16 West.

October 14th, 1876.

-----  
Book 128-16 Survey by W.H.Norway, Deputy Surveyor.  
Contract of Oct.10, 1879.

West Boundary T.5 N.,R.15 W.,  
San Bernardino M.

-----  
From the corner to Tps. 4 and 5 N., between Rs.15 and 16 W.

I run

North between sections 31 and 36,

Variation 14°25'East.

Ascend.

40.00 Set post 4 in. dia. 2 ft. in earth, 2 ft. above for ¼ sec.  
cor.

3432

52.00 Top of high spur, bears NE. and SW.

39+27

59.50 Leave same and descend.

80.00 Set post 4 in. square, 1 ft. in earth, 1 ft. above stone mound, 4½ ft. in diameter at base by 2 ft. in height, for corner to sections 25,30,31,36.

Land, mountainous.

Soil, 1st and 2nd rate.

Timber and undergrowth of oak and cedar.

-----

West Boundary T.5 N., R.15 W., San Bernardino M.

West Boundary T.5 N., R.15 W., San Bernardino M.

North between sections 25 and 30.

Variation  $14^{\circ}25'$  East.

Descend.

330 5.00 Cross gulch 20 lks. wide, course SW. and ascend.

1720 20.00 Summit of spur bears SW. and NE. and descend.

30.00 Enter cañada bears SW. and NE.

40.00 Set post 4 in. dia. 1 ft. in earth 1 ft. above stone mound.  
4 ft. in diameter at base by 2 ft. in height for  $\frac{1}{4}$  sec. cor.  
from which bears a

Live oak 30 in. dia. N.  $22^{\circ}$  W. 243 lks dist.

Live oak 20 in. dia. N.  $27^{\circ}$  E. 150 lks. dist.

42.00 A wash in cañada, course S.W.

50.00 Cross same, course S.W.

54.00 Leave cañada bears SW. and NE. and ascend.

80.00 Set post 4 in. square, 1 ft. in earth 1 ft. above stone mound  
 $4\frac{1}{2}$  ft. in diameter at base by 2 ft. in height and dug pits  
24 x 18 x 12, 8 lks. distant at 4 angles for corner to  
sections 24, 25, 19, 30;  
from which bears a

Live oak 36 in. dia. S.  $50^{\circ}$  E. 177 lks. dist.

Land, mountainous.

Soil, 1st and 2nd rate.

Timber and undergrowth of oak and cedar.

-----  
North between sections 19 and 24.

Variation  $14^{\circ}25'$  East.

Descend .

32.75 Cross gulch 25 lks wide, course S.E. and ascend.

40.00 Set post 4 in. dia. 1 ft. in earth 1 ft. above stone mound  
4 ft. in diameter at base by 2 ft. in height for  $\frac{1}{4}$  sec. cor.

80.00. Set stone 20 x 16 x 10 in stone mound,  $4\frac{1}{2}$  ft. in diameter at  
base by 2 ft. in height for corner to sections 18, 19, 13, 24.

Land, mountainous.

Soil, 2nd rate.

West Boundary T.5 N., R.15 W., San Bernardino M.

Timber and undergrowth of oak and cedar.

-----  
North between sections 13 and 18.

Variation 14°25' East.

Ascend.

- 40.00 Set post 4 in dia. 1 ft. in earth, 1 ft. above stone mound,  
4 ft. in diameter at base by 2 ft. in height, for  $\frac{1}{4}$  sec. cor
- 80.00 Set stone 24 x 16 x 8 in stone mound 4 $\frac{1}{2}$  ft. in diameter at  
base, by 2 ft. in height for cor. to sections 12,13,7,18.

Land, mountainous.

Soil, 2nd rate.

Timber and undergrowth of oak and cedar.

-----  
North between sections 7 and 12.

Variation 14°25' East.

Ascend.

- 40.00 Set stone 16 x 10 x 8 in stone mound 4 ft. in diameter at base  
by 2 ft. in height for  $\frac{1}{4}$  sec. cor.
- 4356 66.00 Summit of spur, bears NE. and SW. and descend.
- 80.00 Set stone 24 x 20 x 6 in stone mound, 4 $\frac{1}{2}$  ft. in diameter  
at base by 2 ft. in height for corner to sections 1,12,6 and 7

Land, mountainous.

Soil, 1st and 2nd rate.

Timber and undergrowth of oak and cedar.

-----  
North between sections 1 and 6.

Variation 14°25' East.

Descend.

- 40.00 Set post 4 in. dia. 1 ft. in earth, 1 ft. above stone mound,  
4 ft. in diameter at base, by 2 ft. in height for  $\frac{1}{4}$  sec. cor.

West Boundary T.5 N., R.15 West, San Bernardino M.

- 68.00 Enter Cañada of San Francisco, bears N.E. and S.W.  
70.50 A wash 100 lks. wide, course S.W.  
72.50 Cross road bears N.E. and S.W.  
74.00 Leave cañada bears N.E. and S.W. and ascend.  
90.00 Cross ravine 50 lks. wide, course S.W.  
and continue ascent.  
103.20 Intersect 1st Standard line North <sup>10830</sup> 1.65 chs. West of Standard  
corner to sections 31 and 32 of Tp.6 N., R.15 W. and set  
post 4 in.square, 1 ft. in earth, 1 ft. above stone mound,  
4½ ft. in diameter at base by 2 ft. in height for closing  
corner to Tps. 5 N., Rs.15 and 16 W., S.B.M.

Land, mountainous.

Soil, 1st and 2nd rate.

Timber and undergrowth of oak and cedar.

Dec.20th,1879.

---

Book 163-22 Survey by W.R.Norris, Deputy Surveyor,  
Contract of Oct.10"1879.  
Survey commenced Oct.28"1879.  
Survey completed Jan,2d,1880.

1st St'd N. on S.B. of T.6 N., R.15 W.,  
S. B. M.

---

West on a true line on S.B. of sec.31.

Var.14°25'E.

x x x x x x x x x x

- 80.00 Set post 4 in.sq. 1 ft. in earth, 1 ft. above stone mound,  
4½ ft. in dia. at base by 2 ft. in height for st'd cor. to  
Tps. 6 N., Rs.15 & 16 W., S.B.M.

Dec.19, 1879.