

HOMESTEAD ENTRY SURVEY NO. 84

T. 2 N., R. 13 W., S.B.M.

I N D E X

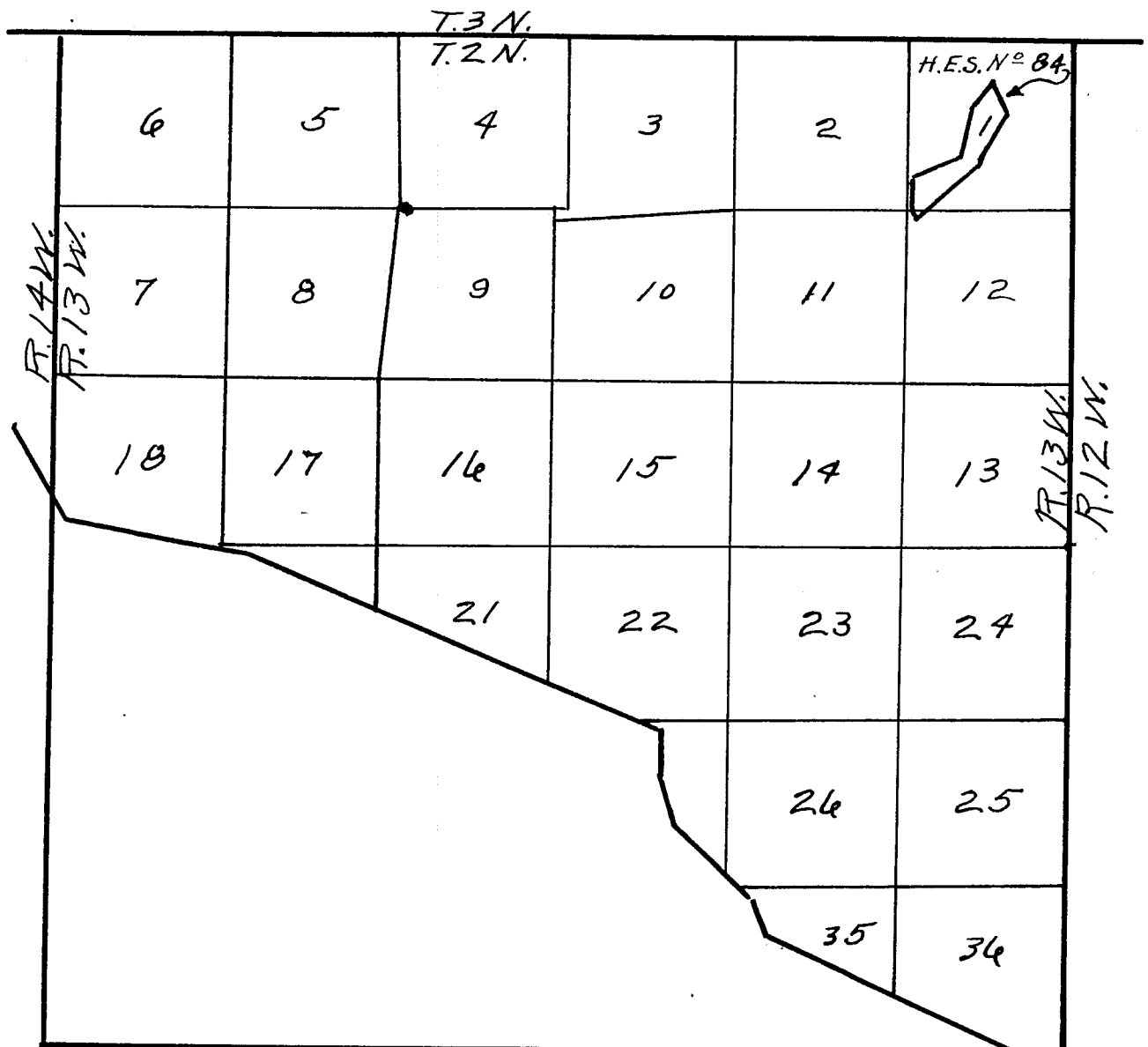

DEPARTMENT OF THE INTERIOR
GENERAL LAND OFFICE

-0-

Public Survey Office

San Francisco, California.

February 1, 1929.

I, FRANK E. BARKER, Office Cadastral Engineer,
do hereby certify that the annexed transcript of
field notes of survey of Homestead Entry No. 84,
Angeles National Forest, Sections 1 and 12, Township
2 North, Range 13 West, San Bernardino Meridian,
California, is a true and literal exemplification
of said field notes as they remain on file and of
record in this office.

Frank E. Barker (Signed)

Office Cadastral Engineer for
California.

U. S. Department of Agriculture
Forest Service

FIELD NOTES
OF
HOMESTEAD ENTRY SURVEY NO. 84
SITUATED IN THE
Angeles NATIONAL FOREST
ADMINISTRATIVE DISTRICT NO. 5

in

Section 1 & 12 Unsurveyed, Township 2 N., Range 13 W.
of the
San Bernardino Base & Meridian
California.

Survey executed by Percy L. Day, Forest Examiner, Forest Service
Under special instructions dated November 1 1913
Survey commenced November 26, 1913
Survey completed November 29, 1913
Under Acts of June 11, 1906, March 4, 1913

Applicant for listing Homer A. Hansen,
Residence, Sunland, California
Application No. 173, dated June 28, 1910
List No. 5-491, dated August 30, 1910
Applicant for survey Homer A. Hansen,
Residence Sunland, California.
H.E. No. 011812, dated February 6, 1911
Land district Los Angeles, California.

OATH OF ASSISTANTS

We hereby certify that we assisted Percy L. Day, Forest Examiner, in surveying all those parts or portions of Homestead Entry Survey No. 84, in unsurveyed Sections 1 and 12 Township 2 N., Range 13 W., of the San Bernardino meridian, State of California, which are represented in the following field notes as having been surveyed by him and under his direction; and that said survey has been in all respects, to the best of our knowledge and belief, well and faithfully surveyed, and the corner monuments established, according to the instructions furnished by the United States Surveyor General for California.

N.B.

There being no person qualified to administer an oath, within 10 miles of this survey, the oaths of assistants were taken by the surveyor. Percy L. Day.

Wm. V. Mendenhall, Chairman.

F.J. Charlesworth, Chairman.

Subscribed and sworn to before me this 29th day of November, 1913.
Percy L. Day,

Forest Examiner,

Forest Service.

OATH OF SURVEYOR.

I, Percy L. Day, Forest Examiner, do solemnly swear that, in strict conformity with the special instructions of the United States Surveyor General for California, dated November 1, 1913, and the laws of the United States, I have well, faithfully, and truly, in my own proper person, surveyed a tract of land embraced in list, No. 5-491, dated August 30, 1910, for patent, under the Act of June 11, 1906, the same to be known as Homestead Entry Survey No. 84, situated within the Angeles National Forest, in unsurveyed Sections 1 and 12, Township 2 N., Range 13 W., and of the San Bernardino meridian, California, and the related retracements and resurveys and section subdivisions, which are represented in the following field notes as having been surveyed by me; and I further solemnly swear that all the corners of said survey have been established and perpetuated in strict accordance with the stated special instructions, and that the following are the original field notes of such survey.

Percy L. Day

Forest Examiner,
Forest Service.

Subscribed and sworn to before me this 6th day of Jan. 1914,

E. A. Croghan,

Notary Public, in and for the County
of San Diego, State of California.

My commission expires
June 11, 1917.

HOMESTEAD ENTRY SURVEY NO. 54

Angeles NATIONAL FOREST

Chains

STATE OF CALIFORNIA.

Applicant for listing, Homer A. Hansen; application No. 173, dated June 25, 1910; list No. 5-491, dated August 30, 1910. Special Instructions dated November 1, 1913 for Homestead Entry Survey No. 54, situated in the Angeles National Forest, in unsurveyed sections 1 and 12, Township 2 North; Range 13 West, San Bernardino Base and Meridian, listed under the Act of June 11, 1906.

Survey commenced November 26, 1913, and executed with a W. & L. E. Gurley light mountain transit, No. 111045, with Burts' solar attachment, the horizontal limb having two double verniers placed opposite to each other and reading to single minutes of arc, which is also the least count of the verniers of the latitude and declination arcs.

The instrument was examined, tested and all necessary adjustments of the levels, line of collimation, solar attachments and stadia interval were made.

The distances were measured with a 100 link steel tape and a Philadelphia stadia rod with double targets, the rod being graduated to read in feet and hundredths and the target verniers to thousandths.

Preliminary to the survey, I adjust the stadia interval of the transit to read 1:132; then to test the solar apparatus, by comparing its indications, resulting from solar observations made during p.m. and a.m. hours, with the meridian determined by Polaris, I proceed as follows: November 26, 1913, at corner No. 1 of this Entry Survey, in unsurveyed sec. 1, T. 2 N. R. 13 W. S. B. M. in lat. $34^{\circ} 17' N.$, long, $115^{\circ} 12' W.$ I set off $20^{\circ} 57' S.$ on the decl. arc, and at 11 h. 47 m. 16 s., A.M. 1 m.t., observe the sun on the meridian. The resulting latitude is $34^{\circ} 17'.$

At 2h. 5m. p.m., 1 m.t. I set off $34^{\circ} 17'$ on the lat. arc, and $20^{\circ} 58' S.$ on the decl. arc and determine a meridian with the solar, marking a point in the line thereof by a nail driven in a stake, firmly set

4 chs. north of the corner.

On the same date at 4h. 54m. p.m., 1 m.t., I observe Polaris in accordance with instructions and mark the line thus determined by a nail in a stake firmly set 4 chs. North of the corner.

Astron. time U.C. of Polaris,	9h. 6.4m.
Astron. time of observation, Nov. 26, 1913,	<u>4h. 54.0m.</u>
Hour angle of Polaris at observation	4h. 14.4m.
Azimuth of Polaris at observation	1° 15.7'

----- November 26, 1913 -----

November 27, 1913; at 8h.0m. a.m., 1 m.t., I lay off the azimuth of Polaris 1°16' to the West and mark the meridian by a nail driven in the stake set November 26, on which the meridian falls .5 inches east of the meridian determined by the solar observation of November 26, 1913.

At 9h.17m. a.m., 1 m.t., I set off 34°17' on the lat. arc. and 21°05'S. on the decl. arc. and determine a meridian with the solar marking a point in the line thereof by a nail in the stake already set, on which the meridian falls .7 inches East of the meridian established by the Polaris observation of November 26.

The solar apparatus by p.m. and a.m. observations defines positions for meridian 36" West and 50" East of the meridian determined on Polaris; I therefore conclude that the adjustments of the instrument are satisfactory.

The Magnetic bearing of said true meridian at 9h. 17m. a.m. is N.15°00' W., the angle thus determined gives the mag. decl. N. 15°00' E.

Commencing at Cor. No. 1, of this entry survey, which is a cypress post, 3 ins. sq., 18 ins. above ground, marked and witnessed as described by the Forest Service. I destroy all trace of this listing corner and in the same place set a granite stone 24x9x6 ins. 14 ins. in the ground for corner No. 1 marked 1 N E S 54 on the NE face, and raise a mound of stone 2 ft. base, 1½ ft. high NE. of corner; from which The corner of secs. 1, 2, 11 and 12, T. 2 N. R.13 W., which is a pine

Chains

post, 4 ins. sq., 14 ins. above ground, marked and witnessed as described by the Surveyor General, bears S. 12°14' W., 3.80 chs. by direct bearing. A live oak 30 ins. dia. bears S. 22°15' W. 124 lks. dist. marked 1 N E S 84 B T.

Thence I run

N. 2°05' E., ascend across rolling land.

5.30 Top of low spur, bears E. and W. descend.

9.27 To cor. No. 2, which is a sycamore post, 3 ins. sq., 16 ins. above ground, marked and witnessed as described by the Forest Service. I destroy all trace of this old listing corner and in its place set a granite stone, 24 x 10 x 6 ins. 14 ins. in the ground for cor. No. 2, marked 2 H E S 84 on the E. face and raise a mound of stone 2 ft. base, 1½ ft. high E. of corner; from which a live oak 30 ins. dia. bears S. 7°30' W. 126 lks. dist. marked, 2 H E S 84 B T.

A live oak 12 ins. dia. bears N. 66°39' W. 72 lks. dist. marked, 2 H E S 84 B T.

Thence I run

N 71°06' E., ascend steep slope, through dense brush.

10.50 Top of spur, bears NW. and SE., descend

12.76 Descend abruptly.

15.26 Dry ravine, 5 lks. wide, course S. 69°E., ascend.

19.76 Top of ascent; enter level brushy mesa, bears S 69°E. and N 69°W.

23.76 Leave mesa, bears N 70°W. and S. 70°E.; descend steep slope

25.24 To cor. No. 3, which is a sycamore post 3 ins. sq. 20 ins. above ground, marked and witnessed as described by The Forest Service. I destroy all trace of this listing corner, and in the same place set a granite stone, 20x8x6 ins., 12 ins. in the ground for cor. No. 3,

Chains marked 3 H E S 84, on the E. face, and raise a mound of stone 2 ft. base, $1\frac{1}{2}$ ft. high E. of corner, from which:
 A live oak 24 ins. dia. N $69^{\circ}30'$ E. 60 lks. dist.
 marked 3 H E S 84 B T.
 A live oak 10 ins. dia. bears S. $32^{\circ}12'$ E. 74 lks. dist.
 marked 3 H E S 84 B T.
 A live oak 12 ins. dia. bears N. $53^{\circ}40'$ W. 28 lks. dist.
 marked 3 H E S 84 B T.

November 27, 1913.

November 28, 1913; at 8h. 15m. a.m. 1 m.t. I set off
 $34^{\circ}17'$ on the lat. arc and $21^{\circ}14'$ S. on the decl. arc.
 and determine a meridian at cor. No. 3 of this Entry Survey

Thence I run

N $26^{\circ}13'$ E., ascend through dense brush.

14.50 Summit of spur, bears N 80° W. and S. 80° E., descend
 27.57 To cor. No. 4, which is a sycamore post, 3 ins. sq. 24 ins.
 above ground, marked and witnessed as described by
 the Forest Service, I destroy all trace of this list-
 ing corner, and in the same place set a granite stone
 $24 \times 12 \times 5$ ins., 14 ins. in the ground, for cor. No. 4.,
 marked 4 H E S 84 on the E. face, and raise a mound of
 stone 2 ft. base, $1\frac{1}{2}$ ft. high E. of corner; from which
 A granite boulder, in place, $2 \times 8 \times 10$ ft. above ground,
 bears S. $3^{\circ}24'$ W. 10 lks. dist. marked, 4 H E S 84 B.R.
 No other witness objects available. Pits impracticable.
 At this corner I set off $21^{\circ}18'$ S. on the decl. arc. and at
 11h. 47m. 56s. a.m., 1 m.t. I observe the sun on the
 meridian, obtaining a reading on the latitude arc of
 $34^{\circ}18'$

Chains Thence I run
 N. $36^{\circ} 41'$ E. along E. base of rocky cliffs
 17.85 Descend steep slope.
 18.76 To cor. No. 5, which is a sycamore post, 3 ins. sq., 20 ins. above ground, marked and witnessed as described by the Forest Service.

I destroy all trace of this listing corner, and in the same place, set a granite stone, 20 x 8 x 6 ins. 12 ins. in the ground, for cor. No. 5 marked 5 H E S 84, on the SE. face and raise a mound of stone 2 ft. base, $1\frac{1}{2}$ ft. high SE. of corner, from which a live oak 16 ins. dia. bears N. $59^{\circ} 00'$ E. 25 lks. dist. marked 5 H E S 84 B T.

A live oak 24 ins. dia. bears N. $75^{\circ} 30'$ W. 130 lks. dist. marked 5 H E S 84 B T.

 Thence I run

S. $11^{\circ} 0'$ E., descend steep, rocky cliff.

1.00 Cross Tejunga Creek, 25 lks. wide, course S. 45° W.

4.50 Base of steep slope; ascend abruptly.

5.09 Top of slope, ascend gently rolling flat.

9.34 To cor. No. 6, which is a sycamore post, 3 ins. sq., 12 ins. above ground, marked and witnessed as described by the Forest Service.

I destroy all trace of this listing corner and in the same place set a granite stone 20 x 8 x 5 ins., 12 ins. in the ground, in a mound of stone, for cor. No. 6, marked 6 H E S 84, on the W. face, and raise a mound of stone, 2 ft. base, $1\frac{1}{2}$ ft. high, West of corner. Pits impracticable. No witness objects available.

 Thence I run

S. $19^{\circ} 04'$ E.; ascend gentle slope.

- Chains
 3.04 Top of spur, bears N. 60° E. and S. 60° W., descend.
 10.50 Ascend point of spur, bears S. 55° E. and N. 55° W.
 11.33 To cor. No. 7, which is a sycamore post, 3 ins. sq., 16 ins. above ground, marked and witnessed as described by the Forest Service. I destroy all trace of this listing corner, and in its place set a granite stone, 26x8x6 ins., 16 ins. in the ground, in a mound of stone, for cor. No. 7, marked 7 H E S 84, on the W. face and raise a mound of stone 2 ft. base, 1½ ft. high west of cor. Pits impracticable. No witness object available.

November 28, 1913.

November 29, 1913; at 8h. 20m., 1 m. t., I set off 34° 18' on the lat. arc, and 21° 26' S. on the decl. arc and determine a meridian at cor. No. 7 of this Entry Survey.

Thence I run

- S. 35° 09' W., descend dense brush.
 14.50 Dry wash, 15 lks. wide, course N. 75° W., descend.
 20.68 Top of spur, bears N. 55° W. and S. 55° E., descend.
 25.72 To cor. No. 8, which is an oak post, 3 ins. sq. 24 ins. above ground, marked and witnessed as described by the Forest Service.
 I destroy all trace of this listing corner and in the same place set a granite stone, 24x12x10 ins., 14 ins. in the ground, for cor. No. 8, marked 8 H E S 84 on the W. face, and raise a mound of stone 2 ft. base, 1½ ft. high, West of corner; from which a live oak 24 ins. dia. bears N. 48° E. 90 lks. dist. marked 8 H E S 84 B T.
 A spruce 30 ins. dia. bears S. 11° 30' E. 50 lks. dist. marked 8 H E S 84 B T.
 A live oak 20 ins. dia. bears N. 81° 55' W. 62 lks. dist. marked 8 H E S 84 B T.
 The NW corner of Entryman's house bears N. 61° 30' W. 3.30 chains
 The NE corner of a house bears N. 47° 00' W. 4.40 chains.
 The SE corner of a log cabin, bears N. 20° 30' W. 5.00 chs.
 The SW corner of a barn bears N. 6° 30' E. 4.00 chs.

Chains

Thence I run

S. $53^{\circ}13'$ W., ascend through dense brush.

4.00 Top of spur, bears N. 15° W. and S. 15° E., descend.

5.75 Cross stream 2 lks. wide, course N. 15° W., ascend.

8.50 Top of spur bears N. 15° W. and S. 15° E., descend.

15.26 To cor. No. 9, which is a sycamore post, 4 ins. sq., 16 ins. above ground, marked and witnessed as described by the Forest Service. I destroy all trace of this listing corner, and in the same place, set a granite stone 20 x 12 x 6 ins. 12 ins. in the ground, for cor. No. 9, marked 9 H E S 54 on the W. face, and raise a mound of stone 2 ft. base, $1\frac{1}{2}$ ft. high, West of corner.

Pits impracticable.

No witness objects available.

At this corner I set off $21^{\circ}29'$ S. on the decl. arc and at 11h.45m.

16 a.m., 1 m.t. observe the sun on the meridian and obtain a

reading on the lat. arc of $34^{\circ}17'$.

Thence I run

S. $59^{\circ}41'$ W., ascend through dense brush.

22.75 To cor. No. 10, which is a sycamore post, 4 ins. sq., 20 ins. above ground, marked and witnessed as described by the Forest Service.

I destroy all trace of this listing corner and in the same place set a granite stone, 22x12x6 ins., 14 ins. in the ground, for cor. No. 10, marked 10 H E S 54 , on the NW. face, and raise a mound of stone, 2 ft. base, $1\frac{1}{2}$ ft. high NW. of corner.

Pits impracticable.

No witness objects available.

Thence I run

N. $53^{\circ}50'$ W. descend slightly.

1.50 Descend steep face of hill, bears N. and S.

2.50 Cross Tejunga Creek, 25 lks. wide, course S. 10° W.

4.25 Road to Sunland, bears S. 15° W. and N. 15° E.

6.70 Ascend point of spur, bears NW. and SE.

7.69 To cor. No. 1, the point of beginning.

November 29, 1913.

Area of Homestead Entry Survey No. 84, 93.76 acres.

IMPROVEMENTS.

The improvements made upon and for the benefits of this Homestead Entry, and belonging to Homer A. Hansen, the entryman herein, consist of

A frame house 24 ft. wide by 36 ft. long, the NW. corner of which bears from cor. No. 8, N. 61° 30' W. 3.30 chains. Course of long sides S. 61° 30' W.

Value \$2000.00

A log house, 14 ft. wide by 22 ft. long, the SE. corner of which bears from cor. No. 8, N. 20° 30' W. 5.00 chains. Course of long sides N. 81° E.

Value \$ 100.00

A barn 14 ft. wide by 24 ft. long, the SW. corner of which bears from cor. No. 8, N. 6°30' E. 4.00 chains. Course of long sides S. 46°30' E.

Value \$ 50.00

In addition to the above buildings, there is a frame house 18 ft. wide by 30 ft. long, owned by Homer A. Hansen, the entryman, the NE. corner of which bears from cor. No. 8, N. 47° W. 4.40 chains.

GENERAL DESCRIPTION

This Homestead Entry occupies the sandy, rocky bed of Tejunga Creek, and the small flats on the hills above the creek bottom.

The flats on the higher elevations are small in extent, being separated by sharp ridges and deep ravines. The small flats in the creek bottom are separated by the stream which crosses the canyon several times during its course across the entry claim.

The soil varies from sandy silt along the stream to red and black loam on the higher flats.

There are a few scattering sycamores, and oak trees along the creek, the balance of the area being covered with dense chaparral.

There are no mining claims or operations in this vicinity and the land embraced in this Entry Survey is strictly non-mineral.

A passable wagon road leads to Sunland, California, the nearest settlement, 10 miles to the SW.

LATITUDES, DEPARTURES AND CLOSING ERRORS.

True Bearing	Distance	Latitudes		Departures	
		N.	S.	E.	W.
N. 2°05' E.	9.27	9.26		.33	
N. 71°06' E.	23.24	8.18		23.68	
N. 26°13' E.	27.57	24.73		12.19	
N. 36°41' E.	18.76	15.05		11.80	
S. 11°00' E.	9.34		9.17	1.78	
S. 19°04' E.	11.33		10.71	3.70	
S. 35°09' W.	25.72		21.04		14.81
S. 53°13' W.	15.26		9.14		12.22
S. 59°41' W.	22.75		11.49		19.63
N. 53°50' W.	7.69	4.54			6.21
Totals	172.93	<u>61.75</u> <u>61.55</u>	61.55	<u>63.08</u> <u>52.87</u>	52.87

Error in Lat. .21 In Dep. .21

Error in Closure = $\frac{172.93}{\sqrt{.21^2 + .21^2}} = 1.552$

Percy L. Day,
Forest Examiner
Forest Service.

APPROVAL

Office of the United States Surveyor General,

San Francisco, California, Feb. 5 1914.

The foregoing field notes of Homestead Entry Survey No. 84 situated in the Angeles National Forest in secs. 1 and 12, unsurveyed, Township 2 North, Range 13 West, San Bernardino Base and Meridian, California, executed by Percy L. Day, Forest Examiner, under his special instructions, dated November 1, 1913, having been critically examined, and the necessary corrections and explanations made, the said field notes, and the surveys they describe, are hereby approved.

(Seal)

E. H. Archer,

U. S. Surveyor General,
for California.