

SURVEY OF THE NORTHERLY LINE  
OF THE  
AZUSA RANCHOS  
BY HENRY HANCOCK.

THESE NOTES COPIED FROM HENRY HANCOCK'S ORIGINAL  
FIELD BOOK NO. 9 LOANED TO THE COUNTY SURVEYOR  
BY THE LA BREA OIL COMPANY, WHOSE OFFICES ARE IN  
THE CALIFORNIA BANK BLDG., LOS ANGELES, CALIFORNIA.

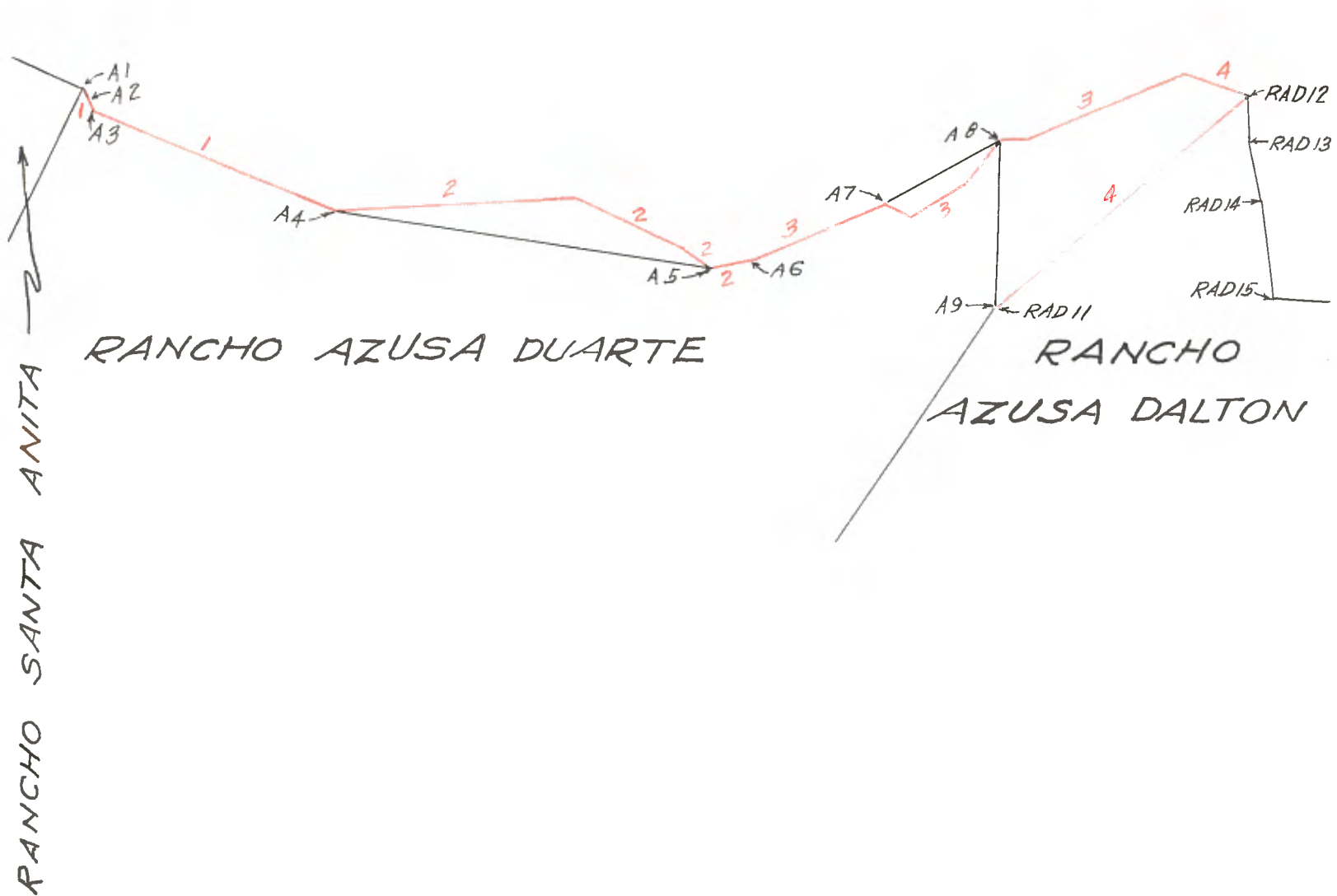

Commencing at N.W. Cor. of Akusa from which a  
sycamore 4" diam. bears N. 75½ W. dist. 31 chs.  
and another, 4" diam. bears N. 59° W. 34 chs.

- 3.15 E. 3.64 Thence I run  
Set Sta. #2 on small tree.
- Thence S. 2° E. through willows along  
left bank of wash.
- .50 Cross stream of water .05 links wide,  
Course S.E.
- 3.50 Set stake for Sta. 3
- Thence S. 68½ E.
- 5.50 Top of bank, course S.E.
- 25.00 Across mouth of Canada, course S.W.  
4 chs. wide and 20 chs. from head of spur to west.
- 35.00
- 42.60 Across dry arroyo 12 links wide  
Course S.W.
- 69.00 S.W. face of spur and opposite to center of  
mining gulchs, some 15 chs. to plain.
- 84.22 To granite rock 18" diam. marked Sta. 4.

Thence S. 89° E.

7.50 To arroyo, course S.W. 12 links wide.

15.00 Across canada, course S.W.

37.00 Canada at head, 1 ch. wide S.W.

49.00 Across head of ravine 2 chs. wide,  
course S.W.

68.00 To brush from which elder 3 in. diam.  
bears N. 46 E. dist. 7.50 chs.

79.00 To rock marked Sta. 6, 20 in. square on  
west bluff of Canada at head course S.W.

Thence S. 68½ E.

5.00 Intersect Canada S.W.

28.31 Oak (W) on east side of line, 32" diam.

33.00 Center of canada 6 chs. from head and  
2 links wide, S.W.

36.00 Leave spur

Thence S. 52½ E.

12 L. brush

Thence N. 75 E.

11.00 To mound of rock on S. base of Mt.

- Thence N.  $68\frac{1}{2}$  E.
- 38.00 Cross arroyo 3 chs. S.
- 45.00 To granite boulder 36 in. high and 30 and 36 chs. from which the old house of Duarte bears S.  $59\frac{1}{2}$  W. (10 chs. per pat.)
- Thence S.  $69\frac{1}{2}$  E.
- 11.00 Station a stake rock mound from which a sycamore 5 in. bears S. 41 E. 71 links dist.
- Thence N. 51 E.
- 19.50 To Sta. 10 a sycamore 6 in. bears N. 71 E. 104 links dist.
- Thence N. 41 E.
- 21.00 To sycamore 13 in. diam. Sta. 11 in center of arroyo 1 ch. wide.
- Thence East
- 5.00 To Sta. 12 a mound of rock on E. side of stand of rocks on S. base of Mt.
- Thence N.  $65\frac{1}{2}$  E.
- 30.00 Enter dry bed of River S.W.
- 45.00 A sycamore 15 in. diam. bears N. 56 W.
- 48.00 N. 86 W. to 2 A --- ?
- 56.00 To Sta. 13 a willow S. 49 W. dist. 54 links md. of rock.

Thence S.  $74\frac{1}{2}$  E.

- 2.50 To stream of water 8 links wide.  
S.W. and pt. of bluff of canon on  
west
- 19.50 To a point about midway of mouth  
canyon on an island in bed of river  
from which a sycamore 14 in.  
diam. bears N.  $70\frac{1}{2}$  E. dist.

23 another 15 in. diam. N. 14 W.

61 links set a post chd. stk

Sta. 14

E. pt. of bluff of canon at mouth  
bears S.S.E.

Thence S.  $46\frac{1}{2}$  W.

- 109.24 To pile of rocks on road Sta. 15

Thence S.  $71\frac{1}{2}$  W.

- 10.00 Pile of rocks near So. end in  
on road

Thence S. 84 W.

- 13.00 To bed of river S.W.

- 24.50 (This last note not decipherable).