

PORTION OF SANTA BARBARA FOREST RESERVE BOUNDARY
 NOW
 ANGELES FOREST RESERVE BOUNDARY

These notes have not as yet been approved by the Surveyor General, and are not to become public records.

Vol. 464: 10-94
 Thorne 1905.

Copied from notes on file in
 U.S. Cadastre Engineer's
 Office, Glendale, California.
 Copied and checked by A.C.
 Johnson and A.J. Bartlett,
 March, 1934.

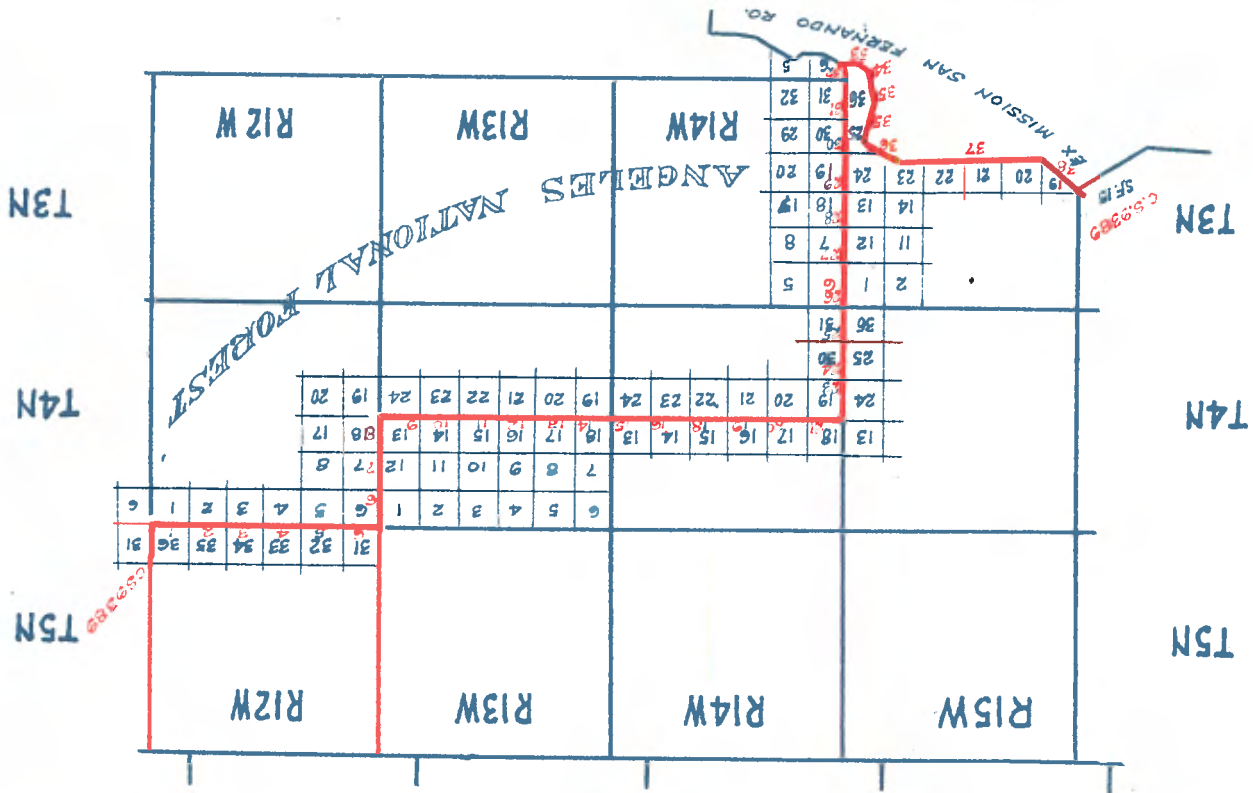

SARVA BARBARA FOREST BOUNDARY

101.464:10-94 of sec. South boundary T.5 N., R. 12 W.

At the corner of Twp. 4 and 5 N., R. 11 and 12 W. at 2 P.M. I set off 1/4 sec. on the 1st. sec. and 1/4 sec. on 2nd. sec. and determine a meridian with the solar

gong. I run West on a random line between Secs. 1 and 36 1/4 sec. corner bears S. 67 1/2° E. which is a cedar post 2 1/2 x 5" square, 18 ft. above mound of stone, 2 ft. base, 1 ft. high firmly set, marked and witnessed. I mark bearing trees as follows:

A cedar 8" diam., bears S. 85° 30' W. 44 lks. dist., marked 1/4 S.E.T. A pinon pine 1 1/2" diam. bears N. 70° 10' W. 300 lks. dist., marked 1/4 S.H.T. Set instrument over 1/4 sec. corner and continue random line west.

Intersect corner of Secs. 1, 2, 35, 36 which is a cedar post 1 1/2" square, 2' above mound of stone, 2 ft. base, 1 ft. high firmly set, marked and witnessed. I then return to corner of T. 4 and 5 N., R. 11 and 12 W., Thence I run

S. 89° 06' on a true line between Secs. 1 and 36 over Grand M. slope, through scattering pine and dense brush ascend S.E. slope

Small drain course S.E. 14.00
Side Hill drain course S. 19.52
Side Hill drain course S. 20.75
Dry drain course S.W. 26.00
Side Hill drain course S.E. 27.00

1/4 sec. corner previously described 40.58
Thence I run West on a true line 44.00
Descend N. slope 48.00
Having 150 lks. side, 20 ft. deep, course N. 20° W. 49.00
Spruce bears N. and S. 51.00
BRAIN course N.E. ascend S.E. slope 54.00
Top of spruce bears N.E. and S.W. 55.00
Ascend steep N.E. slope 61.50
Top of ridge bears N. and S. 66.45
Descend S.E. slope 71.00
BRAIN course S.W. 73.00
BRAIN course S.E. ascend steep S.E. slope 81.07
Corner of Secs. 1, 2, 35 and 36 previously described

Land mountainous Soil rich pine Timber, scattering pinon pine, dense cedar, live oak, Gambelita and chinise brush. Formation - Granite.

March 9, 1905.

March 10. At the corner of Secs. 1, 2, 35 and 36 at 10 A.M. I set off 1/4 sec. on 1st. sec. and 1/4 sec. on 2nd. sec. and determine a meridian with the solar

Thence I run West on a random line between Secs. 2 and 35. 1/4 sec. corner bears N. 2 lks. dist., which is a cedar post 3 x 5" square, 2' above mound of stone, 2 ft. base, 1 ft. high firmly set, marked and witnessed. I mark bearing trees as follows:

SANTA BARBARA FOREST BOUNDARY

<p>A pinion pine, 16" diam. bears S. 31°25' E. 65 lks. dist., marked 1/4 S.H.T. I set instrument over 1/4 Sec. corner and continue random line west.</p>	78.69
<p>Corner of Secs. 34 and 35, T. 5 N., R. 12 W., bears S. 2 lks. dist., which is a cedar post 3" square, 3' above ground properly marked. I raise mound of stone 3 ft. base, 1 ft. high around post; dig pit 24x34x12" N.E. and N.W. of post 4 ft. distant. I then return to corner of Secs. 1, 2, 35 and 36 Thence I run N. 29°25' W. on a true line between Secs. 2 and 35 Ascend S.E. slope through cedar brush</p>	.06
<p>Set from U.S. Forest Reserve Hdq. Post #117 30 inches in ground; raise mound of earth and stone 4 ft. base, 1 ft. high around post, marked No. 117 on S. side of cap 1905 on N. side of rim of cap Reserve in N.E. and N.W. quadrants also marked Reserve in N.E. and N.W. quadrants</p>	
<p>T. 5 N., S. 36 W.C. in N.E. quadrant N. 12 W. S. 1 in S.E. quadrant T. 4 N. S. 2 in S.W. quadrant S. 35 in N.W. quadrant with 1 notch on E. and S. notches on W. edges of rim of cap</p>	
<p>Descend S.W. slope Drain, course S.K. Ascend S.K. slope Top of ridge bears N. 30° W. and S. 30° E. Drain, course S.W. Thence over steep rocky S.W. slope Spur bears N. and S. Drain, course S.K. (200' descent) Ascend steep S.W. slope Change to gradual S.K. slope. At this point I set off 400' S. on decl. arc and at 1/4 sec. observe the sun on the meridian. The resulting int. is 49°25' N. which is about the proper latitude.</p>	
<p>Change to steep S. slope Top of mountain 500 feet above sec. corner. Descend steep rocky W. slope. 1/4 sec. corner previously described. Thence I run S. 89°55' W. on a true line Side hill drain, course S. Drain, course S.W. Top of small spur bears N.E. and S.W. Descend steep W. slope of mountain Enter nearly level land bears N. and S. Dry wash, course N. Cor. of Secs. 34 and 35, T. 5 N., R. 12 W. previously described Land mountainous Soil 4th rate Timber, scattering pinon pine, cedar, manzanita, chamise and ocotilla brush. formation - rocky.</p>	
<p>West on a random line between Secs. 3 and 34 Interest corner of Secs. 2 and 3, T. 4 N., R. 12 W., which is a granite stone 6x6x5" above ground firmly set, marked and witnessed 1/4 Sec. corner bears N. 2 lks. dist., which is a pine post 4" square, 1 ft. above mound, 3 ft. base, 1 ft. high, firmly</p>	<p>2.20 40.83</p>

At the corner of Secs. 33 and 34, S. 16 T. 12 N., R. 12 E. at 10 A.M. I set off 34-25, N. on 1st. etc. and 34-26, S. on 2nd. etc. and determining a meridian with the solar gnomon on random line along S. 16 T. Section 33

March 10, 1905

Set, marked and witnessed. Set instrument over 1/4 sec. corner and continue random line west. Corner of Secs. 33 and 34, bears N. 16 lks. dist., which is a square hollow iron post 4 1/2 square filled with cement, 1 ft. above mound of stone, 4 ft. base, 1 ft. high, firmly set, marked and witnessed, marked in inked letters T 5 N. S. 34 on N.E. face S.G.P.N. 43 R. 12 S. 3 on S.E. face T 4 N. S. 4 on S.W. face S. 33 on N.W. face I then return to the corner of Secs. 34 and 35 Thence I run N. 89-58' W. on a true line between Secs. 3 and 34 over level land, through sage brush. Set iron U.S. Forest marker S.D. Post #112, 30 inches in ground; true mound of earth, 4 ft. base, 1 ft. high, ground post, marked No. 112 on S. side of cap 1904 on S. side of cap on the corner in N.E. and N.W. quadrants also marked; T. 5 N., S. 35 W.G. in N.E. quadrant N. 12 W. S. 34 in N.W. quadrant with 2 notches on N. and 4 notches on N. edge of rim of cap. Corner of Secs. 2 and 3, T. 4 N., R. 12 W., previously described. Dry wash, course N. Leave wash, course N. Ascend E. slope through scrub cedar under abandoned field bears N. and S. Having 25 lks. wide, 5 ft. deep, course N. and K. Cedar along banks. Leave old field. Ascend gradual S.E. slope. Drain, course N.E. Small drain, course N.E. Under old abandoned field 33-25 Thence I run 30 ft. deep. N. 89-46' W. on a true line. Descend steep N. slope into ravine Bottom of ravine, course N.E. West bank of ravine Top of mountain 100 lks. S. of the summit, 500 ft. above sea. corner. Thence along S. slope Change to steep N.W. slope Change to N.E. slope Change to steep N. slope Small drain, course N.W. Cor. of Secs. 33 and 34, S.G.P.N. No. 43 previously described Land mountains Hill 4th rate Timber, consisting Pinon pine, oak, manzanita, cedar and chamise brush.

BANTA BARBARA FOREST BOUNDARY

80.24
80.24
80.00
73.00
68.50
64.50
56.50
43.50
42.80
40.83
33.25
31.05
30.30
24.75
14.10
9.10
6.50
2.60
2.20
06
80.24

BANTA BARBARA FOREST BOUNDARY

1.64	Intersect corner of sections 3 and 4, T. 4 N., R. 12 W., which is a granite stone 6x5 inches above ground firmly set, marked and witnessed.
39.13	1/4 Sec. corner bears N. 137 lks. dist., which is a cedar post 2 1/2 inches by 4 inches, 18 inches above mound of stone, marked 1/4 S. on N. and S.G.T.R. on S. face, firmly set, marked and witnessed over 1/4 Sec. corner and containing random line
78.25	Corner of Secs. 32 and 33 bears N. 20.0 lks. dist., which is a cedar post 5 inches square, 2 ft. above mound of stone, 3 ft. base, 1 1/2 ft. high firmly set and marked T. 5 N. N. 33 on N.E. face S.G.T.R. N. 12 N. S. 4 on S.E. face T. 4 N. S. 5 on S.W. face S. 32 on N.W. face with 4 notches on E. and E notches on W. edge and witnessed I then return to the corner of Secs. 33 and 34 Thence I run N. 66.00' W. on a true line along S. bdy. of Sec. 33 over W. slope Corner of Secs. 3 and 4, T. 4 N., R. 12 W. Enter leveling, 50 lks. wide, 20 ft. deep, course from S.E. to W. Leave leveling, course N.W., then over gradual N.W. slope Drain, course N.E. Ascend steep N.E. slope Side Hill drain, course N.E. Side Hill drain, course N.E. Side Hill drain, course N.E. Side Hill drain, course N.E. Side Hill drain, course N.E. Side Hill drain, course N.E. 1/4 Sec. corner previously described. Thence I run North 89.43' West on a true line Top of ridge bears N. and S. 500 ft above Sec. corner At this point I set off 232' S. on decl. line and at 1209m I.M.S. observe the sun on the meridian. The resulting latitude is 34.28' N. which is about the proper latitude. Descend steep W. slope Drain, course N.W. Thence over N.E. slope Descend N.W. slope Same drain at 49.00 chains. Course S.E. Corner of Secs. 32 and 33 previously described. Land measurements Soil 4th rate Timber, scattering pinon pine, live oak, scrub cedar, and ohonake brush. Formation - Granite.
43.25	North 89.43' West on a true line Top of ridge bears N. and S. 500 ft above Sec. corner At this point I set off 232' S. on decl. line and at 1209m I.M.S. observe the sun on the meridian. The resulting latitude is 34.28' N. which is about the proper latitude. Descend steep W. slope Drain, course N.W. Thence over N.E. slope Descend N.W. slope Same drain at 49.00 chains. Course S.E. Corner of Secs. 32 and 33 previously described. Land measurements Soil 4th rate Timber, scattering pinon pine, live oak, scrub cedar, and ohonake brush. Formation - Granite.
43.87	West on a random line along S. bdy of Sec. 32. Cor. of Secs. 4 and 5, T. 4 N., R. 12 W. bears S. 4 lks. dist., which is a granite stone 6x5 inches above ground, firmly set, marked and witnessed. 1/4 Sec. corner bears 37 lks. dist., which is a cedar post 2 inches square, 2 ft. above mound of stone, 3 ft. base, 1 1/2 ft. high, firmly set and marked - 1/4 S. on N. and S.G.T.R. on S. face and witnessed. Not instrument over 1/4 Sec. corner and containing random line West.

BARTY BARBARA FOREST BOUNDARY

84.59	Cor. of sec. 31 and 32 bears N. 61 lks. dist., which is a cedar post 4 inches square, 2 ft. above mound of stone and earth, 3 ft. base, 1 1/2 ft. high firmly set and marked; 1. 5 N., S. 32 on N.E. face S.O.P.R. R. 12 W. S. 5 on S.E. face 1. 4 N., S. 6 on S.W. face E. 31 on N.W. face, 5 notches on K. and 1 notch on W. face. I then return to the corner of Secs. 32 and 33 through I run S. 89° 31' W. on a true line along S. bdy of Sec. 32, over gradual W. slope through scrub cedar brush. Get from U.S. Forest Reserve Bdy. post #119, 20 inches in the ground; raised a mound of stone 5 ft. base, 2 ft. high around post marked No. 119 on E. side of cap 1905 on E. side of cap on rim RESERVE in N.E. and N.W. quadrants, also marked 1. 5 N., S. 33 W.C. in N.E. quadrant N. 12 W., S. 32 in N.W. quadrant with 4 notches on E. and 2 notches on W. edges of rim of cap. Cor. of Secs. 4 and 5, T. 4 N., R. 12 W., bears S. 1 lk. Drain, course S.W. Ascend gradual S.E. slope Drain, course S.W. Change to S.W. slope Drain, course S.W. 22.00 Drain, course S.W. 25.20 Change to gradual W. slope 38.00 1/4 Sec. corner previously described 43.87
48.41	N. 29° 08' W. on a true line Get from U.S. Forest Reserve Boundary Post #120, 30 inches in the ground; raised mound of earth and stone, 4 ft. base, 1 ft. high around post and dig pits 30x30x12 inches N. and S. of post, 8 ft. distant, marked No. 120 on south side of cap 1905 on E. side of cap on rim Reserve in N.E. and N.W. quadrants Road bears N. 20° W. and S. 20° E. Wash 200 lks. side, course N.W. Ascend steep E. slope Top of mountain ridge bears N. and S. Descend steep W. slope, change to gradual W. slope Corner of Secs. 31 and 32 previously described Land mountainous Soil 4th rate Timber, scattering pine and spruce along washes; cedar and manzanita brush
40.08	West on random line along S. bdy. of sec. 31 1/4 Sec. corner bears S. 23 lks. dist., which is a cedar post 4 inches square, 1 ft. above mound of stone 3 ft. base, 1 1/2 ft. high firmly set and marked 1/4 Sec. corner and witness S. face and witness Get instrument over 1/4 Sec. corner and continue random line west. Intersect the corner of Twp. 4 and 5 N., R. 12 and 13 W., which is a hollow iron post, filled with cement, 4 inches square, 1 ft. above mound of stone, 5 ft. base, 1 1/2 ft. high, firmly set and marked;
80.80	

SANTA BARBARA FOREST BOUNDARY

1. 5 N. S. 31 on N.K. face
 S.G.P.M. 42 R. 12 W. S. 6 on S.E. face
 1. 4 N. S. 1 on S.W. face
 N. 13 W. S. 36 on N.K. face and witnessed;
 I then return to the corner of Secs. 31 and 32
 Thence I run
 S. 89°40' W. on a true line along S. bdy. of Sec. 31, over
 level land, through scattering cedar brush.
 Set iron pin. Next corner boundary post. No. 121, 30 inches
 in the ground; raised mound of stone and earth, 4 ft. base,
 1 ft. high around post and 4 ft. dia. 36x36x12 inches E. and W.
 of post, 8 ft. dist., marked
 No. 121 on S. side of cap
 1905 on S. side of cap on rim
 Residue in N.E. and N.W. quadrants also marked
 1. 5 N. S. 32 W.O. in N.E. quadrant
 R. 12 W. S. 5 in S.E. quadrant
 1. 4 N. S. 6 in S.W. quadrant
 S. 31 in N.W. quadrant with 5 notches
 on E. and I notch on W. edges of rim of cap.
 Dam road bears N.K. and S.W.
 White fence bears N.W. and S.E.
 Drain, course N.W.
 Agent house bears S. 161 lks. distant
 1/4 Sec. corner previously described.
 Thence I run
 West on a true line crossing wire fence bearing N. 81° 4 W.
 44.50
 Thence along private wagon road
 Agent house bears S. 500 lks. distant
 56.80
 80.80
 Land, level
 Corner of Twp. 4 and 5 N., R. 12 and 13 W. previously described.
 Soil 3rd rate

March 14, 1905.

March 15!
 At the corner of Twp. 4 and 5 N., R. 12 and 13 W. bdy. post No. 42
 S.G.P.M. at 9 A.M. 1 m. 4. I set off 300 ft. N. on Int. arc and
 Soil: S. on decl. arc and determine a meridian with the solar.
 Thence I run
 S. on random line between Secs. 1 and 6.
 1/4 Sec. corner bears N. 34 lks. distant, which is a cedar post
 3 inches square, 1 ft. above mound of stone, 4 ft. base, 2 ft.
 high, firmly set and marked 1/4 S. on N. and S.G.P.M. on E. faces
 and witnessed.
 Set instrument over 1/4 corner and continue random line south
 corner of Secs. 1 and 12 bears N. 29 lks. dist., which is a
 cedar post 4 inches square, 1 ft. above mound of stone 4 ft. base
 2 ft. high firmly set, marked and witnessed
 I then return to the corner of T. 4 and 5 N., R. 12 and 13 W.
 Thence I run
 S. 00°35' E. on a true line between Secs. 1 and 6
 ascend steep N. slope through scattering cedar and sage brush
 Wash 10 lks. wide, course S.
 Hook ledge 50 ft. high bears N. and S.
 Top of ridge bears N.W. and S.E. 300 ft. ascent
 Descend gradual S.W. slope
 Over rock boulders
 1/4 Sec. corner previously described
 Thence I run
 S. 00°35' E. on a true line
 45.70
 9.50
 12.50
 13.72
 37.25
 39.02

SANTA BARBARA FOREST BOUNDARY

50.25 From this point action school house of section bears N. 53° 15' W.
 52.25 Ascend house bears S. 51° E. 350 lks. distant.
 59.50 Having 800 lks. wide, 30 ft. deep, course N.W.
 65.00 Side hill drain, course N.E.
 67.00 Drain, course N.E.
 78.05 Corner of Sec. 1 and 12 previously described.
 Land mountainous
 Soil red and 4th rate
 Timber, scrub cedar.
 Formation - volcanic

8. on random line between Sec. 7 and 12
 intersect the closing corner of Sec. 6 and 7 which is a
 granite stone 6x6x6 inches above ground, firmly set, marked
 and witnessed

1/4 sec. corner bears E. 84 lks. distant which is a cedar
 post 4 inches square, in small mound of stone, 1 color's mound
 to 4 ft. base and 2 ft. high, post firmly set and marked 1/4 S.
 on N. and S.O.P.M. on E. base and witnessed

At 1/4 sec. corner I set off 200' S. on decl. arc and at
 1200 p.m. I.M.T. observe the sun on the meridian. The
 resulting latitude is 30° 21' N. which is about 21" less than
 the proper latitude.

Cor. of Sec. 12 and 13 bears E. 20 lks. distant, which is a
 cedar post 4 inches square, 1 ft. above mound of stone, 4 ft.
 base, 2 ft. high firmly set and witnessed. I then return to
 Cor. of Sec. 1 and 12,

These I run
 S. 12 1/2' E. on a true line between Sec. 7 and 12.
 closing cor. of Sec. 6 and 7 bears W. 8 lks. distant
 Top of mountain about 200 lks. N. of summit
 Not from U.S. Forest Reserve Boundary Post No. 122, 30 inches
 in the ground, raised mound of earth and stone, 4 ft. base,
 1 ft. high around post, marked

No. 122 on south side of cap.
 1905 on S. side of cap on rim
 MEXICAN in N.W. and S.W. quadrants.
 Then descend S.W. slope of mountain
 Drain, course W. 200 ft. descent. Ascend steep S.W. slope
 Top of ridge bears E. and W. Descend steep S.W. slope
 Over looks bearing N.E. and S.W.

1/4 sec. corner previously described.
 These I run
 S. 0° 17' E. on a true line
 Drain, course S.W.
 Drain, course W. Ascend steep N.W. slope
 Top of ridge bears N.E. and N.W.

Descend steep S.W. slope
 Change to N.E. slope
 Change to steep S.W. slope
 Side hill drain, course S.E.
 Change to S. slope

Drain, course S.E.
 Drain, course S.E.
 Set from U.S. Forest Reserve Boundary Post No. 123, 30 inches in
 the ground, raised mound of stone and earth, 4 ft. base, 1 ft.
 high around post and 4x6x6 inches E. and W. of post,
 8 ft. distant, marked

50.25
52.25
59.50
65.00
67.00
78.05
77.38
1.29
11.00
11.13
21.45
27.00
30.00
38.00
38.25
40.25
42.15
50.00
53.00
57.00
59.50
64.00
65.20
69.00
72.20
77.32

77.00 Drain, course N.W.
 75.55 Drain, course N.W.
 69.50 Low spur bears E. and W.
 66.25 Dry wash, 100 lks. wide, 4 ft. banks, course W.
 59.90 Dry wash 20 lks. wide, course W.
 54.10 Drain, course N.W.
 53.00 Spur bears E. and W.
 51.50 Drain, course S.W.
 48.20 Drain, course S.W.
 46.00 Top of low divide bears E. and W.
 42.70 Drain, course N.W.
 41.00 Low spur bears N.W. and S.W.
 40.20 Small drain, course N.W.

S. 127: E. on a true line
 These I run
 1/4 sec. corner previously described
 39.50 Small drain, course N.W.
 37.70 Drain, course S.W.
 36.00 Top of Lyons ridge bears E. and W.
 34.75 Drain, course N.W.
 32.50 Drain, course N.W.
 24.30 Drain, course N.W.
 19.00 Top of ledge bears E. and W. Descend N. slope
 3.46 Owing corner of Secs. 7 and 18 bears W. 5 lks.
 3.55 Creek 15 lks. wide, course S.W. beyond through dense brush
 S. 202: E. on a true line between Secs. 13 and 18

These I run
 I then return to cor. Secs. 12 and 13
 and die pits 24x4x12 inches N.W. and S.W. of post 4 ft. dist.
 I enlarge mound around post to 5 ft. base, 1 1/2 ft. high
 on S.W. face; S. 13 on N.W. face and witness it!
 These S.G.V.R. 41 R. 12 W., S. 19 on S.E. face; N. 13 W., S. 24
 finely set and marked in kind letters; 1.4 N., S. 18 on N.E.
 top and 2 1/2 ft. above mound of stone 3 ft. base, 1 ft. high
 a hollow iron post filled with cement 4 inches square at
 corner of Secs. 13 and 24 bears E. 101 lks. dist., which is
 set in instrument over 1/4 corner and contains random line south
 S.G.V.R. on E. face and witness it
 post 5 in. diam., finely set and marked 1/4 S. on N. and
 1/4 sec. corner bears E. 148 lks. distant which is a landmark
 ground finely set, marked and witness it
 E. 8 lks. dist., which is granite stone 10x14x6 inches above
 Owing corner of Secs. 7 and 18, 1.4 N., N. 12 W. bears
 S. on random line between Secs. 13 and 18
 These I run
 are and determine meridian with the solar
 at the corner of Secs. 12 and 13 at 9 A.M. 1. m.t. I set
 March 17:

March 15, 1905

No. 123 on south side of cap
 1905 on S. side of cap on rim
 RISEWAY in N.W. and S.W. quadrants also marked
 1.4 N., S. 13 in S.W. quadrant
 N. 13 W., S. 12 in N.W. quadrant
 W.C. in N.E. quadrant with 2 notches on N. and 4 notches
 on S. edge of rim of cap.
 Cor. of Secs. 12 and 13 previously described
 Land monuments
 set 3rd and 4th rate
 Timber, dense brush of granite and scrub cedar
 formation - granite

SANTA BARBARA FOREST BOUNDARY

BARTHA BARBARA FOREST BOUNDARY

Corner of Secs. 13 and 24, S. 1/4, S. 1/4, N. 1/4, previously described
 Land mountainous
 Soil, 4th rate
 Timber, dense oaks and mountain brush
 Formation - Granite

13.00

W. on random line between Secs. 13 and 24
 At this point I set off 122 1/2' S. on the decl. arc and at
 12:00 p.m. I set the sun on the meridian. The
 resulting latitude is 34° 25' N. which is about 1/4" less than
 the proper latitude.
 1/4 sec. corner bears S. 32° E. dist., which is granite
 stone 1 1/2 inches above ground finely set and marked 1/4 S.
 on N. and S.O.P.R. on S. faces and witness. I mark bearing
 these as follows:
 A sand cedar tree 3 inches diam. bears N. 71° E. 33 lbs.
 dist., marked 1/4 S.S.T.
 A cottonwood 8 inches diam. bears S. 70° E. 184 lbs. dist.,
 marked 1/4 S.S.T.
 I set a monument post 4 ft. long, 4 inches square by side
 of stone.
 Cox. of Secs. 13, 14, 23, 24 bears N. 91 lbs. dist., which is a
 heavy post 16 inches above mound of stone, 8 ft. base, 1 ft.
 high, finely set and marked!

47.66

T. 4 M., S. 13 on N.E. face
 N. 13 W. S. 24 on S.E. face
 S.O.P.R. S. 23 on S.W. face
 S. 14 on N.W. face with 1 notch on E. and 3
 notches on S. edges and witness
 I enlarge mound of stone to 5 ft. base by 1 1/2 ft. high around
 post, and the pile 2 1/2 inches in each sec. 4 ft. distant
 I then return to the corner of Secs. 13 and 24 (S.O.P.R. 41)
 Thence I run
 S. 66° 06' W. on a true line between Secs. 13 and 24 over gradual
 N. slope through dense brush
 Beyond steep bank of creek
 Creek 20 lbs. wide, course N. 20° W. turning water
 Ascend steep N. bank of creek
 Thence over gradual E. slope
 Dam road, bears N. and S.
 Small drain, course N.
 Beyond steep E. bank of creek
 Creek, 40 lbs. wide, course N. Ascend steep N. bank
 Beyond steep bank to creek
 Creek, 20 lbs. wide, course N.E. to W.
 Leads creek, course S.W. to E.
 1/4 sec. corner previously described
 Thence I run

21.29

4.00

Beyond steep bank of creek
 Small drain, course N.
 Beyond steep E. bank of creek
 Creek, 40 lbs. wide, course N. Ascend steep N. bank
 Beyond steep bank to creek
 Creek, 20 lbs. wide, course N.E. to W.
 Leads creek, course S.W. to E.
 1/4 sec. corner previously described
 Thence I run
 N. 66° 29' W. on a true line
 Small drain, course N.E. Ascend gradual E. slope
 Dam road bears N. and S.
 Change to gradual W. slope
 Drain, course N.
 Top of spur bears N. and S.
 Drain, course N.E.
 Ascend steep E. slope
 Change to gradual E. slope
 Top of ridge bears N. and S.
 Cox. of Secs. 13, 14, 23 and 24 previously described
 Land mountainous
 Soil 4th rate
 Timber, oaks and mountain brush
 Formation - Granite

47.66

49.00
 60.14
 66.50
 69.75
 72.00
 73.75
 75.00
 77.00
 81.50

SANTA BARBARA FOREST BOUNDARY

March 18:
 At the corner of Secs. 13, 14, 23 and 24 at 9 A.M. I.M.S. I
 set off theodolite on Int. B. on the decl. and
 and determine a meridian with the solar.
 Then I run
 N. on a random line between Secs. 14 and 23
 intersect 1/4 sec. corner which is an old post 4x5 inches
 square, 1 ft. above mound of earth, 3 ft. base, 1 1/2 ft.
 high likely set and marked 1/4 S. on N. and S.O.P.M. on S.
 Continue random line west
 Cor. of Secs. 14, 15, 22, 23 bears S. 106 lks. dist., which is
 a permanent post 5 inches square 2 1/2 ft. above small mound
 of stone, likely set, witnessed and marked:
 1. 4 N. S. 14 on N.E. face
 N. 13 W. S. 23 on S.E. face
 S.O.P.M. S. 22 on S.W. face
 S. 15 on N.W. face with 2 notches on E. and 3
 notches on S. edges.
 I enlarge a mound of stone to 3 ft. base, 1 1/2 ft. high,
 around post.
 I then return to corner of Secs. 13, 14, 23 and 24.
 Then I run
 West on true line between Secs. 14 and 23 over N.W. slope
 through dense brush
 Set iron U.S. Forest Service Boundary Post No. 124, 30 inches
 in the ground, raised mound of stone and earth, 4 ft. base,
 1 ft. high around post, marked
 No. 124 on S. side of cap
 No. 124 on S. side of cap
 1905 on S. side of cap on rim
 MARKER in N.E. and N.W. quadrants also marked
 1. 4 N. S. 13 W. O. in N.E. quadrant
 N. 13 W. S. 24 in S.E. quadrant
 S. 23 in S.W. quadrant
 S. 14 in N.W. quadrant with 1 notch on
 E. and 3 notches on S. edge of rim of cap
 Drain, course N.E. Ascend steep E. slope of mountain
 Top of ridge bears N.W. and S.R. Descend steep S.W. slope
 Change to gradual E. slope
 1/4 sec. corner provisionally described (700 ft. descent)
 Then I run
 S. 22-27, S. on a true line. Descend steep N. slope,
 then over gradual N. slope
 DRY wash 80 lks. wide, course N.W.
 DRY wash, 10 lks. wide, course N.E.
 Ascend gradual N.W. slope
 Top of low spur bears N. and S.
 Drain, course N. Ascend N.E. slope
 Top of low spur, bears N. and S.
 At this point I set off 650' S. on decl. and at 12:00 P.M.
 P.M. I.M.S. observe the sun on the meridian. The resulting
 latitude is 34° 25' N. which is about 14" less than the proper
 latitude.
 Drain, course N.E. Ascend E. slope of mountain
 Spur bears N. and S.
 Drain, course N.E. and S.
 Top of spur bears N.E. and S.W. Descend N.W. slope
 Change to steep N.E. slope
 Top of spur bears N.W. and S.R.
 Drain, course N.E. Ascend steep N.E. slope
 Top of ridge bears N. and S.
 Drain, course N.E. Ascend steep N.E. slope
 Top of ridge bears N. and S.

79.40
 76.00
 73.00
 70.50
 67.50
 62.45
 61.00
 58.35
 55.50
 51.50
 49.25
 46.00
 45.25
 43.94
 42.13
 37.25
 32.50
 2.25
 2.25
 12.50
 17.25
 42.13
 81.02
 42.13