

FIELD NOTES OF THE

DEPENDENT RESURVEY OF THE SECTION BOUNDARIES

AND

SURVEY OF THE SUBDIVISION-OF-SECTION LINES

OF

SECTIONS 31 AND 32, T. 4 N., R. 15 W., S.B.M.

Executed by

Roger F. Wilson, Cadastral Engineer

Survey completed September 2, 1949

Survey commenced August 9, 1949

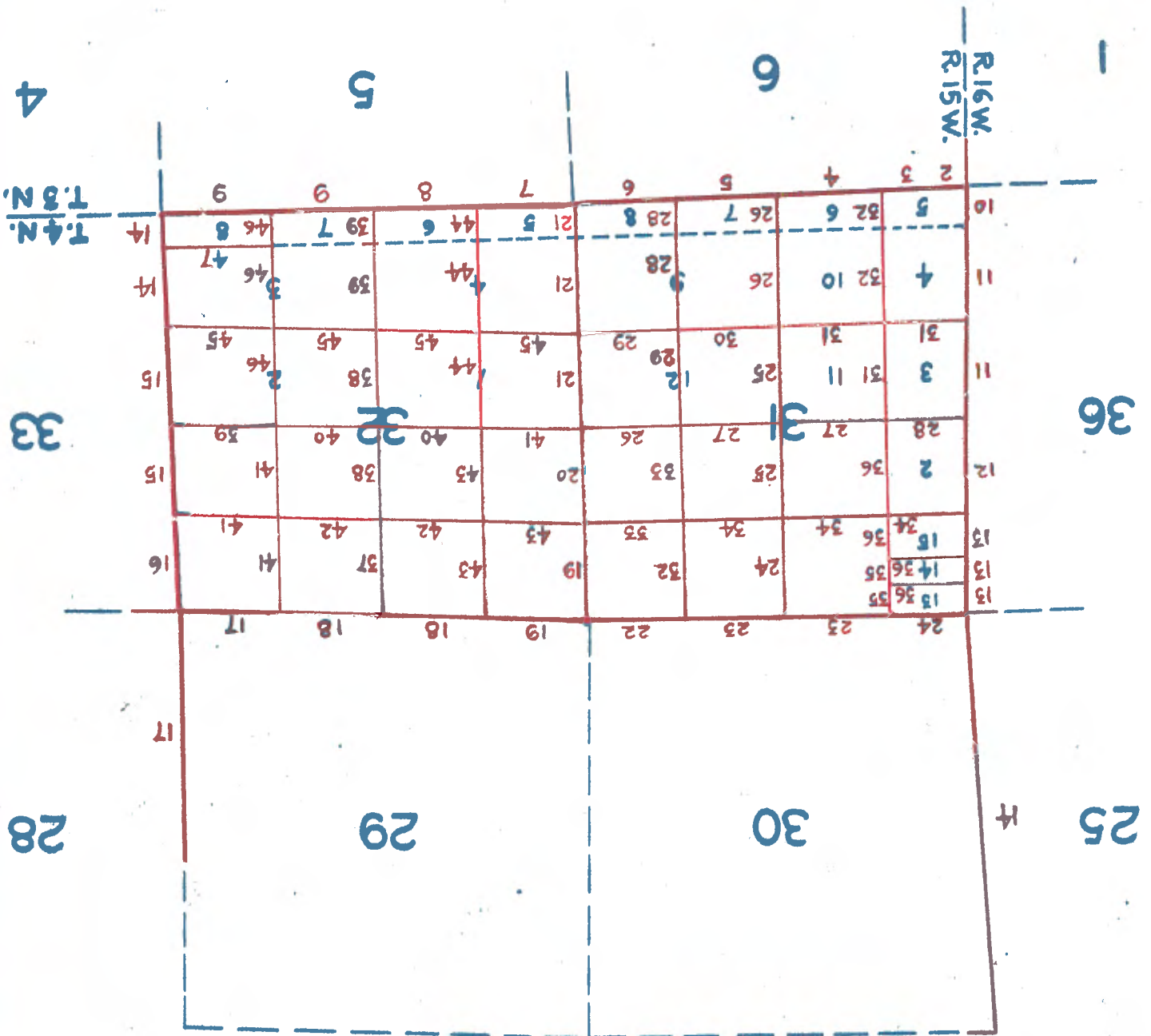

UNITED STATES
DEPARTMENT OF THE INTERIOR
Bureau of Land Management

FIELD NOTES

OF THE

DEPENDENT RESERVE OF THE SECTION BOUNDARIES

AND

SURVEY OF THE SUBDIVISION-OF-SECTION LINES

OF

SECTIONS 31 AND 32, TOWNSHIP 4 NORTH, RANGE 15 WEST

OF THE SAN BERNARDINO MERIDIAN

IN THE STATE OF CALIFORNIA

EXECUTED BY

ROGER F. WILSON, CADASTRAL ENGINEER

Under special instructions dated June 6, 1949, which provided for the surveys included under group No. 368, bearing the approval of the Director, Bureau of Land Management, under date of June 17, 1949, and assignment instructions dated August 1, 1949.

Survey commenced August 9, 1949

Survey completed September 2, 1949

UNITED STATES
DEPARTMENT OF THE INTERIOR
Bureau of Land Management

FIELD ASSISTANTS

CAPACITY	NAMES
SP-3, Truckdriver and moundsman	George C. Hopkins
SP-3, Chairman and notetaker	Victor H. Oberg
SP-2, Chairman and notetaker	Theodore S. Hoffman
SP-2, Axman	Frank D. Gould
SP-2, Flagman	Robert R.B. Manning
SP-2, Axman and moundsman	James H. Peterson
SP-2, Chairman	Robert L. Steffensen

CERTIFICATE OF CADASTRAL ENGINEER

I, Roger F. Wilson, HEREBY CERTIFY upon honor that, in

puruance of special instructions bearing date of the 6th day of June, 1949, I have resurveyed the section boundaries and surveyed the subdivision-of-section lines of sections 31 and 32, Township 4 North, Range 15 West of the San Bernardino Meridian, in the State of California, which are represented in the foregoing

field notes as having been executed by me and under my direction; and that said resurvey and survey has been made in strict

conformity with said instructions, the Manual of Instructions for the Survey of the Public Lands of the United States, and in the specific manner described in the foregoing field notes.

Glendale, California
/s/ Roger F. Wilson
Cadastal Engineer

September 26, 1949

CERTIFICATE OF APPROVAL

Bureau of Land Management,

Washington, D.C., Oct. 27, 1949

The foregoing field notes of the resurvey of the section

boundaries and survey of subdivision-of-section lines of sections 31 and 32, Township 4 North, Range 15 West, of the San Bernardino Meridian, in the State of California, executed by Roger F. Wilson, Cadastal Engineer, having been critically examined and found

correct, are hereby approved.

/s/ Earl G. Harrington

Chief, Division of Engineering

The South boundary of Township 4 North, Range 15 West, of the San Bernardino Meridian, California, was surveyed by M.G. Wheeler, Deputy Surveyor, in 1874. The west boundary and subdivisional lines were surveyed by W.H. Norway in 1876. These surveys are represented upon the township plat approved March 26, 1877, on file in the Public Survey Office. The following field notes are those of the dependent survey, or reestablishment, of the exterior lines of sections 31 and 32 of the township, and survey of the subdivisional lines in said sections 31 and 32.

The resurvey was initiated on the official request of the U.S. Geological Survey, under authority contained in the Bureau of Land Management memorandum "E:W:HH" addressed to the Regional Administrator, Region II, under date of May 17, 1949; to facilitate the administration of all leases by the applicant. All of the section corner locations had been perpetuated with iron post monuments and except for the SW corner of the township there remained no direct evidence of the original monuments. These reestablishments were made in or prior to 1919 at points where evidence of the original monuments was claimed to be found, at that time. There is no remaining government land in these or adjoining sections and the property owners in these sections had accepted the local perpetuations as marking the original corner positions for at least the past thirty years, so no reason can be given for not accepting such corners at the time of this resurvey.

Before restoring the corners, the lines of the original survey were retraced, and diligent search made for any evidence of the original corners, bearing trees and other calls of the original field note record. When duly identified the corner positions were reestablished, or if already permanently reestablished were referenced or new bearing trees were added, where available.

The rules of proportionate measurement were applied in order to ascertain the position of lost corners, after completing the necessary retracements to connect with the identified corner locations but not until exhausting every reasonable possibility of finding direct evidence for the control of each particular corner. The true lines, thus adjusted to the identified original evidence, were then duly run. The retracement data were submitted for office examination and verification prior to the conclusion of the field work. In order to simplify the record, the true line notes only are supplied herewith, which refer to the completed resurvey.

The survey was executed with a light mountain solar transit made by Burt and Burt, serial number 23829, constructed in accordance with the standard instrumental specifications of the General Land Office. The horizontal circle has a diameter of 4 1/2 inches, with two double opposite verniers reading to single minutes; the vertical circle has a diameter of 4 inches, with one double vernier reading to single minutes. The instrument was in good condition and was placed in satisfactory adjustment prior to the beginning of the survey.

The directions of the lines were determined with the solar transit and checked by deflection at intersecting lines. The bearings were checked by deflection from a meridian

Reestablishment of the Survey Executed by M.G. Wheeler, Deputy Surveyor, in 1874.
The cor. of Tr. 3 and 4 N., R. 15 and 16 W., is monumented with an iron post, 2 ins. diam., set in concrete, 8 ins. below surface of paved road, with brass cap mkd.

DEPENDENT RESURVEY OF A PORTION OF THE SOUTH BOUNDARY
OF
T. 4 N., R. 15 W., S.B.M.

August 8, 1949, at camp in the NW 1/4 NE 1/4 of section 1, T. 4 N., R. 15 W., S.B.M., California, every 30 min. from 1.30 to 5 p.m., app. t., I make proper settings on the arcs of the solar attachment and orient the instrument with the solar attachment with the solar attachment with the meridian established by Polaris observation. The measurements were made with a Laithe steel tape, 5 chains in length, graduated every link for the first 100 links, and thereafter at intervals of 10 links. The tape was tested by comparison with a standard tape and found correct. The measurements were made on the slope, and the vertical angle of each interval was ascertained by a clinometer in good adjustment, or by the transit; the horizontal equivalents only are entered in this field note record.

The data furnished with the special instructions give the Geographic position for the SW. cor. of the township as Latitude 34°22.8' N., and Longitude 118°30' W.

August 8, 1949, at camp in the NW 1/4 NE 1/4 of section 1, T. 4 N., R. 15 W., S.B.M., California, every 30 min. from 1.30 to 5 p.m., app. t., I make proper settings on the arcs of the solar attachment and orient the instrument with the solar attachment with the meridian established by Polaris observation. At twilight, make an hour angle observation on Polaris, E. of the meridian, taking six readings, 3 each with the telescope in direct and reversed positions, and accumulating the deflection angle from the reference object, right to Polaris.

Mean watch time of observation, p.m. 7h 11m
Mean deflection angle to Polaris 2° 45.0' E.
Azimuth of Polaris 44.9'

True bearing of reference object. N. 2° 00.1' W.

Mean observed vertical angle 33° 44' 00"

Refraction - 1' 27"

Hour angle + 45' 26"

Reduced latitude 34° 27' 59" N.

Repeat the test of the arcs daily by noon observation and verify the meridional indications at frequent intervals throughout the survey.

Chains

DEPENDENT RESURVEY, S. Bdy. of T. 4 N., R. 15 W.

A black oak, 22 ins. diam., bears N. 82° E., 100
 lks. dist., mkd. T 4 N, R 15 W S 31 BT.

A black oak, 24 ins. diam., bears S. 54° E., 160
 lks. dist., mkd. T 3 N, R 15 W S 6 BT.

A black oak, 24 ins. diam., bears S. 87° W., 58
 lks. dist., mkd. T 3 N, R 16 W S 1 BT.

A black oak, 18 ins. diam., bears N. 31° W., 149
 lks. dist., mkd. T 4 N, R 16 W S 6 BT.

The new bearing trees:

A nail flash in power line pole No. 550152E
 bears S. 7° E., 11 lks. dist.

A nail thru cruiser tag in the original bearing
 tree bears S. 73° 53' E., 76.8 lks. dist.

A 2 in. iron pipe, 8 ins. above ground, bears
 S. 59° W., 55 lks. dist.

A 2 in. iron pipe, 8 ins. above ground, bears
 S. 1° W., 13.2 lks. dist.

A 2 in. iron pipe, 8 ins. above ground, bears
 N. 0° 05' W., 37.7 lks. dist.

There is no remaining evidence of the original bearing
 tree, north, 130 lks. dist.; altho it was reported as
 still standing, and agreeing with the record, in 1930.

The original bearing tree:
 A black oak, 24 ins. diam., bears S. 72° E., 79
 lks. dist.; overgrowth on W. side of tree not
 cut into.

From this corner:

Wheeler's original monument was a granite stone and char-
 red stake. In 1919 the Los Angeles County Road Dept.
 found and used a 1 in. iron pipe here, per C.S. 8196. In
 Nov., 1919, the General Petroleum Company found and accep-
 ted the 1 in. iron pipe and replaced it with a 2 in. iron
 pipe; per C.S. 8205. Ties to the bearing trees show it to
 be in essentially the same position as Wheeler's original
 monument. E.L. Hart, in 1920, calls for a 1 in. iron pipe
 and 3 in. iron pipe, sec. corner in road established in
 1906; per F.B. 900-461 & 72. W.C. Wattles, in 1921-22
 calls for a 1 in. iron pipe checking bearing trees, in
 center of traveled road and opposite end of fence from
 the south; per L.S. 14-49. Hart and Wattles' 1 in. iron
 pipe checks location of the 2 in. iron pipe. In 1930,
 Los Angeles County Surveyors replaced the 2 in. iron pipe
 with the 2 in. iron post, set in concrete.

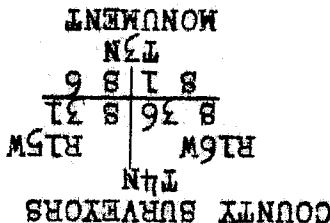

DEPENDENT RESURVEY, S. Bdy. of T. 4 N., R. 15 W. Chains

DEPENDENT RESERVE, S. Bdy. of T. 4 N., R. 15 W. N. 87°32'E., bet. secs. 6 and 31.

Along paved road in Placertias Valley, bears W. to Newhall and E.

13.60 Junction of private road, from N.

14.50 Approximate crossing of L.A. Aqueduct, a 10 ft. pipe line under ground, bears N.10°E. and S.10°W.

15.00 Junction of power line road, from N.9°E.

15.66 High power transmission line, 6 wires on steel poles, bears N.47°W. and S.47°E.

17.096 Point for the S. 1/16 sec. cor. of secs. 6 and 31, at proportionate distance.

Drive a 20 penny nail in nail flash at corner point in approximate center line of paved road bearing E. and W. At a point N.45°E., 63 lks. dist. from cor.

Set an iron post, 3 ft. long, 2 ins. diam., 30 ins. in the ground, with brass cap mkd. W 1/16 S 31 RM 1949 and an arrow pointing to the corner.

At a point S.45°W., 45 lks. dist. from cor.

Set an iron post, 3 ft. long, 2 ins. diam., 30 ins. in the ground, with brass cap mkd. W 1/16 S 6 RM 1949 and an arrow pointing to the corner.

These monuments are under right-of-way fences bearing parallel to the paved road.

From the corner; a nail in crutcher tag on power pole No. 550156E bears N.61°21'E., 74 lks. dist.; and pole No. 102-85 bears S.50-3/4°W., 48 lks. dist.

27.80 Leave oiled road: a fork bears NE., up Placertias Valley; another fork bears SE. to U.S. Highway No. 6.

30.40 Left bank of Placertias Wash, bears N.50°W. and S.50°E.

33.00 Right bank, bears N.50°W. and S.50°E.

33.20 Oiled road, bears S.45°E. and N.45°W., in Placertias Valley.

36.66 Intersect an iron post, 2 ins. diam., buried 12 ins. below surface of ground, with brass cap mkd. COUNTY SURVEYOR RE 2177 1/4 N 1/2 W SEC 6 SEC 31 T3N WC 7/8 COR. This monument was established in Sept. 1938, as a reference point to the original corner.

Ascend 10 ft. on highway fill.

37.28 The 7/8 sec. cor. of secs. 6 and 31, marked by an iron pipe, 2 ins. diam., 30 ins. below surface of road fill. Wheeler's original monument, a 15 in. sycamore tree, was not found. In 1919 the L.A. County Road Dept. found and accepted a 1 1/2 in. iron bar at this point. This iron bar was also used as the corner by General Petroleum Co., in

1919; per C.S. 8196 and C.S. 8205, and by W.C. Wattles in 1921-22, per L.S. 14-49. In 1930 the Los Angeles County Surveyors replaced the iron bar with an iron pipe, 2 ins. diam., set in concrete with brass cap properly marked. In Sept. 1938 the iron pipe was found with the brass cap sheared off by a bulldozer. This is accepted as the best available evidence of the original corner.

At the corner point

Set an iron post, 3 ft. long, 2 ins. diam., 36 ins. in the ground, near base of highway fill, with brass cap mkd.

$$\frac{1/4 \text{ S } 31}{\text{S } 6} 1949$$

from which

A black oak, 14 ins. diam., bears S. 68 1/2° W., 189 lbs. dist., mkd. 1/4 S 6 BT.

A nail in cruiser tag on S. side of power pole bears S. 87° 31' W., 59.7 lbs. dist. The power line bears N. and W.

A Historical Landmark No. 168 marker bears N. 22° 55' E., 7.84 chs. dist. This marker is about 8x5x2 ft., built of wash boulders and cement, with a bronze plaque on E. side, facing U.S. Hwy. No. 6.

N. 87° 20' E., bet. secs. 6 and 31.

Ascend 20 ft. on road fill.

W. shoulder of highway.

Center line of U.S. Highway No. 6, bears N. 22° E. and S. 22° W.

E. shoulder of highway; descend 30 ft.

Dirt road, bears N. 25° E. and S. 25° W., at mouth of side valley from NE., in N. bottom of Placeritas Valley.

Corner of corral fencing, bears N. 87° 20' E. and S. 25° W.

Intersect an iron post, 2 ins. diam., set in concrete, flush with ground, with brass cap mkd. COUNTY SURVEYOR RE 2177 1/4 N 15 W SEC 6 SEC 31 1/2 N W 1/2 COR. This monument was established in Sept. 1938, as a reference point to the original 1/2 sec. cor. of secs. 6 and 31. Add the marks 1949 on SE. side of brass cap.

Corner of corral fencing, bears S. 75° E. and S. 87 1/2° W.

Dirt road, bears S. 60° E. and N. 60° W.

Leave Placeritas Valley, bears NW. and SE.; ascend 125 ft. on SW. slope, thru medium to heavy undergrowth.

This monument was set by L.A. County Surveyors in 1930, to replace a 2 1/2 in. iron pipe in small mound of rocks. Wheel-er's original monument was a granite stone with charred stake and stone mound on S. slope of a hill. In 1919, the County Road Dept. found and accepted the above found 2 1/2 in. iron pipe with old charred stake, 4 ins. sq., along- side it, per C.S. 8196. This pipe was also used as the corner monument by the General Petroleum Co., in 1919, per C.S. 8205; and by H.L. Hart in 1920, per F.B. 900-46E and 69.

Add the marks 1949 at bottom of brass cap.

MONUMENT

14N
 3132
 615
 173N
 COUNTY SURVEYORS
 14N 115W

At a point N. 45° W., 50 lks. dist. from cor. set an iron post, 3 ft. long, 2 ins. diam., 28 ins. in the ground for a reference monument, with brass cap mkd. S 45° E 33 ft to E 1/16 SEC COR REF MON 1949, and an arrow pointing to the corner.

Ascend 16 ft. along gentle SW. slope, thru undergrowth. A point 2 lks. S. of an unmarked iron pipe, 2 ins. diam., 2 ft. above ground.

A point 2 lks. S. of an iron pipe, 2 ins. diam., 2 ft. above ground, mkd. 50 on S. side; on flat spur sloping S.; descend 50 ft.

Side ravine, course S.; ascend 30 ft.

Intersect an unmarked iron pipe, 2 ins. diam., 2 ft. above ground, on side spur sloping S.; descend 65 ft.

Wash, 10 lks. wide and 3 ft. deep, in wood ravine, course S. 10° W.; ascend 37 ft.

Flat spur, slopes S.; descend 7 ft.

The cor. of secs. 5, 6, 31 and 32, monumented with an iron post, 2 ins. diam., 2 ins. above ground, set in concrete form, with brass cap mkd.

14N
 331
 78
 173N 86
 RE 4324

Point for the E. 1/16 sec. cor. of secs. 6 and 31; marked by an iron post, 3 ins. diam., 3 ins. above ground, set in concrete and a small mound of stone, with iron cap mkd.

A point 2 lks. S. of an iron pipe, 2 ins. diam., 16 ins. above ground, set in ground and small mound of stone, on side spur sloping S.; ascend 20 ft. along SW. slope.

Point for the E. 1/16 sec. cor. of secs. 6 and 31; marked by an iron post, 3 ins. diam., 3 ins. above ground, set in concrete and a small mound of stone, with iron cap mkd.

DEPENDENT RESURVEY, S. Bdy. of T. 4 N., R. 15 W.

chains

15.124

20.21

21.17

28.22

30.00

33.35

37.20

39.00

40.42

From which

The original bearing tree:
Decayed stump of a large sycamore bears S. 47° W.,
585 lks. dist., with no remaining legible marks.

The new bearing tree:

A black oak, 30 ins. diam., bears S. 2° 33' W.,
585 lks. dist., mkd. T3N R15W S 6 BT.
A dry old prospect hole, at end of side road,
bears N. 78° E., 13 1/2 chs. dist.

At a point N. 45° E., 22.73 lks. dist. from cor.
set an iron post, 3 ft. long, 2 ins. diam., 30 ins.
in the ground, for a reference monument, with brass
cap mkd. S45° W. 15 FT TO SEC COR RM 1949 and an
arrow pointing to the corner.

Land, which is level in Placertias Valley, is gentle,
broken S. slope of valley.
Soil, sandy, gravelly and rocky clayloam, 1st to 3d rate.
Undergrowth, chamisal.
Timber, black oak and sycamore, in some of the ravines,
and in Placertias Valley.

N. 89° 01' E., bet. secs. 5 and 32.

Along gentle S. slope, thru heavy undergrowth of chamisal.
1.50 Low spur, slopes S. 10° E.; descend 33 ft.

3.90 N. end of a private road, bears S. 15° W.; S. side of a
board cabin, 1 room, 18 N., 20 lks. dist.

4.20 Wash, 10 lks. wide and 3 ft. deep, in timber side ravine,
course S. 15° W.; ascend 30 ft.

5.60 Flat spur, slopes S. 15° W.; continue along S. slope.

9.00 Rocky side ravine, 20 lks. wide and 5 ft. deep, course SW.
Ascend 53 ft.

10.77 A point 2 lks. S. of cor. of 3 wire fence on steel posts,
bears S. 89° E. and S. 15° W.

13.26 A point 4 lks. N. of cor. of 3 wire fence on steel posts,
bears N. 89° W. and N. 15° E.; on spur sloping S.; descend
66 ft.

17.25 Graded road, bears N. 10° E. to old prospect hole and S. 10° W.

17.50 Wash, 15 lks. wide and 3 ft. deep, in wooded side valley,
course S. 15° W.; ascend 16 ft.

18.80 Spur, slopes SW., near end; descend 10 ft.

19.94 Point for the W. 1/16 sec. cor. of secs. 5 and 32, at
proportional distance.

Set an iron post, 3 ft. long, 2 ins. diam., 22 ins. in the
ground to bedrock, and in a mound of stone to top, with

brass cap mkd.

8 32
W 1/16 S 5

1949

from which

A black oak, 8 ins. diam., bears S. 28° E., 55 lks. dist., mkd. W 1/16 S 5 BT.

Ascend 7 ft. along gentle SW. slope, thru undergrowth.

Intersect an iron pipe, 2 ins. diam., 5 ins. above ground, with wooden plug in top and brass tag marked J. W. Betty. Is 2313.

Wash, 20 lks. wide and 3 ft. deep, in brushy ravine, course SW.; ascend 160 ft. on NW. to W. slope.

Ridge-spur, slopes S. 60° W., from N. 50° E.

Descend 155 ft. on SE. slope.

Graded road, bears N. 60° E. and S. 60° W. to Placerville Valley.

Wash, 50 lks. wide and 10 ft. deep, in Bee Valley, course S. 45° W. Valley is 6 chs. wide and timbered with black oak. Ascend 15 ft.

A point 8 lks. S. of cor. of 3 board whitewashed fence, bears S. 87 1/2° E. and S. 45° W.; cultivated land on S. side.

The 3/4 sec. cor. of sees. 5 and 32, monumented with an iron post, 2 ins. diam., set flush with surface of ground in concrete form 6 ins. diam., with brass cap mkd.

COUNTY SURVEYORS
H15W 14N

1/4 COR

SEC 32

SEC 5

T3N

MONUMENT

Add the marks 1949 to S. side of brass cap.

This monument was set by L.A. County Surveyors in 1930, to replace a 1 1/2 in. iron pipe in mound of rocks. Wheeler's original monument was a granite stone in mouth of ravine. In 1919, the County Road Dept. found and accepted a rock mound here, per C.S. 8196. Later in 1919, the General Petroleum Co. also found and accepted the mound and set the 1 1/2 in. iron pipe, per C.S. 8205. This is accepted as the best available evidence of the original corner.

From which, the new bearing trees:

A black oak, 10 ins. diam., bears S. 74 1/2° E., 105 lks. dist., mkd. 3/4 S 5 BT.

A black oak fork, 12 ins. diam., the SW. fork of 3, bears N. 37 1/2° W., 128 lks. dist., mkd. 3/4 S 32 BT.

DEPENDENT RESURVEY, S. Bay. of T. 4 N., R. 15 W.

N. 87° 52' E., bet. secs. 5 and 32.

Over gentle, open SW. slope of Bee Valley, thru scattering timber.

1.00 Leave valley, bears NE. and SW.; ascend 56 ft. on W. slope. E. end of 3 board whitewashed fence 1/2 S., about 5 lks. dist.

6.30 Side spur, slopes NW.

8.10 Side ravine, course NW.; ascend 215 ft. on very broken, very brushy NW. slope.

20.89 Point for the E. 1/16 sec. cor. of secs. 5 and 32, at proportionate distance.

Set an iron post, 3 ft. long, 2 ins. diam., 30 ins. in the ground, with brass cap mkd.

E 1/16 S 32
S 5

1949

Raise a mound of stone, 3 ft. base, around post to top. Ascend 42 ft. on NW. slope, thru dense high undergrowth.

22.30 Ridge-spur, slopes S. 30° W., from N. 30° E.; descend 170 ft. along NE. slope of side spur.

27.00 Side ravine, course SE.; change to S. slope.

28.50 Side spur, slopes S. 70° E.; descend 45 ft.

30.00 N. end of 1st road, bears S. 20° E. to Placetas Valley.

30.40 Wash, 5 lks. wide and 2 ft. deep, in timbered side valley, course S. 20° E.; ascend 50 ft. thru dense undergrowth.

32.40 Side spur, slopes S.; descend 40 ft.

35.20 Side ravine, course SW.; ascend 70 ft. along SW. slope.

41.50 Small side ravine, course SW.; ascend 5 ft.

41.78 The cor. of secs. 4, 5, 32 and 33, monumented with an iron post, 2 ins. diam., 2 ins. above ground, set in concrete form, 6 ins. diam., in the original mound of stone, 3 ft. base, with brass cap mkd.

COUNTY SURVEYORS

R15W T4N
32 33
5 4
5 14
T3N

MONUMENT

Add the marks 1949 on S. side of brass cap.