

FIELD NOTES OF THE
SURVEY OF
RANCHO TOPANGA MALIBU

RESURVEYED BY J. GOLDSWORTHY
U.S. DEPUTY SURVEYOR
JUNE, JULY - 1894

Copied from copy loaned to
County Surveyor by Gerald
C. Fitzgerald - Civil Engineer.
625 Rowan Bldg. Los Angeles.

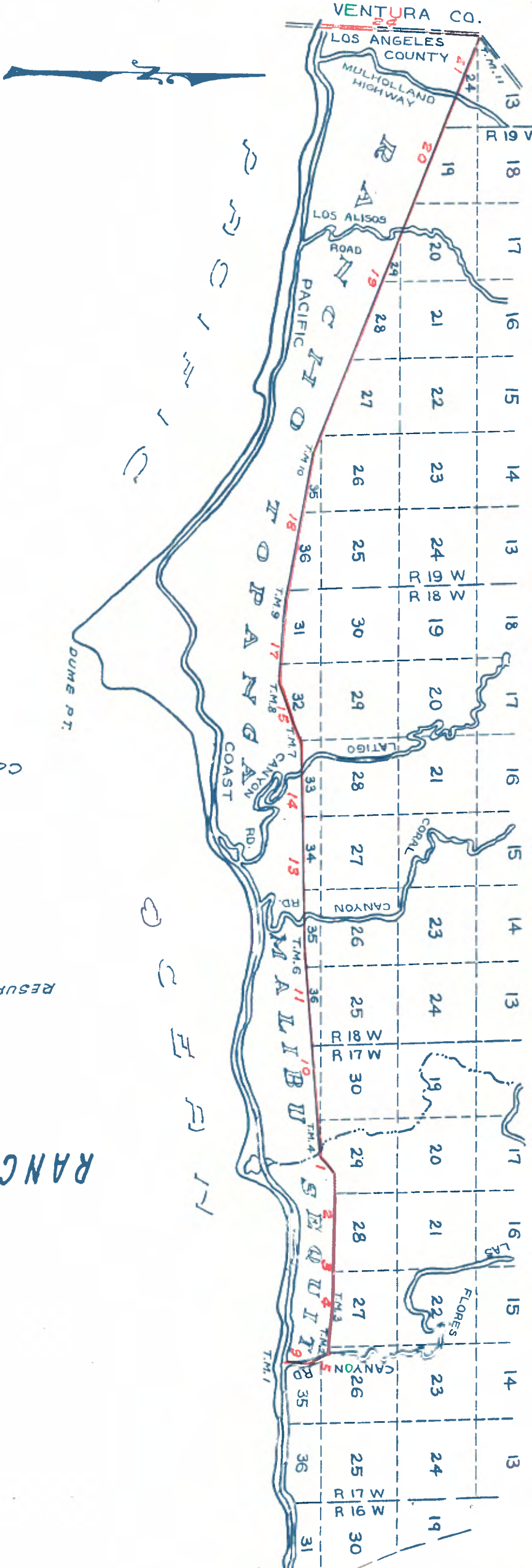

Copied from copy loaned to County Surveyor
by Gerald C. Fitzgerald, Civil Engineer,
625 Rowan Building, Los Angeles, Calif.

Resurveyed by J. Goldsworthy, U. S. Deputy Surveyor
June and July, 1894

FIELD NOTES OF
SURVEY OF THE RANCHO
TOPANGA MALIBU

RANCHO TOPANGA MALIBU

FIELD NOTES

Chains

From sycamore tree diam. E. M. No. 4

N 63 E

Mag. Var. 14° 15' East

0.51-1/2

To peg

To wire fence north, and south 60 links to Alliso tree

0.70

To wire fence north, 2 chains to alliso tree, and south 75 links to

1.35

gate. Enter prune orchard

Middle of avenue course East and West

7.38

To west side of road course north, and south 65 links to live oak

12.00

tree with 3 notches on south side. Old house north 2.10 chs.

To middle of main avenue course north and south

12.82

To middle of road.

15.50

The N. W. corner of bunk-house south 41 lks. dist.

16.00

To point in prune orchard 13-1/2 lks. south of the 4th row of

22.00

trees from the north, 16-1/2 lks. north of the 5th row from the

north, and the 9th row from the south, and 4-9/10 lks. west of

the 2nd row from the east.

At this point there is set a 4 x 4 redwood post 15 in. long, 11

inches below the surface, and marked F H R on the north, and

T. M. 3 on the south for Topanga Malibu No. 3, with a 6 x 12

rock centered and set even with the surface from which a grey

sand rock in place (no ledge showing) bears N 1-3/4 W 2.19 chains

distant. This grey sand rock is marked B. P. T. M. 3 for bearing

point to Topanga Malibu No. 3, and is situated at the base of a

rocky spur, about 10 feet above and 60 lks. N. of ploughed land.

Thence

Chains S 89° 30' E

16.99 To peg in avenue

17.19 The S. W. corner of cottage bears N 29-1/2° E 5 lks dist.
42 x 32 feet

17.31 To + on house 7.60 E. of S. W. corner

27.74 To a 4 x 4 post marked 28 and 29, 10.66 chains west of corner
to sections 28, 29, 32 and 33 T 1 S R 17 W S. B. M.

29.10 To point on hill. Old mound south 3 lks distant
Set a gray sand rock 30 x 12 x 12 inches, marked T M 4 -

29.55, 15 inches in the ground and erect mound of rocks on
ridge course South 10 chs thence S. W. to Ocean at Senton's house.
Old mound 21 lks south. Enter gentle slope of good land course
south, and north about 5 chains.

31.00 Enter buck-horn brush N. & S.

32.50 To west side of ravine course South

33.00 To brushy ravine course south

35.50 To spur course south 10 chs.

39.00 To ravine course south to ocean

67.03 To point on ridge

67.14 A large grey sand rock in place, marked with a +, about 1 chain
E and W, from 5 to 20 feet high, and from 20 to 40 feet wide,
is 6 links N. of line, Descend

75.84 To peg marked T M 4 - 75.84

82.00 To head of ravine course south to ocean
Brow south about 2 chains. Good grazing land with trees about
8 chains south

82.50 To peg

82.60 To edge of precipice course N. and S. about 75 feet high

87.00 To ravine course S. E. about 20 chs, thence south to ocean.
A ridge with trees about 3 chains north

92.84 To point on ridge course S. E. from which I run N 31° 45' E

55 links distant.

A grey sandstone in place, at west edge of creek, marked on top B x T M No. 3 for Topanga Malibu No. 3 bears S 12° E water east in creek at base of tree, from which,

(white) about 6 feet N. and E. (liable to move) and pool of I re-mark the tree T M No. 3. There is a sand rock boulder placed on the east side, on the west edge of creek bank.

At Station T M No. 3 which is a live oak tree 32 1/2 in diam. The true course of this line is S 88° 55' E 129° 28 chains

The Live Oak Tree Sta. No. 3 bears S 41 1/2° E 1.81 ch dist To a shell boulder at East end of this course, from which

128° 08 of deep pools of clear good water with some white sulphur. This is not at present a running stream, but contains a number To water in creek course S.

125° 89 To a boulder 8 feet square on west edge of creek Descend toward Canada Piedras Colorado

4 or 5 acres can be cleared just north of ravine. Enter pasture land, creek 4 chs. wide, good Bee Ranch.

116° 16 To point set out 116° 52 Ravine with water from 2 to 4 chs north

Thence from point at 93° 20 along N. slope of ridge on the west edge of a ravine course South.

some brush grows on the west side near the top. It is situated From the vertical, is detached about 40 feet from another rock;

called the "Leaning Tower of Malibu." It leans about 4 feet To a pillar of gravel cement about 25 feet high and 6 feet diam. (Tower)

7° 50 To ravine course S. E.

6° 00 To spur " " 4 chs

3° 00 To ravine course east

Descending about 200 feet chains

59.64	To point set flag about 2 chs south of ravine
50.00	To ravine course N. E.
45.17	To stake marked and descend
42.55	To stake marked
	to Canon
40.30	To ravine heads 1 ch north, and runs south 2 chs, thence E. S. E.
39.00	To road course South & N. E.
	Land bears S 57 1/2° W.
	6 chains, thence E. S. E. along ridge to mouth of canon. Grassy
	Mated Canon. Road 60 lks, east of point runs south along ridge
	one fork runs to mouth of Cole ravine, the other to mouth of
38.46	To point on ridge course S 7 1/2° W 6 chs to where ridge forks;
	Canon*
37.00	To ravine course south 5 chs, thence S. W. 12 chs into main
	barley patch on hill north 2.50 chains.
34.50	To point, ridge 1.50 ch. north, the west end of good appearing
32.48	To peg T M No. 3 - 32.48
	N. E. of main ravine. Flat 15 chs. W of vineyard
	A flat (10 ac) extends 12 chs W to rear. Course S to June. 5 chs.
	ravine course S. W. About 20 chs N to vineyard. Extends E 3 chs.
	course S 18 W to mouth of canon on east. About 12 chs N to
29.26	To point on ridge in wild alfalfa. Hill 400 ft above ravine
6.50	To ravine course S. W. 3 chains to main ravine
5.50	To spur course south
3.50	To creek at base of precipice 75 feet high
2.98	To point set peg

S 82° 30' E

Thence

The course of creek here is south, but comes from nearly due west about 2 chains north of this point

Thence

Chains

Chains

69.00

To point 2.70 chs S 7° 30' W from T. M. No. 2
The true course and distance is S 84°, 44' E 69.05 from
T. M. 3 to T. M. 2

T. M. No. 2 is a tall straight sycamore tree 15 in. diam.
plainly marked T. M. No. 2 on S. W. side, situated on the
south end of a point of land, main creek 6 feet deep 30 ft
west of tree, another creek 20 ft east; a sycamore tree 16 in
diam 17 inches N. of marked tree. A live oak tree 15 in. diam
bears S 58° W, 65 lks. dist. It was placed on the east side,
but not marked. I marked it T M 2 B T. It is on the west
bank of creek. From the sycamore T M No. 2, west base of
creek 60 lks. dist. east base 75 lks. dist. The canon widens
above the eye.

Meander down Mateo Canon

S 31 E

6.00

To point at east base of hills. Set sand rock 36 x 12 x 8
inches marked R H R 12 in a mound of rocks. Creek west 50 lks
dist. Hills west 6 chs. dist.

Thence

S 29° 30' W

2.88

To a grey sand rock 4 1/2 ft high, 9 ft diam with 3
on top on line. A live oak tree 12 in. dia. with 3 notches
on the east side just E of path, 32 lks. west. Creek east of
rock.

4.50

To point in creek set peg F. H. R. 11 in mound of rocks
a sycamore tree 13 in. diam. marked F. H. R. 11 B. T. bears
S. 81° E 48-1/3 lks. distant. This is the most northerly
of a clump of 5 sycamores on the east bank of creek. West
bank of creek 50 lks west. Point of hill 1.50 chs. east.
Base of hills 300 ft high 1.50 ch north.

Thence

Chains

S 6° W

Along creek bed to rocky point in hills on the west
Set a sycamore post 4 in. diam. in a mound of rocks, on
a fine rock in place above high water, marked F. H. 10,
from which, a sycamore tree 18 inches diam. on the east
bank of creek bears N 50 E 48 lks dist. East base of hills
East 150 lks. dist. A small flat to the east. Thence

S 68 1/2° E

Along creek bed

A sycamore tree 4 in. diam. on north bank of creek, with
3 notches on the south, 1 k north of line.
Set a grey sand rock 12 x 12 x 26 inches F. H. 9 in mound
of rock, from which, in solid sand rock in place, near
rocky spur, 25 feet high, bears S 46 1/2° E 19 links distant.
marked F.H.R. 9 B.P

7.50

S 18° W

To creek

A sycamore tree with 3 notches on the west side bears East
1 1/2 lks. dist.

1.38

To point in center of creek. No corner set as it would be
washed away, from which, a line 4 in diam. marked F. H. R.
8 B. bears S 46 1/2° E. 56 lks. dist.

3.50

A small flat (good land) East 1.50 ch. dist. Thence

S. 11° W

To rock in place marked 3 on west side of creek

0.96

To sycamore spruce 4 in. diam. from old stump, on west bank of
creek, 3 links east. Water at East bank 125 links East

1.65

To water

2.50

4.50

To point on west bank of creek, from which, a sycamore tree 16 in. dia. on east bank of creek, 4 1/2 ft. above water bears 56 links distant. Marked F. H. R. 7. At last named point I set a grey sand rock 26 x 1 1/4 x 9 inches, 9 inches in the ground in a mound of rock on west bank of creek. 3.50 chn.

east to hills

Plat begins 1 ch. north

" continues 2 1/2 chn. south

A ravine at south end comes from East, fine land

Thence

1.50

To point on grey sand rock in place, 12 ft high, 8 ft

S 5-3/4° E

west of east edge of rock on west side of creek; set a yellow sand rock 6 x 10 x 3 1/2 inches 1/3 in the ground, 8 feet west of creek and 12 feet above bed. From which,

I in grey sand rock, 8 x 5 x 2 1/2, marked B. P. H. R. 6,

bears S 31°, 10' W 30-3/4 links distant

Small flat course north 1 ch west 1 ch and south 30 links.

Thence

0.30

To creek and down same

2.27

A sycamore tree 13 in. diam. with 3 notches, on the east edge

of creek bears East 9 links distant.

3.50

To point in wash of creek set a grey sand rock 8 x 10 x 26 in.

F. H. R. 5, from which,

A sycamore tree 16 in. diam. F. H. R. 5 B. T. on west bank

of creek above high water bears S 10 1/2° W 28 links distant.

East bank of creek 60 links. East edge of flat 150 links. East

Ravine 1 ch north comes from N 35° E

West edge of flat 2 chn. west.

Thence

chains
0.25 To west bank enter flat
0.50 To trail
1.09 A dead sycamore tree with 3 notches, 3 lks. East of line, some
young sprouts around
3.50 East base creek 3 chs. east flat begins
4.20 To creek and down same
6.00 To point in middle of creek, from which
A sycamore tree 5 in. diam. F. H. R. 4 B. T. on east bank,
bears S 33 1/2° E 39 lks. dist.
A sycamore tree 6 in. diam. F. H. R. 4 B. T. on west bank, bears
S 58-3/4° W 66 lks. dist.
flat, good land extends 8 chs. east
Stable 3 chs. East
Thence
S. 14° W
Down dry creek bed
3.00 To point set a whitish grey sand rock 9 x 18 x 22 inches marked
F. H. R. 3, 11 inches in the ground, in a mound of rocks on the
west edge of creek bank and east edge of road, and from which,
A sycamore tree 4 in. diam. marked F. H. R. 3 B. T., bears
S 7-3/4° W 34 lks. dist.
A willow 3 1/2 in. diam. marked F. H. R. 3 B. T. bears S 79-3/4° W
23 lks. distant. N. point of flat begins at this corner.
Thence
S 25° E
4.22 To a young sycamore 3 in. diam with 3 notches, on line in middle of
creek bed
5.00 To point in creek bed F. H. R. 2 from which,
A sycamore tree 4 in. diam. marked F. H. R. 2 B. T. on the
west bank of wash, bears S. 35° W, 30 lks. dist.
A sycamore tree 5 in. diam, bears N. 80 1/2° E. 45 lks. dist.

Ocean*

3 ft high, in the mouth of Mateo Canon, at high tide of Pacific
 weighing each from 30 to 100 lbs, 3 ft. diam, at the base and
 planed and painted white, marked T. M. No. 1, in a mound of boulders
 To a 4 x 6 redwood post, 9 feet long, 3 feet in the ground,
 12.00
 1 ch. wide. 6 chs. to east base line flat
 To point of west base in wash
 7.50
 8 chs. to east base*
 To large sand rock marked F on line. 75 lks. to west base,
 4.00
 The south end of flat on the west 75 lks. west
 1.00

S 36 1/2 E

along creek

Thence
 1 ch. to west base, and to the west, flat ends 1 ch. S*
 line flat to the east begins 2 1/2 chs. north
 4 chains to east base
 N. W. between them.
 Both of these trees are on the east bank with a road course
 S. 80° E. 7 1/4 lks. distant
 A sycamore tree 4 in. diam. marked F. H. R. 1, B. T. bears
 lks. distant.
 A sycamore 9 in. diam. marked F. H. R. 1 B. T. bears N. 66 E. 93
 water, from which
 F. H. R. 1, on west bank of creek in mound of rocks, away from
 To point F. H. R. 1, set a drab sand stone 5 x 12 x 2 1/2 inches
 7.50
 50 lks. east on top of bench 6 ft. diam 5 ft. high
 To a large drab sand rock on east bank of creek marked F
 5.82
 flat begins on the east
 4.50
 west to west base, line flat with sumach brush
 To point, 5 lks east to creek, 1 ch. east to high bank, 8 chs.
 1.00
 West bank 9 ft. high
 0.40

S 47 1/2 E.

5 chs. west to hills, fine good land. Thence
 J. J. Lammert's house bears N. 30 E about 3 chs. dist.
 chains

From Sycamore tree H. M. No. 4

S 35° 50' W

9.88 To cross in rock at west edge Malibu Creek

12.33 To point on face of solid grey sand stone, where it was im-

practicable to set a corner, cut it at point and mark rock

F. H. R. 5. Ascend steep rocky point

20.79 To peg in mound of rocks

21.79 To point, sand rock marked #, 6 x 3 x 4 ft. high, bears N. 47 1/2

W, 13 1/2 lbs. dist. Descend

22.00 To point on ridge set peg and ridge runs north about 5 chs. to

ravine course N. E.

26.00 To Puertazuelo

28.58 To rock in rock mound on rocky spur course N. 1 ch. to ravine

32.29 To point on spur, set brown sand rock 6 x 8 x 20 inches, marked

F. H. R. 6 in stone mound

32.83 To point set flag in mound of rocks on north slope

Havine course E. N. E. about 1 ch. N. Spur course East about

1.50 ch. N.

A ravine course East to creek about 2 chs. N.

A ridge course east to honey house about 6 chs. north

A ravine course easterly to ravine last named about 12 chs. north

A high ridge course East about 18 chs. north

From F. H. R. 6, a large sand rock marked # on west side of ravine

above water mark for B. P. R. H. R. 6 bears S 85-3/4 W. 1.09 ch.

dis.

33.48 To last named B. P. R. H. R. 6

57.04 To flag on ridge course S. 60° E 8 chs to mess. Spring in ravine

course east 5 chs. bears west

The mouth of a ravine bears S 40° E

A mesquit at head of ravine bears S 26 1/2° E course, S. W. 10 chs.

thence south to ocean

58.43 To point on ridge set peg 5 chs. to spur course S. 15 W, 10 chs.

175 feet. There are some fine basins in the bed of ravine. of pure cold water comes out of this lode and falls about 150 to that has indications of quicksilver. A spring of about 2 inches the line crosses ravine there is a good showing of a mineral lode This ravine has some fine timber, principally live oak, where course S. 30 E. to ocean.

158*00 To climber ravine course S. W. 10 chs. thence on a general

climber formation in contact with sand-stone.

146*18 To flag on ridge. About 6 chs. south there appears to be

about 4 chs. distant

A Bee Cave in what appears to be quicksilver croppings south

north about 1.40 ch. dist.

A ridge with flat, and lands that appear to contain springs

128*18 To flag on spur course south

114*80 Center of Canon course south and ascend

86 lks. N. of temporary section corner

S. B. B. and M., set peg

To 1 south Rs 17 and 18 W

114*31 Intersect Range line between

of placer gravel extends 3 chs. north and 3 to 5 chs. south

105*09 To peg marked 105*09 on front of canon course south at edge

92*35 To flag on ridge, course of ridge south. Fence 9 chs. North

88*00 To ravine course S. S. E. 5 chs. to last named ravine

83*00 To spur course South 4 chs.

Course S. 25 W 20 chs. thence S. E. 8 chs. to Ocean

A ravine heads in ridge N 28 W about 15 chs. dist

75*00 To deep gorge with fine grey and brown sand rock.

descend about 400 feet

66*25 To point set flag. Mouth of Ravine S. 13 E 22 chs. distant and

62*50 Ravine course south

Head of ravine bears S. 40 E 2 chs. distant

To west end of spur.

Chains

There is a big land slide of 5 to 10 acres lying east of this ravine, which has at times choked it up, but it has been washed out

166*00 To timber ridge course south, from 1 to 6 chs. fine croppings To ridge, straight, narrow and grassy, course south about 30 chs. to good flat

184*00 To ravine containing willows and water course S. to ocean To flag set per 196*26 on clean grassy spur course south to

ocean. Descend about 350 feet to canon To point 18 lks. south of a sycamore tree 30 in. diam. in a gorge 12 ft west of creek, above water and tree from floods.

There being no other tree in the canon to answer the description in the official notes, viz; a sycamore tree 18 in. diam. in rocky gorge, I mark said tree T. M. 6.

I also mark a bearing tree, as follows: T. M. 6 B. T. This is a clean, straight live oak 12 in. diam. and bears N. 66 W. 26-1/2 lks. dist.

The course of the last run will be therefore S 85° 46' W 217*04 chains from T. M. 5 to T. M. 6 Thence

S. 89° 15' W

27*79 Ascending steep rocky gorge To brow of hill course south 18 feet south of a fence course east and west.

Good grazing from 1/4 to 1/2 a mile north of line, from land slide, with fine water in timber and American Canons. A spur tree from brush and with good grass, runs S. 19° W to ocean.

The mouth of American Canon bears S 26-1/4 E

A barley field on hill about 12 chs. north. Descend

32*79 Head of canon course S. W.

Chains

38.00 To dry falls 150 ft deep course S. W. and along volcanic ledge on south slope of ridge

73.84 To flag on spur course S. about 12 chs. to junction of 2 fine ravines; one comes from N. E. the other from N. W. The course is thence S. 30 1/2° E. to ocean. Fine live oak timber and water in the ravine from N. W.

Fence about 4 chs. south. Set peg and flag T. M. 6 1/2

73.64 and descend

93.50 To Soto Creek, about 4 inches water in fine canon, called Soto or Sweeney Canon. Contains alder, sycamore and live oak trees; about 15 chs. north of line on the east side of this canon is a fine tepid sulphur spring coming from a ledge of volcanic rock, apparently alnabur formation.

96.31 To peg. H. G. Sweeney's house 4.97 chs. south. Some 4 or 5 acres of fine land around this house. Ascend

118.77 To point set peg

120.15 Top of spur course S. 27 E. 20 chs. thence east to ocean. Set peg and flag in mound of rocks, from which, Mouth of Soto Canon bears S 58 1/2 E. The mouth of the next canon bears S. 25° E.

Mark said peg T. M. 6 1/2 120.15

Set peg flag marked T. M. G 1/2 127.29 in mound of rock

135.00 To ravine course S. E. about 40 chs. then turns east to Soto Canon. I am informed that there is a body of about 200 acres of fine land due south of this point on the coast.

138.00 To ravine 300 ft deep, course S 45 E to ocean. No wood and apparently no water

142.00 To ridge course S. 28 E to ocean

146.00 To ravine 150 feet deep, course S. E. about 12 chs. to junction with a ravine containing live oak, from N. W.

149.65 To flag on spur, course South, about 12 chs. to a wooded ravine from N. W. dry, course South to coast and along spur facing S.

Chains

170.00 To Canada Large course S. E. 40 chs. thence E. S. E. to ocean
Ascend

190.00 To graded road to the places occupied by W. A. Hayes, Sr.

and Jr. course

North and South

190.20 Set peg T. M. 6 \pm 191 chs.

191.58 " " " \pm 192.33 on

ridge course S. 27 E. to coast

196.25 Drove peg marked T. M. 6 \pm 197.05

215.35 To a point 2.02 chs S. 0° 45' E from T. M. No. 7

The true course and distance is therefore S. 88°, 42' W 215.35
chains from T. M. No. 6 to T. M. No. 7

T. M. No. 7 is a sycamore tree 28 in. diam. standing on the

west bank of creek 10 ft above water; it was pointed out to me

by Will Sweeney

plainly blazed and with some marks of letters; chopped out.

the new growth of wood and found letters. The new growth had

somewhat obscured the T. M. but the rest was plain thus T No. 7

I called the attention of the people who were present to the

marks; present Wm. G. Fleming, R. Dahling, L. C. Plot, J. J.

Goldsworthy and myself, J. Goldsworthy

\pm in face of cliff on west side of canon bears S. 85° W

28 lks. dist. I mark same T. M. 7 B. P.

The tree is 20 ft south of falls, 60 feet deep. 2 fine sul-

phur springs come out of the rock and a stream of about 4 inches

of good water. Falls 150 ft deep 4 chs. N.

Thence from T. M. No. 7

S 71° 30' W

0.50

To point 30 ft. high

1.50

Set peg and flag T. M. 7 \pm 150

8.76

To peg on slope of ridge

13.81

To peg on ridge, marked same T. M. 7 \pm 13.81, ridge runs

S 73 $\frac{1}{2}$ ° E. about 15 chs. into a ravine containing fine water

and sycamore and live oak trees

course of ravine S 76-3/4° E about 40 chs.