

F.D. 9465

1-479

F.D. 9465

FIELD NOTES

OF THE SURVEY OF THE

Rancho La Habra

In T.S. 8 N., Rs. 16, 17 and 18 W., T. 9 N., Rs. 16, 17 and 18 W.,

T. 10 N., Rs. 15 and 16 W.,

Of the San Bernardino Meridian,

In the State of

EXECUTED BY

Geo. H. Thompson, Dep. Sur.

In the capacity of U. S. Surveyor, under Special Instructions dated, 191, issued by the United States Surveyor General to govern surveys included in Group No. _____, which were approved by the Commissioner of the General Land Office, _____, 191, and Assignment Instructions dated _____, 191

Survey commenced July 1862

Survey completed _____, 191

Index Diagram

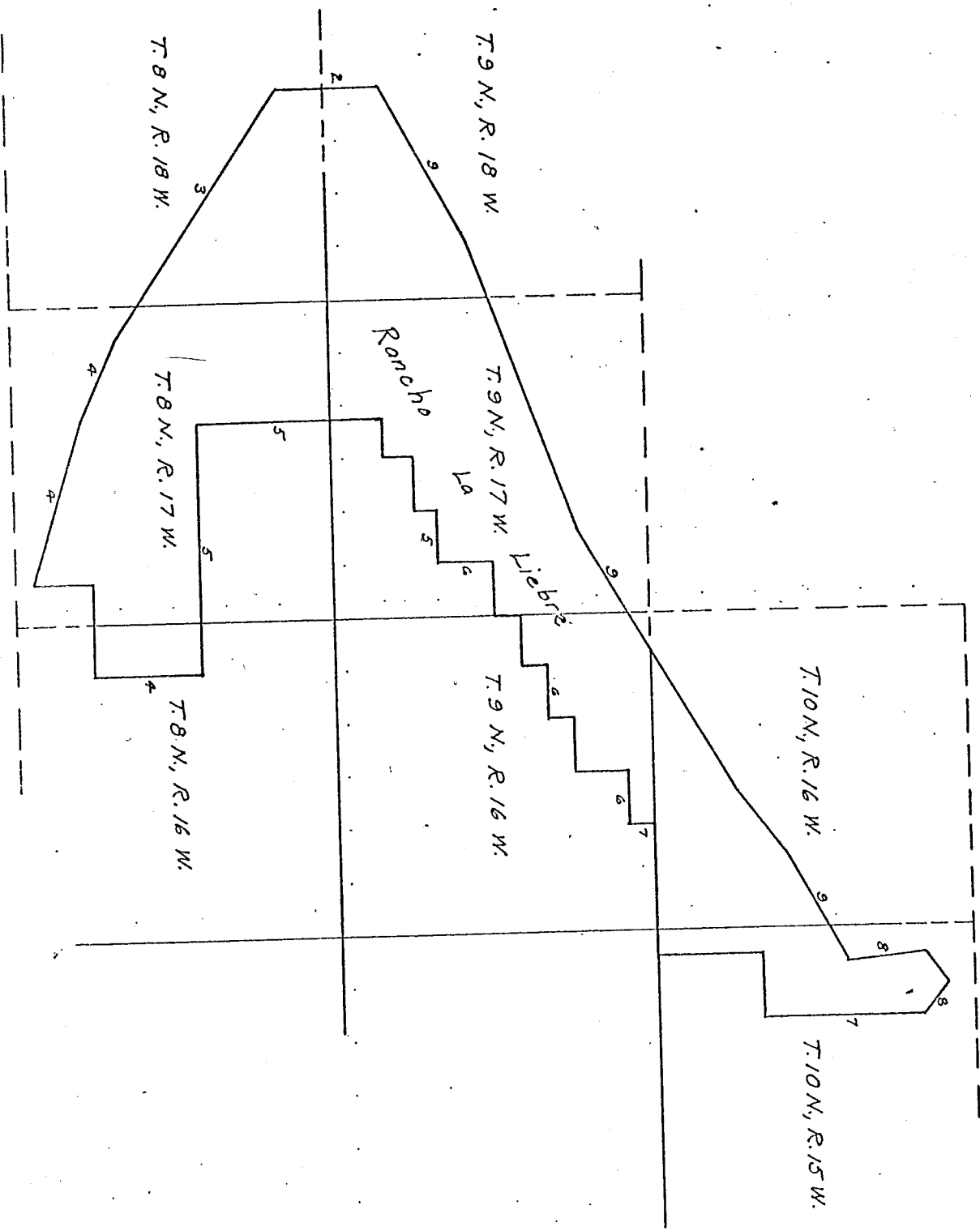

begins South five chains and ninety five links distant,
from which a white oak tree eighteen inches in diameter
chains and twenty seven links to Post marked L. T. No. 2
Eighty chains ascends hill. One hundred and twenty six
at seventy five chains enter "Canada de los Oros", at
and cross small creek, course South Twenty degrees West
Forty chains enter brush, at sixty chains leave brush
cross creek, course South Forty five degrees West at
minutes East, South two degrees East, at five chains
magnetic needle being fourteen degrees and fifteen
according to the true meridian the variation of the

Thence

L. T. No. 1.

West of and near "Pine Springs", where a post is marked
Beginning at a stone mound in the top of the Sierra

bounded and described as follows, to wit:

Land Office, for the said tract of land the same being
United States upon the presentation hereof to the General
Jose Maria Flores is entitled to a patent from the
the said confirmation survey and proceedings, the said
And I do further certify that under and by virtue of
Court.
of said tract of land so approved by said District
certify the annexed map to be a true and accurate plan
copy of which is also hereto annexed; and I do further
District of California and final decree had therein a
survey was ordered into the U.S. District Court Southern
of confirmed private land claims" the said approved
States in California in regard to the Survey and Location
the jurisdiction of the District Court of the United
to amend an act entitled an act to define and regulate
regulate

marked T L No 2 B I and a large Spring of water bears
 North fifty two degrees East, Seven chains and sixty
 seven links distant. Station
 Thence over rolling hills, South fifty three degrees and forty
 five minutes East, at Ten chains cross small Canada,
 course North. At forty two chains enter timber, at
 forty seven chains cross gulch, course North fifty eight
 chains to timbered gulch, at sixty two chains and fifty
 links leaves timber, sixty eight chains to timbered
 ravine, course North East, at eighty one chains and fifty
 links a small house in "Canada de los Ozos" bears North
 forty six degrees East, eighty eight chains to timbered
 ravine, course North, at ninety five chains small house
 in "Canada de los Ozos" bears North thirty five degrees
 East, at one hundred and eighteen chains enter scattering
 Pine and Oak timber, one hundred and forty nine chains
 and fifty links cross Canada two chains wide, course
 North East. One hundred and eighty three chains to dry
 arroyo, thence along same, at two hundred chains leave
 arroyo bearing to the East, at two hundred and forty
 chains leaves scattering timber. Two hundred and forty
 chains to Canada, course North fifty five degrees East,
 at two hundred and fifty one chains cross road, course
 North East and South West, at two hundred and fifty three
 chains leaves Canada, at three hundred and ten chains
 enter valley, course East and West, at three hundred
 and eighty three chains cross telegraph line, course
 North East, eighty one degrees East, and South eighty
 one degrees West, at four hundred and forty chains leaves
 valley and enters low hills. Four hundred and eighty
 six chains and thirty four links to grey granite stone,
 marked T L No 3, from which a white oak tree ten inches
 in diameter bears South eighty five degrees and fifteen

FIELD NOTES

OF THE SURVEY AND RESERVE OF

a portion of the

Santa Barbara Forest Reserve Boundary

Of the San Bernardino Meridian,

In the State of California

EXECUTED BY

William H. Thorn, U. S. Surveyor.

orders
In the capacity of U. S. Surveyor, under special instructions dated November 1904,
Director of the U. S. Geological Survey

1904, issued by the District Chief Engineer to govern surveys included in the

which were approved by the Commissioner of the General Land

Office, and assignment instructions dated 1904.

Survey commenced November 29, 1904.

Survey completed January 10, 1906.

1904

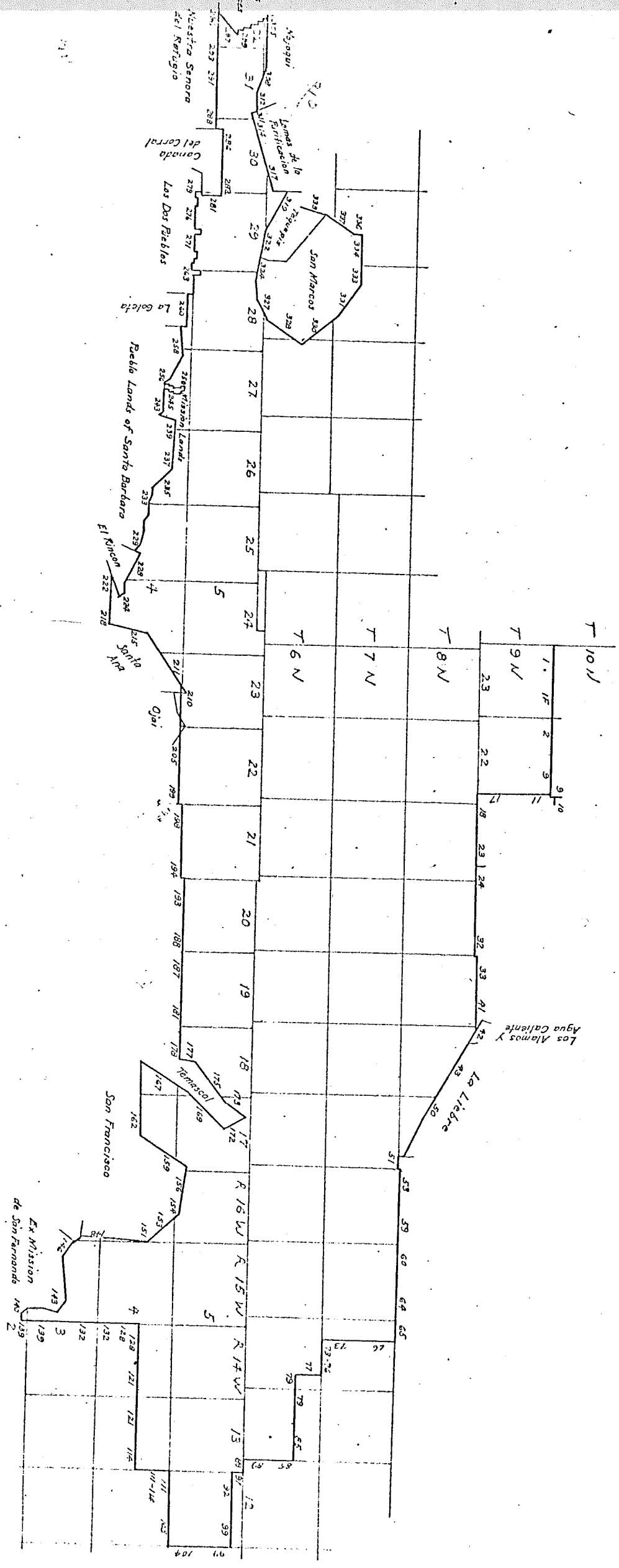

104

Ex Mission
de San Fernando No 2

San Francisco

Los Alamos y
Agua Caliente

La Liebre

Riebla Lands of Santa Barbara

Mission Lands

Las Dos Pueblas

Canada del Corral

Nuestra Señora del Refugio

T 6 N

T 7 N

T 8 N

T 9 N

T 10 N

R 16 W

R 15 W

R 14 W

R 13 W

104

103

102

101

100

99

98

97

96

95

94

93

92

91

90

89

88

87

86

85

84

83

82

81

80

79

78

77

76

75

74

73

72

71

70

69

68

67

66

65

64

63

62

61

60

59

58

57

56

55

54

53

52

51

50

49

48

47

46

45

44

43

42

41

40

39

38

37

36

35

34

33

32

31

30

29

28

27

26

25

24

23

22

21

20

19

18

17

16

15

14

13

12

11

10

9

8

7

6

5

4

3

2

1

0

-1

-2

-3

-4

-5

-6

-7

-8

-9

-10

-11

-12

-13

-14

-15

-16

-17

-18

-19

-20

-21

-22

-23

-24

-25

-26

-27

-28

-29

-30

-31

-32

-33

-34

-35

-36

-37

-38

-39

-40

-41

-42

-43

-44

-45

-46

-47

-48

-49

-50

-51

-52

-53

-54

-55

-56

-57

-58

-59

-60

-61

-62

-63

-64

-65

-66

-67

-68

-69

-70

-71

-72

-73

-74

-75

-76

-77

-78

-79

-80

-81

-82

-83

-84

-85

-86

-87

-88

-89

-90

-91

-92

-93

-94

-95

-96

-97

-98

-99

-100

-101

-102

-103

-104

-105

-106

-107

-108

-109

-110

-111

-112

-113

-114

-115

-116

-117

-118

-119

-120

-121

-122

-123

-124

-125

-126

-127

-128

-129

-130

-131

-132

-133

-134

-135

-136

-137

-138

-139

-140

-141

-142

-143

-144

-145

-146

-147

-148

-149

-150

-151

-152

-153

-154

-155

-156

-157

-158

-159

-160

-161

-162

-163

-164

-165

-166

-167

Survey of North Boundary of

T. 8 N., R. 18 W.

Chains Over gradual W. slope, through scattering oak timber.

06. Set an iron post, 4 ft. long, 3/4 ins. diam., 30 ins. in the ground, and in mound of earth and stone, 4 ft. base, 1 ft. high, for U. S. Forest Reserve Boundary Post No. 45, with brass cap mkd. No. 45 on S. side of cap, 1905 on S. side of cap, RESERVE in SW. and SE. quadrants, 9 N S 31 WC in NE. quadrant, 18 W S 6 in SW. quadrant, 8 N S 1 in SW. quadrant, 19 W S 36 in NW. quadrant, with 6 notches on N. E., S. and W. edges of rim.

5.00 Enter nearly level land, bears N. and S.

9.00 Small drain, course N.

13.00 Ascend gradual SW. slope.

20.00 Side hill drain, course SW.

24.50 Wire fence, bears N. 85° E. and S. 85° W.

33.50 Spur, bears NW. and SE.; descend steep NE. slope.

36.50 Change to steep N. slope, over gullies.

40.00 Set a granite stone, 20x10x8 ins., 15 ins. in the ground for 1/2 sec. cor., mkd. 1/2 on N. face, from which

An oak, 16 ins. diam., bears N. 47° E., 40 lks. dist. mkd. 1/2 S B T

An oak, 14 ins. diam., bears S. 75° 55' W., 329 lks. dist., mkd. 1/2 S B T

43.00 Side hill drain, course NW.; ascend NW. slope.

45.50 Spur, bears NE. and SW.; descend E. slope.

48.00 Enter flat, bears N. and S.

50.67 Wire fence, bears N. 60° W. and S. 60° E.

54.50 Leave flat, ascend W. slope of spur.

57.00 Change to steep W. slope, through dense live oak brush.

72.54 Intersect the south boundary of Rancho Los Alamos y Agua Caliente, 114.55 chs. N. 68° 16' W. from cor. No. 2 of the Rancho La Liebre and a cor. of the Rancho Los Alamos y Agua Caliente, hereinafter described.

Set a granite stone, 20x10x8 ins., 15 ins. in the ground, for closing cor. of trac. 7s. 8 and 9 N., R. 18 W., 1st. 66 and 1 notch on W. face, and dig pits, 2 1/2 x 1 1/2 ins., N. 68° 16' W. and S. 68° 16' E., 8 ft. dist., on Rancho Mts. Raise a mound of stone, 5 ft. base, 2 1/2 ft. high, W. of cor.

Land, rolling and level. Soil, 2nd and 3rd rate. Timber, scattering oak and live oak, undergrowth, brush.

Resurvey of South Boundary of
Rancho Los Alamos y Agua Caliente

Chains

187.00

Drain, course N.

189.00

Ascend steep W. slope.

197.26

Spur, bears NE. and SW.; descend E. slope.

206.90

Small drain, course NE.; ascend steep W. slope.

212.50

Change to gradual N. slope.

218.00

Spur, bears NE. and SW.

219.50

Descend steep E. slope.

224.65

Cor. No. 2 of Rancho La Liebre and a cor. of Rancho Los Alamos y Agua Caliente, determined from the original bearing tree. At point for cor.

Set a white oak post, 4 ft. long, 6 ins. sq., 2 ft. in the ground, for cor. No. 2 of Rancho La Liebre and a cor. of Rancho Los Alamos y Agua Caliente, mkd. T L No 2 of NE. face, T A Y A C on NW. face, with a granite stone, 17x8x8 ins., 12 ins. in the ground, alongside of post, mkd. T L No 2 on NE. face, T A Y A C on NW. face, from which the original bearing tree, in a good state of preservation, bears S. 5.95 lks. dist.

Land, mountainous. Soil, 2nd and 3rd rate. Timber, oak and pine, undergrowth, dense brush, live manzanita and iron wood.

Resurvey of a portion of the
South Boundary of
Rancho La Liebre

From cor. No. 2

S. 53° 15' E., on a random line along the south boundary of Rancho La Liebre.

480.75

Cor. No. 3 bears N. 36° 45' E., 23 1/4 lks. dist.

I return to cor. No. 2 heretofore described.

Thence

S. 53° 32' E., on true line along south boundary of Rancho La Liebre.

Over gradual NE. slope, through prairie.

.06

Set an iron post, 4 ft. long, 3 1/2 ins. diam., 30 ins. in the ground, and in mound of earth and stone, 4 ft. base, 1 ft. high, for U. S. Forest Reserve Boundary Post No. 48, with brass cap mkd. No. 48 on S. side of cap, 1905 on S. side of cap, RESERVE in SE. and SW. quadrants, T L No. 2 WC in NE. quadrant, T A Y A C in NW. quadrant on rim.

1.50

Change to level land.

11.50

Ascend NW. slope.

20.00

Spur, bears N. and S.

21.00

Descend NE. slope.

Chains From cor. No. 7 of Rancho Gastac and a cor. of Rancho Los Alamos y Agua Caliente,

S. 69° 30' E., on a random line along the south boundary of Rancho Los Alamos y Agua Caliente.

Point for cor. No. 2 of Rancho La Liebre and a cor. of Rancho Los Alamos y Agua Caliente, bears S. 20° 30' W., 4.8 chs. dist.

I return to cor. No. 7 of Rancho Gastac and cor. of Rancho Los Alamos y Agua Caliente, which is a white oak, 4 ft. diam, in good state of preservation. I cut into tree and find the marks No 7 S B C. The tree had made a growth of 8 ins. since it was originally marked. I remark the tree No 7 S B C.

Thence

S. 68° 16' E., on true line along south boundary of Rancho Los Alamos y Agua Caliente.

110.12 The closing cor. of trac. Ts. 8 and 9 N., R. 18 W., herebefore described.

110.18 Set an iron post, 4 ft. long, 3/8 ins. diam., 30 ins. in the ground, and in mound of earth and stone, 4 ft. base, 1 ft. high, for U. S. Forest Reserve Boundary Post No. 46, with brass cap mkd. No. 46 on S. side of cap, 1905 on S. side of cap, RESERVE in SE. and SW. quadrants, CC on W. side of rim, T 9 N S 31 in NW. quadrant, T 8 N R 18 W S 6 in SW. quadrant, WC in NE. quadrant, T A A C on N. side of rim.

119.27 Leave dense oak brush; enter scattering timber.

127.22 Wire fence, bears E. and W.

128.00 Ridge, bears NE. and SW.

129.00 Descend gradual SE. slope, through open timber.

132.50 Drain, course N. 70° E., thence over gradual N. slope, through dense brush and scattering timber.

142.00 Descend steep E. slope.

149.50 Leave timber, bears N. and S.

150.50 Drain, course N. 10° E.

152.00 Ascend steep W. slope, through dense brush.

157.29 Wire fence, bears N. 67° 30' W. and S. 67° 30' E.

160.56 Set an iron post, 4 ft. long, 3/8 ins. diam., 30 ins. in the ground, and in mound of earth and stone, 4 ft. base, 1 ft. high, for U. S. Forest Reserve Boundary Post No. 47, with brass cap mkd. No. 47 on S. side of cap, 1905 on S. side of cap, RESERVE in SE. and SW. quadrants,

Descend gradual NE. slope.

172.05 Drain, course N.

179.32 Leave timber, enter prairie.

Page 35 of 35

FIELD NOTES.

—OF—
a portion of
fractious & ...
lines of Township

18 feet, from ...
Florida, California

—BY—

A. H. ...
Deputy Surveyor.
under his Contract of
October 10th 1879

Survey Commenced
October 23rd 1880.

Survey Completed
October 29th 1880.

4-9

Allen Jones ... 1881.
of ...
of ...

34

164

St. M. 28.18 H. S. B. M.

33-36-1-2, from which corner
to base of 61' H., on a line line
between sections 35-36.

37-83-Set Post 4 in diameter, 1 ft. in diam.
1 ft. above base, marked, 4 ft. in
diameter, at base, by 2 ft. in
height - for 1/4 section corner.
11.83 Off corner to section, 25-26 35-36.
Land Mountain.

Set 2nd rate.

Trunk and undergrowth of Oak,
Sycamore and Buckeye.

Retracing

Being unable to find any trace
of old corner to section, 22-23-26
27, in order to reestablish same,
begin at corner to section, 14-15-
22-23, which I find standing and
agreeing with field notes, and
run back, on a true line between
sections 22 and 23.

Navigation, 14° 36' East.

through Valley.

Corner West, base E. end of

10.00 Being unable, after diligent search

to find old corner, I set back
11. in diameter, 1 ft. in diam., 1 ft.
above base marked, 4 ft. in diam.
at base by 2 ft. in height, and
run back on a true line between
sections 10 and 11.

Oct 18 1871 G. B. M.

1/4 section river near valley from

E. end of Mt. and ascending gradient from E. + S. W.

70.00 top of mountain, from E. + S. W. and, descent.

80.00 ditto, 4 in. diameter, 1 ft. in length, 1 ft. above earth surface, 4 1/2 ft. in diameter, at base, by 2 ft. in height, round dug pits, 24 x 18 x 12

8 links distant, at 4 angles, for

run to section, 22-23-26-27.

land mountainous.

Soil 1st and 2nd rate.

Timber and undergrowth of 1/4

Punchgrass and Kobovardak.

Death, fetters, section 26-27.

Navigation 14° 30' East

Descent.

Summit of Ridge, from E. end of

and descent.

30.00 of Spring from East, about 9.00

distant.

ditto, 4 in. diameter, 1 ft. in length, 1 ft. above earth surface, 4 ft. in diameter, at base, by 2 ft. in height, round dug pits, 24 x 18 x 12, 8 links, for 1/4 section river.

56.00 ditto diameter, from S. W. end of

63.00 same same, same and

80.00 ditto, 4 in. diameter, 1 ft. in length, 1 ft. above earth surface, 4 1/2 ft. in diameter, at base, by 2 ft. in height, round dug pits, 24 x 18 x 12, 8 links, for 1/4 section river.

S. M. H. 18. H. D. B. M.

Death, see a number of lines between

actions 34-35.

Navigation 14' 50' East.

Death.

Set temporary 14 action corner.

19.77

Intersect Death Boundary of town

side, 18 links East of corner to action

34-35-2-3. from which corner of

and D. & B. are a true line between

actions 34-35.

Navigation, 14' 30' East.

39.77

Set Post, 4 in dia, 1 ft. in width, 1 ft.

above stone marked, 4 ft. in dia, 4 in

face, by 2 ft. in height, for 14 in

corner.

from which frame

Post, 10 in dia, D. 18 3/4 H. 74 lbs. dia.

19.77

The corner to actions 26-27-34-35

David Montanone.

Set 1st and 2nd note.

Timber and wooding north of Oak

Kaplan and Buchgrabe.

October 25-1880.

Noticing.

Being unable, after diligent search

to find any trace of corner to

line, 21-22-27-28, in order to

establish corner, I go to corner to

actions 15-16-21-22, which I find

planning with compass with find

article, and also found, more

3
4