

MAP
 Showing Assessment District for the
 Proposed Widening
 of
Sixteenth Street
 between
**BUSH ST
 AND HOOVER ST**
 City of Los Angeles Cal.

Filed March 10, 1898.

Confirmed and adopted March 7, 1898
 C. H. Hence City Clerk.

Ordinance No. 4606.

Scale 1 inch = 40 ft.

LOT 4, BLK B, H.S.

Exhibit A

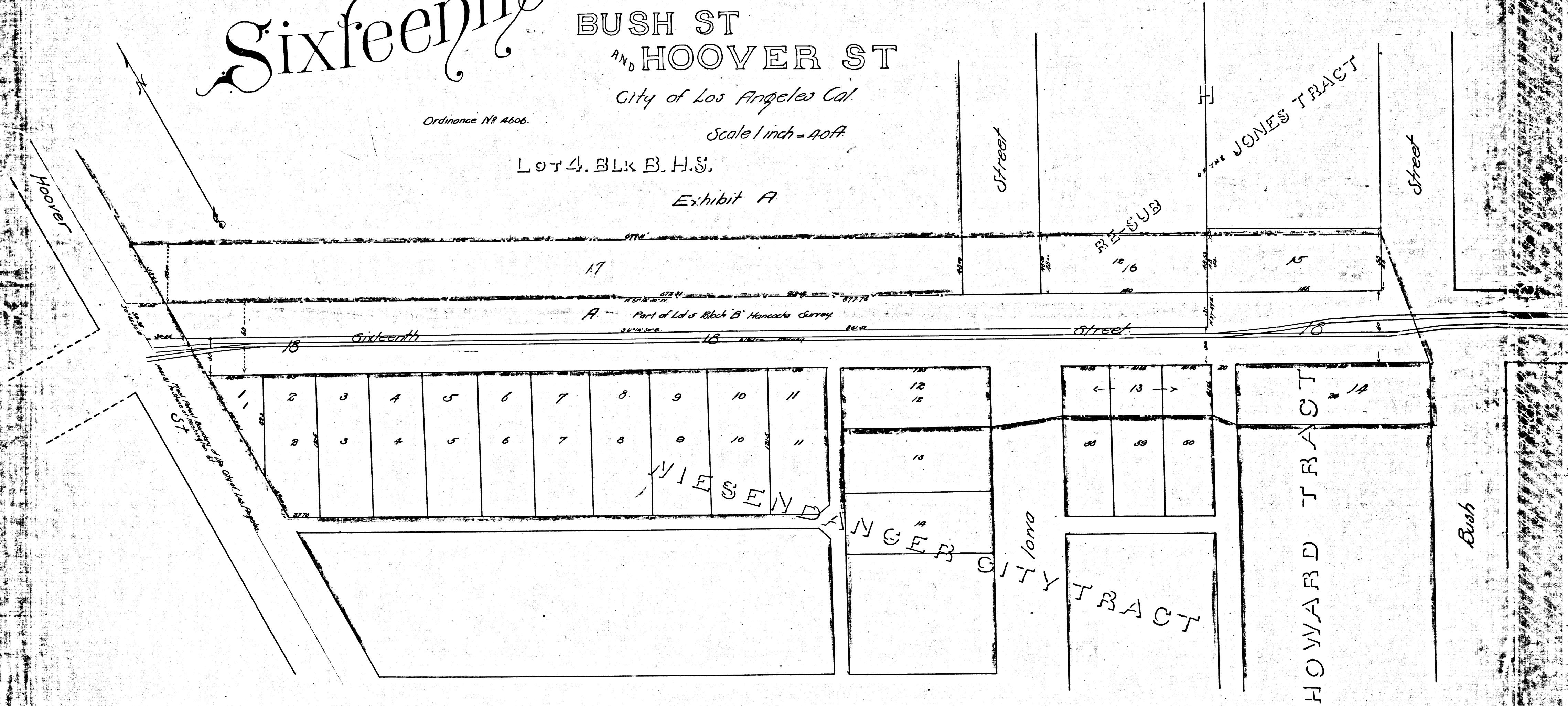

R.F. 66