

R.F.		158
A1	OF	A2

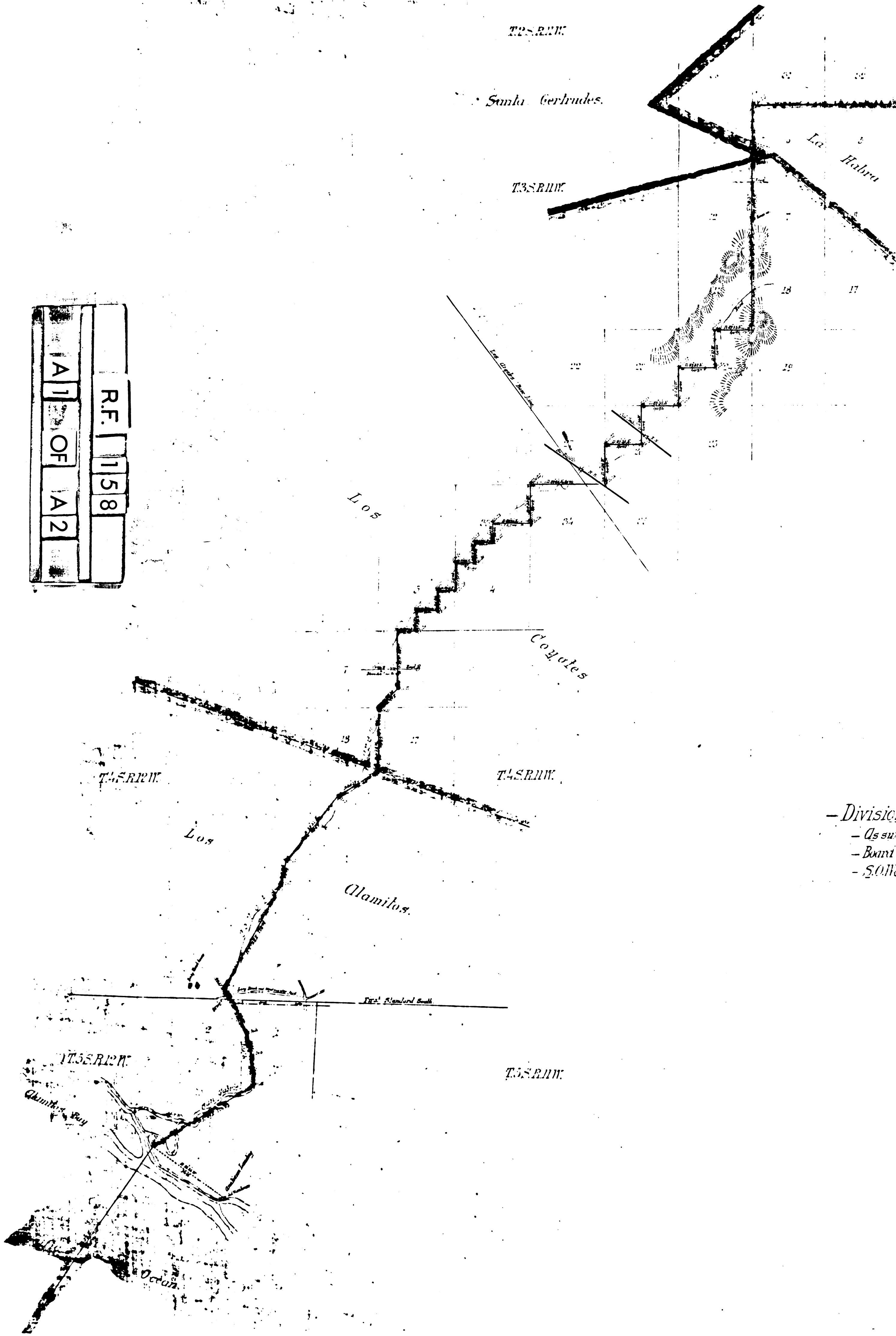

- Division
 - As su
 - Bound
 - S.O.W.

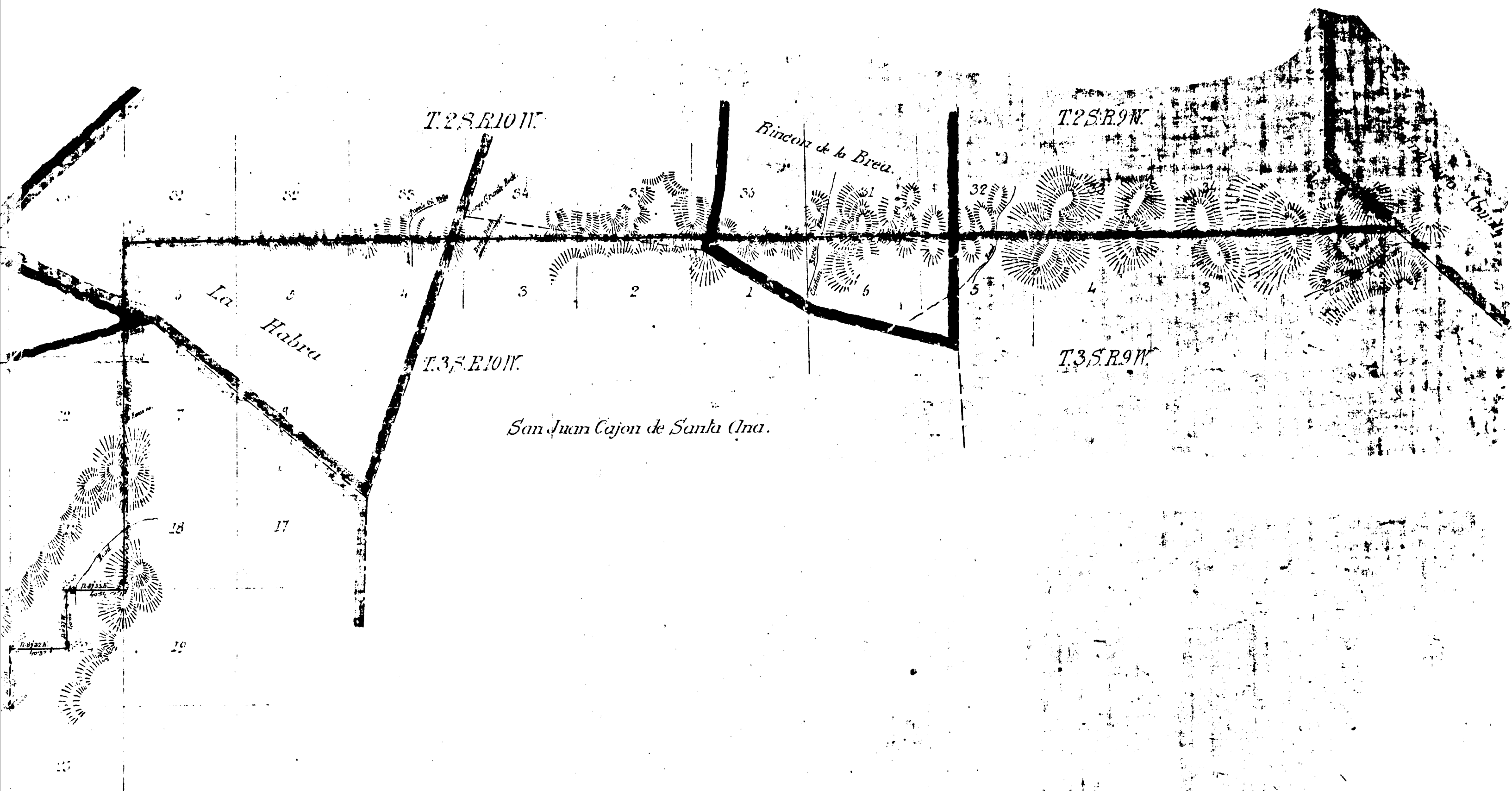

--Map--
 of the --
 -- Division Line between Los Angeles and Orange Counties. --
 -- As surveyed in September 1889, under instructions from the Hon. --
 -- Board of Supervisors of Los Angeles and Orange Counties, by --
 -- S.O. Woods, County Surveyor of Orange County, and E.T. Wright, --
 -- of Los Angeles County. --

Scale - 50 chains to one inch. -

Neg. 670
 INDEX 34
 INDEX 38
 INDEX 39
 INDEX 31

Board of Supervisors

23 - 2 P

W.A. Macdonald

file

R.F.	158
A 2	OF
A 2	