

SURVEY
of the
BOUNDARY LINE
between
LOS ANGELES AND KERN COUNTIES

State of California

BY ORDER OF THE BOARDS OF SUPERVISORS OF THE AFORESAID COUNTIES —
EXECUTED by G.W. ORTH for KERN COUNTY, & Wm. P. REYNOLDS for LOS ANGELES COUNTY

Scale - 80 chs. = 1 in.

R.F. 167
A1 OF A3

KERN

COUNTY

T.9-N R.15-W

T.9-N R.14-W

T.9-N R.13-W

T.9-N R.12-W

T.9-N R.11-W

T.8-N R.15-W

T.8-N R.14-W

T.8-N R.13-W

T.8-N R.12-W

T.8-N R.11-W

LOS

ANGELES

CO

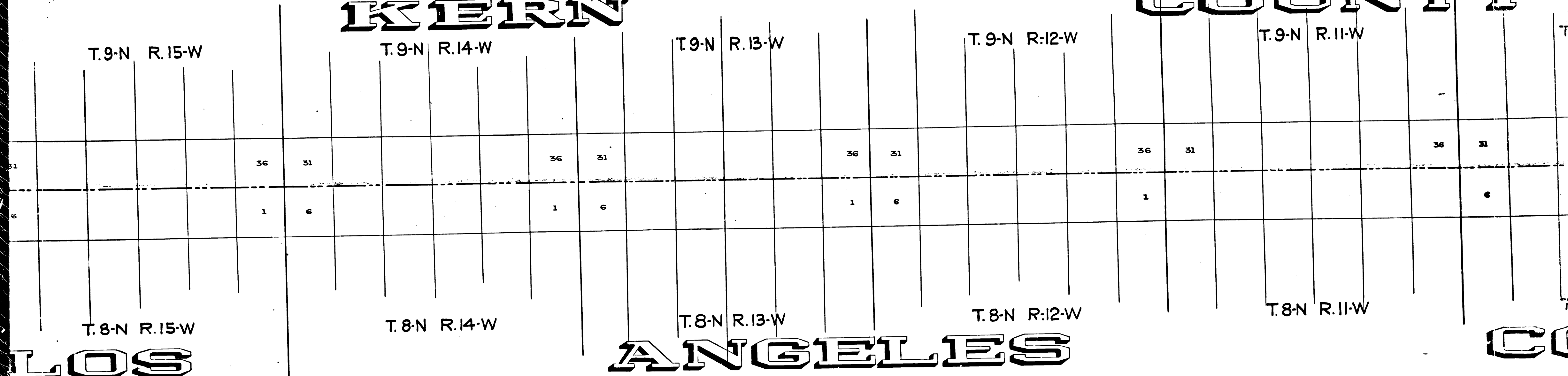

R.F.	167	
A2	OF	A3

6

TY

T.9-N R.10-W

T.9-N R.9-W

T.9-N R.8-W

T.9-N R.7-W

SAN BERNARDINO COUNTY

T.8-N R.10-W

T.8-N R.9-W

T.8-N R.8-W

T.8-N R.7-W

COUNTY

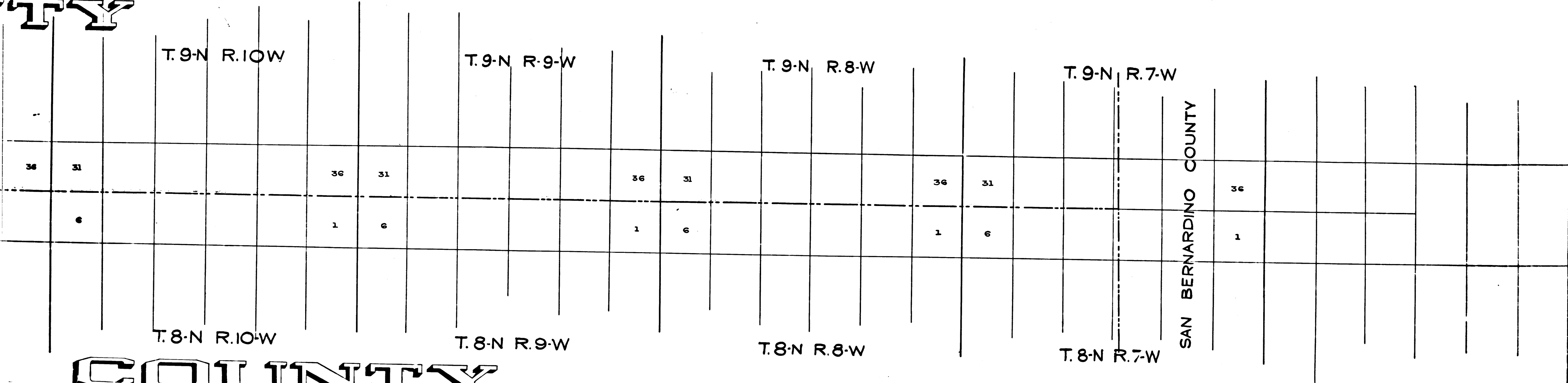

WE HEREBY CERTIFY:

that this is a true and correct plat of the Boundary Line as described in the "Title of this Map," taken from the Field Notes of the same.

_____ SURVEYOR FOR KERN COUNTY.
 _____ SURVEYOR FOR LOS ANGELES COUNTY.

	R.F.	167
A 3	OF	A 3