

*Clay's Subdivision
of Block 11 Carolina Tract
Scale 100 ft. one inch.*

Helena St. changed to Gaffey St. Ord 20312

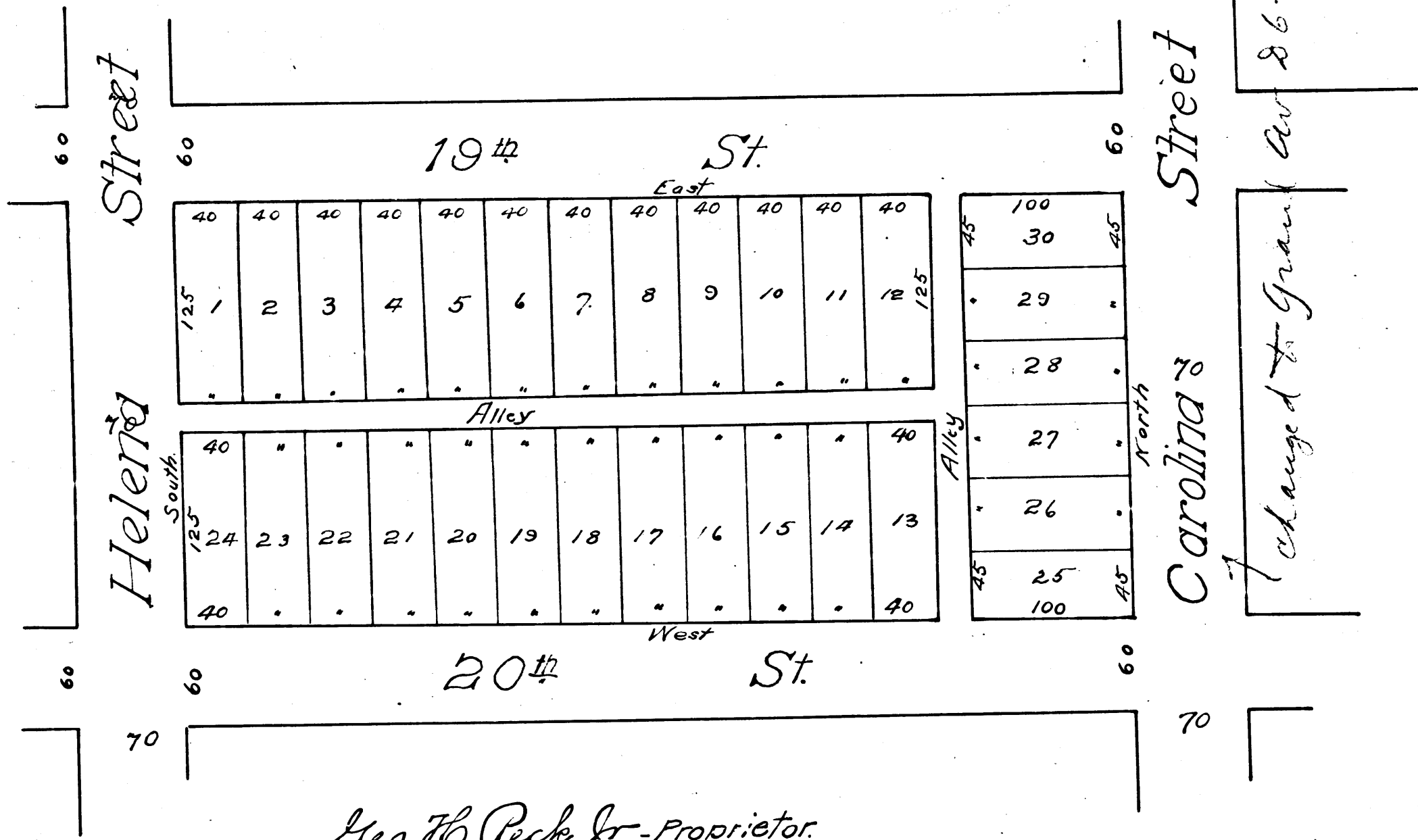

changed to Gaffey Ord 86-294

Geo. H. Peck, Jr. - Proprietor.

*Filed Nov. 12. 1898
at request of Geo. H. Peck.*

R.F. 182