

DORLAND ST.

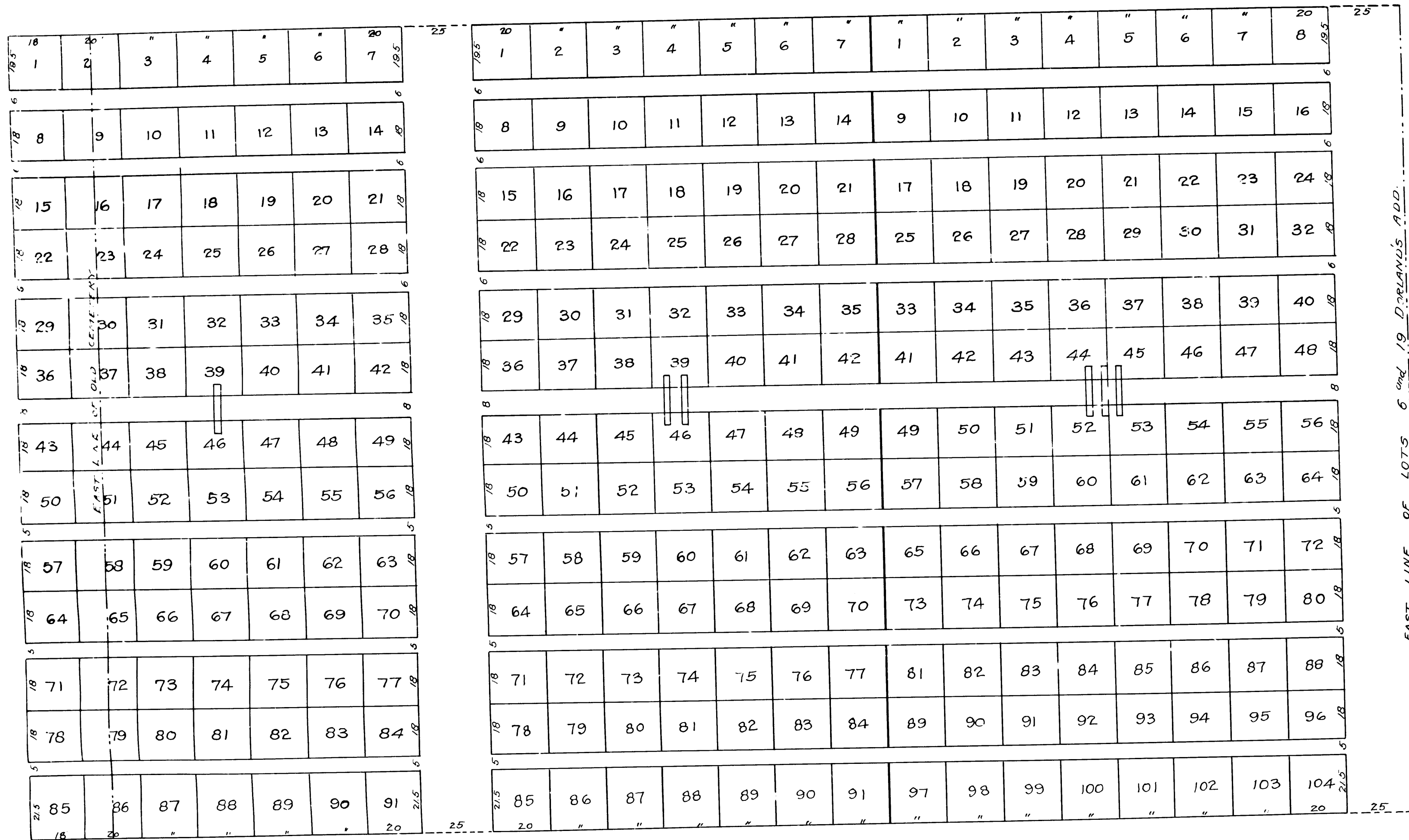

BROADWAY

EAST LINE OF LOTS 6 and 19 DORLANDS ADD.

PLAT
 OF THE
FIRST EXTENSION
 OF THE
WHITTIER CEMETERY ASSOCIATION'S GROUND
Being a Subdivision of Lots 6-7-8-9
16-17-18 and 19 of Block 4 of
Dorland's Addition to Whittier
and a Re Plat of the Easterly 28 feet
of the original Plat of the
Whittier Cemetery Association's Ground
 SCALE 1 in. = 30 ft.

--- Filed Apr. 5, 1904 ---

R.F. 211