

MAP SHOWING THE
 LANDS DEEMED NECESSARY TO
 OF A UNIFORM WIDTH OF 20 FEET
 FROM THE EASTERLY LINE OF
 OF PALERMO AVENUE TOGETHER
 OF LAND TO BE AFFECTED OR
 ASSESSED TO PAY THE DAMAGES

#229

This plat finally confirmed and adopted by the Trustees of South Pasadena, California, was delivered to Frank R. Pierce, Street Superintendent of South Pasadena, California May 31 1905

Alexis Hinckley CITY CLERK.

F. R. Pierce STREET SUPERINTENDENT

KEY
 ——— LAND TO BE TAKEN
 ····· LAND TO BE ASSESSED

MAP BY:
 H. R. POSTLE, City Engineer
 of the City of SOUTH PASADENA CAL.

The map shows the relative location of each of the original lots. Blue lines show the boundary of the assessment district. Figures in block ink show the numbers of the lots and blocks taken. Figures in red ink show the numbers of the subdivisions, additions and tracts.

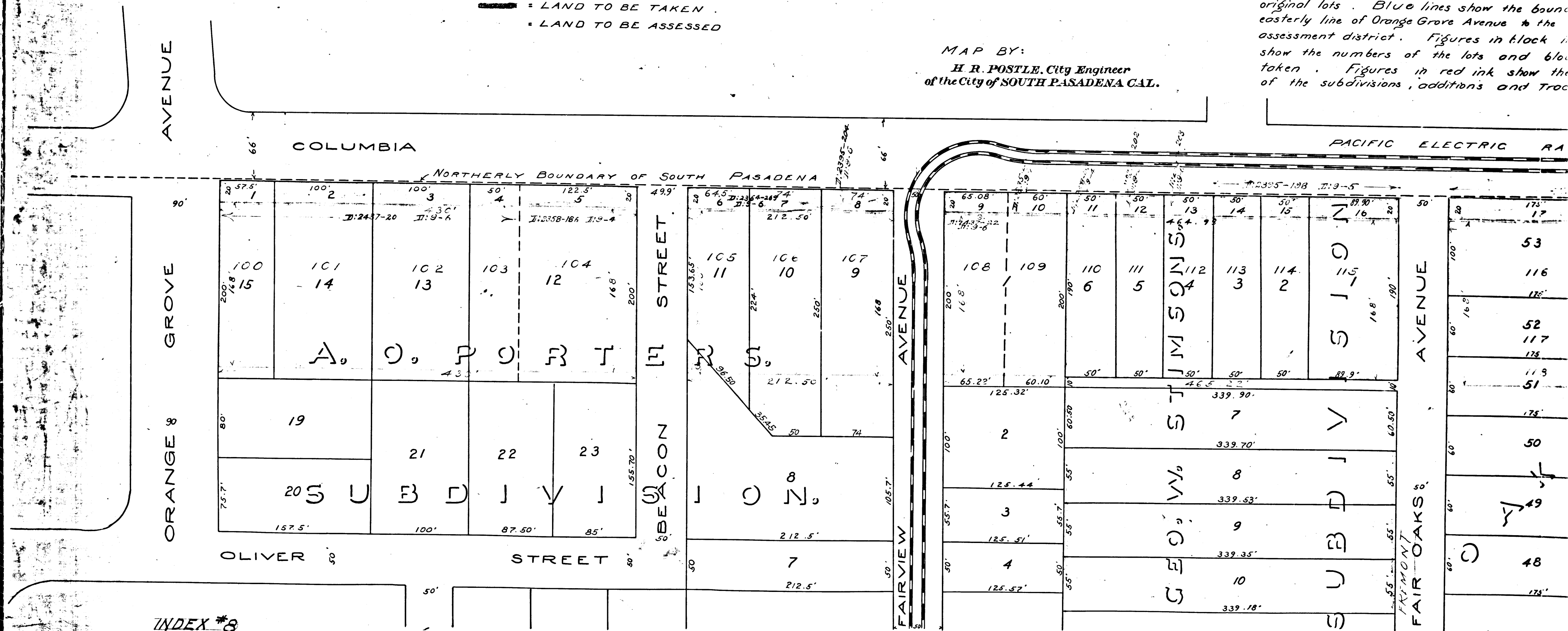

INDEX #3

R.F. 229
 A1 OF A2

MAP SHOWING THE

LANDS DEEMED NECESSARY TO BE TAKEN FOR OPENING A STREET
 OF A UNIFORM WIDTH OF 20 FEET TO BE KNOWN AS **COLUMBIA STREET**
 FROM THE EASTERLY LINE OF ORANGE GROVE AVENUE TO THE WESTERLY LINE
 OF PALERMO AVENUE TOGETHER WITH THE EXTERIOR BOUNDARIES OF THE DISTRICT
 OF LAND TO BE AFFECTED OR BENEFITED BY SAID WORK OR IMPROVEMENT AND TO BE
 ASSESSED TO PAY THE DAMAGES, COST AND EXPENSES THEREOF.

#229

1905
 CLERK.
 ST SUPERINTENDENT

Engineer
 PASADENA CAL.

The map shows the relative location of each district, block, lot, portion or parcel of land assessed, together with its dimensions. Each block, lot or portion of lot taken or assessed is designated and described by the number marked hereon in orange ink. Hereon continuous black lines show original lot lines. Dotted black lines show subdivisions of the original lots. Blue lines show the boundaries of the lands to be taken for the opening of Columbia Street from the easterly line of Orange Grove Avenue to the westerly line of Palermo Avenue. Red lines show the boundaries of the assessment district. Figures in black ink next to lot lines show the lengths of said lines; other figures in black ink show the numbers of the lots and blocks. Figures in blue ink show the dimensions of the lands to be taken. Figures in red ink show the dimensions of the assessment district. Tintings show the boundaries of the subdivisions, additions and tracts named.

THE SCALE OF THE DIAGRAM IS 1 INCH = 60 FEET

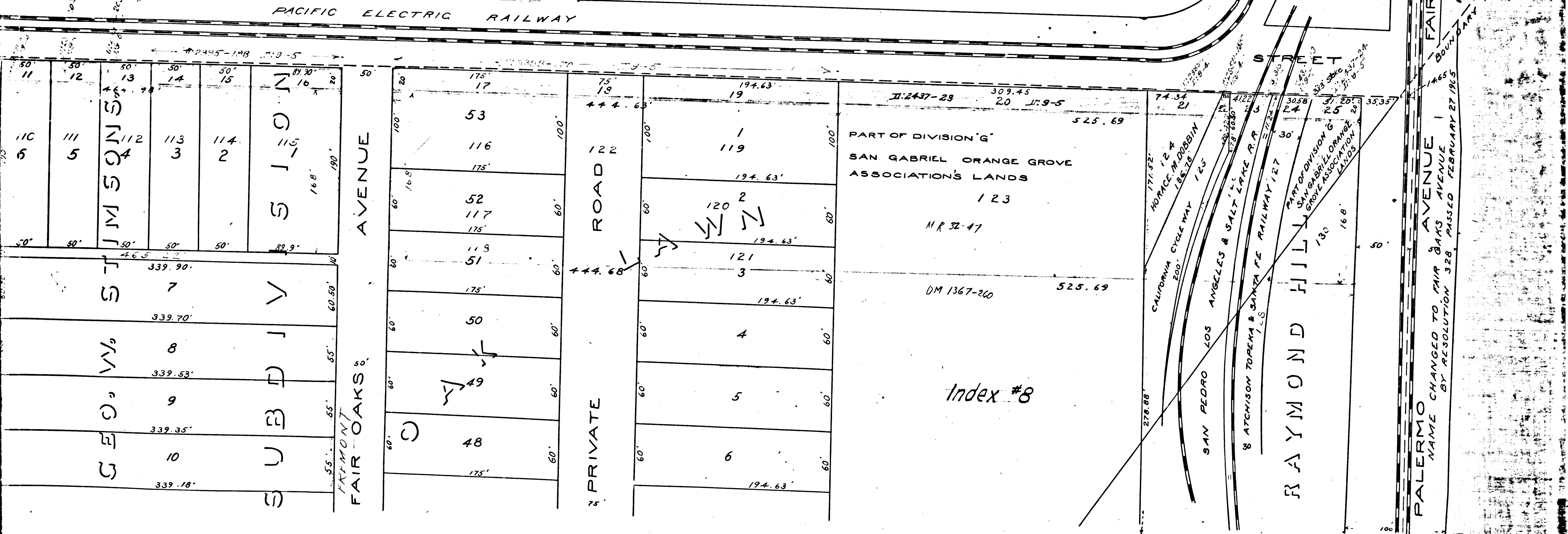
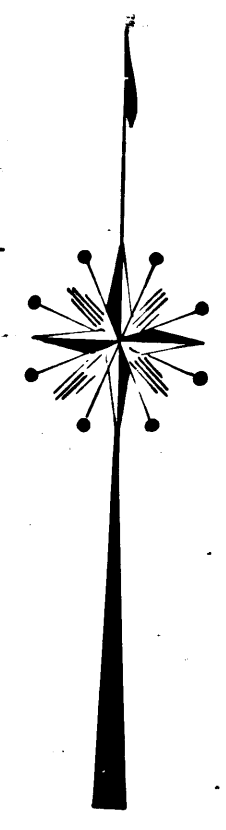

Filed Aug 11 1905

R.F. 229
 A2 OF A2