

# OLIVE AVENUE

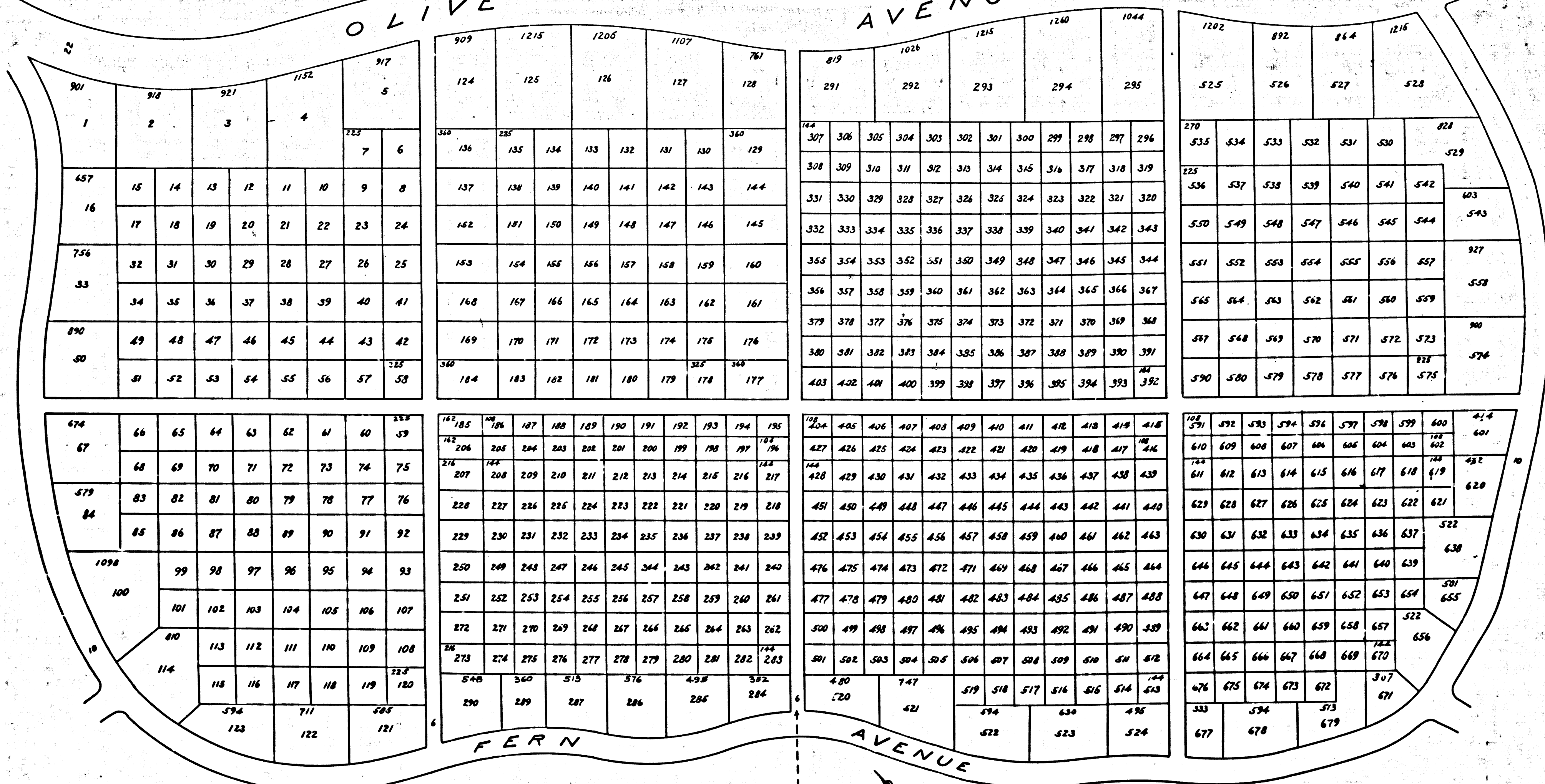

**Section C**  
**Forest Lawn Cemetery.**  
 Forest Lawn Cemetery Association,  
 Tropic Los Angeles Co. Cal.  
 Scale 30 Feet to 1 inch.

January 10<sup>th</sup> 1906

- See map Tr. N. 44° 44' W. 1200 Ft.

North boundary line of L.A.S.P. & S.L. R.R. Right of Way

Filed Jan. 22-1906

R.F. 235