

DIAGRAM

Showing the assessment district of the land to be taken for the opening of a public street in the City of Alhambra, from the Eastern line of Granada Avenue to the Western line of Vega Street; also showing the land assessed and the relative location of each district, block, lot, portion of lot, or parcel of land and their dimensions.
 Each district, lot, portion of lot, or parcel of land taken or assessed is designated and described by the number marked thereon in red ink.

Hereon: the mark means feet; figures in black ink next to property lines show each the length of said lines in feet; other figures in black ink show the numbers of the lots; solid black lines show lot lines; blue lines show land to be taken for the opening of said street; orange tintings show boundaries of the assessment district; all other tintings show the boundaries of subdivisions or portions of subdivisions named.
 The diagram is drawn to a scale of 100 feet to 1 inch.

I hereby certify that this plat was confirmed and adopted by the Board of Trustees of the City of Alhambra in and by its resolution No. 118 adopted this 13th day of Oct-1908.

Street Sup.
 Oct 16 1908
 1 PM

E.E. Salladay
 506

AVENUE

STREET

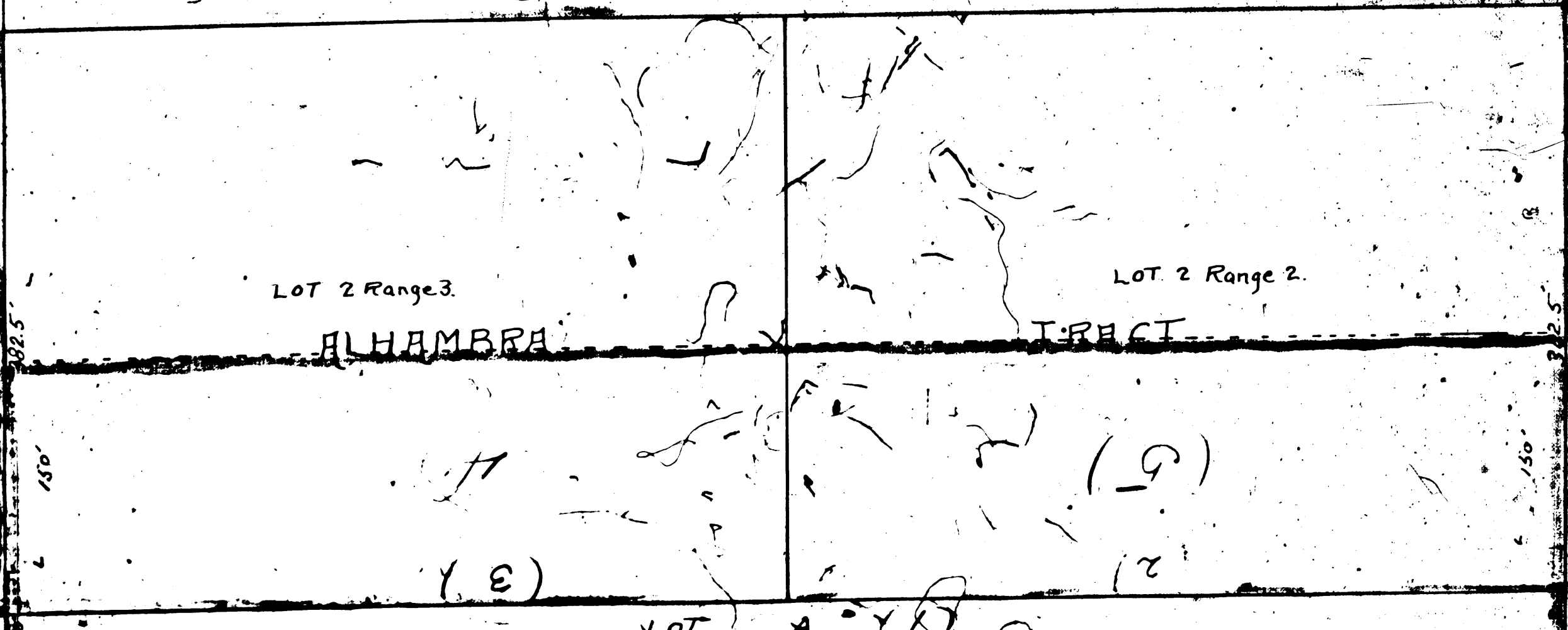

11 18	01 19	57.90	60	6 54	8 55	50	70	7 86	9 87
21 17	01 20		37.95	14 53	16 56	50	50	71 85	11 88
91 16	12 21	50	50	12 52	12 57	50	50	14 84	81 89

GRANADA

VALENCIA

EL MOLINA

VEGA