

Filed in Recorders Office
Feb. 7th 1910 No. 278

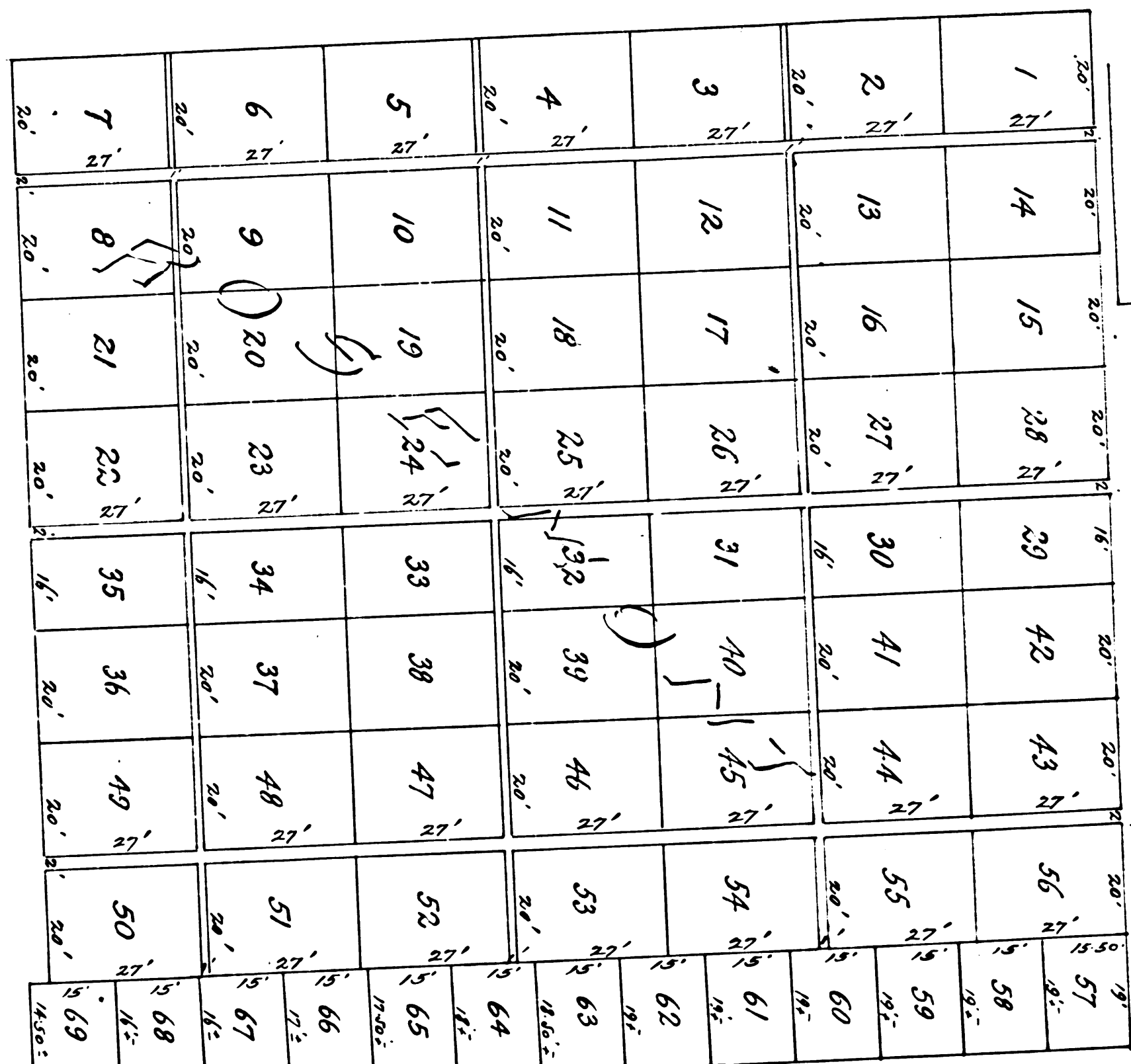

MARIPOSA WALK

NORTH

MARIPOSA Page 1

DRIVE

MARIPOSA

Sierra 5

R.F. 278

Map of
ROSEMONT PLOT
 in the
INGLEWOOD PARK CEMETERY
 located in the
 County of Los Angeles, State of California
 Surveyed in January 1910
 Scale 20 feet to one inch by V. J. A. [Signature] Surveyor