

FILED AT REQUEST OF
Supervisors
MAR. 19. 1914.
At 20 min past 3 P.M.

Assessment Map

Recorder's File Map 4334

Exhibit A

Records Los Angeles Co., Cal.
C. L. LOGAN,
COUNTY RECORDER.
By E.E. Sillady,
Deputy.
Fee Free.

APPROVED AS TO FORM
A. J. HILL,
COUNTY ENGINEER.
Charles E. Haas,
F.A.

413 showing Alignment and Right of Way along Rubio Storm Drain No. 2

FROM SAN PASQUAL ST. SOUTH TO HUNTINGTON DR.

Scale: 1 in = 200 FT.

AUGUST, 1913

LOUIS A. BARTLETT,
Engineer in Charge.

Note: Rubio Storm Drain has been approved by the Board of Supervisors of the County of Los Angeles, California, on August 19, 1913, and the same is shown on the map as filed for record on August 19, 1913.

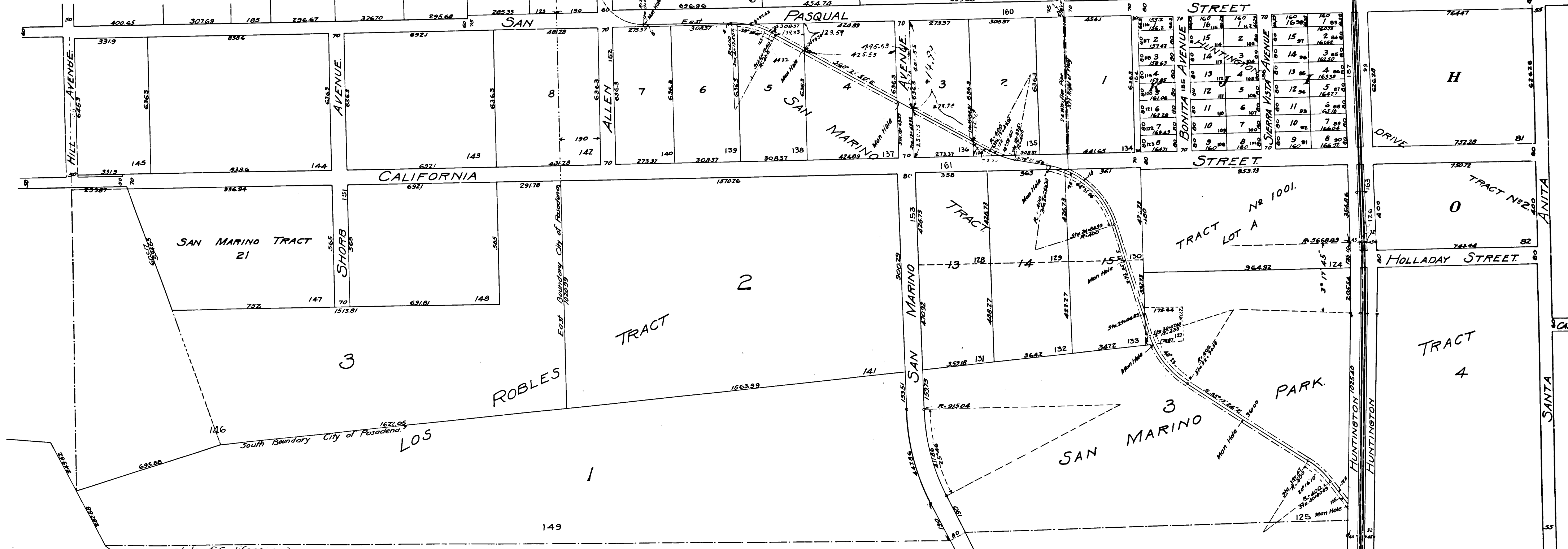

State of California }
County of Los Angeles }
I, H. J. Lelande, County Clerk, and ex officio Clerk of the Board of Supervisors of said County, do hereby certify that the foregoing is a full, true and correct copy of the original Plat accompanying report of Commissioners of Rubio Tract District Number 2, on file in my office, and that I have carefully compared the same with the original. In witness whereof I have hereunto set my hand and affixed the Seal of the Board of Supervisors this eighteenth day of March, 1914. H. J. Lelande, County Clerk and ex officio Clerk of the Board of Supervisors, By A. M. McPherson, Deputy.

R.F. 314