

P A C

R.F. 412

A1 OF A5

IDAHO AVE

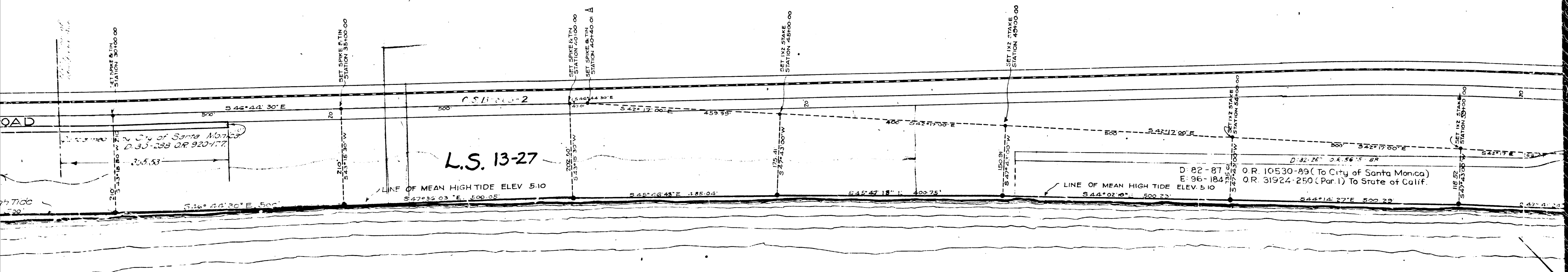

C I F I C CIT

AS ES  
CITY  
No 26  
BY  
ERS

For description of this survey see D. 31-208 O.R. 431-30

R.F. 412  
A2 OF A5

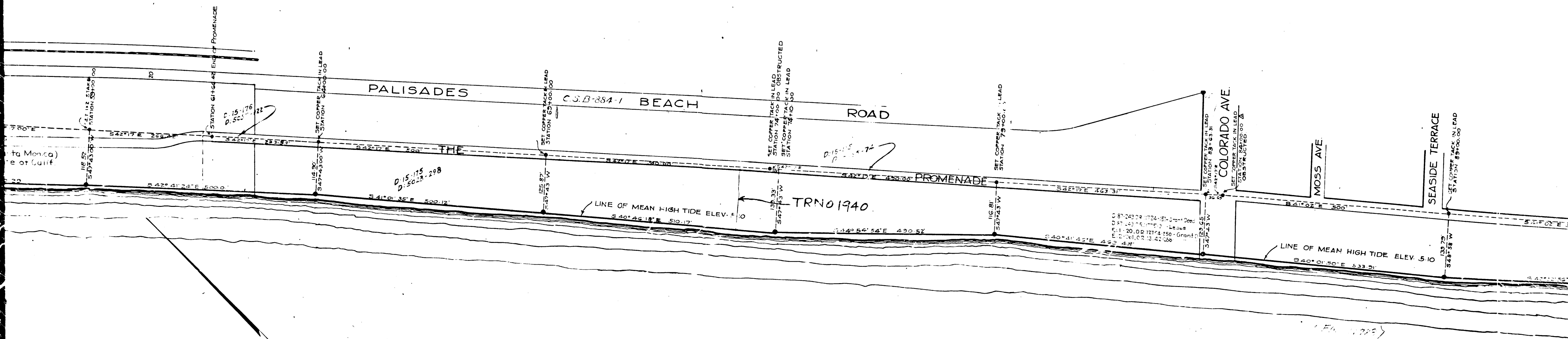

**MAP**  
 SHOWING  
**LINE OF MEAN HIGH TIDE**  
**OF PACIFIC OCEAN**  
 IN THE  
**CITY OF SANTA MONICA**  
**CALIFORNIA**

AS ESTABLISHED BY SURVEY ORDERED BY THE  
 CITY COUNCIL OF SAID CITY BY RESOLUTION  
 No 263, ADOPTED MARCH 11, 1921, AND ADOPTED  
 BY ----- ORDINANCE No 188, COMMISSIONERS  
 SERIES ON JULY 25, 1921.

NOTE: Datum plane is Mean Lower Low Water of Pacific  
 Ocean, as established by the United States Coast  
 and Geodetic Survey and United States Eng-  
 ineer of San Pedro, California.

Surveyed and compiled by Engineering  
 Department, City of Santa Monica, Calif.  
 March 1921 John A. Morton City Engr.  
 Scale 1" = 120'

DRAWING No 0-777

Adopted by the City Council of the City of  
 Santa Monica, at a meeting held July 25, 1921,  
 by Ordinance No 188 (Commissioners Series).

*Frederick S. ...*  
*Deputy*

R.F. 4 | 1 | 2

A 3 | OF | A 5

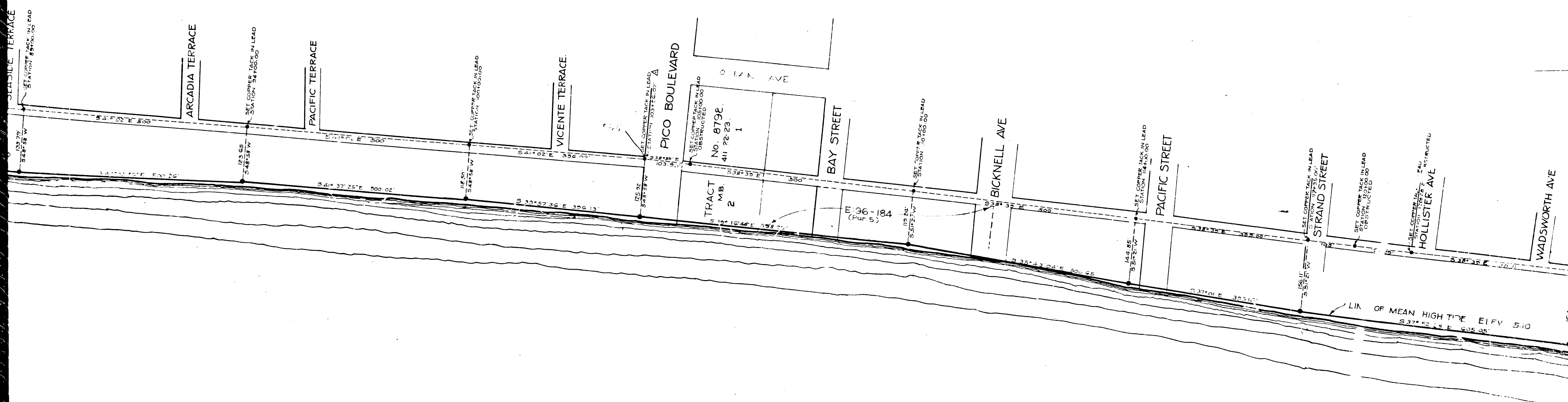

O  
C  
E  
A  
N

R.F. 412  
A4 OF A5

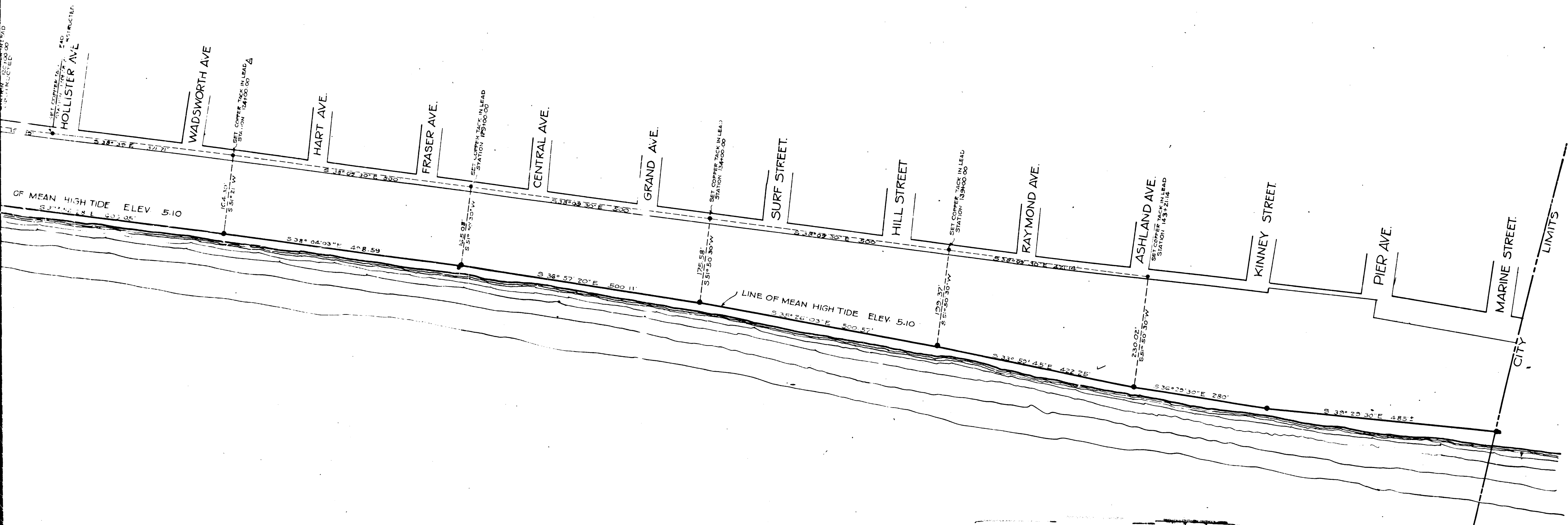

R.F. 412

A5 OF A5