

B4 5
A9 64

STATE OF CALIFORNIA
 TRANSPORTATION AGENCY
 DEPARTMENT OF PUBLIC WORKS
 DIVISION OF HIGHWAYS

Authy
 DEPUTY DISTRICT ENGINEER
 MAY 1, 1967
 DATE

RIGHT OF WAY MAPS OF
STATE HIGHWAY

In Los Angeles County on Route 5 at Gorman U. C.

3233
 RECORDED
 AT REQUEST OF
 DEPT. OF PUBLIC WORKS
 MAY 3, 1967
 4:11 P.M.
 IN BOOK 5
 AT PAGE 64
 OF STATE HIGHWAY MAPS
 LOS ANGELES COUNTY, CALIF.
 RAY E. LEE
 COUNTY RECORDER
 BY *[Signature]*
 Deputy

354 PM

Free

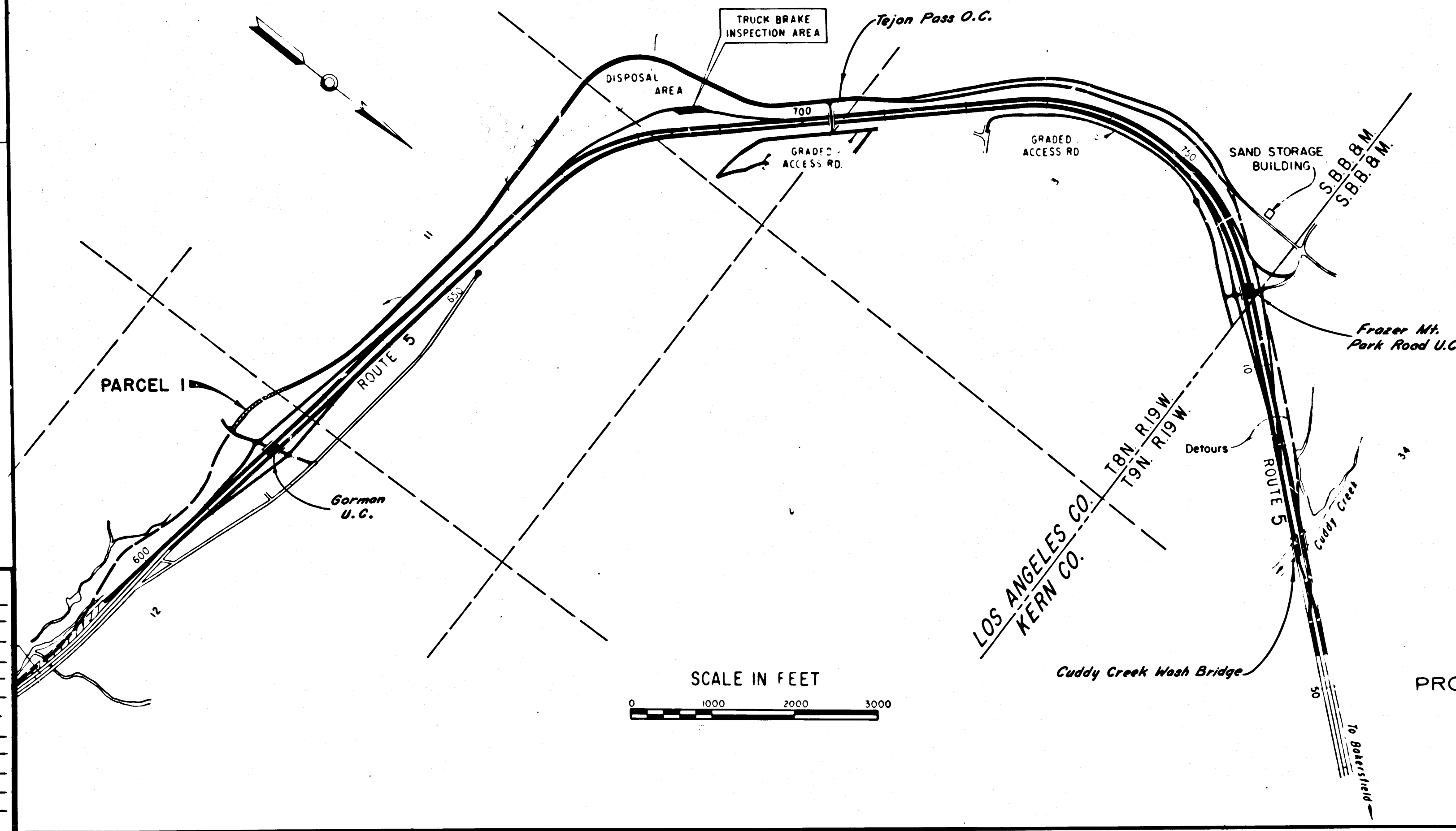

REL-610
 DRN BY *EEH*
 C/LC BY *EEH*
 C/K'D BY *S.L.T.*
 BASE MAP NO'S
F-1326
 REF. MAP NO'S
C.C.M. 31
 BUILT NO'S
186-15

INTERSTATE
 STATE OF CALIFORNIA
 TRANSPORTATION AGENCY
 DEPARTMENT OF PUBLIC WORKS
 DIVISION OF HIGHWAYS
PROPOSED RELINQUISHMENT

