

DIST	COUNTY	ROUTE	POST MILES	SHEET NO.	TOTAL SHEETS
07	L.A.	118	0.0/2.2	1	1

STATE OF CALIFORNIA
 TRANSPORTATION AGENCY
 DEPARTMENT OF PUBLIC WORKS
 DIVISION OF HIGHWAYS

Anthony
 DEPUTY DISTRICT ENGINEER
 July 15, 1968
 DATE

RIGHT OF WAY MAPS OF
STATE HIGHWAY

In the County of Los Angeles between
 the Ventura County Line and the L.A. City Limits

2902
 FILED
 AT REQUEST OF
 DEPT. OF PUBLIC WORKS
 July 19, 1968
 5 PAST 12 P.M.
 IN BOOK 7
 AT PAGE 21
 OF STATE HIGHWAY MAPS
 LOS ANGELES COUNTY, CALIF.
 RAY E. LEE
 COUNTY RECORDER
 BY *Free*
 Deputy

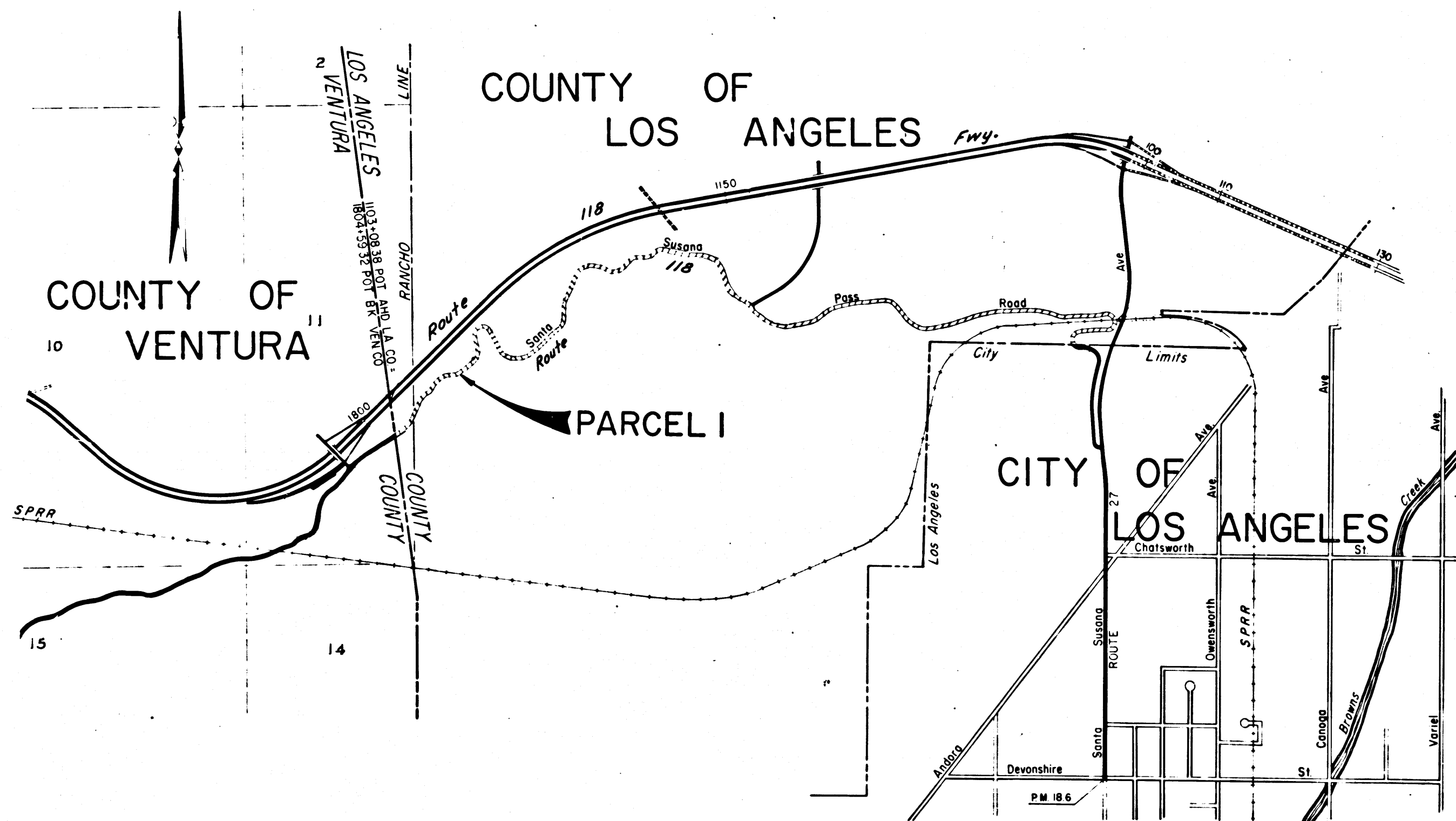

STATE OF CALIFORNIA
 TRANSPORTATION AGENCY
 DEPARTMENT OF PUBLIC WORKS
 DIVISION OF HIGHWAYS

PROPOSED RELINQUISHMENT
 SCALE IN FEET

1000 0 1000 2000

AREA TO BE RELINQUISHED SHOWN THUS

DR'N BY <i>M.A.C.</i>	R/W MAP NO. <i>P-4136</i>
C'LC BY <i>G.D.W.</i>	REF. MAP NO. <i>171-8</i>
C'K'D BY <i>J.L.T.</i>	REL- 671
REVISED	

COUNTY ENGINEER'S COPY