

| DIST | COUNTY | ROUTE | POST MILES | SHEET NO. | TOTAL SHEETS |
|------|--------|-------|------------|-----------|--------------|
| 07 | L.A. | 91 | 17.5/18.8 | 1 | 1 |

Ad. Huelbeck
 DEPUTY DISTRICT ENGINEER
 June 24, 1968
 DATE

2189

FILED
 AT REQUEST OF
 DEPT. OF PUBLIC WORKS
 JULY 9, 1969
 35 MIN 11AM
 BY BOOK 8
 AT PAGE 18
 OF STATE HIGHWAY MAPS
 LOS ANGELES COUNTY, CALIF.
 RAY E. EISE
 COUNTY REGISTRAR
 Fee

STATE OF CALIFORNIA
 TRANSPORTATION AGENCY
 DEPARTMENT OF PUBLIC WORKS
 DIVISION OF HIGHWAYS

RIGHT OF WAY MAPS OF
STATE HIGHWAY
 In the City of Artesia on Artesia Blvd. between
 E. City Limit and W. City Limit of Cerritos

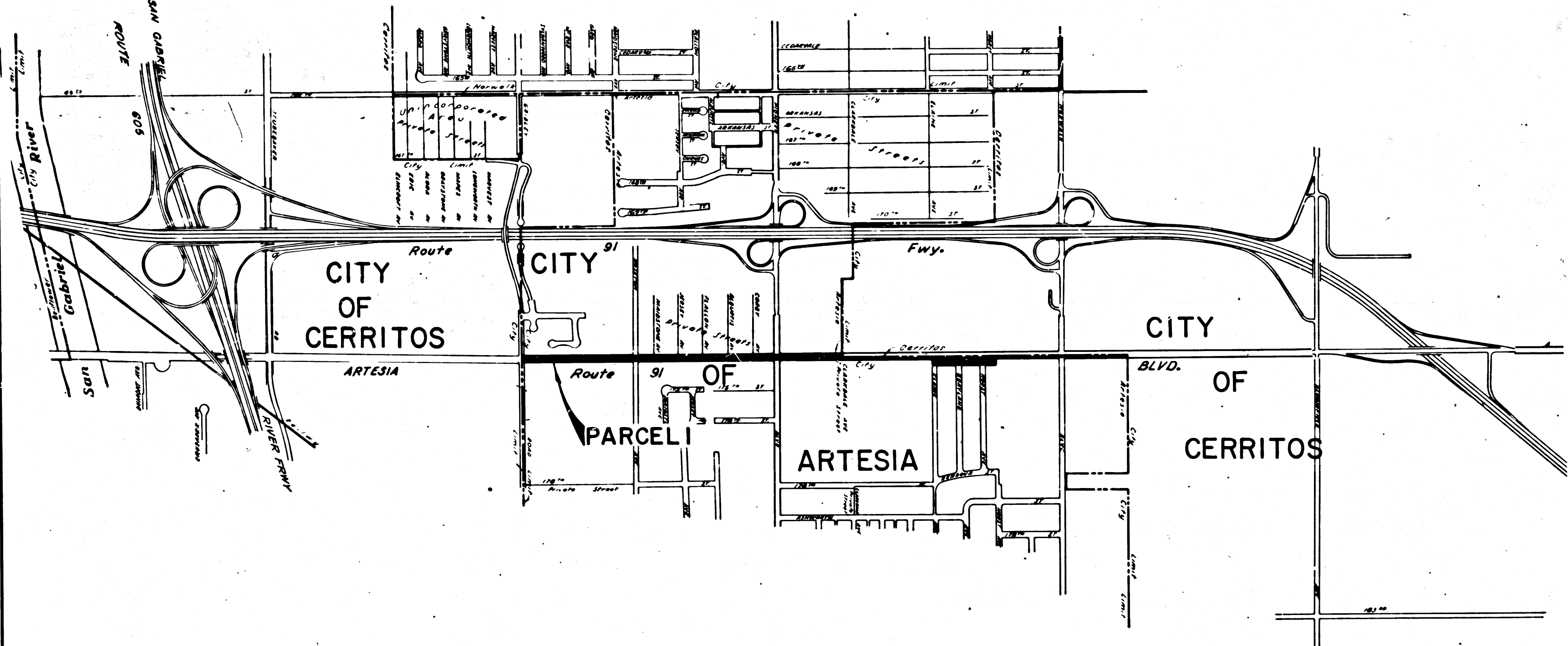
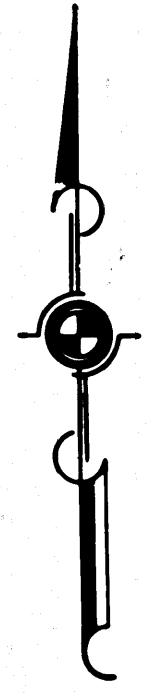

STATE OF CALIFORNIA
 TRANSPORTATION AGENCY
 DEPARTMENT OF PUBLIC WORKS
 DIVISION OF HIGHWAYS
PROPOSED RELINQUISHMENT

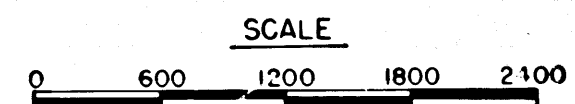

| | |
|------------------------|-----------------|
| DR'N BY <i>M.A.C.</i> | R/W MAP NO. |
| C'LC BY <i>G.H.</i> | REF. MAP NO. |
| C'K'D BY <i>G.D.H.</i> | REL- 733 |
| REVISED | |