

DIST	COUNTY	ROUTE	POST MILES	SHEET NO.	TOTAL SHEETS
07	L.A.	210	41.1/42.1	1	1

STATE OF CALIFORNIA  
 TRANSPORTATION AGENCY  
 DEPARTMENT OF PUBLIC WORKS  
 DIVISION OF HIGHWAYS

*A. J. Hill*  
 DEPUTY DISTRICT ENGINEER  
 DATE Dec. 8, 1969

RIGHT OF WAY MAPS OF  
**STATE HIGHWAY**  
 In the County of Los Angeles on  
 Alostia Ave. between Little Dalton Wash and  
 the West City Limits of Glendora

2143  
 FILED  
 AT REQUEST OF  
 DEPT. OF PUBLIC WORKS  
 FEB. 12, 1970  
 30 MIN. PAST 12 P.M.  
 IN BOOK 8  
 PAGE 75  
 OF STATE HIGHWAY MAPS  
 LOS ANGELES COUNTY, CALIF.  
 RAY E. LEE  
 COUNTY RECORDER  
 Deputy Free

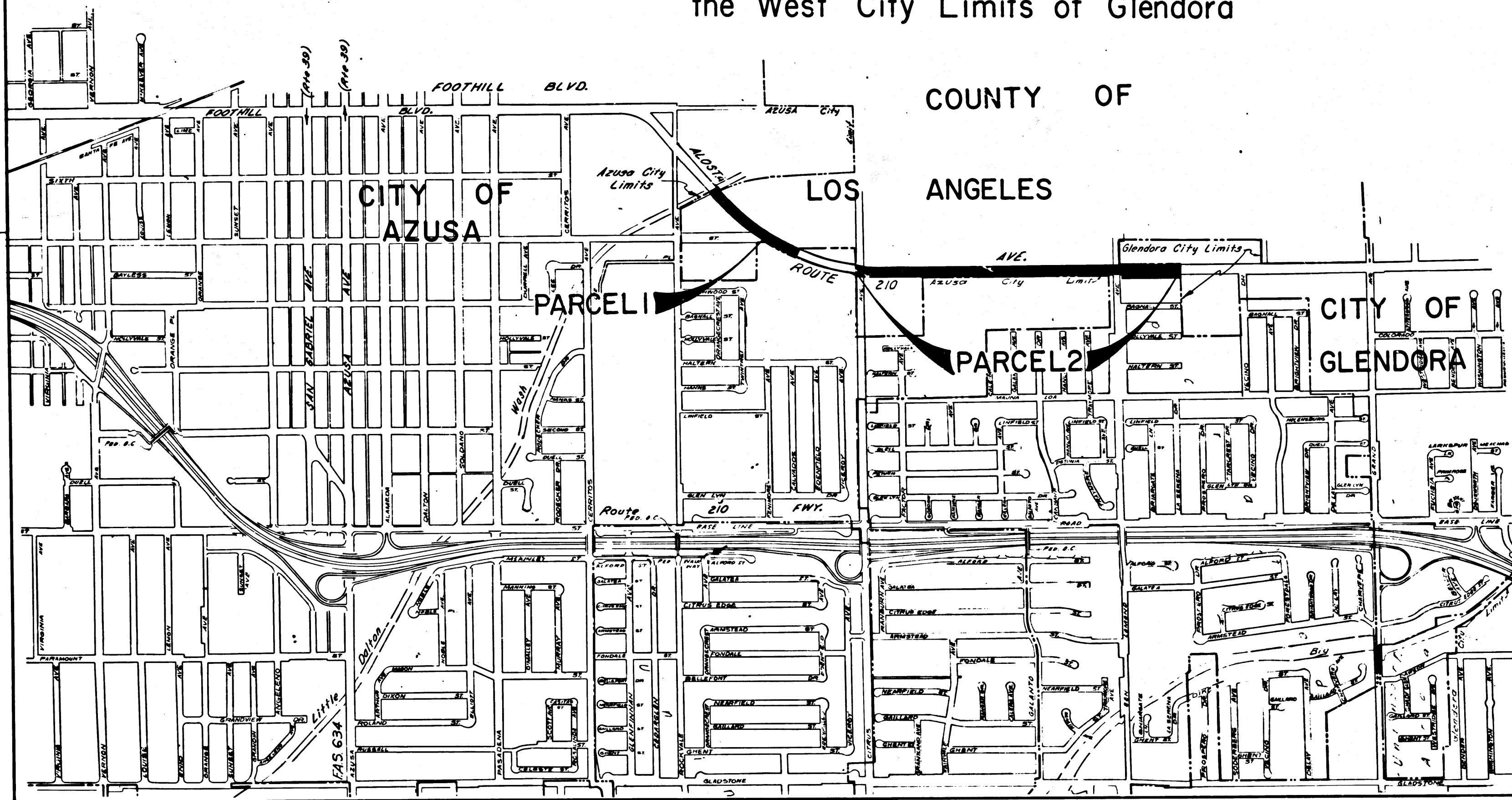

COUNTY OF  
 LOS ANGELES



STATE OF CALIFORNIA  
 TRANSPORTATION AGENCY  
 DEPARTMENT OF PUBLIC WORKS  
 DIVISION OF HIGHWAYS  
**PROPOSED RELINQUISHMENT**  
 SCALE  
 0 600 1200 1800 2400

AREA TO BE RELINQUISHED SHOWN THUS

DR'N BY	M. A. C.	R/W MAP NO.	P 24483
C'LC BY	G. D. W.	REF. MAP NO.	
C'KD BY	G. H.	REL-	757
REVISED	11-16-69		

COUNTY ENGINEER'S COPY

615