

DIST	COUNTY	ROUTE	POST MILES	SHEET NO.	TOTAL SHEETS
07	LA	10	170	1	2

STATE OF CALIFORNIA
 TRANSPORTATION AGENCY
 DEPARTMENT OF PUBLIC WORKS
 DIVISION OF HIGHWAYS

Ad. Hummel
 DEPUTY DISTRICT ENGINEER
 April 7, 1970
 DATE

RIGHT OF WAY MAPS OF
 STATE HIGHWAY

2333

In the City of Los Angeles
 at Mc Garry St.

FILED
 AT REQUEST OF
 DEPT. OF PUBLIC WORKS
 MAY 18, 1970
 MIN. 12 PAST
 12 P.M.
 IN BOOK 8
 AT PAGE 98
 OF STATE HIGHWAY MAPS
 LOS ANGELES COUNTY, CALIF.
 RAY E. JEE
 COUNTY RECORDER
 Deputy
 FRC

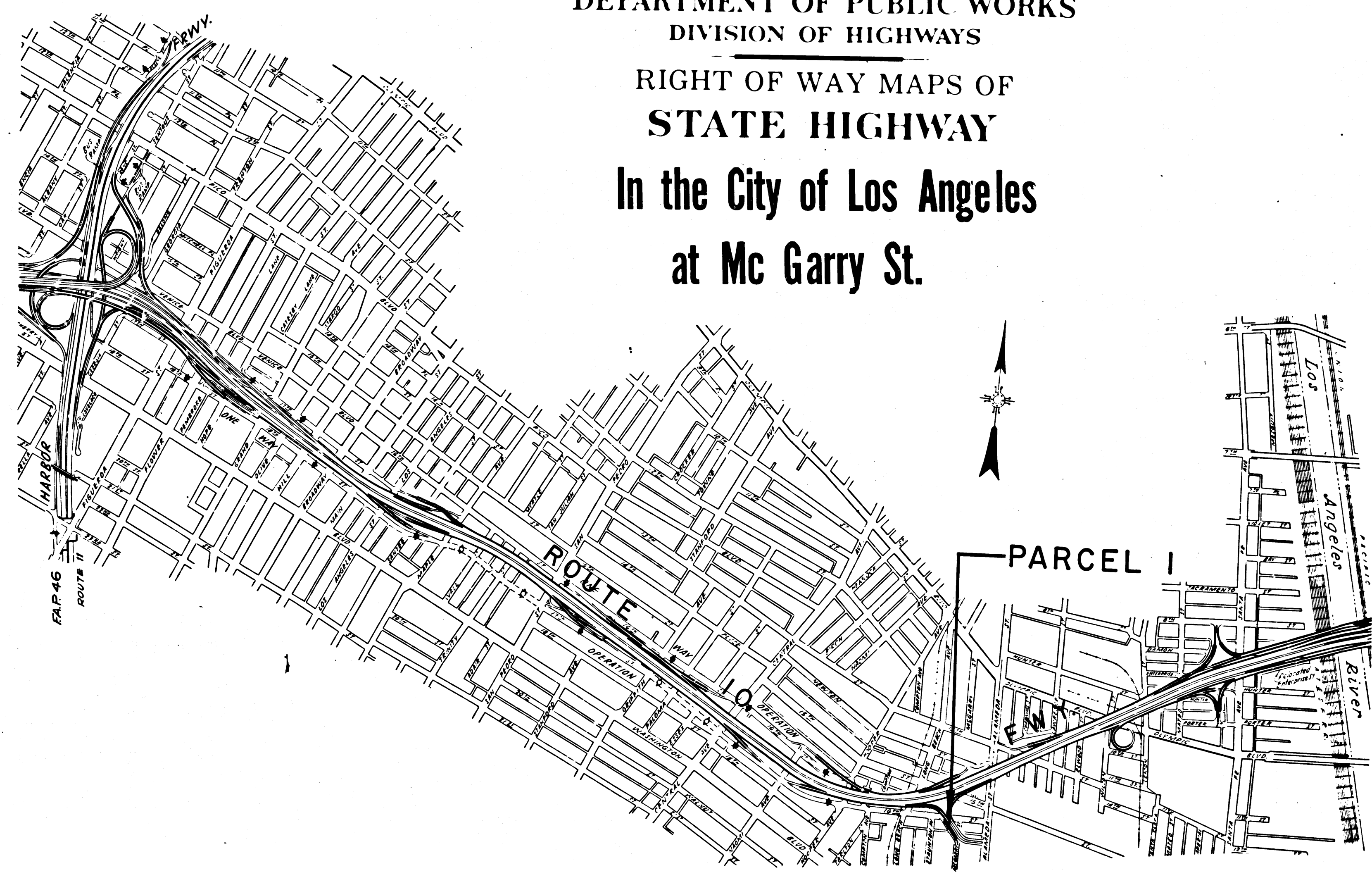

INTERSTATE
 STATE OF CALIFORNIA
 TRANSPORTATION AGENCY
 DEPARTMENT OF PUBLIC WORKS
 DIVISION OF HIGHWAYS
 PROPOSED RELINQUISHMENT

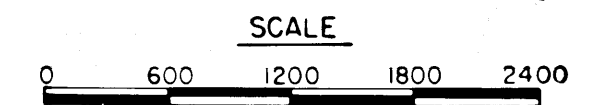

DR'N BY	O.F.J.	R/W MAP NO.	F-2081-
C'LC BY	O.F.J.	REF. MAP NO.	134-B
C'K'D BY	G.H.		REL- 783
REVISED			

COUNTY ENGINEER'S COPY

8/98

