

STATE OF CALIFORNIA
TRANSPORTATION AGENCY
DEPARTMENT OF PUBLIC WORKS
DIVISION OF HIGHWAYS

RIGHT OF WAY MAPS OF
STATE HIGHWAY
In the City of Compton at Atlantic Ave. Undercrossing.

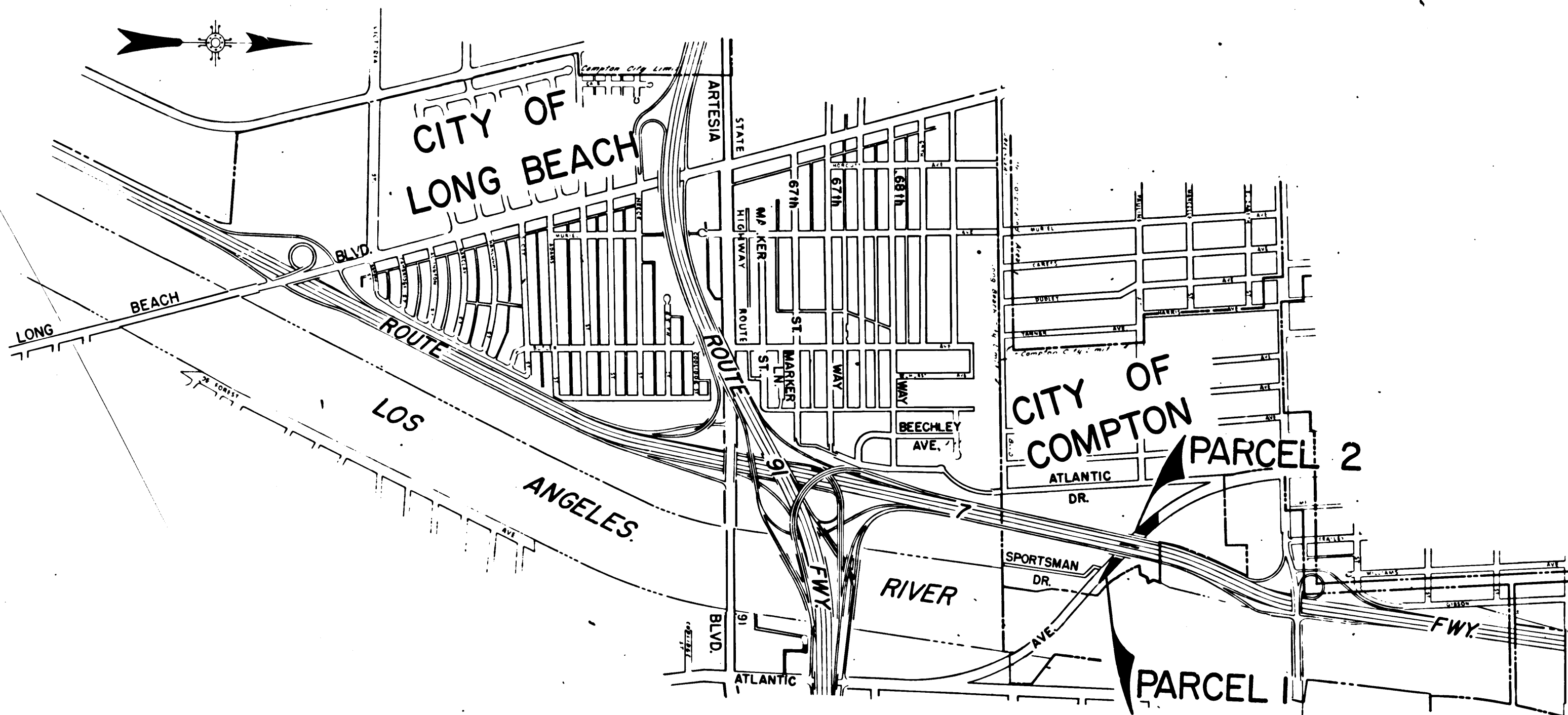

DIST	COUNTY	ROUTE	POST MILES	SHEET NO.	TOTAL SHEETS
07	L.A.	7	13.6	1	2

A. L. Hummelbock
DEPUTY DISTRICT ENGINEER
REGISTERED CIVIL ENGINEER NO. 6416
August 9, 1971
DATE

FILED
AT REQUEST OF
DEPT. OF PUBLIC WORKS
NOV. 15, 1971
MAIL
5 PM
2 PM
IN BOOK 70
AT PAGE
OF STATE HIGHWAY MAPS
LOS ANGELES COUNTY, CALIF.
COUNTY RECORDER
FPP

STATE OF CALIFORNIA
TRANSPORTATION AGENCY
DEPARTMENT OF PUBLIC WORKS
DIVISION OF HIGHWAYS
PROPOSED RELINQUISHMENT

SCALE
0 600 1200 1800 2400

DR'N BY <i>L.W.K.</i>	R/W MAP NO. <i>F/1517</i>
C'LC BY <i>O.K.F.</i>	REF. MAP NO. <i>185-5</i>
C'K'D BY <i>H.L.</i>	REL-823
REVISED <i>6-28-71</i>	

CITY OF COMPTON

Detail A

Not to Scale

PARCEL 2

PARCEL 1

TRACT NO. 561

M. B. 15 / 49

LOT A

FILED WITH LOS ANGELES
COUNTY RECORDER
NOV 15 1971

DIST	COUNTY	ROUTE	POST MILES	SHEET NO	TOTAL SHEETS
07	L.A.	7	13.6	2	2

R.W. Felt
DISTRICT RIGHT OF WAY ENGINEER
August 9, 1971
DATE

STATE OF CALIFORNIA
TRANSPORTATION AGENCY
DEPARTMENT OF PUBLIC WORKS
DIVISION OF HIGHWAYS
PROPOSED RELINQUISHMENT

0 50 100 150 200

AREA TO BE RELINQUISHED SHOWN THUS 
ACCESS PROHIBITED 

DR'N BY <i>L.W.K.</i>	R/W MAP NO <i>F-1517</i>
C'LC BY <i>D.D.</i>	REF MAP NO <i>185-5</i>
C'K'D BY <i>H.L.</i>	REL-823
REVISED <i>6-28-71</i>	

COUNTY ENGINEER'S COPY