

DIST	COUNTY	ROUTE	POST MILES	SHEET NO.	TOTAL SHEETS
07	LA	210	30.1/30.2	1	2

STATE OF CALIFORNIA  
 TRANSPORTATION AGENCY  
 DEPARTMENT OF PUBLIC WORKS  
 DIVISION OF HIGHWAYS

*A. Hamilton*  
 DEPUTY DISTRICT ENGINEER  
 REGISTERED CIVIL ENGINEER NO. 6416  
 November 3, 1972  
 DATE

RIGHT OF WAY MAPS OF  
 STATE HIGHWAY

In the City of Pasadena Along Foothill Blvd. (Route 210)  
 Between Quigley Ave. and Michillinda Ave.

FILED  
 AT REQUEST OF  
 DEPT. OF PUBLIC WORKS  
 JAN. 23, 1973  
 47 PAST 2 PM  
 IN BOOK 10  
 AT PAGE 64  
 OF STATE HIGHWAY MAPS  
 LOS ANGELES COUNTY, CALIF.  
 COUNTY RECORDER  
 Denny  
 FFC

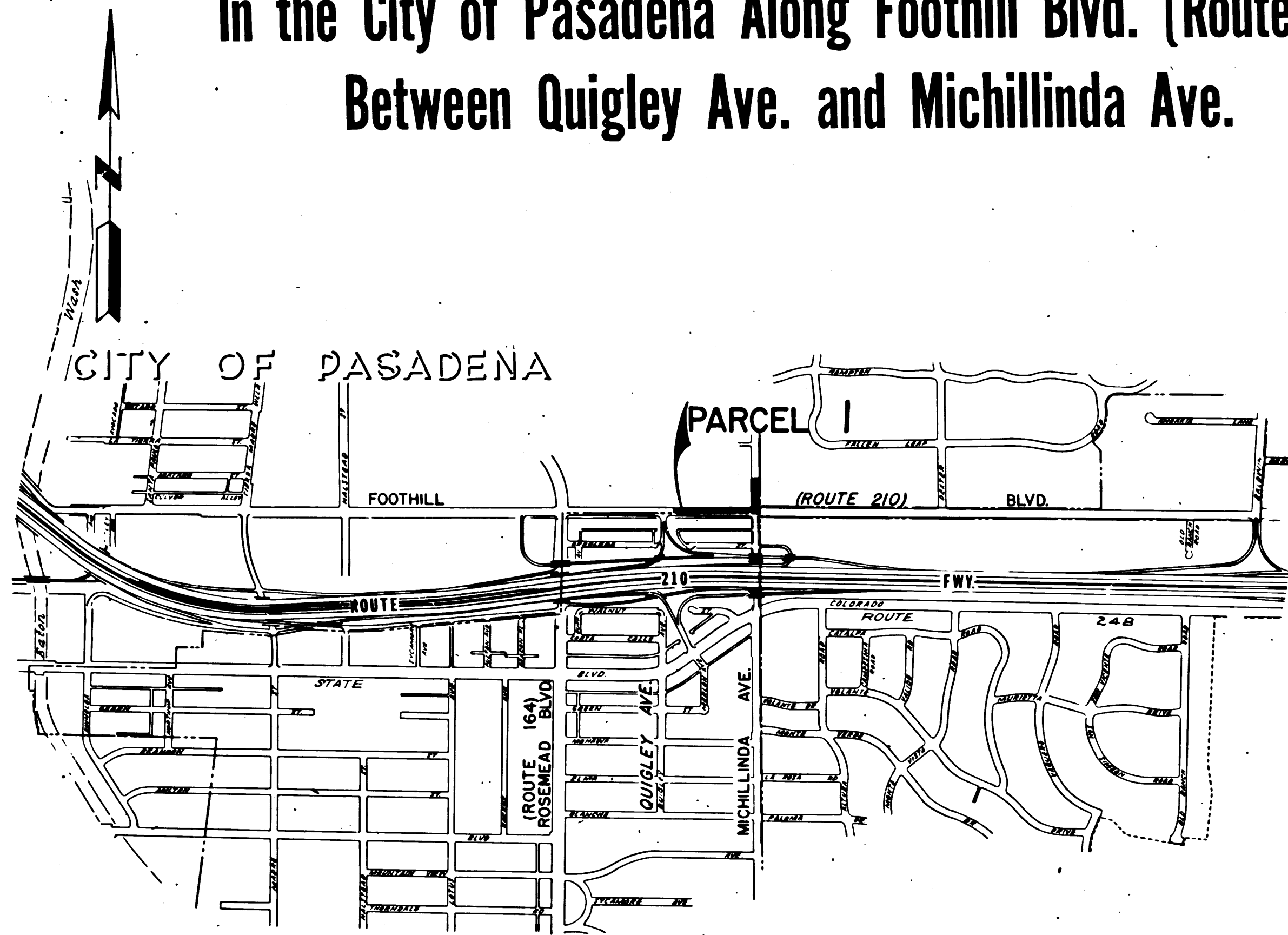

STATE OF CALIFORNIA  
 TRANSPORTATION AGENCY  
 DEPARTMENT OF PUBLIC WORKS  
 DIVISION OF HIGHWAYS

PROPOSED RELINQUISHMENT

SCALE  
 0 600 1200 1800 2400

AREA TO BE RELINQUISHED SHOWN THUS ████████

DR'N BY	J. Q.	R/W MAP NO.	F1219
C'LC BY	J. M.	CONTRACT NO.	033274
C'K'D BY	H. L.	REL-	861
REVISED			

10/64-65

FILED WITH LOS ANGELES COUNTY RECORDER  
 JAN 23 1973

DIST	COUNTY	ROUTE	POST MILES	SHEET NO.	TOTAL SHEETS
07	LA	210	301/302	2	2

*Carl B. Mordley*  
 DISTRICT RIGHT OF WAY ENGINEER  
 November 3, 1972  
 DATE

CITY OF PASADENA



PARCEL I

TRACT NO. 12129

M.B. 230-18

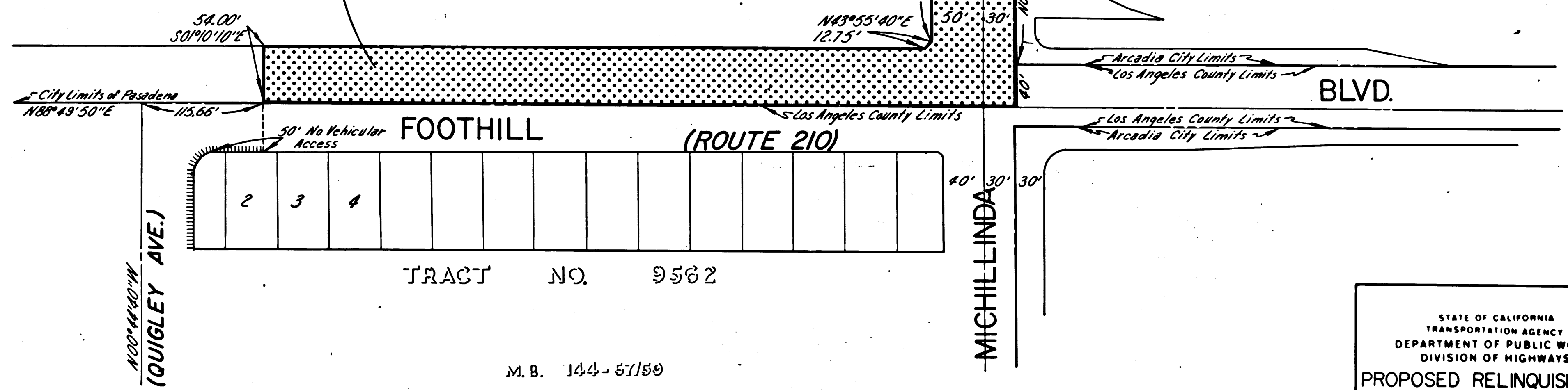

STATE OF CALIFORNIA  
 TRANSPORTATION AGENCY  
 DEPARTMENT OF PUBLIC WORKS  
 DIVISION OF HIGHWAYS

**PROPOSED RELINQUISHMENT**

0 50 100 150 200

AREA TO BE RELINQUISHED SHOWN THUS

ACCESS PROHIBITED

DR'N BY J. Q.	R/W MAP NO. F1219
C'L.C BY J. M.	CONTRACT NO. 033274
C'D BY H. L.	REL-861
REVISED	