

DIST	COUNTY	ROUTE	POST MILES	SHEET NO.	TOTAL SHEETS
07	LA	210	30.1/30.2	1	2

STATE OF CALIFORNIA
 TRANSPORTATION AGENCY
 DEPARTMENT OF PUBLIC WORKS
 DIVISION OF HIGHWAYS

A. L. Hummelbock
 DEPUTY DISTRICT ENGINEER
 REGISTERED CIVIL ENGINEER NO. 6416
 May 24, 1973
 DATE

RIGHT OF WAY MAPS OF
 STATE HIGHWAY

In the County of Los Angeles On Foothill Blvd. (Rte. 210)
 bet Quigley Ave. and Michillinda Ave.

2581

FILED
 AT REQUEST OF
 DEPT. OF PUBLIC WORKS
 SEPT. 4, 1973
 1 M.P.
 PAST 2 PM
 IN BOOK 11
 PAGE 25
 OF STATE HIGHWAY MAPS
 LOS ANGELES COUNTY, CALIF.
 COUNTY RECORDER
 Deputy *Free*

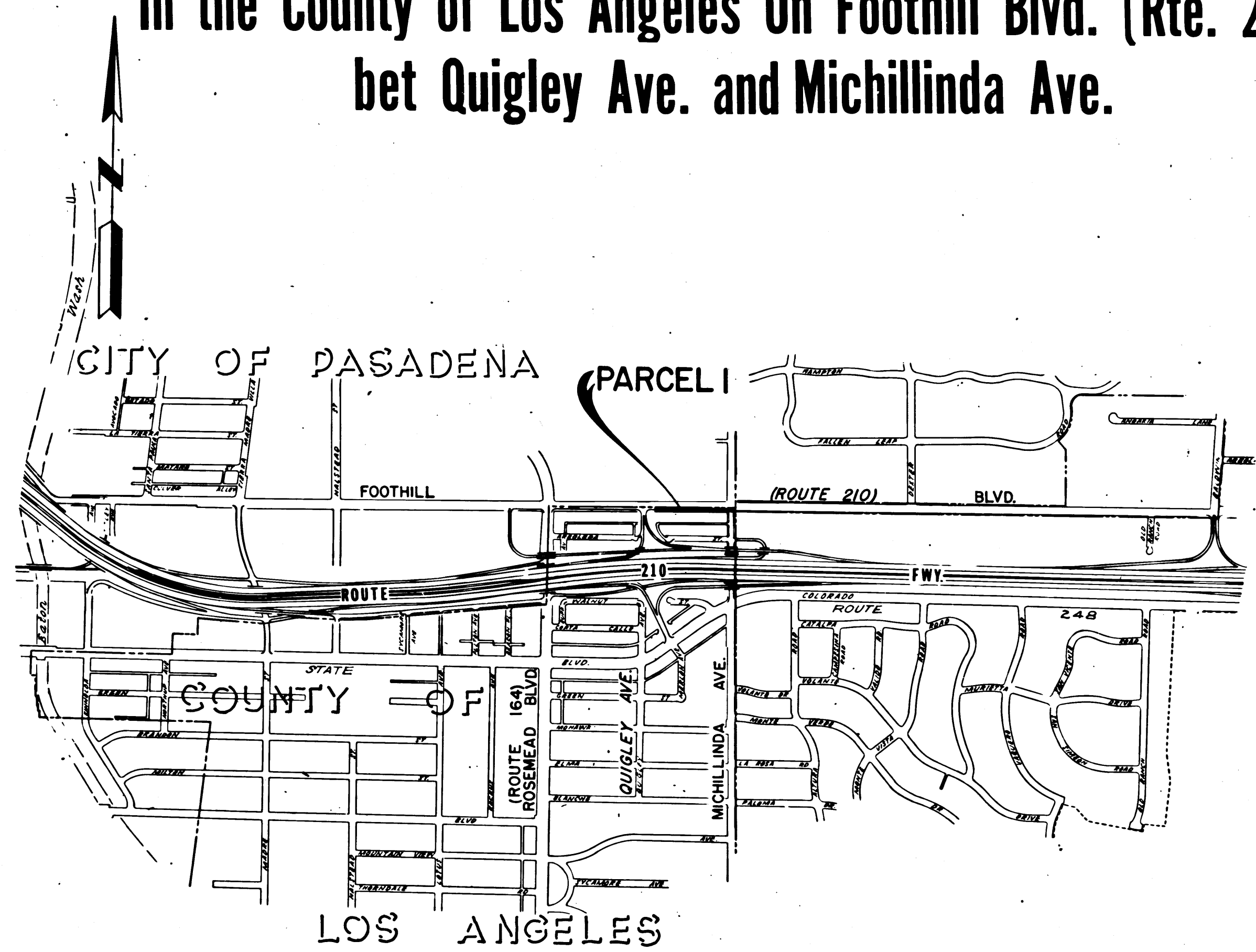

STATE OF CALIFORNIA
 TRANSPORTATION AGENCY
 DEPARTMENT OF PUBLIC WORKS
 DIVISION OF HIGHWAYS

PROPOSED RELINQUISHMENT

SCALE
 0 600 1200 1800 2400

AREA TO BE RELINQUISHED SHOWN THUS

DR'N BY H.L.	R/W MAP NO. F1219
C'LC BY A.M.	CONTRACT NO. 033274
C'K'D BY H.W.	REL-927
REVISED	

11/25-24
 COUNTY ENGINEER'S COPY

DIST	COUNTY	ROUTE	POST MILES	SHEET NO	TOTAL SHEETS
07	LA	210	301/302	2	2

Carl B. Wozniak
 DISTRICT RIGHT OF WAY ENGINEER
 REGISTERED CIVIL ENGINEER NO. 14734
 May 24, 1973
 DATE

FILED WITH LOS ANGELES
 COUNTY RECORDER
 SEP 4 1973



CITY OF PASADENA

PARCEL - 1

FOOTHILL 54

(ROUTE 210)

S. 88° 32' 52" W.
30.00'

BLVD.

LOS ANGELES COUNTY LIMITS

CITY LIMITS OF PASADENA N. 88° 49' 50" E. 698.95'

N. 88° 32' 52" E.

CITY LIMITS OF ARCADIA

NO VEHICULAR
 ACCESS 52.46'

S. 01° 10' 10" E.
46.00'

S. 88° 49' 50" W. 698.85'

N. 00° 44' 40" W.
 QUIGLEY AVE.

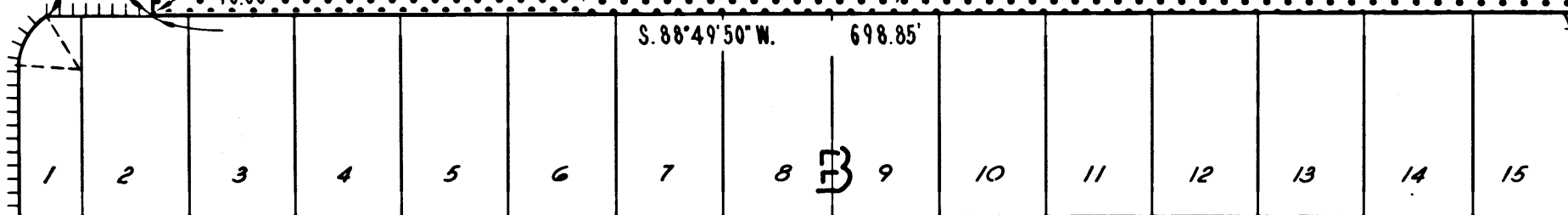

TRACT NO. 9562

M. B. 144-57/59

COUNTY OF LOS ANGELES

50'
 AVE.

N. 00° 55' 23" W.

CITY LIMITS OF PASADENA

CITY LIMITS OF ARCADIA

46'
 30'

N. 88° 55' 50" E.
 30.00'

N. 01° 04' 10" W.
 MICHELLIN AVE.

46.20'
 N. 01° 04' 10" E.

STATE OF CALIFORNIA
 TRANSPORTATION AGENCY
 DEPARTMENT OF PUBLIC WORKS
 DIVISION OF HIGHWAYS

PROPOSED RELINQUISHMENT

0 50 100 150 200

AREA TO BE RELINQUISHED SHOWN THUS

ACCESS PROHIBITED

DR'N BY H.L.	R/W MAP NO. F-1219
C'LC BY A.M.	CONTRACT NO. 07-033274
C'K'D BY H.W.	REL-927
REVISED	