

STATE OF CALIFORNIA  
 BUSINESS AND TRANSPORTATION AGENCY  
 DEPARTMENT OF TRANSPORTATION

RIGHT OF WAY MAPS OF  
 STATE HIGHWAY  
 In the City of Glendale,  
 Along Rte. 134 Fwy.,  
 At Orange St.

BOOK 15 PAGE 75

DIST	COUNTY	ROUTE	POST MILES	SHEET NO.	TOTAL SHEETS
07	LA	134	7.0	1	1

*C.B. Wallace*  
 RIGHT OF WAY ENGINEERING  
 REGISTERED CIVIL ENGINEER NO. 14117  
 DATE 11-1-77

Recorded in the Office  
 of the County Recorder  
 LOS ANGELES COUNTY  
 S.H.M.B. No. Pg.  
 77-1251259

FILED  
 AT REQUEST OF  
 DEPT. OF PUBLIC WORKS  
 NOV. 18, 1977  
 H. PAST 11 A.M.  
 COUNTY CLERK  
 LOS ANGELES COUNTY CALIF.

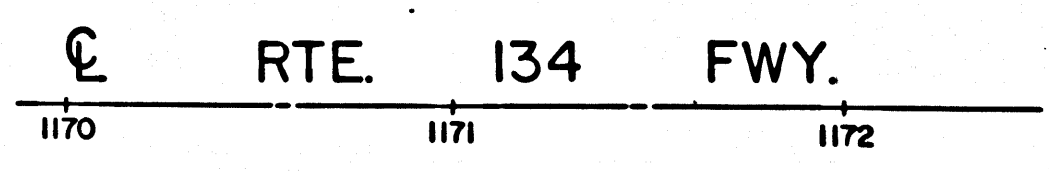
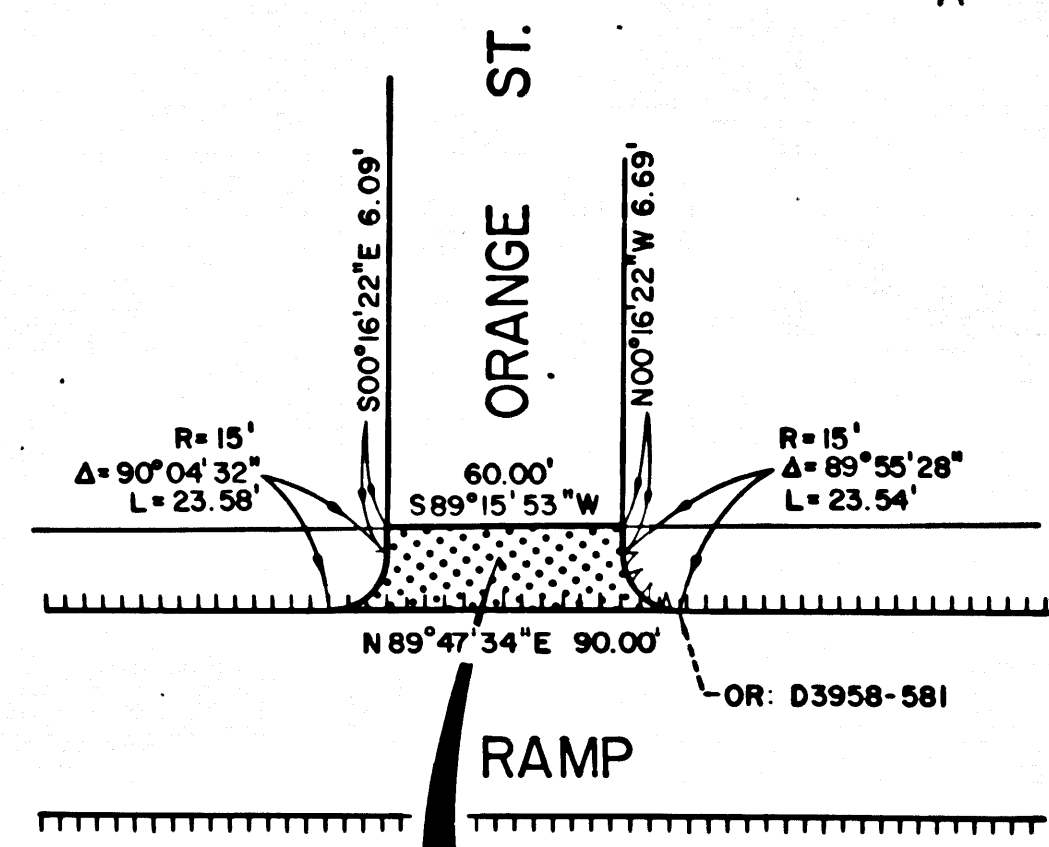
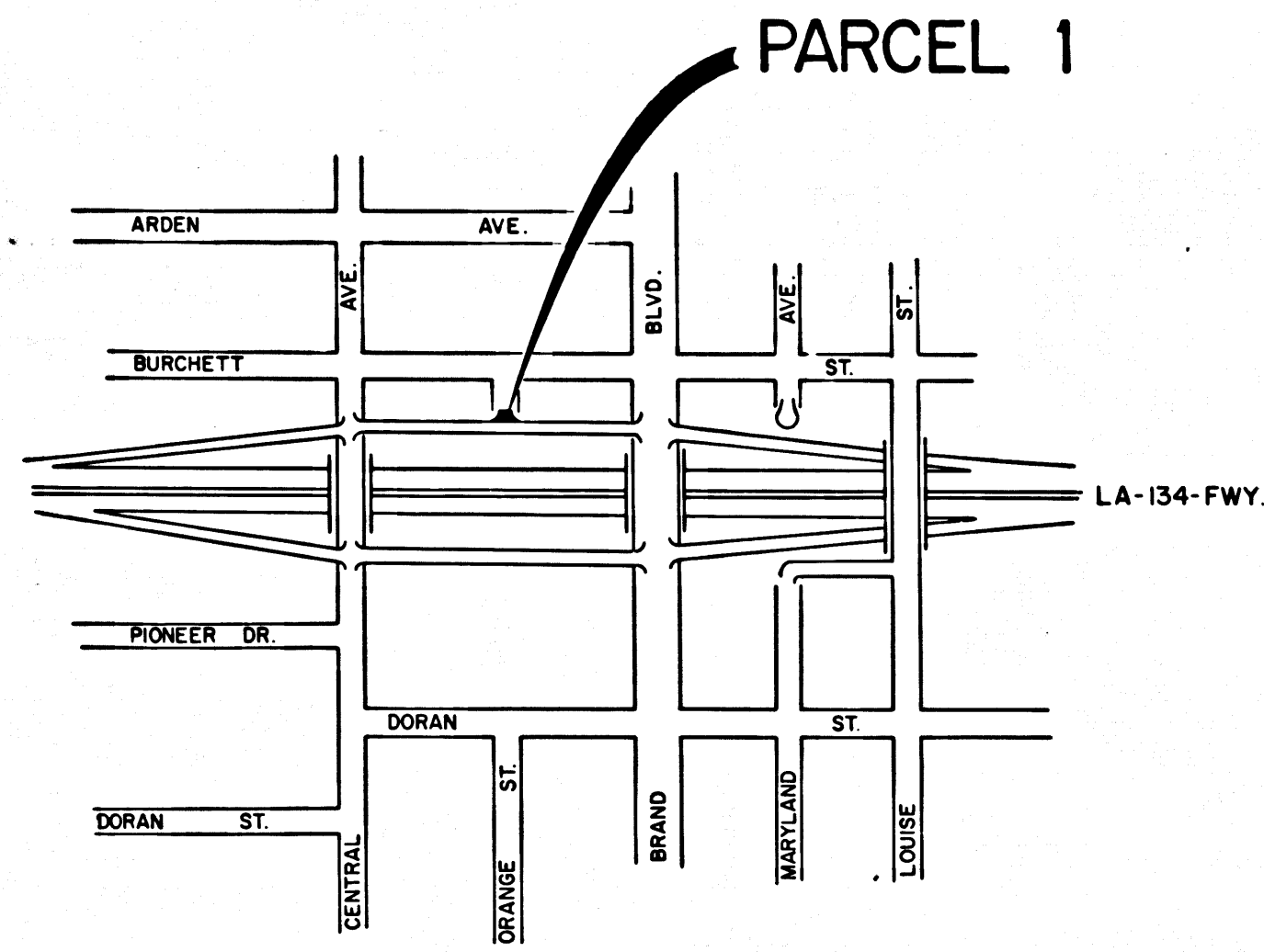

STATE OF CALIFORNIA  
 BUSINESS AND TRANSPORTATION AGENCY  
 DEPARTMENT OF TRANSPORTATION

**PROPOSED RELINQUISHMENT**

ACCESS TO BE RELINQUISHED

0 30 60 90 120

ACCESS PROHIBITED

AREA TO BE RELINQUISHED

DR'N BY V. J. R.	R/W MAP NO. F1163-2
C/LC BY K. M.	CONTRACT NO. 02 0814
C/K'D BY K. M.	REL-1015
REVISED	