

Book No. 15

BOOK 16 PAGE 15

STATE OF CALIFORNIA
BUSINESS AND TRANSPORTATION AGENCY
DEPARTMENT OF TRANSPORTATION

| DIST | COUNTY | ROUTE | POST MILES | SHEET NO. | TOTAL SHEETS |
|------|--------|-------|------------|-----------|--------------|
| 07 | L.A. | 14 | 61.4-64.4 | 1 | 1 |

C.B. Galbraith
RIGHT OF WAY ENGINEERING
REGISTERED CIVIL ENGINEER NO. 14117
DATE: 8-14-78

RIGHT OF WAY MAPS OF
STATE HIGHWAY

In the City of Palmdale on Sierra Highway (Rte. 14) between
the Southerly and Northerly City Limits of Palmdale.
Also on Ave P-8 at Division St.

78-983909
FILED
AT REQUEST OF
DEPT. OF PUBLIC WORKS
SEP 24 1978
27 PAST 2 PM
BOOK 16
PAGE 14
OF STATE HIGHWAY MAPS
LOS ANGELES COUNTY, CALIF.
REGISTERED SURVEYOR
K. Lee
FREE

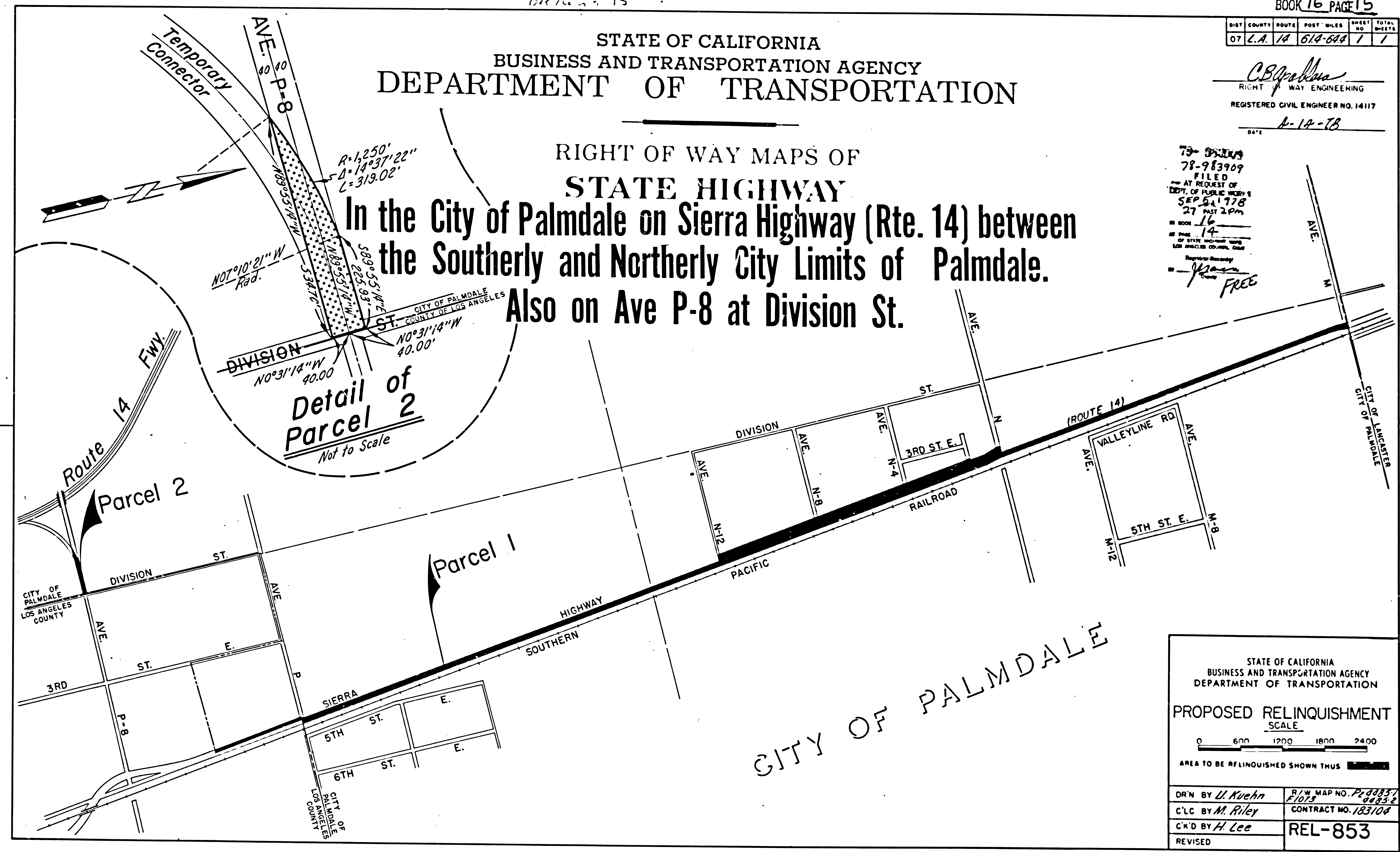

CITY OF PALMDALE

STATE OF CALIFORNIA
BUSINESS AND TRANSPORTATION AGENCY
DEPARTMENT OF TRANSPORTATION

PROPOSED RELINQUISHMENT
SCALE

0 600 1200 1800 2400

AREA TO BE RELINQUISHED SHOWN THUS

| | |
|-------------------------|----------------------------|
| DR'N BY <i>U. Kuehn</i> | R/W MAP NO. <i>P20037</i> |
| C'LC BY <i>M. Riley</i> | <i>F1073</i> |
| C'K'D BY <i>H. Lee</i> | CONTRACT NO. <i>183108</i> |
| REVISED | REL-853 |