

STATE OF CALIFORNIA
 BUSINESS AND TRANSPORTATION AGENCY
 DEPARTMENT OF TRANSPORTATION

80-15438

DIST	COUNTY	ROUTE	POST MILES	SHEET NO.	TOTAL SHEETS
07	LA	210	22.0	1	1

FILED
 AT REQUEST OF
 DEPT. OF PUBLIC WORKS
 JAN. 4, 1980
 27 PAST 12 AM
 IN BOOK 16
 AT PAGE 50
 OF STATE HIGHWAY 8-1
 LOS ANGELES COUNTY, CALIF.
 Register-Recorder
 BY [Signature] FREE

Willy Luback
 RIGHT OF WAY ENGINEERING
 REGISTERED CIVIL ENGINEER NO. 8944
 DATE September 18, 1979

RIGHT OF WAY MAPS OF
 STATE HIGHWAY

80-15438

Recorded in the Office
 of the County Recorder
 LOS ANGELES COUNTY

S.H.M.B. No. Pg.

In The City of La Cañada-Flintridge along Route 210 Freeway
 at Linda Vista Avenue (Route 159)

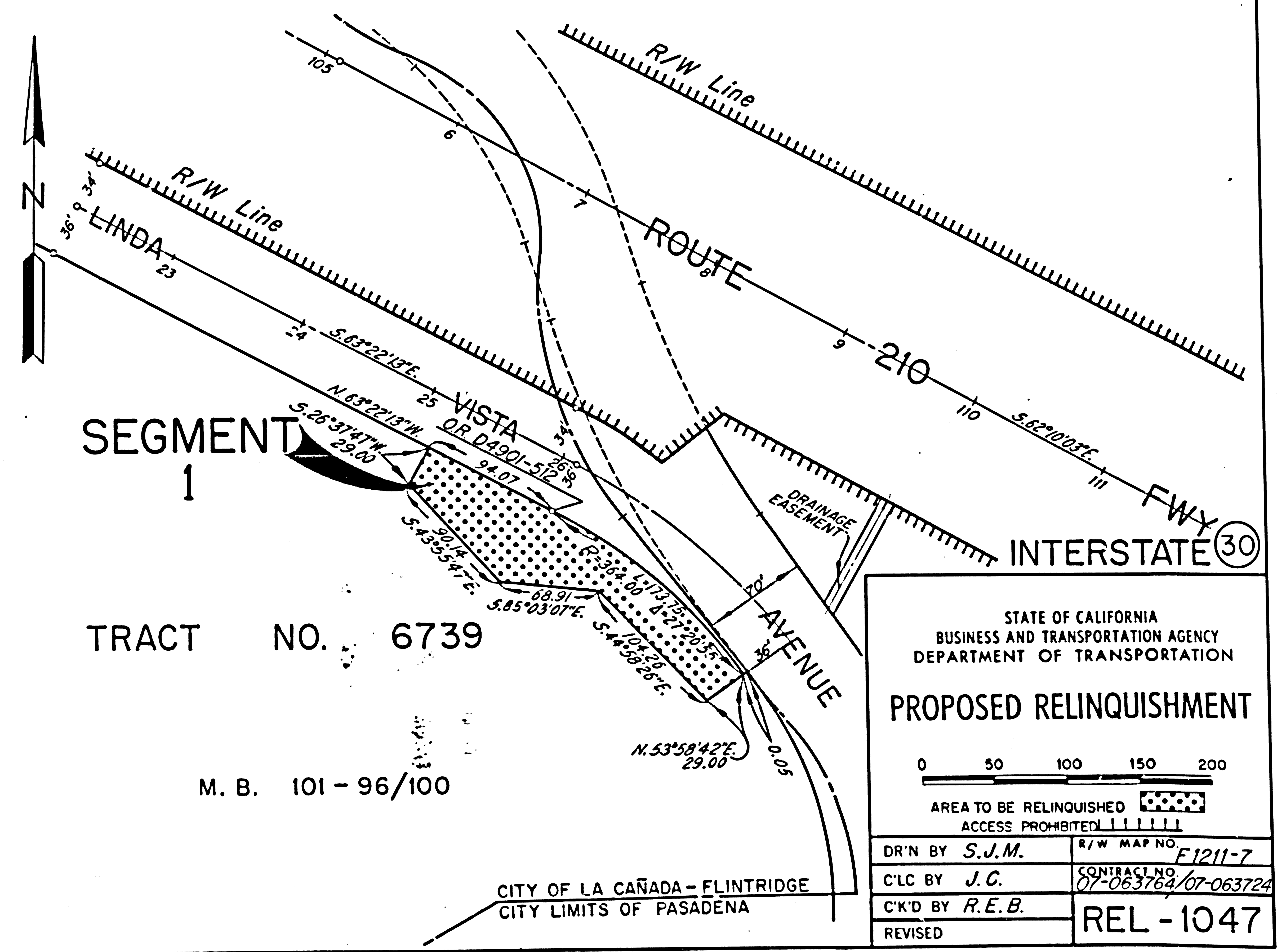
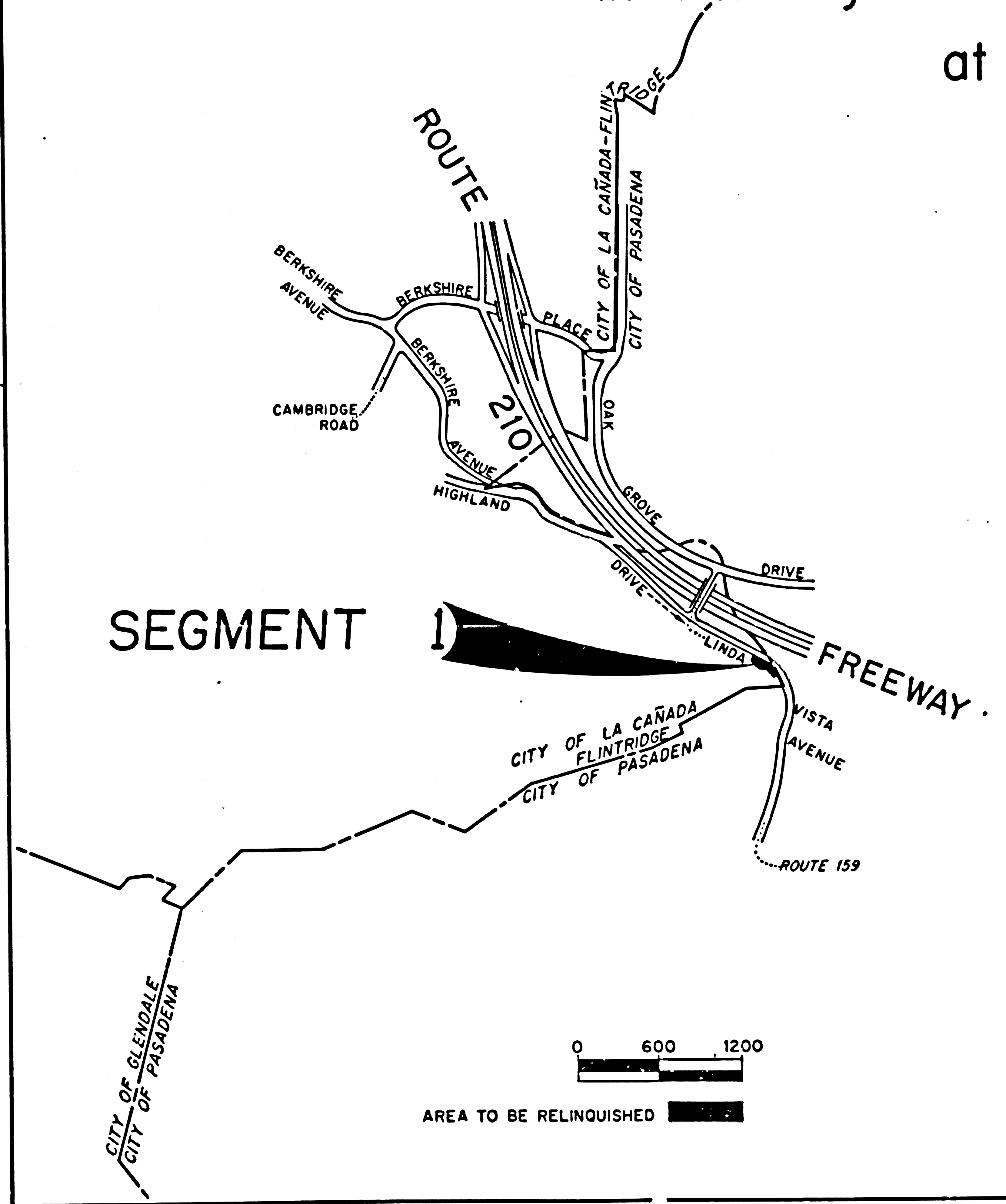

SEGMENT 1
 TRACT NO. 6739
 M. B. 101 - 96/100

STATE OF CALIFORNIA
 BUSINESS AND TRANSPORTATION AGENCY
 DEPARTMENT OF TRANSPORTATION

PROPOSED RELINQUISHMENT

0 50 100 150 200

AREA TO BE RELINQUISHED [Dotted Pattern]
 ACCESS PROHIBITED [Hatched Pattern]

DR'N BY S.J.M.	R/W MAP NO. F1211-7
C/LC BY J.C.	CONTRACT NO. 07-063763/07-063724
C/K'D BY R.E.B.	REL - 1047
REVISED	

