

BOOK 16 PAGE 65

STATE	FEDERAL PROJECT NO.				
CALIF.	U-086-1 (1)				
DIST	COUNTY	ROUTE	POST MILES	PREF. NO.	TOTAL SHEETS
07	LA	134	7.0	1	2

STATE OF CALIFORNIA
 BUSINESS AND TRANSPORTATION AGENCY
 DEPARTMENT OF TRANSPORTATION

RIGHT OF WAY MAPS OF
 STATE HIGHWAY
 In the City of Glendale along Rte. 134 Fwy.
 Between Central Ave. and Brand Blvd.

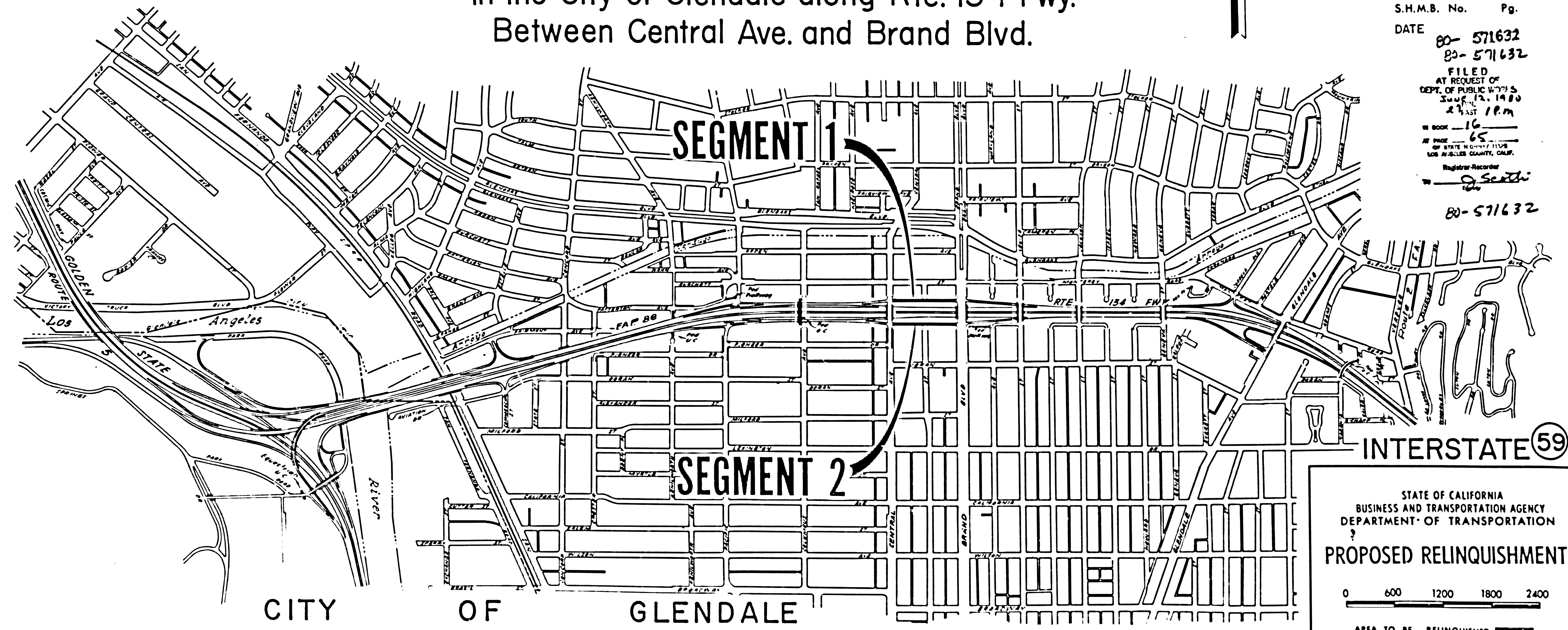

Walter Lubasak
 RIGHT OF WAY ENGINEERING
 REGISTERED CIVIL ENGINEER NO. 8944
 1-21-80
 DATE

Recorded in the Office
 of the County Recorder
 LOS ANGELES COUNTY

S.H.M.B. No. Pg.
 DATE 80-571632
 80-571632

FILED
 AT REQUEST OF
 DEPT. OF PUBLIC WORKS
 JUNE 12, 1980
 2:45 PM
 W BOOK 16
 P PAGE 65
 OF STATE HIGHWAY MAPS
 LOS ANGELES COUNTY, CALIF.

Registrar-Recorder
J. Scott
 80-571632

STATE OF CALIFORNIA
 BUSINESS AND TRANSPORTATION AGENCY
 DEPARTMENT OF TRANSPORTATION
PROPOSED RELINQUISHMENT

0 600 1200 1800 2400

AREA TO BE RELINQUISHED

DR'N BY M.L.S.	R/W MAP NO. F1163-2
C'LC BY H.H.	CONTRACT NO. 07-020814
C'K'D BY R.A.	REL-1054
REVISED	

BOOK 116 PAGE 66

STATE	FEDERAL PROJECT NO.			
CALIF.	U-086-1(1)			
DIST.	COUNTY	ROUTE	POST MILES	SHEET NO.
07	LA	134	7.0	2
				TOTAL SHEETS
				2

FILED WITH LOS ANGELES
REGISTRAR-RECORDER
JUN 12 1980

Walter L. Kubasek
RIGHT OF WAY ENGINEERING
REGISTERED CIVIL ENGINEER NO. 8944
1-21-80
DATE

Recorded in the Office
of the County Recorder
LOS ANGELES COUNTY

S.H.M.B. No. Pg.
DATE

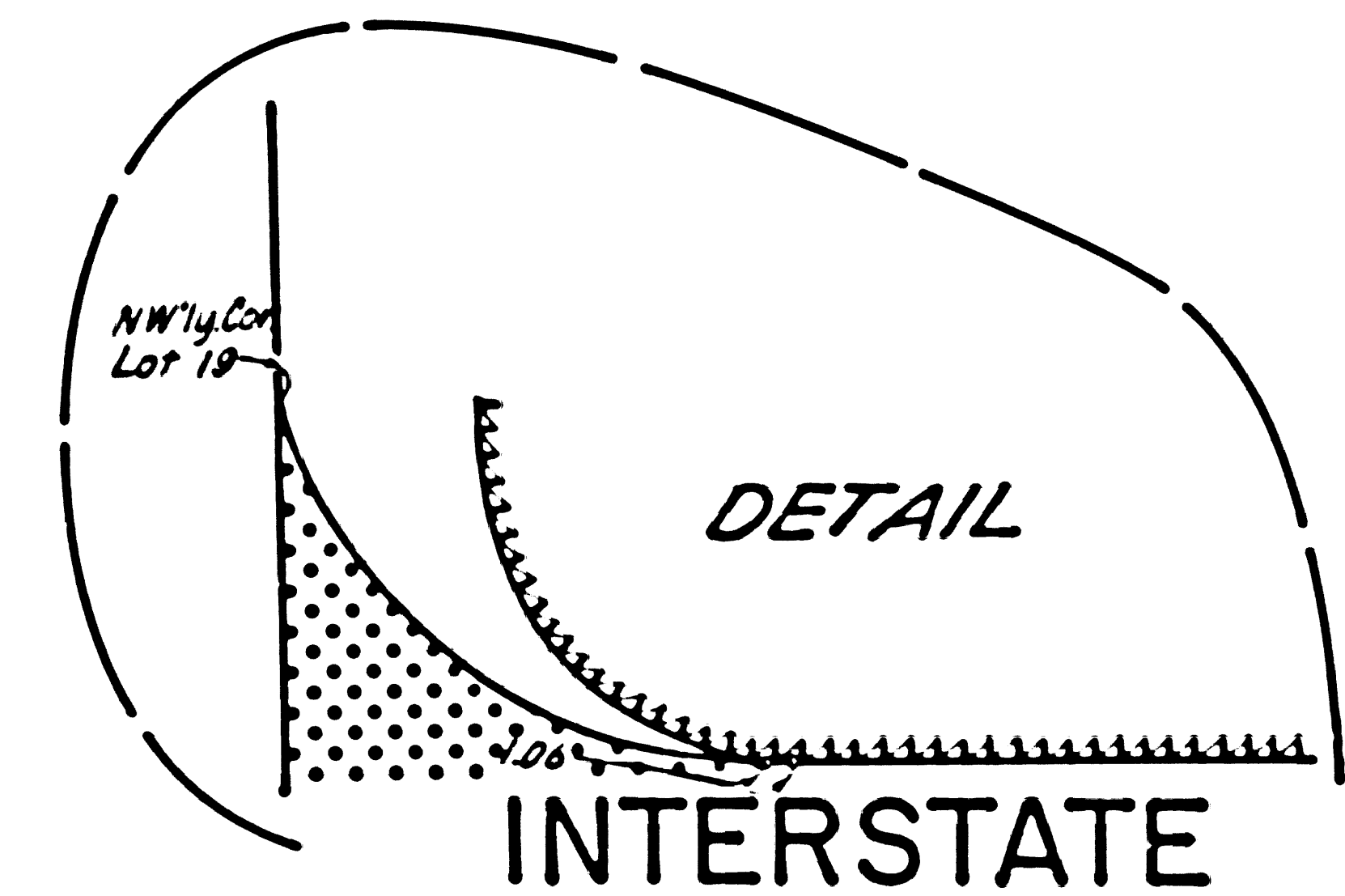

STATE OF CALIFORNIA
BUSINESS AND TRANSPORTATION AGENCY
DEPARTMENT OF TRANSPORTATION

PROPOSED RELINQUISHMENT

0 50 100 150 200

ACCESS TO BE RELINQUISHED [dotted pattern]

AREA TO BE RELINQUISHED [dotted pattern]

ACCESS PROHIBITED [hatched pattern]

DR'N BY	M.L.S.	R/W MAP NO.	F1163-2
C'LC BY	H.H.	CONTRACT NO.	07-020814
C'K'D BY	RA	REL-1054	
REVISED			

CITY OF GLENDALE

BURCHETT

ST.

SEGMENT 1

NW 1/4 Cor. Lot 19
D5050-634/656

R=25.00
Δ=73°09'25"
L=31.92

See Detail

R=20.00
Δ=90°05'01"
L=31.44

OVERCROSSING
CENTRAL 100'±240'±W AVE.

N89°47'34"E 735.32

N89°47'34"E

FRONTAGE RD.

N89°47'34"E 779.11

1106±05.07 ± Const
26±27.63 Central

RTE 134 FWY

N89°47'34"E 1110

ORANGE

SEGMENT 2

D 4432-267/269

129.19

R=974.00 Δ=11°31'45" L=195.99

N89°47'34"E 477.09

FRONTAGE RD. N89°47'34"E

N78°40'41"W

R=1000.00

N89°47'34"E 308.35

R=40.00
Δ=101°43'19"
L=71.02

R=15.00
Δ=59°59'58"
L=15.71

R=15.00
Δ=51°53'30"
L=13.59

R=40.00
Δ=60°57'44"
L=42.56

R=1003.00 Δ=11°31'45" L=207.26

N89°47'34"E

ORANGE

BRAND

BLVD.

BRAND

1174±74.98 ± Const
25±18.61 ± Const